

SEE THE TRAFFIC SIGNAL PLANS FOR TRAFFIC SIGNAL REMOVAL ITEMS.

SEE THE ROADWAY LIGHTING PLANS FOR ROADWAY LIGHTING REMOVAL ITEMS.

SEE DRAINAGE PLANS FOR ADDITIONAL INFORMATION.

THE LIMITS OF SIDEWALK REMOVAL AND BRICK PAVER REMOVAL ARE NOT SHOWN FOR THE REMOVAL AND/OR INSTALLATION OF LIGHT POLES, JUNCTION BOXES, OR PARKING METERS. QUANTITIES FOR THIS WORK ARE INCLUDED ON THE PLANS.

THE STRUCTURE INFORMATION SHOWN IN ITALICS IS ALSO SHOWN ON THE DRAINAGE PLANS. THE SCHEDULE OF QUANTITIES FOR THESE ITEMS IS SHOWN ON THE REMOVAL PLANS.

SEE SHEET 11 FOR REMOVAL NOTES

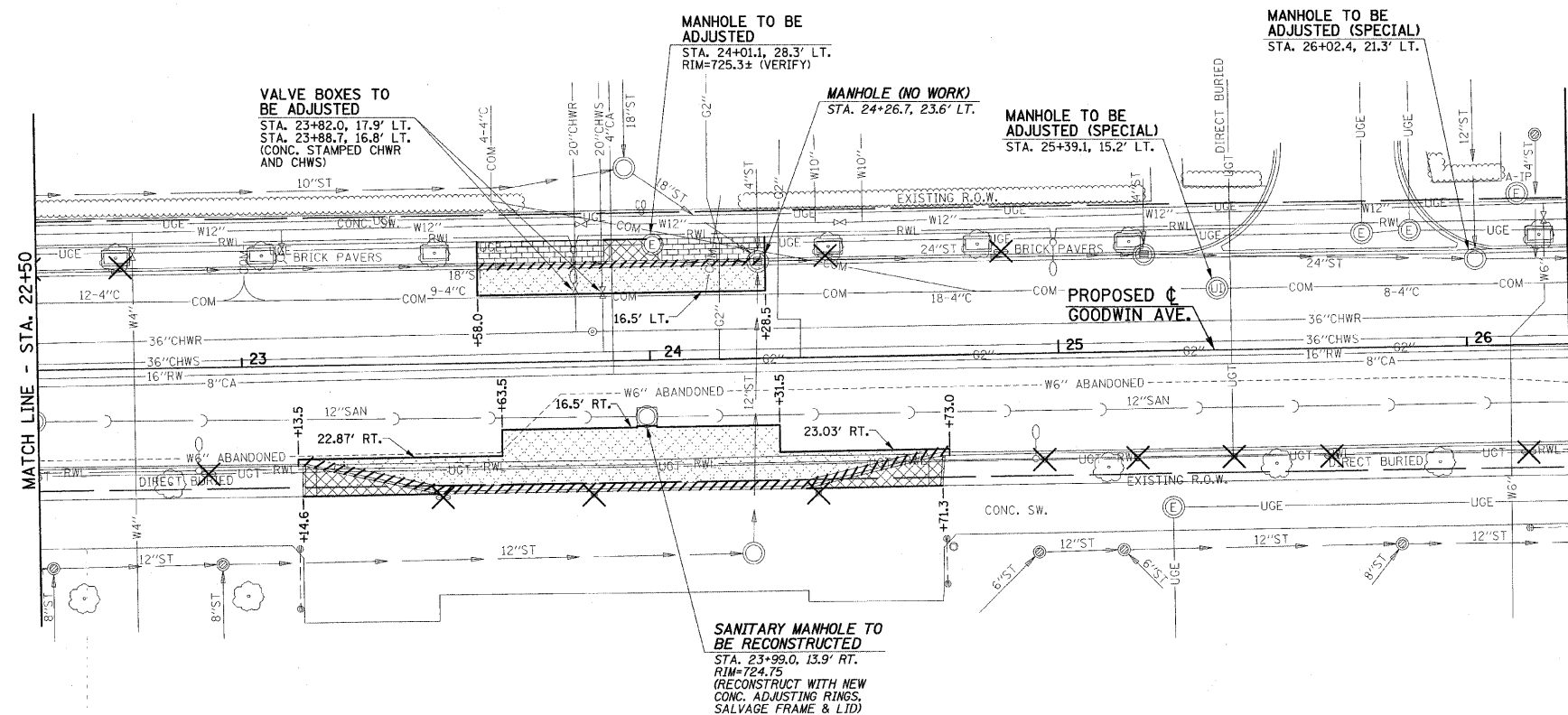

REMOVE AND REINSTALL BRICK PAVER (XX003313)		
STATION	TO STATION	SQ FT
23+58 LT.	24+28.5 LT.	303.4
ROADWAY LIGHTING		175.0
PARKING METER POSTS		20.0
SHEET TOTAL		498.4

PAVEMENT REMOVAL (44000100)		
STATION	TO STATION	SQ YD
23+58 LT.	24+28.5 LT.	49.4
23+13.5 RT.	24+73 RT.	144.0
SHEET TOTAL		193.4

COMBINATION CURB AND GUTTER REMOVAL (44000500)		
STATION	TO STATION	FOOT
23+58 LT.	24+28.5 LT.	70.5
23+13.5 RT.	24+73 RT.	161.1
SHEET TOTAL		231.6

SIDEWALK REMOVAL (44000600)		
STATION	TO STATION	SQ FT
23+89.1 LT.	24+03.3 LT.	75.6
23+14.6 RT.	24+71.3 RT.	253.8
PARKING METER POSTS		30.0
SHEET TOTAL		359.4

PARKING METER POSTS TO BE REMOVED (Z0036700)		
STATION	TO STATION	EACH
22+71 LT.	24+86 LT.	3
22+92 RT.	26+15 RT.	9
SHEET TOTAL		12

STRUCTURE ADJUSTMENT AND REMOVAL PAY ITEMS - 22+50 TO 26+25		
CODE NO.	DESCRIPTION	UNIT   QUAN.
60255500	MANHOLES TO BE ADJUSTED	EACH   1
60255600	MANHOLES TO BE ADJUSTED (SPECIAL)	EACH   2
60260050	SANITARY MANHOLES TO BE RECONSTRUCTED	EACH   1
60266600	VALVE BOXES TO BE ADJUSTED	EACH   2

FILE NAME = p:\u0070052\plans\sheets\10-Removal.dgn  
 PLOT DATE = 2/27/2009 3:21:40 PM

DESIGNED - JAJ  
 DRAWN - DLM  
 CHECKED - RLH  
 DATE - 01-2009

REVISED -  
 REVISED -  
 REVISED -  
 REVISED -

STATE OF ILLINOIS  
 DEPARTMENT OF TRANSPORTATION

REMOVALS/RELOCATIONS PLAN

SCALE: 1"=20' SHEET NO. 14 OF 75 SHEETS STA. 22+50 TO STA. 26+25

REVISED A-6-09

F.A.U. RTE.	SECTION	COUNTY	TOTAL SHEETS	SHEET NO.
7175	07-00456-00-RS	CHAMPAIGN	75	14
GOODWIN AVENUE		CONTRACT NO. 91392		
FED. ROAD DIST. NO.		ILLINOIS FED. AID PROJECT		