

SEC. 18, T.19N., R.9E., 3rd P.M.
CHAMPAIGN COUNTY, ILLINOIS

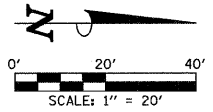

FOR THE COMB CC&G TB6.12 SPL, A 1-FOOT STUB SHALL BE CONSTRUCTED PERPENDICULAR TO THE SAWED EDGE OF EXISTING PAVEMENT AT THE LOCATIONS SHOWN ON THE PLANS. SEE THE TYPICAL SECTIONS FOR ADDITIONAL INFORMATION.

THE LIMITS OF SIDEWALK INSTALLATION, BRICK PAVER INSTALLATION, AND SEEDING ARE NOT SHOWN FOR THE REMOVAL AND/OR INSTALLATION OF LIGHT POLES, JUNCTION BOXES, OR PARKING METERS. QUANTITIES FOR THIS WORK ARE INCLUDED ON THE PLANS.

SEE THE INTERSECTION DETAILS FOR THE PROPOSED CURB HEIGHTS FOR THE COMB CC&G TB6.12 SPL AND THE TYPE B CURB.

SEE THE INTERSECTION DETAILS FOR THE LOCATIONS OF THE MONOLITHIC CURB ADJACENT TO THE PROPOSED CONCRETE SIDEWALK.

SEE THE INTERSECTION DETAILS FOR ADDITIONAL INFORMATION.

KEY NOTES

- ① 1' STUB

BEGIN IMPROVEMENTS
GREGORY DR.
STA. 99+27.00
(MATCH EXISTING)

BEGIN IMPROVEMENTS
GOODWIN AVE.
STA. 10+00.00

STA. 10+00.00
(C GOODWIN AVE.) =
STA. 100+00.00
(C GREGORY DRIVE)

END IMPROVEMENTS
GREGORY DR.
STA. 100+87.00
(MATCH EXISTING)

TBM #1
SOUTHEAST TOP FLANGE BOLT HEAD
OF FIRE HYDRANT AT STA. 99+51.3 RT.
ELEV.= 743.59

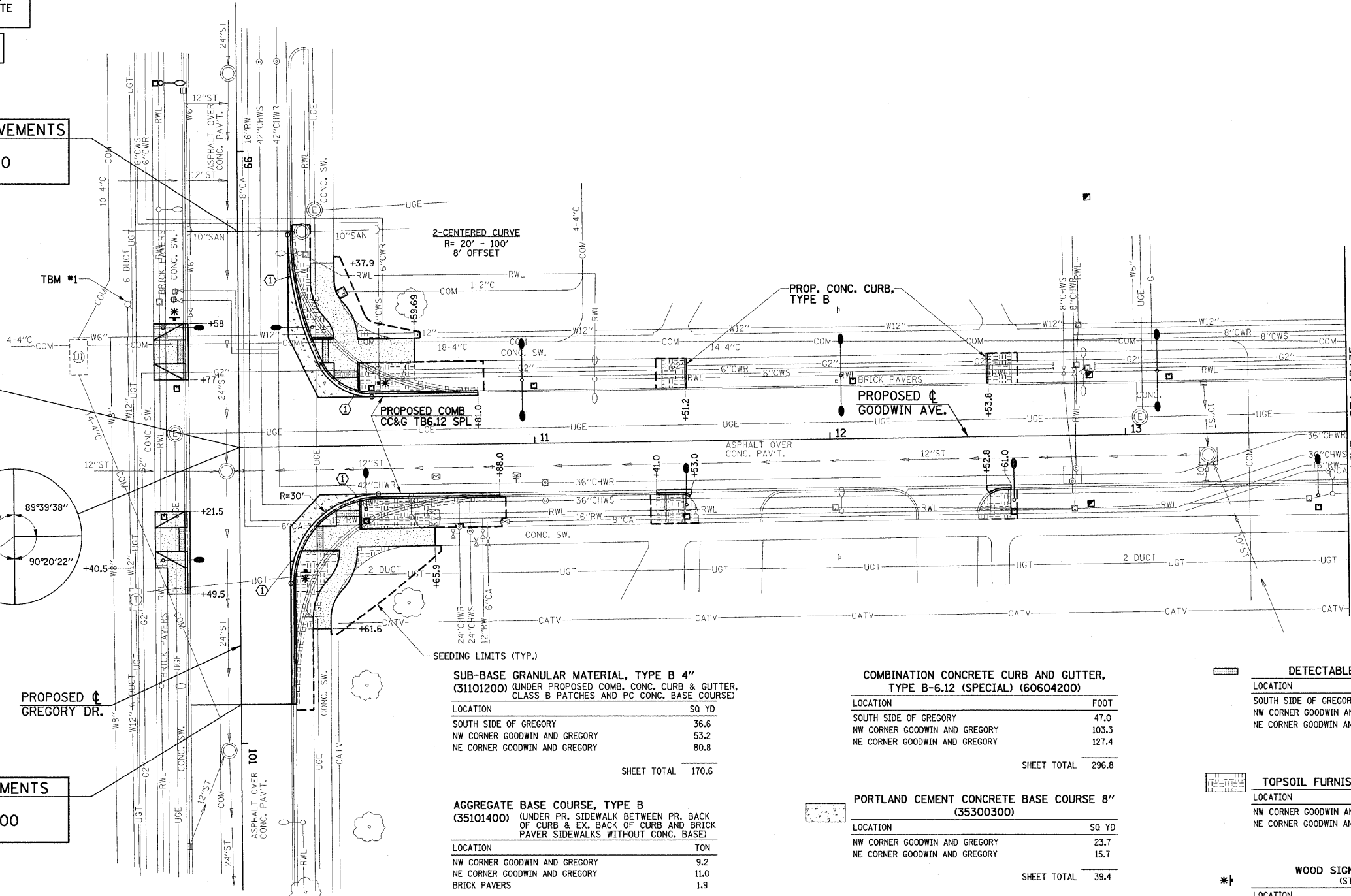

SEEDING LIMITS (TYP.)

SUB-BASE GRANULAR MATERIAL, TYPE B 4" (31101200) (UNDER PROPOSED COMB. CONC. CURB & GUTTER, CLASS B PATCHES AND PC CONC. BASE COURSE)

LOCATION	SQ YD
SOUTH SIDE OF GREGORY	36.6
NW CORNER GOODWIN AND GREGORY	53.2
NE CORNER GOODWIN AND GREGORY	80.8
SHEET TOTAL	170.6

AGGREGATE BASE COURSE, TYPE B (35101400) (UNDER PR. SIDEWALK BETWEEN PR. BACK OF CURB & EX. BACK OF CURB AND BRICK PAVER SIDEWALKS WITHOUT CONC. BASE)

LOCATION	TON
NW CORNER GOODWIN AND GREGORY	9.2
NE CORNER GOODWIN AND GREGORY	11.0
BRICK PAVERS	1.9
SHEET TOTAL	22.1

CONCRETE CURB, TYPE B (60600605)

LOCATION	FOOT
STA. 11+51.2 LT.	9.9
STA. 12+53.8 LT.	10.1
SHEET TOTAL	20.0

COMBINATION CONCRETE CURB AND GUTTER, TYPE B-6.12 (SPECIAL) (60604200)

LOCATION	FOOT
SOUTH SIDE OF GREGORY	47.0
NW CORNER GOODWIN AND GREGORY	103.3
NE CORNER GOODWIN AND GREGORY	127.4
SHEET TOTAL	296.8

PORTLAND CEMENT CONCRETE BASE COURSE 8" (35300300)

LOCATION	SQ YD
NW CORNER GOODWIN AND GREGORY	23.7
NE CORNER GOODWIN AND GREGORY	15.7
SHEET TOTAL	39.4

PORTLAND CEMENT CONCRETE SIDEWALK 6 INCH (42400300)

LOCATION	SQ FT
SOUTH SIDE OF GREGORY	436.4
NW CORNER GOODWIN AND GREGORY	567.5
NE CORNER GOODWIN AND GREGORY	553.2
SHEET TOTAL	1557.1

DETECTABLE WARNINGS (42400800)

LOCATION	SQ FT
SOUTH SIDE OF GREGORY	32
NW CORNER GOODWIN AND GREGORY	32
NE CORNER GOODWIN AND GREGORY	32
SHEET TOTAL	96

TOPSOIL FURNISH AND PLACE, 6" (21101625)

LOCATION	SQ YD
NW CORNER GOODWIN AND GREGORY	63
NE CORNER GOODWIN AND GREGORY	91
SHEET TOTAL	154

WOOD SIGN SUPPORT (73000100) (STOP SIGN LOCATIONS)

LOCATION	FOOT
STA. 99+56.5 RT.	12
STA. 100+42 LT.	12
STA. 10+47.5 LT.	12
SHEET TOTAL	36

SEEDING PAY ITEMS - 10+00 TO 13+75

CODE NO.	DESCRIPTION	UNIT	QUAN.
XX000880	SEEDING, CLASS 1, SPECIAL	SQ YD	390
X0321566	MULCH, SPECIAL	SQ YD	390

FILE NAME = p:\u0070052\plans\sheet\19-SitePlan.dgn
PLOT DATE = 2/27/2009 3:21:44 PM

DESIGNED - JAJ	REVISED -
DRAWN - JRM	REVISED -
CHECKED - RLH	REVISED -
DATE - 01-2009	REVISED -

STATE OF ILLINOIS
DEPARTMENT OF TRANSPORTATION

SITE IMPROVEMENTS PLAN

SCALE: 1"=20' SHEET NO. 19 OF 75 SHEETS STA. 10+00 TO STA. 13+75

F.A.U. RTE.	SECTION	COUNTY	TOTAL SHEETS	SHEET NO.
7175	07-00456-00-RS	CHAMPAIGN	75	19

GOODWIN AVENUE CONTRACT NO. 91392
FED. ROAD DIST. NO. ILLINOIS FED. AID PROJECT

REVISED 4-6-09