

SEC. 18, T.19N., R.9E., 3rd P.M.
CHAMPAIGN COUNTY, ILLINOIS

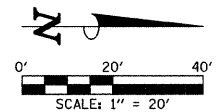

FOR THE COMB CC&G TB6.12 SPL, A 1-FOOT STUB SHALL BE CONSTRUCTED PERPENDICULAR TO THE SAWE EDGE OF EXISTING PAVEMENT AT THE LOCATIONS SHOWN ON THE PLANS. SEE THE TYPICAL SECTIONS FOR ADDITIONAL INFORMATION.

THE LIMITS OF SIDEWALK INSTALLATION, BRICK PAVER INSTALLATION, AND SEEDING ARE NOT SHOWN FOR THE REMOVAL AND/OR INSTALLATION OF LIGHT POLES, JUNCTION BOXES, OR PARKING METERS. QUANTITIES FOR THIS WORK ARE INCLUDED ON THE PLANS.

SEE THE INTERSECTION DETAILS FOR THE PROPOSED CURB HEIGHTS FOR THE COMB CC&G TB6.12 SPL AND THE TYPE B CURB.

SEE THE INTERSECTION DETAILS FOR THE LOCATIONS OF THE MONOLITHIC CURB ADJACENT TO THE PROPOSED CONCRETE SIDEWALK.

SEE THE INTERSECTION DETAILS FOR ADDITIONAL INFORMATION.

KEY NOTES

① 1' STUB

STA. 20+21.10 (C GOODWIN AVE.) =
STA. 300+00.00 (C OREGON ST.)

STA. 20+21.10 (C GOODWIN AVE.) =
STA. 300+03.33 (C OREGON ST.)

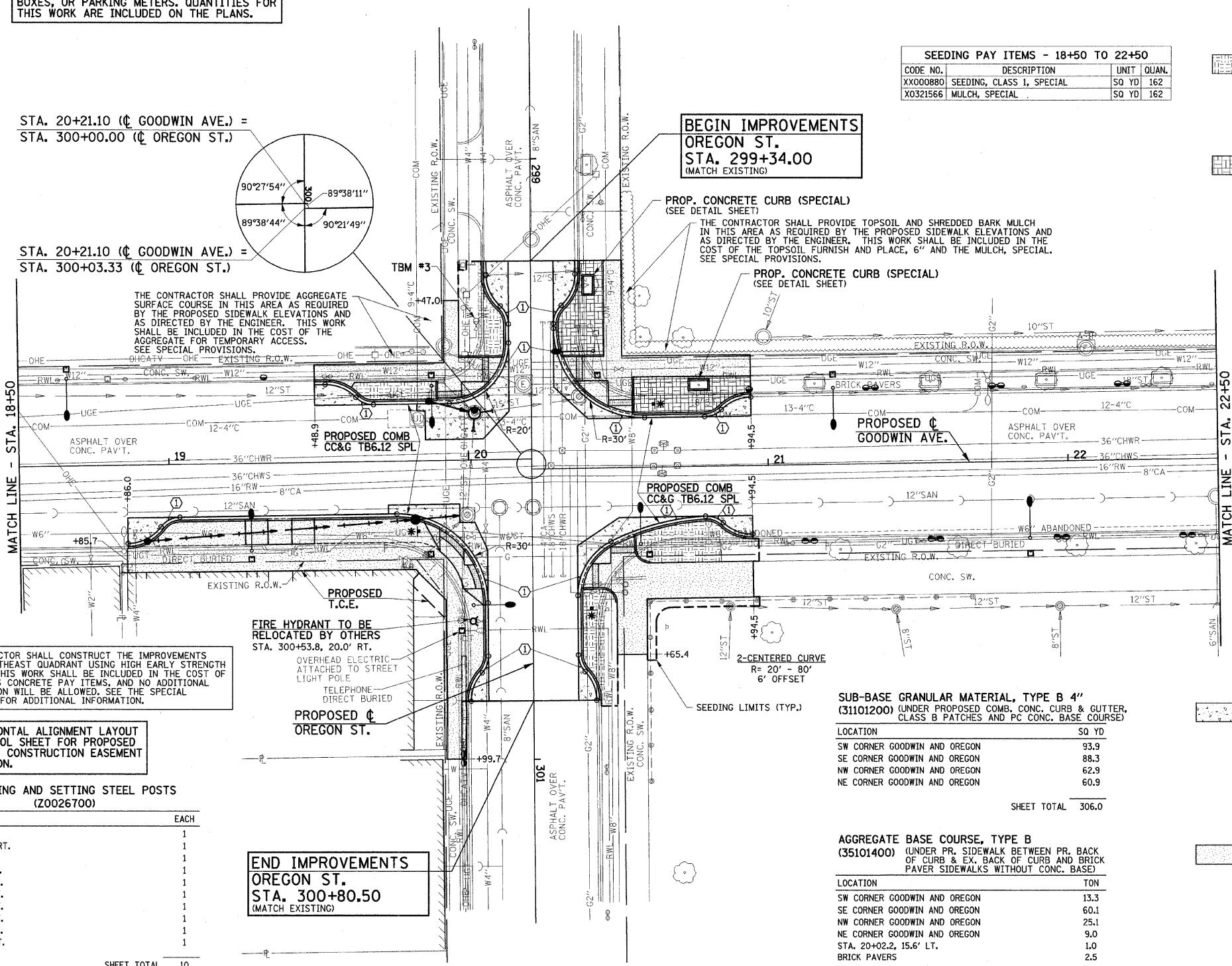

BEGIN IMPROVEMENTS
OREGON ST.
STA. 299+34.00
(MATCH EXISTING)

PROP. CONCRETE CURB (SPECIAL)
(SEE DETAIL SHEET)

THE CONTRACTOR SHALL PROVIDE TOPSOIL AND SHREDDED BARK MULCH IN THIS AREA AS REQUIRED BY THE PROPOSED SIDEWALK ELEVATIONS AND AS DIRECTED BY THE ENGINEER. THIS WORK SHALL BE INCLUDED IN THE COST OF THE TOPSOIL FURNISH AND PLACE, 6" AND THE MULCH, SPECIAL. SEE SPECIAL PROVISIONS.

PROP. CONCRETE CURB (SPECIAL)
(SEE DETAIL SHEET)

THE CONTRACTOR SHALL PROVIDE AGGREGATE SURFACE COURSE IN THIS AREA AS REQUIRED BY THE PROPOSED SIDEWALK ELEVATIONS AND AS DIRECTED BY THE ENGINEER. THIS WORK SHALL BE INCLUDED IN THE COST OF THE AGGREGATE FOR TEMPORARY ACCESS. SEE SPECIAL PROVISIONS.

PROPOSED C
GOODWIN AVE.

FIRE HYDRANT TO BE RELOCATED BY OTHERS
STA. 300+53.8, 20.0' RT.

THE CONTRACTOR SHALL CONSTRUCT THE IMPROVEMENTS ON THE SOUTHEAST QUADRANT USING HIGH EARLY STRENGTH CONCRETE. THIS WORK SHALL BE INCLUDED IN THE COST OF THE VARIOUS CONCRETE PAY ITEMS, AND NO ADDITIONAL COMPENSATION WILL BE ALLOWED. SEE THE SPECIAL PROVISIONS FOR ADDITIONAL INFORMATION.

SEE HORIZONTAL ALIGNMENT LAYOUT AND CONTROL SHEET FOR PROPOSED TEMPORARY CONSTRUCTION EASEMENT INFORMATION.

FURNISHING AND SETTING STEEL POSTS
(Z0026700)

LOCATION	EACH
STA. 19+32 LT.	1
STA. 300+99.5 RT.	1
STA. 20+94 LT.	1
STA. 21+13.5 RT.	1
STA. 21+34.5 LT.	1
STA. 21+55.5 RT.	1
STA. 21+76.5 LT.	1
STA. 21+97.5 RT.	1
STA. 22+18.5 LT.	1
STA. 22+39.5 RT.	1
SHEET TOTAL	10

WOOD SIGN SUPPORT (73000100)
(STOP SIGN LOCATIONS)

LOCATION	FOOT
STA. 19+83 RT.	12
STA. 20+62 LT.	12
STA. 300+50 LT.	12
SHEET TOTAL	36

END IMPROVEMENTS
OREGON ST.
STA. 300+80.50
(MATCH EXISTING)

TBM #3
NORTHEAST TOP FLANGE BOLT HEAD OF FIRE HYDRANT AT STA. 20+03.3 LT. ELEV.= 733.83

SEEDING PAY ITEMS - 18+50 TO 22+50

CODE NO.	DESCRIPTION	UNIT	QUAN.
XX000880	SEEDING, CLASS 1, SPECIAL	SQ YD	162
X0321566	MULCH, SPECIAL	SQ YD	162

TOPSOIL FURNISH AND PLACE, 6" (21101625)

LOCATION	SQ YD
SW CORNER GOODWIN AND OREGON	35
NE CORNER GOODWIN AND OREGON	66
SHEET TOTAL	101

BRICK PAVER SIDEWALK (XX004688)

LOCATION	SQ FT
NW CORNER GOODWIN AND OREGON	220
SHEET TOTAL	220

NOTE: A QUANTITY OF 505 SQ FT OF SALVAGED BRICK PAVERS SHALL BE USED AT THIS LOCATION. THIS WORK IS INCLUDED IN THE COST OF REMOVE AND REINSTALL BRICK PAVER. THE BRICK PAVER SIDEWALK AT THIS LOCATION SHALL HAVE A CONCRETE SIDEWALK BASE. SEE SPECIAL PROVISIONS.

CONCRETE CURB (SPECIAL) (60600505)

LOCATION	FOOT
NW CORNER GOODWIN AND OREGON	44.0
SHEET TOTAL	44.0

SUB-BASE GRANULAR MATERIAL, TYPE B 4" (31101200) (UNDER PROPOSED COMB. CONC. CURB & GUTTER, CLASS B PATCHES AND PC CONC. BASE COURSE)

LOCATION	SQ YD
SW CORNER GOODWIN AND OREGON	93.9
SE CORNER GOODWIN AND OREGON	88.3
NW CORNER GOODWIN AND OREGON	62.9
NE CORNER GOODWIN AND OREGON	60.9
SHEET TOTAL	306.0

PORTLAND CEMENT CONCRETE BASE COURSE 8" (35300300)

LOCATION	SQ YD
SW CORNER GOODWIN AND OREGON	63.7
SE CORNER GOODWIN AND OREGON	38.9
NW CORNER GOODWIN AND OREGON	32.1
NE CORNER GOODWIN AND OREGON	30.3
SHEET TOTAL	165.0

AGGREGATE BASE COURSE, TYPE B (35101400) (UNDER PR. SIDEWALK BETWEEN PR. BACK OF CURB & EX. BACK OF CURB AND BRICK PAVER SIDEWALKS WITHOUT CONC. BASE)

LOCATION	TON
SW CORNER GOODWIN AND OREGON	13.3
SE CORNER GOODWIN AND OREGON	60.1
NW CORNER GOODWIN AND OREGON	25.1
NE CORNER GOODWIN AND OREGON	9.0
STA. 20+02.2, 15.6' LT. BRICK PAVERS	1.0
	2.5
SHEET TOTAL	111.0

PORTLAND CEMENT CONCRETE SIDEWALK 6 INCH (42400300)

LOCATION	SQ FT
SW CORNER GOODWIN AND OREGON	575.4
SE CORNER GOODWIN AND OREGON	2410.4
NW CORNER GOODWIN AND OREGON	1504.4
NE CORNER GOODWIN AND OREGON	913.5
ROADWAY LIGHTING	105.0
SHEET TOTAL	5508.7

COMBINATION CONCRETE CURB AND GUTTER, TYPE B-6.12 (SPECIAL) (60604200)

LOCATION	FOOT
SW CORNER GOODWIN AND OREGON	106.0
SE CORNER GOODWIN AND OREGON	172.5
NW CORNER GOODWIN AND OREGON	107.6
NE CORNER GOODWIN AND OREGON	107.4
SHEET TOTAL	493.5

DETECTABLE WARNINGS (42400800)

LOCATION	SQ FT
SW CORNER GOODWIN AND OREGON	32.0
SE CORNER GOODWIN AND OREGON	38.9
NW CORNER GOODWIN AND OREGON	32.0
NE CORNER GOODWIN AND OREGON	32.0
SHEET TOTAL	134.9

REVISED 4-6-09

FILE NAME = p:\u0070052\plans\sheet\19-SitePlan.dgn
PLOT DATE = 2/27/2009 3:21:46 PM

DESIGNED - JAJ
DRAWN - JRM
CHECKED - RLH
DATE - 01-2009

REVISED -
REVISED -
REVISED -
REVISED -

STATE OF ILLINOIS
DEPARTMENT OF TRANSPORTATION

SITE IMPROVEMENTS PLAN

SCALE: 1"=20' SHEET NO. 21 OF 75 SHEETS STA. 18+50 TO STA. 22+50

F.A.U. RTE.	SECTION	COUNTY	TOTAL SHEETS	SHEET NO.
7175	07-00456-00-RS	CHAMPAIGN	75	21
GOODWIN AVENUE			CONTRACT NO. 91392	
FED. ROAD DIST. NO.			ILLINOIS FED. AID PROJECT	