

FOR THE COMB CC&G TB6.12 SPL, A 1-FOOT STUB SHALL BE CONSTRUCTED PERPENDICULAR TO THE SAWED EDGE OF EXISTING PAVEMENT AT THE LOCATIONS SHOWN ON THE PLANS. SEE THE TYPICAL SECTIONS FOR ADDITIONAL INFORMATION.

THE LIMITS OF SIDEWALK INSTALLATION, BRICK PAVER INSTALLATION, AND SEEDING ARE NOT SHOWN FOR THE REMOVAL AND/OR INSTALLATION OF LIGHT POLES, JUNCTION BOXES, OR PARKING METERS. QUANTITIES FOR THIS WORK ARE INCLUDED ON THE PLANS.

SEE THE INTERSECTION DETAILS FOR THE PROPOSED CURB HEIGHTS FOR THE COMB CC&G TB6.12 SPL AND THE TYPE B CURB.

SEE THE INTERSECTION DETAILS FOR THE LOCATIONS OF THE MONOLITHIC CURB ADJACENT TO THE PROPOSED CONCRETE SIDEWALK.

SEE THE INTERSECTION DETAILS FOR ADDITIONAL INFORMATION.

KEY NOTES

- ① 1' STUB

**BEGIN IMPROVEMENTS
SPRINGFIELD AVE.
STA. 596+65.00
(MATCH EXISTING)**

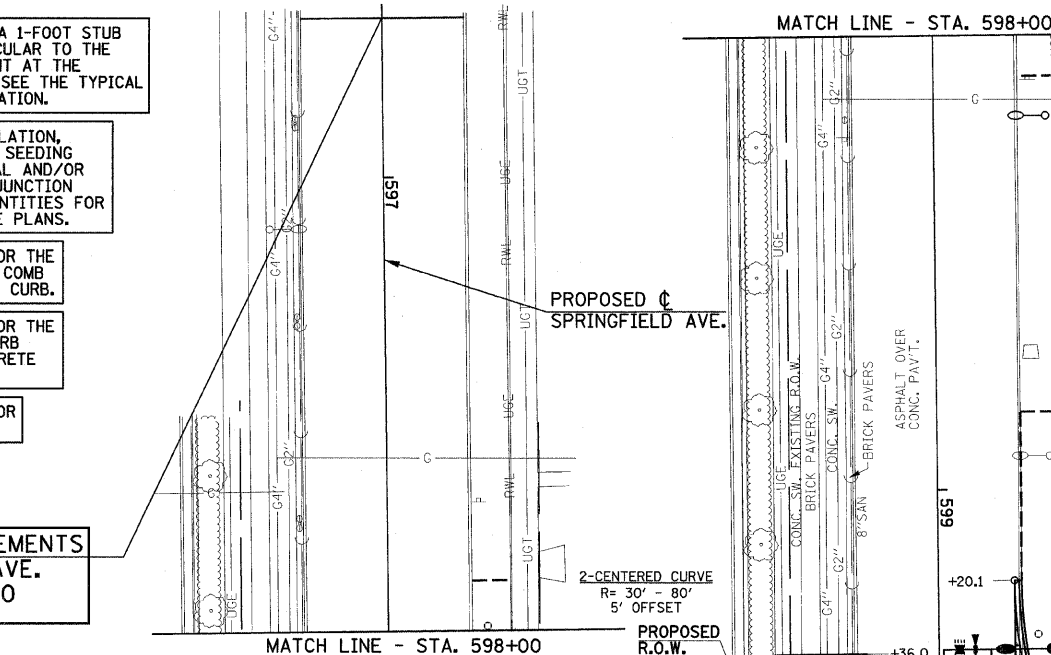

SUB-BASE GRANULAR MATERIAL, TYPE B 4" (31101200)
(UNDER PROPOSED COMB. CONC. CURB & GUTTER, CLASS B PATCHES AND PC CONC. BASE COURSE)

LOCATION	SQ YD
SW CORNER GOODWIN AND SPRINGFIELD	67.2
SE CORNER GOODWIN AND SPRINGFIELD	149.6
NW CORNER GOODWIN AND SPRINGFIELD	136.2
NE CORNER GOODWIN AND SPRINGFIELD	158.3
SHEET TOTAL	511.3

AGGREGATE BASE COURSE, TYPE B (35101400)
(UNDER PR. SIDEWALK BETWEEN PR. BACK OF CURB & EX. BACK OF CURB AND BRICK PAVER SIDEWALKS WITHOUT CONC. BASE)

LOCATION	TON
SW CORNER GOODWIN AND SPRINGFIELD	4.6
STA. 41+05.2, 15.7' RT.	1.1
STA. 41+47.0, 27.0' RT.	1.1
BRICK PAVERS	0.2
SHEET TOTAL	7.0

COMBINATION CONCRETE CURB AND GUTTER, TYPE B-6.12 (SPECIAL) (60604200)

LOCATION	FOOT
SW CORNER GOODWIN AND SPRINGFIELD	98.5
SE CORNER GOODWIN AND SPRINGFIELD	121.0
NW CORNER GOODWIN AND SPRINGFIELD	80.1
NE CORNER GOODWIN AND SPRINGFIELD	96.7
SHEET TOTAL	396.3

CONCRETE CURB TYPE B (SPECIAL) (60601005)

LOCATION	FOOT
NW CORNER GOODWIN AND SPRINGFIELD	60.0
SHEET TOTAL	60.0

PORTLAND CEMENT CONCRETE BASE COURSE 8" (35300300)

LOCATION	SQ YD
SW CORNER GOODWIN AND SPRINGFIELD	39.0
SE CORNER GOODWIN AND SPRINGFIELD	115.1
NW CORNER GOODWIN AND SPRINGFIELD	70.8
NE CORNER GOODWIN AND SPRINGFIELD	68.5
SHEET TOTAL	293.4

PORTLAND CEMENT CONCRETE SIDEWALK 6 INCH (42400300)

LOCATION	SQ FT
SW CORNER GOODWIN AND SPRINGFIELD	1114.1
SE CORNER GOODWIN AND SPRINGFIELD	500.5
NW CORNER GOODWIN AND SPRINGFIELD	984.6
NE CORNER GOODWIN AND SPRINGFIELD	1011.5
ROADWAY LIGHTING	180.0
PARKING METER POSTS	20.0
SHEET TOTAL	3810.7

DETECTABLE WARNINGS (42400800)

LOCATION	SQ FT
SW CORNER GOODWIN AND SPRINGFIELD	42.0
SE CORNER GOODWIN AND SPRINGFIELD	20.9
NW CORNER GOODWIN AND SPRINGFIELD	34.7
NE CORNER GOODWIN AND SPRINGFIELD	36.4
SHEET TOTAL	134.0

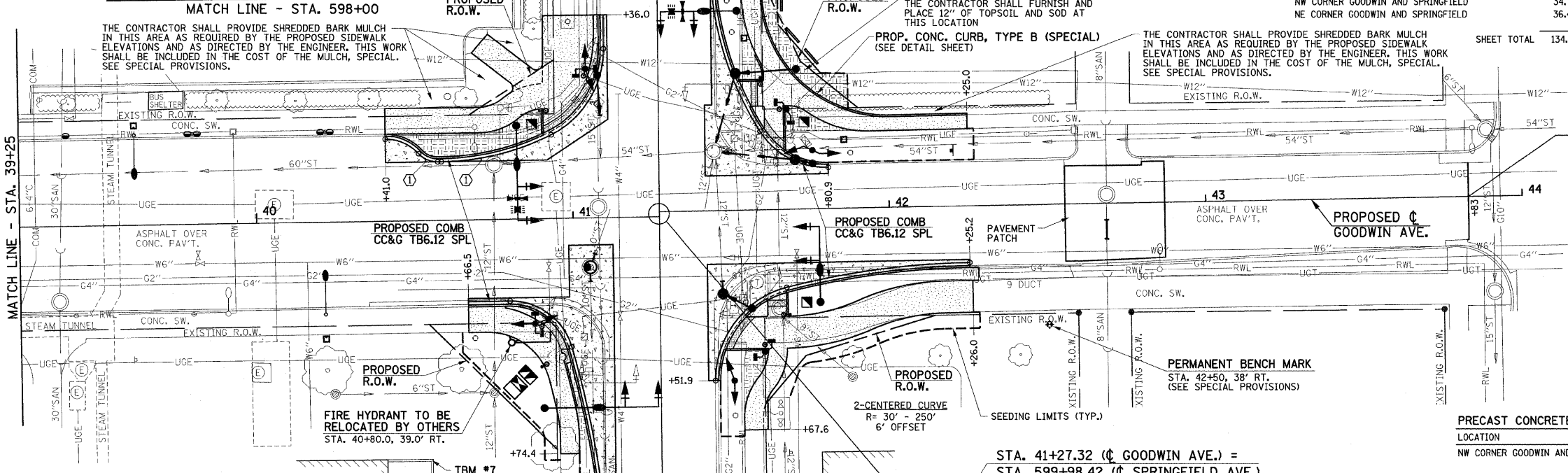
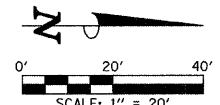

**TOPSOIL F & P 12 = 36 SQ YD
SODDING = 36 SQ YD**
THE CONTRACTOR SHALL FURNISH AND PLACE 12" OF TOPSOIL AND SOD AT THIS LOCATION

PROP. CONC. CURB, TYPE B (SPECIAL)
(SEE DETAIL SHEET)

THE CONTRACTOR SHALL PROVIDE SHREDDED BARK MULCH IN THIS AREA AS REQUIRED BY THE PROPOSED SIDEWALK ELEVATIONS AND AS DIRECTED BY THE ENGINEER. THIS WORK SHALL BE INCLUDED IN THE COST OF THE MULCH, SPECIAL. SEE SPECIAL PROVISIONS.

TBM #7
CHISELED SQUARE IN TOP OF ACCESS WELL WALL. STA. 40+55, 75' RT. ELEV.= 723.27

SEE HORIZONTAL ALIGNMENT LAYOUT AND CONTROL SHEET FOR PROPOSED RIGHT-OF-WAY (LICENSE) INFORMATION.

FIRE HYDRANT TO BE RELOCATED BY OTHERS
STA. 40+80.0, 39.0' RT.

**STA. 41+27.32 (C GOODWIN AVE.) =
STA. 599+98.42 (C SPRINGFIELD AVE.)**

SEEDING PAY ITEMS - 39+25 TO 43+83

CODE NO.	DESCRIPTION	UNIT	QUAN.
XX000880	SEEDING, CLASS 1, SPECIAL	SQ YD	380
X0321566	MULCH, SPECIAL	SQ YD	380

PRECAST CONCRETE PARKING BLOCK (X0301430)

LOCATION	EACH
NW CORNER GOODWIN AND SPRINGFIELD	5
SHEET TOTAL	5

TOPSOIL FURNISH AND PLACE, 6" (21101625)

LOCATION	SQ YD
SW CORNER GOODWIN AND SPRINGFIELD	32
SE CORNER GOODWIN AND SPRINGFIELD	5
NW CORNER GOODWIN AND SPRINGFIELD	18
NE CORNER GOODWIN AND SPRINGFIELD	8
SHEET TOTAL	63

FURNISHING AND SETTING STEEL POSTS (Z0026700)

LOCATION	EACH
STA. 39+40 LT.	1
STA. 39+80 LT.	1
STA. 40+22 LT.	1
SHEET TOTAL	3

METAL POST - TYPE B (72900200)

LOCATION	FOOT
STA. 42+20 LT.	12
SHEET TOTAL	12

**END IMPROVEMENTS
SPRINGFIELD AVE.
STA. 602+56.00
(MATCH EXISTING)**

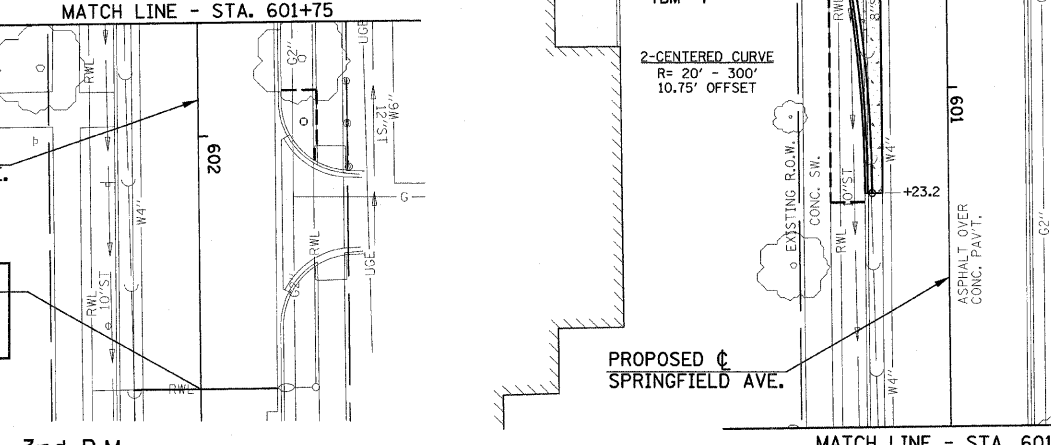

**STA. 41+27.32 (C GOODWIN AVE.) =
STA. 600+00.00 (C SPRINGFIELD AVE.)**

**SEC. 18, T.19N., R.9E., 3rd P.M.
CHAMPAIGN COUNTY, ILLINOIS**

**SEC. 7, T.19N., R.9E., 3rd P.M.
CHAMPAIGN COUNTY, ILLINOIS**

FILE NAME = p:\u0070052\plans\sheet\19-SitePlan.dgn	DESIGNED - JAJ	REVISED -
PLOT DATE = 2/27/2009 3:21:53 PM	DRAWN - JRM	REVISED -
	CHECKED - RLH	REVISED -
	DATE - 01-2009	REVISED -

DESIGNED - JAJ	REVISED -
DRAWN - JRM	REVISED -
CHECKED - RLH	REVISED -
DATE - 01-2009	REVISED -

STATE OF ILLINOIS
DEPARTMENT OF TRANSPORTATION

SITE IMPROVEMENTS PLAN

SCALE: 1"=20' SHEET NO. 26 OF 75 SHEETS STA. 39+25 TO STA. 43+83

F.A.U. R.T.E.	SECTION	COUNTY	TOTAL SHEETS	SHEET NO.
7175	07-00456-00-RS	CHAMPAIGN	75	26
GOODWIN AVENUE			CONTRACT NO. 91392	
FED. ROAD DIST. NO.			ILLINOIS FED. AID PROJECT	

REVISED A-6-09