

CONDUIT/CABLE SCHEDULE

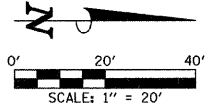

- (A) (1) 2" CONDUIT WITH 4-#6, 1-#6 GND (2 LIGHTING CIRCUITS) AND 6-#8, 1-#8 GND (4 REC. CIRCUITS).
- (B) (1) 1 1/4" PVC CONDUIT WITH 2-#10, 1-#10 GND (1 LIGHTING CIRCUIT) AND 2#10, 1-#10 GND (1 REC. CIRCUIT).
- (C) (1) 3" CONDUIT WITH 4-#6, 1-#6 GND (2 "B" LIGHTING CIRCUITS), 6-#8, 1-#8 GND (4 "BR" REC. CIRCUITS), 4-#6, 1-#6 GND (2 "D" LIGHTING CIRCUITS), AND 2-#10, 1-#10 GND (1 "DR" REC. CIRCUIT).
- (D) (1) 1 1/2" CONDUIT WITH 4-#6, 1-#6 GND (2 LIGHTING CIRCUITS) AND 2-#10, 1-#10 GND (1 REC. CIRCUIT).
- (E) (2) 3" PVC CONDUITS:
 (1) 3" PVC CONDUIT WITH 4-#6, 1-#6 GND (2 "A" LIGHTING CIRCUITS), 6-#8, 1-#8 GND (4 "AR" REC. CIRCUITS), AND 4-#6, 1-#6 GND (2 "B" LIGHTING CIRCUITS).
 (1) 3" PVC CONDUIT WITH 6-#8, 1-#8 GND (4 "BR" REC. CIRCUITS), 4-#6, 1-#6 GND (2 "C" LIGHTING CIRCUITS), 2-#10, 1-#10 GND (1 "CR" REC. CIRCUIT), 4-#6, 1-#6 GND (2 "D" LIGHTING CIRCUITS), AND 2-#10, 1-#10 GND (1 "DR" REC. CIRCUIT).
- (F) (1) 3" PVC SERVICE LATERAL CONDUIT WITH 3-#3/0. SERVICE LATERAL CONDUITS ABOVE GRADE SHALL BE RIGID GALVANIZED STEEL. ALL ELBOWS SHALL BE LONG RADIUS TYPE, RIGID GALVANIZED STEEL. SERVICE LATERAL CONDUITS SHALL COMPLY WITH ALL AMEREN IP REQUIREMENTS.

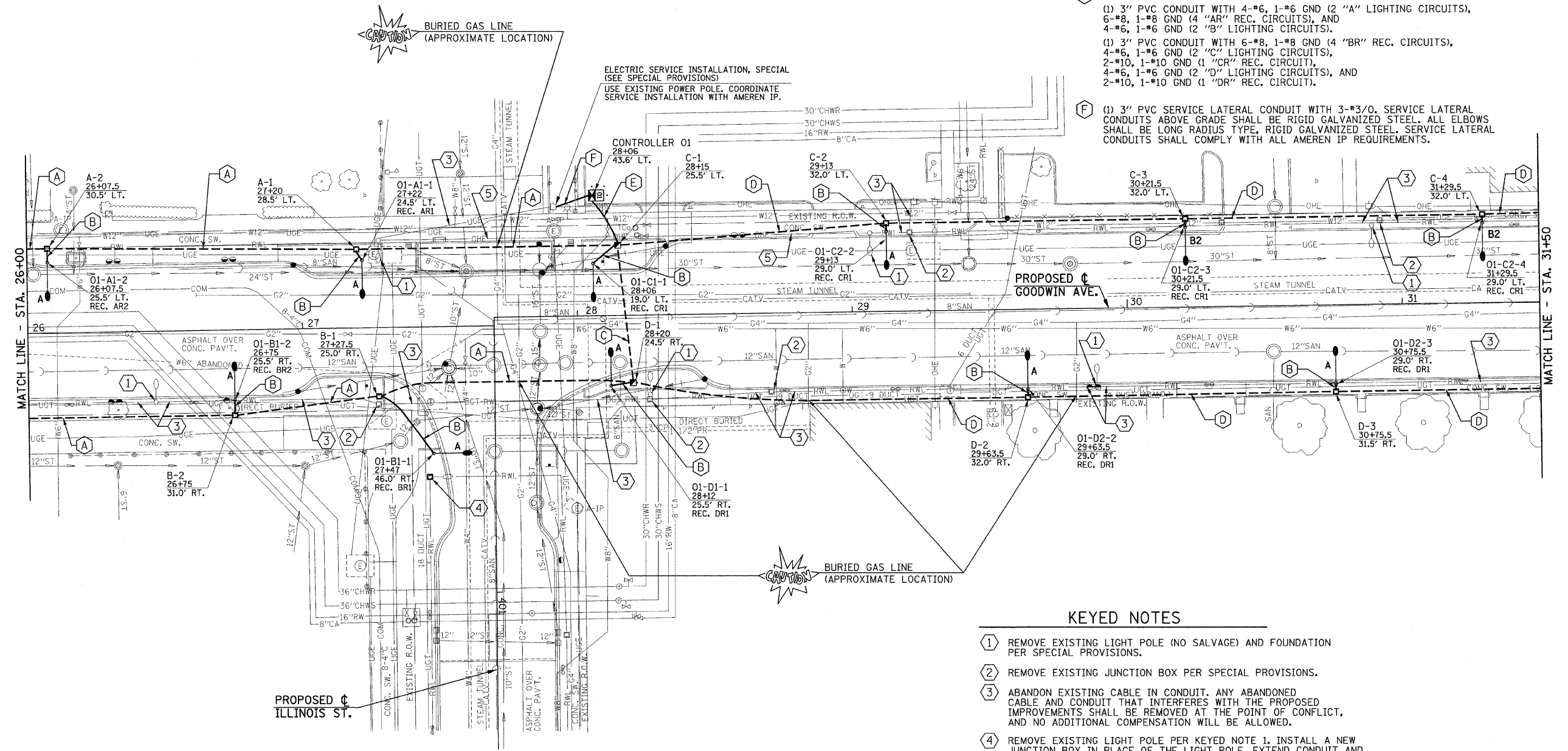

KEYED NOTES

- 1 REMOVE EXISTING LIGHT POLE (NO SALVAGE) AND FOUNDATION PER SPECIAL PROVISIONS.
- 2 REMOVE EXISTING JUNCTION BOX PER SPECIAL PROVISIONS.
- 3 ABANDON EXISTING CABLE IN CONDUIT. ANY ABANDONED CABLE AND CONDUIT THAT INTERFERES WITH THE PROPOSED IMPROVEMENTS SHALL BE REMOVED AT THE POINT OF CONFLICT, AND NO ADDITIONAL COMPENSATION WILL BE ALLOWED.
- 4 REMOVE EXISTING LIGHT POLE PER KEYED NOTE 1. INSTALL A NEW JUNCTION BOX IN PLACE OF THE LIGHT POLE. EXTEND CONDUIT AND CABLES INTO NEW BOX. COORDINATE RECONNECTION BY CITY OF URBANA PERSONNEL.
- 5 REMOVE OVERHEAD CABLE BACK TO ITS SOURCE PER SPECIAL PROVISIONS.

REVISED 4-6-09

FILE NAME = p:\u0070052\plans\sheets\64-Lighting.dgn	DESIGNED - MTP	REVISED -	STATE OF ILLINOIS DEPARTMENT OF TRANSPORTATION	ROADWAY LIGHTING PLAN		F.A.U. RTE. 7175	SECTION 07-00456-00-RS	COUNTY CHAMPAIGN	TOTAL SHEETS 75	SHEET NO. 67	
PLOT DATE = 2/27/2009 3:22:07 PM	DRAWN - RJS	REVISED -		SCALE : 1"=20'			SHEET NO. 67 OF 75 SHEETS		STA. 26+00 TO STA. 31+50		CONTRACT NO. 91392
CHECKED - JJF	DATE - 01-2009	REVISED -		FED. ROAD DIST. NO.			ILLINOIS		FED. AID PROJECT		