

CONDUIT/CABLE SCHEDULE

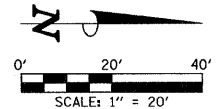

- (A) (1) 1 1/2" CONDUIT WITH 4-#6, 1-#6 GND (2 LIGHTING CIRCUITS).
- (B) (1) 1 1/4" PVC CONDUIT WITH 2-#10, 1-#10 GND (1 LIGHTING CIRCUIT) AND 2#10, 1-#10 GND (1 REC. CIRCUIT).
- (C) (1) 1 1/4" PVC CONDUIT WITH 2-#10, 1-#10 GND (1 LIGHTING CIRCUIT).
- (D) (1) 1 1/2" CONDUIT WITH 4-#6, 1-#6 GND (2 LIGHTING CIRCUITS) AND 2-#10, 1-#10 GND (1 REC. CIRCUIT).
- (E) (1) 1 1/2" CONDUIT WITH 2-#6 (LIGHTING CIRCUIT C1), 2-#10 (LIGHTING CIRCUIT C2), AND 1-#6 GND (2 LIGHTING CIRCUITS).
- (F) (1) 1 1/2" CONDUIT WITH 4-#10, 1-#10 GND (2 LIGHTING CIRCUITS).
- (G) (1) 1 1/2" CONDUIT WITH 2-#6 (LIGHTING CIRCUIT D1), 2-#10 (LIGHTING CIRCUIT D2), AND 1-#6 GND (2 LIGHTING CIRCUITS).
- (H) (3) CONDUIT RIGID STEEL, PVC COATED, 2" ATTACHED TO STRUCTURE:
 (1) CONDUIT WITH 4-#6, 1-#6 GND (2 LIGHTING CIRCUITS),
 (1) CONDUIT WITH 4-#6, 1-#6 GND (2 LIGHTING CIRCUITS), AND
 (1) CONDUIT SHALL BE EMPTY.

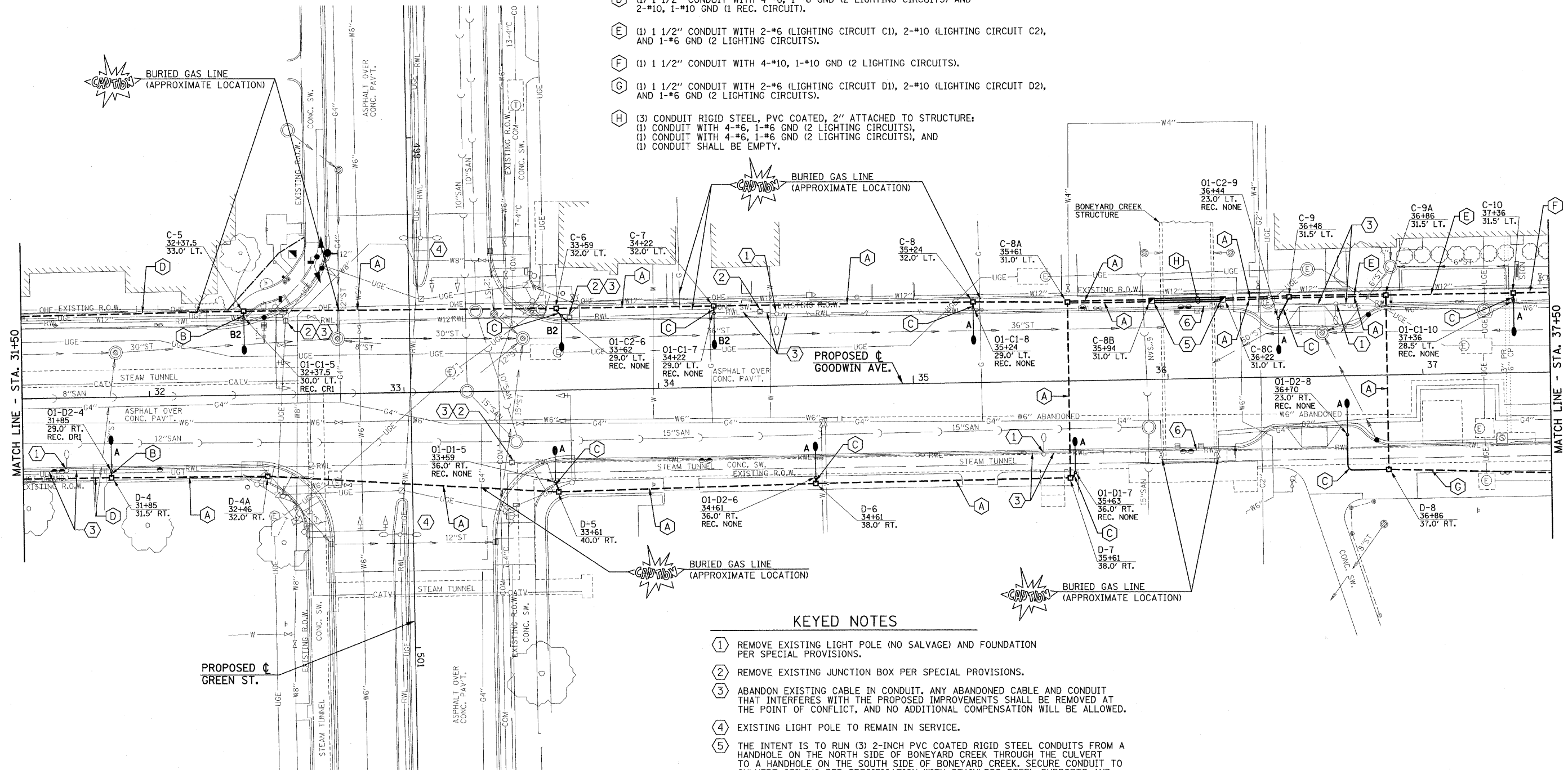

KEYED NOTES

- 1 REMOVE EXISTING LIGHT POLE (NO SALVAGE) AND FOUNDATION PER SPECIAL PROVISIONS.
- 2 REMOVE EXISTING JUNCTION BOX PER SPECIAL PROVISIONS.
- 3 ABANDON EXISTING CABLE IN CONDUIT. ANY ABANDONED CABLE AND CONDUIT THAT INTERFERES WITH THE PROPOSED IMPROVEMENTS SHALL BE REMOVED AT THE POINT OF CONFLICT, AND NO ADDITIONAL COMPENSATION WILL BE ALLOWED.
- 4 EXISTING LIGHT POLE TO REMAIN IN SERVICE.
- 5 THE INTENT IS TO RUN (3) 2-INCH PVC COATED RIGID STEEL CONDUITS FROM A HANDHOLE ON THE NORTH SIDE OF BONEYARD CREEK THROUGH THE CULVERT TO A HANDHOLE ON THE SOUTH SIDE OF BONEYARD CREEK. SECURE CONDUIT TO CULVERT CEILING PER SPECIFICATION WITH STAINLESS STEEL SUPPORTS AND HARDWARE APPROVED FOR THIS PURPOSE. EXTEND CONDUIT OUT OF WALL A MINIMUM OF 12 INCHES INTO HANDHOLE. PROVIDE A WATER TIGHT SEAL AROUND THE CONDUIT AT THE PENETRATIONS. CORE DRILLING OF CULVERT WALLS SHALL BE INCLUDED IN THE COST OF THE PVC COATED RIGID STEEL CONDUIT.
- 6 REMOVE EXISTING STREET LIGHTING CONDUIT FROM BONEYARD CREEK CULVERT AND DISPOSE OF OFF SITE PER SPECIAL PROVISIONS. FILL OPENINGS WITH CONCRETE AND CAP.

REVISED 4-6-09

FILE NAME = p:\u0070052\plans\sheet\64-Lighting.dgn	DESIGNED - MTP	REVISED -
PLOT DATE = 2/27/2009 3:22:08 PM	DRAWN - RJS	REVISED -
	CHECKED - JUF	REVISED -
	DATE - 01-2009	REVISED -

STATE OF ILLINOIS DEPARTMENT OF TRANSPORTATION	
ROADWAY LIGHTING PLAN	
SCALE: 1"=20'	SHEET NO. 68 OF 75 SHEETS
STA. 31+50	TO STA. 37+50

F.A.J. RTE. 7175	SECTION 07-00456-00-RS	COUNTY CHAMPAIGN	TOTAL SHEETS 75	SHEET NO. 68
GOODWIN AVENUE		CONTRACT NO. 91392		
FED. ROAD DIST. NO.		ILLINOIS FED. AID PROJECT		