

**PLAN**  
SCALE 1" = 10'

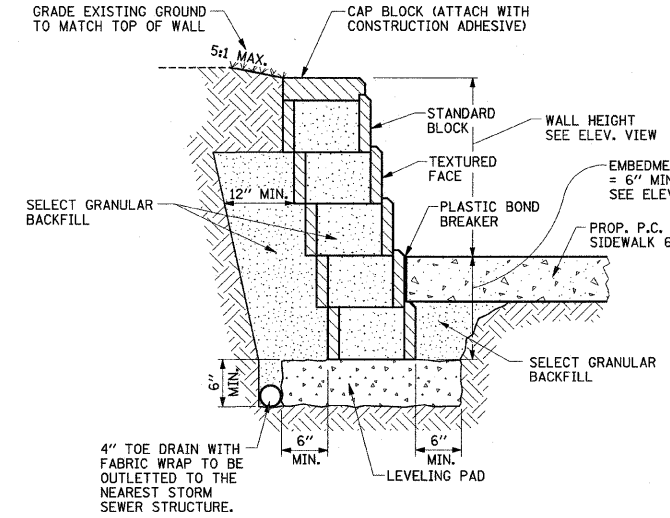

**SEGMENTAL CONCRETE BLOCK WALL**  
**TYPICAL SECTION DETAIL**  
NO SCALE

- NOTES:**
1. THE STATIONS, OFFSETS AND ELEVATIONS AS SHOWN IN THE DETAIL ARE BASED ON BLOCKS WITH THE FOLLOWING DIMENSIONS:  
 STANDARD BLOCK:  
 LENGTH = 17-5/8"  
 HEIGHT = 7-7/8"  
 DEPTH = 11-7/8"  
 CAP BLOCK:  
 LENGTH = 17-5/8"  
 HEIGHT = 3-7/8"  
 DEPTH = 12"  
 SET BACK: 6" WALL BATTER FROM VERTICAL
  2. COLOR SAMPLE SHALL BE SUBMITTED BY THE CONTRACTOR.
  3. THE FRONT SURFACE AREA OF THE SEGMENTAL CONCRETE BLOCK WALL = 155 SQ.FT.
  4. THE FACE OF THE BLOCK WALL SHALL BE COVERED WITH PLASTIC OR OTHER MATERIAL DURING THE SIDEWALK CONSTRUCTION TO PREVENT SPLATTERING OF CONCRETE ON THE BLOCKS.
  5. ADDITIONAL SIDEWALK WIDTH MAY BE REQUIRED DUE TO BLOCK WALL OFFSET CHANGES.
  6. SEE SPECIAL PROVISIONS FOR PAYMENT INFORMATION.

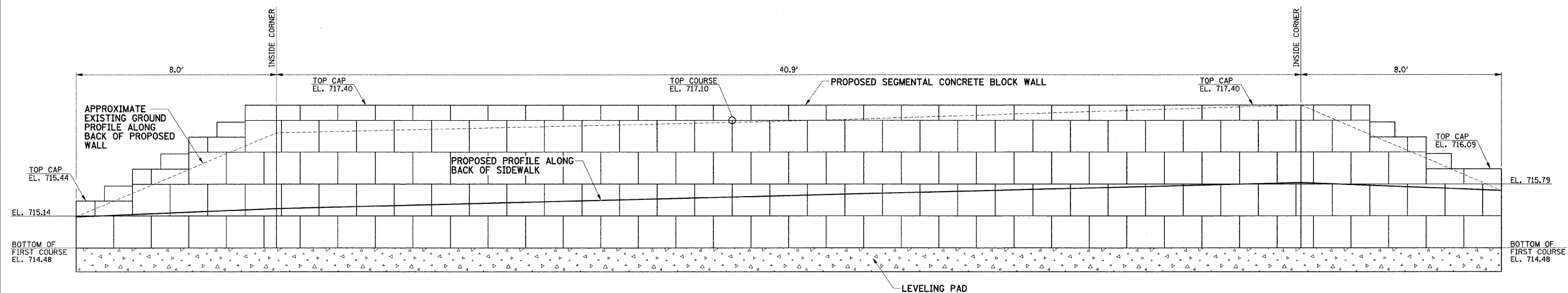

**ELEVATION**  
APPROXIMATE SCALE:  
HORIZ. 1" = 2'  
VERT. 1" = 1'

REVISED 4-6-09

FILE NAME = p:\u0070052\plans\sheet\72-MiscDetails.dgn  
 PLOT DATE = 2/27/2009 3:22:15 PM

DESIGNED - JRM	REVISED -
DRAWN - JRM	REVISED -
CHECKED - RLH	REVISED -
DATE - 01-2009	REVISED -

STATE OF ILLINOIS  
 DEPARTMENT OF TRANSPORTATION

MISCELLANEOUS DETAILS

SCALE : NONE SHEET NO. 75 OF 75 SHEETS STA. TO STA.

F.A.U. RTE. 7175	SECTION 07-00456-00-RS	COUNTY CHAMPAIGN	TOTAL SHEETS 75	SHEET NO. 75
GOODWIN AVENUE		CONTRACT NO. 91392		
FED. ROAD DIST. NO. [ILLINOIS] FED. AID PROJECT				