

LEGEND
 (R) - STRUCTURE TO BE REMOVED

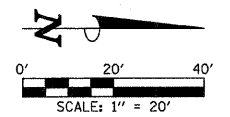

SEE THE TRAFFIC SIGNAL PLANS FOR TRAFFIC SIGNAL REMOVAL ITEMS.
 SEE THE ROADWAY LIGHTING PLANS FOR ROADWAY LIGHTING REMOVAL ITEMS.
 SEE DRAINAGE PLANS FOR ADDITIONAL INFORMATION.

THE LIMITS OF SIDEWALK REMOVAL AND BRICK PAVER REMOVAL ARE NOT SHOWN FOR THE REMOVAL AND/OR INSTALLATION OF LIGHT POLES, JUNCTION BOXES, OR PARKING METERS. QUANTITIES FOR THIS WORK ARE INCLUDED ON THE PLANS.

THE STRUCTURE INFORMATION SHOWN IN ITALICS IS ALSO SHOWN ON THE DRAINAGE PLANS. THE SCHEDULE OF QUANTITIES FOR THESE ITEMS IS SHOWN ON THE REMOVAL PLANS.

SEE SHEET 11 FOR REMOVAL NOTES

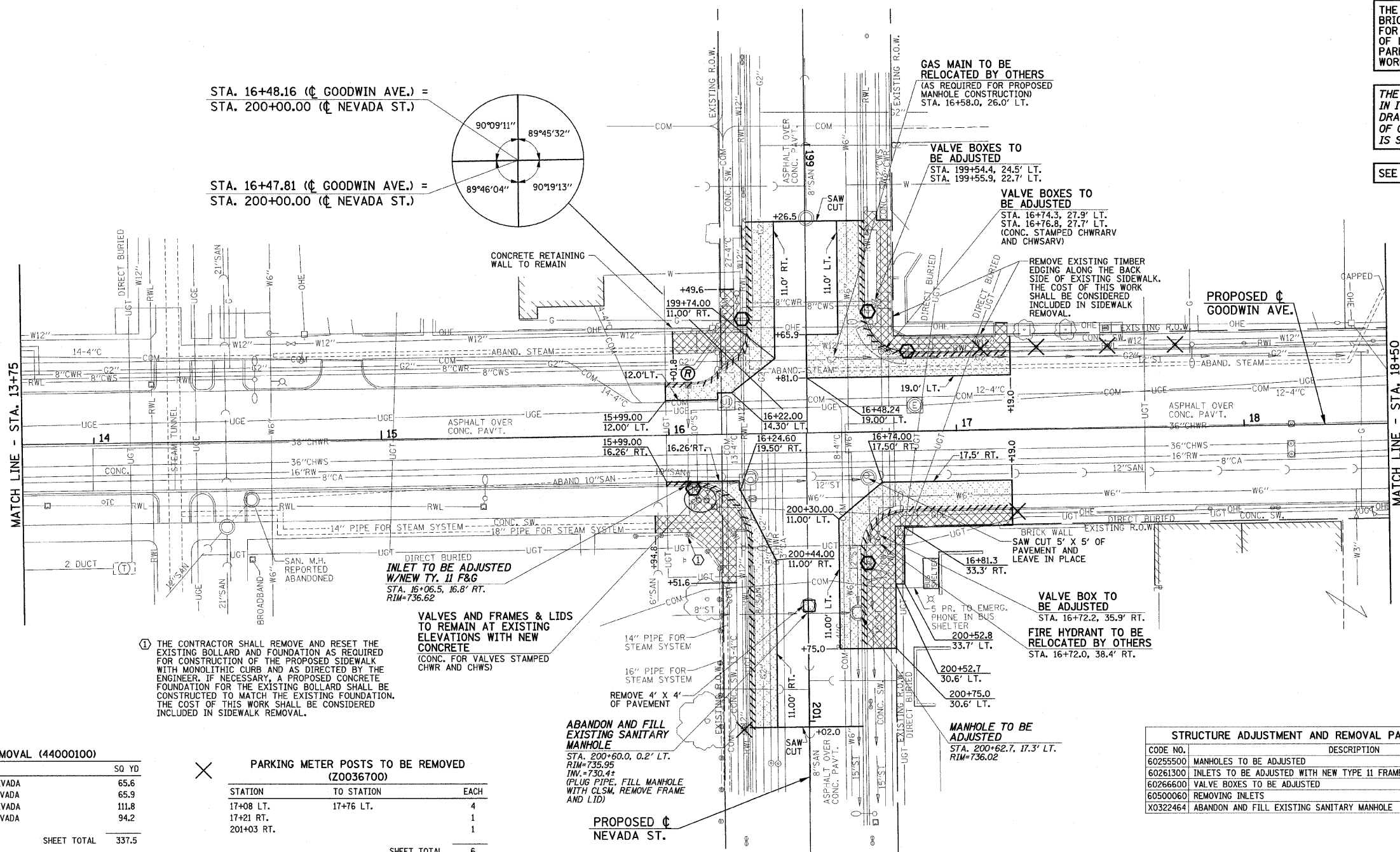

① THE CONTRACTOR SHALL REMOVE AND RESET THE EXISTING BOLLARD AND FOUNDATION AS REQUIRED FOR CONSTRUCTION OF THE PROPOSED SIDEWALK WITH MONOLITHIC CURB AND AS DIRECTED BY THE ENGINEER. IF NECESSARY, A PROPOSED CONCRETE FOUNDATION FOR THE EXISTING BOLLARD SHALL BE CONSTRUCTED TO MATCH THE EXISTING FOUNDATION. THE COST OF THIS WORK SHALL BE CONSIDERED INCLUDED IN SIDEWALK REMOVAL.

INLET TO BE ADJUSTED W/NEW TY. II F&G
 STA. 16+06.5, 16.8' RT.
 RIM=736.62

VALVES AND FRAMES & LIDS TO REMAIN AT EXISTING ELEVATIONS WITH NEW CONCRETE
 (CONC. FOR VALVES STAMPED CHWR AND CHWS)

ABANDON AND FILL EXISTING SANITARY MANHOLE
 STA. 200+80.0, 0.2' LT.
 RIM=735.95
 INV.=730.4±
 (PLUG PIPE, FILL MANHOLE WITH CLSM, REMOVE FRAME AND LID)

MANHOLE TO BE ADJUSTED
 STA. 200+62.7, 17.3' LT.
 RIM=736.02

PAVEMENT REMOVAL (44000100)

LOCATION	SQ YD
SW CORNER GOODWIN AND NEVADA	65.6
SE CORNER GOODWIN AND NEVADA	65.9
NW CORNER GOODWIN AND NEVADA	111.8
NE CORNER GOODWIN AND NEVADA	94.2
SHEET TOTAL	337.5

PARKING METER POSTS TO BE REMOVED (Z0036700)

STATION	TO STATION	EACH
17+08 LT.	17+76 LT.	4
17+21 RT.		1
201+03 RT.		1
SHEET TOTAL		6

SIDEWALK REMOVAL (44000600)

LOCATION	SQ FT
SW CORNER GOODWIN AND NEVADA	301.9
SE CORNER GOODWIN AND NEVADA	460.6
NW CORNER GOODWIN AND NEVADA	493.4
NE CORNER GOODWIN AND NEVADA	725.8
ROADWAY LIGHTING	185.0
PARKING METER POSTS	40.0
SHEET TOTAL	2206.7

COMBINATION CURB AND GUTTER REMOVAL (44000500)

LOCATION	FOOT
SW CORNER GOODWIN AND NEVADA	76.5
SE CORNER GOODWIN AND NEVADA	105.5
NW CORNER GOODWIN AND NEVADA	90.8
NE CORNER GOODWIN AND NEVADA	93.1
SHEET TOTAL	365.9

REMOVING AND RESETTING STREET SIGNS (Z0051500)

LOCATION	EACH
STA. 16+08 RT.	1
STA. 16+83 LT.	1
STA. 199+58 LT.	1
STA. 199+60 RT.	1
STA. 200+45 LT.	1
SHEET TOTAL	5

STRUCTURE ADJUSTMENT AND REMOVAL PAY ITEMS - 13+75 TO 18+50

CODE NO.	DESCRIPTION	UNIT	QUAN.
60255500	MANHOLES TO BE ADJUSTED	EACH	1
60261300	INLETS TO BE ADJUSTED WITH NEW TYPE II FRAME AND GRATE	EACH	1
60266600	VALVE BOXES TO BE ADJUSTED	EACH	5
60500600	REMOVING INLETS	EACH	1
X0322464	ABANDON AND FILL EXISTING SANITARY MANHOLE	EACH	1

FILE NAME = p:\u0070052\plans\sheets\10-Removal.dgn
 PLOT DATE = 1/12/2009 7:46:13 PM

DESIGNED - JAJ
 DRAWN - DLM
 CHECKED - RLH
 DATE - 01-2009

STATE OF ILLINOIS
 DEPARTMENT OF TRANSPORTATION

REMOVALS/RELOCATIONS PLAN
 SCALE: 1"=20'
 SHEET NO. 12 OF 75 SHEETS
 STA. 13+75 TO STA. 18+50

F.A.U. RTE.	SECTION	COUNTY	TOTAL SHEETS	SHEET NO.
1715	07-00456-00-RS	CHAMPAIGN	75	12
GOODWIN AVENUE			CONTRACT NO. 91392	
FED. ROAD DIST. NO. [ILLINOIS] FED. AID PROJECT				