

SEE THE TRAFFIC SIGNAL PLANS FOR TRAFFIC SIGNAL REMOVAL ITEMS.
SEE THE ROADWAY LIGHTING PLANS FOR ROADWAY LIGHTING REMOVAL ITEMS.
SEE DRAINAGE PLANS FOR ADDITIONAL INFORMATION.

THE LIMITS OF SIDEWALK REMOVAL AND BRICK PAVER REMOVAL ARE NOT SHOWN FOR THE REMOVAL AND/OR INSTALLATION OF LIGHT POLES, JUNCTION BOXES, OR PARKING METERS. QUANTITIES FOR THIS WORK ARE INCLUDED ON THE PLANS.

THE STRUCTURE INFORMATION SHOWN IN ITALICS IS ALSO SHOWN ON THE DRAINAGE PLANS. THE SCHEDULE OF QUANTITIES FOR THESE ITEMS IS SHOWN ON THE REMOVAL PLANS.

SEE SHEET 11 FOR REMOVAL NOTES

STA. 20+21.10 (C GOODWIN AVE.) =
STA. 300+00.00 (C OREGON ST.)

STA. 20+21.10 (C GOODWIN AVE.) =
STA. 300+03.33 (C OREGON ST.)

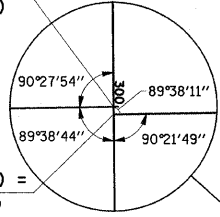

LEGEND

(R) - STRUCTURE TO BE REMOVED

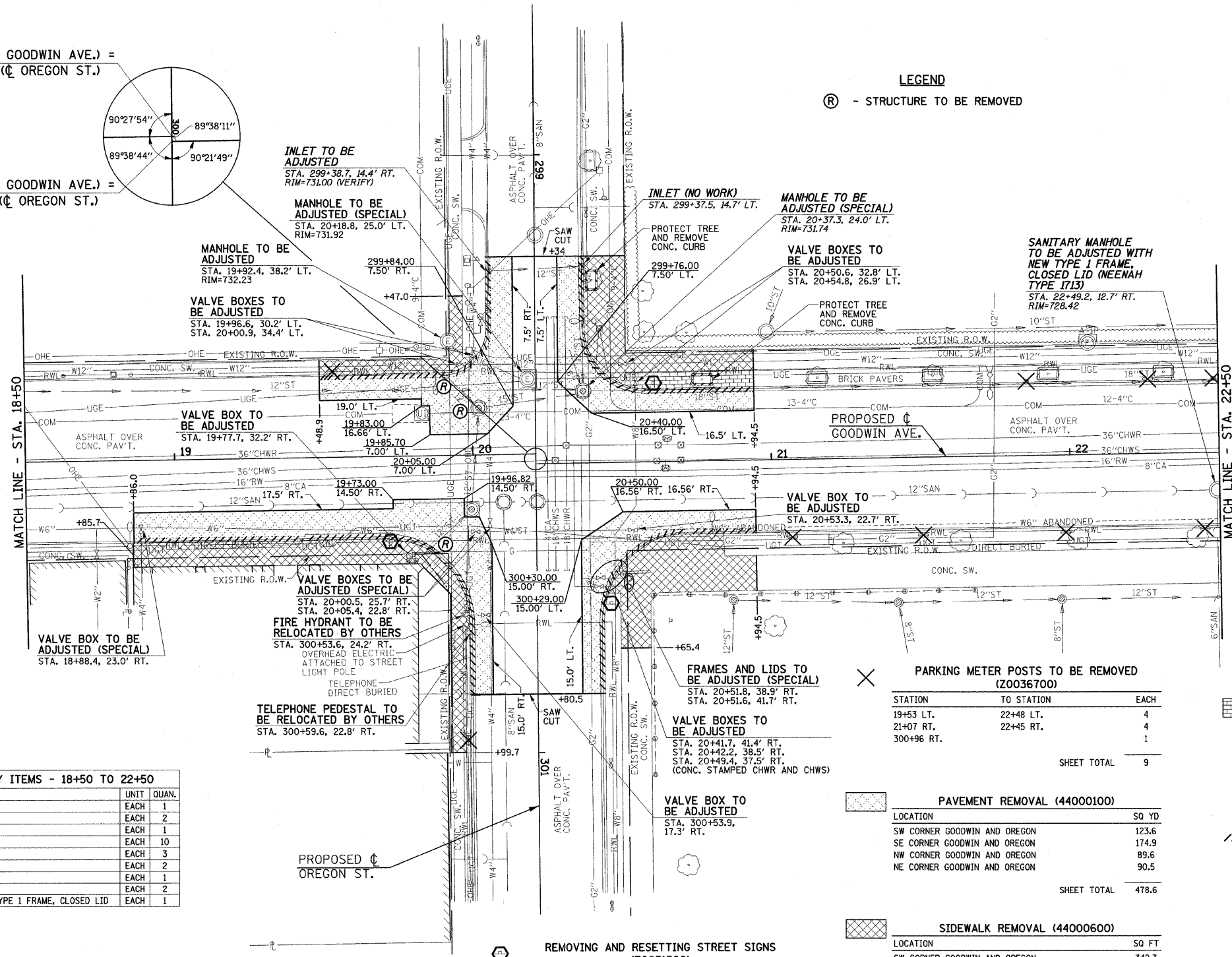

STRUCTURE ADJUSTMENT AND REMOVAL PAY ITEMS - 18+50 TO 22+50

CODE NO.	DESCRIPTION	UNIT	QUAN.
60255500	MANHOLES TO BE ADJUSTED	EACH	1
60255600	MANHOLES TO BE ADJUSTED (SPECIAL)	EACH	2
60260100	INLETS TO BE ADJUSTED	EACH	1
60266600	VALVE BOXES TO BE ADJUSTED	EACH	10
60266610	VALVE BOXES TO BE ADJUSTED (SPECIAL)	EACH	3
60300310	FRAMES AND LIDS TO BE ADJUSTED (SPECIAL)	EACH	2
60500040	REMOVING MANHOLES	EACH	1
60500060	REMOVING INLETS	EACH	2
X0321558	SANITARY MANHOLES TO BE ADJUSTED WITH NEW TYPE 1 FRAME, CLOSED LID	EACH	1

VALVE BOXES TO BE ADJUSTED (SPECIAL)

STATION	TO STATION	EACH
19+53 LT.	22+48 LT.	4
21+07 RT.	22+45 RT.	4
300+96 RT.		1
SHEET TOTAL 9		

PARKING METER POSTS TO BE REMOVED (Z0036700)

STATION	TO STATION	EACH
19+53 LT.	22+48 LT.	4
21+07 RT.	22+45 RT.	4
300+96 RT.		1
SHEET TOTAL 9		

PAVEMENT REMOVAL (44000100)

LOCATION	SQ YD
SW CORNER GOODWIN AND OREGON	123.6
SE CORNER GOODWIN AND OREGON	174.9
NW CORNER GOODWIN AND OREGON	89.6
NE CORNER GOODWIN AND OREGON	90.5
SHEET TOTAL 478.6	

SIDEWALK REMOVAL (44000600)

LOCATION	SQ FT
SW CORNER GOODWIN AND OREGON	342.3
SE CORNER GOODWIN AND OREGON	1146.1
NW CORNER GOODWIN AND OREGON	800.0
NE CORNER GOODWIN AND OREGON	970.4
ROADWAY LIGHTING	105.0
SHEET TOTAL 3363.8	

REMOVE AND REINSTALL BRICK PAVER (XX003313)

LOCATION	SQ FT
NW CORNER GOODWIN AND OREGON	206.6
ROADWAY LIGHTING	75.0
PARKING METER POSTS	24.0
SHEET TOTAL 305.6	

COMBINATION CURB AND GUTTER REMOVAL (44000500)

LOCATION	FOOT
SW CORNER GOODWIN AND OREGON	88.9
SE CORNER GOODWIN AND OREGON	154.0
NW CORNER GOODWIN AND OREGON	93.4
NE CORNER GOODWIN AND OREGON	93.2
SHEET TOTAL 429.5	

CURB REMOVAL (44000300)

LOCATION	FOOT
NW CORNER GOODWIN AND OREGON	44.0
SHEET TOTAL 44.0	

REMOVING AND RESETTING STREET SIGNS (Z0051500)

LOCATION	EACH
STA. 19+72 RT.	1
STA. 20+61 LT.	1
STA. 300+50 RT.	1
SHEET TOTAL 3	

FILE NAME = p:\u0070052\plans\sheets\10-Removal.dgn
DESIGNED - JAJ
DRAWN - DLM
CHECKED - RLH
PLOT DATE = 1/12/2009 7:46:14 PM
DATE - 01-2009

DESIGNED - JAJ
DRAWN - DLM
CHECKED - RLH
DATE - 01-2009

STATE OF ILLINOIS
DEPARTMENT OF TRANSPORTATION

REMOVALS/RELOCATIONS PLAN
SCALE: 1"=20'
SHEET NO. 13 OF 75 SHEETS
STA. 18+50 TO STA. 22+50

F.A.U. RTE.	SECTION	COUNTY	TOTAL SHEETS	SHEET NO.
7175	07-00456-00-RS	CHAMPAIGN	75	13
GOODWIN AVENUE		CONTRACT NO. 91392		
FED. ROAD DIST. NO.		ILLINOIS FED. AID PROJECT		