

SEE THE TRAFFIC SIGNAL PLANS FOR TRAFFIC SIGNAL REMOVAL ITEMS.

SEE THE ROADWAY LIGHTING PLANS FOR ROADWAY LIGHTING REMOVAL ITEMS.

SEE DRAINAGE PLANS FOR ADDITIONAL INFORMATION.

THE LIMITS OF SIDEWALK REMOVAL AND BRICK PAVEMENT REMOVAL ARE NOT SHOWN FOR THE REMOVAL AND/OR INSTALLATION OF LIGHT POLES, JUNCTION BOXES, OR PARKING METERS. QUANTITIES FOR THIS WORK ARE INCLUDED ON THE PLANS.

THE STRUCTURE INFORMATION SHOWN IN ITALICS IS ALSO SHOWN ON THE DRAINAGE PLANS. THE SCHEDULE OF QUANTITIES FOR THESE ITEMS IS SHOWN ON THE REMOVAL PLANS.

SEE SHEET 11 FOR REMOVAL NOTES

LEGEND

(R) - STRUCTURE TO BE REMOVED

PR* - TREE PRUNING (BY OTHERS)

PARKING METER POST TO BE REMOVED AT STA. 597+76 RT.

SAW CUT AT STA. 596+65

PARKING METER POSTS TO BE REMOVED (Z0036700)

STATION	TO STATION	EACH
39+43 RT.	39+80 RT.	2
597+76 RT.	598+18 RT.	2
602+42 RT.		1
SHEET TOTAL		5

PAVEMENT REMOVAL (44000100)

LOCATION	SQ YD	
SW CORNER GOODWIN AND SPRINGFIELD	71.9	
SE CORNER GOODWIN AND SPRINGFIELD	57.3	
NW CORNER GOODWIN AND SPRINGFIELD	32.8	
NE CORNER GOODWIN AND SPRINGFIELD	22.7	
SHEET TOTAL		184.7

CLASS B PATCHES, TYPE IV, 8" (44200944)

STATION	TO STATION	SQ YD
42+55.5 LT.	42+87 LT.	30.3
42+55.5 LT. & RT.	42+87 LT. & RT.	38.5
42+55.5 RT.	42+87 RT.	36.2
SHEET TOTAL		105.0

SIDEWALK REMOVAL (44000600)

LOCATION	SQ FT	
SW CORNER GOODWIN AND SPRINGFIELD	1039.4	
SE CORNER GOODWIN AND SPRINGFIELD	635.6	
NW CORNER GOODWIN AND SPRINGFIELD	1057.1	
NE CORNER GOODWIN AND SPRINGFIELD	978.8	
ROADWAY LIGHTING	180.0	
PARKING METER POSTS	20.0	
SHEET TOTAL		3910.9

REMOVE AND REINSTALL BRICK PAVEMENT (XX003313)

LOCATION	SQ FT	
SW CORNER GOODWIN AND SPRINGFIELD	24.3	
PARKING METER POSTS	8.0	
SHEET TOTAL		32.3

COMBINATION CURB AND GUTTER REMOVAL (44000500)

LOCATION	FOOT	
SW CORNER GOODWIN AND SPRINGFIELD	92.9	
SE CORNER GOODWIN AND SPRINGFIELD	131.8	
NW CORNER GOODWIN AND SPRINGFIELD	92.6	
NE CORNER GOODWIN AND SPRINGFIELD	107.3	
SHEET TOTAL		424.6

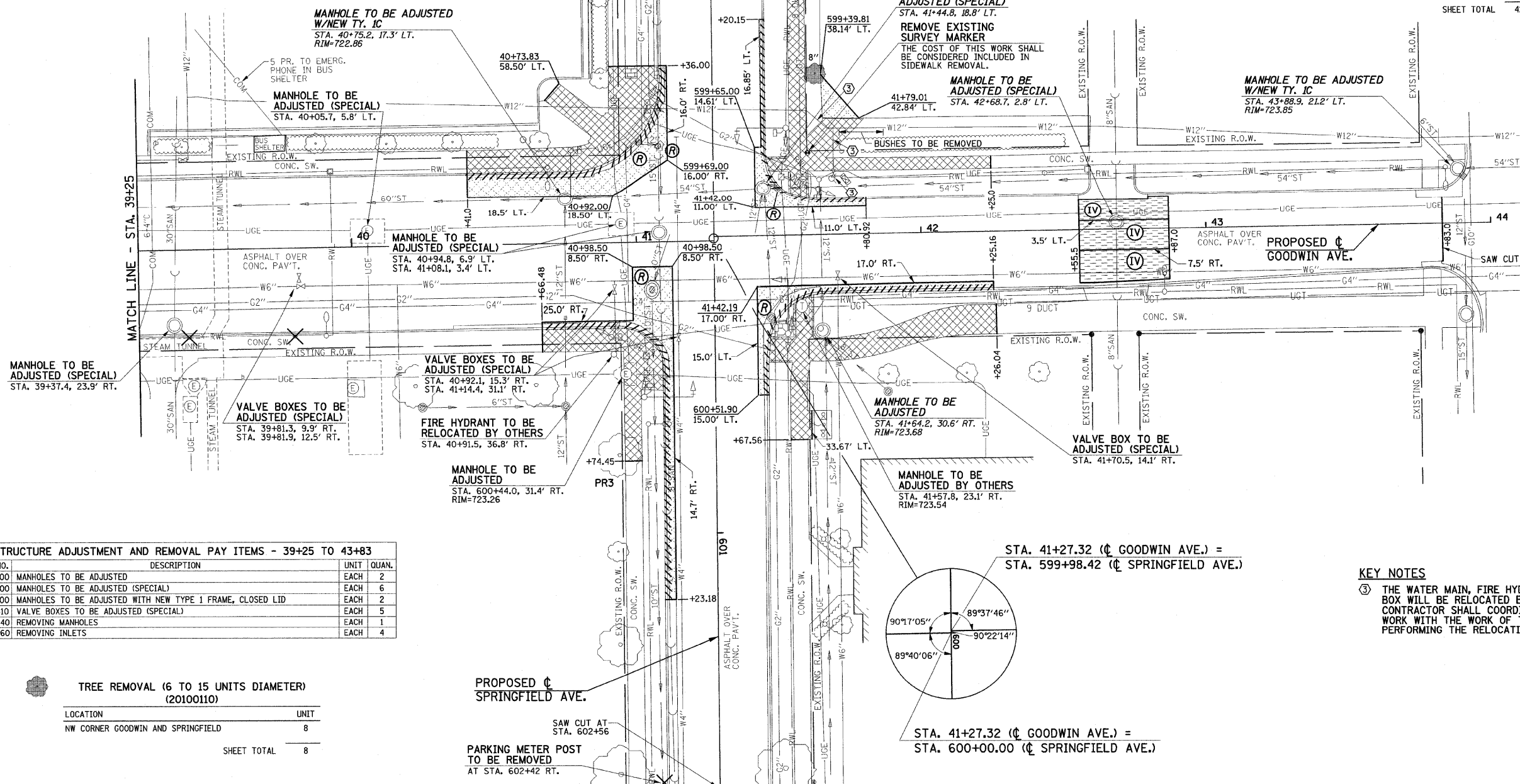
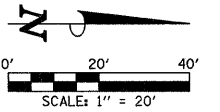

STRUCTURE ADJUSTMENT AND REMOVAL PAY ITEMS - 39+25 TO 43+83

CODE NO.	DESCRIPTION	UNIT	QUAN.
60255500	MANHOLES TO BE ADJUSTED	EACH	2
60255600	MANHOLES TO BE ADJUSTED (SPECIAL)	EACH	6
60255800	MANHOLES TO BE ADJUSTED WITH NEW TYPE 1 FRAME, CLOSED LID	EACH	2
60266610	VALVE BOXES TO BE ADJUSTED (SPECIAL)	EACH	5
60500040	REMOVING MANHOLES	EACH	1
60500060	REMOVING INLETS	EACH	4

TREE REMOVAL (6 TO 15 UNITS DIAMETER) (20100110)

LOCATION	UNIT	
NW CORNER GOODWIN AND SPRINGFIELD	8	
SHEET TOTAL		8

KEY NOTES

③ THE WATER MAIN, FIRE HYDRANT, AND VALVE BOX WILL BE RELOCATED BY OTHERS. THE CONTRACTOR SHALL COORDINATE HIS/HER WORK WITH THE WORK OF THE CONTRACTOR PERFORMING THE RELOCATION.

