

**STRUCTURE LEGEND**

- TA - TYPE A INLET
- TB - TYPE B INLET
- TA (4' DIA.) - TYPE A MANHOLE (DIA. SPECIFIED)
- R.D. - RESTRICTED DEPTH
- ☉ RIM - CENTER OF 2' OPENING
- ◉ RIM - TOP OF FRAME ELEVATION
- T/F.S.T. - TOP OF FLAT SLAB TOP
- 1C - TYPE 1 FRAME AND CLOSED LID
- 8 - TYPE 8 GRATE
- 11 - TYPE 11 FRAME AND GRATE

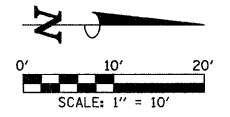

THE STRUCTURE INFORMATION SHOWN IN ITALICS IS ALSO SHOWN ON THE REMOVAL PLANS. THE SCHEDULE OF QUANTITIES FOR THESE ITEMS IS SHOWN ON THE REMOVAL PLANS.

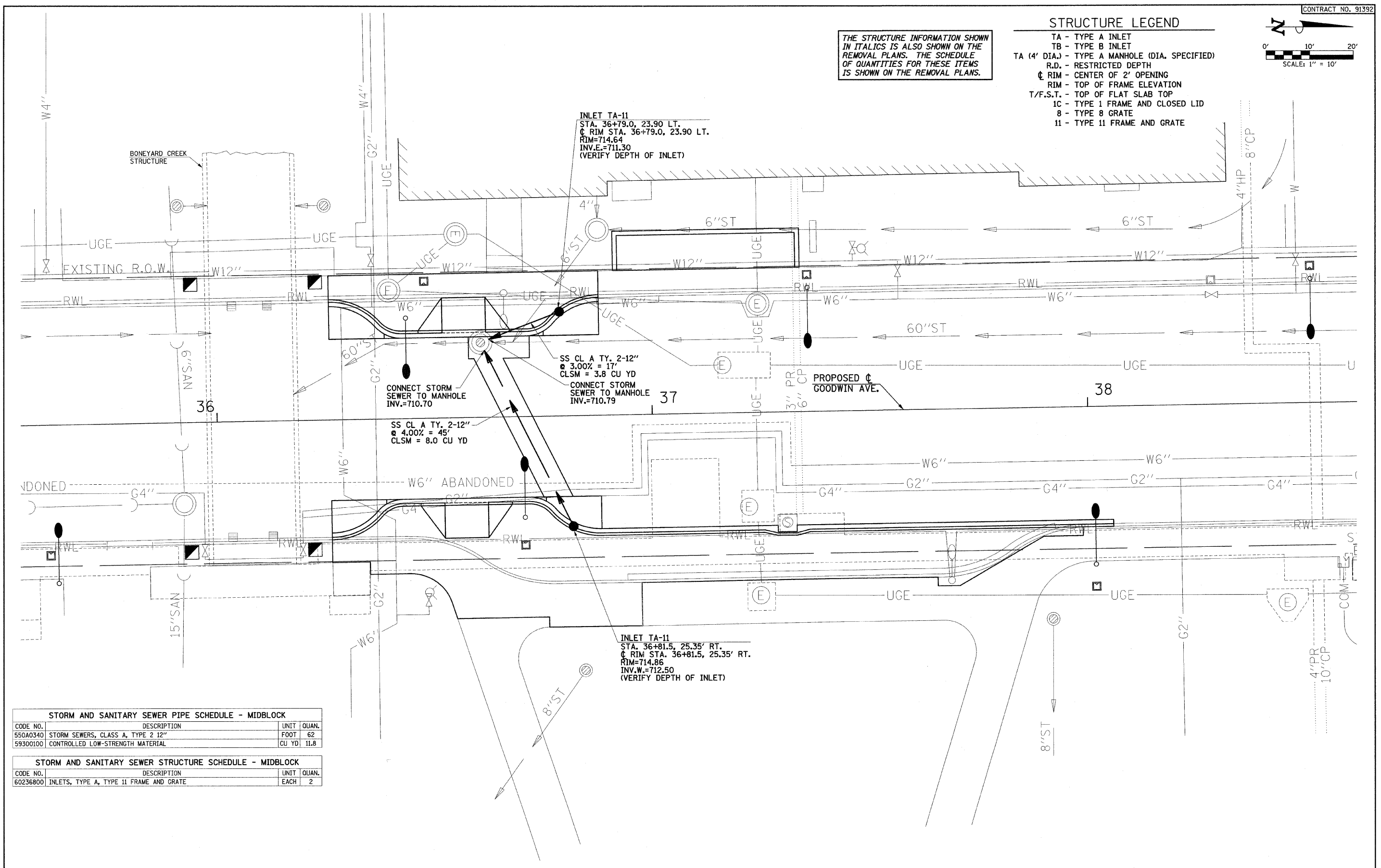

**STORM AND SANITARY SEWER PIPE SCHEDULE - MIDBLOCK**

CODE NO.	DESCRIPTION	UNIT	QUAN.
550A0340	STORM SEWERS, CLASS A, TYPE 2 12"	FOOT	62
59300100	CONTROLLED LOW-STRENGTH MATERIAL	CU YD	11.8

**STORM AND SANITARY SEWER STRUCTURE SCHEDULE - MIDBLOCK**

CODE NO.	DESCRIPTION	UNIT	QUAN.
60236800	INLETS, TYPE A, TYPE 11 FRAME AND GRATE	EACH	2

FILE NAME = p:\u0070052\plans\sheets\27-Drainage.dgn  
 PLOT DATE = 1/12/2009 7:48:35 PM

DESIGNED - RLH	REVISED -
DRAWN - JRM	REVISED -
CHECKED - JAJ	REVISED -
DATE - 01-2009	REVISED -

STATE OF ILLINOIS  
 DEPARTMENT OF TRANSPORTATION

**DRAINAGE PLAN**  
 SCALE: 1"=10' SHEET NO. 32 OF 75 SHEETS STA. TO STA.

F.A.U. RTE.	SECTION	COUNTY	TOTAL SHEETS	SHEET NO.
7175	07-00456-00-RS	CHAMPAIGN	75	32
GOODWIN AVENUE		CONTRACT NO. 91392		
FED. ROAD DIST. NO.		ILLINOIS FED. AID PROJECT		