

CONDUIT/CABLE SCHEDULE

- (A) (1) 2" CONDUIT WITH 4-#6, 1-#6 GND (2 LIGHTING CIRCUITS), 3-#8 (REC. CIRCUITS 2 & 4), 3-#10 (REC. CIRCUITS 1 & 3), AND 1-#8 GND (TOTAL 4 REC. CIRCUITS).
- (B) (1) 2" CONDUIT WITH 4-#6, 1-#6 GND (2 LIGHTING CIRCUITS) AND 6-#10, 1-#10 GND (4 REC. CIRCUITS).
- (C) (1) 1 1/4" PVC CONDUIT WITH 2-#10, 1-#10 GND (1 CIRCUIT).
- (D) (1) 2" CONDUIT WITH 2-#6 (LIGHTING CIRCUIT A1), 2-#10 (LIGHTING CIRCUIT A2), 1-#6 GND (TOTAL 2 LIGHTING CIRCUITS), AND 5-#10 AND 1-#10 GND (TOTAL 3 REC. CIRCUITS).
- (E) (1) 2" CONDUIT WITH 4-#10, 1-#10 GND (2 LIGHTING CIRCUITS) AND 4#10, 1-#10 GND (2 REC. CIRCUITS).
- (F) (1) 1 1/2" CONDUIT WITH 2-#10, 1-#10 GND (1 CIRCUIT).
- (G) (1) 1 1/2" CONDUIT FOR 2-#6, 1-#6 GND (1 CIRCUIT). (CONDUCTORS BY OTHERS)
- (H) (1) 1 1/4" PVC CONDUIT WITH 2-#10, 1-#10 GND (1 LIGHTING CIRCUIT) AND 2#10, 1-#10 GND (1 REC. CIRCUITS).
- (I) (1) 1 1/2" CONDUIT WITH 2-#10, 1-#10 GND (1 LIGHTING CIRCUIT) AND 2#10, 1-#10 GND (1 REC. CIRCUIT).
- (J) (1) 2" CONDUIT WITH 2-#6 (LIGHTING CIRCUIT B1), 2-#10 (LIGHTING CIRCUIT B2), 1-#6 GND (TOTAL 2 LIGHTING CIRCUITS), AND 5-#10 AND 1-#10 GND (TOTAL 3 REC. CIRCUITS).

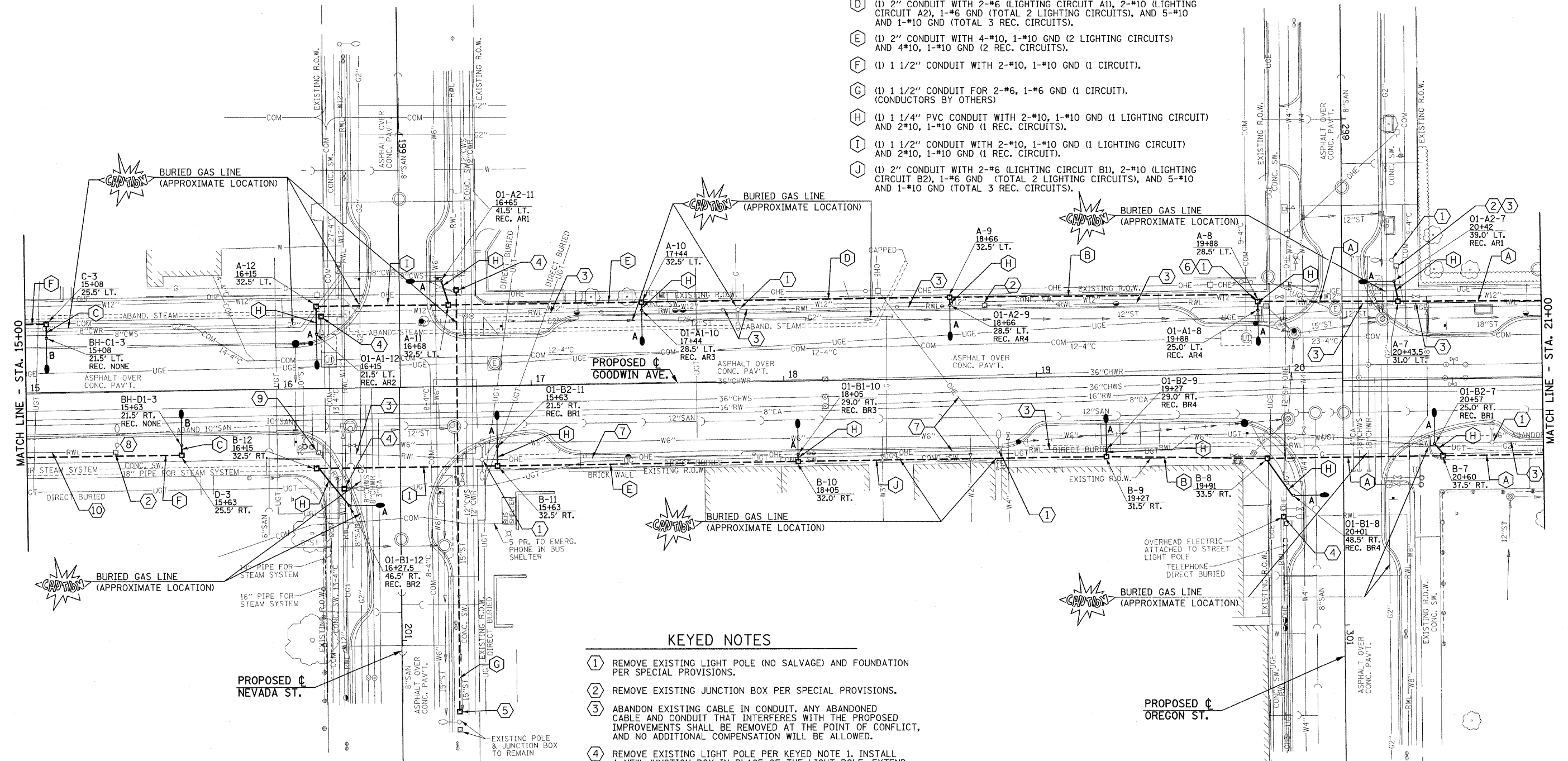

KEYED NOTES

- 1 REMOVE EXISTING LIGHT POLE (NO SALVAGE) AND FOUNDATION PER SPECIAL PROVISIONS.
- 2 REMOVE EXISTING JUNCTION BOX PER SPECIAL PROVISIONS.
- 3 ABANDON EXISTING CABLE IN CONDUIT, ANY ABANDONED CABLE AND CONDUIT THAT INTERFERES WITH THE PROPOSED IMPROVEMENTS SHALL BE REMOVED AT THE POINT OF CONFLICT, AND NO ADDITIONAL COMPENSATION WILL BE ALLOWED.
- 4 REMOVE EXISTING LIGHT POLE PER KEYED NOTE 1. INSTALL A NEW JUNCTION BOX IN PLACE OF THE LIGHT POLE. EXTEND CONDUIT AND CABLES INTO NEW BOX. COORDINATE RECONNECTION BY CITY OF URBANA PERSONNEL.
- 5 INSTALL NEW JUNCTION BOX AT THIS LOCATION. COORDINATE WITH THE CITY FOR CONNECTING CONDUIT INTO EXISTING POLE. PROVIDE 1/2" CONDUIT TO JUNCTION BOX INSTALLED IN PLACE OF REMOVED LIGHT POLE ON THE NW QUADRANT OF THE INTERSECTION AS SHOWN.
- 6 DO NOT DISTURB GROUND WITHIN 3' OF LOCATION OF PROPOSED LIGHT TO ALLOW FOR THE INSTALLATION OF POLE BASE IN UNDISTURBED SOIL.
- 7 REMOVE OVERHEAD CABLE BACK TO ITS SOURCE PER SPECIAL PROVISIONS.
- 8 REMOVE EXISTING LIGHT POLE (FOR SALVAGE) PER SPECIAL PROVISIONS.
- 9 EXISTING JUNCTION BOX TO REMAIN.
- 10 REMOVE CABLE FROM CONDUIT BACK TO ITS SOURCE PER SPECIAL PROVISIONS. CONDUIT AND DIRECT BURIED CABLES MAY BE ABANDONED IN PLACE IF THEY DO NOT INTERFERE WITH THE INSTALLATION OF NEW.

FILE NAME =	DESIGNED - MTP	REVISED -
P:\U0070052\Plans\sheet64-Lighting.dgn	DRAWN - RJS	REVISED -
PLOT DATE =	CHECKED - JJF	REVISED -
1/13/2009 10:45:10 AM	DATE - 01-2009	REVISED -

STATE OF ILLINOIS
DEPARTMENT OF TRANSPORTATION

ROADWAY LIGHTING PLAN
SCALE: 1"=20'
SHEET NO. 65 OF 75 SHEETS
STA. 15+00 TO STA. 21+00

F.A.U. RTE.	SECTION	COUNTY	TOTAL SHEETS	SHEET NO.
7175	07-00456-00-RS	CHAMPAIGN	75	65
GOODWIN AVENUE		CONTRACT NO. 91392		
FED. ROAD DIST. NO.		ILLINOIS FED. AID PROJECT		

STATE OF ILLINOIS
DEPARTMENT OF TRANSPORTATION