

CONDUIT/CABLE SCHEDULE

- (A) (1) 2" CONDUIT WITH 4-#6, 1-#6 GND (2 LIGHTING CIRCUITS) AND 6-#8, 1-#8 GND (4 REC. CIRCUITS).
- (B) (1) 1 1/4" PVC CONDUIT WITH 2-#10, 1-#10 GND (1 LIGHTING CIRCUIT) AND 2#10, 1-#10 GND (1 REC. CIRCUIT).
- (C) (1) 3" CONDUIT WITH 4-#6, 1-#6 GND (2 "B" LIGHTING CIRCUITS), 6-#8, 1-#8 GND (4 "BR" REC. CIRCUITS), 4-#6, 1-#6 GND (2 "D" LIGHTING CIRCUITS), AND 2-#10, 1-#10 GND (1 "DR" REC. CIRCUIT).
- (D) (1) 1 1/2" CONDUIT WITH 4-#6, 1-#6 GND (2 LIGHTING CIRCUITS) AND 2-#10, 1-#10 GND (1 REC. CIRCUIT).
- (E) (2) 3" PVC CONDUITS:
 (1) 3" PVC CONDUIT WITH 4-#6, 1-#6 GND (2 "A" LIGHTING CIRCUITS), 6-#8, 1-#8 GND (4 "AR" REC. CIRCUITS), AND 4-#6, 1-#6 GND (2 "B" LIGHTING CIRCUITS).
 (1) 3" PVC CONDUIT WITH 6-#8, 1-#8 GND (4 "BR" REC. CIRCUITS), 4-#6, 1-#6 GND (2 "C" LIGHTING CIRCUITS), 2-#10, 1-#10 GND (1 "CR" REC. CIRCUIT), 4-#6, 1-#6 GND (2 "D" LIGHTING CIRCUITS), AND 2-#10, 1-#10 GND (1 "DR" REC. CIRCUIT).
- (F) (1) 3" CONDUIT. SEE SPECIAL PROVISIONS.

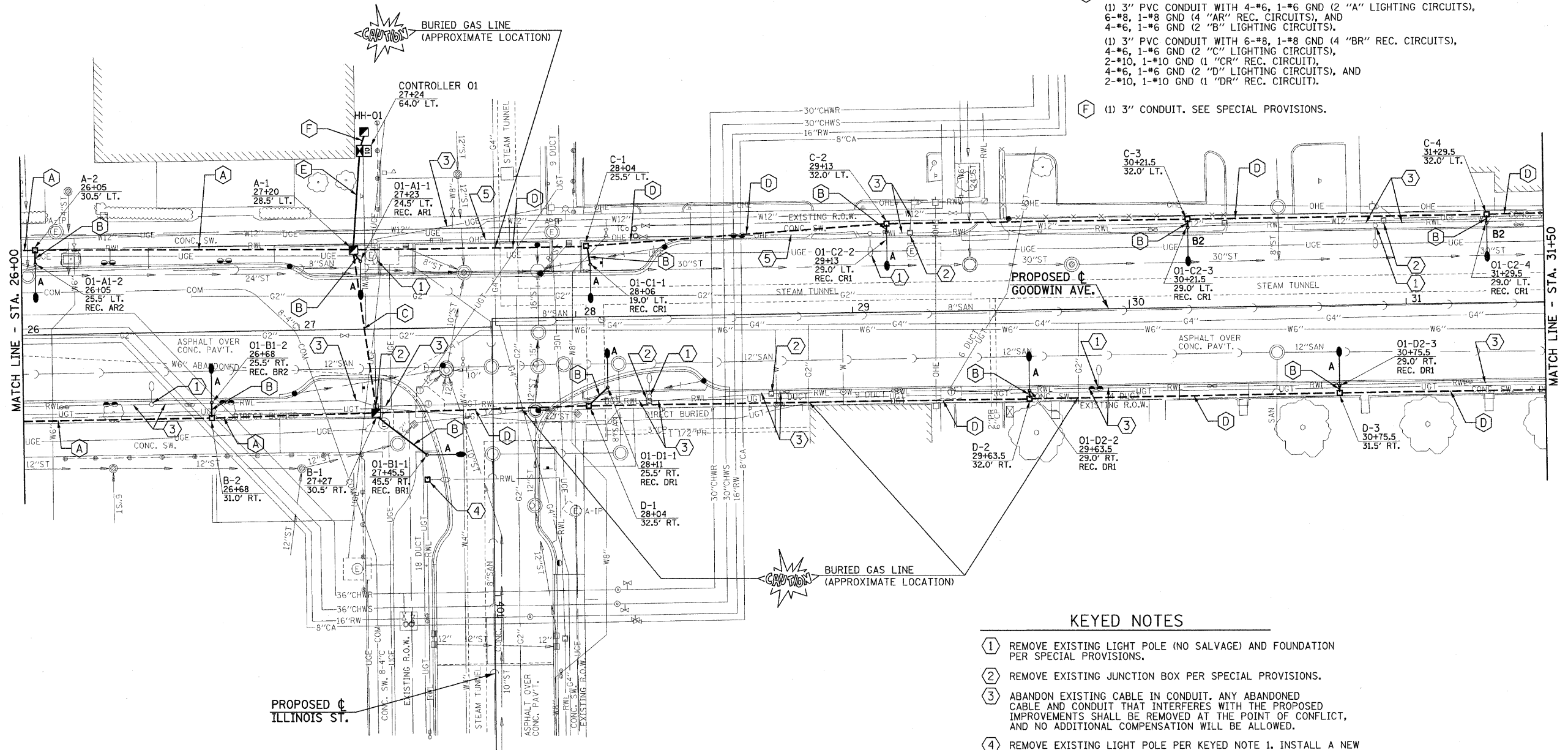

KEYED NOTES

- 1 REMOVE EXISTING LIGHT POLE (NO SALVAGE) AND FOUNDATION PER SPECIAL PROVISIONS.
- 2 REMOVE EXISTING JUNCTION BOX PER SPECIAL PROVISIONS.
- 3 ABANDON EXISTING CABLE IN CONDUIT. ANY ABANDONED CABLE AND CONDUIT THAT INTERFERES WITH THE PROPOSED IMPROVEMENTS SHALL BE REMOVED AT THE POINT OF CONFLICT, AND NO ADDITIONAL COMPENSATION WILL BE ALLOWED.
- 4 REMOVE EXISTING LIGHT POLE PER KEYED NOTE 1. INSTALL A NEW JUNCTION BOX IN PLACE OF THE LIGHT POLE. EXTEND CONDUIT AND CABLES INTO NEW BOX. COORDINATE RECONNECTION BY CITY OF URBANA PERSONNEL.
- 5 REMOVE OVERHEAD CABLE BACK TO ITS SOURCE PER SPECIAL PROVISIONS.

FILE NAME =	DESIGNED - MTP	REVISED -
P:\U00700521\Plans\sheet\64-Lighting.dgn	DRAWN - RJS	REVISED -
PLOT DATE =	CHECKED - JJF	REVISED -
1/13/2009 10:45:12 AM	DATE - 01-2009	REVISED -

DESIGNED - MTP	REVISED -
DRAWN - RJS	REVISED -
CHECKED - JJF	REVISED -
DATE - 01-2009	REVISED -

STATE OF ILLINOIS
DEPARTMENT OF TRANSPORTATION

ROADWAY LIGHTING PLAN	
SCALE: 1"=20'	SHEET NO. 67 OF 75 SHEETS
STA. 26+00	TO STA. 31+50

F.A.U. RTE.	SECTION	COUNTY	TOTAL SHEETS	SHEET NO.
7175	07-00456-00-RS	CHAMPAIGN	75	67
GOODWIN AVENUE		CONTRACT NO. 91392		
FED. ROAD DIST. NO.		ILLINOIS FED. AID PROJECT		