

- INDEX OF SHEETS**
- 1 - TITLE SHEET
  - 2 - SUMMARY OF QUANTITIES & GENERAL NOTES
  - 3 - TYPICAL ROADWAY SECTIONS
  - 4 - ENTRANCE DETAILS
  - 5-7 - INTERSECTION DETAILS
  - 8 - SCHEDULE OF QUANTITIES
  - 9-17 - PLAN & PROFILE
  - 18-57 - CROSS SECTIONS

**HIGHWAY STANDARDS**

- STANDARD 630301-05
- STANDARD 635006-03
- STANDARD 701006-03
- STANDARD 701011-02
- STANDARD 701201-03
- STANDARD 701301-03
- STANDARD 701306-02
- STANDARD 701311-03
- STANDARD 701326-03
- STANDARD 701501-05
- STANDARD 701901-01
- STANDARD 780001-02
- STANDARD BLR 24-2
- STANDARD BLR 26-2

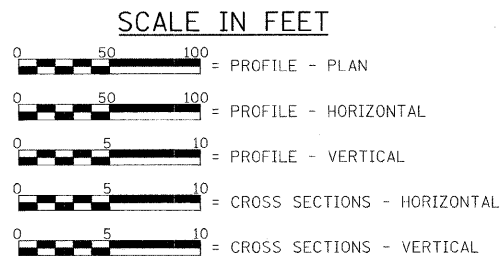

LAND SECTIONS - 31, 32, & 33  
 FUNCTIONAL CLASSIFICATION: MAJOR COLLECTOR (NON-URBAN)  
 A.D.T. - 4150 (2007) 5115 (2028)  
 50 M.P.H. DESIGN SPEED  
 3R GUIDELINES

**CONTRACT NO. 93480**

**STATE OF ILLINOIS  
 DEPARTMENT OF TRANSPORTATION  
 PLANS FOR PROPOSED  
 SURFACE TRANSPORTATION PROGRAM**

**F.A.S. ROUTE 732 - C.H. 17  
 PROJECT NO. RS-0732(147)  
 SECTION 07-00125-02-RS  
 MONTGOMERY COUNTY  
 C-96-225-09**

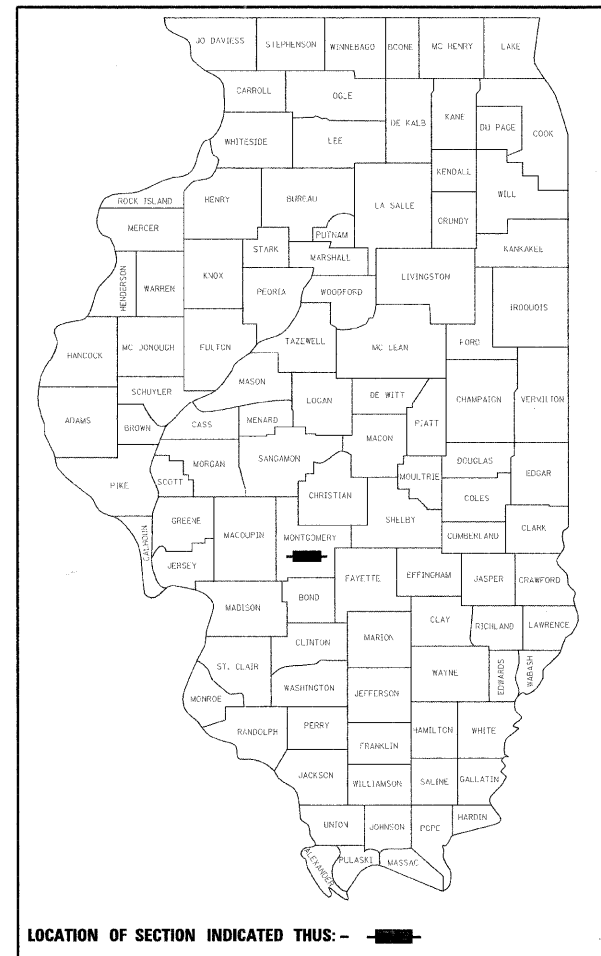

PROJECT DESCRIPTION: PROJECT CONSISTS OF A 3" HOT MIX ASPHALT OVERLAY, SHOULDER WIDENING, GUARDRAIL PLACEMENT AND OTHER ROADWAY ITEMS OF WORK.

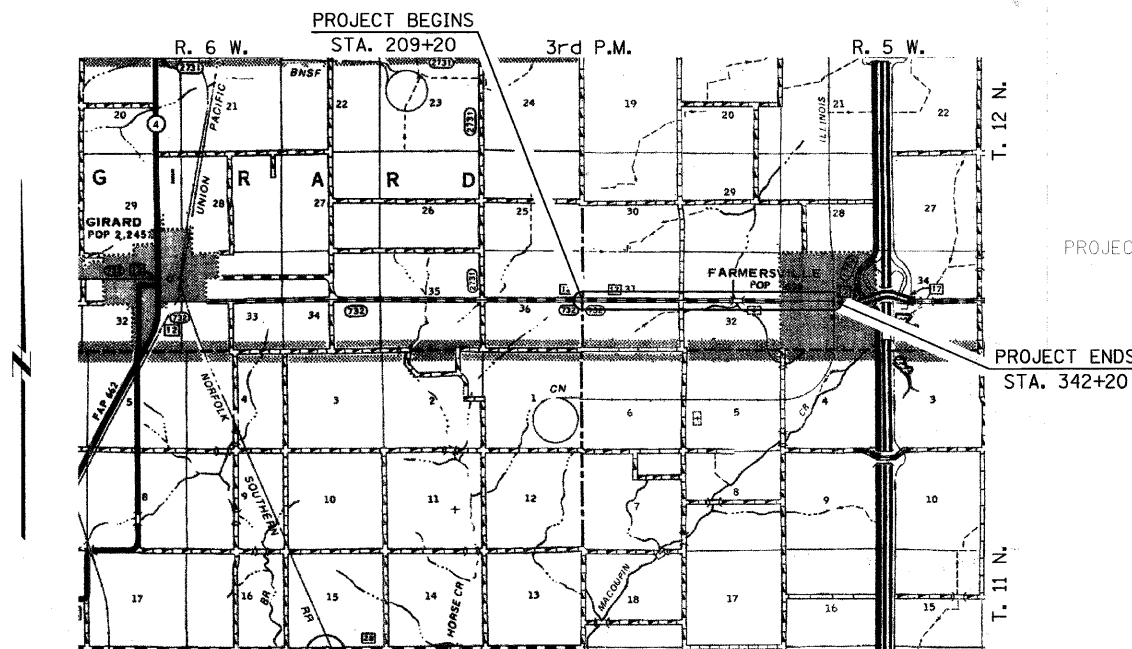

**LOCATION PLAN**

LENGTH OF SECTION - 13300.00 FEET = 2.519 MILES

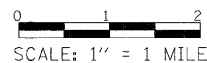

*Christopher P. Koblus* 12/17/08  
 EXPIRATION: 11/30/2009

APPROVED <u>12-15</u> , 20 <u>08</u> <i>[Signature]</i> COUNTY ENGINEER
PASSED <u>FEB 5</u> , 20 <u>09</u> <i>[Signature]</i> DISTRICT SIX ENGINEER OF LOCAL ROADS & STREETS
PASSED <u>February 3</u> , 20 <u>09</u> <i>[Signature]</i> DISTRICT SIX CONSTRUCTION ENGINEER
Releasing For Bid Based on Limited Review <u>FEB 5</u> , 20 <u>09</u> <i>[Signature]</i> DEPUTY DIRECTOR OF HIGHWAYS, REGION FOUR ENGINEER
STATE OF ILLINOIS DEPARTMENT OF TRANSPORTATION

TOLL FREE  
 "JOINT UTILITY LOCATION INFORMATION FOR EXCAVATORS"  
 (J.U.L.I.E.) TELEPHONE NUMBER  
 1-800-892-0123

	USER NAME = #15FR8	DESIGNED - ---	REVISED - ---		<b>Allen Henderson &amp; Associates, Inc.</b> Civil and Structural Engineers Springfield, IL 62703 Phone: (217)544-8033 IL Design Firm No. 184-001907	<b>TITLE SHEET</b>	F.A.S. RTE. 732	SECTION 07-00125-02-RS	COUNTY MONTGOMERY	TOTAL SHEETS 57	SHEET NO. 1
	TLOT SCALE = #SCALE#	CHECKED - ---	REVISED - ---	SCALE: 1" = 1 MILE SHEET NO. 1 OF 57 SHEETS STA. 209+20.00 TO STA. 342+20.00			CONTRACT NO. <b>93480</b>				
	TLOT DATE = #DATE#	DATE - ---	REVISED - ---	FED. ROAD DIST. NO. ILLINOIS FED. AID PROJECT							