

SECTION 32, T. 12 N., R. 5 W., 3rd P.M.

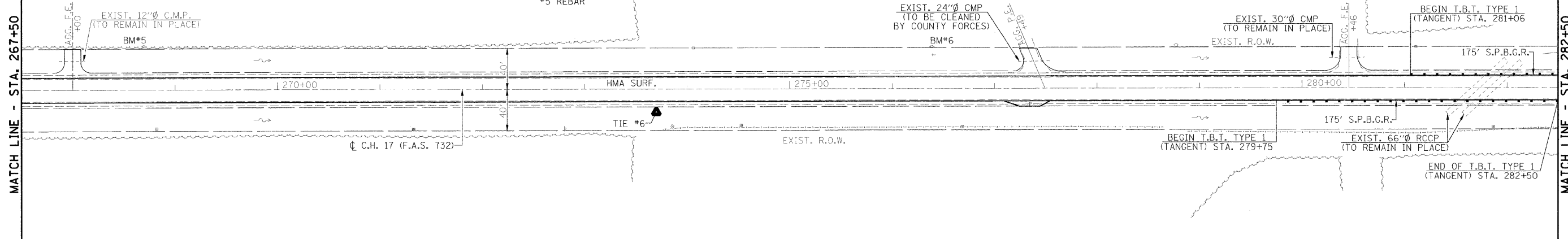

- UTILITIES**
- CONSOLIDATED COMMUNICATIONS
1-800-553-7611
 - AMEREN CIPS
1-888-789-2477
 - CHARTER COMMUNICATIONS
1-217-287-7992
 - ATMOS
1-888-824-3434
 - VILLAGE OF FARMERSVILLE
1-217-227-4169

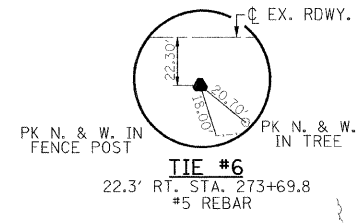
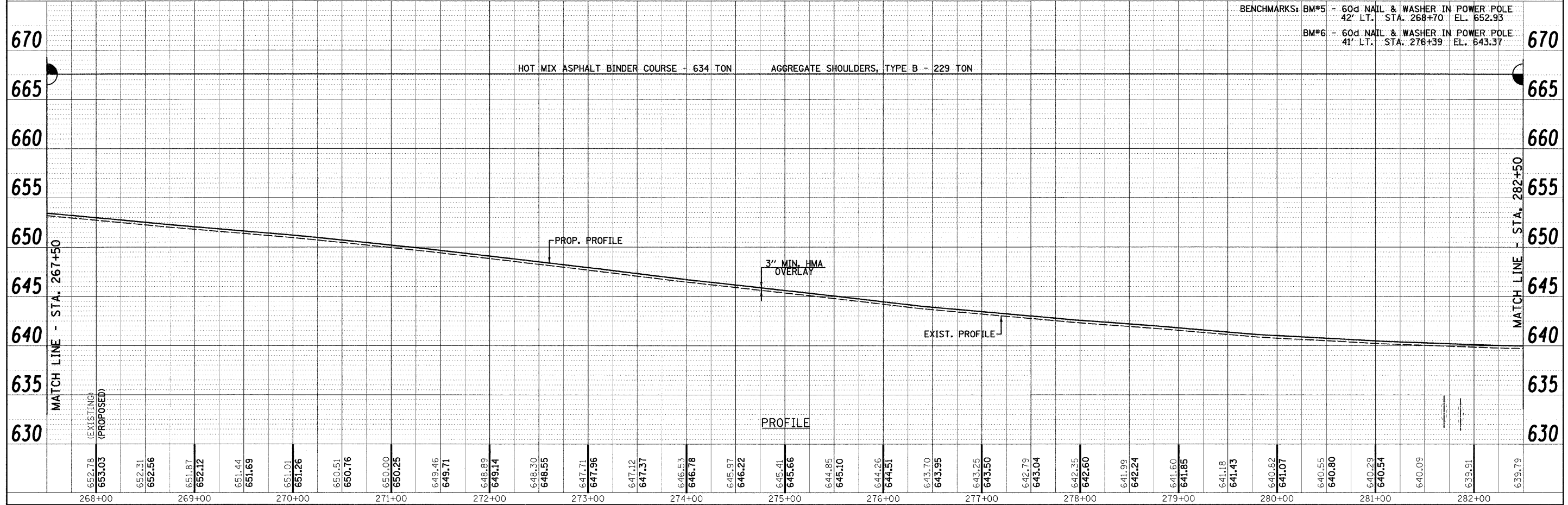
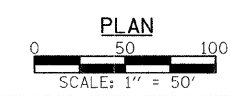

- BENCHMARKS:**
- BM#5 - 60d NAIL & WASHER IN POWER POLE 42' LT. STA. 268+70 EL. 652.93
 - BM#6 - 60d NAIL & WASHER IN POWER POLE 41' LT. STA. 276+39 EL. 643.37

| | | | | | | | | | | | |
|-------------|--------------------|------------|-----------|---|---------------------------|----------------|-------------|---------|----------------------------|---------------------|---------------------------|
| FILE NAME = | USER NAME = #USER# | DESIGNED - | REVISED - | <p>Allen Henderson & Associates, Inc. Civil and Structural Engineers Springfield, IL. 62703 Phone: (217)544-8033 IL Design Firm No. 184-001907</p> | PLAN & PROFILE | | F.A.S. RTE. | SECTION | COUNTY | TOTAL SHEETS | SHEET NO. |
| | | DRAWN - | REVISED - | | SCALE: 1" = 50' | SHEET NO. | OF | SHEETS | STA. 209+20 TO STA. 342+20 | FED. ROAD DIST. NO. | ILLINOIS FED. AID PROJECT |
| | | CHECKED - | REVISED - | | 732 | 07-00125-02-RS | MONTGOMERY | 57 | 13 | CONTRACT NO. 9348 | |
| | | DATE - | REVISED - | | | | | | | | |

PLAN

| | | |
|---------------|----|------|
| SURVEYED | BY | DATE |
| PLOTTED | | |
| NOTED | | |
| CAD FILE NAME | | |

PROFILE

| | | |
|--------------------------|----|------|
| SURVEYED | BY | DATE |
| PLOTTED | | |
| NOTED | | |
| STRUCTURE NOTATIONS CHND | | |