

SECTION 32, T. 12 N., R. 5 W., 3rd P.M.

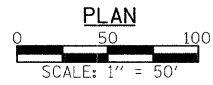

- UTILITIES**
- CONSOLIDATED COMMUNICATIONS
1-800-553-7611
 - AMEREN CIPS
1-888-789-2477
 - CHARTER COMMUNICATIONS
1-217-287-7992
 - ATMOS
1-888-824-3434
 - VILLAGE OF FARMERSVILLE
1-217-227-4169

BENCHMARKS: BM#8 - 60d NAIL & WASHER IN POWER POLE
42' LT. STA. 297+89 EL. 646.64

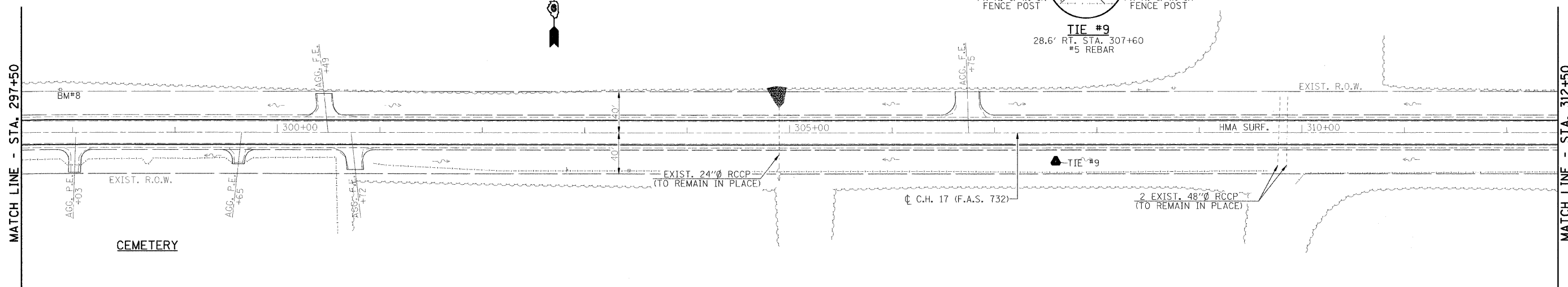
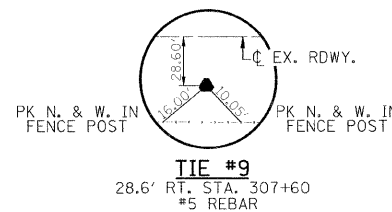
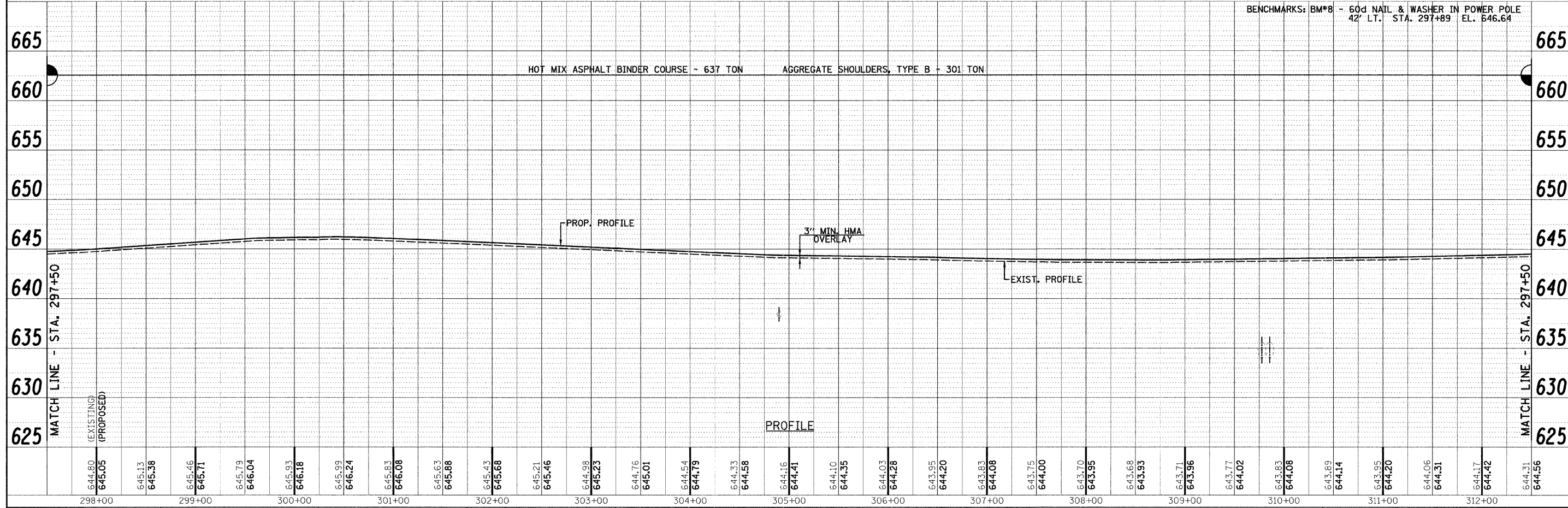

644.80	645.05	645.13	645.38	645.46	645.71	645.79	646.04	645.93	646.18	645.99	646.24	645.83	646.08	645.63	645.88	645.43	645.68	645.21	645.46	644.98	645.23	644.76	645.01	644.54	644.79	644.33	644.58	644.16	644.41	644.10	644.35	644.03	644.28	643.95	644.20	643.83	644.08	643.75	644.00	643.70	643.95	643.68	643.93	643.71	643.96	643.77	644.02	643.83	644.08	643.89	644.14	643.95	644.20	644.06	644.31	644.17	644.42	644.31	644.56
298+00	299+00	300+00	301+00	302+00	303+00	304+00	305+00	306+00	307+00	308+00	309+00	310+00	311+00	312+00																																													

PLAN

SURVEYED	BY	DATE
PLOTTED		
NOTE BOOK		
NO.		

PROFILE

DESIGNED	BY	DATE
DRAWN		
CHECKED		
DATE		

Allen Henderson & Associates, Inc.
Civil and Structural Engineers Springfield, IL.
62703 Phone: (217)544-8033 IL Design Firm
No. 184-001907

FILE NAME =	USER NAME = #USER#	DESIGNED -	REVISED -		<p>PLAN & PROFILE</p> <p>SCALE: 1" = 50' SHEET NO. OF SHEETS STA. 209+20 TO STA. 342+20</p>		F.A.S. RTE.	SECTION	COUNTY	TOTAL SHEETS	SHEET NO.
		DRAWN -	REVISED -		732	07-00125-02-RS	MONTGOMERY	57	15		
		CHECKED -	REVISED -		CONTRACT NO. 93480						
		DATE -	REVISED -		FED. ROAD DIST. NO. ILLINOIS FED. AID PROJECT						