

SECTION 32, T. 12 N., R. 5 W., 3rd P.M.

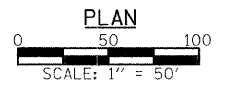

- UTILITIES**
- CONSOLIDATED COMMUNICATIONS
1-800-553-7611
 - AMEREN CIPS
1-888-789-2477
 - CHARTER COMMUNICATIONS
1-217-287-7992
 - ATMOS
1-888-824-3434
 - VILLAGE OF FARMERSVILLE
1-217-227-4169

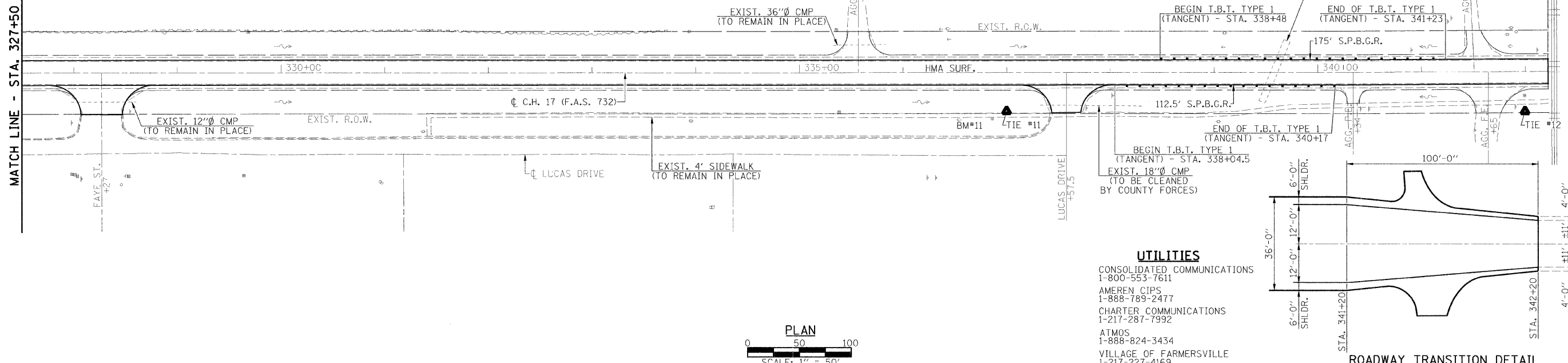
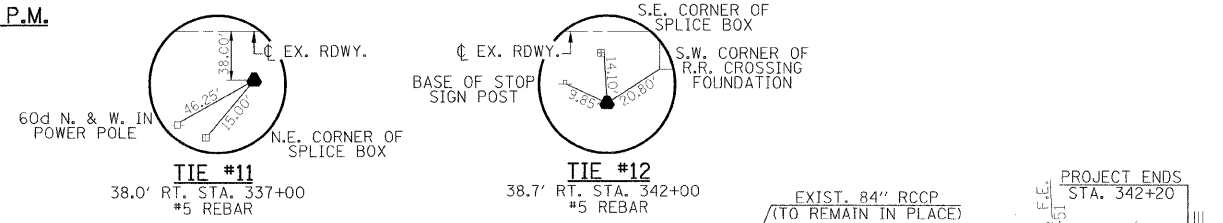
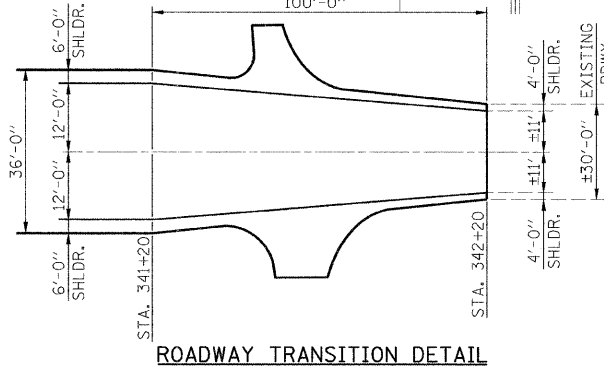

PLAN	SURVEYED	DATE
	PLOTTED	
	CHECKED	
	BY	
	NO. OF WAY CHECKED	
	CADD FILE NAME	

PROFILE	SURVEYED	DATE
	PLOTTED	
	CHECKED	
	BY	
	NO. OF WAY CHECKED	
	STRUCTURE NOTATIONS SHIPS	

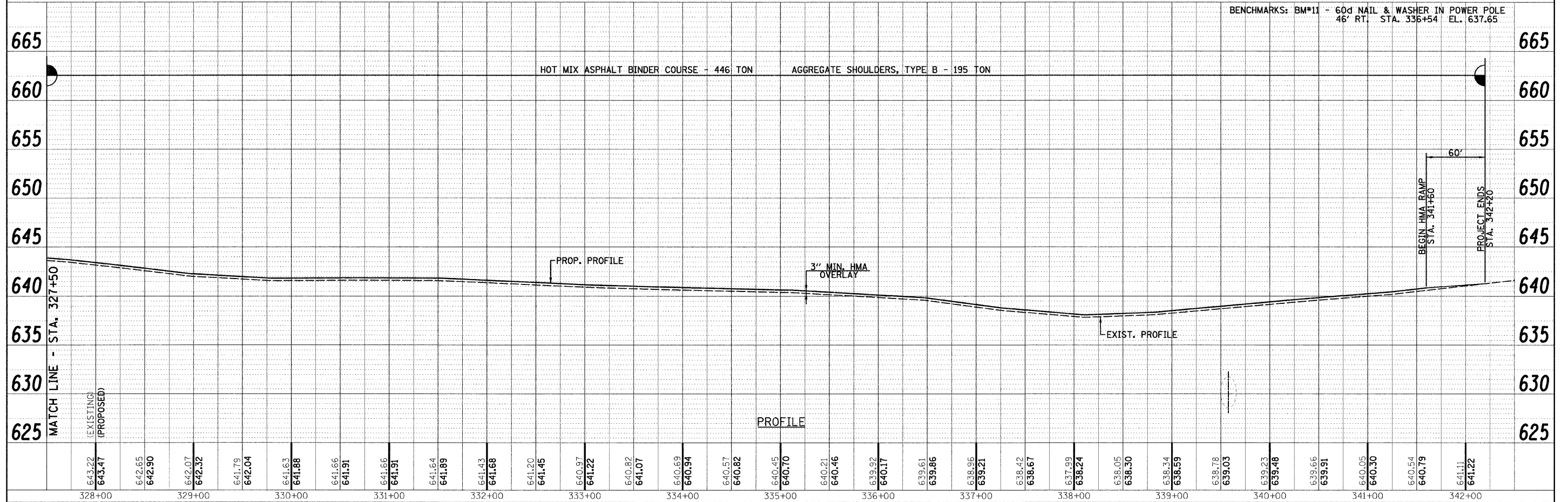

FILE NAME =	USER NAME = #USER#	DESIGNED -	REVISED -	<p>Allen Henderson & Associates, Inc. Civil and Structural Engineers Springfield, IL. 62703 Phone: (217)544-8033 IL Design Firm No. 184-001907</p>	PLAN & PROFILE		F.A.S. RTE. 732	SECTION 07-00125-02-RS	COUNTY MONTGOMERY	TOTAL SHEETS 57	SHEET NO. 17	
PLOT SCALE = #SCALE#	CHECKED -	REVISED -	REVISED -		SCALE: 1" = 50'	SHEET NO. OF SHEETS	STA. 209+20 TO STA. 342+20	CONTRACT NO. 9348		ILLINOIS FED. AID PROJECT		
PLOT DATE = #DATE#	DATE -	REVISED -	REVISED -									