

| F.A.P. RTE. | SECTION | COUNTY | TOTAL SHEETS | SHEET NO. |
|---------------------|---------|----------------|--------------|------------------|
| 781 | | CRAWFORD | 212 | 62 |
| STA. 14+500 | | TO STA. 14+850 | | |
| FED. ROAD DIST. NO. | | ILLINOIS | | FED. AID PROJECT |

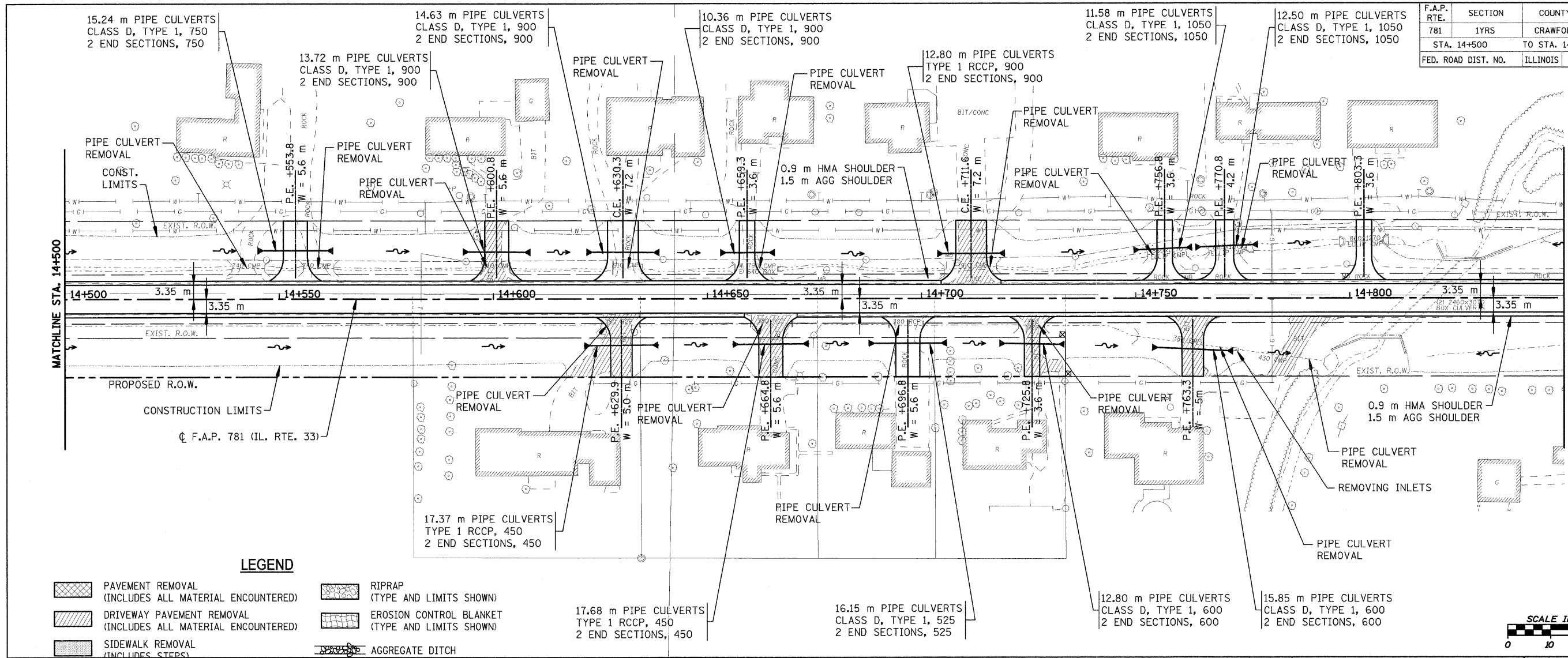

LEGEND

- PAVEMENT REMOVAL (INCLUDES ALL MATERIAL ENCOUNTERED)
- DRIVEWAY PAVEMENT REMOVAL (INCLUDES ALL MATERIAL ENCOUNTERED)
- SIDEWALK REMOVAL (INCLUDES STEPS)
- TREE REMOVAL (HECTARES)
- TREE REMOVAL
- RIPRAP (TYPE AND LIMITS SHOWN)
- EROSION CONTROL BLANKET (TYPE AND LIMITS SHOWN)
- AGGREGATE DITCH

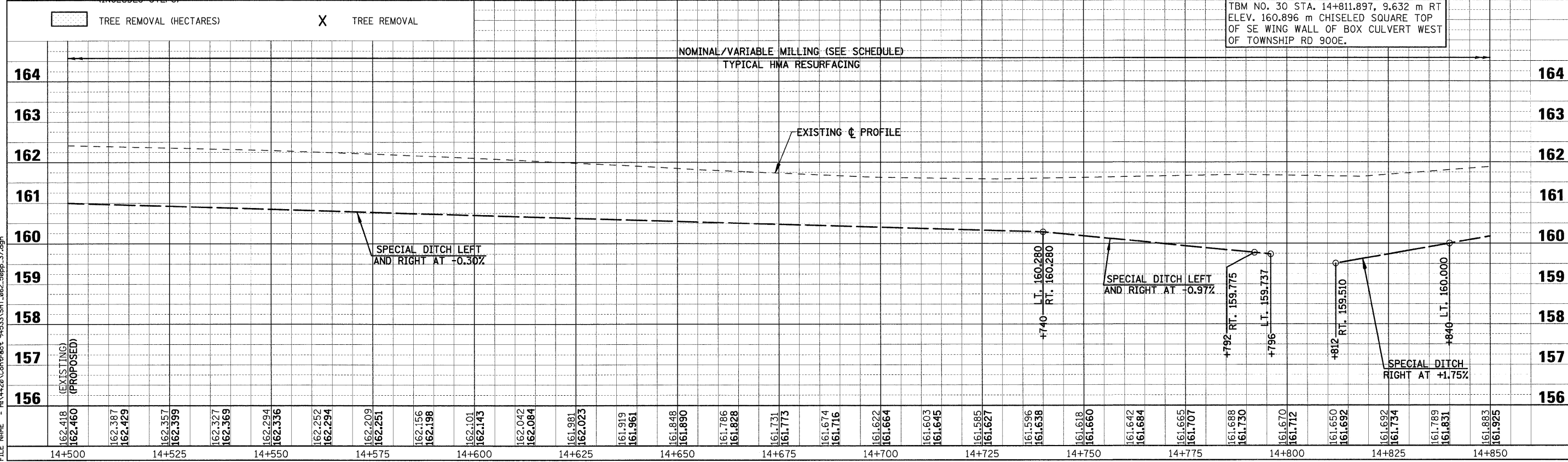

TBM NO. 30 STA. 14+811.897, 9.632 m RT ELEV. 160.896 m CHISELED SQUARE TOP OF SE WING WALL OF BOX CULVERT WEST OF TOWNSHIP RD 900E.

PLOT DATE = 12/22/2008
FILE NAME = H:\4420\Contract\94533\SHT_062_50ppp_37.dgn