

ROUTE NO.	SECTION	COUNTY	TOTAL SHEETS	SHEET NO.
FAS 1539	*	MACON	57	3
FED. ROAD DIST. NO.	ILLINOIS	PROJECT		

* 00-00155-00-BR

TBM
CHISELED SQUARE SOUTHWEST CORNER
OF SOUTHEAST WINGWALL
ELEVATION 611.21

PAVEMENT REMOVAL (SPECIAL)

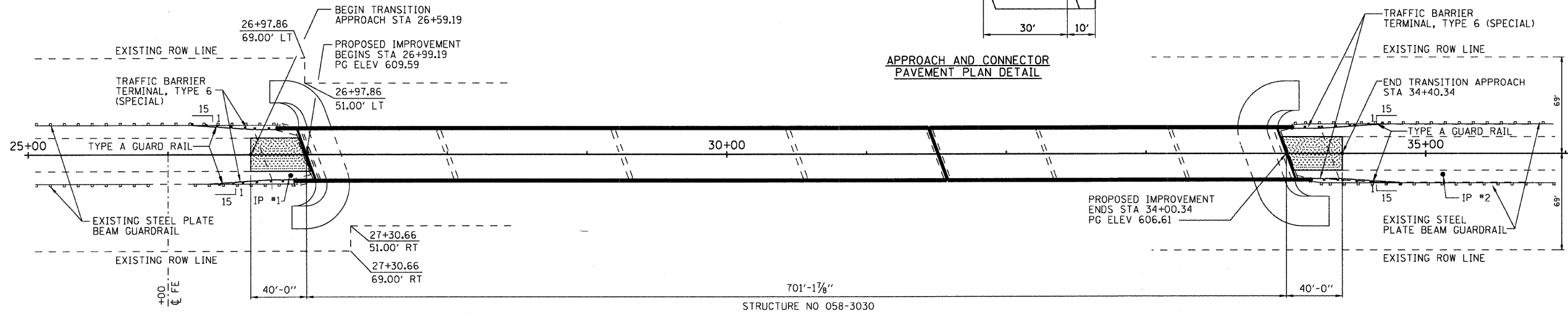
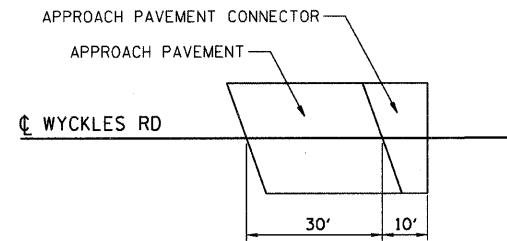

PLAN	DATE
NO.	

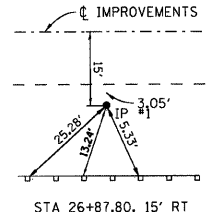

PAVEMENT REMOVAL (SPECIAL)		
STA	TO	STA
26+59.19	26+99.19	107
34+00.34	34+40.34	107
TOTAL		214

GUARDRAIL REMOVAL			FEET
STA	TO	STA	
LT 26+16.5	26+77.5	61.0	
RT 26+29.6	26+90.6	61.0	
LT 34+05.3	34+70.1	64.8	
RT 34+18.4	34+83.2	64.8	
TOTAL			252

PAINT PAVEMENT MARKING LINE - 4"				FEET
COLOR	STA	TO	STA	
SOLID WHITE	LT 26+59.19	TO	34+40.34	781
SOLID WHITE	RT 26+59.19	TO	34+40.34	781
YELLOW SKIP DASH	26+59.19	TO	34+40.34	200
TOTAL				1762

TRAFFIC BARRIER TERMINAL, TYPE 6 (SPECIAL)				FEET
STA	TO	STA	EACH	
LT 26+34.4	26+78.1	1		
RT 26+47.5	26+91.2	1		
LT 34+04.7	34+48.4	1		
RT 34+17.8	34+61.5	1		
TOTAL				4

STEEL PLATE BEAM GUARD RAIL, TYPE A SPL				FEET
STA	TO	STA	EACH	
LT 26+16.5	26+34.4	17.9		
RT 26+29.6	26+47.5	17.9		
LT 34+48.4	34+70.1	21.7		
RT 34+61.5	34+83.2	21.7		
TOTAL				80

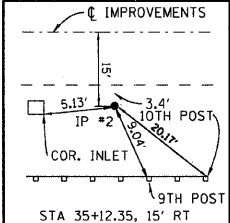

PROFILE	DATE
NO.	

