

NOTES:

1. ALL LIGHT POLES ARE OFFSET 2' FROM FACE OF CURB TO FACE OF THE CLAM SHELL BASE UNLESS OTHERWISE NOTED.
2. CONDUIT ACROSS STREETS SHALL BE PUSHED.
3. LIGHT POLE EA6 SHALL BE LOCATED AT SIMILAR LOCATION TO EXISTING POLE.

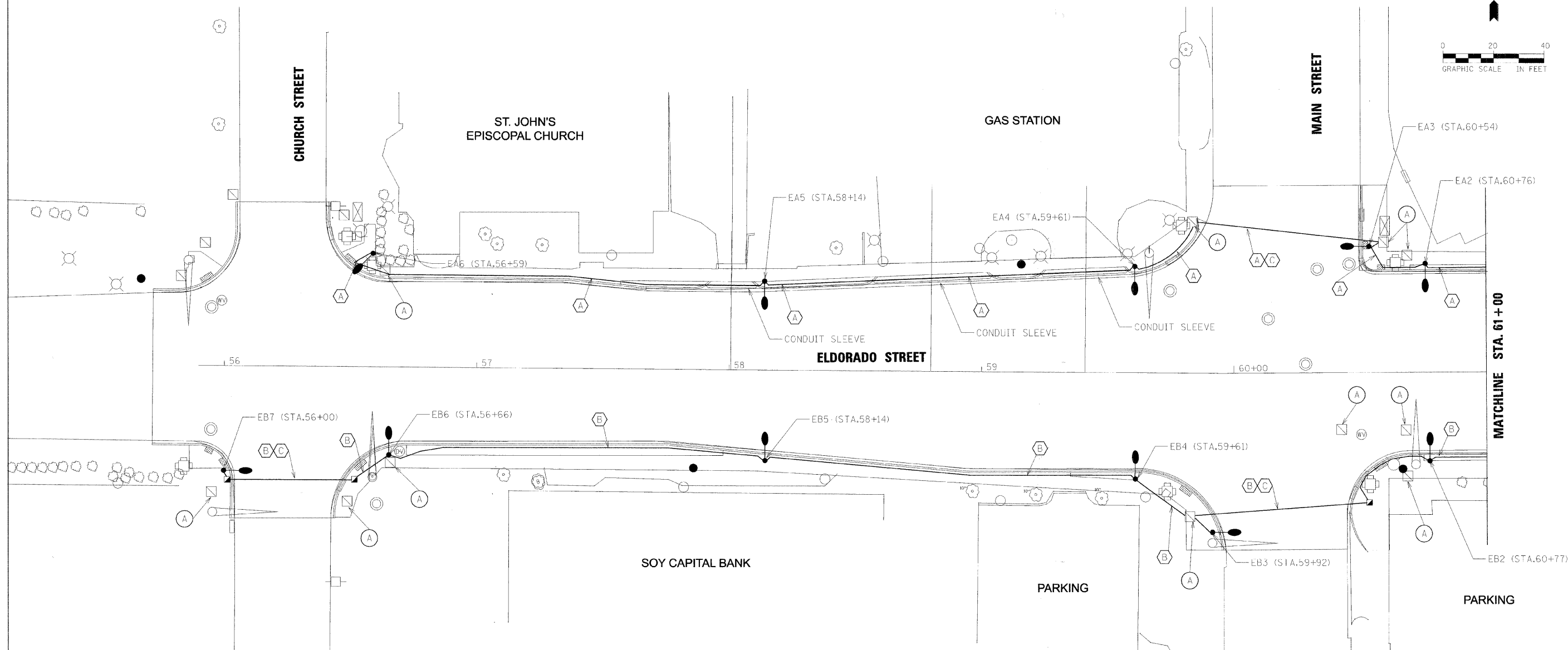
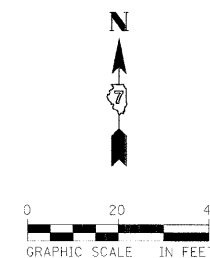

LEGEND

- (A) HANDHOLE TO BE ADJUSTED 81400115
- PROPOSED STREET LIGHT LOCATION 30' POLE
- ⊗ EXISTING STREET LIGHT TO REMAIN
- PROPOSED HANDHOLE
- ⊞ EXISTING HANDHOLE

- (A) UNIT DUCT 2-1/2" x 8", 1/2" x 8" GROUND (XLP-TYPE USE)
- (B) UNIT DUCT 2-1/2" x 6", 1/2" x 8" GROUND (XLP-TYPE USE)
- (C) 3" RIGID GALV. STEEL PUSHED
- CONDUIT SLEEVE FOR UNIT DUCT 2" RIGID GALV. STEEL
- (P) PAINT EXISTING POLE & INSTALL CLAM SHELL BASE

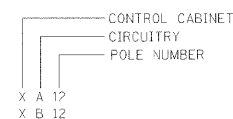

FILE NAME = #FILES#



USER NAME =	DESIGNED - DAD	REVISED - March 13, 2009
PLOT SCALE =	DRAWN - DAD/KJB/WM	REVISED - March 23, 2009
PLOT DATE =	CHECKED - JJM	REVISED -
	DATE -	REVISED -

**STATE OF ILLINOIS
DEPARTMENT OF TRANSPORTATION**

**ROADWAY LIGHTING PLANS
STA 55+80 TO 61+00**

SHEET NO. 1 OF 6 SHEETS STA. 55+80 TO STA. 61+00

F.A.P. RTE.	SECTION	CITY	TOTAL SHEETS	SHEET NO.
323	06-00625-00-SW	DECATUR	121	73
ELDORADO STREETScape PROJECT CONTRACT NO. 95574				
FED. ROAD DIST. NO. ILLINOIS FED. AID PROJECT: TE-00D(7)351				