

FAU ROUTE	IDOT SECTION	COUNTY
9177	*	ST. CLAIR
FEDERAL AID PROJECT		ILLINOIS
IDOT JOB NO. C-98-309-09		
IDOT CONTRACT NO. 97362		
* 05-00007-03-PV; 06-00007-05-PV		

THOUVENOT, WADE & MOERCHEN, INC.
ENGINEERS ♦ SURVEYORS ♦ PLANNERS



- CORPORATE OFFICE**
4940 OLD COLLINSVILLE RD.
SWANSEA, ILLINOIS 62226
TEL (618) 624-4488
FAX (618) 624-6688
corp@twm-inc.com
- CARBONDALE OFFICE**
206 WEST COLLEGE ST., SUITE 2
CARBONDALE, ILLINOIS 62901
TEL (618) 549-8844
FAX (618) 549-8450
info@twm-inc.com
- EDWARDSVILLE OFFICE**
10158 CENTURY DRIVE
EDWARDSVILLE, ILLINOIS 62025
TEL (618) 656-4040
FAX (618) 656-4343
info@twm-inc.com
- ST. CHARLES OFFICE**
400 NORTH 5th ST., SUITE 101
ST. CHARLES, MISSOURI 63301
TEL (636) 724-8300
FAX (636) 724-8304
info@twm-inc.com
- WATERLOO OFFICE**
113 SOUTH MAIN STREET
WATERLOO, ILLINOIS 62298
TEL (618) 939-5050
FAX (618) 939-3938
info@twm-inc.com

PROFESSIONAL REGISTRATIONS	LICENSE NO.
ILLINOIS PROFESSIONAL DESIGN FIRM	184-001220
PROFESSIONAL ENGINEERING CORP.	62-035370
PROFESSIONAL STRUCTURAL ENGR. CORP.	81-005202
ILLINOIS PROF. LAND SURVEYING CORP.	048-000029
MISSOURI PROFESSIONAL ENGR. CORP.	NC 001528
MISSOURI LAND SURVEYING CORP.	NC 000346

PROPOSED ALIGNMENT, TIES, AND BENCHMARKS

PROJECT:
SEIBERT ROAD
RECONSTRUCTION - PHASE III
VILLAGE OF SHILOH
ST. CLAIR COUNTY, ILLINOIS

REV.	DATE	DESCRIPTION

DRAWN BY: JWS	SHEET
DESIGNED BY: JWS	11A
CHECKED BY: SJK	OF 79 SHEETS
APPROVED BY: SJK	PROJECT DESCRIPTION
PROJECT NUMBER: 20-010479	SEIBERT ROAD RECONSTRUCTION
<input checked="" type="checkbox"/> ISSUED FOR REVIEW	<input type="checkbox"/> ISSUED FOR BIDDING
<input type="checkbox"/> ISSUED FOR CONSTR.	<input type="checkbox"/> RECORD DRAWING

PROP. CURVE PRSEIB7
PI STA. = 46+55.73
 $\Delta = 80^\circ 04' 27''$ (RT)
D = 19° 04' 39"
R = 300.33'
T = 252.34'
L = 419.73'
E = 91.94'
e = N.C.
T.R. = N/A
S.E. RUN = N/A
P.C. STA = 44+03.40
P.T. STA = 48+23.12

PROP. CURVE PRSEIB8
PI STA. = 55+98.97
 $\Delta = 75^\circ 39' 39''$ (LT)
D = 19° 04' 39"
R = 300.33'
T = 233.22'
L = 396.60'
E = 79.92'
e = N.C.
T.R. = N/A
S.E. RUN = N/A
P.C. STA = 53+65.76
P.T. STA = 57+62.35

PROP. CURVE SR1-1
PI STA. = 0+80.54
 $\Delta = 56^\circ 17' 36''$ (RT)
D = 52° 05' 13"
R = 110.00'
T = 58.85'
L = 108.08'
E = 14.75'
e = N.C.
T.R. = N/A
S.E. RUN = N/A
P.C. STA = 0+21.69
P.T. STA = 1+29.77

**BEGIN PHASE III
END PHASE IV OMISSION
STA 44 + 03.40**

**END PROJECT
END PHASE III
STA 58 + 13.25**

**END PROJECT
END PHASE III
STA 2 + 03.96 (JOHNSON RD.)**

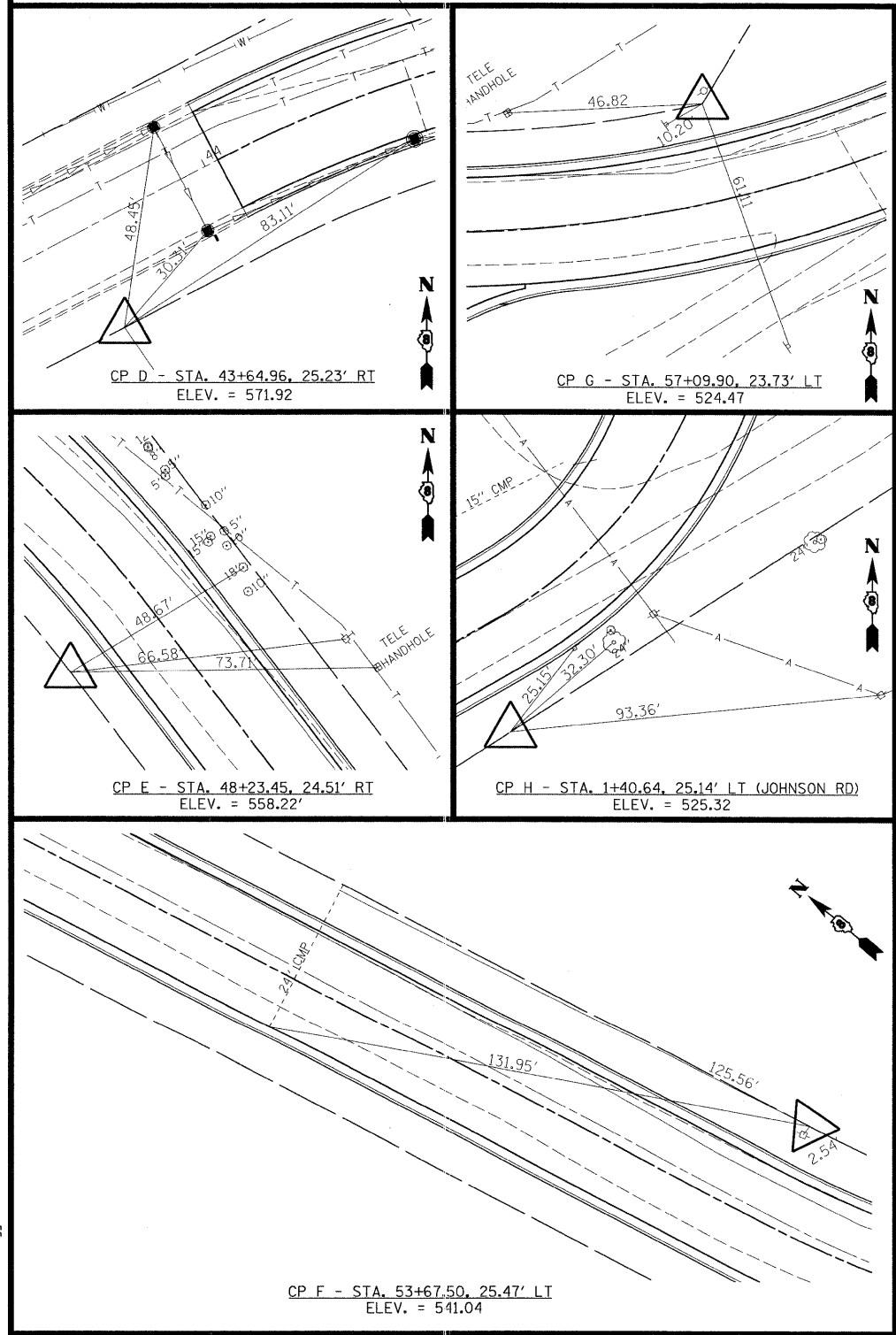
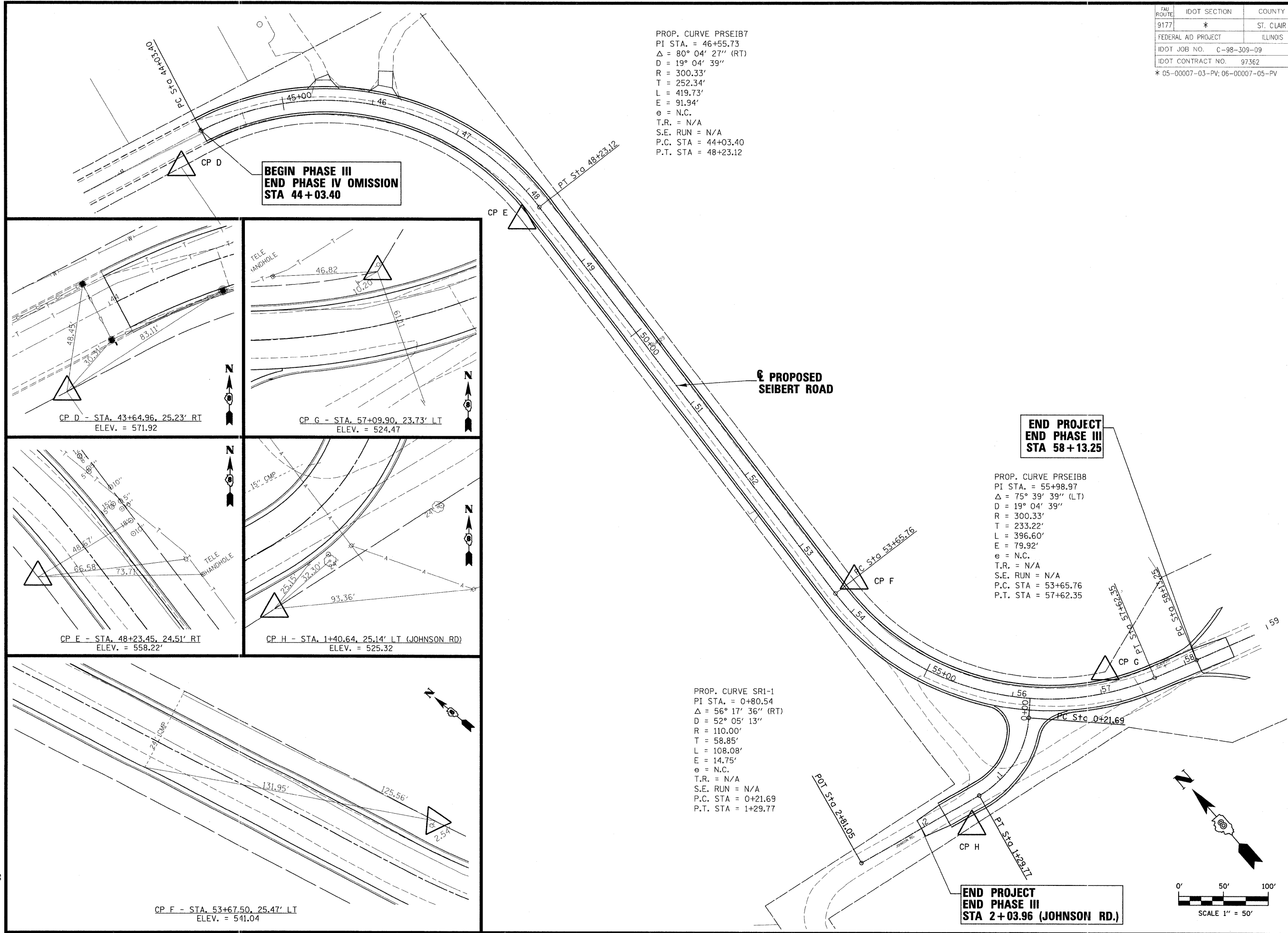

PLOT DATE = 2/19/2009
 FILE NAME = F:\1010479\98\dgn\IDOT PHASE III\Phase III\010479B-ALION_P113.dgn
 PLOT SCALE = 50.00000 / 1 IN.
 USER NAME = dbjg98

