

PLOT DATE = 2/19/2009  
 FILE NAME = F:\0104799\DOT PHASE V - TMM PHASE III\phaseIII\0104799-EROSION.PH3.dgn  
 PLOT SCALE = 28.0000 / 1 IN.  
 USER NAME = dbj93

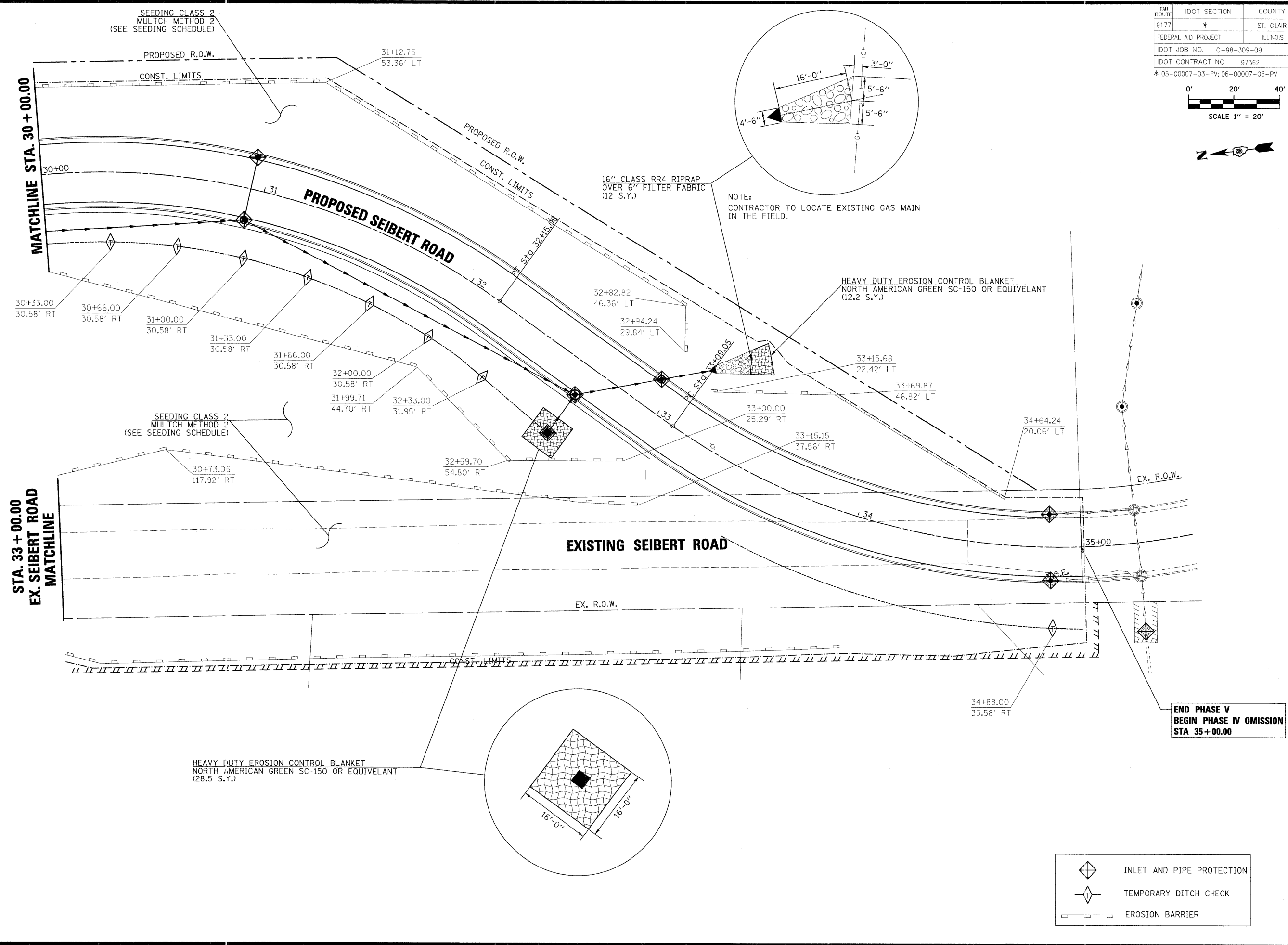

FAU ROUTE	IDOT SECTION	COUNTY
9177	*	ST. CLAIR
FEDERAL AID PROJECT	ILLINOIS	
IDOT JOB NO.	C-98-309-09	
IDOT CONTRACT NO.	97362	

\* 05-00007-03-PV; 06-00007-05-PV

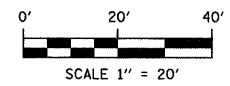

**THOUVENOT, WADE & MOERCHEN, INC.**  
 ENGINEERS ♦ SURVEYORS ♦ PLANNERS



- CORPORATE OFFICE**  
 4940 OLD COLLINSVILLE RD.  
 SWANSEA, ILLINOIS 62226  
 TEL (618) 624-4488  
 FAX (618) 624-6688  
 corp@twm-inc.com
- CARBONDALE OFFICE**  
 206 WEST COLLEGE ST., SUITE 2  
 CARBONDALE, ILLINOIS 62901  
 TEL (618) 549-8844  
 FAX (618) 549-8450  
 info@twm-inc.com
- EDWARDSVILLE OFFICE**  
 1015B CENTURY DRIVE  
 EDWARDSVILLE, ILLINOIS 62025  
 TEL (618) 656-4040  
 FAX (618) 656-4343  
 info@twm-inc.com
- ST. CHARLES OFFICE**  
 400 NORTH 5th ST., SUITE 101  
 ST. CHARLES, MISSOURI 63301  
 TEL (636) 724-8300  
 FAX (636) 724-8304  
 info@twm-inc.com
- WATERLOO OFFICE**  
 113 SOUTH MAIN STREET  
 WATERLOO, ILLINOIS 62298  
 TEL (618) 939-5050  
 FAX (618) 939-3938  
 info@twm-inc.com

PROFESSIONAL REGISTRATIONS	LICENSE NO.
ILLINOIS PROFESSIONAL DESIGN FIRM	184-001220
PROFESSIONAL ENGINEERING CORP.	62-035370
PROFESSIONAL STRUCTURAL ENGR. CORP.	81-005202
ILLINOIS PROF. LAND SURVEYING CORP.	048-000029
MISSOURI PROFESSIONAL ENGR. CORP.	NC 001528
MISSOURI LAND SURVEYING CORP.	NC 000346

**TITLE:** TEMPORARY EROSION CONTROL DETAILS  
 STA 30+00.00 TO 35+00.00

**PROJECT:** SEIBERT ROAD RECONSTRUCTION - PHASE V  
 VILLAGE OF SHILOH  
 ST. CLAIR COUNTY, ILLINOIS

REV.	DATE	DESCRIPTION

DRAWN BY: JWS	SHEET <b>32</b> OF 79 SHEETS
DESIGNED BY: JWS	
CHECKED BY: SJK	PROJECT DESCRIPTION SEIBERT ROAD RECONSTRUCTION
APPROVED BY: SJK	
PROJECT NUMBER: 20-010479	ISSUED FOR REVIEW <input type="checkbox"/>
	ISSUED FOR BIDDING <input type="checkbox"/>
	RECORD DRAWING <input type="checkbox"/>

