

F.A.P. RTE.	SECTION	COUNTY	TOTAL SHEETS	SHEET NO.
312	101-2(A,B,R)	ALEXANDER	152	41
STA.	TO STA.			
FED. ROAD DIST. NO.	ILLINOIS FED. AID PROJECT			

NOTE: CONSTRUCTION LIMITS ON NORTH SIDE HAVE BEEN OMITTED FOR CLARITY.

FINAL SURVEY	DATE
SURVEYED	
PLOTTED	
NOTE BOOK	
TEMPLATE	
AREAS CHECKED	
NO.	

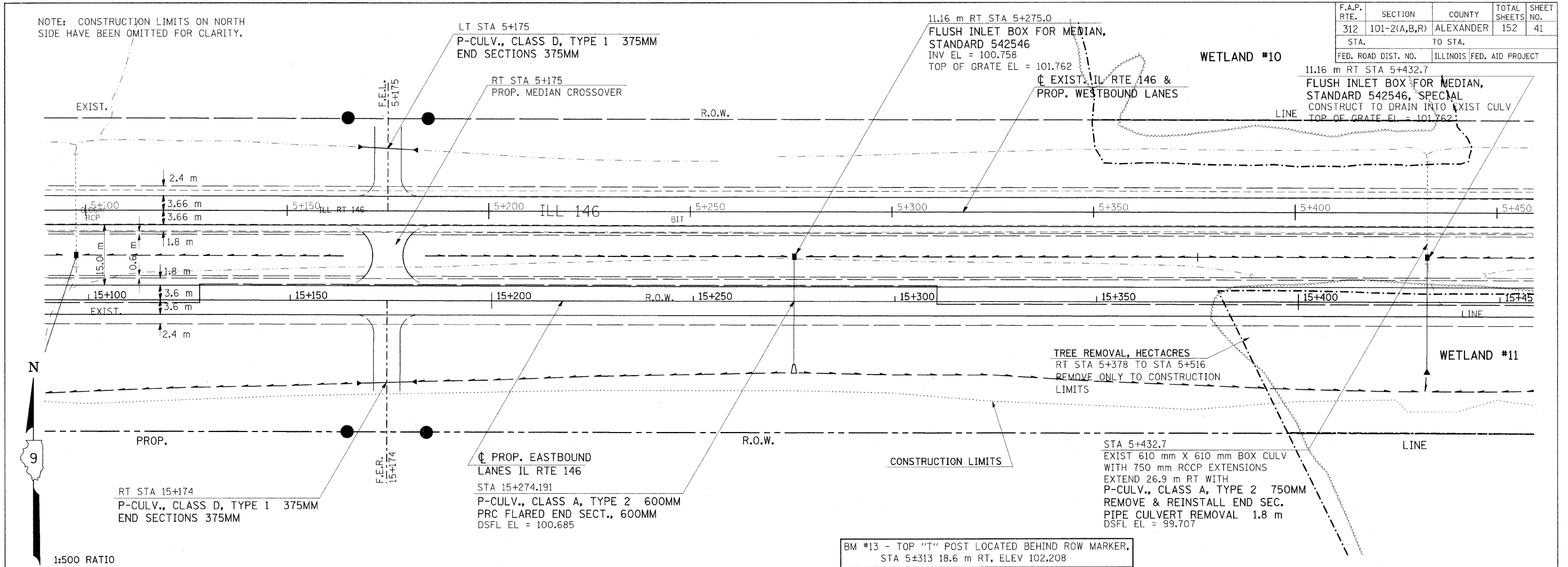

1:500 RATIO

BM #13 - TOP "T" POST LOCATED BEHIND ROW MARKER, STA 5±313 18.6 m RT, ELEV 102.208

Friday, November 21, 2008 @ 10:55:42 AM
 c:\pwworkspace\haskel\headcn\dms39821\m0259991.dgn LV2-20-24-60-62-63
 c:\pwworkspace\haskel\headcn\dms39821\m0259991.dgn LV2-20-24-60-62-63
 c:\pwworkspace\haskel\headcn\dms39821\m0259991.dgn LV2-20-24-60-62-63

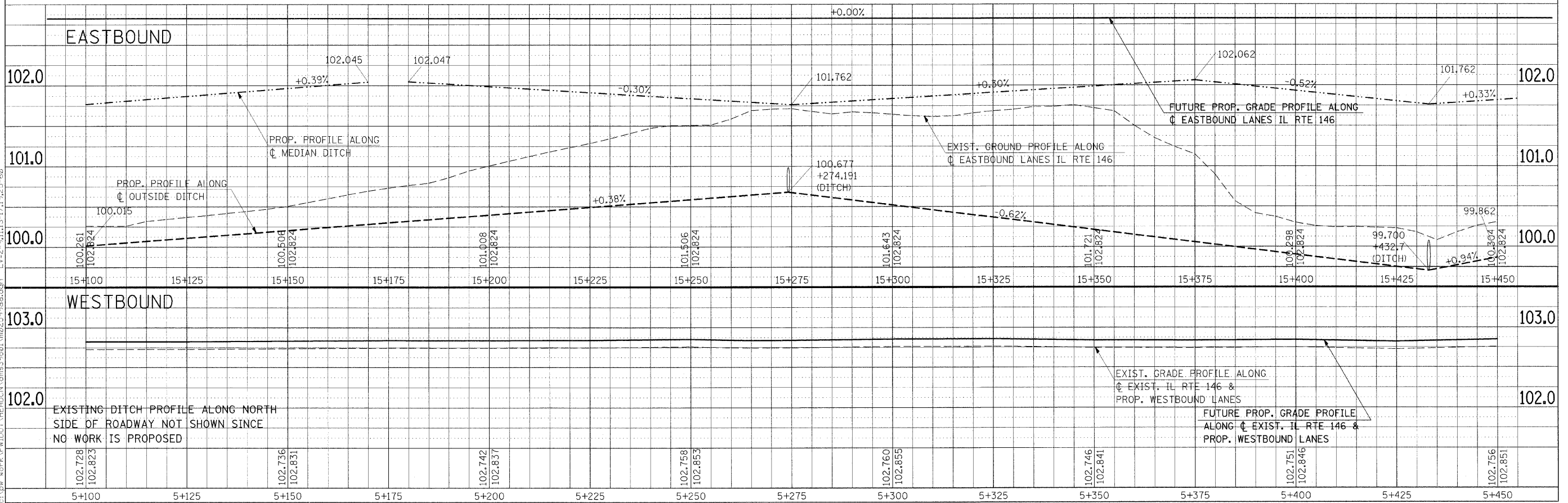

PLAN-PROFILE - STA 5+100 TO STA 5+450