

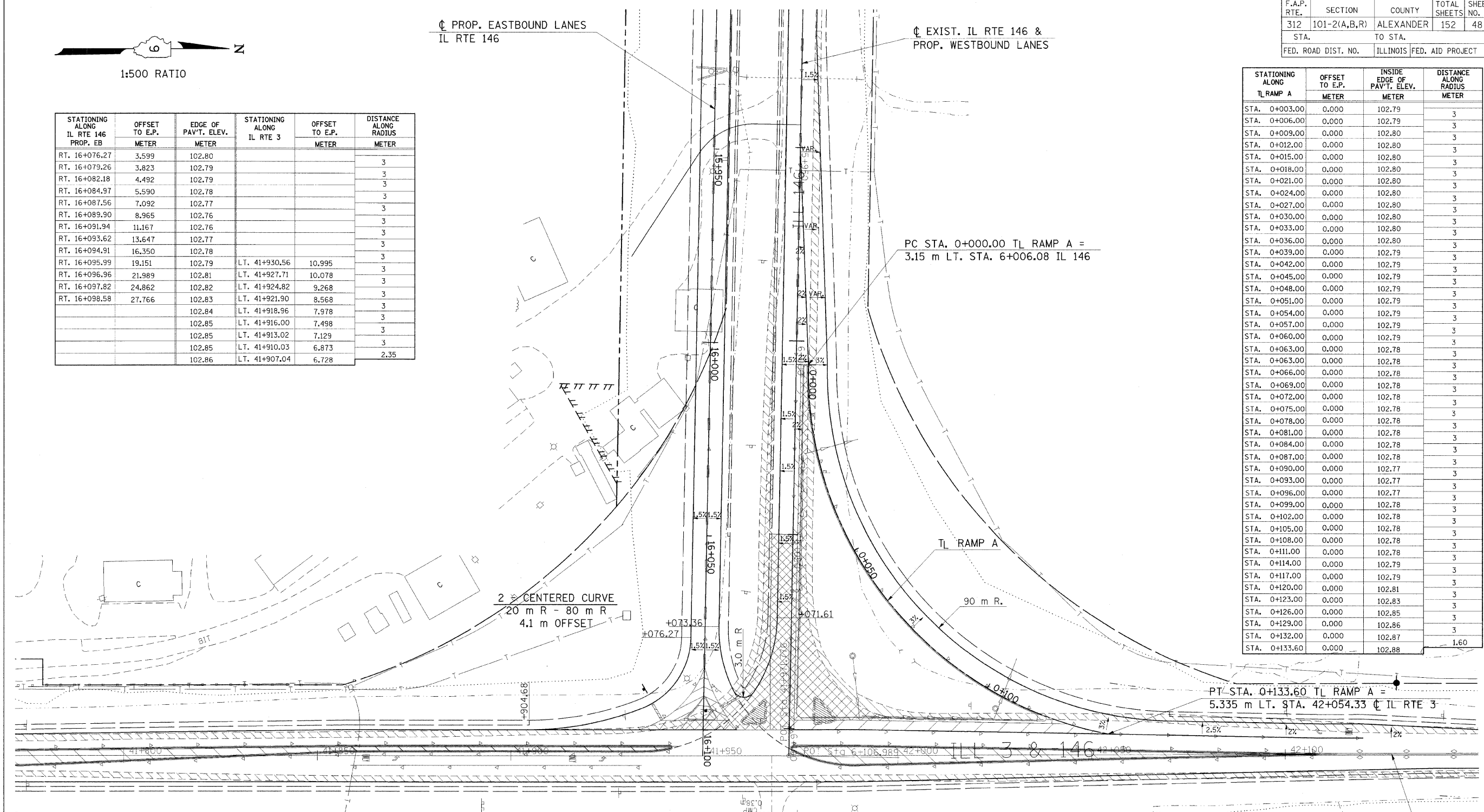

STATIONING ALONG IL RTE 146 PROP. EB	OFFSET TO E.P. METER	EDGE OF PAV'T. ELEV. METER	STATIONING ALONG IL RTE 3	OFFSET TO E.P. METER	DISTANCE ALONG RADIUS METER
RT. 16+076.27	3.599	102.80			3
RT. 16+079.26	3.823	102.79			3
RT. 16+082.18	4.492	102.79			3
RT. 16+084.97	5.590	102.78			3
RT. 16+087.56	7.092	102.77			3
RT. 16+089.90	8.965	102.76			3
RT. 16+091.94	11.167	102.76			3
RT. 16+093.62	13.647	102.77			3
RT. 16+094.91	16.350	102.78			3
RT. 16+095.99	19.151	102.79	LT. 41+930.56	10.995	3
RT. 16+096.96	21.989	102.81	LT. 41+927.71	10.078	3
RT. 16+097.82	24.862	102.82	LT. 41+924.82	9.268	3
RT. 16+098.58	27.766	102.83	LT. 41+921.90	8.568	3
		102.84	LT. 41+918.96	7.978	3
		102.85	LT. 41+916.00	7.498	3
		102.85	LT. 41+913.02	7.129	3
		102.85	LT. 41+910.03	6.873	3
		102.86	LT. 41+907.04	6.728	2.35

F.A.P. RTE.	SECTION	COUNTY	TOTAL SHEETS	SHEET NO.
312	101-2(A,B,R)	ALEXANDER	152	48
STA.		TO STA.		
FED. ROAD DIST. NO.		ILLINOIS FED. AID PROJECT		

STATIONING ALONG TL RAMP A	OFFSET TO E.P. METER	INSIDE EDGE OF PAV'T. ELEV. METER	DISTANCE ALONG RADIUS METER
STA. 0+003.00	0.000	102.79	3
STA. 0+006.00	0.000	102.79	3
STA. 0+009.00	0.000	102.80	3
STA. 0+012.00	0.000	102.80	3
STA. 0+015.00	0.000	102.80	3
STA. 0+018.00	0.000	102.80	3
STA. 0+021.00	0.000	102.80	3
STA. 0+024.00	0.000	102.80	3
STA. 0+027.00	0.000	102.80	3
STA. 0+030.00	0.000	102.80	3
STA. 0+033.00	0.000	102.80	3
STA. 0+036.00	0.000	102.80	3
STA. 0+039.00	0.000	102.79	3
STA. 0+042.00	0.000	102.79	3
STA. 0+045.00	0.000	102.79	3
STA. 0+048.00	0.000	102.79	3
STA. 0+051.00	0.000	102.79	3
STA. 0+054.00	0.000	102.79	3
STA. 0+057.00	0.000	102.79	3
STA. 0+060.00	0.000	102.79	3
STA. 0+063.00	0.000	102.78	3
STA. 0+066.00	0.000	102.78	3
STA. 0+069.00	0.000	102.78	3
STA. 0+072.00	0.000	102.78	3
STA. 0+075.00	0.000	102.78	3
STA. 0+078.00	0.000	102.78	3
STA. 0+081.00	0.000	102.78	3
STA. 0+084.00	0.000	102.78	3
STA. 0+087.00	0.000	102.78	3
STA. 0+090.00	0.000	102.77	3
STA. 0+093.00	0.000	102.77	3
STA. 0+096.00	0.000	102.77	3
STA. 0+099.00	0.000	102.78	3
STA. 0+102.00	0.000	102.78	3
STA. 0+105.00	0.000	102.78	3
STA. 0+108.00	0.000	102.78	3
STA. 0+111.00	0.000	102.78	3
STA. 0+114.00	0.000	102.79	3
STA. 0+117.00	0.000	102.79	3
STA. 0+120.00	0.000	102.81	3
STA. 0+123.00	0.000	102.83	3
STA. 0+126.00	0.000	102.85	3
STA. 0+129.00	0.000	102.86	3
STA. 0+132.00	0.000	102.87	3
STA. 0+133.60	0.000	102.88	1.60



STATIONING ALONG ILL 146 EB	OFFSET TO E.P. METER	MEDIAN EDGE OF PAV'T. ELEV. METER	DISTANCE ALONG EDGE METER
LT. 16+073.36	3.602	102.80	3
LT. 16+076.36	3.730	102.79	3
LT. 16+079.33	4.115	102.79	3
LT. 16+082.26	4.752	102.78	3
LT. 16+085.13	5.639	102.77	3
LT. 16+087.90	6.767	102.75	3
LT. 16+089.80	7.703	102.74	2.116

STATIONING ALONG ILL 146 WB	OFFSET TO E.P. METER	MEDIAN EDGE OF PAV'T. ELEV. METER	DISTANCE ALONG EDGE METER
RT. 6+071.61	3.658	102.80	3
RT. 6+074.60	3.787	102.80	3
RT. 6+077.58	4.172	102.79	3
RT. 6+080.51	4.809	102.78	3
RT. 6+083.37	5.695	102.77	3
RT. 6+086.15	6.824	102.75	2.333
RT. 6+088.82	8.186	102.73	
RT. 6+090.82	9.400	102.73	

STATIONING ALONG ILL RTE 3	OFFSET TO OUTSIDE EDGE OF SHOULDER METER	OUTSIDE EDGE OF SHOULDER ELEVATION METER	DISTANCE ALONG EDGE METER
LT. 41+973.17	9.097	102.81	3
LT. 41+976.17	9.097	102.81	3
LT. 41+979.17	9.097	102.81	3
LT. 41+982.17	9.096	102.81	3
LT. 41+985.17	9.096	102.81	3
LT. 41+988.17	9.096	102.81	3
LT. 41+991.17	9.050	102.81	3
LT. 41+994.17	8.987	102.811	3
LT. 41+997.17	8.925	102.812	3
LT. 42+000.17	8.862	102.813	3
LT. 42+003.17	8.800	102.814	3
LT. 42+006.17	8.738	102.815	3
LT. 42+009.17	8.675	102.816	3

STATIONING ALONG ILL RTE 3	OFFSET TO OUTSIDE EDGE OF SHOULDER METER	OUTSIDE EDGE OF SHOULDER ELEVATION METER	DISTANCE ALONG EDGE METER
LT. 42+010.00	8.658	102.816	3
LT. 42+012.17	8.611	102.817	3
LT. 42+015.17	8.549	102.818	3
LT. 42+018.17	8.487	102.819	3
LT. 42+021.17	8.425	102.821	3
LT. 42+024.17	8.363	102.821	3
LT. 42+027.17	8.301	102.821	3
LT. 42+030.17	8.239	102.822	3
LT. 42+033.17	8.177	102.823	3
LT. 42+036.17	8.115	102.824	3
LT. 42+039.17	8.053	102.825	0.550
LT. 42+039.72	8.038	102.825	

\*DATE-TIME\*  
 \*DGN-SPEC\*  
 \*REF-geom1\*  
 \*REF-geom2\*  
 \*REF-

CL FAP 14 (ILL RTE 3)