

F.A.P. RTE.	SECTION	COUNTY	TOTAL SHEETS	SHEET NO.
312	101-2(A,B,R)	ALEXANDER	152	57
STA.		TO STA.		
FED. ROAD DIST. NO.		ILLINOIS	FED. AID PROJECT	

NOTE: CONSTRUCTION LIMITS ON NORTH SIDE HAVE BEEN OMITTED FOR CLARITY.

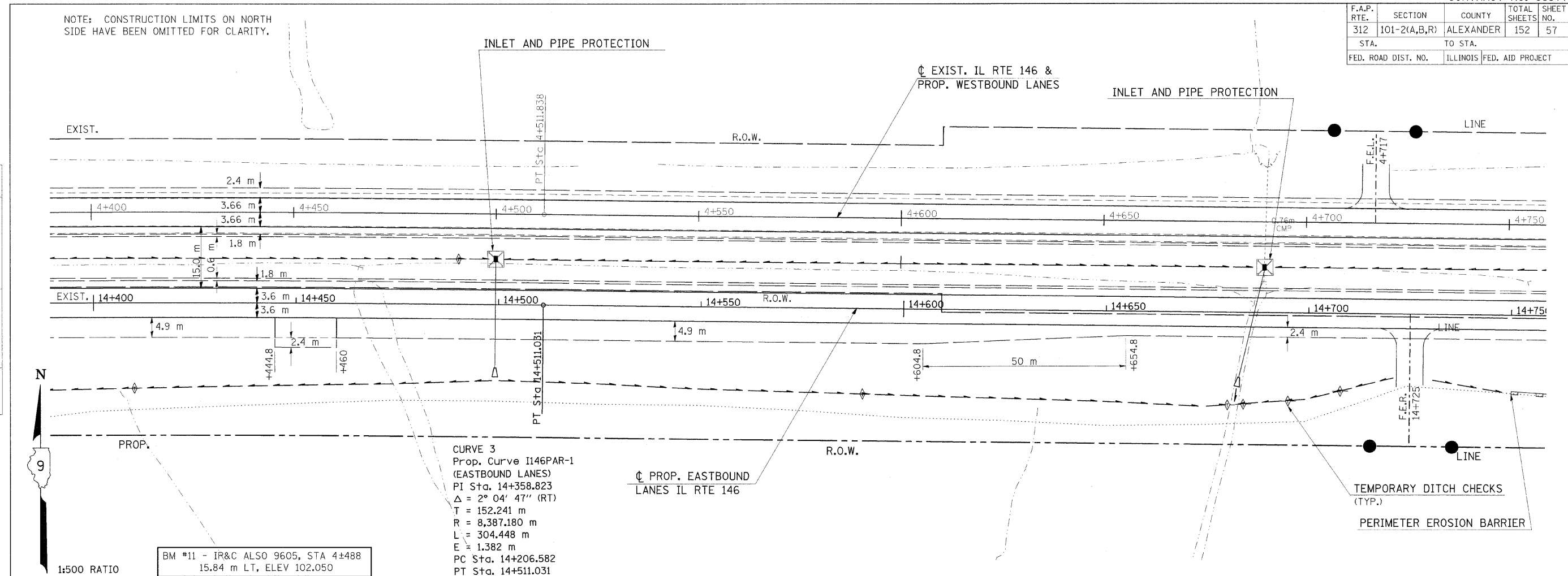

CURVE 3
 Prop. Curve I146PAR-1
 (EASTBOUND LANES)
 PI Sta. 14+358.823
 $\Delta = 2^\circ 04' 47''$ (RT)
 T = 152.241 m
 R = 8,387.180 m
 L = 304.448 m
 E = 1.382 m
 PC Sta. 14+206.582
 PT Sta. 14+511.031

BM #11 - IR&C ALSO 9605, STA 4+488
 15.84 m LT, ELEV 102.050

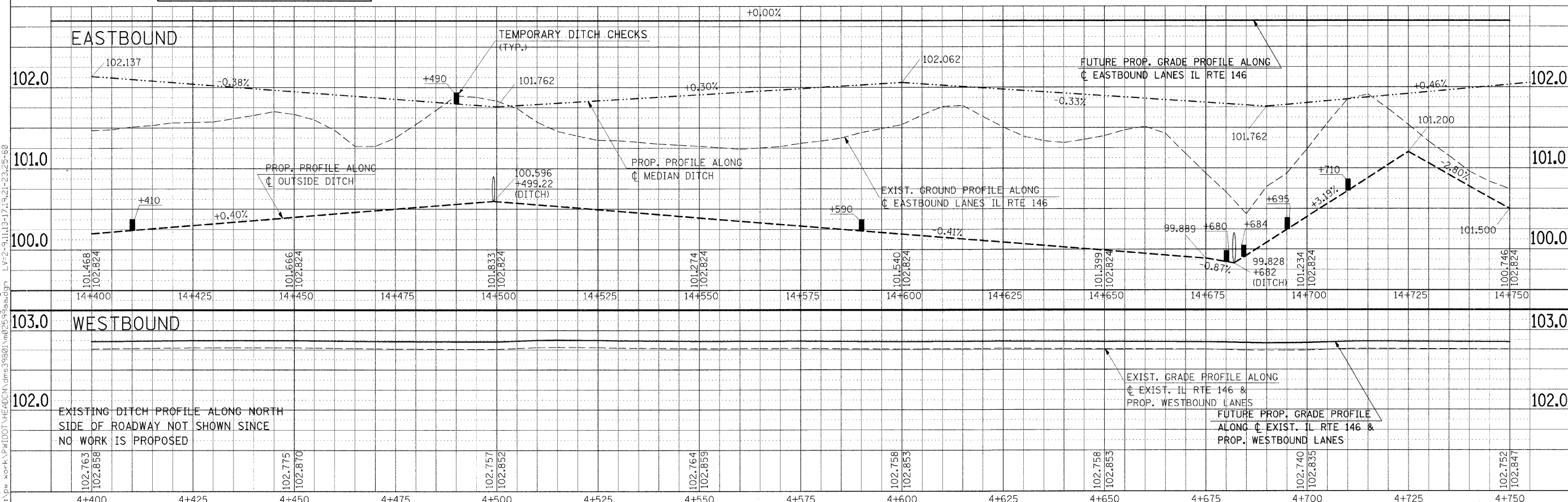

FINAL SURVEY	BY	DATE
SURVEYED		
PLOTTED		
NOTE BOOK TEMPLATE		
AREAS CHECKED		
NO.		

Friday, November 21, 2008 @ 11:48:57 AM
 c:\pwork\p1001\HEADCON\m02599pl.dgn LV=2-23,25-60,62-63
 c:\pwork\p1001\HEADCON\m02599pl.dgn LV=1-9,21-53
 c:\pwork\p1001\HEADCON\m02599pl.dgn LV=2-9,11,13-17,19,21-23,25-60