

STATE OF ILLINOIS
DEPARTMENT OF TRANSPORTATION

ROUTE NO.	SECTION	COUNTY	TOTAL SHEETS	SHEET NO.	SHEET NO. 7 11 SHEETS
F.A.P. 312	101B-1	ALEXANDER	152	89	
ILLINOIS		FED. AID PROJECT-			

Contract No. 98577

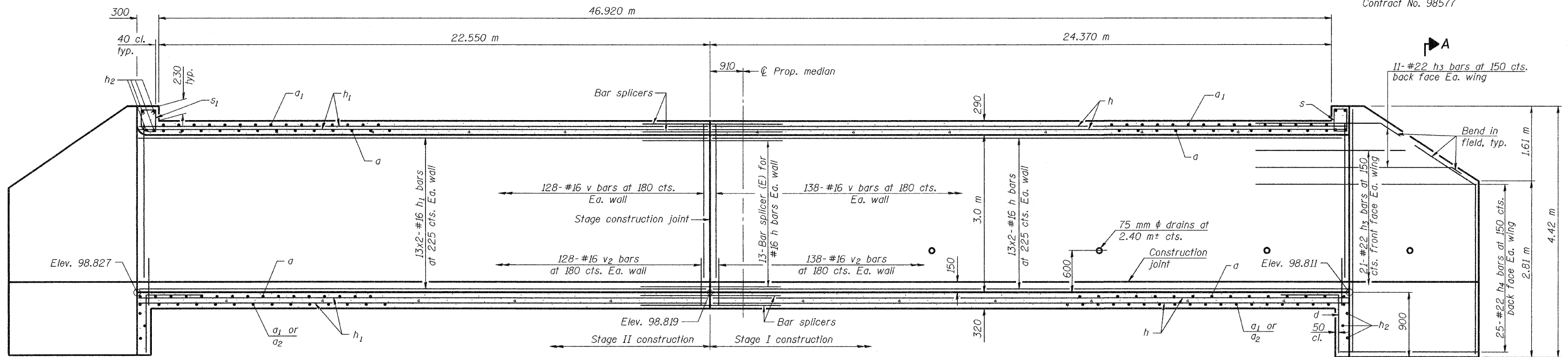

LONGITUDINAL SECTION

Tilt hook of a bars if necessary for 40 mm min. cl.

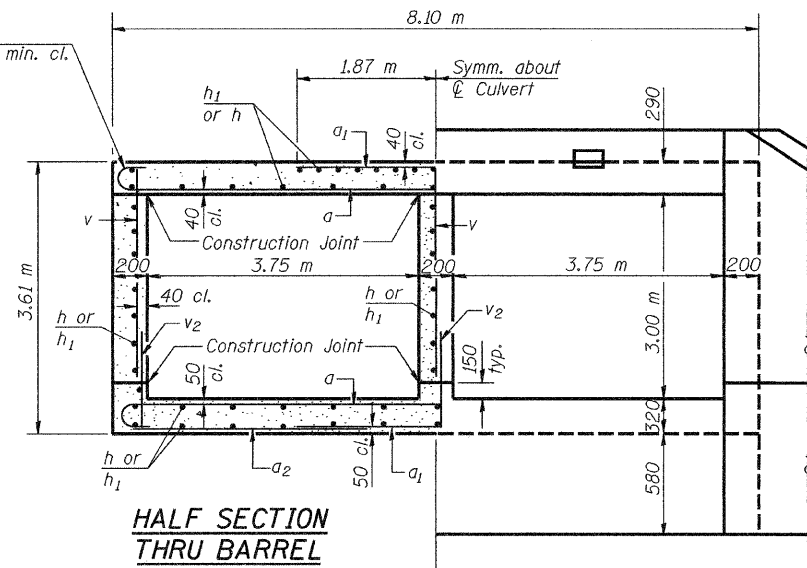

HALF SECTION THRU BARREL

HALF END ELEVATION

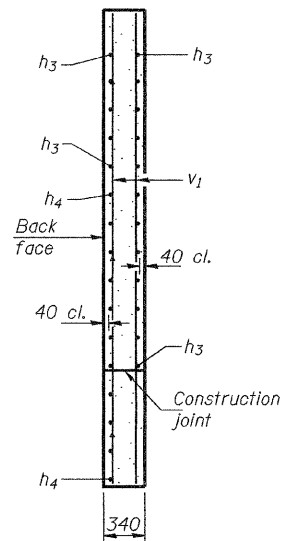

SECTION A-A

MIN. BAR LAPS
#16 bars = 550

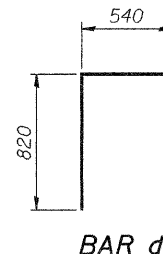

BAR d

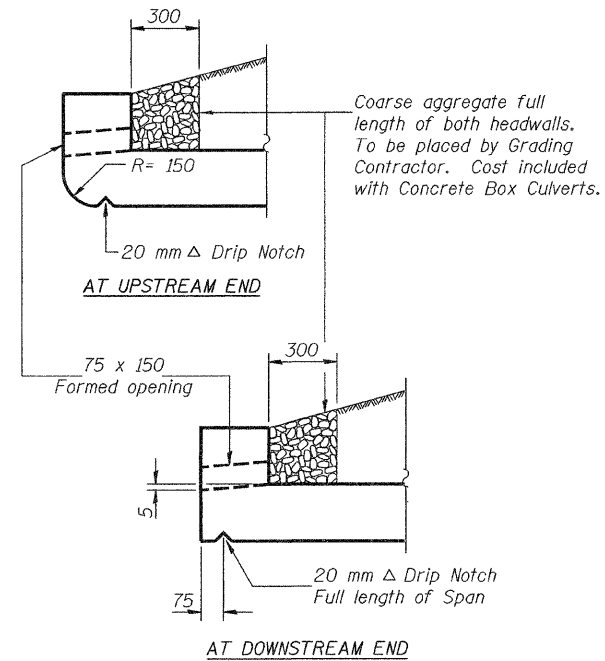

DRAIN DETAIL

BILL OF MATERIAL

Bar	No.	Size	Length (m)	Shape
a	592	#19	8.40	U
a1	500	#22	3.74	—
a2	170	#16	2.75	—
d	56	#16	1.36	L
h	280	#16	12.56	—
h1	280	#16	11.65	—
h2	14	#19	8.18	—
h3	128	#22	2.40	—
h4	100	#22	5.20	—
s	28	#13	1.55	□
s1	28	#13	1.50	□
v	802	#16	3.06	—
v1	16	#16	4.32	—
v2	802	#16	0.85	—
Concrete Box Culverts		m ³	347.6	
Reinforcement Bars, Epoxy Coated		kg	36000	

Bars indicated thus 13 x 2-#16 etc. indicates 13 lines of bars with 2 lengths per line. See sheet 8 of 11 for bar splicer details. All reinforcement bars shall be epoxy coated.

DESIGNED	J.S.B.
CHECKED	C.C.C.
DRAWN	h.t. duong R.T.D.
CHECKED	J.S.B./C.C.C.

EXAMINED *Thomas J. Domagala*
ENGINEER OF BRIDGE DESIGN
PASSED *Ralph E. Anderson*
ENGINEER OF BRIDGES AND STRUCTURES

Jan 26, 2009

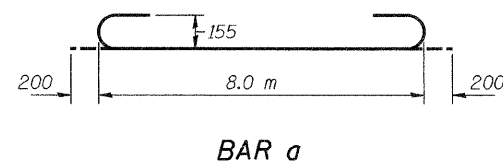

BAR a

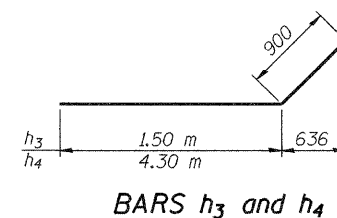

BARS h3 and h4

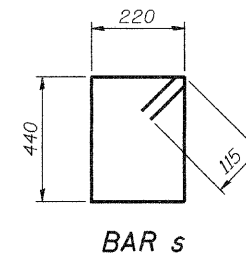

BAR s

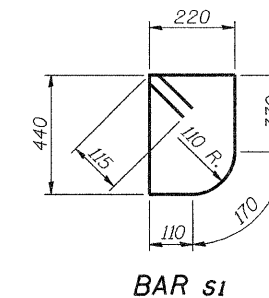

BAR s1

CULVERT DETAILS
F.A.P. RTE. 312 - SECTION 101B-1
ALEXANDER COUNTY
STATION 5+699.435
STRUCTURE NO. 002-2002