

| F.A.S. | SECTION | COUNTY | TOTAL SHEETS | SHEET NO. |
|--------------------------------|----------------|--------------------|--------------|-----------|
| 880 | 06-00097-00-FP | HAMILTON | 25 | 4 |
| FED. ROAD DIST. NO. 9 ILLINOIS | | BELLE PRAIRIE ROAD | | |
| PROJECT # SR-880106 | | CONTRACT # 99339 | | |
| LEC JOB # H081003M | | | | |

323 W. 3RD ST.
P.O. BOX 160
MT. CARMEL, IL
62863
PHONE:
(618)-262-8651
FAX:
(618)-263-3327

405 W STATE ST.
SUITE1
PRINCETON, IN
47670
PHONE:
(812)-386-7611
FAX:
(812)-385-2812



PROFESSIONAL DESIGN FIRM
LAND SURVEY & PROFESSIONAL ENGINEERING CORPORATION
184-00887
(62-032435)(35-002769)



AARON M. MEFFORD
NAME
SIGNATURE
12-17-08
DATE
11-30-09
EXPIRES

F.A.S. 880 (CH 8)
BELLE PRAIRIE ROAD
SECTION 06-00097-00-FP
HAMILTON COUNTY, ILLINOIS

SHEET TITLE:

EROSION CONTROL PLAN

SCALE: VARIES
BY: AMM
DATE: 11/08
REV:

4 OF 25 SHEETS

SHEET NO. 4

P.I. STA= 209+21.61
 $\Delta = 00^{\circ}13'01''$ RT

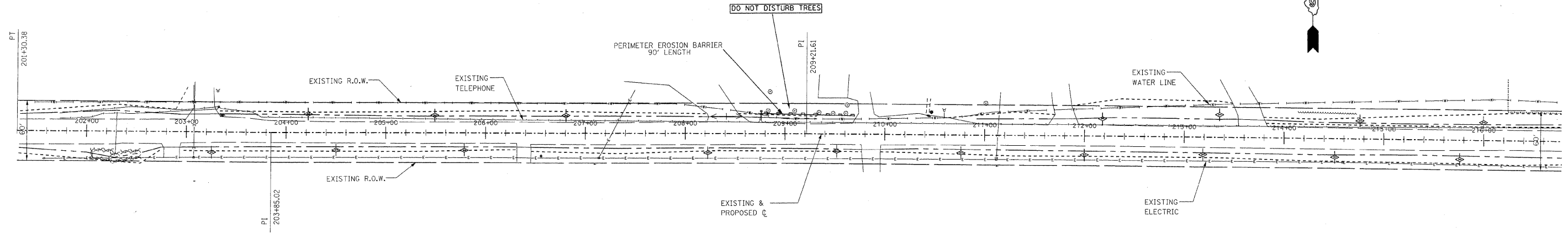

P.I. STA= 203+85.02
 $\Delta = 00^{\circ}35'10''$ LT

- ⊕ INLET PROTECTION
- ⊕ TEMPORARY DITCH CHECK
- ⊕ PERIMETER EROSION BARRIER

P.I. STA= 229+37.86
 $\Delta = 00^{\circ}22'50''$ RT

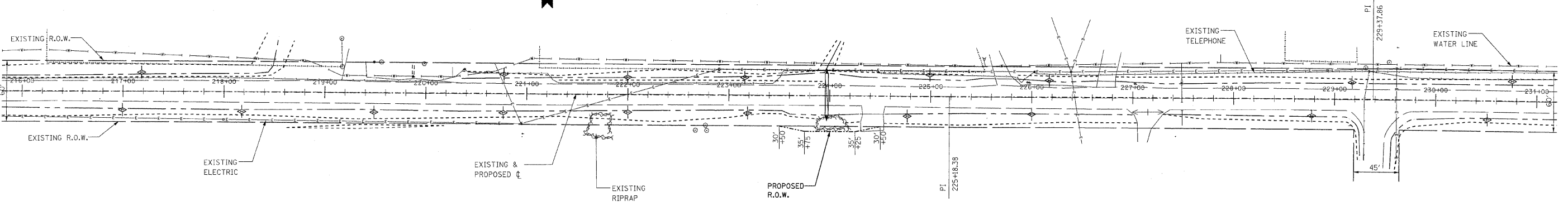

P.I. STA= 225+18.38
 $\Delta = 00^{\circ}08'44''$ LT

- ⊕ INLET PROTECTION
- ⊕ TEMPORARY DITCH CHECK
- ⊕ PERIMETER EROSION BARRIER

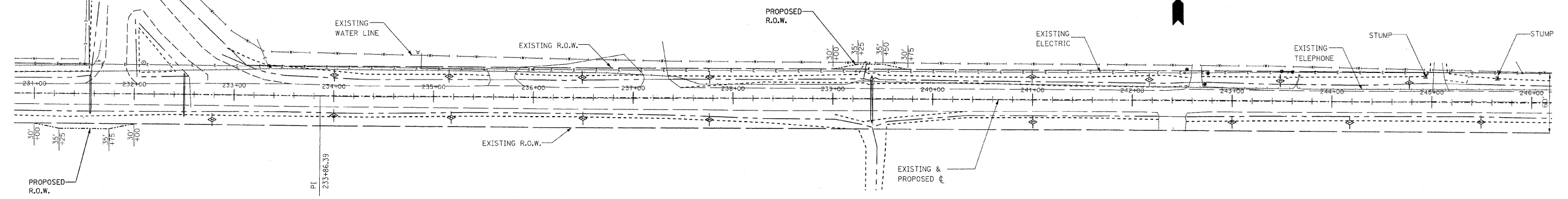

P.I. STA= 233+86.39
 $\Delta = 00^{\circ}07'37''$ LT

- ⊕ INLET PROTECTION
- ⊕ TEMPORARY DITCH CHECK
- ⊕ PERIMETER EROSION BARRIER