

255+70 SIDEROAD

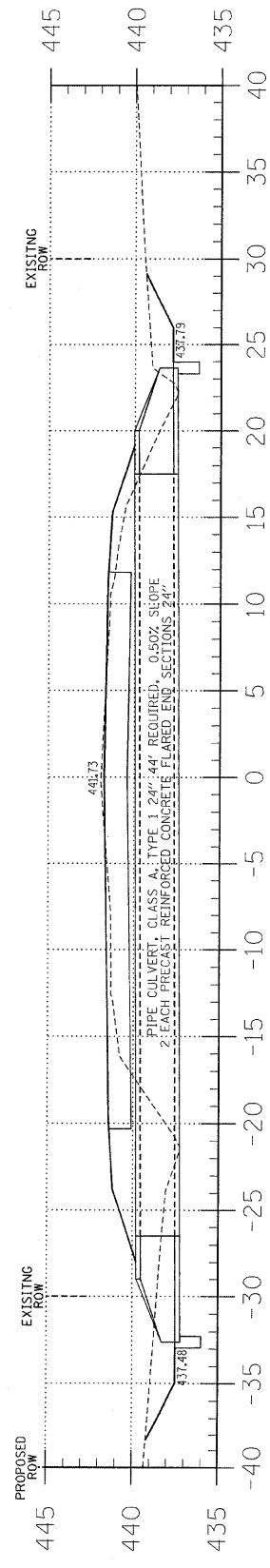

281+08

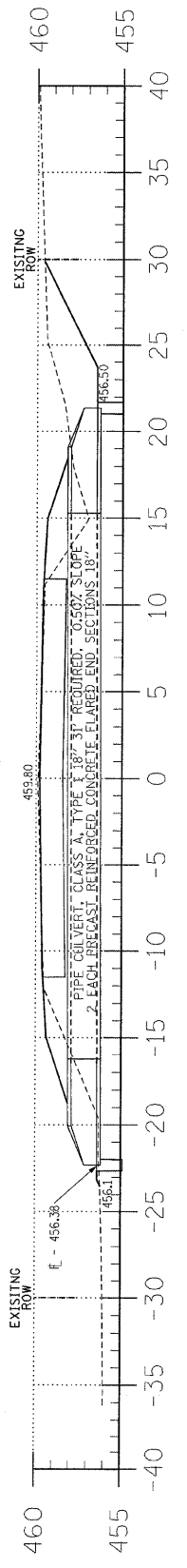

262+84

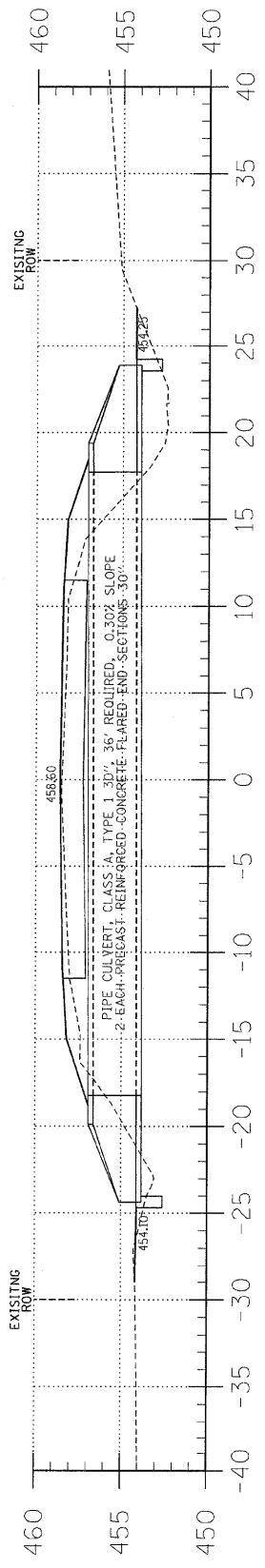

253+70

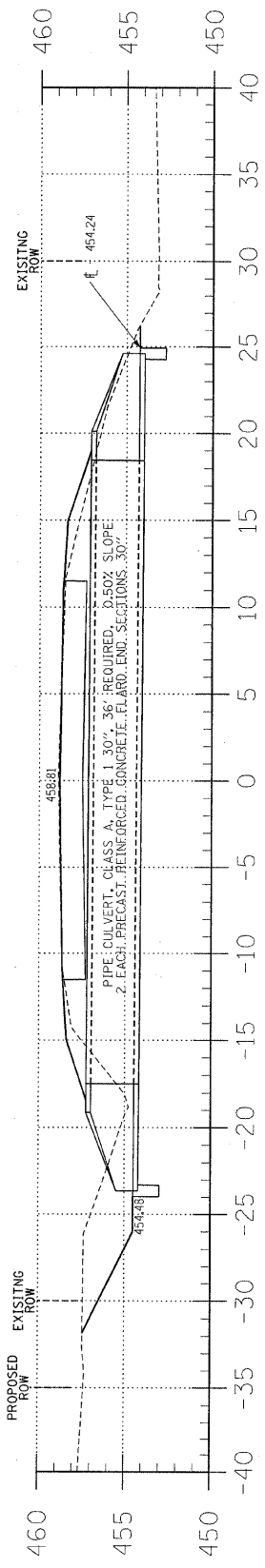

239+39

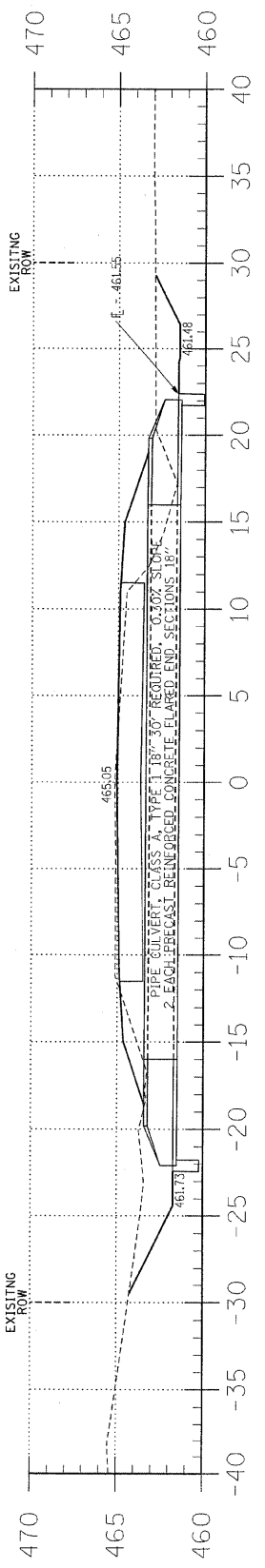

232+56

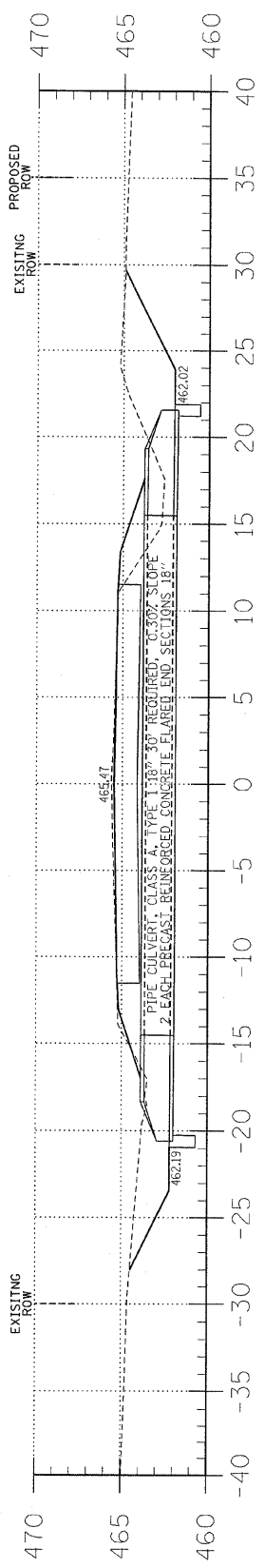

231+56

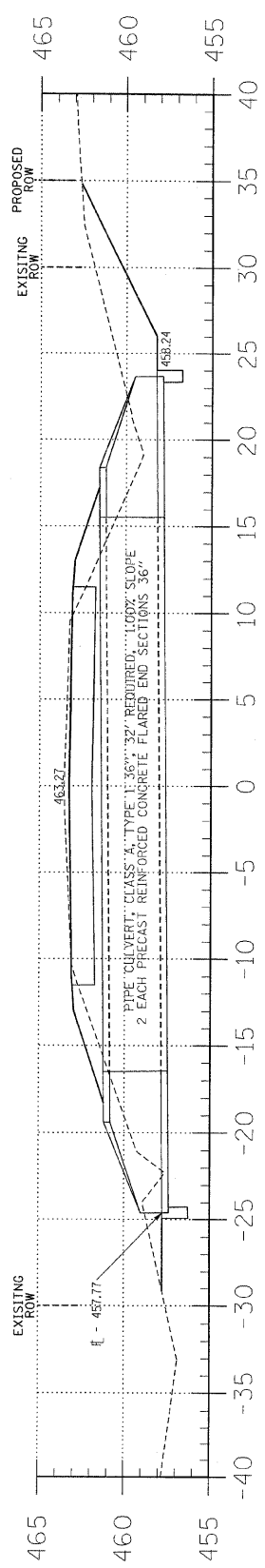

223+97

ACROSS ROAD PIPE CULVERTS

F.A.S.	SECTION	COUNTY	TOTAL SHEETS	SHEET NO.
880	06-00097-00-FP	HAMILTON	25	24
FED. ROAD DIST. NO. 5	ILLINOIS	BELLE PRAIRIE ROAD	PROJECT# SR-880(106) CONTRACT# 99339	
LEC JOB # H06L003NM				

323 W. 3RD ST.  
P.O. BOX 160  
MT. CARMEL, IL  
62863  
PHONE:  
(618)-262-8651  
FAX:  
(618)-263-3327

405 W. STATE ST  
SUITE 1  
PRINCETON, IN  
47670  
PHONE:  
(812)-386-7611  
FAX:  
(812)-385-2812



PROFESSIONAL  
DESIGN FIRM  
LAND SURVEY &  
ENGINEERING  
CORPORATION  
184-00887  
(62-032436)(35-002769)

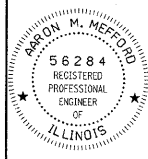

AARON M. MEFFORD  
NAME  
SIGNATURE  
12-17-08  
DATE  
11-30-09  
EXPIRES

F.A.S. 880 (CH 8)  
BELLE PRAIRIE ROAD  
SECTION 06-00097-00-FP  
HAMILTON COUNTY, ILLINOIS

SHEET TITLE:

CROSS-SECTIONS

SCALE: 1" = 5'  
BY: AMM  
DATE: 11/9/08  
REV:

24 OF 25 SHEETS

SHEET NO. 24