

DATE	
BY	
SURVEYED	
PLOTTED	
TEMPLATE	
NOTE BOOK	
AREAS CHECKED	

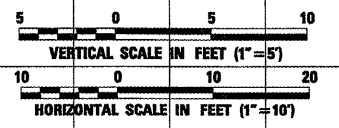

DATE	
BY	
SURVEYED	
PLOTTED	
TEMPLATE	
NOTE BOOK	
AREAS CHECKED	

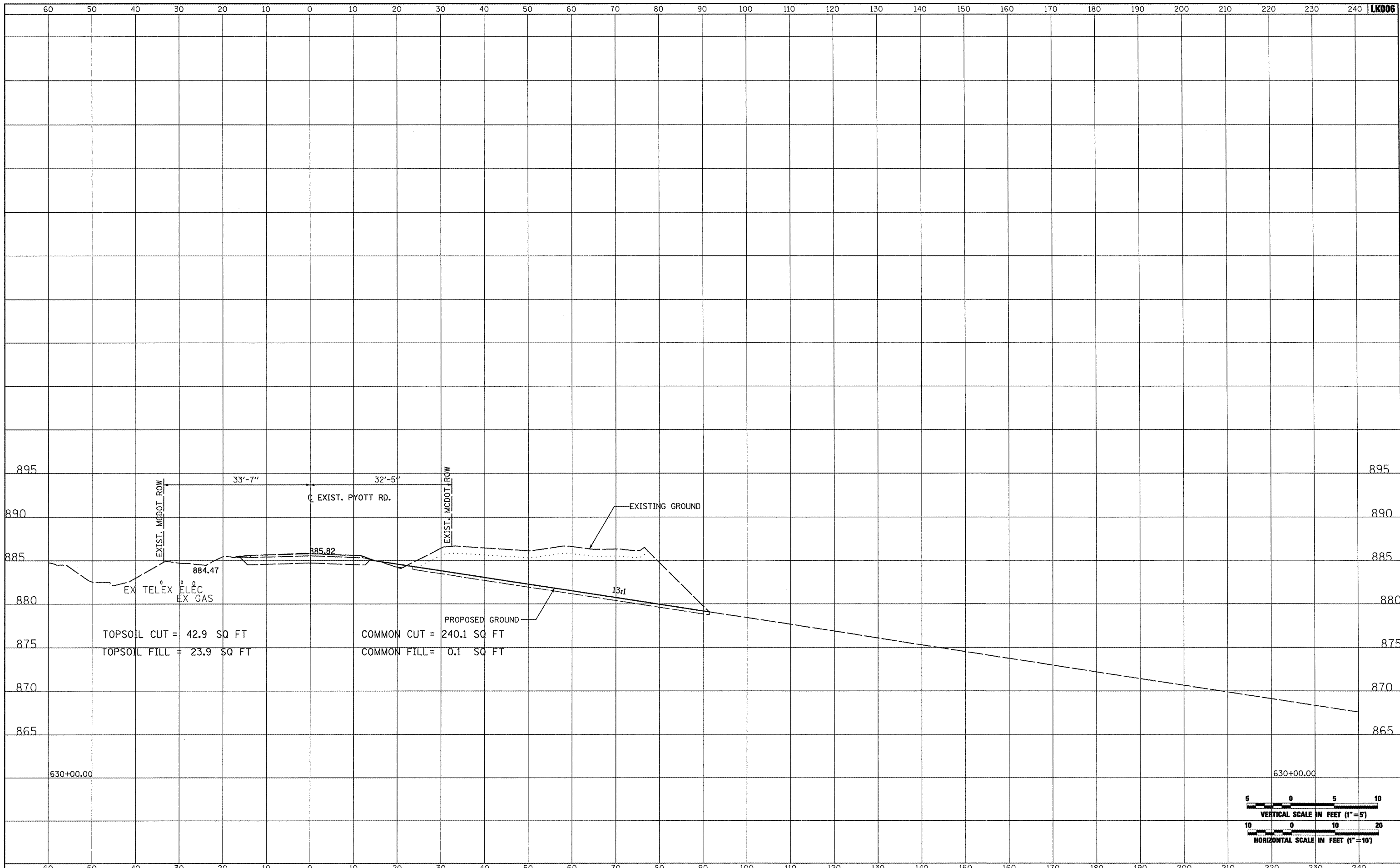

FILE NAME =	USER NAME = B1a1n01219	DESIGNED - BLB	REVISED -	VILLAGE OF LAKE IN THE HILLS, ILLINOIS	CROSS SECTIONS EXISTING PYOTT ROAD	COUNTY	TOTAL SHEETS	SHEET NO.
\\05jobs\00841\05b8021\civil part b\sheets\CROSSSECTIONS_Cur\Pylt.sh	DRAWN - CBP	REVISED -	MCHENRY			143	108	
PLOT SCALE = 20.0000' / IN.	CHECKED - LDH	REVISED -	FEDERAL AIP, NO. 3-17-012-B10 ILLINOIS					
PLOT DATE = 02/25/2009, 01:54 PM	DATE - 05/21/08	REVISED -	IDA NO. 3CK-3807					
SCALE: AS SHOWN		STA. 630+00.00 TO STA. 630+00.00						