

STRUCTURE SCHEDULE

NUMBER	LOCATION	TYPE	℄ ELEV.	LID OR GRATE ELEV.	REMARK
18	633+90, LT 53'	MANHOLE, SPL., 2' DIA.	579.77'	583.07'	AR751570
19	633+10.86, RT 53'	MANHOLE, SPL., 2' DIA.	580.30'	583.02'	AR751570
20	636+67.27, RT 16.2'	EXISTING CATCH BASIN	EXTG = 570.96'	EXTG = 575.54'	REMOVE EXISTING, AR751906
21	636+76.41, RT 55'	MANHOLE, 4' DIA.	N = 570.81' MEET EXTG S = 570.76'	583.08'	AR751540
22	34+32.6, LT 155'	INLET SPECIAL (SINGLE)	MEET EXTG = 570.11'	579.33'	NEENAH R-3475, AR751415
23	884+25.63, LT 46.37'	EXISTING MANHOLE	MEET EXTG, 573.86'	EXTG = 580.34' PROP = 580.58'	ADJUST EXISTING, AR751945
24	884+25.08, RT 48.51'	EXISTING MANHOLE	MEET EXTG, 573.86'	EXTG = 580.02' PROP = 580.09'	ADJUST EXISTING, AR751945

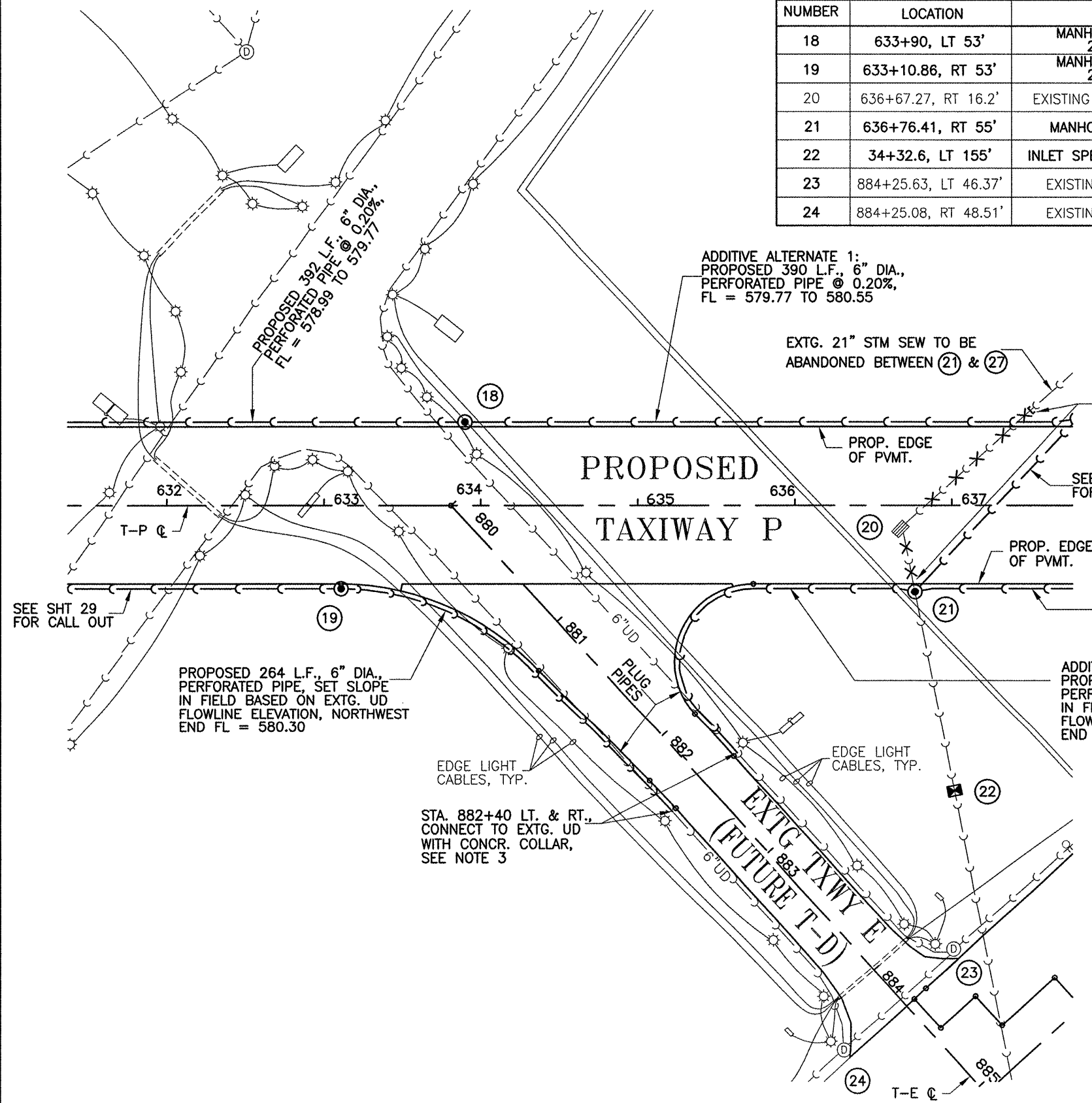
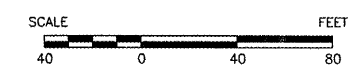

LEGEND:

- EXTG EDGE LIGHT
- EXTG GUIDANCE SIGN
- EXTG ELECTRICAL CABLE
- EXTG STORM SEWER, FIELD TILE OR UNDERDRAIN
- EXTG INLET
- EXTG OUTLET
- EXTG STORM MANHOLE
- EXTG SANITARY MANHOLE
- EXTG DRAINAGE DITCH
- EXTG CONDUIT OR DUCT BANK
- PROPOSED MANHOLE
- PROPOSED INLET
- PROPOSED FLARED END SECTION
- PROPOSED STORM SEWER, SANITARY SEWER OR UNDERDRAIN
- PROPOSED / EXISTING STRUCTURE NUMBER
- PROPOSED PIPE REMOVAL

GENERAL DRAINAGE NOTES:

1. SEE PLAN & PROFILE SHEETS FOR THE LOCATION OF EXISTING UNDERGROUND UTILITIES. CONTRACTOR SHALL HAND DIG AROUND ALL EXISTING UNDERGROUND UTILITIES. CONTRACTOR SHALL BE RESPONSIBLE FOR COST OF REPAIRING ALL DAMAGE UTILITIES.
2. OUTLET PROPOSED UNDER DRAIN INTO EXISTING / PROPOSED STM. SEW. PER DETAIL.
3. CONTRACTOR TO EXCAVATE AND EXPOSE EXISTING STORM PIPES, ELEC. CABLES, AND ELEC. DUCT BANKS AT PROPOSED MANHOLE, INLET, AND PIPE CROSSING LOCATIONS TO FIELD VERIFY VERTICAL LOCATIONS OF EXISTING UTILITIES. ENGINEER MAY ADJUST SLOPES AND TIE-INS AT THE TIME OF CONSTRUCTION AS REQUIRED.
4. THE LOCATIONS OF THE EXISTING UNDERDRAINS SHOWN ON THESE DRAWINGS WERE TAKEN FROM AIRPORT RECORDS AND ARE APPROXIMATE. PRIOR TO ORDERING MATERIALS, THE CONTRACTOR SHALL EXCAVATE, EXPOSE, AND FIELD VERIFY THE HORIZONTAL LOCATION, VERTICAL LOCATION, AND SIZE OF THE EXISTING CLAY UNDERDRAINS. ELEVATIONS, SLOPES, AND PIPE SIZES SHALL BE ADJUSTED BY THE RESIDENT ENGINEER IN THE FIELD AT THE TIME OF CONSTRUCTION. THE COST OF THIS WORK SHALL BE INCLUDED IN THE CONTRACT UNIT RATES.
5. PLUG EXISTING PIPES TO BE ABANDONED IN PLACE. THE PLUGGING OF EXISTING PIPES TO BE ABANDONED IN PLACE SHALL BE ACCOMPLISHED WITH BRICKS AND GROUT (3,500 LBS. @ 28 DAY MIX) TO THE SATISFACTION OF THE RESIDENT ENGINEER. COST FOR PLUGGING EXISTING PIPES SHALL BE INCLUDED IN THE CONTRACT 701 UNIT PRICES. NO SEPARATE PAYMENT WILL BE MADE FOR THIS WORK.

G:\airport\A08T032 TP MID PVMT\DRAINAGE.dwg, 4/1/2009 8:14:09 AM, jefm