

TAXIWAY D, STA. 863+44 LEFT TO TAXIWAY E STA. 882+40 RIGHT UNDERDRAIN CENTERLINE PROFILE

QUAD CITY INTERNATIONAL AIRPORT
TAXIWAY P, PHASE II - MIDDLE PAVING
ILL. MLI-3854, QU008
SHEET 35 OF 82

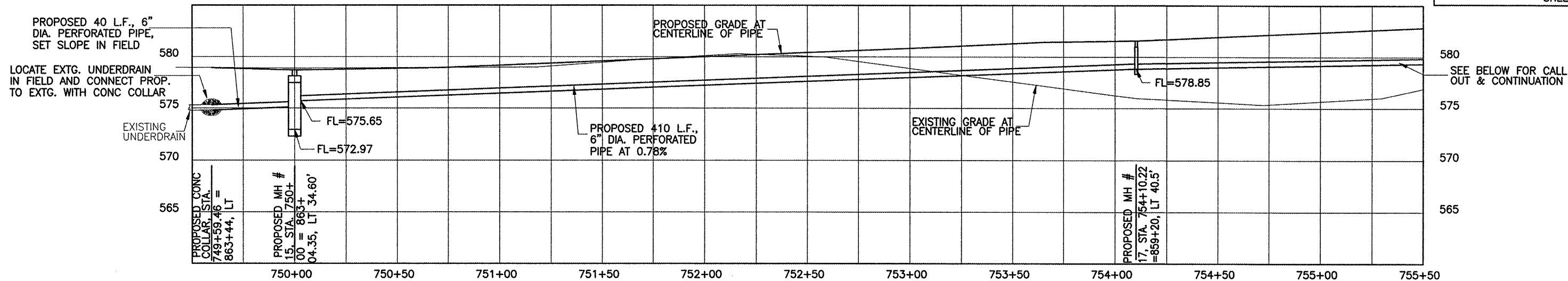

TAXIWAY D, STA. 863+44 LEFT TO TAXIWAY E STA. 882+40 RIGHT UNDERDRAIN CENTERLINE PROFILE, CONTINUED

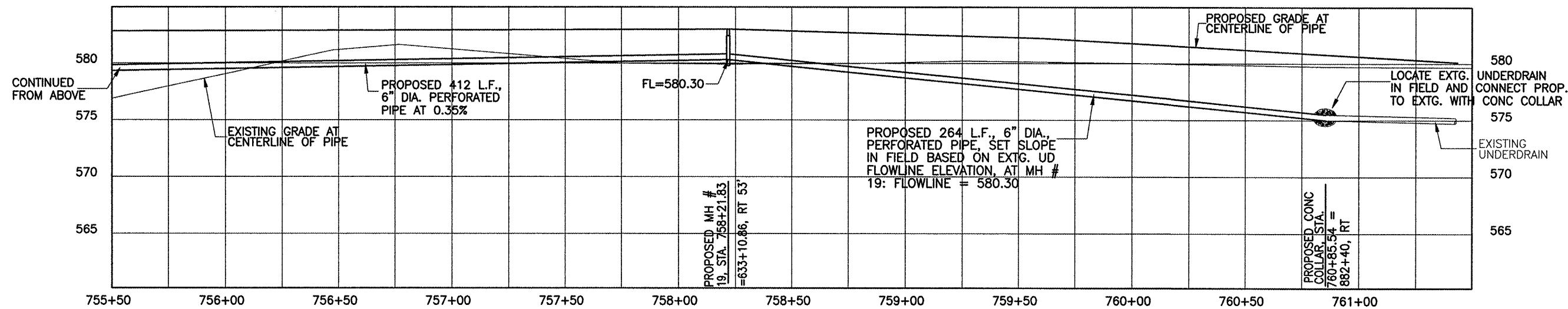

TAXIWAY E, STA. 882+40 LEFT TO RUNWAY 5-23, STA. 35+70 LEFT UNDERDRAIN CENTERLINE PROFILE

