

FEB 11, 2009 7:47 AM HAGL000382  
 I:\AIRPORTS\STLOUIS\817-08RWYD\MRPORT\SHEETS\R-702PNP.DWG - Layout1

SR085

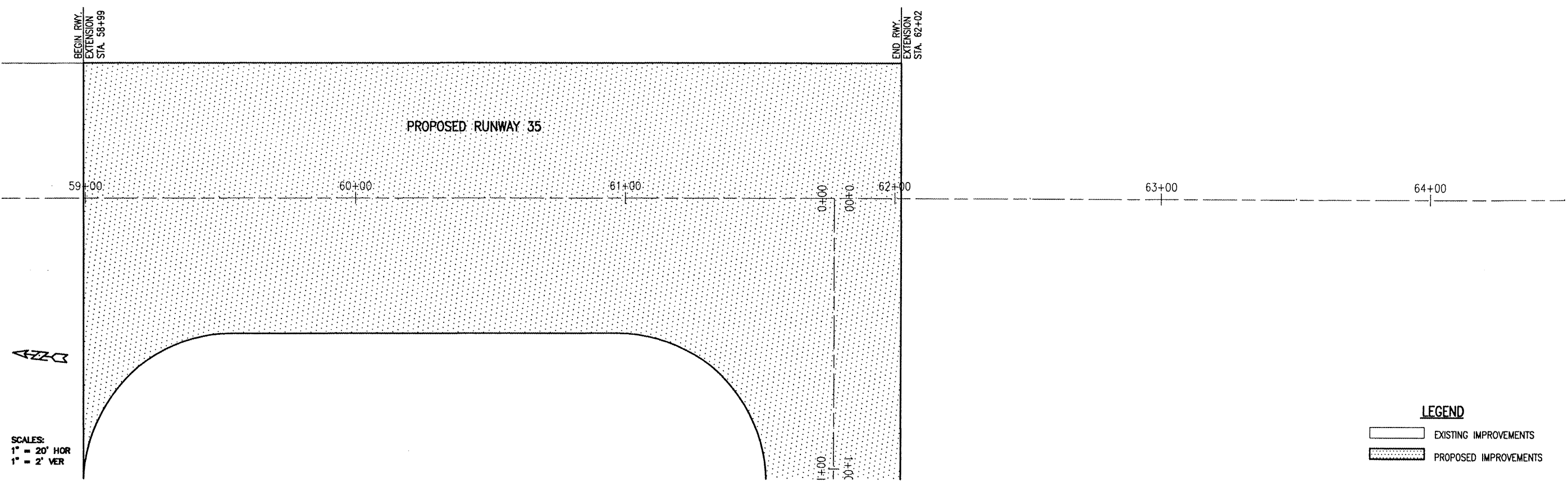

SCALES:  
 1" = 20' HOR  
 1" = 2' VER

**LEGEND**  
 [Dotted Pattern] EXISTING IMPROVEMENTS  
 [Solid Pattern] PROPOSED IMPROVEMENTS

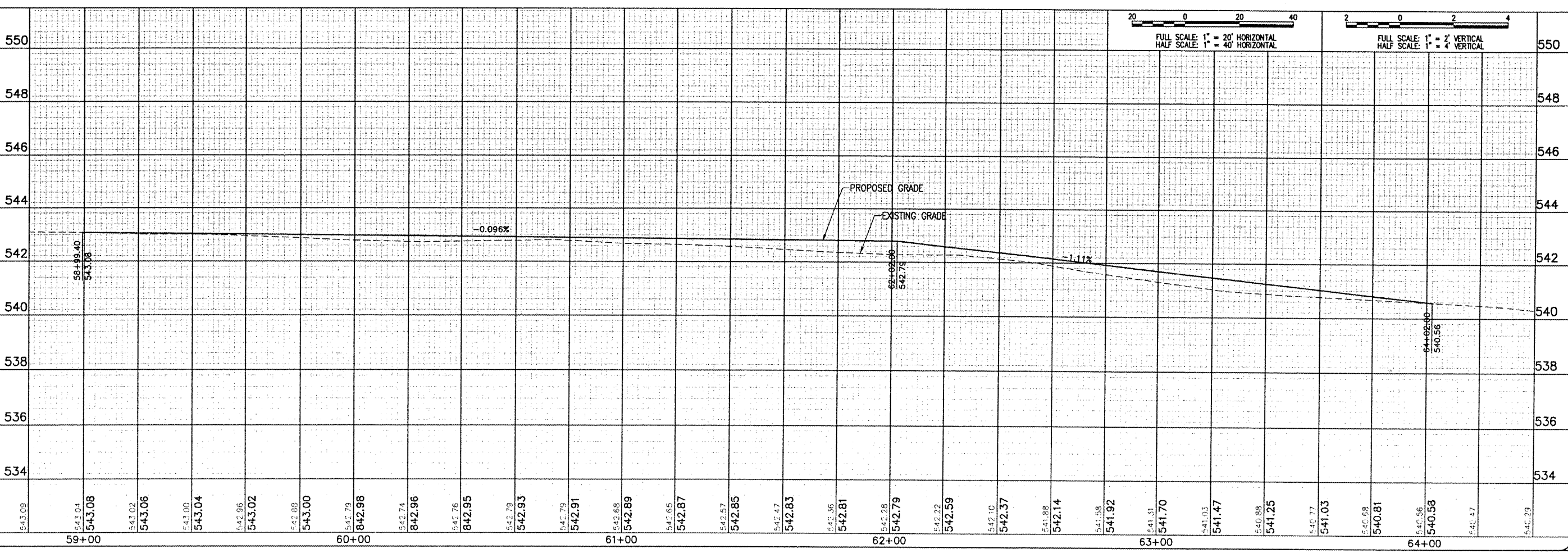

FULL SCALE: 1" = 20' HORIZONTAL  
 HALF SCALE: 1" = 40' HORIZONTAL  
 FULL SCALE: 1" = 2' VERTICAL  
 HALF SCALE: 1" = 4' VERTICAL

DATE	REVISION	BY

ST. LOUIS REGIONAL AIRPORT  
  
 EAST ALTON, ILLINOIS  
 A.I.P. PROJ.: 3-17-0002-B42  
 I.L. PROJ.: ALN-3825

IEL Project No. 83706RWYD_0800 Filename: R-702PNP.DWG Scale: H. 1" = 20' V. 1" = 2' Date: 06/21/08	LAYOUT: JFO 06/21/08 DRAWN: JFO 06/21/08 REVIEWED: CAH 07/11/08
---	---

**HANSON**  
 Hanson Professional Services Inc.  
 1525 South Sixth Street  
 Springfield, Illinois 62703-2885  
 Offices Nationwide

RUNWAY SAFETY  
 AREA IMPROVEMENTS  
 PROPOSED  
 PLAN AND PROFILE  
 FOR RUNWAY END 35