

STATE OF ILLINOIS  
DEPARTMENT OF TRANSPORTATION  
DIVISION OF HIGHWAYS

**PROPOSED  
HIGHWAY PLANS**

VARIOUS ROUTE  
SECTION DIST 8 SCOUR MITIGATION 2015-2

SCOUR MITIGATION  
VARIOUS COUNTY

C-98-032-15

F.A. RTE.	SECTION	COUNTY	TOTAL SHEETS	SHEET NO.
VARIOUS	DIST 8 MITIGATION 2015-2	VARIOUS	10	1
		ILLINOIS	CONTRACT NO. 76H80	

D-98-038-15

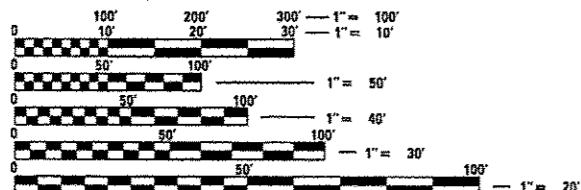
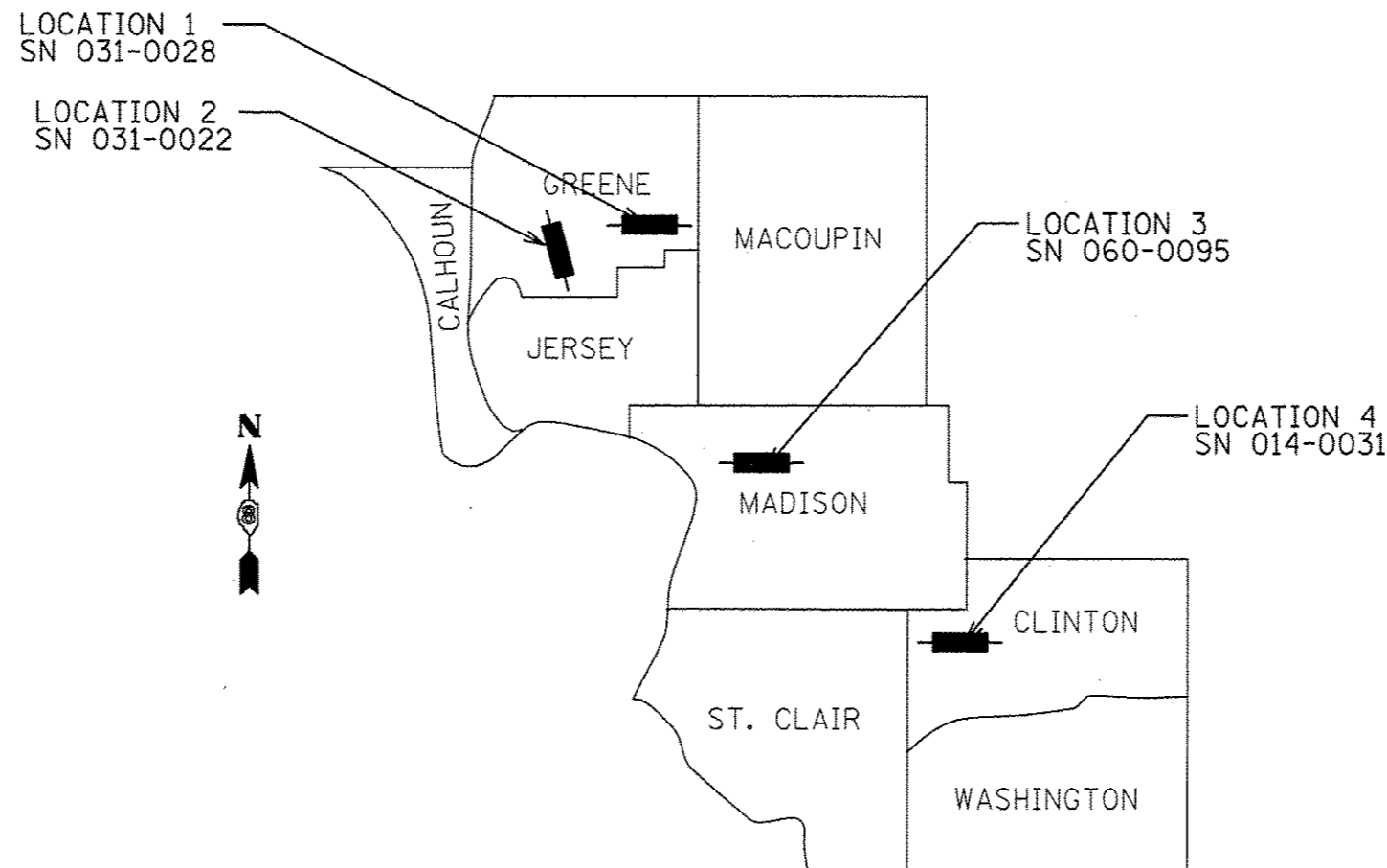
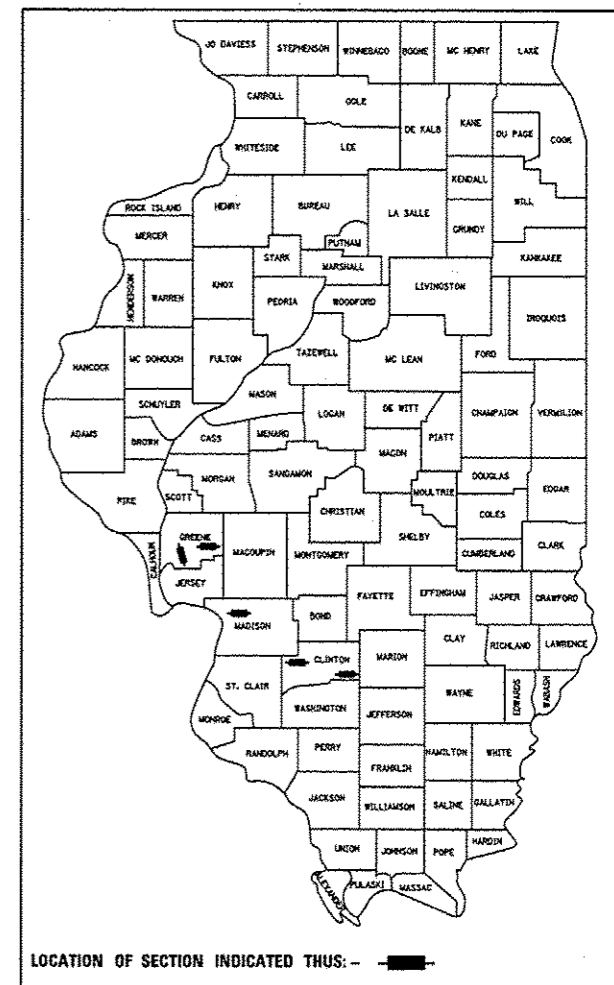

FULL SIZE PLANS HAVE BEEN PREPARED USING STANDARD ENGINEERING SCALES. REDUCED SIZED PLANS WILL NOT CONFORM TO STANDARD SCALES. IN MAKING MEASUREMENTS ON REDUCED PLANS, THE ABOVE SCALES MAY BE USED.

J.U.L.I.E.  
JOINT UTILITY LOCATION INFORMATION FOR EXCAVATION  
1-800-892-0123  
OR 811

PROJECT ENGINEER: PATTI LEBEAU (618) 346-3179  
PROJECT CONTACT: TONI MANN (618) 346-3189

CONTRACT NO. 76H80

STATE OF ILLINOIS  
DEPARTMENT OF TRANSPORTATION  
DIVISION OF HIGHWAYS

SUBMITTED *Feb 4 20 15*  
*Jeffrey Zike*  
DEPUTY DIRECTOR OF HIGHWAYS, REGION 5 ENGINEER

*Mar 20 20 15*  
*John D. Boranzoni PE*  
ENGINEER OF DESIGN AND ENVIRONMENT

*Mar 20 20 15*  
*Omar Osman PE*  
DIRECTOR OF HIGHWAYS, CHIEF ENGINEER

PRINTED BY THE AUTHORITY  
OF THE STATE OF ILLINOIS

**GENERAL NOTES**

- ILLINOIS STATE LAW REQUIRES A 48-HOUR NOTICE BE GIVEN TO ALL UTILITIES WITHIN THE PROJECT AREA BEFORE DIGGING. FIELD MARKING OF FACILITIES MAY BE OBTAINED BY CONTACTING J.U.L.I.E. OR FOR NON-MEMBERS, THE UTILITY COMPANY DIRECTLY. AGENCIES KNOWN TO HAVE FACILITIES WITHIN THE PROJECT AREA ARE AS FOLLOWS:

LOCATION 1 - SN 031-0028  
FRONTIER COMMUNICATIONS  
GREENE COUNTY RURAL WATER DT

LOCATION 2 - SN 031-0022  
NEW WAVE COMMUNICATIONS  
GREENE COUNTY RURAL WATER DT.  
FRONTIER COMMUNICATIONS

LOCATION 3 - SN 060-0095  
ATT/DISTRIBUTION  
EXPLORER PIPELINECOMPANY  
AMEREN IP  
MARATHON PIPE LINE LLC  
MEADOWBROOK PUBLIC WATER DISTRICT  
SOUTHWESTERN ELECTRIC COOP  
CHARTER COMMUNICATIONS  
BUCKEYE PARTNERS

LOCATION 4 - SN 014-0031  
ATT/DISTRIBUTION  
VILLAGE OF AVISTON  
CLINTON COUNTY ELECTRIC CO-OP  
AMEREN IP  
ST ROSE PUBLIC WATER DISTRICT

MEMBERS OF J.U.L.I.E. CALL TOLL FREE (800) 892-0123 OR 811 AND ARE INDICATED BY \*. NON-J.U.L.I.E. MEMBERS MUST BE NOTIFIED INDIVIDUALLY.

- THE CONTRACTOR AND THE ENGINEER SHALL BE AWARE THAT NO SURVEY WAS PERFORMED FOR THIS PROJECT. THE STATIONING AND TOPOGRAPHY SHOWN IN THE PLANS WAS CREATED USING MICROFILM AND FIELD MEASUREMENTS. BOTH SHALL BE ASSUMED TO BE APPROXIMATE. THE CONTRACTOR SHALL VERIFY DIMENSIONS AND CONDITIONS IN THE FIELD PRIOR TO CONSTRUCTION AND ORDERING OF MATERIALS.
- ONLY SHORT TERM LANE CLOSURES SHALL BE ALLOWED FOR MOVEMENT OF EQUIPMENT AND AS DIRECTED BY THE ENGINEER.
- FLAGGERS SHALL BE PRESENT DURING LANE CLOSURES AND NO ADDITIONAL COMEPENSATION WILL BE ALLOWED.
- IT IS THE CONTRACTOR'S RESPONSIBILITY TO BE AWARE OF ALL OF THE 404 PERMIT CONDITIONS REGARDING EROSION CONTROL MEASURES AND BE IN COMPLIANCE WITH THEM.
- IN ORDER TO AVOID EROSION OF THE EXCAVATED AREAS, THE CONTRACTOR SHALL HAVE RIPRAP PLACED WITHIN 24 HOURS OF EXCAVATION UNLESS OTHERWISE DIRECTED BY THE ENGINEER DUE TO ADVERSE WEATHER CONDITIONS.
- IF THE CONTRACTOR, FOR HIS CONSTRUCTION ACTIVITY, REMOVES TREES WITHIN THE RIGHT-OF-WAY LIMITS WHICH ARE NOT DESIGNATED ON THE PLANS FOR REMOVAL, I.E. IN ORDER TO GAIN ACCESS TO THE PROJECT SITE; IT WILL BE HIS RESPONSIBILITY TO REPLACE THE TREES AT A 1:1 RATIO. THE TREES WILL BE REPLACED WITH A 1 GALLON NATIVE ILLINOIS TREE SPECIES AND SHALL BE APPROVED BY THE ENGINEER. THE TREE REMOVAL AND TREE REPLACEMENT WILL BE AT THE CONTRACTOR'S EXPENSE, AND NO ADDITIONAL COMPENSATION WILL BE ALLOWED.
- "TRUCKS ENTERING AND LEAVING" SIGNS SHALL BE REQUIRED AND PLACED ACCORDING TO THE ENGINEER'S DISCRETION. NO ADDITIONAL COMENSATION WILL BE ALLOWED.
- THE CONTRACTOR IS RESPONSIBLE FOR PROVIDING AND MAINTAINING ACCESS TO THE WORK AREA. NO ADDITIONAL COMPENSATION WILL BE PERMITTED.
- ANY AREAS DISTURBED DUE TO CONSTRUCTION ACTIVITIES SHALL BE SEEDED (TEMPORARY AND PERMANENT) AT THE CONTRACTOR'S EXPENSE AND NO OTHER COMPENSATION WILL BE PERMITTED.
- COORDINATION WITH THE DEPARTMENT'S BUREAU OF OPERATIONS IS REQUIRED BEFORE ANY TRENCHING SHALL BE DONE TO LOCATE HIGHWAY LIGHTING/PUMP STATION/ INTELLIGENT TRANSPORTATION SYSTEM FACILITIES AND TO COORDINATE OTHER FIELD ACTIVITIES.
- THE ILLINOIS DEPARTMENT OF TRANSPORTATION STRONGLY ENCOURAGES THE PRIME CONTRCTOR AND THEIR APPROVED SUB-CONTRACTORS TO HIRE MINORITY, WOMEN, AND DISADVANTAGE INDIVIDUALS FROM ITS FEDERALLY FUNDED HIGHWAY CONSTRUCTION CARRERS TRAINING PROGRAM (HCCTPO TO HELP MEET WORKFORCE AND TRAINEE GOALS. THIS PROGRAM IS TRAINING MINORITIES, WOMEN, AND DISADVANTAGE INDIVIDUALS IN HIGHWAY CONSTRUCTION-RELATED SKILLS, E.G., MATH FOR TRADES, JOB READINESS, TECHNICAL SKILLS CORSEWORK (CARPENTRY, CONCRETE FLATWORK, BLUEPRING READING, SITE PLANS, SITE WORK, TOOLS USE, ETC.) AND ODSHA 10 HOUR CERTIFICATION, TO PREPARE THEM FOR A CARRER IN THE HIGHWAY CONSTRUCTION TRADES. GRADUATES ARE WELL-TRAINED AND READY TO BECOME PRODUCTIVE ENTRY -LEVEL CONSTRUCTION WORKERS. PLEASE CONTACT THE DISTRICT 8 EEO OFFICE AT 618-346-3360 AND/OR THE HCCTP COORDINATOR AT 618\*874-6528 TO LEARN MORE ABOUT THE PROGRAM AND FOR ASSISTANCE IN MEETING WORKFORCE AND TRAINEE GOALS.

**INDEX OF SHEETS**

- COVER SHEET
- GENERAL NOTES, STANDARDS, COMMITMENTS, ADT
- SUMMARY OF QUANTITIES
- LOCATION MAPS
- PLAN SHEETS

**STANDARDS**

- 000001-06
- 001006
- 701001-02
- 701006-05
- 701201-04
- 701301-04
- 701901-04

**COMMITMENTS**

NO COMMITMENTS

**ADT**

LOCATION 1 - SN 031-0028  
GREENE COUNTY  
2013 ADT = 775 (ACTUAL)  
2015 ADT = 800 (ESTIMATED)  
SU = 3.9%  
MU = 5.2%

LOCATION 2 - SN 031-0022  
GREENE COUNTY  
2013 ADT = 4500 (ACTUAL)  
2015 ADT = 4600 (ESTIMATED)  
SU = 3.6%  
MU = 5.6%

LOCATION 3 - 060-0095  
MADISON COUNTY  
2013 ADT = 6000 (ACTUAL)  
2015 ADT = 6200 (ESTIMATED)  
SU = 5.0%  
MU = 4.6%

LOCATION 4 - SN 014-0031  
CLINTON COUNTY  
2010 ADT = 5100 (ACTUAL)  
2015 ADT = 5400 (ESTIMATED)  
SU = 2.9%  
MU = 2.0%

\* DIST 8 SCOUR MITIGATION 2015-2

FILE NAME #	USER NAME # *USER#	DESIGNED -	REVISED -	<b>STATE OF ILLINOIS DEPARTMENT OF TRANSPORTATION</b>	<b>GENERAL NOTES, STANDARDS, COMMITMENT, ADT</b>			F.A. RTE.	SECTION	COUNTY	TOTAL SHEETS	SHEET NO.
#FILE#		DRAWN -	REVISED -					VAR.	*	VARIOUS	10	2
	PLOT SCALE # *SCALE#	CHECKED -	REVISED -		SCALE:	SHEET NO.	OF	SHEETS	STA.	TO STA.	FED. ROAD DIST. NO.	ILLINOIS FED. AID PROJECT
	PLOT DATE # *DATE#	DATE -	REVISED -		CONTRACT NO. 76H80							

CODE NO.	ITEM	UNIT	TOTAL QUANTITY	CONSTRUCTION CODE			
				100% STATE	100% STATE	100% STATE	100% STATE
				BRIDGE	BRIDGE	BRIDGE	BRIDGE
				0020	0020	0020	0020
				SN 031-0028	SN 031-0022	060-0095	014-0031
20300100	CHANNEL EXCAVATION	CU YD	390	20	30	300	40
28100107	STONE RIPRAP, CLASS A4	SQ YD	900	0	900	0	0
28100109	STONE RIPRAP, CLASS A5	SQ YD	320	0	0	0	320
28100111	STONE RIPRAP, CLASS A6	SQ YD	300	50	0	250	0
28200200	FILTER FABRIC	SQ YD	1100	30	560	210	300
67100100	MOBILIZATION	L SUM	1	0.25	0.25	0.25	0.25
70100450	TRAFFIC CONTROL AND PROTECTION, STANDARD 701201	L SUM	1	0.25	0.25	0.25	0.25

7

\* DIST 8 SCOUR MITIGATION 2015-2

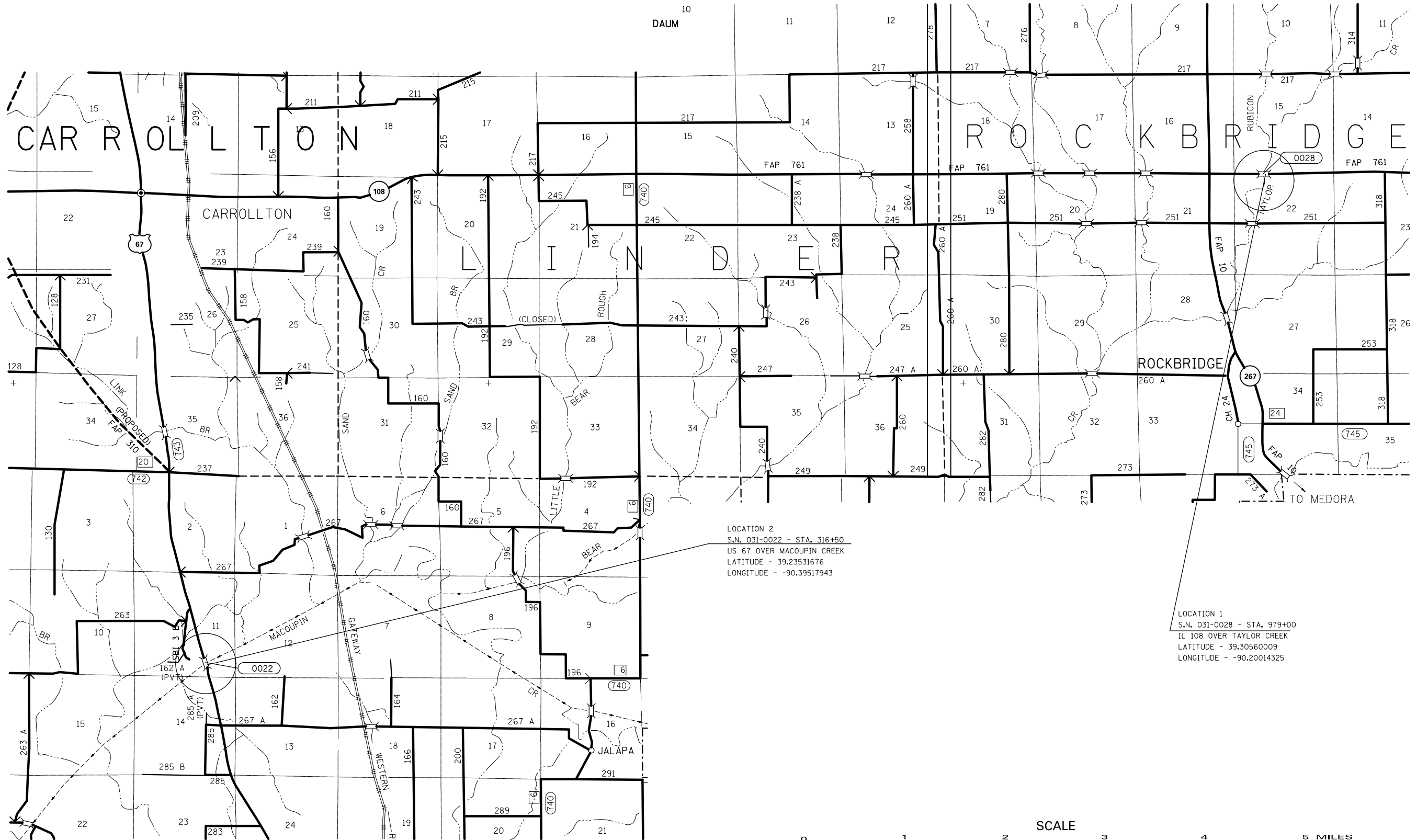

LOCATION 2  
 S.N. 031-0022 - STA. 316+50  
 US 67 OVER MACOUPIN CREEK  
 LATITUDE - 39.23531676  
 LONGITUDE - -90.39517943

LOCATION 1  
 S.N. 031-0028 - STA. 979+00  
 IL 108 OVER TAYLOR CREEK  
 LATITUDE - 39.30560009  
 LONGITUDE - -90.20014325

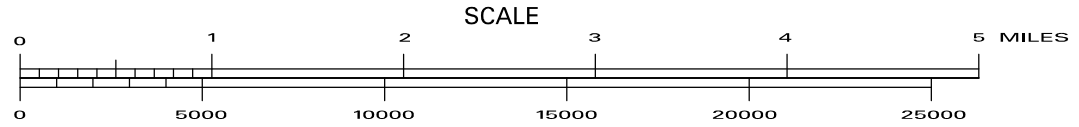

FILE NAME = *FILEL*	USER NAME = *USER*	DESIGNED -	REVISED -
		DRAWN -	REVISED -
		CHECKED -	REVISED -
		DATE -	REVISED -

**STATE OF ILLINOIS  
 DEPARTMENT OF TRANSPORTATION**

**LOCATION 1 & 2 MAP**

SCALE:	SHEET NO.	OF SHEETS	STA.	TO STA.
--------	-----------	-----------	------	---------

\* DIST 8 SCOUR MITIGATION 2015-2

F.A. RTE.	SECTION	COUNTY	TOTAL SHEETS	SHEET NO.
VAR.	*		10	4
CONTRACT NO. 76H80				
FED. ROAD DIST. NO. ILLINOIS FED. AID PROJECT				

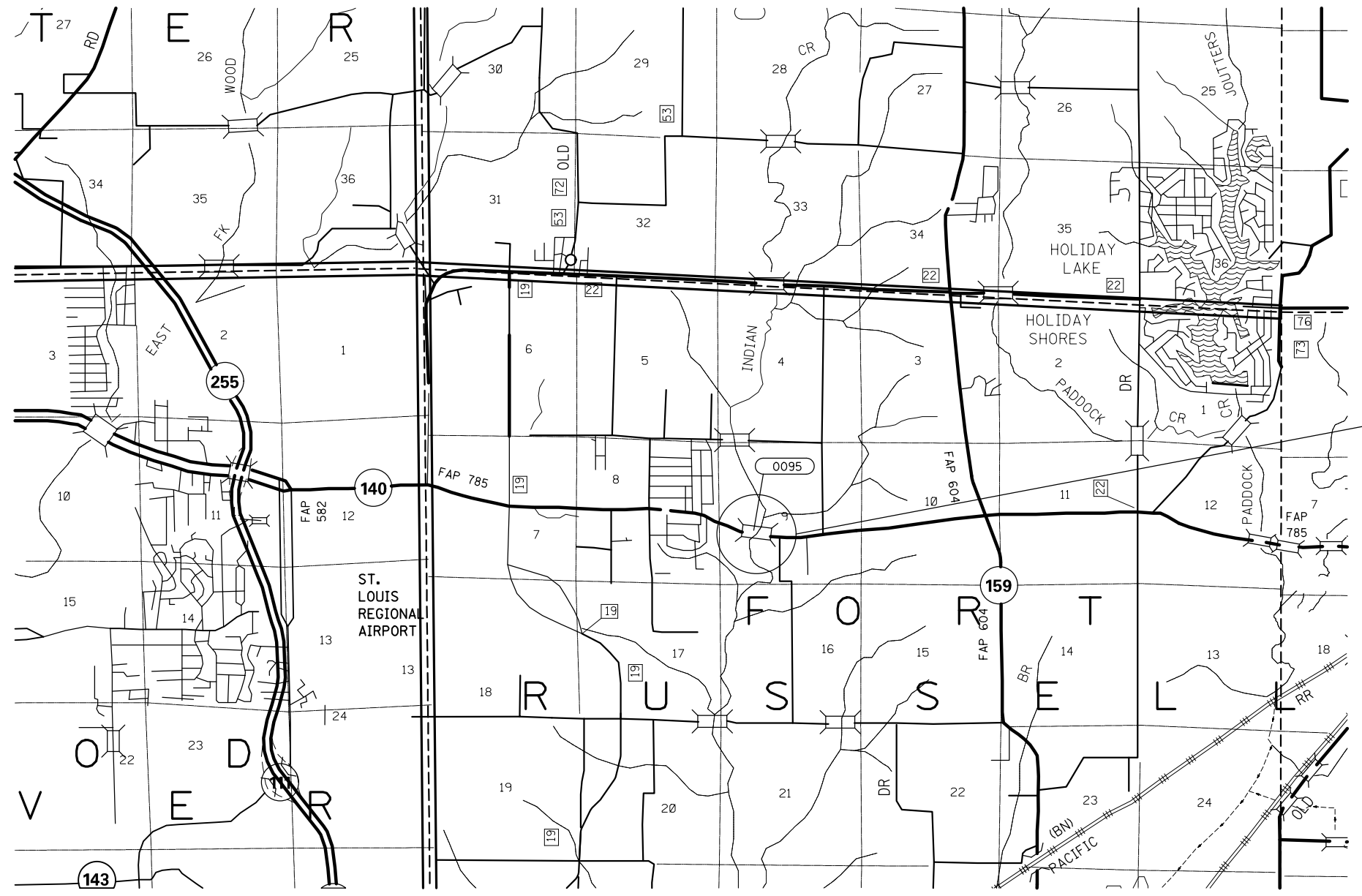

LOCATION 3  
 S.N. 060-0095 - STA. 406+50  
 IL 140 OVER INDIAN CREEK  
 LATITUDE - 38.89611023  
 LONGITUDE - -89.9969435

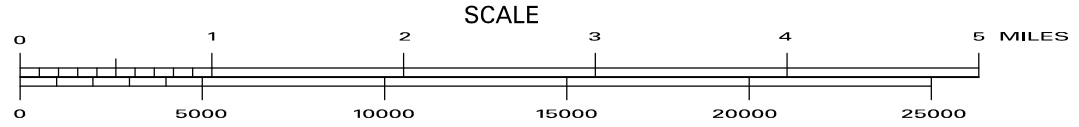
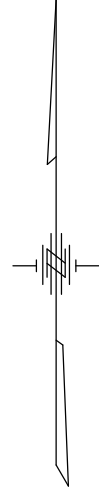

FILE NAME = *FILEL*		USER NAME = *USER*	DESIGNED -	REVISED -	<b>STATE OF ILLINOIS DEPARTMENT OF TRANSPORTATION</b>	<b>LOCATION 3 MAP</b>				* DIST 8 SCOUR MITIGATION 2015-2					
		PLOT SCALE = *SCALE*	DRAWN -	REVISED -		SCALE:	SHEET NO.	OF SHEETS	STA.	TO STA.	F.A. RTE.	SECTION	COUNTY	TOTAL SHEETS	SHEET NO.
		PLOT DATE = *DATE*	CHECKED -	REVISED -							VAR.	*	VARIOUS	10	5
			DATE -	REVISED -							CONTRACT NO. 76H80				
													FED. ROAD DIST. NO. ILLINOIS FED. AID PROJECT		

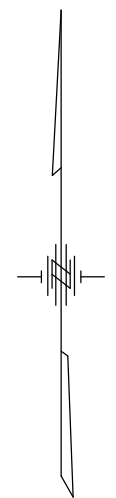
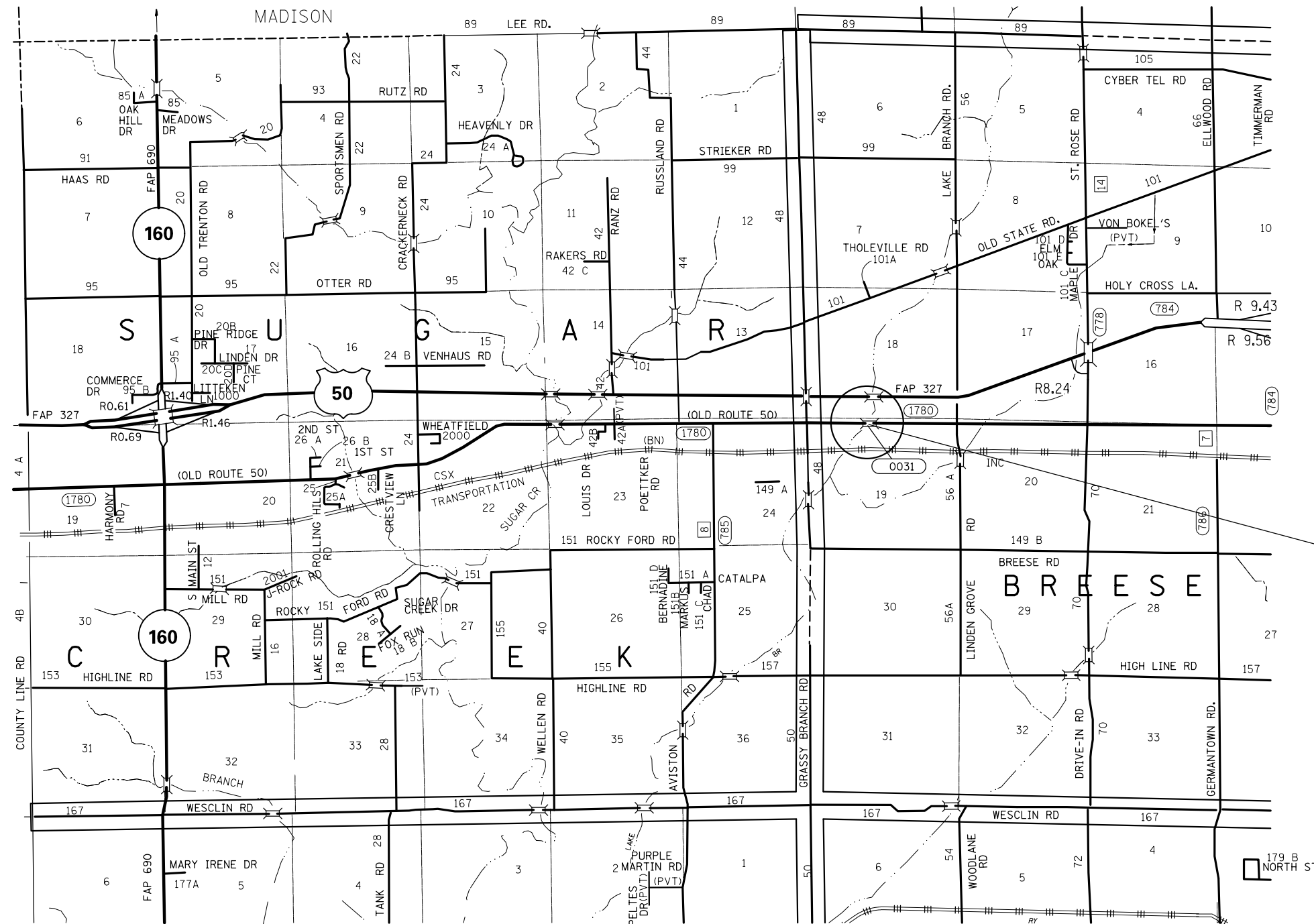

LOCATION 4  
 S.N. 014-0031 - STA. 258+14  
 OLD US 50 OVER LAKE BRANCH  
 LATITUDE- 38.61212849  
 LONGITUDE- -89.58554668

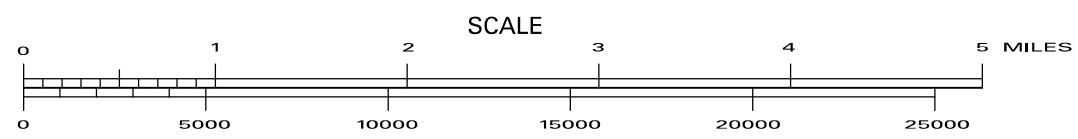

FILE NAME = *FILEL*	USER NAME = *USER*	DESIGNED -	REVISED -	<b>STATE OF ILLINOIS DEPARTMENT OF TRANSPORTATION</b>	<b>LOCATION 4 MAP</b>				F.A. RTE.	SECTION	COUNTY	TOTAL SHEETS	SHEET NO.
		DRAWN -	REVISED -		SCALE:	SHEET NO.	OF SHEETS	STA.	TO STA.	VAR.	*	10	6
		CHECKED -	REVISED -		CONTRACT NO. 76H80								
		DATE -	REVISED -		FED. ROAD DIST. NO. ILLINOIS FED. AID PROJECT								

\* DIST 8 SCOUR MITIGATION 2015-2



Existing Structure: S.N. 031-0028 consists of a two span precast prestressed concrete deck beam superstructure supported on closed abutments founded on timber piles and a solid wall concrete pier with a footing founded on precast concrete piles.

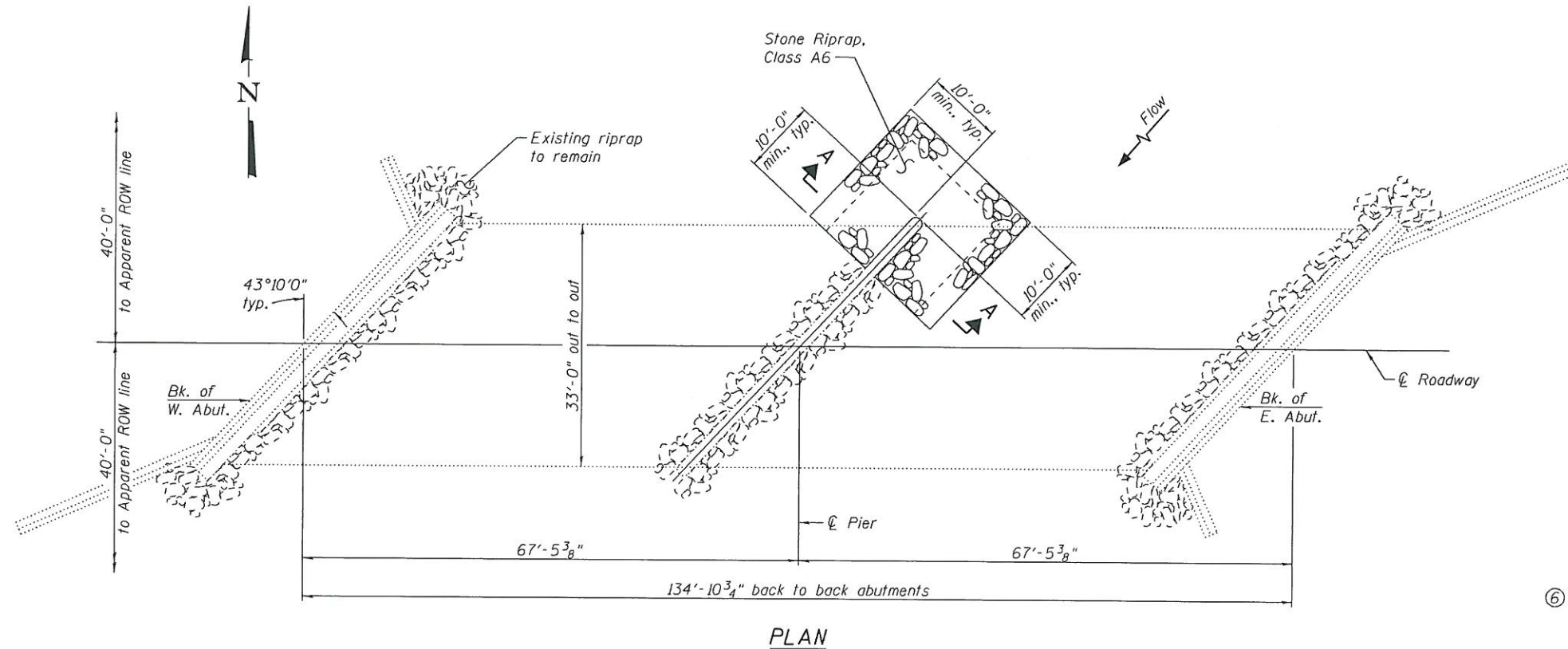
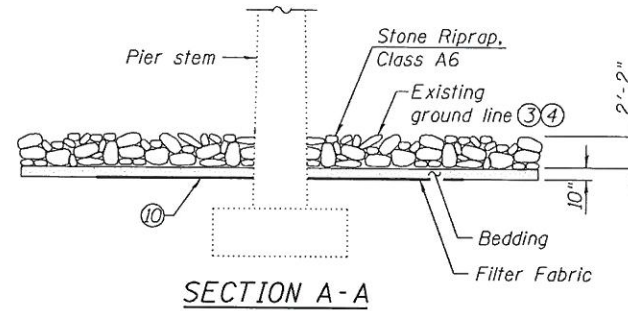
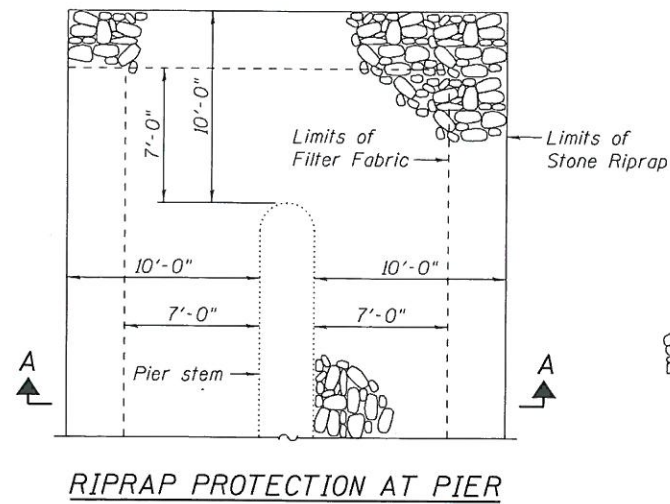

ELEVATION VIEW ⑧  
(Looking Southwest)

TOTAL BILL OF MATERIAL ⑨

CODE NO.	ITEM	UNIT	TOTAL
20300100	Channel Excavation	Cu. Yd.	20
28100111	Stone Riprap, Class A6	Sq. Yd.	50
28200200	Filter Fabric	Sq. Yd.	30

- Notes:
- ① The Contractor shall field verify existing dimensions, details, and conditions affecting new construction and make necessary approved adjustments prior to construction or ordering of materials. Such variations shall not be cause for additional compensation for a change in scope of the work, however, the Contractor will be paid for the quantity actually furnished based upon the unit price bid for the work.
  - ② Layout of the slope protection system may be varied to suit ground conditions in the field as directed by the Engineer. Slope protection system shall be placed in a manner that does not reduce the total waterway opening or block the flow of the local ditches below the structure.
  - ③ Grade channel bank to a slope that will provide a stable base for riprap as directed by the Engineer. Cost included in Channel Excavation.
  - ④ Grade streambed so that the top of the Stone Riprap approximately matches the existing stream profile as directed by the Engineer. Cost included in Channel Excavation.
  - ⑤ Additional excavation and reshaping of channel and bank may be required to facilitate proper placement of Stone Riprap as directed by the Engineer.
  - ⑥ Channel Excavation shall include the cost of removing and disposing of existing riprap, brick, block, rubble, or other material as encountered.
  - ⑦ Contractor to locate existing underground utilities. Where existing underground utilities conflict with riprap placement, the Contractor shall adjust the layout as directed by the Engineer.
  - ⑧ Elevation view shown as of January 30, 2014. Actual conditions may vary.
  - ⑨ Estimated quantities. Actual quantities to be determined in the field.
  - ⑩ The filter fabric shall not be lower than the top of footing.

DANIEL GEORGE LUIZ  
062-060383  
LICENSED PROFESSIONAL ENGINEER OF ILLINOIS

DATE: 1/29/2015  
EXPIRATION: 11/30/2015

IL ROUTE 108 OVER TAYLOR CREEK  
STRUCTURE NO. 031-0028

Existing Structure: S.N. 060-0095 consists of a two span concrete continuous slab superstructure supported on closed reinforced concrete abutments founded on timber piles and a reinforced concrete center pier founded on timber piles.

**GENERAL NOTES**

- ① Plan dimensions and details relative to existing plans are subject to routine variations. The Contractor shall field verify existing dimensions and details affecting new construction and make necessary approved adjustments prior to construction or ordering of materials. Such variations shall not be cause for additional compensation for a change in scope of the work; however, the Contractor will be paid for the quantity actually furnished based upon the unit price bid for the work.
- ② Layout of the erosion control protection system may be varied to suit ground conditions in the field as directed by the Engineer.
- ③ Grade streambed so that the top of the Stone Riprap approximately matches the existing stream profile as directed by the Engineer. Cost included in Channel Excavation.
- ④ Additional excavation and reshaping of channel and bank may be required to facilitate proper placement of Stone Riprap as directed by the Engineer.
- ⑤ Channel Excavation shall include the cost of removing and disposing of existing riprap, brick, block, rubble, or other material as encountered.
- ⑥ Contractor to locate existing underground utilities. Where existing underground utilities conflict with riprap placement, the Contractor shall adjust the layout as directed by the Engineer.
- ⑦ Elevation view shown as of September 2013. Actual conditions may vary.
- ⑧ Estimated quantities. Actual quantities to be determined in the field.

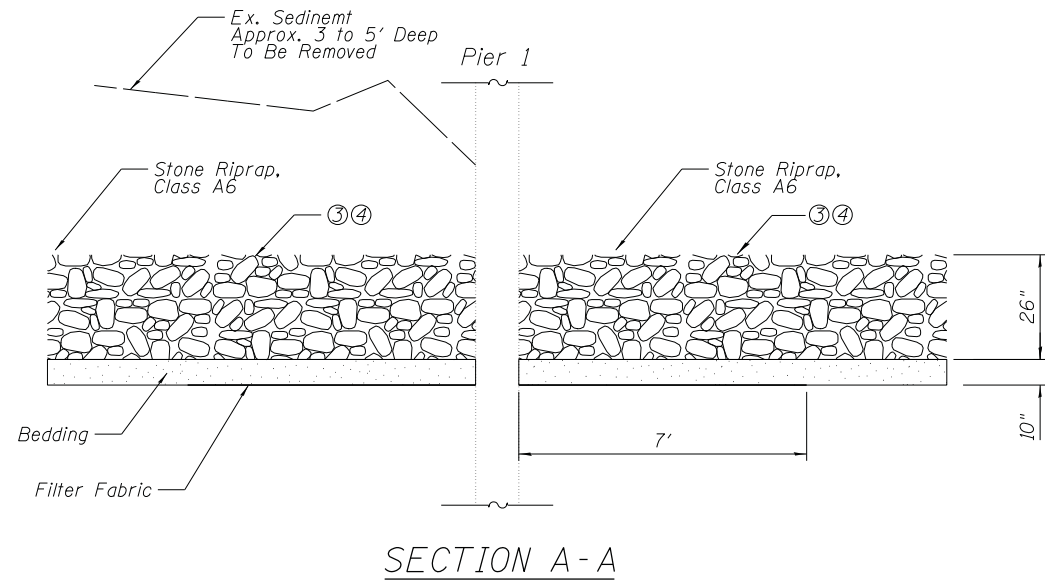

**SECTION A-A**

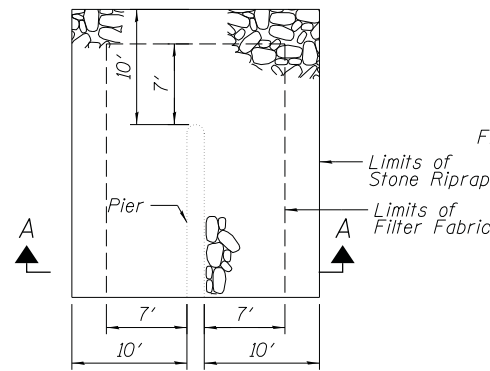

**RIPRAP PROTECTION AT PIER 1**

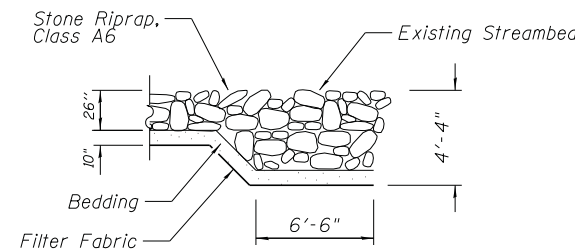

**SECTION B-B**

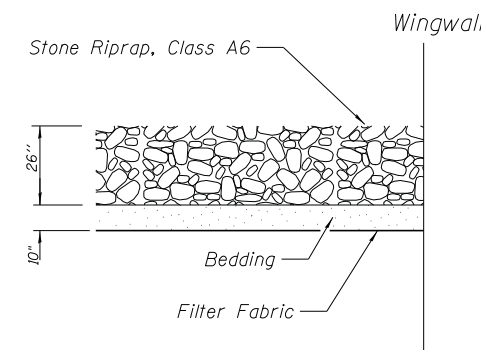

**SECTION C-C**



**ELEVATION VIEW ⑦**  
(Looking South)

**TOTAL BILL OF MATERIAL ⑧**

CODE NO.	ITEM	UNIT	QUANTITY
⑤ 29300100	Channel Excavation	Cu. Yd.	300
28100011	Stone Riprap, Class A6	Sq. Yd.	250
28200200	Filter Fabric	Sq. Yd.	210

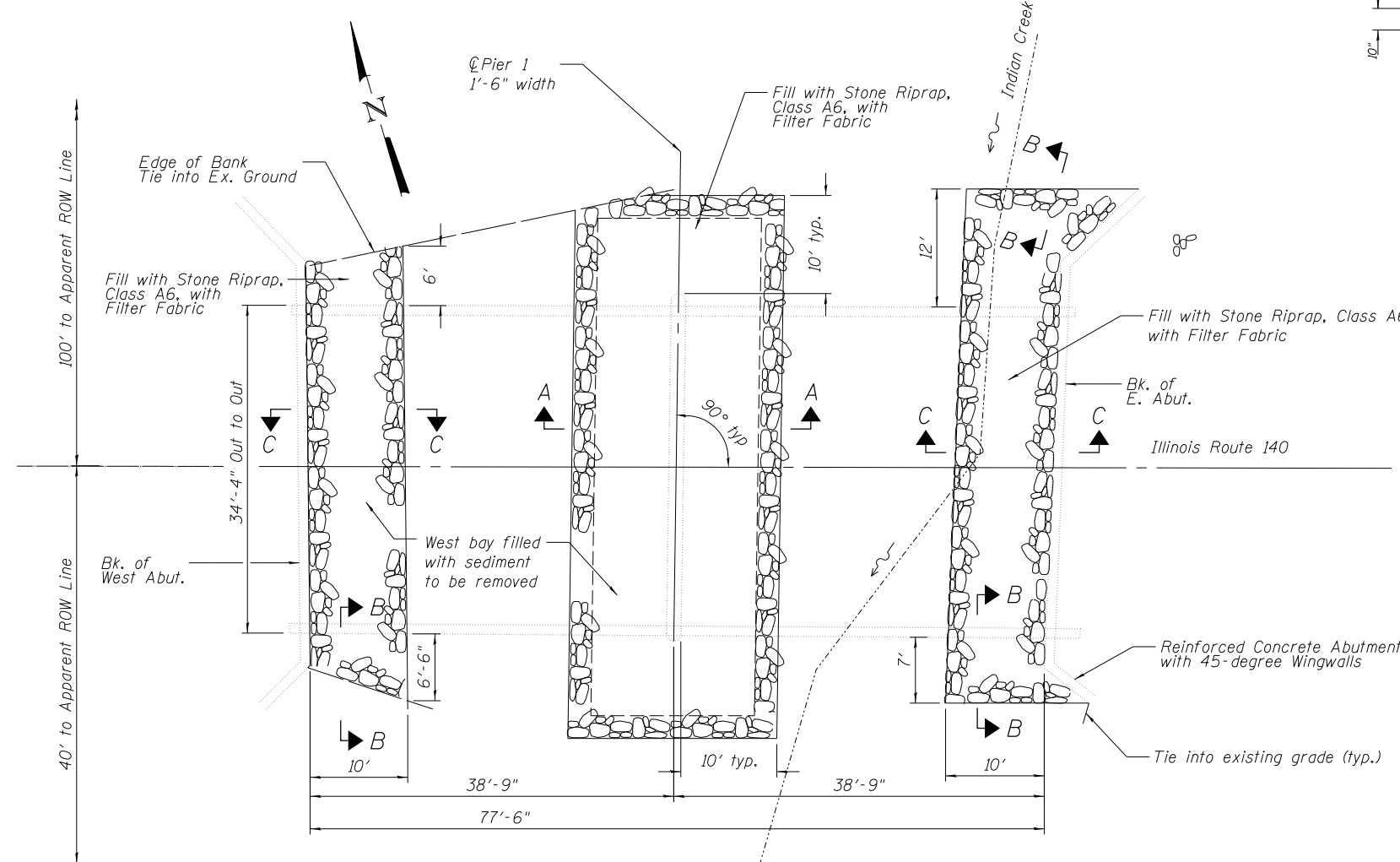

USER NAME =	DESIGNED ML	REVISED
	CHECKED MK	REVISED
PLOT SCALE =	DRAWN ML	REVISED
PLOT DATE =	CHECKED MK	REVISED

**STATE OF ILLINOIS**  
**DEPARTMENT OF TRANSPORTATION**

SHEET NO. 1 OF 1 SHEETS

F.A. RTE.	SECTION	COUNTY	TOTAL SHEETS	SHEET NO.
VAR.		VARIOUS	10	8
• D8 SCOUR MITIGATION 2015-2			CONTRACT NO. 76H80	
ILLINOIS FED. AID PROJECT				

**IL ROUTE 140 OVER INDIAN CREEK**  
**STRUCTURE NO. 060-0095**



Existing Structure: S.N. 014-0031 consists of a four span reinforced concrete slab bridge supported on reconstructed abutments and a precast concrete pile bent.

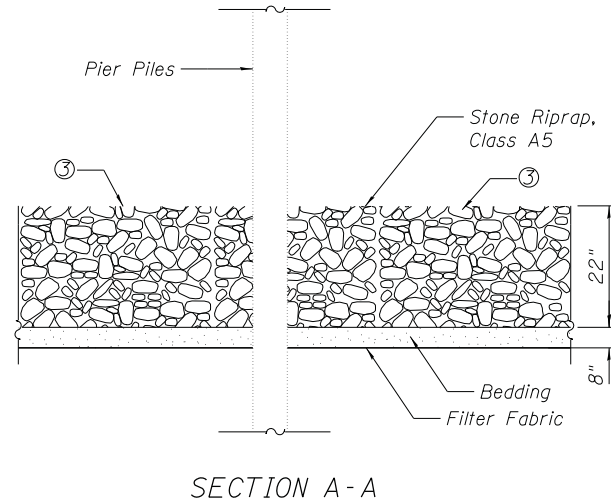
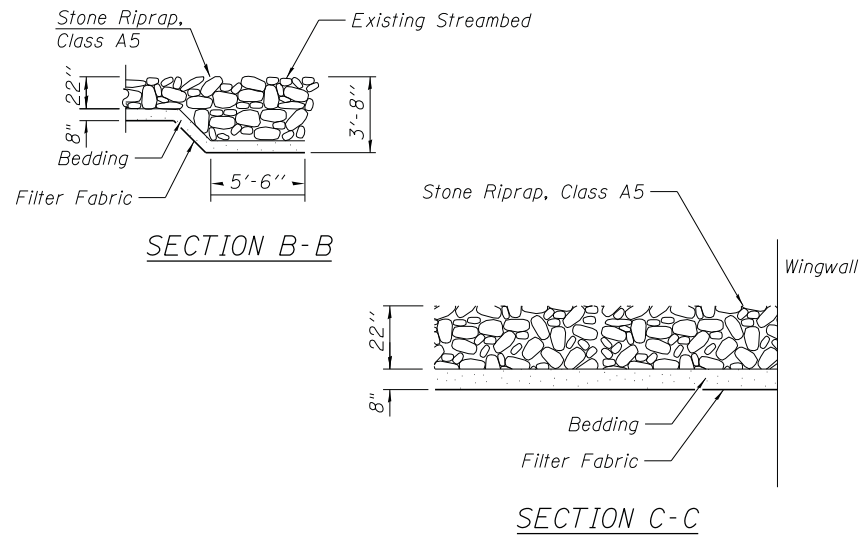

- ### GENERAL NOTES
- Plan dimensions and details relative to existing plans are subject to routine variations. The Contractor shall field verify existing dimensions and details affecting new construction and make necessary approved adjustments prior to construction or ordering of materials. Such variations shall not be cause for additional compensation for a change in scope of the work; however, the Contractor will be paid for the quantity actually furnished based upon the unit price bid for the work.
  - Layout of the erosion control protection system may be varied to suit ground conditions in the field as directed by the Engineer.
  - Grade streambed so that the top of the Stone Riprap approximately matches the existing stream profile as directed by the Engineer. Cost included in Channel Excavation.
  - Additional excavation and reshaping of channel and bank may be required to facilitate proper placement of Stone Riprap as directed by the Engineer.
  - Channel Excavation shall include the cost of removing and disposing of existing riprap, brick, block, rubble, or other material as encountered.
  - Contractor to locate existing underground utilities. Where existing underground utilities conflict with riprap placement, the Contractor shall adjust the layout as directed by the Engineer.
  - Elevation view shown as of December 2014. Actual conditions may vary.
  - Estimated quantities. Actual quantities to be determined in the field.



ELEVATION VIEW ⑦  
(Looking Southwest)

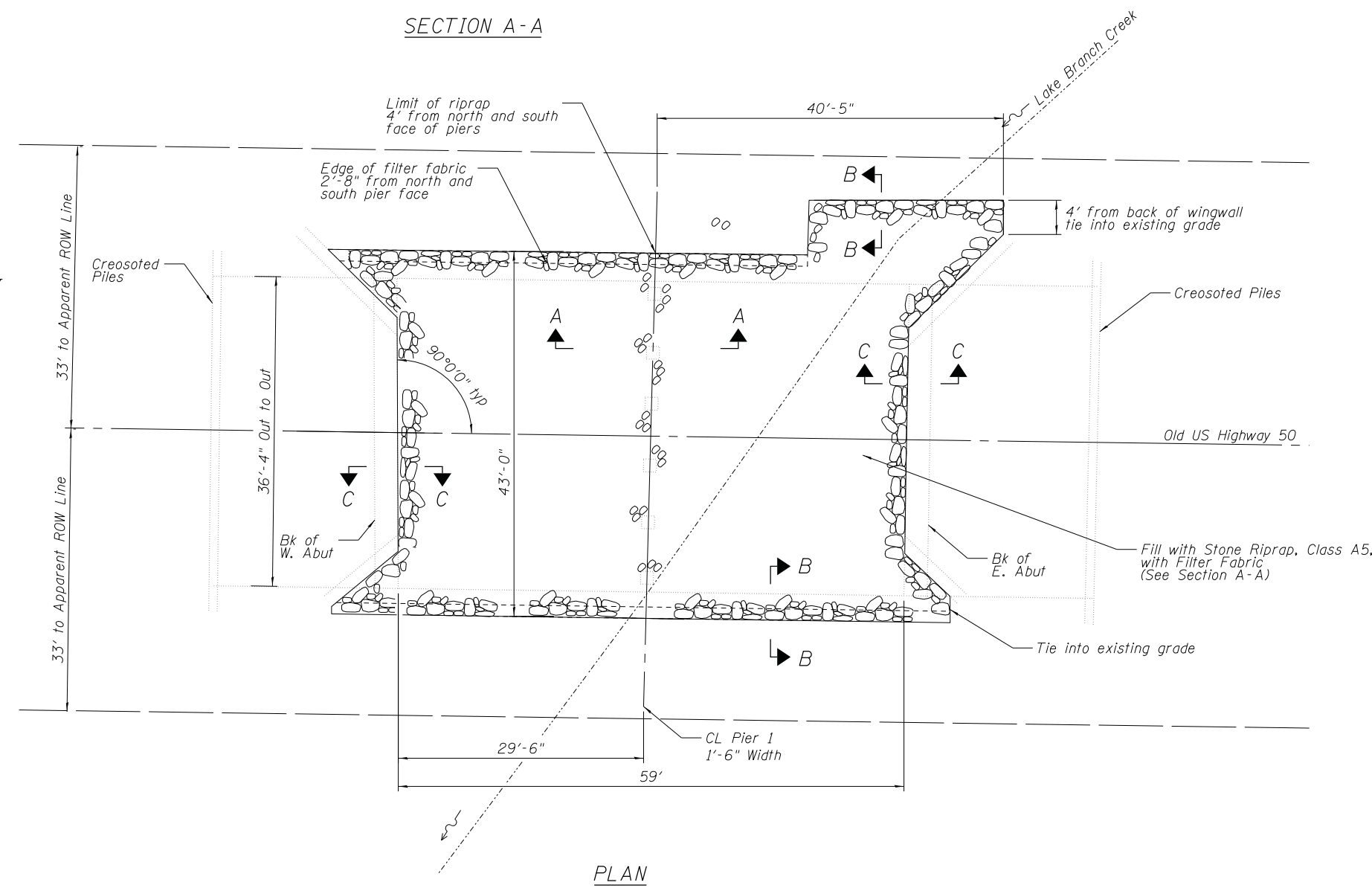

### TOTAL BILL OF MATERIAL ⑧

CODE NO.	ITEM	UNIT	QUANTITY
29300100	Channel Excavation	Cu. Yd.	40
28100109	Stone Riprap, Class A5	Sq. Yd.	320
28200200	Filter Fabric	Sq. Yd.	300



OLD US 50 OVER LAKE BRANCH CREEK  
STRUCTURE NO. 014-0031

Midclarity	USER NAME =	DESIGNED ML	REVISED
		CHECKED MK	REVISED
	PLOT SCALE =	DRAWN ML	REVISED
	PLOT DATE =	CHECKED MK	REVISED

STATE OF ILLINOIS  
DEPARTMENT OF TRANSPORTATION

F.A. RTÉ.	SECTION	COUNTY	TOTAL SHEETS	SHEET NO.
VAR.		VARIOUS	10	9
• DB SCOUR MITIGATION 2015-2			CONTRACT NO. 76H80	
ILLINOIS FED. AID PROJECT				

Existing Structure: S.N. 031-0022 consists of a seven span steel superstructure supported on open abutments founded on precast concrete piles and protected by concrete slopewalls and solid wall hammerhead piers with spread footings founded on timber piles.

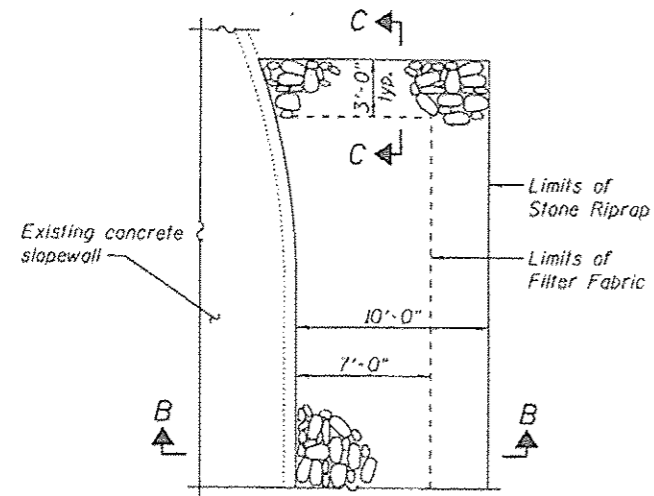

RIPRAP PROTECTION AT SLOPEWALLS

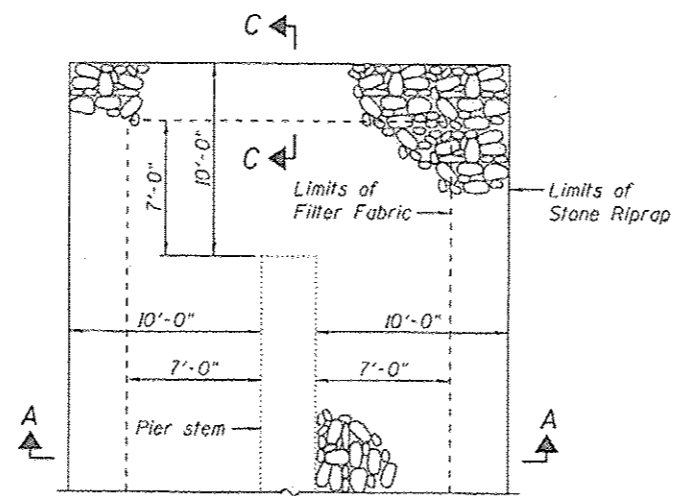

RIPRAP PROTECTION AT PIERS

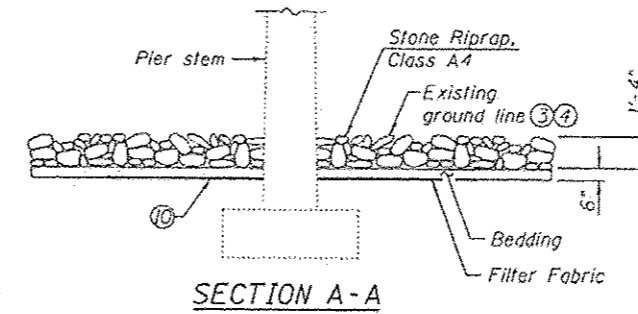

SECTION A-A

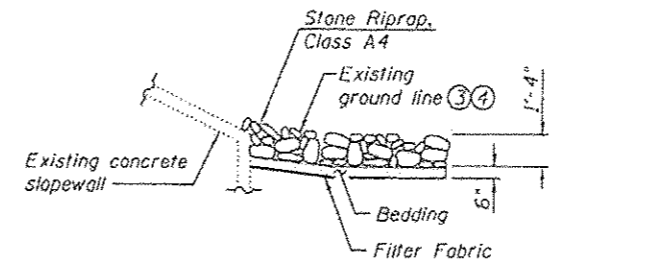

SECTION B-B

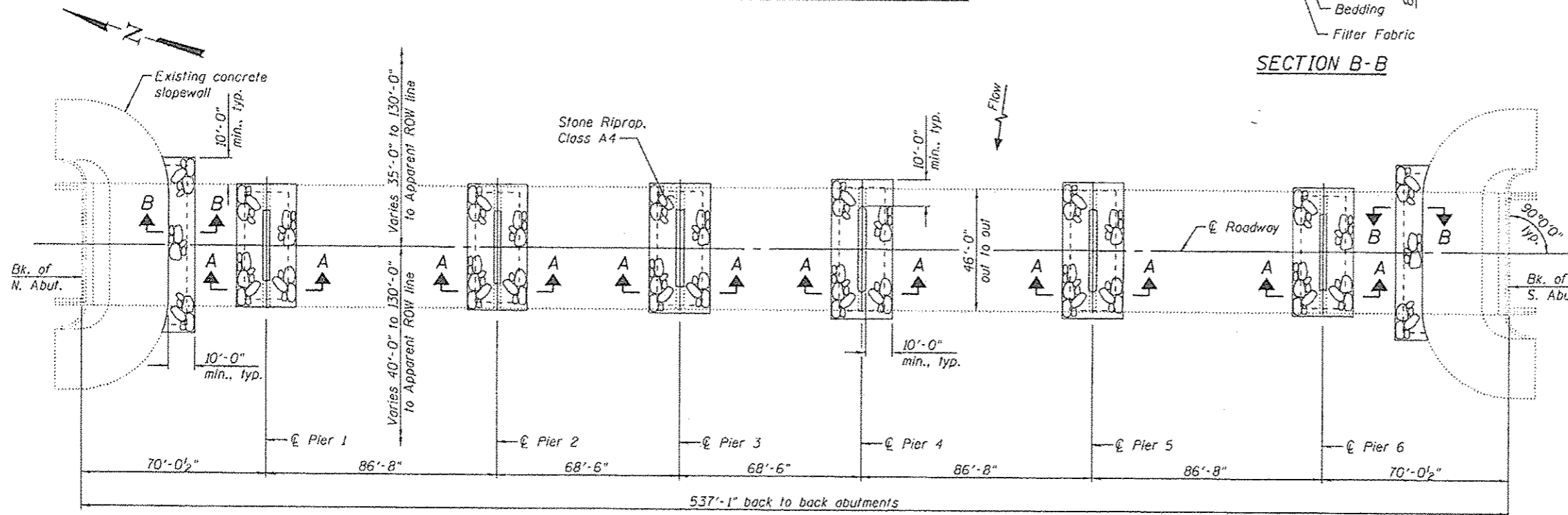

PLAN

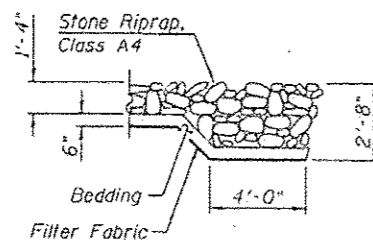

SECTION C-C

- Notes:
- The Contractor shall field verify existing dimensions, details, and conditions affecting new construction and make necessary approved adjustments prior to construction or ordering of materials. Such variations shall not be cause for additional compensation for a change in scope of the work, however, the Contractor will be paid for the quantity actually furnished based upon the unit price bid for the work.
  - Layout of the slope protection system may be varied to suit ground conditions in the field as directed by the Engineer. Slope protection system shall be placed in a manner that does not reduce the total waterway opening or block the flow of the drainage ditches below the structure.
  - Grade channel bank to a slope that will provide a stable base for riprap as directed by the Engineer. Cost included in Channel Excavation.
  - Grade streambed so that the top of the Stone Riprap approximately matches the existing stream profile as directed by the Engineer. Cost included in Channel Excavation.
  - Additional excavation and reshaping of channel and bank may be required to facilitate proper placement of Stone Riprap as directed by the Engineer.
  - Channel Excavation shall include the cost of removing and disposing of existing riprap, brick, block, rubble, or other material as encountered.
  - Contractor to locate existing underground utilities. Where existing underground utilities conflict with riprap placement, the Contractor shall adjust the layout as directed by the Engineer.
  - Elevation view shown as of January 30, 2014. Actual conditions may vary.
  - Estimated quantities. Actual quantities to be determined in the field.
  - The filter fabric shall not be lower than the top of footing.
  - Flank stone only required on upstream and downstream ends of riprap pads.



ELEVATION VIEW (Looking Northwest)

TOTAL BILL OF MATERIAL

CODE NO.	ITEM	UNIT	TOTAL
20300100	Channel Excavation	Cu. Yd.	30
28200107	Stone Riprap, Class A4	Sq. Yd.	900
28200206	Filter Fabric	Sq. Yd.	560

DANIEL GEORGE LUTZ  
062-060383  
LICENSED PROFESSIONAL ENGINEER  
ILLINOIS  
DATE: 3/6/2015  
EXPIRATION: 11/30/2015

U.S. 67 OVER MACOUPIN CREEK  
STRUCTURE NO. 031-0022

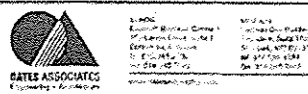

USER NAME	DESIGNED	REVISIONS
MAC	MAC	REVISIONS
JAD	JAD	REVISIONS
MAC	MAC	REVISIONS
JAD	JAD	REVISIONS

STATE OF ILLINOIS  
DEPARTMENT OF TRANSPORTATION

F.A. RTE.	SECTION	COUNTY	TOTAL SHEETS	SHEET NO.
01ST & SCOUR MIT 2015-2		GREENE	10	10
CONTRACT NO. 76H80				
ILLINOIS FED. AID PROJECT				