

FOR INDEX OF SHEETS AND LIST OF HIGHWAY STANDARDS SEE SHEET NO. 2

STATE OF ILLINOIS
DEPARTMENT OF TRANSPORTATION
DIVISION OF HIGHWAYS

PLANS FOR PROPOSED
FEDERAL AID PROJECT

SAFE ROUTES TO SCHOOL
SECTION 12-00001-00-SW
PROJECT SRTS-4009(316)
VILLAGE OF NEWARK
KENDALL COUNTY
C-93-050-15

F.A.U. RTE.	SECTION	COUNTY	TOTAL SHEETS	SHEET NO.
	12-00001-00-SW	KENDALL	19	1
CONTRACT NO. 87612				

04-24-2015 LETTING ITEM 104

POLICY STATEMENT:
PLANS DESIGNED IN ACCORDANCE WITH THE
BUREAU OF LOCAL ROADS AND STREETS MANUAL



PROJECT LOCATED
IN THE VILLAGE OF
NEWARK

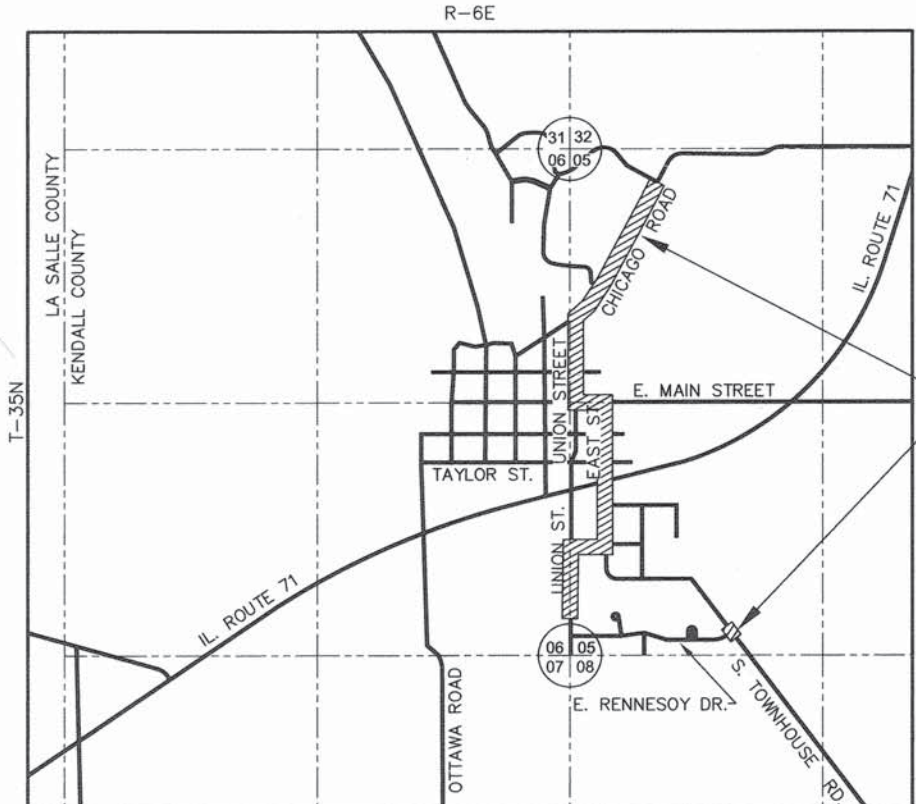

PROJECT LOCATION

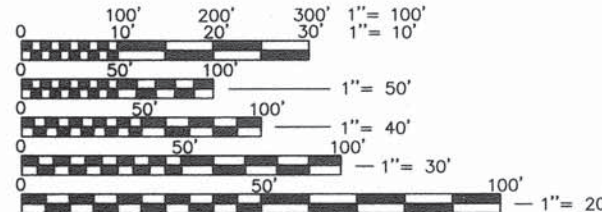

FULL SIZE PLANS HAVE BEEN PREPARED USING STANDARD ENGINEERING SCALES, REDUCED SIZED PLANS WILL NOT CONFORM TO STANDARD SCALES, IN MAKING MEASUREMENTS ON REDUCED PLANS, THE ABOVE SCALES MAY BE USED.

NW 1/4 AND SW 1/4 OF SECTION 05,
NE 1/4 AND SE 1/4 OF SECTION 06,
T35N, R6E, 3RD PM, BIG GROVE TOWNSHIP

LOCATION MAP

SCALE: 1" = 2000'

GROSS LENGTH OF PROJECT = 7,709 FEET (1.460 MILE)
NET LENGTH OF PROJECT = 5,894 FEET (1.116 MILE)

JULIE
JOINT
UTILITY
LOCATION
INFORMATION FOR
EXCAVATION
CALL 811

Know what's below.
Call before you dig.

CONTRACT NO. 87612

Engineering Enterprises, Inc.
CONSULTING ENGINEERS
52 Wheeler Road
Sugar Grove, Illinois 60554
Phone: (630) 466-6700

STATE OF ILLINOIS
DEPARTMENT OF TRANSPORTATION
DIVISION OF HIGHWAYS

APPROVED 2/6 2015
Jim Davis
VILLAGE OF NEWARK, PRESIDENT

PASSED 2-20 2015
Daniel R. P.
DISTRICT 3 LOCAL ROADS AND STREETS ENGINEER

RELEASING FOR
BID BASED ON
LIMITED REVIEW 2-20 2015
Paul A. Wells
DEPUTY DIRECTOR OF HIGHWAYS, REGION 2 ENGINEER

DATE: 2/6/2015

BY: *Todd A. Wells*
TODD A. WELLS

LICENSE EXPIRES: NOVEMBER 30, 2015

SEAL

PRINTED BY THE AUTHORITY
OF THE STATE OF ILLINOIS

GENERAL NOTES

THE THICKNESS OF HMA SHOWN ON THE PLANS IS THE NOMINAL THICKNESS. DEVIATIONS FROM THE NOMINAL THICKNESS WILL BE PERMITTED WHEN SUCH DEVIATIONS OCCUR DUE TO IRREGULARITIES IN THE EXISTING SURFACE OR BASE ON WHICH THE HMA IS PLACED.

THE HMA SURFACE OF ALL MAILBOX TURNOUTS, PRIVATE ENTRANCES, COMMERCIAL ENTRANCES, AND SIDE ROADS SHALL BE MADE NEATLY, IN A WORKMANLIKE MANNER, AND SHALL ACCURATELY CONFORM TO THE SHAPES AND DIMENSIONS SHOWN ON THE PLAN DETAILS. IF REQUIRED BY THE ENGINEER, THE CONTRACTOR SHALL SAW CUT THE HMA SURFACE TO CONFORM TO THE SHAPES AND DIMENSIONS SHOWN ON THE PLAN DETAILS. THIS WORK WILL BE INCLUDED IN THE COST OF THE ASSOCIATED PAY ITEMS.

EXCEPT AS NOTED ON THE PLANS, PAVEMENT GRADES SHOWN ARE AT THE TOP OF PAVEMENT SURFACES.

BEFORE ORDERING PIPE CULVERTS OR PIPE DRAINS, THE CONTRACTOR SHALL CONSULT THE ENGINEER FOR EXACT LENGTHS.

THE ENGINEER WILL BE THE SOLE JUDGE CONCERNING CURING TIME FOR THE VARIOUS HMA LIFTS.

SEEDING WILL NOT BE PERMITTED AT ANY TIME WHEN THE GROUND IS FROZEN, WET, OR IN AN UNTILLABLE CONDITION. LOCATIONS TO BE SEEDED WILL BE DETERMINED BY THE ENGINEER.

ONLY THOSE TREES DESIGNATED BY THE ENGINEER OR LISTED IN THE TREE REMOVAL SCHEDULE SHALL BE REMOVED. THE CONTRACTOR SHALL PROTECT ALL REMAINING TREES FROM DAMAGE DUE TO HIS OPERATIONS.

ALL EXCAVATION OCCURRING WITHIN THE ILLINOIS ROUTE 71 RIGHT-OF-WAY SHALL REMAIN WITHIN THE IL ROUTE 71 R.O.W. THE COST FOR SPREADING, PLACEMENT, AND PREPARATION OF THIS MATERIAL FOR SEEDING IS INCLUDED IN THE COST OF SEEDING, CLASS 1.

PAY LIMITS FOR EARTH EXCAVATION (SPECIAL) SHALL EXTEND TO THE FULL WIDTH OF THE PROPOSED AGGREGATE BASE. ANY EXCAVATION BEYOND THESE LIMITS SHALL BE INCLUDED IN THE COST OF THE CONTRACT.

DETECTABLE WARNING SURFACES SHALL EXTEND 2.0 FT MINIMUM IN THE DIRECTION OF PEDESTRIAN TRAVEL. AT CURB RAMP AND BLENDED TRANSITIONS, DETECTABLE WARNING SURFACES SHALL EXTEND THE FULL WIDTH OF THE RAMP RUN (EXCLUDING ANY FLARES) OR BLENDED TRANSITIONS. SOME DETECTABLE WARNING PRODUCTS REQUIRE A CONCRETE BORDER FOR PROPER INSTALLATION. THE CONCRETE BORDER SHALL NOT EXCEED 2 INCHES.

ALL ELEVATIONS REFERRING TO U.S.G.S. MEAN SEA LEVEL DATUM.

ABANDONED UNDERGROUND UTILITIES THAT CONFLICT WITH CONSTRUCTION SHALL BE DISPOSED OF OUTSIDE THE LIMITS OF THE RIGHT OF WAY ACCORDING TO ARTICLE 202.03 OF THE STANDARD SPECIFICATIONS AND AS DIRECTED BY THE ENGINEER. THIS WORK WILL NOT BE PAID FOR SEPARATELY, BUT WILL BE INCLUDED IN THE COST OF EARTH EXCAVATION (SPECIAL).

ANY REFERENCE TO A STANDARD IN THESE PLANS SHALL BE INTERPRETED TO MEAN THE EDITION AS INDICATED BY THE SUBNUMBER SHOWN IN THE LIST OF STANDARDS OR THE COPY INCLUDED IN THESE PLANS.

THE FOLLOWING RATES OF APPLICATION HAVE BEEN USED IN CALCULATING PLAN QUANTITIES:

GRANULAR MATERIALS	1.80	TONS / CU YD
HMA RESURFACING	112	LBS / SQ YD / IN
SHORT TERM PAVEMENT MARKING	10	FT /100 FT OF APPLICATION
MIX FOR CRACKS, JTS & FLGWYS	0.0003	TONS / SQ YD
LEVEL BINDER (HAND METHOD)	0.0005	TONS / SQ YD
SUPPLEMENTAL WATERING	3	GAL / SQ YD / APPLICATION
CALCIUM CHLORIDE	2	LB / SQ YD / APPLICATION
AGGREGATE DITCH CHECKS	5	TONS AGGREGATE

ALL DAMAGE TO DEPARTMENT OWNED UNDERGROUND FACILITIES, CAUSED BY THE CONTRACTOR SHALL BE REPAIRED TO THE SATISFACTION OF THE DEPARTMENT AT THE CONTRACTOR'S EXPENSE. THIS SHALL INCLUDE ALL TEMPORARY REPAIRS REQUIRED TO KEEP THE FACILITY OPERATIONAL WHILE MATERIAL IS BEING OBTAINED TO MAKE PERMANENT REPAIRS. SPLICING OF ELECTRIC CABLE WILL NOT BE ALLOWED. ELECTRIC CABLE SHALL BE REPLACED FROM POLE TO POLE OR CONTROLLER.

THE WORK REQUIRED TO CONNECT ANY SEWER TO AN EXISTING DRAINAGE STRUCTURE OR PIPE WILL NOT BE PAID FOR SEPARATELY, BUT WILL BE CONSIDERED AS INCLUDED IN THE CONTRACT UNIT PRICE BID FOR THE SEWER ITEMS.

MEMBERS OF JULIE KNOWN TO BE WITHIN THE LIMITS OF THE IMPROVEMENT ARE:
VILLAGE OF NEWARK
AMEREN IP
AT&T
COMCAST
NICOR GAS

THE CONTRACTOR SHALL CONTACT JULIE AT LEAST 48 HOURS PRIOR TO EXCAVATION TO DETERMINE WHICH UTILITIES ARE IN THE AREA.

'RESTORATION' CALLOUT IN THE PLANS CONSISTS OF THE FOLLOWING PAY ITEMS: TOPSOIL FURNISHING AND PLACEMENT, 4"; SEEDING, CLASS 1; FERTILIZER NUTRIENTS (NITROGEN, PHOSPHORUS AND POTASSIUM); AND EROSION CONTROL BLANKET

THE PAY LIMITS FOR PAY ITEMS ASSOCIATED WITH RESTORATION SHALL EXTEND A MAXIMUM WIDTH OF 2 FEET FROM THE EDGE OF PROPOSED SIDEWALK. ANY DISTURBANCE BEYOND THESE LIMITS SHALL BE RESTORED AT THE CONTRACTOR'S EXPENSE.

WHEN THE PLANS OR SPECIAL PROVISIONS INCLUDE INFORMATION PERTAINING TO THE LOCATION OF UNDERGROUND UTILITY FACILITIES, SUCH INFORMATION REPRESENTS ONLY THE OPINION OF THE VILLAGE OF NEWARK AS TO THE LOCATION OF SUCH UTILITIES AND IS ONLY INCLUDED FOR THE CONVENIENCE OF THE BIDDER.

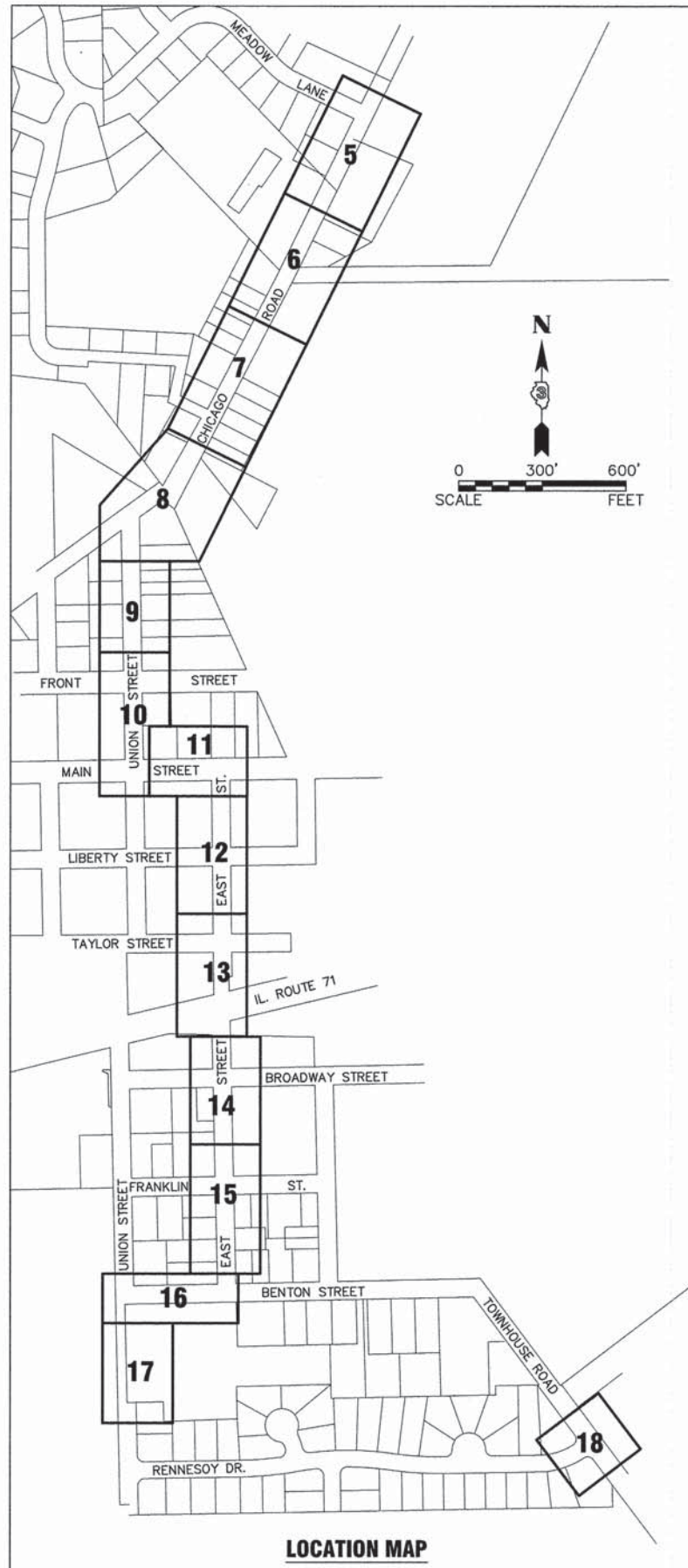

INDEX OF SHEETS

SHEET NO.	SHEET DESCRIPTION
1.	COVER SHEET AND LOCATION MAP
2.	GENERAL NOTES, HIGHWAY STANDARDS, SUPPLEMENTAL LEGEND AND INDEX OF SHEETS
3.	SUMMARY OF QUANTITIES
4.	TYPICAL SECTIONS
5.-18.	PLAN AND PROFILES
19.	MISCELLANEOUS DETAILS

HIGHWAY STANDARDS

STD. NO.	DESCRIPTION
00001-06	STANDARD SYMBOLS, ABBREVIATIONS, AND PATTERNS
424001-08	PERPENDICULAR CURB RAMP FOR SIDEWALKS
424011-02	CORNER PARALLEL CURB RAMP FOR SIDEWALKS
424021-03	DEPRESSED CORNER FOR SIDEWALKS
442201-03	CLASS C AND D PATCHES
542401-01	METAL END SECTION FOR PIPE CULVERTS
606001-06	CONCRETE CURB TYPE B AND COMBINATION CONCRETE CURB AND GUTTER
701201-04	LANE CLOSURE, 2L, 2W, DAY ONLY, FOR SPEEDS ≥ 45 MPH
701301-04	LANE CLOSURE, 2L, 2W, SHORT TIME OPERATIONS
701501-06	URBAN LANE CLOSURE, 2L, 2W, UNDIVIDED
701801-05	SIDEWALK, CORNER OR SIDEWALK CLOSURE
701901-04	TRAFFIC CONTROL DEVICES
780001-05	TYPICAL PAVEMENT MARKINGS

SUPPLEMENTAL LEGEND

SEE IDOT HIGHWAY STANDARDS FOR ADDITIONAL INFORMATION

- SIDEWALK OR DRIVEWAY REMOVAL
- CLASS D PATCHES, 4"
- EXISTING COMBINATION CONCRETE CURB AND GUTTER
- COMBINATION CONCRETE CURB AND GUTTER REMOVAL AND REPLACEMENT

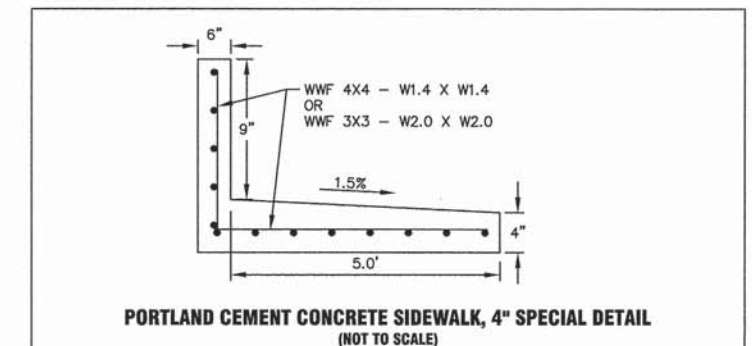

FILE NAME = H:\SDSKPROJ\NET1004\DWG\FINAL\ENG\NET1004-CVR
 Plotted: February 5, 2015 @ 3:30 PM By: Larry Nolan - Model Name: 02 Index 22x34
 COPYRIGHT © 2015 ENGINEERING ENTERPRISES, INC.

Engineering Enterprises, Inc.
CONSULTING ENGINEERS
52 Wheeler Road
Sugar Grove, Illinois 60554
630.466.6700 / www.eeiweb.com

USER NAME = Larry Nolan	DESIGNED - T.A.W.	REVISED -
PLOT SCALE =	DRAWN - J.P.S.	REVISED -
PLOT DATE = February 5, 2015 @ 3:30 PM	CHECKED - T.V.W.	REVISED -
	DATE - 12/29/14	REVISED -

**VILLAGE OF NEWARK
KENDALL COUNTY, ILLINOIS**

**GENERAL NOTES, HIGHWAY STANDARDS,
SUPPLEMENTAL LEGEND AND INDEX OF SHEETS**

SCALE: N.T.S. SHEET 1 OF 1 SHEETS STA. TO STA.

F.A.U. RTE.	SECTION	COUNTY	TOTAL SHEETS	SHEET NO.
	I2-00001-00-SW	KENDALL	19	2
FED. ROAD DIST. NO. 3 ILLINOIS FED. AID PROJECT			CONTRACT NO. 87612	

SUMMARY OF QUANTITIES

SPECIALTY ITEM SPECIAL PROVISIONS	CODE NUMBER	PAY ITEM	UNIT	QUANTITY CONSTRUCTION TYPE CODE 0021
	20100110	TREE REMOVAL (6 TO 15 UNITS DIAMETER)	UNIT	24
	20101200	TREE ROOT PRUNING	EACH	27
	20800150	TRENCH BACKFILL	CU YD	6
Δ	21101615	TOPSOIL FURNISH AND PLACE, 4"	SQ YD	3,339
	21400100	GRADING AND SHAPING DITCHES	FOOT	446
Δ	25000100	SEEDING, CLASS 1	ACRE	0.7
Δ	25000400	NITROGEN FERTILIZER NUTRIENT	POUND	64
Δ	25000500	PHOSPHORUS FERTILIZER NUTRIENT	POUND	64
Δ	25000600	POTASSIUM FERTILIZER NUTRIENT	POUND	64
Δ	25100630	EROSION CONTROL BLANKET	SQ YD	3,339
	28000305	TEMPORARY DITCH CHECKS	FOOT	30
	28000500	INLET AND PIPE PROTECTION	EACH	10
	35101400	AGGREGATE BASE COURSE, TYPE B	TON	401
	40200800	AGGREGATE SURFACE COURSE, TYPE B	TON	30
	42400100	PORTLAND CEMENT CONCRETE SIDEWALK 4 INCH	SQ FT	26,861
	42400300	PORTLAND CEMENT CONCRETE SIDEWALK 6 INCH	SQ FT	1,558
	42400800	DETECTABLE WARNINGS	SQ FT	450
	44000200	DRIVEWAY PAVEMENT REMOVAL	SQ YD	76
	44000500	COMBINATION CURB AND GUTTER REMOVAL	FOOT	21
	44000600	SIDEWALK REMOVAL	SQ FT	2,200
	44201694	CLASS D PATCHES, TYPE III, 4 INCH	SQ YD	16
	50105220	PIPE CULVERT REMOVAL	FOOT	47
	54200213	PIPE CULVERTS, CLASS C, TYPE 1 8"	FOOT	45
	54200217	PIPE CULVERTS, CLASS C, TYPE 1 12"	FOOT	102
	54200220	PIPE CULVERTS, CLASS C, TYPE 1 15"	FOOT	24
	54215547	METAL END SECTIONS 12"	EACH	9
	54215550	METAL END SECTIONS 15"	EACH	1
	60608300	COMBINATION CONCRETE CURB AND GUTTER, TYPE M-2 12	FOOT	21
	67100100	MOBILIZATION	L SUM	1
	70100450	TRAFFIC CONTROL AND PROTECTION, STANDARD 701201	L SUM	1
	70102620	TRAFFIC CONTROL AND PROTECTION, STANDARD 701501	L SUM	1
	70102640	TRAFFIC CONTROL AND PROTECTION, STANDARD 701801	L SUM	1
	72000100	SIGN PANEL - TYPE 1	SQ FT	25
	72400100	REMOVE SIGN PANEL ASSEMBLY - TYPE A	EACH	2
	72400500	RELOCATE SIGN PANEL ASSEMBLY - TYPE A	EACH	11
	72800100	TELESCOPING STEEL SIGN SUPPORT	FOOT	30
Δ *	78000400	THERMOPLASTIC PAVEMENT MARKING - LINE 6"	FOOT	1,113
Δ *	78000600	THERMOPLASTIC PAVEMENT MARKING - LINE 12"	FOOT	997
Δ *	78000650	THERMOPLASTIC PAVEMENT MARKING - LINE 24"	FOOT	53
Δ *	78300100	PAVEMENT MARKING REMOVAL	SQ FT	187
Δ	X2020410	EARTH EXCAVATION (SPECIAL)	CU YD	661
Δ	X4240420	PORTLAND CEMENT CONCRETE SIDEWALK 4 INCH, SPECIAL	SQ FT	523
Δ *	X6640535	CHAIN LINK FENCE, 6' ATTACHED TO STRUCTURE	FOOT	100
Δ *	X8000005	WIRELESS LIGHTED PEDESTRIAN CROSSING SYSTEM	L SUM	1
Δ	Z0004510	HOT-MIX ASPHALT DRIVEWAY PAVEMENT, 3"	SQ YD	76
Δ *	Z0022810	FENCE REMOVAL (SPECIAL)	FOOT	80

Δ INDICATES SPECIALTY ITEM
* SEE SPECIAL PROVISIONS

Plotted: February 6, 2015 @ 12:12 PM By: Kris Pung - Model Name: 03_Sum of Quan 22x34

FILE NAME = H:\SDSKPROJ\NE1004\DWG_FINAL_ENG\NE1004-CVR

COPYRIGHT © 2015 ENGINEERING ENTERPRISES, INC.



Engineering Enterprises, Inc.
CONSULTING ENGINEERS
52 Wheeler Road
Sugar Grove, Illinois 60554
630.466.6700 / www.eeiweb.com

USER NAME = Kris Pung	DESIGNED - T.A.W.	REVISED -
PLOT SCALE =	DRAWN - J.P.S.	REVISED -
PLOT DATE = February 6, 2015 @ 12:12 PM	CHECKED - T.V.W.	REVISED -
	DATE - 12/29/14	REVISED -

VILLAGE OF NEWARK
KENDALL COUNTY, ILLINOIS

SUMMARY OF QUANTITIES

SCALE: N.T.S. SHEET 1 OF 1 SHEETS STA. TO STA.

F.A.U. RTE.	SECTION	COUNTY	TOTAL SHEETS	SHEET NO.
	12-00001-00-SW	KENDALL	19	3
FED. ROAD DIST. NO. 3 ILLINOIS FED. AID PROJECT			CONTRACT NO. 87612	

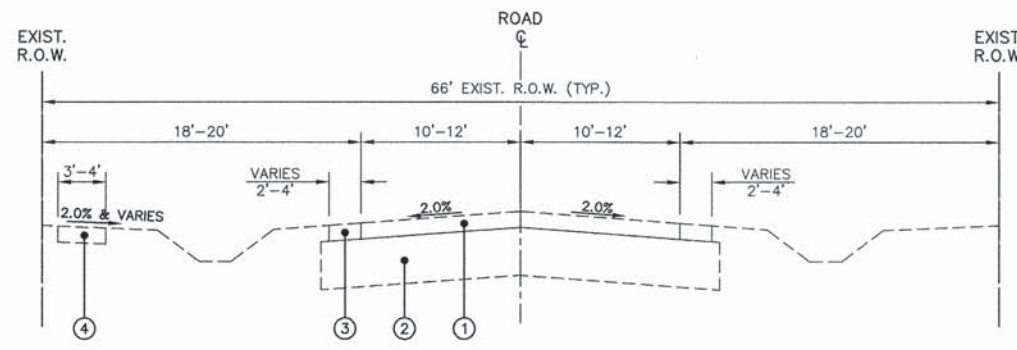

EXISTING TYPICAL SECTION
 CHICAGO ROAD - NEWARK HIGH SCHOOL ENTRANCE TO UNION STREET
 UNION STREET - MAIN STREET TO CHICAGO ROAD
 EAST STREET - MAIN STREET TO BROADWAY STREET
 RENNESOY DRIVE AT UNION STREET / NORWAY STREET AND TOWNHOUSE ROAD
 UNION STREET - 200' NORTH OF RENNESOY DRIVE TO RENNESOY DRIVE
 N.T.S.

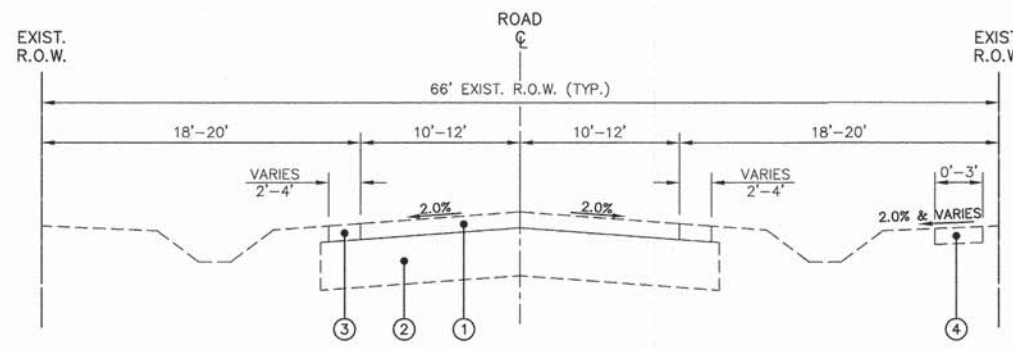

EXISTING TYPICAL SECTION
 CHICAGO ROAD - MEADOW LANE TO NEWARK HIGH SCHOOL ENTRANCE
 MAIN STREET - UNION STREET TO EAST STREET
 EAST STREET - BENTON STREET TO BROADWAY STREET
 N.T.S.

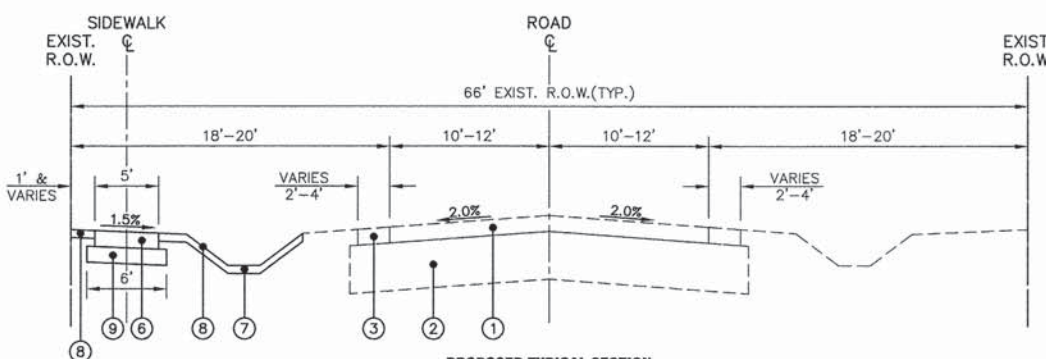

PROPOSED TYPICAL SECTION
 CHICAGO ROAD - NEWARK HIGH SCHOOL ENTRANCE TO UNION STREET
 UNION STREET - MAIN STREET TO CHICAGO ROAD
 EAST STREET - MAIN STREET TO BROADWAY STREET
 RENNESOY DRIVE AT UNION STREET / NORWAY STREET AND TOWNHOUSE ROAD
 UNION STREET - 200' NORTH OF RENNESOY DRIVE TO RENNESOY DRIVE
 N.T.S.

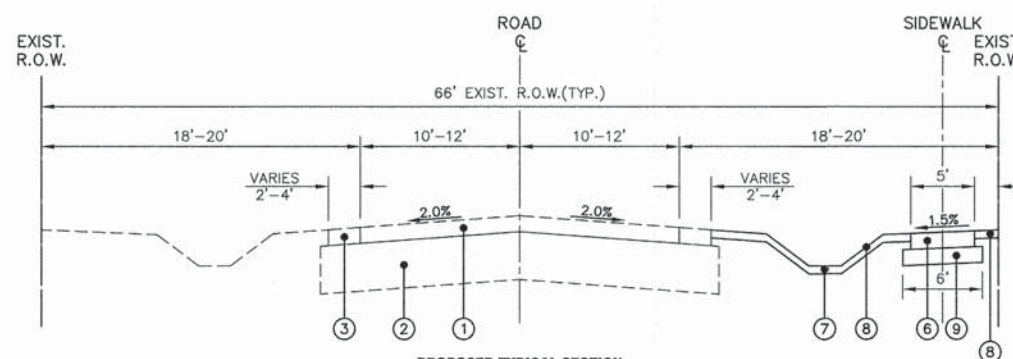

PROPOSED TYPICAL SECTION
 CHICAGO ROAD - MEADOW LANE TO NEWARK HIGH SCHOOL ENTRANCE
 MAIN STREET - UNION STREET TO EAST STREET
 EAST STREET - BENTON STREET TO BROADWAY STREET
 N.T.S.

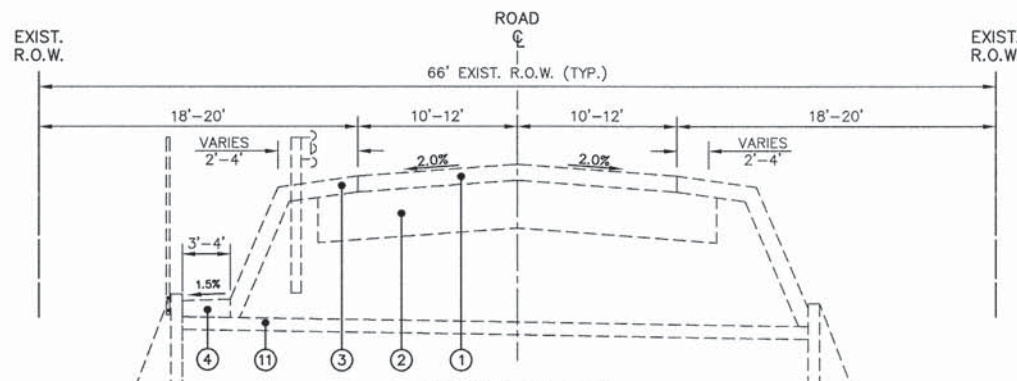

EXISTING TYPICAL SECTION
 CHICAGO ROAD - STA. 15+96 TO STA. 16+92
 N.T.S.

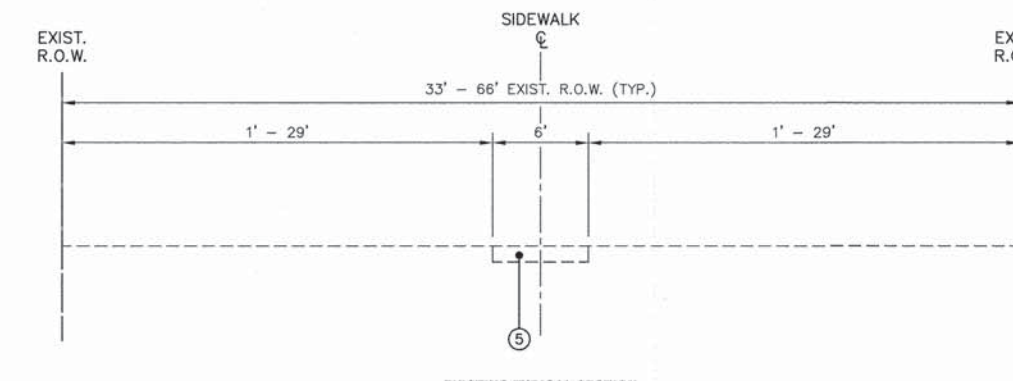

EXISTING TYPICAL SECTION
 BENTON STREET R.O.W. - UNION STREET R.O.W. TO EAST STREET
 UNION STREET R.O.W. - BENTON STREET TO 200' NORTH OF RENNESOY DRIVE
 N.T.S.

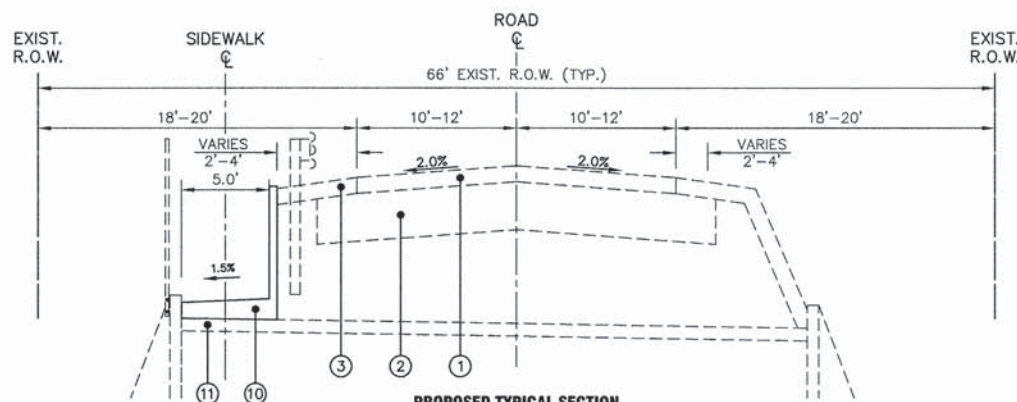

PROPOSED TYPICAL SECTION
 CHICAGO ROAD - STA. 15+96 TO STA. 16+92
 N.T.S.

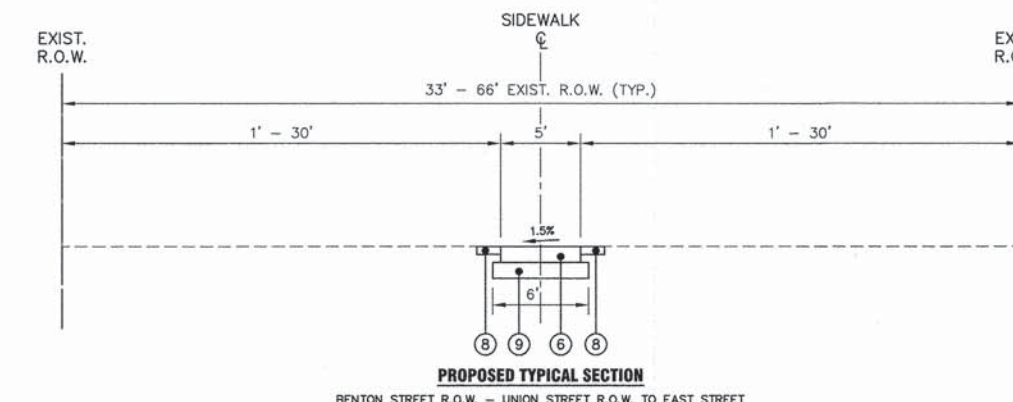

PROPOSED TYPICAL SECTION
 BENTON STREET R.O.W. - UNION STREET R.O.W. TO EAST STREET
 UNION STREET R.O.W. - BENTON STREET TO 200' NORTH OF RENNESOY DRIVE
 N.T.S.

LEGEND

- ① EXISTING 4" ASPHALT PAVEMENT
- ② EXISTING 12" AGGREGATE BASE COURSE
- ③ EXISTING AGGREGATE SHOULDER
- ④ EXISTING 3' P.C.C. SIDEWALK
- ⑤ EARTH EXCAVATION (SPECIAL) / SIDEWALK REMOVAL AND REPLACEMENT
- ⑥ PROPOSED P.C.C. SIDEWALK 4 INCH (6 INCH AT DRIVEWAYS)
- ⑦ GRADING AND SHAPING DITCHES (AS DIRECTED BY ENGINEER)
- ⑧ TOPSOIL, 4", CLASS 1 SEEDING, FERTILIZER AND EROSION CONTROL BLANKET
- ⑨ AGGREGATE BASE COURSE, TYPE B, 2"
- ⑩ P.C.C. SIDEWALK, 4 INCH, SPECIAL
- ⑪ EXISTING P.C.C. BOX CULVERT

HMA MIXTURE REQUIREMENTS

	HMA DRIVEWAYS	HMA PATCHES
PG GRADE	PG 64-22	PG 64-22
DESIGN AIR VOIDS	4.0% @ N50	4.0% @ N50
MIXTURE COMPOSITION	IL 9.5	IL 9.5
FRICTION AGGREGATE		
DENSITY TEST METHOD	SATISFACTION OF THE ENGINEER	SATISFACTION OF THE ENGINEER
MIXTURE WEIGHT	112#SQ YD./IN.	112#SQ YD./IN.
QUALITY MANAGEMENT PROGRAM	QC QA	QC QA
SUBLOT SIZE	N/A	N/A
LOCATION(S)	DRIVEWAYS	PATCHES

MATERIAL SHALL BE COMPACTED TO 93.0 - 97.4 PERCENT OF THE MAXIMUM THEORETICAL DENSITY, EXCEPT THAT WHEN PLACED AS FIRST LIFT ON AN UNIMPROVED SUBGRADE THE MINIMUM PERCENT COMPACTED SHALL BE 92.0 PERCENT. THE MAXIMUM THEORETICAL DENSITY SHALL BE DETERMINED FROM THE MOVING AVERAGE AS SPECIFIED IN THE QA/QC SPECIFICATION.

FILE NAME = H:\SDSKPROJ\NE1004\DWG_FINAL_ENG\NE1004-CVR
 PLOTTED: February 5, 2015 @ 2:14 PM By: Larry Nolan - Model Name: 04_Typ Section 22x34

Engineering Enterprises, Inc.
 CONSULTING ENGINEERS
 52 Wheeler Road
 Sugar Grove, Illinois 60554
 630.466.6700 / www.eelweb.com

USER NAME = Larry Nolan	DESIGNED - T.A.W.	REVISED -
PLOT SCALE =	DRAWN - J.P.S.	REVISED -
PLOT DATE = February 5, 2015 @ 2:14 PM	CHECKED - T.V.W.	REVISED -
	DATE - 12/29/14	REVISED -

**VILLAGE OF NEWARK
 KENDALL COUNTY, ILLINOIS**

TYPICAL SECTIONS

SCALE: N.T.S. SHEET 1 OF 1 SHEETS STA. TO STA.

F.A.U. RTE.	SECTION	COUNTY	TOTAL SHEETS	SHEET NO.
	I2-00001-00-SW	KENDALL	19	4
CONTRACT NO. 87612				
FED. ROAD DIST. NO. 3 ILLINOIS FED. AID PROJECT				

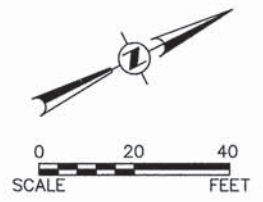
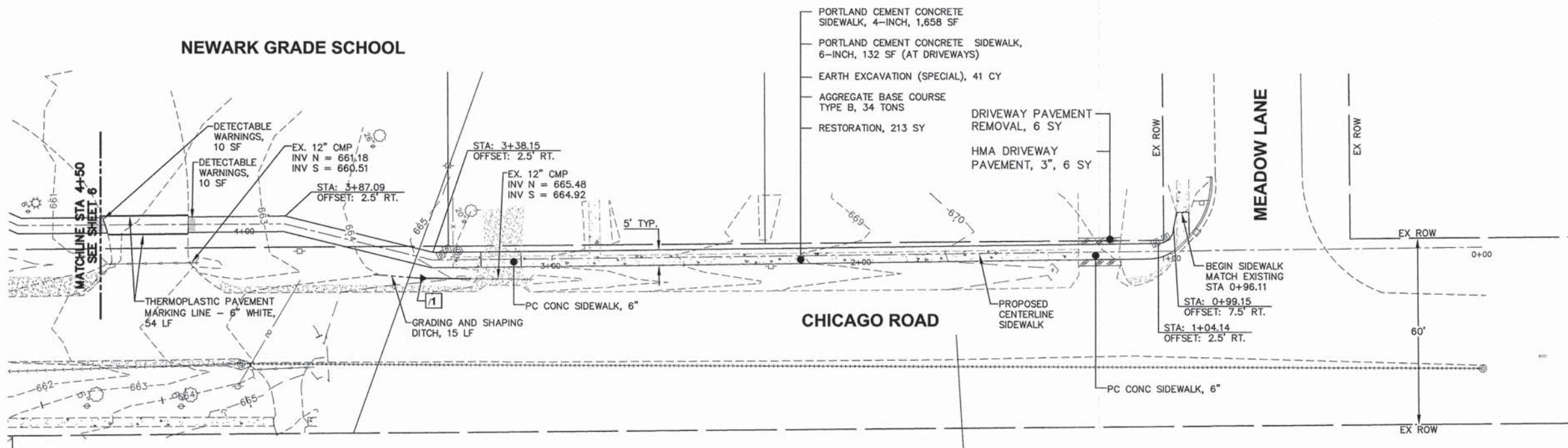

1 METAL END SECTION 12" STA. 3+40.26, 6.81 LT. INV = 664.60 16 LF PIPE CULVERTS, CLASS C, TYPE 1, 12" @ 2.00%

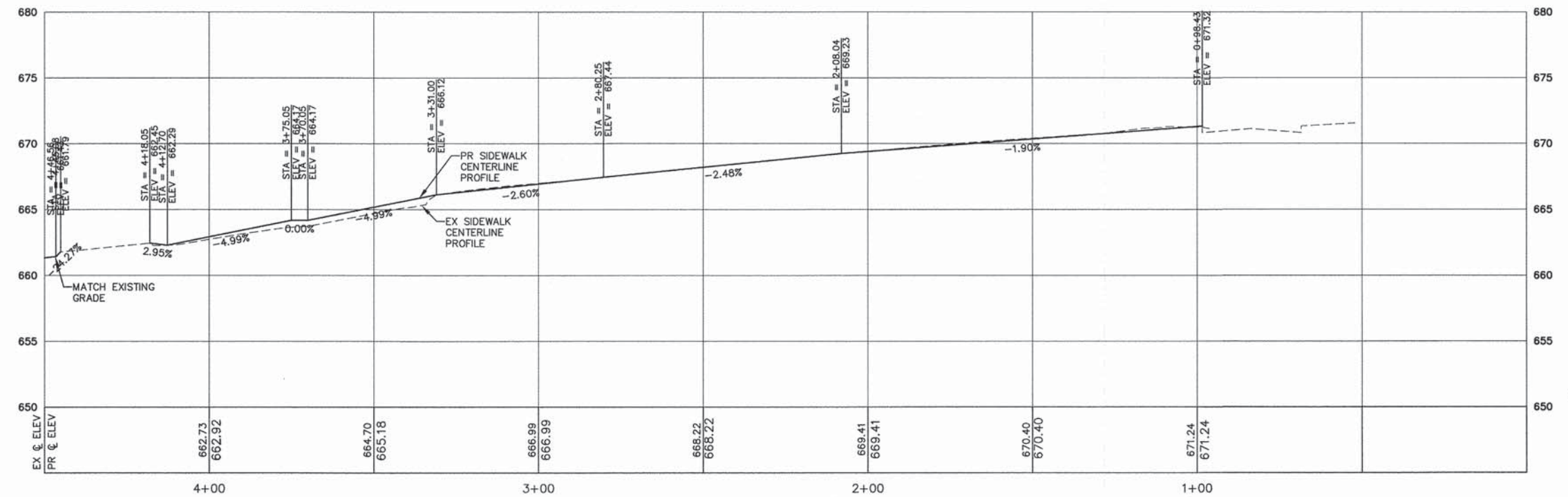

FILE NAME = H:\SSSPROJ\NET004\DWG_FINAL_ENG\NET004-P&P-NORTH
 Plotted: February 6, 2015 @ 11:22 AM By: Larry Nolan - Model Name: (05) P&P 01 (22x34)
 COPYRIGHT © 2015 ENGINEERING ENTERPRISES, INC.

Engineering Enterprises, Inc.
 CONSULTING ENGINEERS
 52 Wheeler Road
 Sugar Grove, Illinois 60554
 630.466.6700 / www.eelweb.com

USER NAME = Larry Nolan	DESIGNED - T.A.W.	REVISED -
PLOT SCALE =	DRAWN - J.P.S.	REVISED -
PLOT DATE = February 6, 2015 @ 11:22 AM	CHECKED - T.V.W.	REVISED -
	DATE - 12/29/14	REVISED -

**VILLAGE OF NEWARK
 KENDALL COUNTY, ILLINOIS**

**PLAN AND PROFILE
 CHICAGO ROAD**

SCALE: 1" = 20'
 SHEET 01 OF 14 SHEETS
 STA. 0+00 TO STA. 4+50

F.A.U. RTE.	SECTION	COUNTY	TOTAL SHEETS	SHEET NO.
	12-00001-00-SW	KENDALL	19	5
CONTRACT NO. 87612				
FED. ROAD DIST. NO. 3 ILLINOIS FED. AID PROJECT				

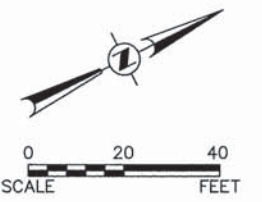
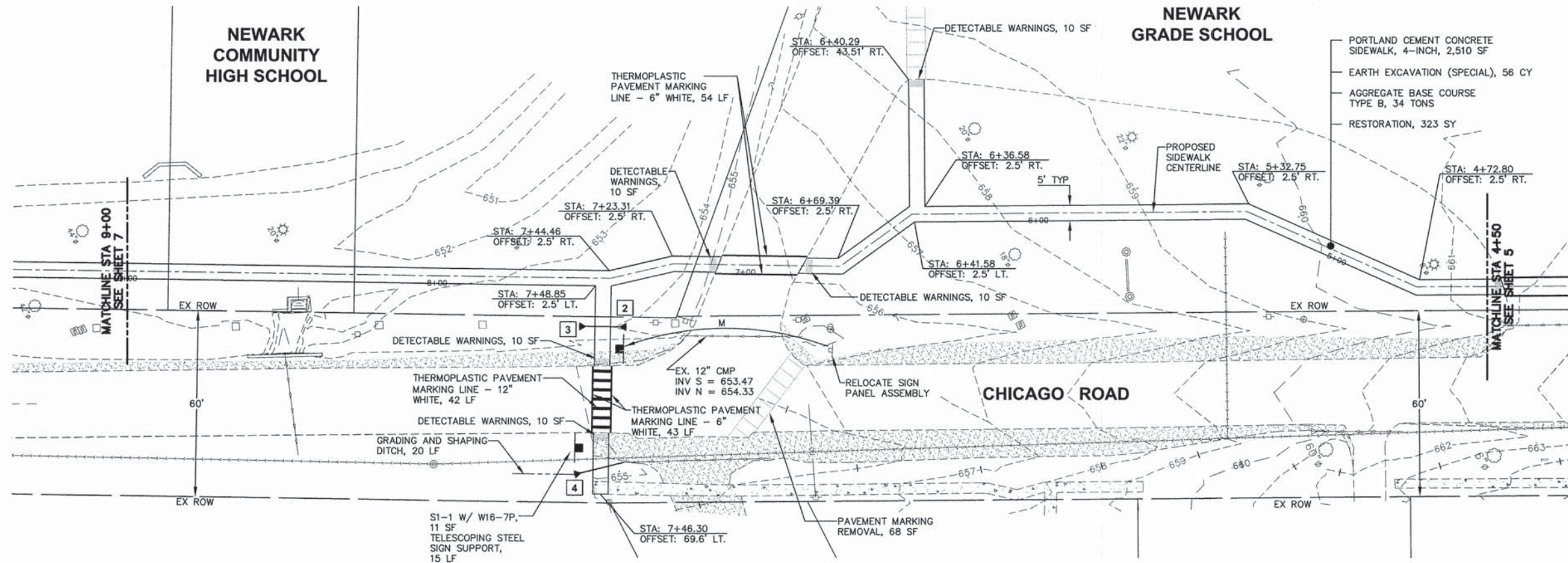

- 2 METAL END SECTION 12" STA. 7+43.0, 16.0 LT. INV = 654.00
- 3 METAL END SECTION 12" STA. 7+54.0, 15.0 LT. INV = 653.80 16 LF PIPE CULVERTS, CLASS C, TYPE 1, 12" @ 1.00%
- 4 METAL END SECTION 12" STA. 7+55.0, 63.0 LT. INV = 654.80 16 LF PIPE CULVERTS, CLASS C, TYPE 1, 12" @ 1.00%

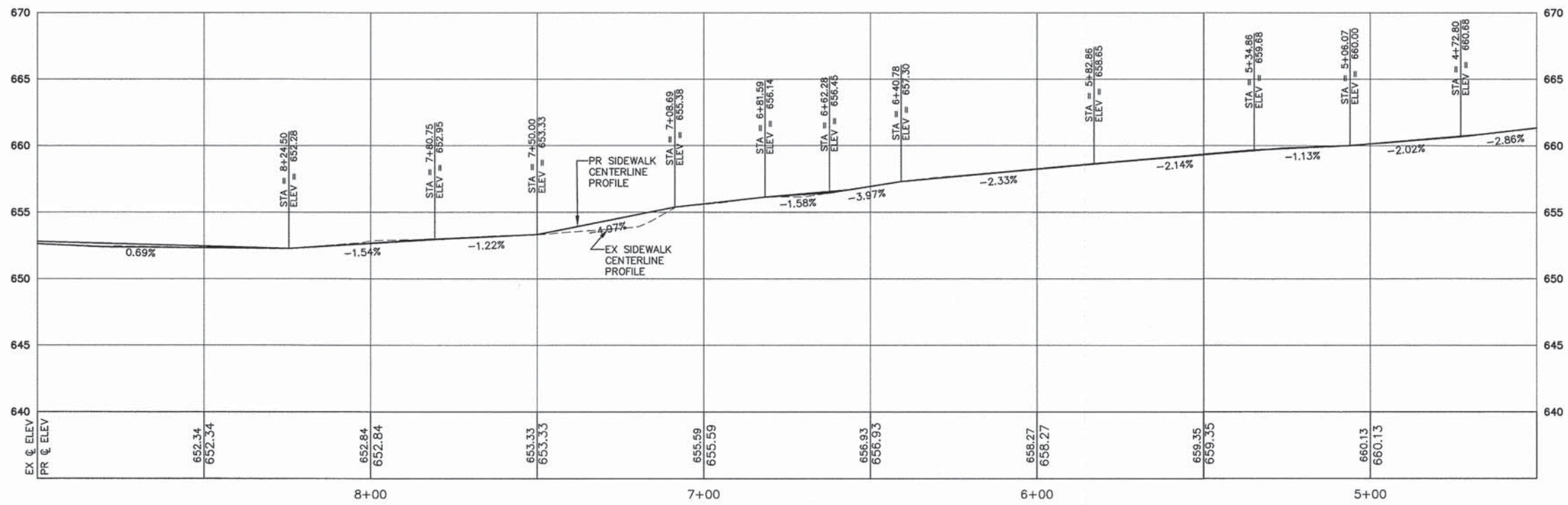

Plotted: February 6, 2015 @ 11:21 AM By: Larry Nolan - Model Name: (06) P&P 02 (22x34)
 FILE NAME = H:\SDSKPROJ\NE1004\DWG FINAL ENG\NE1004-P&P NORTH

Engineering Enterprises, Inc.
 CONSULTING ENGINEERS
 52 Wheeler Road
 Sugar Grove, Illinois 60554
 630.466.6700 / www.eeiweb.com

USER NAME = Larry Nolan	DESIGNED - T.A.W.	REVISED -
PLOT SCALE =	DRAWN - J.P.S.	REVISED -
PLOT DATE = February 6, 2015 @ 11:21 AM	CHECKED - T.V.W.	REVISED -
	DATE - 12/29/14	REVISED -

VILLAGE OF NEWARK
KENDALL COUNTY, ILLINOIS

PLAN AND PROFILE
CHICAGO ROAD

SCALE: 1" = 20' SHEET 02 OF 14 SHEETS STA. 4+50 TO STA. 9+00

F.A.U. RTE.	SECTION	COUNTY	TOTAL SHEETS	SHEET NO.
	12-00001-00-SW	KENDALL	19	6
FED. ROAD DIST. NO. 3 ILLINOIS FED. AID PROJECT				

**NEWARK
COMMUNITY
HIGH SCHOOL**

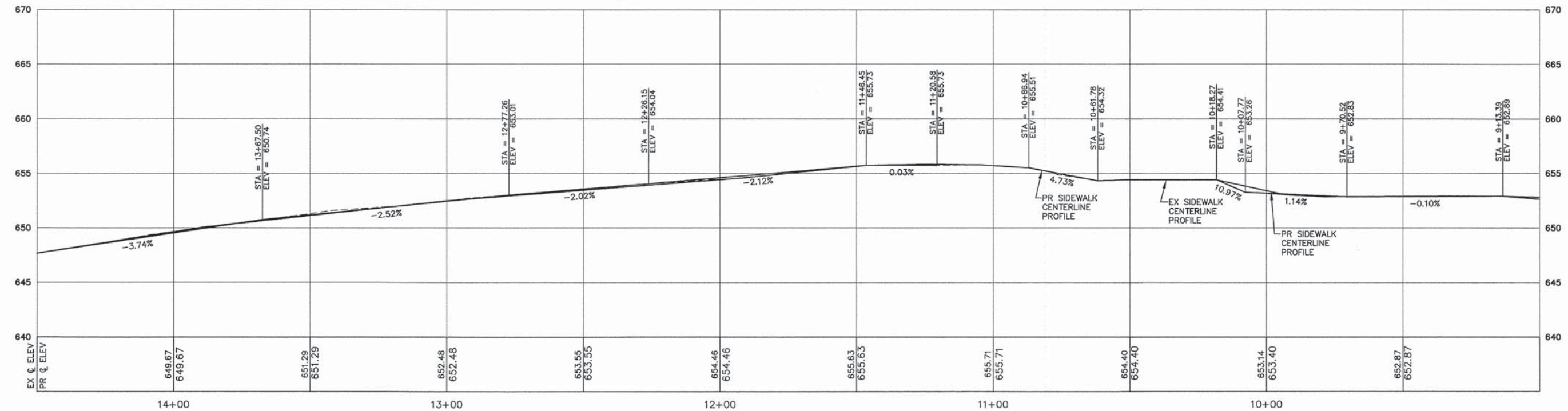
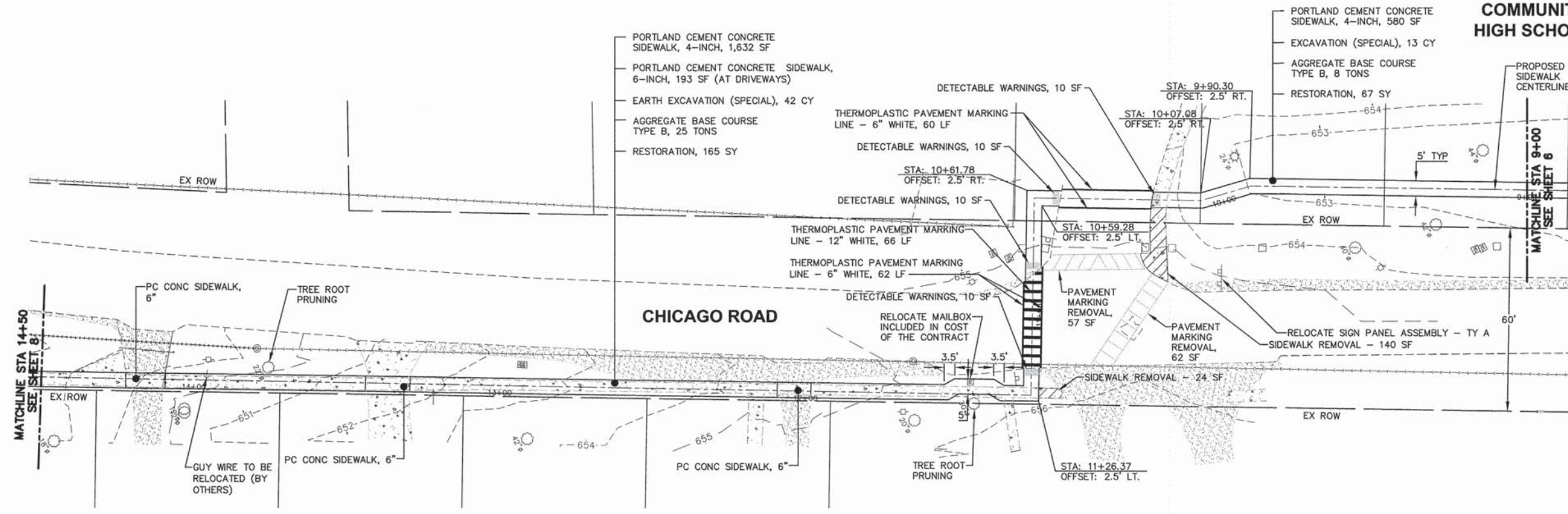
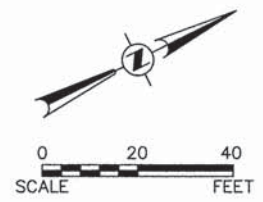

Plotted: February 6, 2015 @ 11:21 AM By: Larry Nolan - Model Name: (07) P&P 03 (22x34)
 FILE NAME = H:\SDSKPROJ\NET004\DWG_FINAL_ENG\NET004-P&P_NORTH

Engineering Enterprises, Inc.
 CONSULTING ENGINEERS
 52 Wheeler Road
 Sugar Grove, Illinois 60554
 630.466.6700 / www.eeiweb.com

USER NAME = Larry Nolan	DESIGNED - T.A.W.	REVISED -
PLOT SCALE =	DRAWN - J.P.S.	REVISED -
PLOT DATE = February 6, 2015 @ 11:21 AM	CHECKED - T.V.W.	REVISED -
	DATE - 12/29/14	REVISED -

**VILLAGE OF NEWARK
KENDALL COUNTY, ILLINOIS**

**PLAN AND PROFILE
CHICAGO ROAD**

SCALE: 1" = 20' SHEET 03 OF 14 SHEETS STA. 9+00 TO STA. 14+50

F.A.I.D. RTE.	SECTION	COUNTY	TOTAL SHEETS	SHEET NO.
	12-00001-00-SW	KENDALL	19	7
CONTRACT NO. 87612				
FED. ROAD DIST. NO. 3 ILLINOIS FED. AID PROJECT				

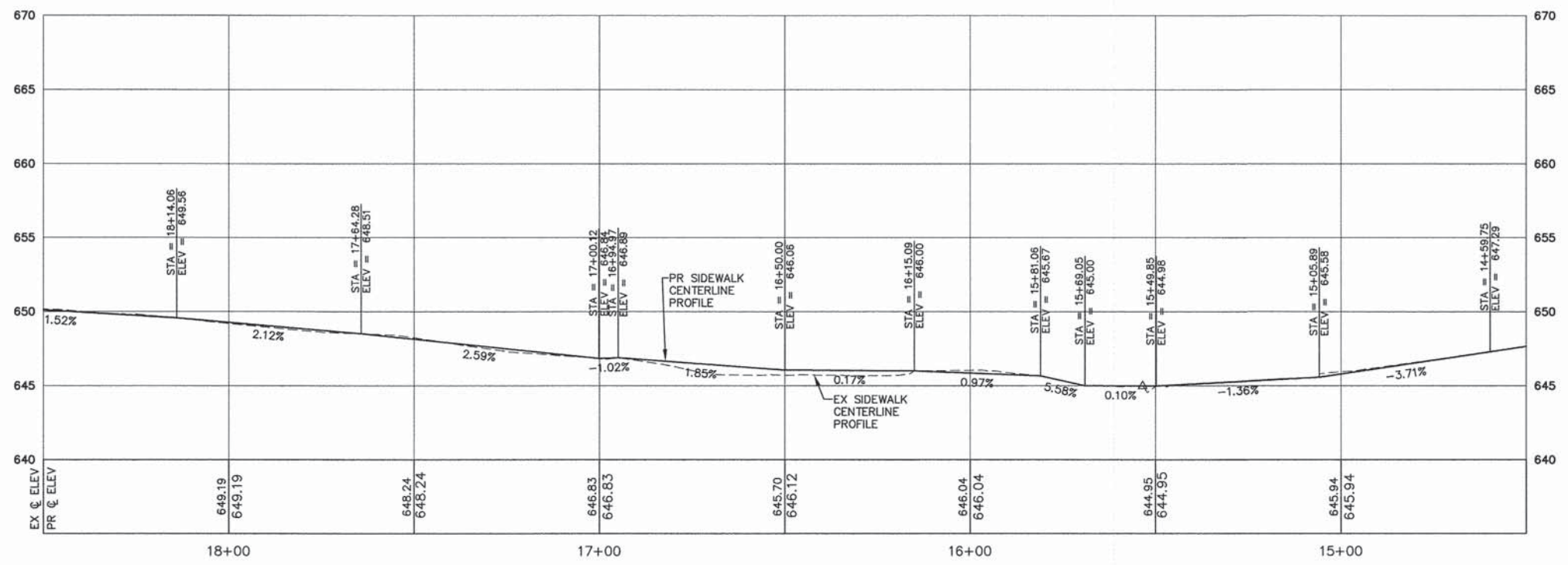
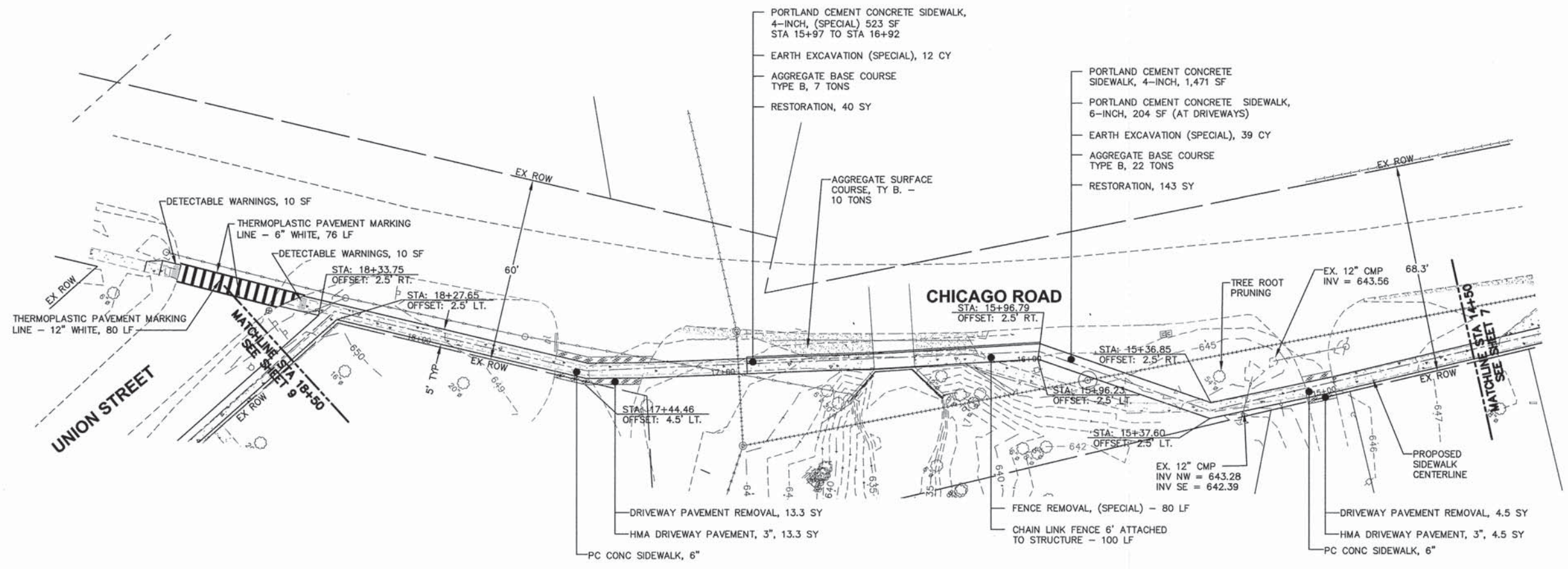
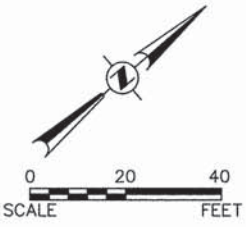

Plotted: February 6, 2015 @ 11:20 AM By: Larry Nolan - Model Name: (08) P&P 04 (22x34)

FILE NAME = H:\SDSKPROJ\NET004\DWG_FINAL_ENG\NET004-P&P_NORTH

Engineering Enterprises, Inc.
CONSULTING ENGINEERS
52 Wheeler Road
Sugar Grove, Illinois 60554
630.466.6700 / www.eelweb.com

USER NAME = Larry Nolan	DESIGNED - T.A.W.	REVISED -
PLOT SCALE =	DRAWN - J.P.S.	REVISED -
PLOT DATE = February 6, 2015 @ 11:20 AM	CHECKED - T.V.W.	REVISED -
	DATE - 12/29/14	REVISED -

**VILLAGE OF NEWARK
KENDALL COUNTY, ILLINOIS**

**PLAN AND PROFILE
CHICAGO ROAD**

SCALE: 1" = 20' SHEET 04 OF 14 SHEETS STA. 14+50 TO STA. 18+50

F.A.U. RTE.	SECTION	COUNTY	TOTAL SHEETS	SHEET NO.
	12-0001-00-SW	KENDALL	19	8
CONTRACT NO. 87612				
FED. ROAD DIST. NO. 3 ILLINOIS FED. AID PROJECT				

FILE NAME = H:\SDSKPROJ\NE1004\DWG_FINAL_ENG\NE1004-P&P-NORTH
 Plotted: February 5, 2015 @ 11:20 AM By: Larry Nolan - Model Name: (09) P&P 05 (22x34)
 COPYRIGHT © 2015 ENGINEERING ENTERPRISES, INC.

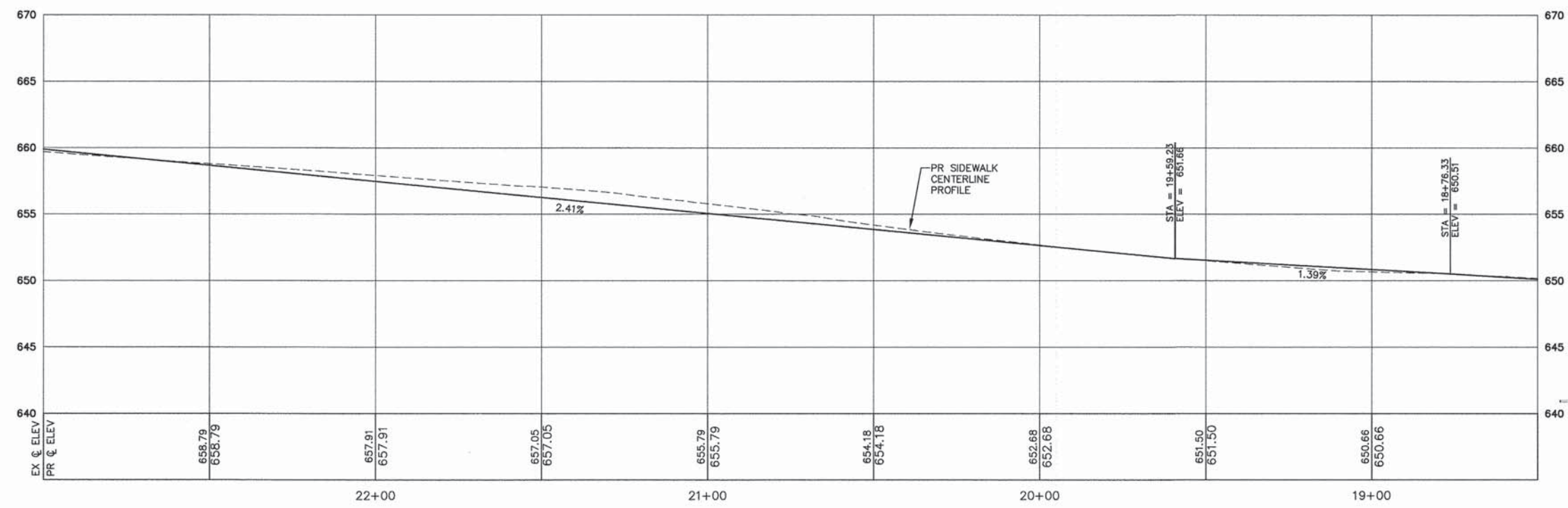
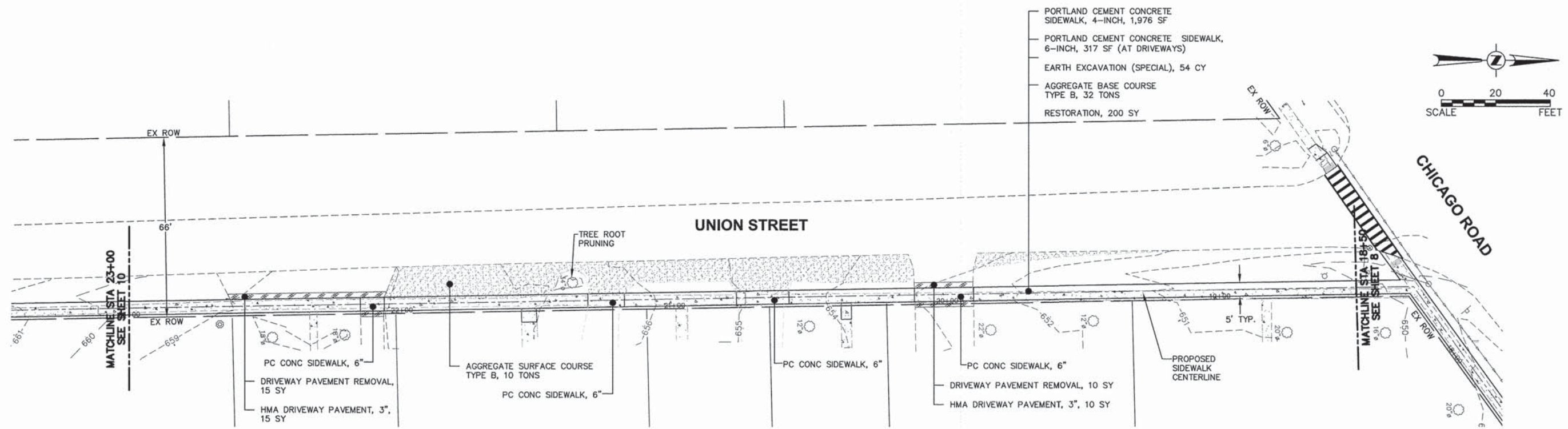

Engineering Enterprises, Inc.
 CONSULTING ENGINEERS
 52 Wheeler Road
 Sugar Grove, Illinois 60554
 630.466.6700 / www.eeiweb.com

USER NAME = Larry Nolan	DESIGNED - T.A.W.	REVISED -
PLOT SCALE =	DRAWN - J.P.S.	REVISED -
PLOT DATE = February 5, 2015 @ 11:20 AM	CHECKED - T.V.W.	REVISED -
	DATE - 12/29/14	REVISED -

VILLAGE OF NEWARK
KENDALL COUNTY, ILLINOIS

PLAN AND PROFILE
UNION STREET

SCALE: 1" = 20' SHEET 05 OF 14 SHEETS STA. 18+50 TO STA. 23+00

F.A.U. RTE.	SECTION	COUNTY	TOTAL SHEETS	SHEET NO.
	12-00001-00-SW	KENDALL	19	9
CONTRACT NO. 87612				
FED. ROAD DIST. NO. 3 ILLINOIS FED. AID PROJECT				

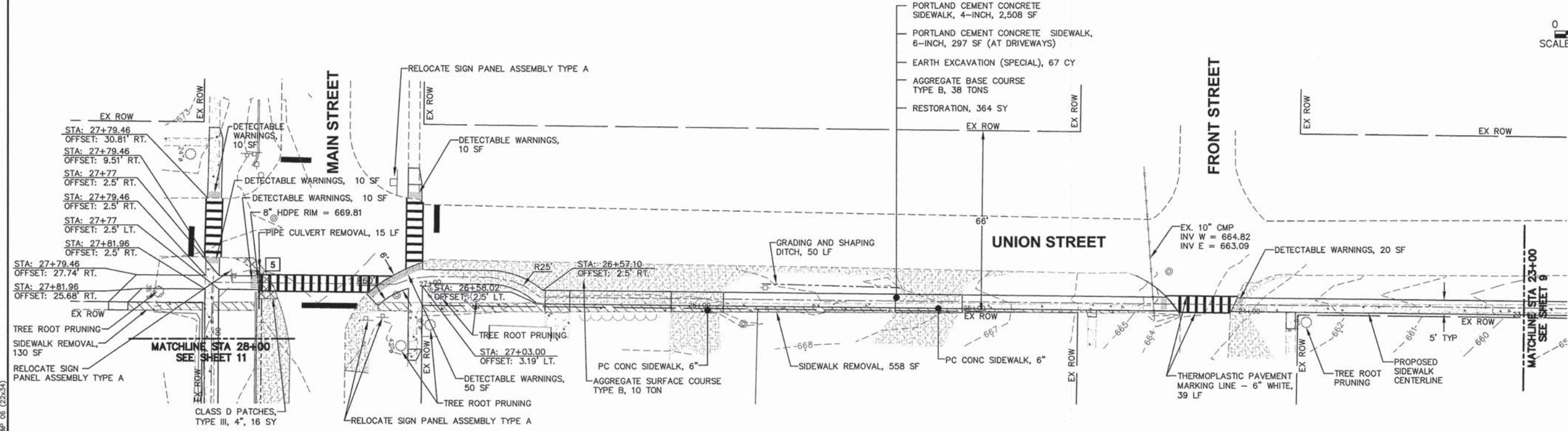
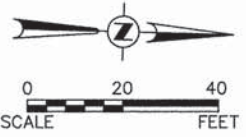

5 STA. 27+62.0, 5.0 RT.
 INV = 670.10
 15 LF PIPE CULVERTS,
 CLASS C, TYPE 1, 8"
 @ 0.50%

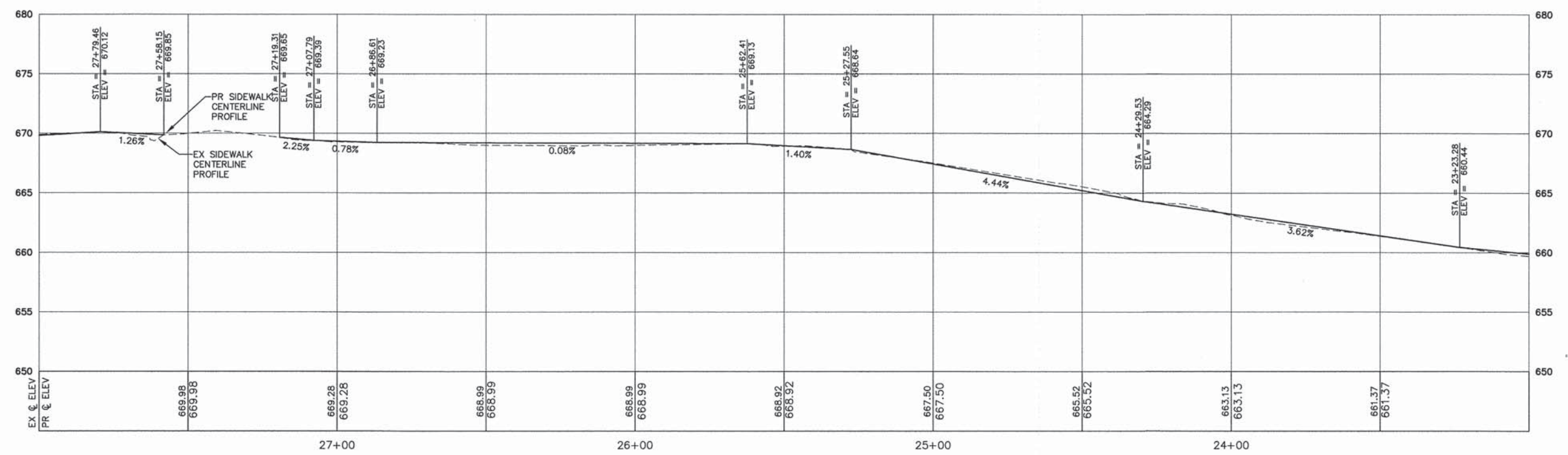

Plotted: February 6, 2015 @ 11:19 AM By: Larry Nolan - Model Name: (10) P&P 06 (22x34)

FILE NAME = H:\SDSKPROJ\NET004\DWG FINAL ENG\NET004-P&P NORTH

Engineering Enterprises, Inc.
 CONSULTING ENGINEERS
 52 Wheeler Road
 Sugar Grove, Illinois 60554
 630.466.6700 / www.eeiweb.com

USER NAME = Larry Nolan	DESIGNED - T.A.W.	REVISED -
PLOT SCALE =	DRAWN - J.P.S.	REVISED -
PLOT DATE = February 6, 2015 @ 11:19 AM	CHECKED - T.V.W.	REVISED -
	DATE - 12/29/14	REVISED -

**VILLAGE OF NEWARK
 KENDALL COUNTY, ILLINOIS**

**PLAN AND PROFILE
 UNION STREET**

SCALE: 1" = 20' SHEET 06 OF 14 SHEETS STA. 23+00 TO STA. 28+00

F.A.U. RTE.	SECTION	COUNTY	TOTAL SHEETS	SHEET NO.
	12-00001-00-SW	KENDALL	19	10
CONTRACT NO. 87612				
FED. ROAD DIST. NO. 3 ILLINOIS FED. AID PROJECT				

FILE NAME = H:\SSK\PROJ\NET004\DWG_FINAL_ENG\NET004-P&P-NORTH
 Plotted: February 6, 2015 @ 11:19 AM By: Larry Nolan - Model Name: (1) P&P 07 (22x34)
 COPYRIGHT © 2015 ENGINEERING ENTERPRISES, INC.

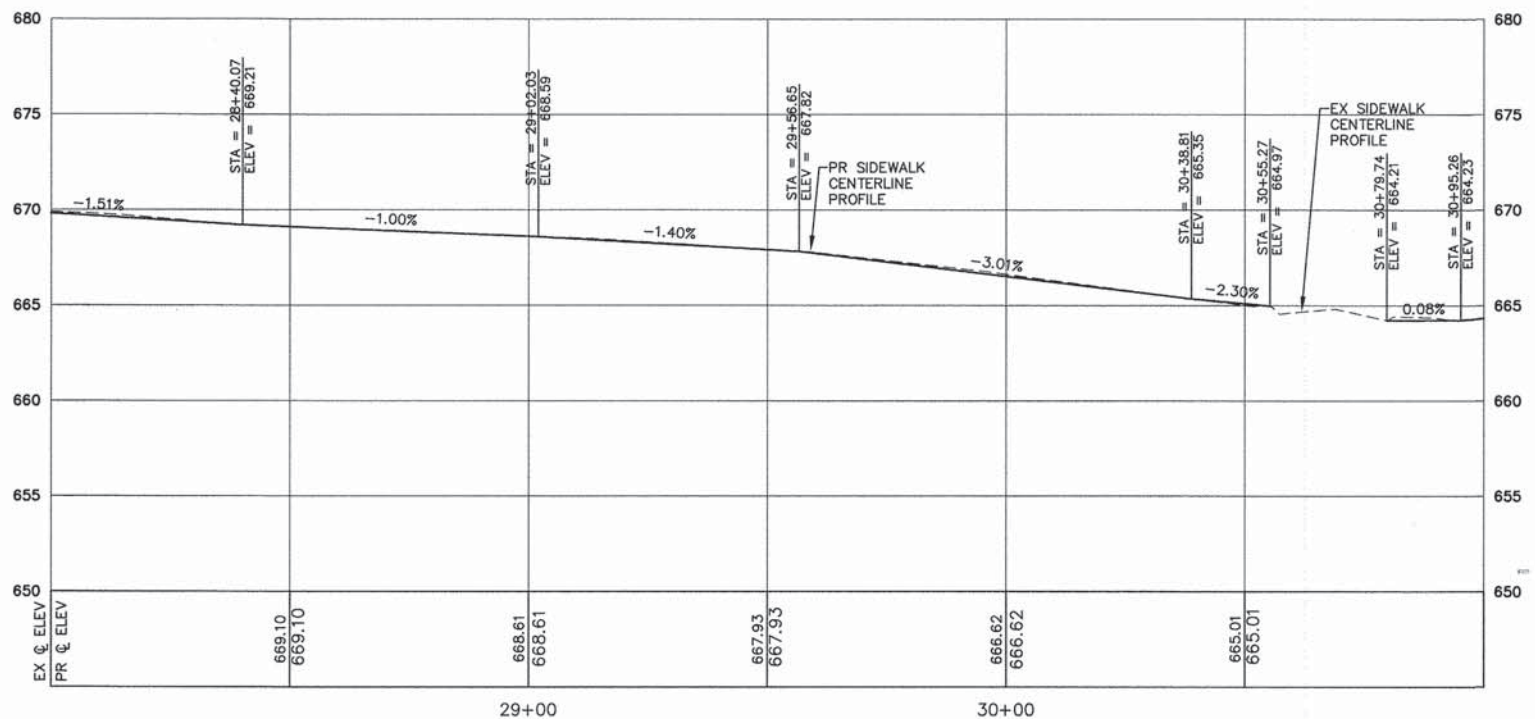
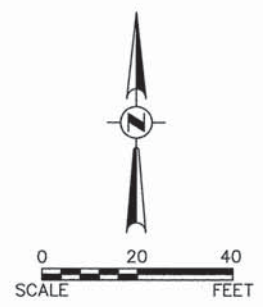
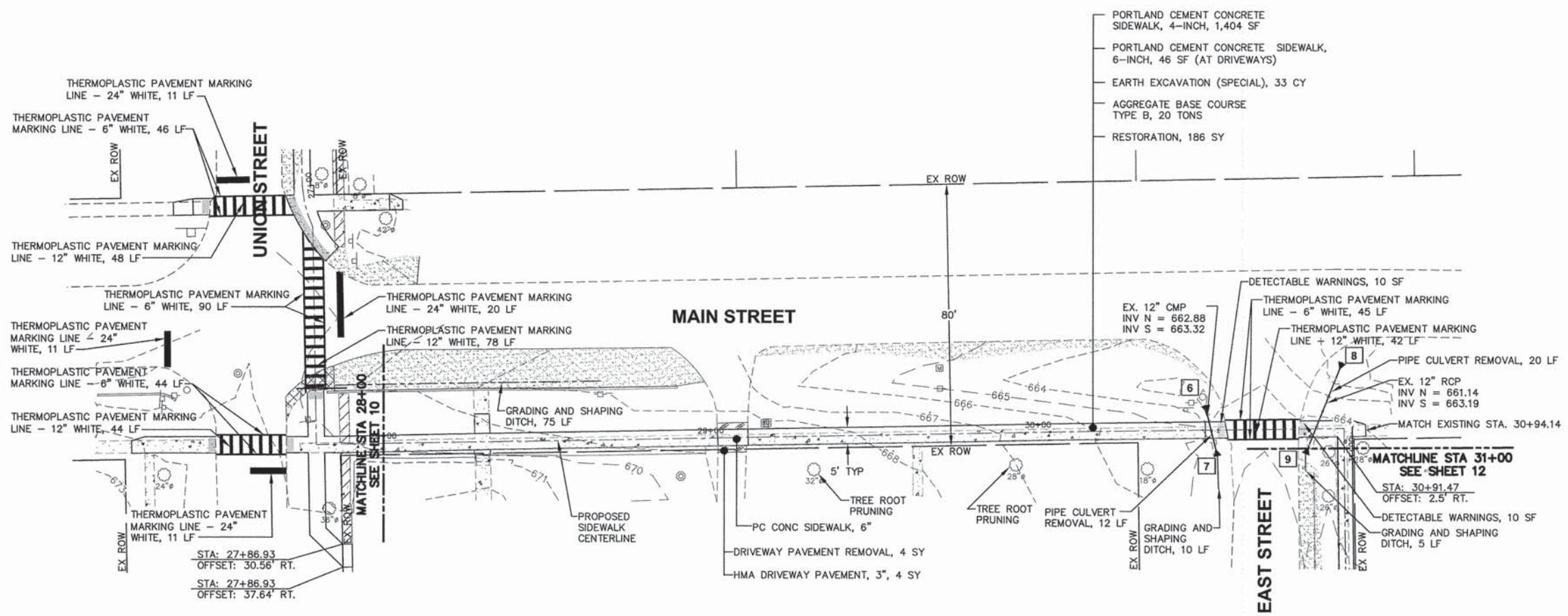

- 6 METAL END SECTION 12"
 STA. 30+51.0, 8.0 LT.
 INV = 662.75
- 7 METAL END SECTION 12"
 STA. 30+55.0, 8.0 RT.
 INV = 663.32
 16 LF PIPE CULVERTS,
 CLASS C, TYPE 1, 12"
 @ 4.00%
- 8 METAL END SECTION 12"
 STA. 30+93.0, 20.0 LT.
 INV = 662.00
- 9 METAL END SECTION 12"
 STA. 30+82.0, 8.0 RT.
 INV = 664.05
 30 LF PIPE CULVERTS,
 CLASS C, TYPE 1, 12"
 @ 7.00%

Engineering Enterprises, Inc. CONSULTING ENGINEERS 52 Wheeler Road Sugar Grove, Illinois 60554 630.466.6700 / www.eeiweb.com	USER NAME = Larry Nolan	DESIGNED - T.A.W.	REVISED -	VILLAGE OF NEWARK KENDALL COUNTY, ILLINOIS	PLAN AND PROFILE MAIN STREET		F.A.U. RTE.	SECTION	COUNTY	TOTAL SHEETS	SHEET NO.
	PLOT SCALE =	CHECKED - T.V.W.	REVISED -				12-00001-00-SW	KENDALL	19	11	
	PLOT DATE = February 6, 2015 @ 11:19 AM	DATE - 12/29/14	REVISED -				CONTRACT NO. 87612				
					SCALE: 1" = 20'		SHEET 07 OF 14 SHEETS		STA. 28+00 TO STA. 31+00		
					FED. ROAD DIST. NO. 3 ILLINOIS FED. AID PROJECT						

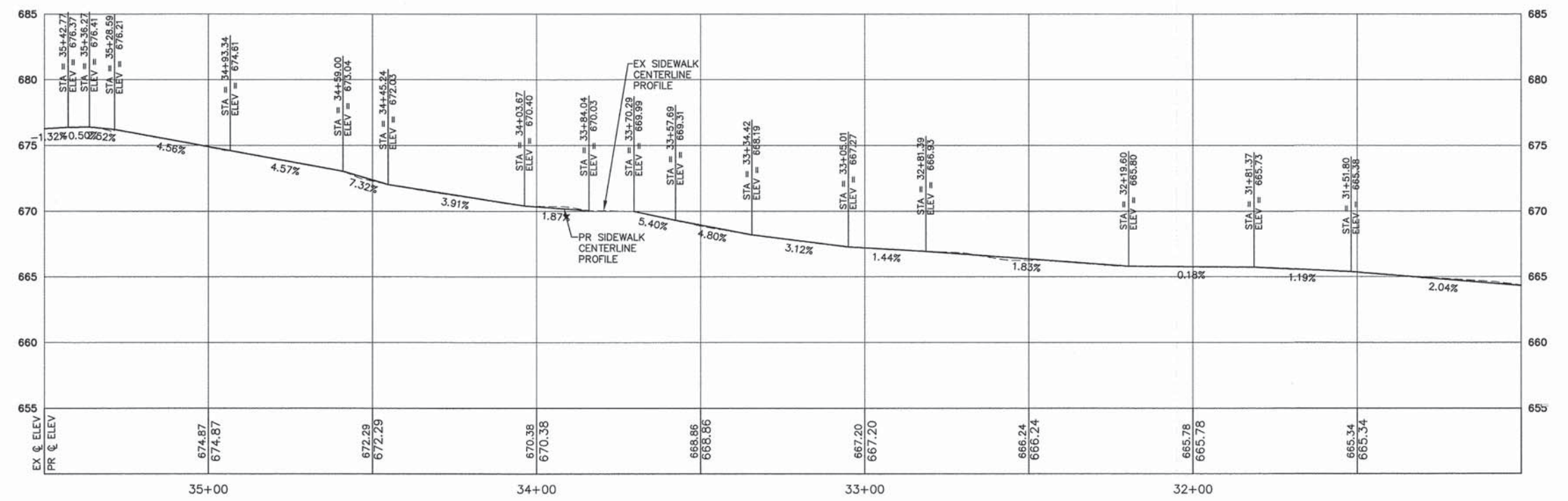
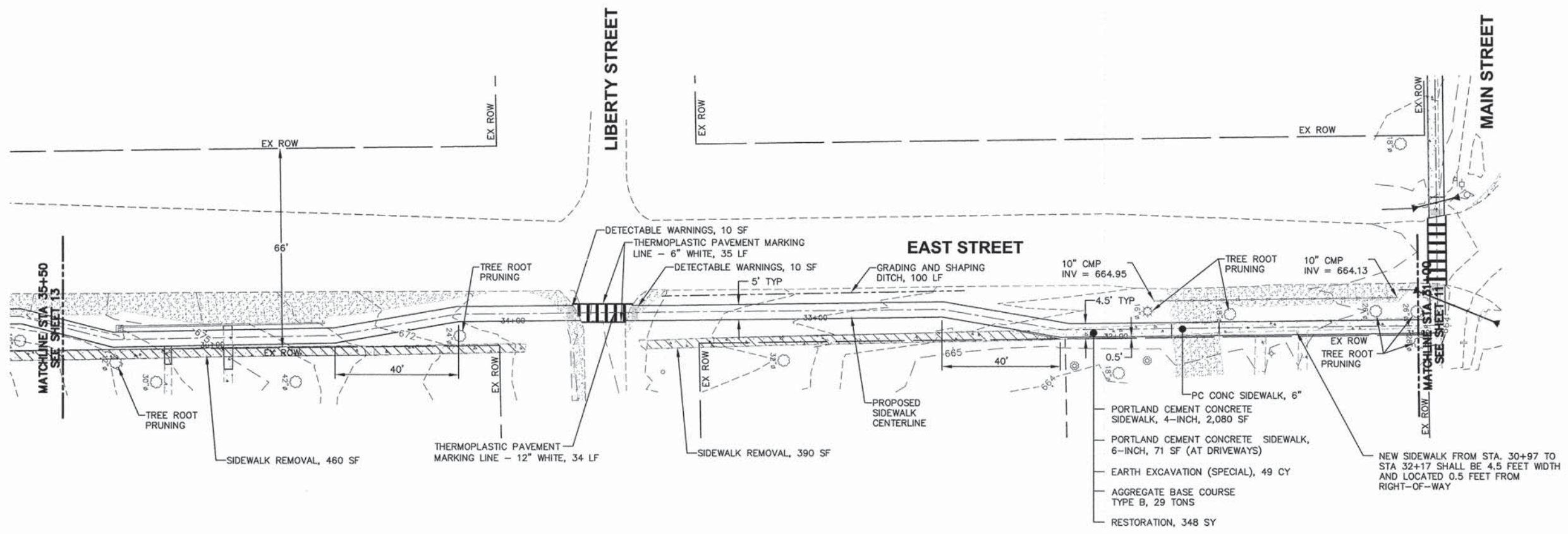
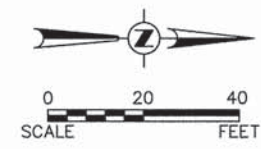

Plotted: February 6, 2015 @ 11:18 AM By: Larry Nolan - Model Name: (12) P&P 08 (22x34)

FILE NAME = H:\SDSKPROJ\NET004\DWG\FINAL\ENG\NET004-P&P-NORTH

Engineering Enterprises, Inc. CONSULTING ENGINEERS 52 Wheeler Road Sugar Grove, Illinois 60554 630.466.6700 / www.eeiweb.com	USER NAME = Larry Nolan	DESIGNED - T.A.W.	REVISED -	VILLAGE OF NEWARK KENDALL COUNTY, ILLINOIS	PLAN AND PROFILE EAST STREET		F.A.U. RTE.	SECTION	COUNTY	TOTAL SHEETS	SHEET NO.
	PLOT SCALE =	CHECKED - T.V.W.	REVISED -				12-00001-00-SW	KENDALL	19	12	
	PLOT DATE = February 6, 2015 @ 11:18 AM	DATE - 12/29/14	REVISED -				CONTRACT NO. 87612				
SCALE: 1" = 20'					SHEET 08	OF 14 SHEETS	STA. 31+00	TO STA. 35+00		FED. ROAD DIST. NO. 3 ILLINOIS FED. AID PROJECT	

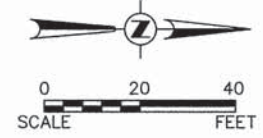
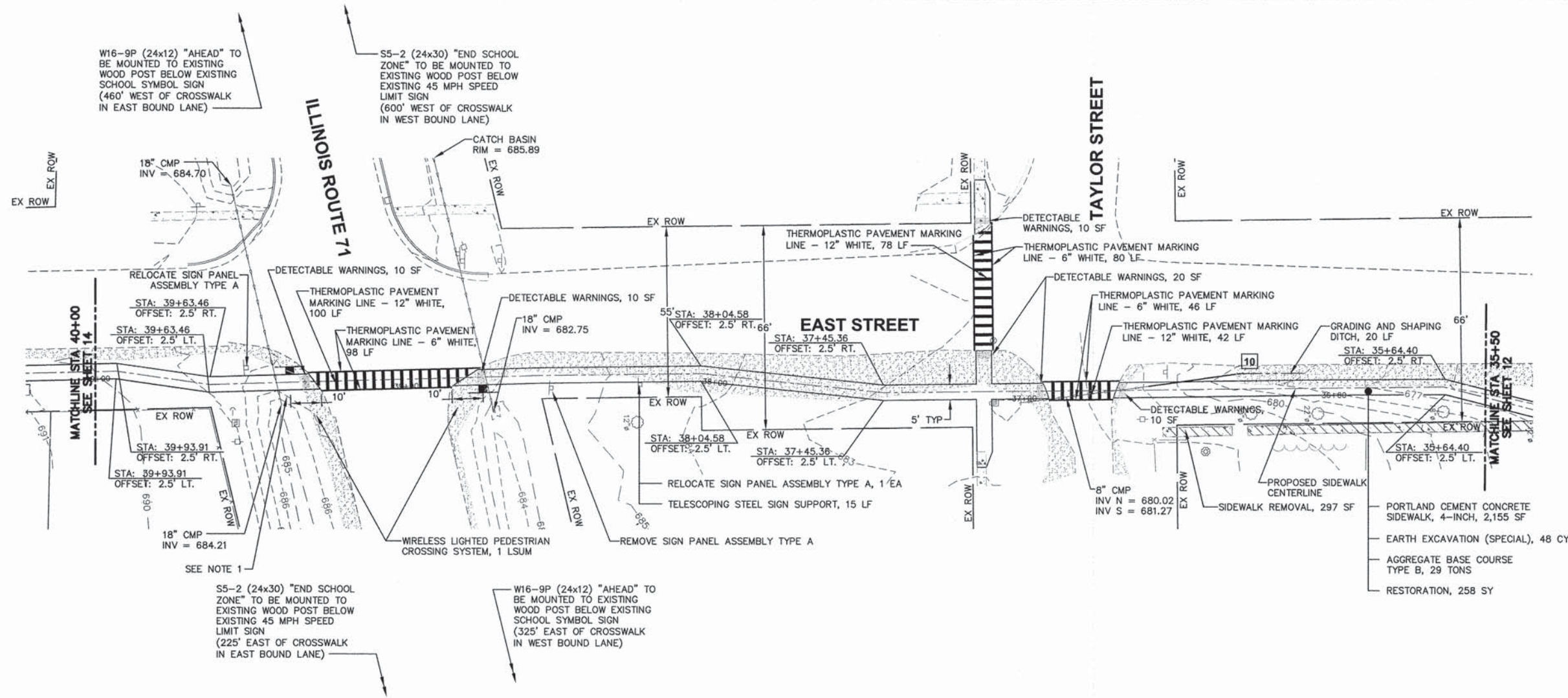

10 METAL END SECTION 8" STA. 36+30, 5.0 RT. INV = 669.87 30 LF PIPE CULVERTS, CLASS C, TYPE 1, 8" @ 0.5%

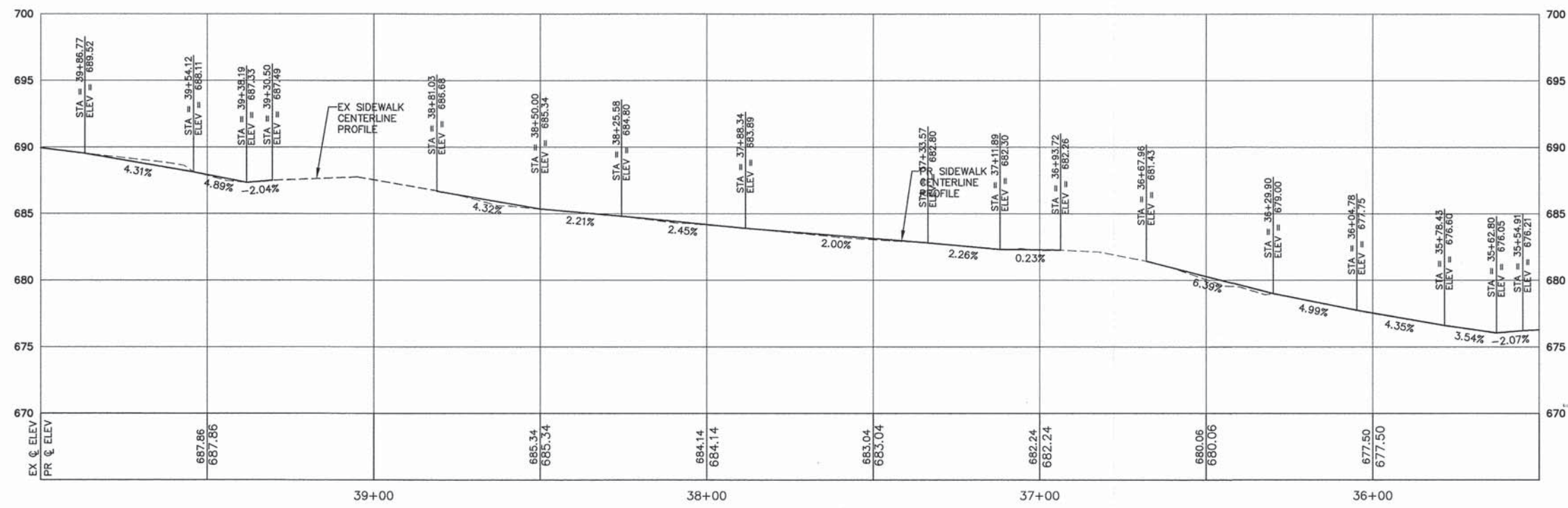

- NOTES:
1. ALL EXCAVATION OCCURRING WITHIN THE ILLINOIS ROUTE 71 RIGHT-OF-WAY SHALL REMAIN WITHIN THE IL ROUTE 71 R.O.W. THE COST FOR SPREADING, PLACEMENT, AND PREPARATION OF THIS MATERIAL FOR SEEDING IS INCLUDED IN THE COST OF SEEDING. CLASS I, STRIPING AND PLACEMENT OF EXISTING TOPSOIL SHALL BE PAID AS TOPSOIL FURNISH AND PLACE, 4", MEASURED IN ITS FINAL LOCATION.
 2. ALL NEW SIGNAGE SHEETING SHALL BE FLORESCENT YELLOW GREEN OR WHITE AS REQUIRED

FILE NAME = H:\SDSK\PROJ\NET004\DWG FINAL\ENG\NET004-P&P NORTH
 Plotted: February 6, 2015 @ 11:17 AM By: Larry Nolan - Model Name: (13) P&P 09 (22x34)
 COPYRIGHT © 2015 ENGINEERING ENTERPRISES, INC.

Engineering Enterprises, Inc.
 CONSULTING ENGINEERS
 52 Wheeler Road
 Sugar Grove, Illinois 60054
 630.466.6700 / www.eeiweb.com

USER NAME = Larry Nolan	DESIGNED - T.A.W.	REVISED -
PLOT SCALE =	DRAWN - J.P.S.	REVISED -
PLOT DATE = February 6, 2015 @ 11:17 AM	CHECKED - T.V.W.	REVISED -
	DATE - 12/29/14	REVISED -

**VILLAGE OF NEWARK
 KENDALL COUNTY, ILLINOIS**

PLAN AND PROFILE EAST STREET	
SCALE: 1" = 20'	SHEET 09 OF 14 SHEETS
STA. 35+50 TO STA. 40+00	

F.A.U. RTE.	SECTION	COUNTY	TOTAL SHEETS	SHEET NO.
	12-00001-00-SW	KENDALL	19	13
CONTRACT NO. 87612				
FED. ROAD DIST. NO. 3 ILLINOIS FED. AID PROJECT				

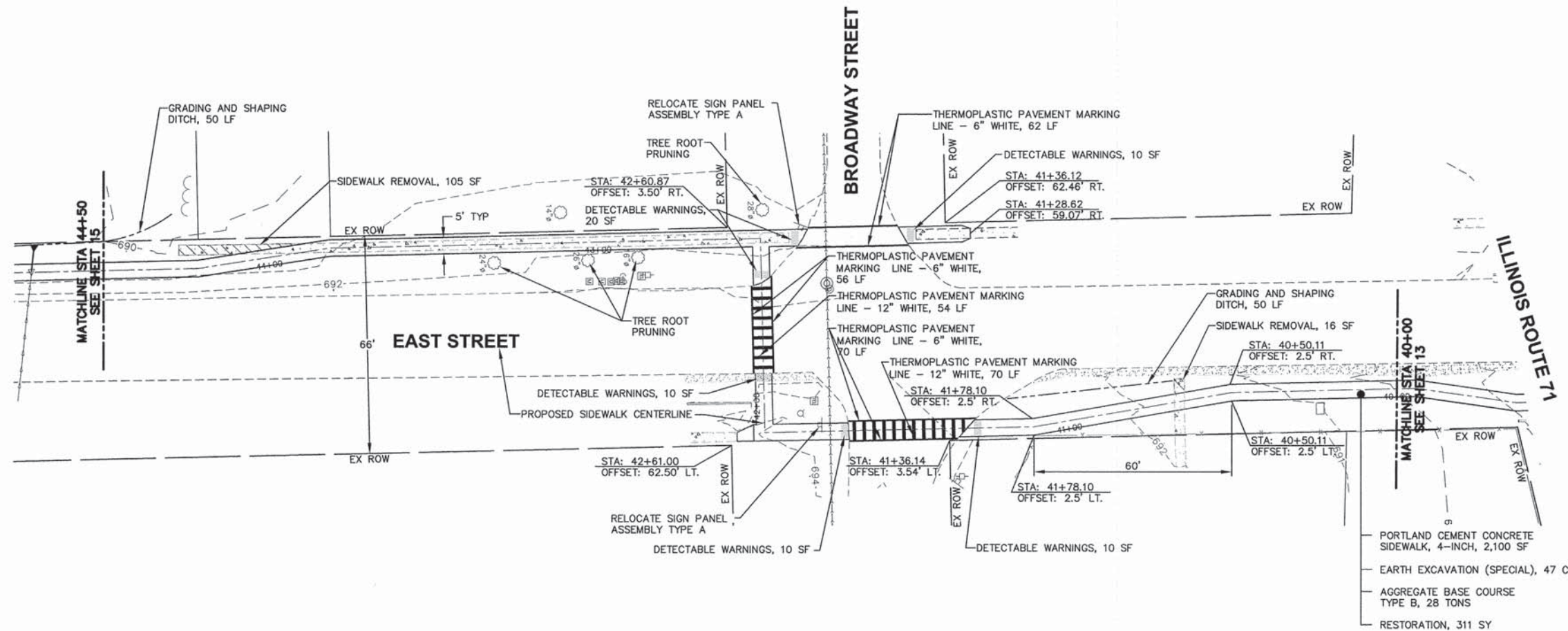
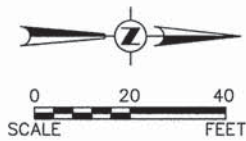

- PORTLAND CEMENT CONCRETE SIDEWALK, 4-INCH, 2,100 SF
- EARTH EXCAVATION (SPECIAL), 47 CY
- AGGREGATE BASE COURSE TYPE B, 28 TONS
- RESTORATION, 311 SY

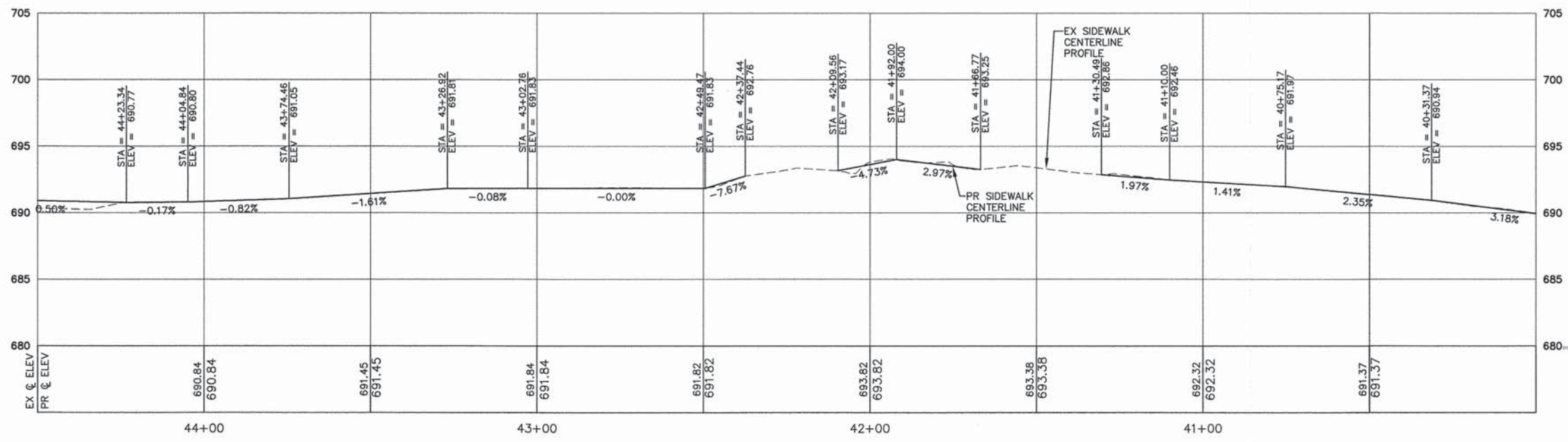

SCALE:
 HORIZONTAL 1" = 20'
 VERTICAL 1" = 5'

FILE NAME = H:\SDSKPROJ\NET1004\DWG\FINAL\ENG\NET1004-P&P SOUTH
 Plotted: February 6, 2015 @ 11:36 AM By: Larry Nolan - Model Name: (14) P&P 10 (22x34)
 COPYRIGHT © 2015 ENGINEERING ENTERPRISES, INC.

Engineering Enterprises, Inc. CONSULTING ENGINEERS 52 Wheeler Road Sugar Grove, Illinois 60554 630.466.6700 / www.eeiweb.com	USER NAME = Larry Nolan	DESIGNED - T.A.W.	REVISED -	VILLAGE OF NEWARK KENDALL COUNTY, ILLINOIS	PLAN AND PROFILE EAST STREET			F.A.U. RTE.	SECTION	COUNTY	TOTAL SHEETS	SHEET NO.
	PLOT SCALE =	CHECKED - T.V.W.	REVISED -		12-00001-00-SW	KENDALL	19	14				
	PLOT DATE = February 6, 2015 @ 11:36 AM	DATE - 12/29/14	REVISED -		CONTRACT NO. 87612							
				SCALE: 1" = 20' SHEET 10 OF 14 SHEETS STA. 40+00 TO STA. 44+50				FED. ROAD DIST. NO. 3 ILLINOIS FED. AID PROJECT				

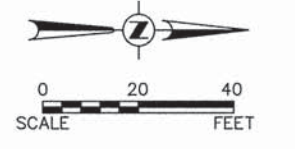
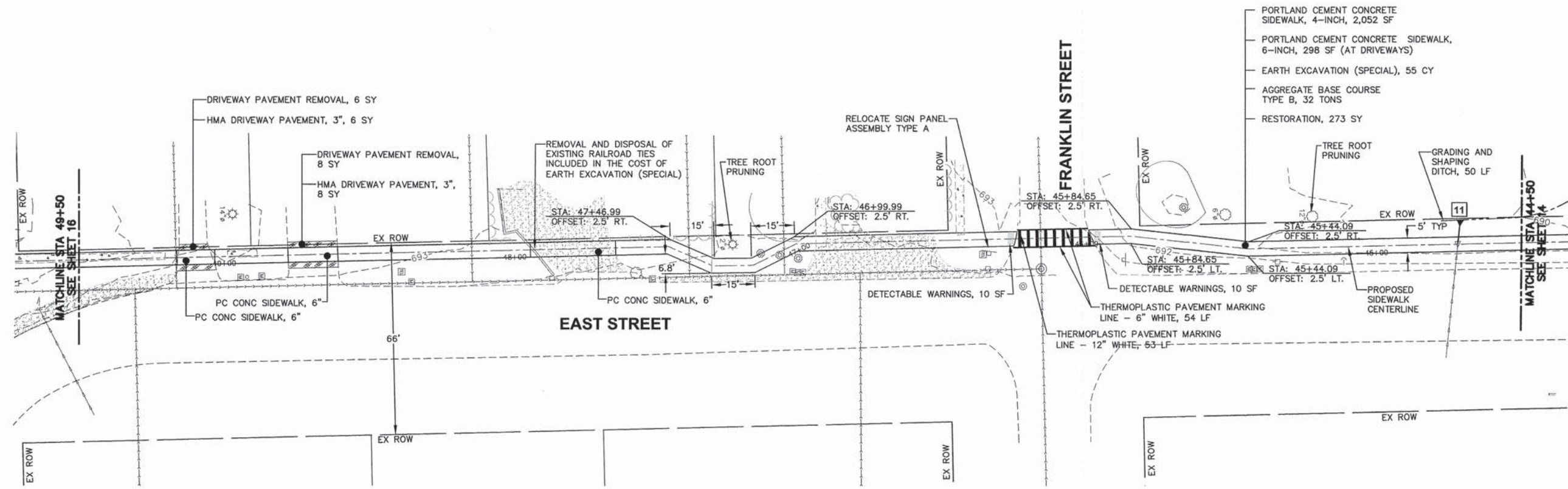

11 METAL END SECTION 12" STA. 44+71.0, 8.0 RT. INV = 669.00 8 LF PIPE CULVERTS, CLASS C, TYPE 1, 12" @ 0.50%

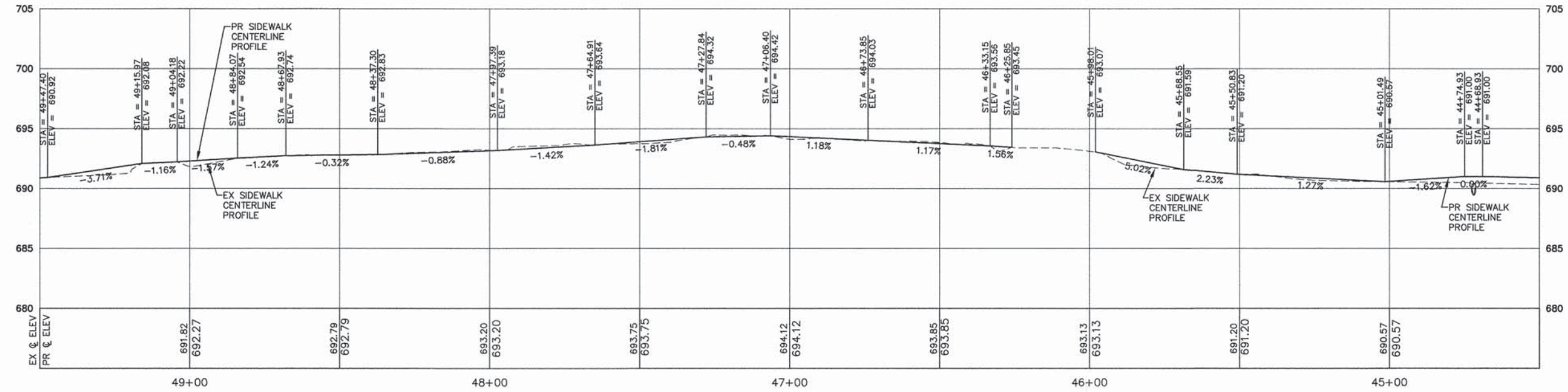

SCALE: HORIZONTAL 1" = 20' VERTICAL 1" = 5'

FILE NAME = H:\SDSKPROJ\NET004\DWG FINAL\ENGINEERING\NET004-P&P SOUTH PLOTTED: February 6, 2015 @ 11:35 AM BY: Larry Nolan - Model Name: (15) P&P 11 (22x34) COPYRIGHT © 2015 ENGINEERING ENTERPRISES, INC.

Engineering Enterprises, Inc.
 CONSULTING ENGINEERS
 52 Wheeler Road
 Sugar Grove, Illinois 60554
 630.466.6700 / www.eeiweb.com

USER NAME = Larry Nolan	DESIGNED - T.A.W.	REVISED -
PLOT SCALE =	DRAWN - J.P.S.	REVISED -
PLOT DATE = February 6, 2015 @ 11:35 AM	CHECKED - T.V.W.	REVISED -
	DATE - 12/29/14	REVISED -

**VILLAGE OF NEWARK
 KENDALL COUNTY, ILLINOIS**

**PLAN AND PROFILE
 EAST STREET**
 SCALE: 1" = 20' SHEET 11 OF 14 SHEETS STA. 44+50 TO STA. 49+50

F.A.U. RTE.	SECTION	COUNTY	TOTAL SHEETS	SHEET NO.
	12-00001-00-SW	KENDALL	19	15
CONTRACT NO. 87612				
FED. ROAD DIST. NO. 3 ILLINOIS FED. AID PROJECT				

FILE NAME = H:\SDSKPROJ\NET004\DWG_FINAL_ENGINE\NET004-P&P_SOUTH
 Plotted: February 6, 2015 @ 11:34 AM By: Larry Nolan - Model Name: (16) P&P 12 (22x34)
 COPYRIGHT © 2015 ENGINEERING ENTERPRISES, INC.

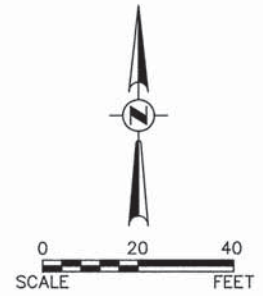
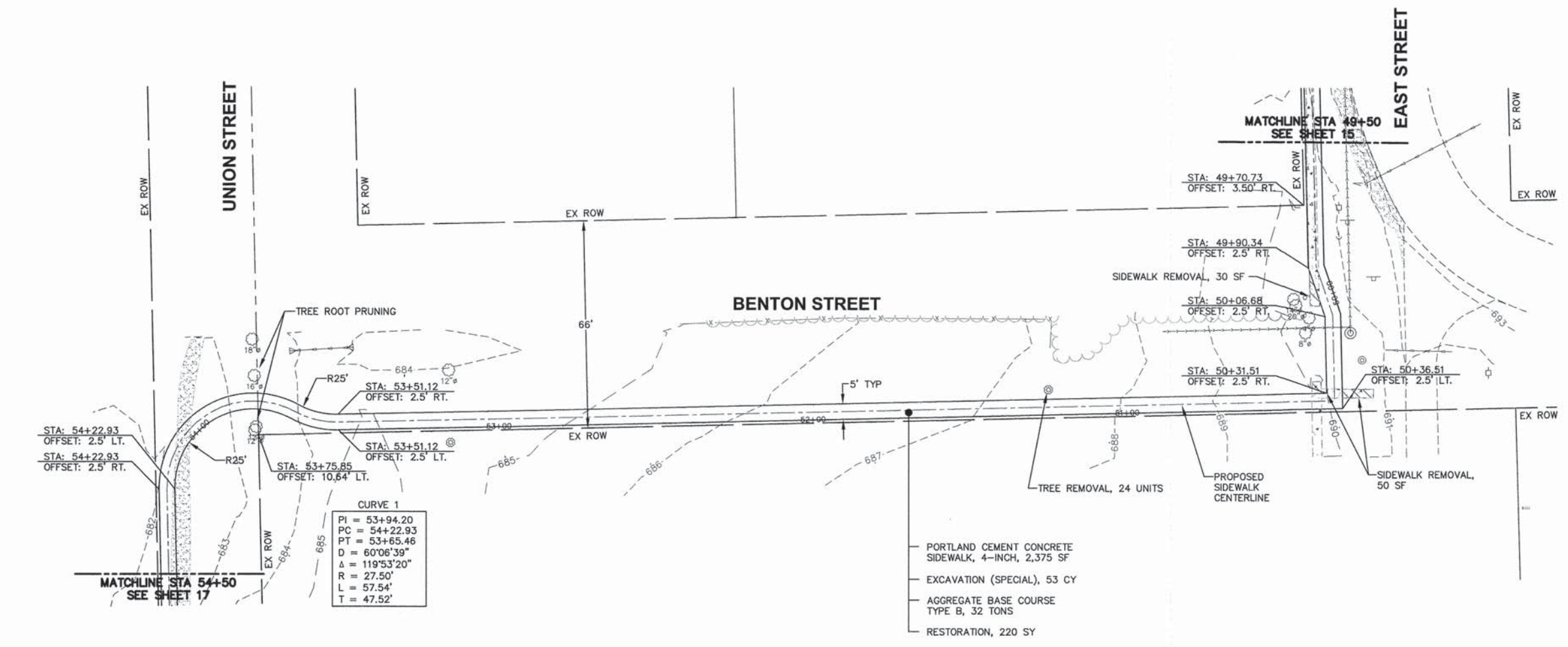

CURVE 1

PI	= 53+94.20
PC	= 54+22.93
PT	= 53+65.46
D	= 60°06'39"
Δ	= 119°53'20"
R	= 27.50'
L	= 57.54'
T	= 47.52'

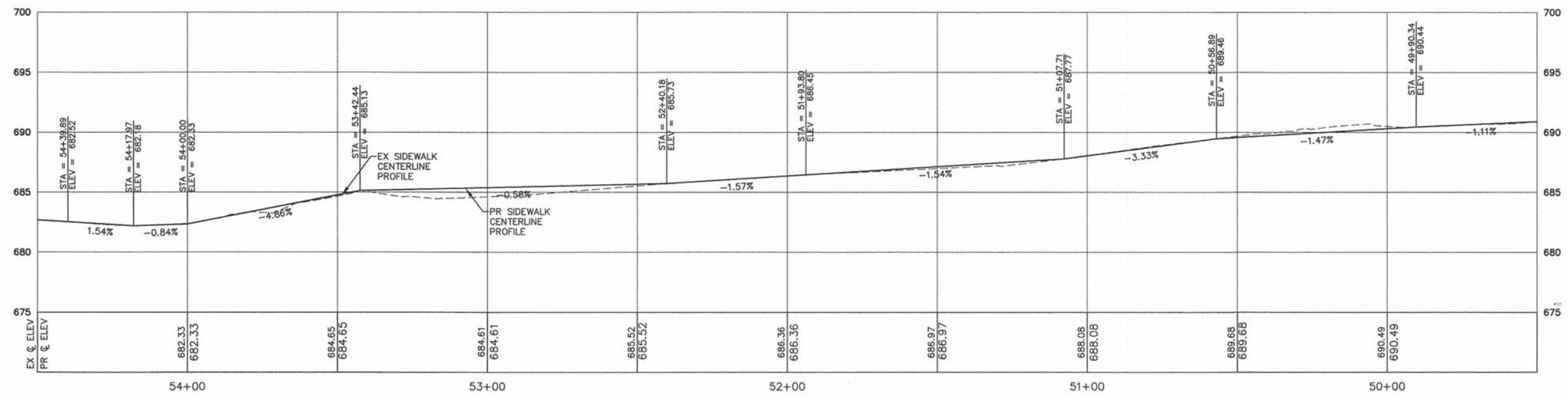

SCALE:
 HORIZONTAL 1" = 20'
 VERTICAL 1" = 5'

<p>Engineering Enterprises, Inc. CONSULTING ENGINEERS 52 Wheeler Road Sugar Grove, Illinois 60554 630-466-6700 / www.eeiweb.com</p>	USER NAME = Larry Nolan	DESIGNED - T.A.W.	REVISED -	VILLAGE OF NEWARK KENDALL COUNTY, ILLINOIS	PLAN AND PROFILE BENTON STREET			F.A.I.D. RTE.	SECTION	COUNTY	TOTAL SHEETS	SHEET NO.
	PLOT SCALE =	CHECKED - T.V.W.	REVISED -		12-00001-00-SW	KENDALL	19	16				
	PLOT DATE = February 6, 2015 @ 11:34 AM	DATE - 12/29/14	REVISED -		CONTRACT NO. 87612							
								FED. ROAD DIST. NO. 3 ILLINOIS FED. AID PROJECT				

SCALE: 1" = 20' SHEET 12 OF 14 SHEETS STA. 49+50 TO STA. 54+50

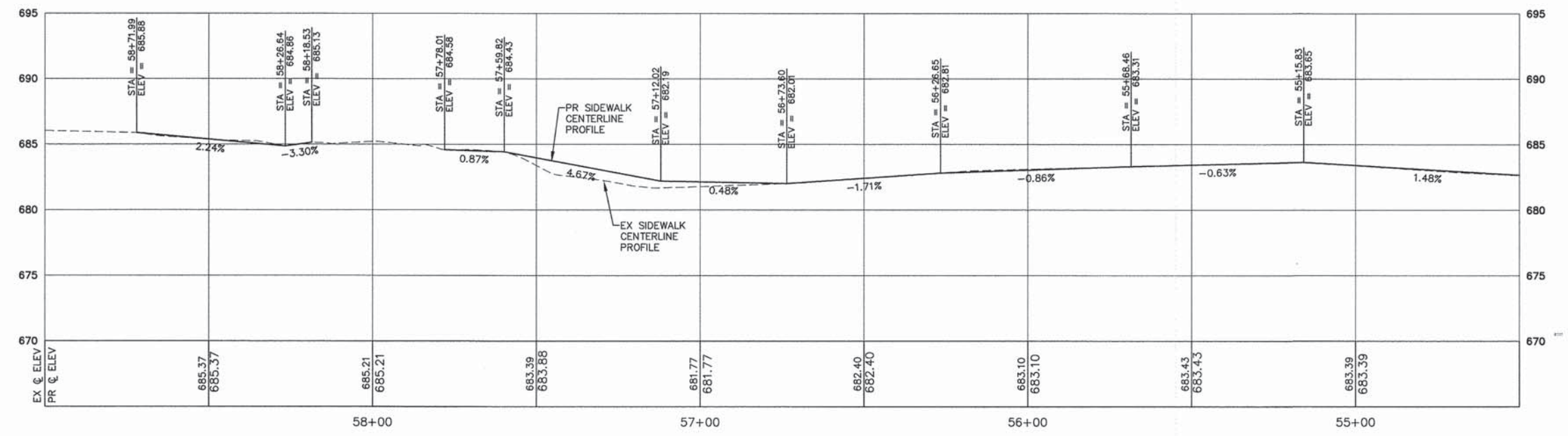
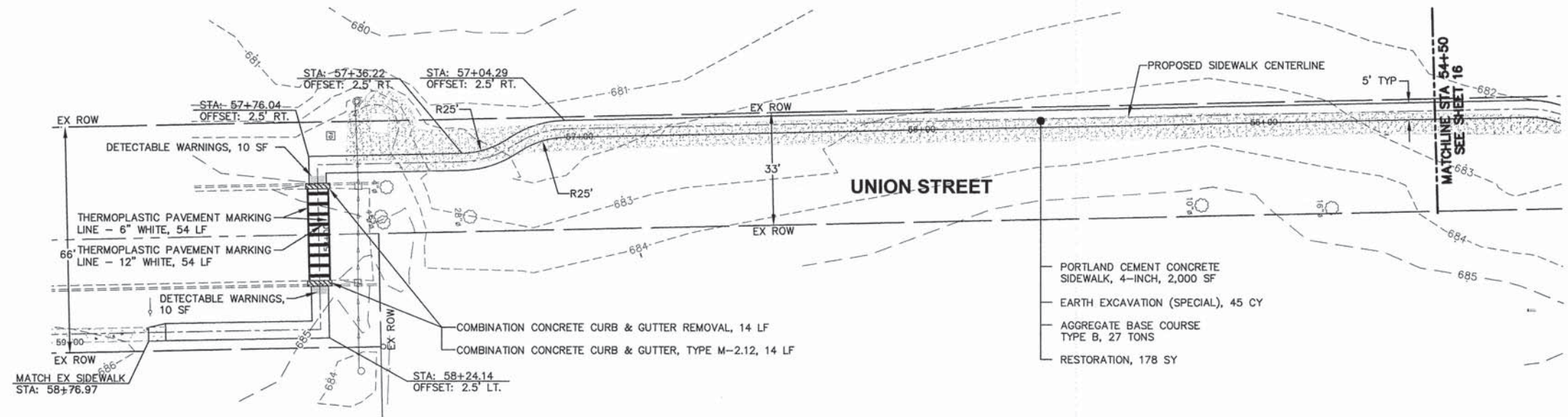
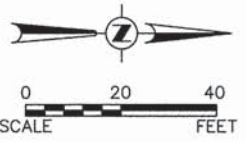

SCALE:
 HORIZONTAL 1" = 20'
 VERTICAL 1" = 5'

Plotted: February 6, 2015 @ 11:32 AM By: Larry Nolan - Model Name: (17) P&P 13 (22x34)

FILE NAME = H:\SSK\PROJ\NET004\DWG_FINAL_ENG\NET004-P&P_SOUTH

Engineering Enterprises, Inc.
 CONSULTING ENGINEERS
 52 Wheeler Road
 Sugar Grove, Illinois 60554
 630.466.6700 / www.eeieeb.com

USER NAME = Larry Nolan	DESIGNED - T.A.W.	REVISED -
PLOT SCALE =	DRAWN - J.P.S.	REVISED -
PLOT DATE = February 6, 2015 @ 11:32 AM	CHECKED - T.V.W.	REVISED -
	DATE - 12/29/14	REVISED -

**VILLAGE OF NEWARK
 KENDALL COUNTY, ILLINOIS**

PLAN AND PROFILE UNION STREET			
SCALE: 1" = 20'	SHEET 13	OF 14 SHEETS	STA. 54+50 TO STA. 59+00

F.A.U. RTE.	SECTION	COUNTY	TOTAL SHEETS	SHEET NO.
	12-00001-00-SW	KENDALL	19	17
CONTRACT NO. 87612				
FED. ROAD DIST. NO. 3 ILLINOIS FED. AID PROJECT				

Plotted: February 6, 2015 @ 11:31 AM By: Larry Nolan - Model Name: (18) P&P 14 (22x34)

FILE NAME = H:\SDSKPROJ\NE1004\DWG\FINAL\ENG\NET1004-P&P SOUTH

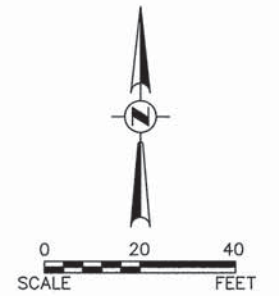
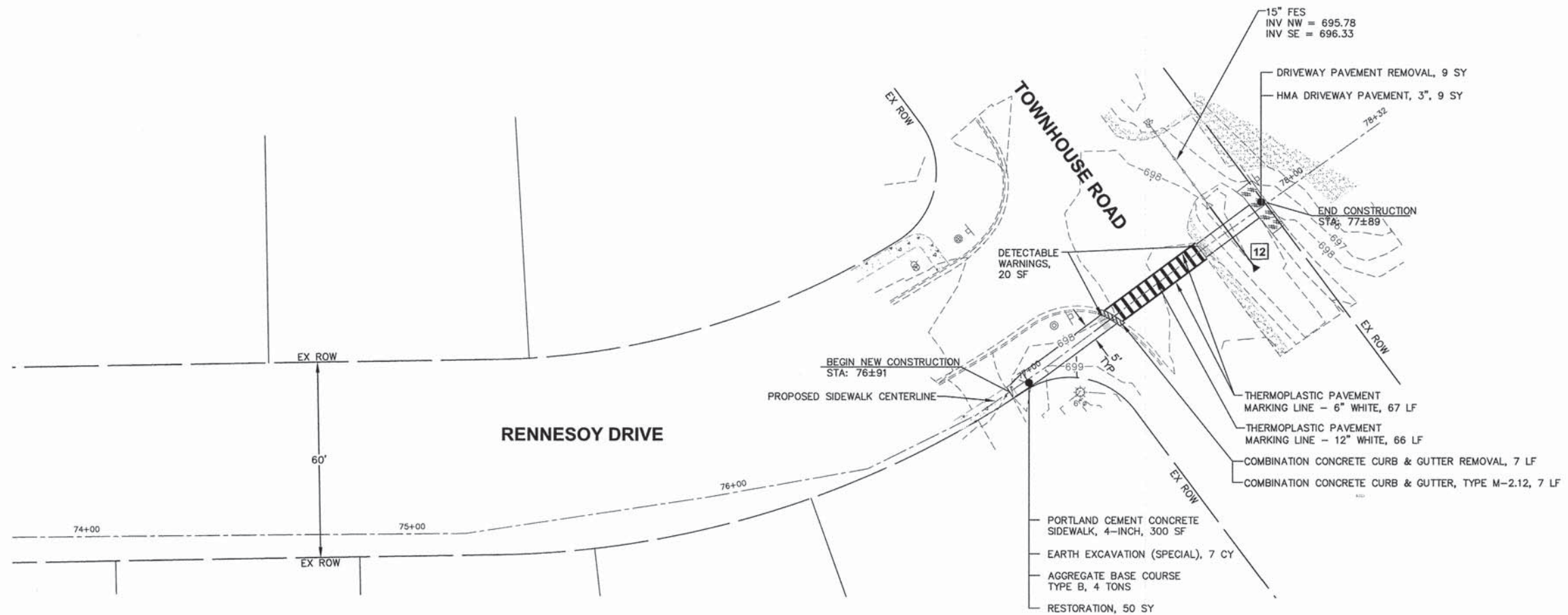

12 METAL END SECTION 15"
 STA. 77+75.0, 15.0 LT.
 INV = 697.00
 24 LF PIPE CULVERTS,
 CLASS C, TYPE 1, 15"
 @ 3.00%

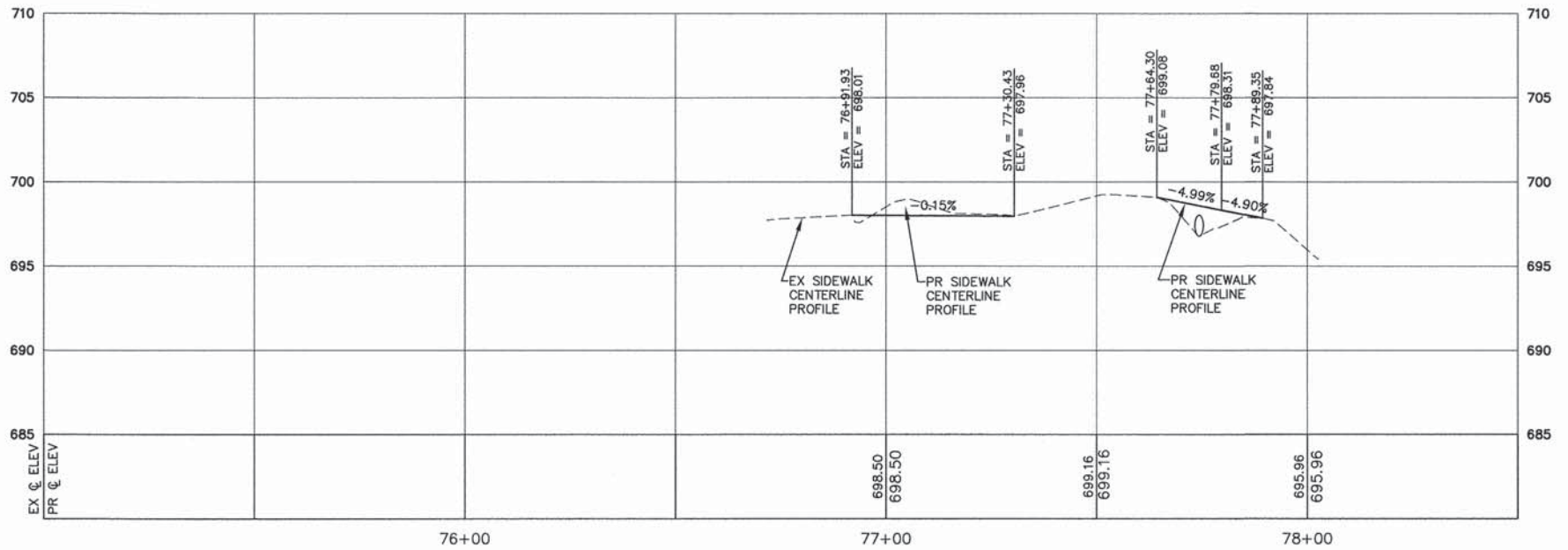

SCALE:
 HORIZONTAL 1" = 20'
 VERTICAL 1" = 5'

Engineering Enterprises, Inc.
 CONSULTING ENGINEERS
 52 Wheeler Road
 Sugar Grove, Illinois 60554
 630.466.6700 / www.eeiweb.com

USER NAME = Larry Nolan	DESIGNED - T.A.W.	REVISED -
	DRAWN - J.P.S.	REVISED -
PLOT SCALE =	CHECKED - T.V.W.	REVISED -
PLOT DATE = February 6, 2015 @ 11:31 AM	DATE - 12/29/14	REVISED -

**VILLAGE OF NEWARK
 KENDALL COUNTY, ILLINOIS**

**PLAN AND PROFILE
 RENNESOY DRIVE**

SCALE: 1" = 20' SHEET 14 OF 14 SHEETS STA. 76+90 TO STA. 77+90

F.A.U. RTE.	SECTION	COUNTY	TOTAL SHEETS	SHEET NO.
	12-00001-00-SW	KENDALL	19	18
FED. ROAD DIST. NO. 3 ILLINOIS FED. AID PROJECT				

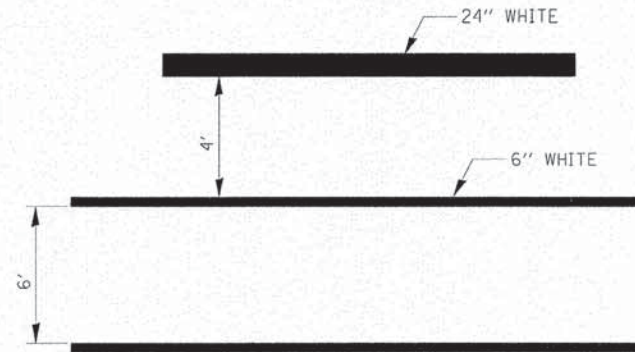

**TYPICAL SPACING DETAIL FOR
CROSSWALKS AND STOP BARS**

**780-3
OPTION 1**

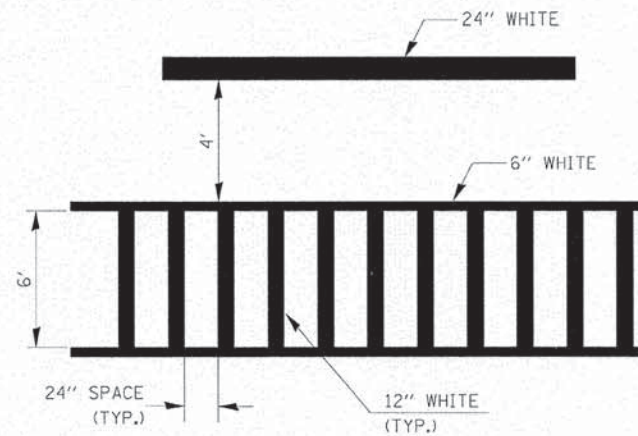

**TYPICAL SPACING DETAIL FOR
CROSSWALKS AND STOP BARS**

**780-3
OPTION 2**

Plotted: February 5, 2015 @ 2:14 PM By: Larry Nolan - Model Name: 19_Spec'd Details 23x34

FILE NAME = H:\SDS\PROJ\NET004\DWG\FINAL\ENG\NET004-CVR

Engineering Enterprises, Inc.
CONSULTING ENGINEERS
52 Wheeler Road
Sugar Grove, Illinois 60554
630.466.6700 / www.ee1web.com

USER NAME = Larry Nolan	DESIGNED - T.A.W.	REVISED -
	DRAWN - J.P.S.	REVISED -
PLOT SCALE =	CHECKED - T.V.W.	REVISED -
PLOT DATE = February 5, 2015 @ 2:14 PM	DATE - 12/29/14	REVISED -

**VILLAGE OF NEWARK
KENDALL COUNTY, ILLINOIS**

MISCELLANEOUS DETAILS

SCALE: N.T.S. SHEET 1 OF 1 SHEETS STA. TO STA.

F.A.J. RTE.	SECTION	COUNTY	TOTAL SHEETS	SHEET NO.
	I2-00001-00-SW	KENDALL	19	19
CONTRACT NO. 87612				
FED. ROAD DIST. NO. 3 ILLINOIS FED. AID PROJECT				