

STATE OF ILLINOIS
DEPARTMENT OF TRANSPORTATION
DIVISION OF HIGHWAYS

PLANS FOR PROPOSED
FEDERAL AID HIGHWAY

FAU RTE 1569 (73rd STREET)
CENTRAL AVENUE TO CICERO AVENUE (IL-50)
ROADWAY RESURFACING
SECTION No. 14-00037-00-RS
PROJECT No. M-4003(376)
JOB No. C-91-419-14
VILLAGE OF BEDFORD PARK
COOK COUNTY

FAU RTE	SECTION	COUNTY	TOTAL SHEETS	SHEET NO.
1569	14-00037-00-RS	COOK	20	1
STA. 10+00 TO STA. 63+44.31				
FED. ROAD DIST. NO.		ILLINOIS	FED. AID PROJECT	
CONTRACT NO.		61B26		

PROGRAM AND OFFICE ENGINEER: CHARLES F. RIDDLE, P.E. 1-847-705-4406
CONSULTANT: HOEFFERLE BUTLER ENGINEERING, INC. 1-708-599-8980

INDEX TO SHEETS: SEE SHEET 2
HIGHWAY STANDARDS: SEE SHEET 2

ADT = 13,500
SPEED LIMIT = 30 MPH
DESIGN SPEED = 35 MPH
DESIGN DESIGNATION - MAJOR COLLECTOR

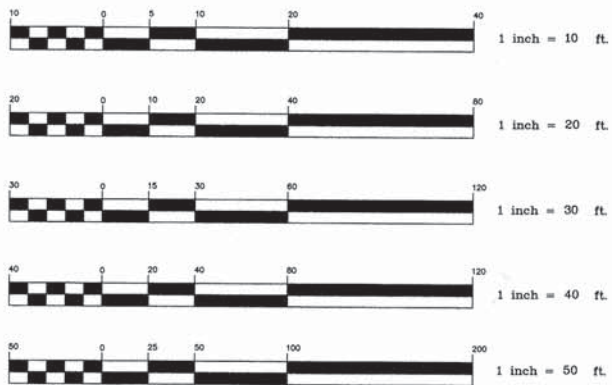

FULL SIZE PLANS HAVE BEEN PREPARED USING STANDARD ENGINEERING SCALES. REDUCED SIZED PLANS WILL NOT CONFORM TO STANDARD SCALES. IN MAKING MEASUREMENTS ON REDUCED PLANS, THE ABOVE SCALES MAY BE USED

J.U.L.I.E.
JOINT UTILITY LOCATION FOR EXCAVATION
1-800-892-0123 -OR- 811

CONTRACT NO. 61B26



PROJECT BEGINS AT STA. 10+00

T 38 N

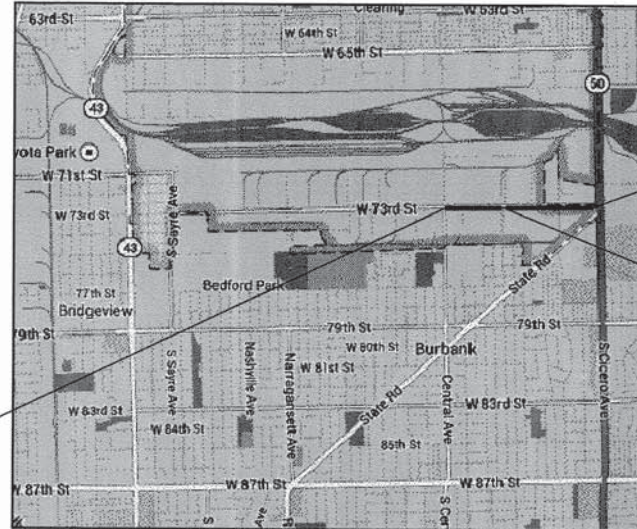

LOCATION MAP

THIS PROJECT IS LOCATED IN THE VILLAGE OF BEDFORD PARK

PROJECT ENDS AT STA. 63+44.31

PROJECT OMISSION STA. 50+40 TO STA 50+54



STATE OF ILLINOIS DEPARTMENT OF TRANSPORTATION DIVISION OF HIGHWAYS	
APPROVED	JANUARY 30, 2015 [Signature] VILLAGE OF BEDFORD PARK PRESIDENT
PASSED	FEBRUARY 18, 2015 [Signature] DISTRICT 1 ENGINEER OF LOCAL ROADS & STREETS
RELEASING FOR BID BASED ON LIMITED REVIEW	FEBRUARY 18, 2015 [Signature] DEPUTY DIRECTOR OF HIGHWAYS/REGION ENGINEER

GROSS LENGTH OF PROJECT: 5,344 FEET (1.01 MILES)
NET LENGTH OF PROJECT: 5,330 FEET (1.01 MILES)

hbe Hoeffler-Butler Engineering, Inc.
Consulting Civil Engineers - Land Surveyors
PROFESSIONAL DESIGN FIRM LICENSE NO. 194-000819
874 S. ROBERTS ROAD HICKORY HILLS, ILLINOIS 60457
TEL: 599-8980 FAX: 599-8790

EXPIRES 11-30-15

[Signature]
SIGNATURE
1/30/15
DATE

PRINTED BY AUTHORITY OF THE STATE OF ILLINOIS

HBE JOB No:13-517

INDEX TO SHEETS:

Table with 2 columns: SHEET NO., DESCRIPTION. Lists sheets 1 through 20 including COVER SHEET, GENERAL NOTES, SUMMARY OF QUANTITIES, and various DISTRICT 1 DETAILS.

HIGHWAY STANDARDS:

Table with 2 columns: STANDARD NO., DESCRIPTION. Lists standards such as STANDARD SYMBOLS, PERPENDICULAR CURB RAMPS, CLASS B PATCHES, etc.

GENERAL NOTES

COMMITMENTS

NONE

PAVING

THE THICKNESS OF HMA SHOWN ON THE PLANS IS THE NOMINAL THICKNESS. DEVIATIONS FROM THE NOMINAL THICKNESS WILL BE PERMITTED WHEN SUCH DEVIATIONS OCCUR OR IRREGULARITIES IN THE EXISTING SURFACE OR BASE ON WHICH THE HMA IS PLACED.

PAVEMENT GRADES SHOWN ON PLANS ARE TOP OF PAVEMENT

THE ENGINEER WILL BE THE SOLE JUDGE CONCERNING CURING TIME FOR THE VARIOUS HMA LIFTS.

UTILITIES

THE CONTRACTOR SHALL BE RESPONSIBLE FOR CONTACTING THE OWNER OF ALL EXISTING FACILITIES SO THAT THE UTILITIES AND THEIR APPURTENANCES MAY BE LOCATED AND ADJUSTED OR MOVED, IF NECESSARY, PRIOR TO THE START OF CONSTRUCTION OPERATIONS.

THE LOCATIONS OF EXISTING DRAINAGE STRUCTURES, STORM AND SANITARY SEWERS, WATER SERVICE LINES AND OTHER UTILITY LINES ARE APPROXIMATE, AND THE VILLAGE DOES NOT GUARANTEE THEIR ACCURACY, THEIR EXACT HORIZONTAL AND VERTICAL LOCATIONS ARE TO BE DETERMINED IN THE FIELD BY THE CONTRACTOR AT HIS OWN EXPENSE.

THE CONTRACTOR SHALL BE RESPONSIBLE FOR THE PROTECTION OF ALL UNDERGROUND OR SURFACE UTILITIES EVEN THOUGH THEY MAY NOT BE SHOWN ON THE PLANS. ANY UTILITY THAT IS DAMAGED DURING CONSTRUCTION SHALL BE REPAIRED OR REPLACED TO THE SATISFACTION OF THE ENGINEER OR THE VILLAGE.

COORDINATION OF ALL UTILITY WORK INVOLVED IN THE CONSTRUCTION AREA WILL BE DISCUSSED AT THE PRECONSTRUCTION CONFERENCE.

BEFORE STARTING ANY EXCAVATION, THE CONTRACTOR SHALL CALL "JULIE" AT 800-892-0123 FOR FIELD LOCATIONS OF BURIED ELECTRIC, TELEPHONE, GAS AND CABLE TELEVISION FACILITIES. (48 HOURS NOTIFICATION IS REQUIRED.)

CARE IS TO BE TAKEN AS NOT TO DAMAGE ANY OF THE EXISTING TRAFFIC SIGNAL CONDUITS, DETECTORS AND EQUIPMENT. IF ANY OF THE TRAFFIC SIGNAL CONDUIT AND/OR EQUIPMENT IS DAMAGED, THE CONTRACTOR SHALL REPAIR AND/OR REPLACE THE CONDUIT AND/OR EQUIPMENT AT NO COST TO THE COUNTY OR VILLAGE.

STORM SEWER

ANY EXISTING STORM SEWER DAMAGED BY THE CONTRACTOR DURING CONSTRUCTION SHALL BE REPLACED BY THE CONTRACTOR AT HIS OR HER OWN EXPENSE.

RESTORATION

CONTRACTOR IS TO RESTORE ALL UNPAVED AREAS DAMAGED DURING CONSTRUCTION OPERATIONS TO THEIR ORIGINAL CONDITION INCLUDING THE FINE GRADING AND SODDING OR SEEDING OF AREAS WITHIN EASEMENTS AND RIGHTS-OF-WAY.

SEEDING SHALL NOT BE PERMITTED AT ANY TIME WHEN THE GROUND IS FROZEN, WET, OR IN AN UNTILLABLE CONDITION. LOCATIONS TO BE SEEDED WILL BE DETERMINED BY THE ENGINEER.

TRAFFIC SIGNS

THE RESIDENT ENGINEER SHALL CONTACT THE TRAFFIC CONTROL SUPERVISOR, CORY JUCIUS, AT 847-705-4470 PRIOR TO THE PLACEMENT OF ANY TEMPORARY TRAFFIC CONTROL DEVICES.

MISCELLANEOUS

ACCESS: THE CONTRACTOR SHALL PROVIDE ACCESS TO ABUTTING PROPERTY AT ALL TIMES DURING CONSTRUCTION.

DIMENSIONS: IT SHALL BE THE CONTRACTOR'S RESPONSIBILITY TO VERIFY ALL DIMENSIONS AND CONDITIONS EXISTING IN THE FIELD PRIOR TO ORDERING MATERIALS AND BEGINNING CONSTRUCTION.

ALL SAWCUTTING SHALL BE INCLUDED IN THE UNIT OF COST OF REMOVAL ITEMS AND SHALL BE PERFORMED PRIOR TO BEGINNING REMOVAL. ANY ITEMS OF WORK REMOVED PRIOR TO SAWCUTTING WILL NOT BE MEASURED FOR PAYMENT.

BARRICADES: THE CONTRACTOR SHALL PROVIDE AND INSTALL TWO (2) WEIGHTED SAND BAGS ON EACH TYPE I OR TYPE II BARRICADE USED. (ONE (1) WEIGHTED SAND BAG ACROSS EACH BOTTOM RAIL.) TYPE III BARRICADES SHALL HAVE A MINIMUM OF FOUR SANDBAGS PER BARRICADE.

ANY EXISTING PAVEMENT OUTSIDE THE AREAS DESIGNATED FOR REMOVAL IN THE PLANS DAMAGED BY THE CONTRACTOR DURING THE CONSTRUCTION SHALL BE REPLACED/REPAIRED BY THE CONTRACTOR AT HIS/HERS OWN EXPENSE TO THE SATISFACTION OF THE ENGINEER WITH NO ADDITIONAL COMPENSATION TO THE CONTRACTOR.

STAKING

THE CONTRACTOR SHALL TAKE CARE TO PROTECT AND PRESERVE ALL STAKING AND MARKING DURING CONSTRUCTION. CONTINUOUS DESTRUCTION OF STAKES AS A RESULT OF CARELESSNESS MAY RESULT IN THE CONTRACTOR BEING BILLED FOR THE COST OF REPLACEMENT.

THE ENGINEER SHALL BE NOTIFIED AT LEAST TWO (2) WORKING DAYS PRIOR TO THE COMMENCEMENT OF WORK. THEY SHALL BE NOTIFIED AT LEAST 72 HOURS IN ADVANCE IF CONSTRUCTION STAKING IS REQUIRED.

THE FOLLOWING RATES OF APPLICATION HAVE BEEN USED IN CALCULATING PLAN QUANTITIES

Table with 3 columns: Material Name, Quantity, Unit. Lists BITUMINOUS MAT PRIME COAT, HMA RESURFACING, FERTILIZER NUTRIENTS, and MIXTURE FOR CRACKS.

MEMBERS OF "JULIE" KNOWN TO BE WITHIN THE LIMITS OF THE IMPROVEMENT ARE:

- 1. NICOR GAS
2. AT&T
3. COMMONWEALTH EDISON Co.
4. VILLAGE OF BEDFORD PARK

Project information table including DRAWN BY: JMH, CHECKED BY: SAL, DATE: 12.01.14, REVISIONS, STATE OF ILLINOIS DEPARTMENT OF TRANSPORTATION, GENERAL NOTES, SCALE: N.T.S., SHEET No. 2 OF 20 SHEETS, FAU RTE: 1569, SECTION: 14-00037-00-RS, COUNTY: COOK, TOTAL SHEETS: 20, SHEET NO.: 2, CONTRACT No. 61B26, FED. ROAD DIST. NO., ILLINOIS, FED. AID PROJECT.

			CONSTRUCTION CODE
			STP FUNDS
			80% FED
			20% LOCAL
			0005
			URBAN
			TOTAL
CODE NO.	ITEM	UNIT	QTY.
X6030310	FRAMES AND LIDS TO BE ADJUSTED (SPECIAL)	EACH	46
Z0004562	COMBINATION CURB AND GUTTER REMOVAL AND REPLACEMENT	FOOT	1,269
Z0048	RAILROAD PROTECTIVE LIABILITY INSURANCE	L SUM	1.00
21101615	TOPSOIL FURNISH & PLACE, 4"	SQ YD	78
25000210	SEEDING CLASS 1A	ACRE	0.02
25000400	NITROGEN FERTILIZER NUTRIENT	POUND	2
25000500	PHOSPHOROUS FERTILIZER NUTRIENT	POUND	2
25000600	POTASSIUM FERTILIZER NUTRIENT	POUND	2
40600275	BITUMINOUS MATERIALS (PRIME COAT)	POUND	12,036
40600400	MIXTURE FOR CRACKS, JOINTS AND FLANGEWAYS	TON	8
40600825	POLYMERIZED LEVELING BINDER (MACHINE METHOD), N50	TON	1,100
40600982	HOT-MIX ASPHALT SURFACE REMOVAL-BUTT JOINT	SQ YD	109
40603595	POLYMERIZED HOT-MIX ASPHALT SURFACE COURSE, MIX "F", N90	TON	4,494
42400410	PORTLAND CEMENT CONCRETE SIDEWALK, 8"	SQ FT	715
42400800	DETECTABLE WARNINGS	SQ FT	60
44000161	HOT-MIX ASPHALT SURFACE REMOVAL, 3"	SQ YD	26,747
44000600	SIDEWALK REMOVAL	SQ FT	715
44200970	CLASS B PATCHES, TYPE II, 10 INCH	SQ YD	700
44200974	CLASS B PATCHES, TYPE III, 10 INCH	SQ YD	350

			CONSTRUCTION CODE
			STP FUNDS
			80% FED
			20% LOCAL
			0005
			URBAN
			TOTAL
CODE NO.	ITEM	UNIT	QTY.
44200976	CLASS B PATCHES, TYPE IV, 10 INCH	SQ YD	100
44213100	PAVEMENT FABRIC	SQ YD	450
44213200	SAW CUTS	FOOT	1,600
44213204	TIE BARS 3/4"	EACH	2,100
44300100	AREA REFLECTIVE CRACK CONTROL TREATMENT	SQ YD	26,747
60206905	CATCH BASINS, TYPE C, TYPE 1 FRAME, OPEN LID	EACH	3
60234200	INLETS, TYPE A, TYPE 1 FRAME, OPEN LID	EACH	4
60500060	REMOVING INLETS	EACH	4
60500050	REMOVING CATCH BASINS	EACH	3
60255410	CATCH BASINS TO BE CLEANED	EACH	35
60255500	MANHOLES TO BE ADJUSTED	EACH	2
60265700	VALVE VAULTS TO BE ADJUSTED	EACH	8
67100100	MOBILIZATION	L SUM	1.00
70102625	TRAFFIC CONTROL AND PROTECTION, STD. 701606	L SUM	1.00
70300100	SHORT-TERM PAVEMENT MARKING	FOOT	4,700
* 78000100	THERMOPLASTIC PAVEMENT MARKING- LETTERS & SYMBOLS	SQ FT	311.8
* 78000200	THERMOPLASTIC PAVEMENT MARKING - LINE 4"	FOOT	11,200
* 78000400	THERMOPLASTIC PAVEMENT MARKING - LINE 6"	FOOT	477
* 78000650	THERMOPLASTIC PAVEMENT MARKING - LINE 24"	FOOT	267
* 88600600	LOOP DETECTOR REPLACEMENT	FOOT	333

~ DENOTES SPECIAL PROVISION ITEM

* DENOTES SPECIALTY ITEM

	DRAWN BY: JMH	REVISED: _____	STATE OF ILLINOIS	SUMMARY OF QUANTITIES			FAU RTE	SECTION	COUNTY	TOTAL SHEETS	SHEET NO.
	CHECKED BY: SAL	REVISED: _____					1569	14-00037-00-RS	COOK	20	3
	DATE: 12.01.14	REVISED: _____	DEPARTMENT OF TRANSPORTATION	SCALE: N.T.S. SHEET No. 3 OF 20 SHEETS			CONTRACT No. 61B26				
	REVISED: _____	REVISED: _____					FED. ROAD DIST. NO.	ILLINOIS	FED. AID PROJECT		

HEB 008 No.13-817

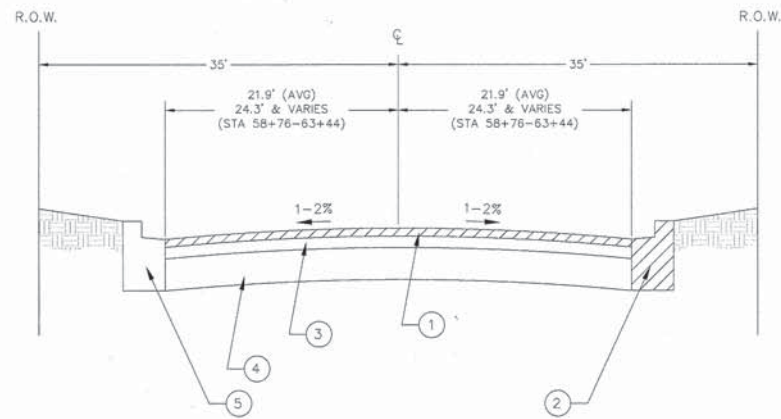

EXISTING TYPICAL CROSS-SECTION
73rd STREET, STA 10+00-STA 63+44

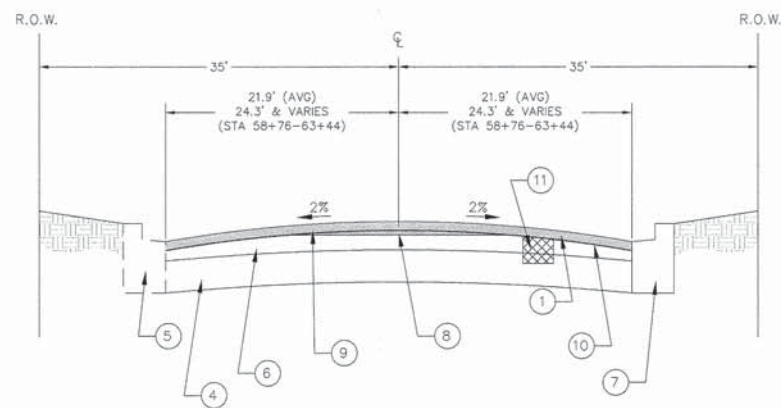

PROPOSED TYPICAL CROSS-SECTION
73rd STREET, STA 10+00-STA 63+44

- | | |
|--|--|
| ① PROPOSED HOT-MIX ASPHALT SURFACE REMOVAL, 3" | ⑦ PROPOSED COMBINATION CURB & GUTTER, TY B6.12 (WHERE MARKED) |
| ② PROPOSED CURB & GUTTER REMOVAL | ⑧ PROPOSED POLYMERIZED LEVELING BINDER (MACHINE METHOD), N50, 3/4" (MAX) |
| ③ EXISTING HOT-MIX ASPHALT SURFACE & BINDER COURSES, ±5.5" | ⑨ PROPOSED POLYMERIZED HOT-MIX ASPHALT SURFACE COURSE, MIX "F", N90, 3" |
| ④ EXISTING CONCRETE BASE, ±8" | ⑩ PROPOSED AREA REFLECTIVE CRACK CONTROL TREATMENT |
| ⑤ EXISTING COMBINATION CURB & GUTTER, TY B6.12 | ⑪ PROPOSED CLASS B PATCHES, 10" |
| ⑥ EXISTING HOT-MIX ASPHALT BINDER COURSE | |

STRUCTURAL DESIGN TRAFFIC: YEAR 2025

PV= 9,990 SU= 1,080 MU= 2,430

ROAD/STREET CLASSIFICATION: I

PERCENT OF STRUCTURAL DESIGN TRAFFIC IN DESIGN LANE:

P= 32 S= 45 M= 45

TRAFFIC FACTOR: ACTUAL T.F.= 16.64 $SN_C = 4.6$
MINIMUM T.F.= N/A

PG GRADE: SURFACE= SBS/SBR PG 70-22

IBV= 3

SSR= FAIR

HOT-MIX ASPHALT MIXTURE REQUIREMENTS CHART

MIXTURE TYPE	AIR VOIDS AT Ndes
PAVEMENT RESURFACING	
POLYMERIZED HOT-MIX ASPHALT SURFACE COURSE, MIX 'F', N90, 3"	4% AT 90 GYR
POLYMERIZED LEVELING BINDER (MACHINE METHOD), N50	4% AT 50 GYR

THE UNIT WEIGHT USED TO CALCULATE ALL HMA SURFACE MIXTURE QUANTITIES IS 112 LBS/SQ YD/IN

THE "AC TYPE" FOR POLYMERIZED HMA MIXES SHALL BE "SBS/SBR PG 70-22" AND FOR NON-POLYMERIZED HMA THE "AC TYPE" SHALL BE "PG 64-22" UNLESS MODIFIED BY DISTRICT ONE SPECIAL PROVISIONS.

FOR "PERCENT OF RAP" SEE DISTRICT ONE SPECIAL PROVISIONS.

DRAWN BY: JMH CHECKED BY: SAL DATE: 12.01.14 REVISED: _____	REVISED: _____	STATE OF ILLINOIS DEPARTMENT OF TRANSPORTATION	73rd STREET TYPICAL CROSS-SECTIONS HMA MIXTURE CHART, STRUCTURAL DESIGN		FAU RTE 1569	SECTION 14-00037-00-RS	COUNTY COOK	TOTAL SHEETS 20	SHEET NO. 4
	REVISED: _____		CONTRACT No. 61B26						
	REVISED: _____		SCALE: NOT TO SCALE	SHEET No. 4 OF 20 SHEETS	FED. ROAD DIST. NO.	ILLINOIS	FED. AID PROJECT		
	REVISED: _____								

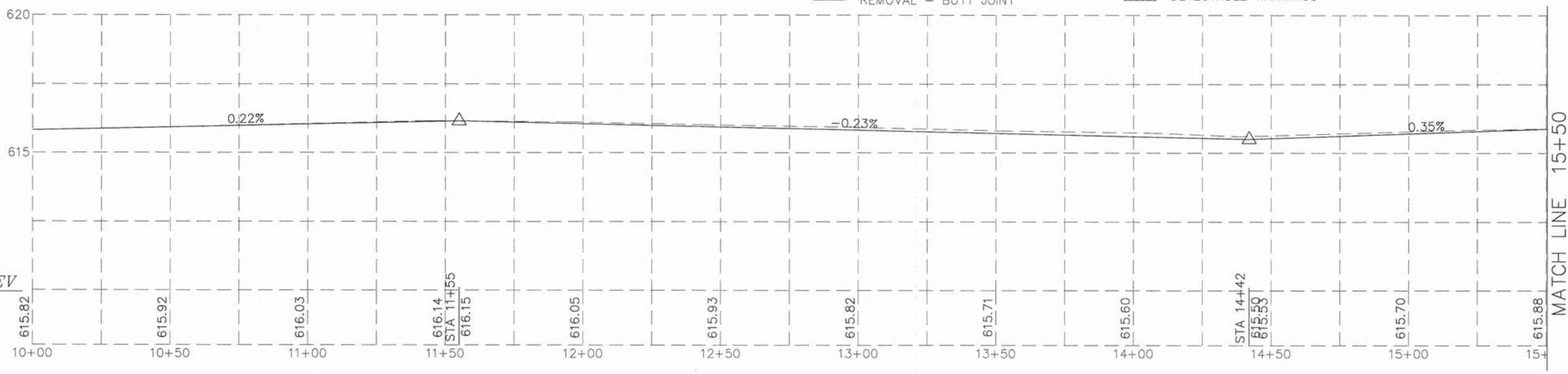
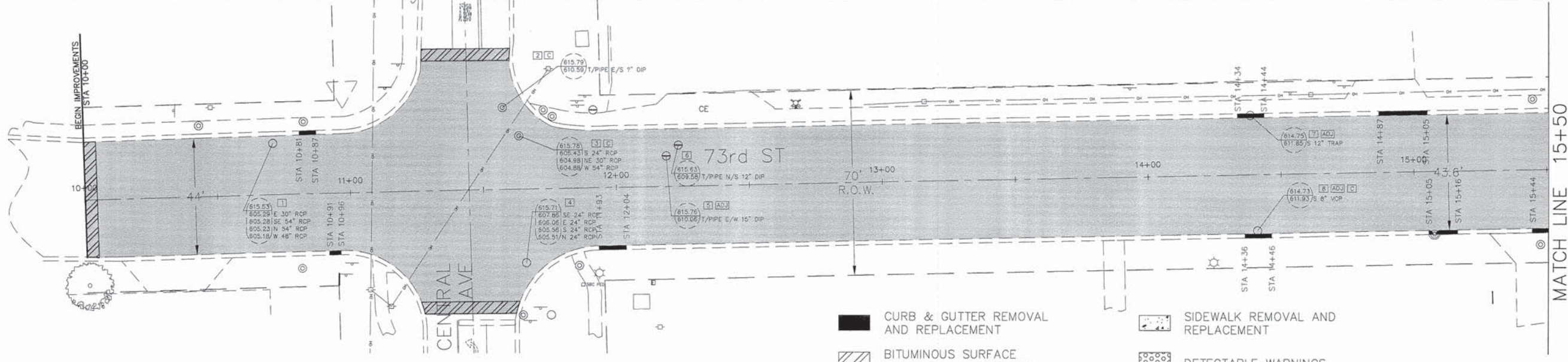
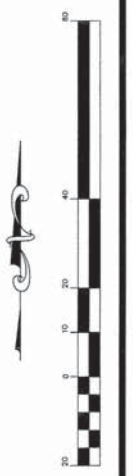
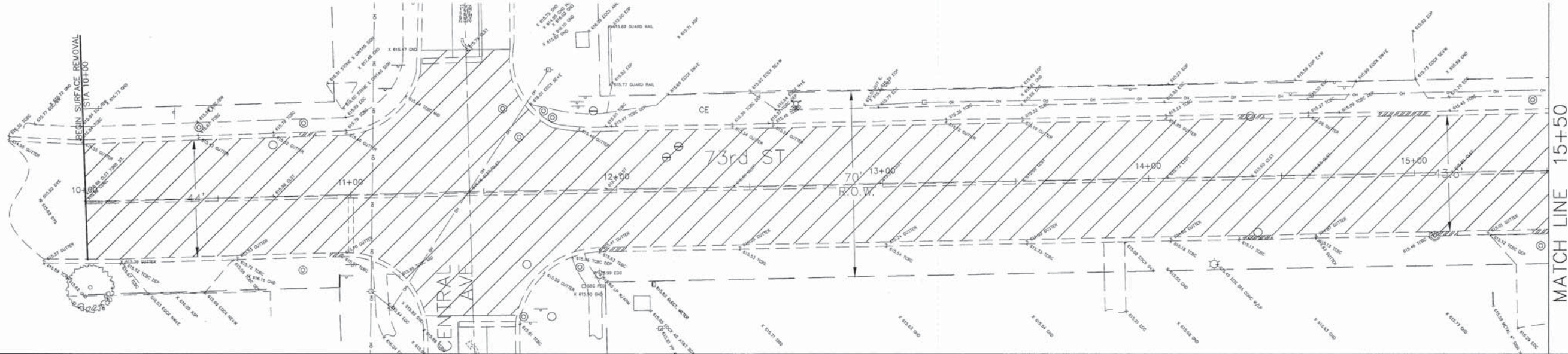

DATUM ELEV
610.00

STA. 10+00 TO STA. 15+50	DRAWN BY: JMH	REVISED: _____	STATE OF ILLINOIS DEPARTMENT OF TRANSPORTATION	73rd STREET PLAN & PROFILE SHEET		FAU RTE 1569	SECTION 14-00037-00-RS	COUNTY COOK	TOTAL SHEETS 20	SHEET NO. 5
	CHECKED BY: SAL	REVISED: _____		SCALE: H:1"=20' V:1"=2'		SHEET No. 5 OF 20 SHEETS		CONTRACT No. 61B26		
	DATE: 12.01.14	REVISED: _____				FED. ROAD DIST. NO.	ILLINOIS	FED. AID PROJECT		
	REVISED: _____	REVISED: _____								

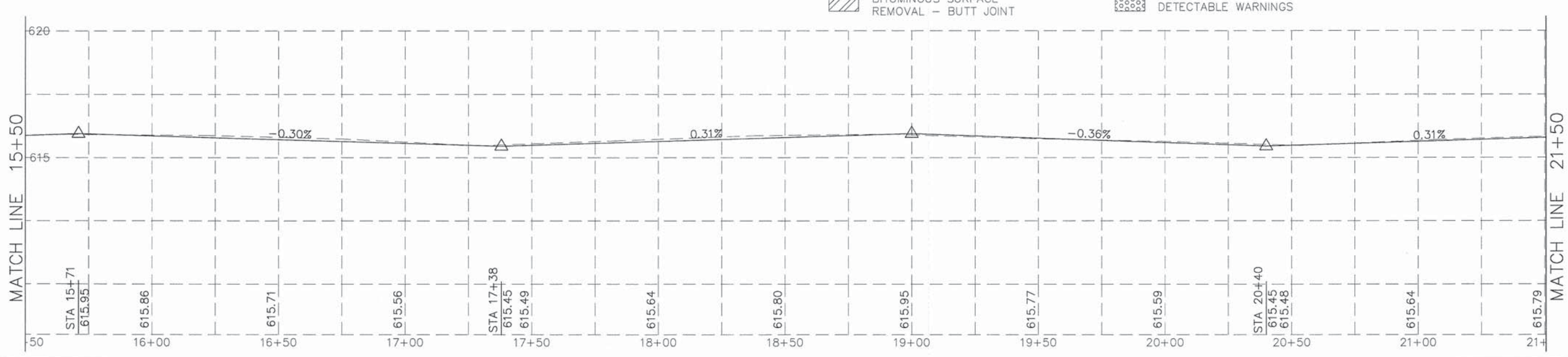
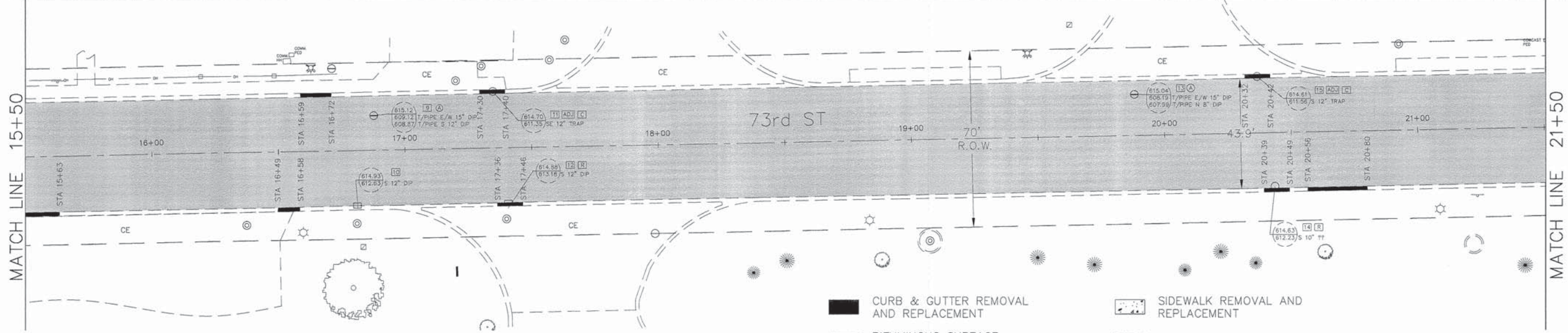
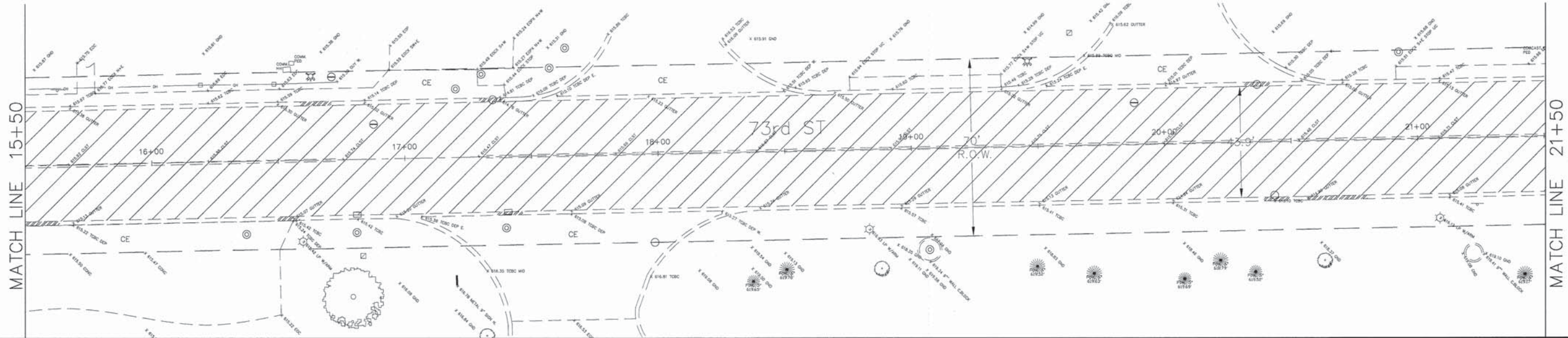

STA. 15+50 TO STA. 21+50	DRAWN BY: JMH	REVISED: _____	STATE OF ILLINOIS DEPARTMENT OF TRANSPORTATION	73rd STREET PLAN & PROFILE SHEET		FAU RTE	SECTION	COUNTY	TOTAL SHEETS	SHEET NO.
	CHECKED BY: SAL	REVISED: _____		1569	14-00037-00-RS	COOK	20	6		
	DATE: 12.01.14	REVISED: _____	SCALE: H:1"=20' V:1"=2'		SHEET No. 6 OF 20 SHEETS		CONTRACT No. 61B26			
	REVISED: _____	REVISED: _____			FED. ROAD DIST. NO.	ILLINOIS	FED. AID PROJECT			

HBE JOB No: 13-517

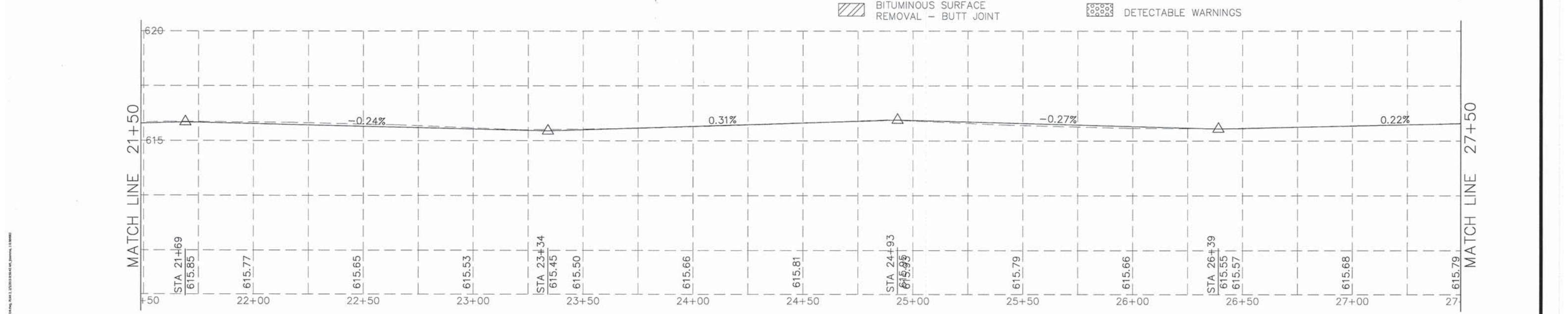
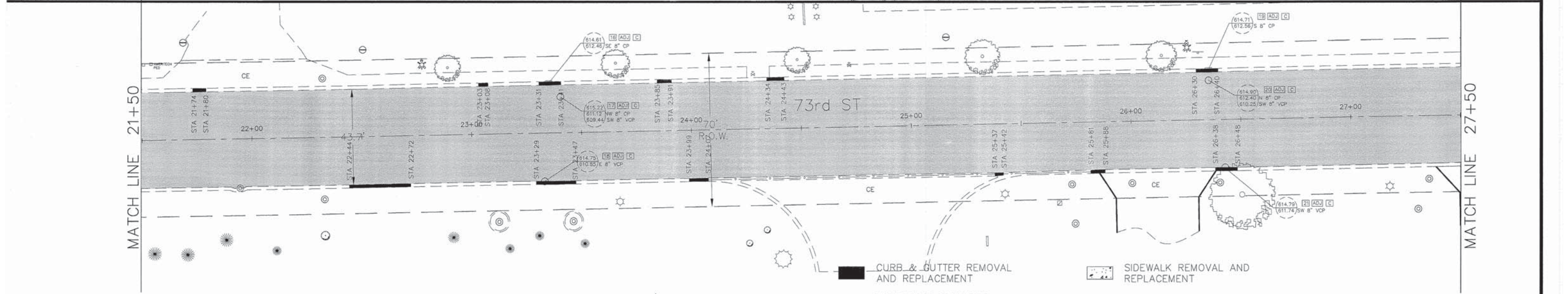
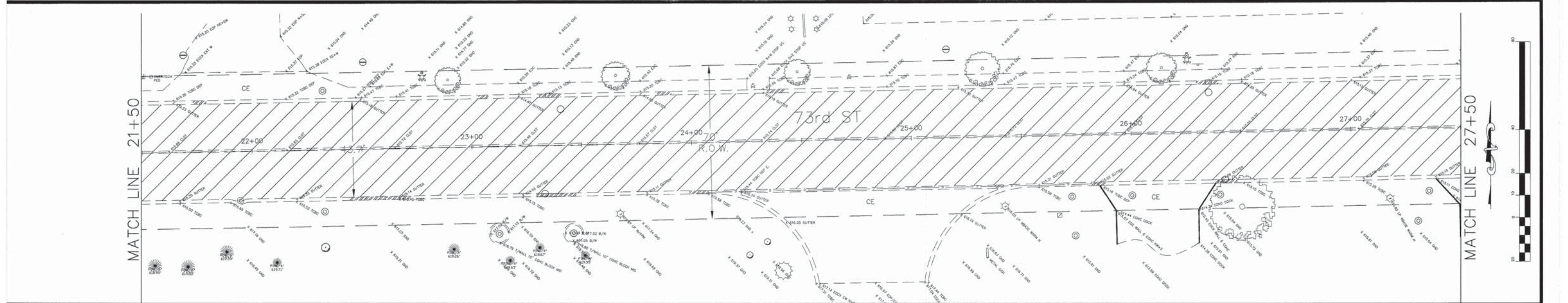

STA. 21+50 TO STA. 27+50	DRAWN BY: JMH	REVISED: _____	STATE OF ILLINOIS DEPARTMENT OF TRANSPORTATION	73rd STREET PLAN & PROFILE SHEET		FAU RTE	SECTION	COUNTY	TOTAL SHEETS	SHEET NO.
	CHECKED BY: SAL	REVISED: _____		1569	14-00037-00-RS	COOK	20	7		
	DATE: 12.01.14	REVISED: _____	SCALE: H:1"=20' V:1"=2'		SHEET No. 7 OF 20 SHEETS		CONTRACT No. 61B26			
	REVISED: _____	REVISED: _____	FED. ROAD DIST. NO.		ILLINOIS		FED. AID PROJECT			

H:\projects\120114\120114.dwg, 12/1/14, 12:01:14, JMH, 12/1/14
 H:\projects\120114\120114.dwg, 12/1/14, 12:01:14, JMH, 12/1/14

HBE JOB No: 13-517

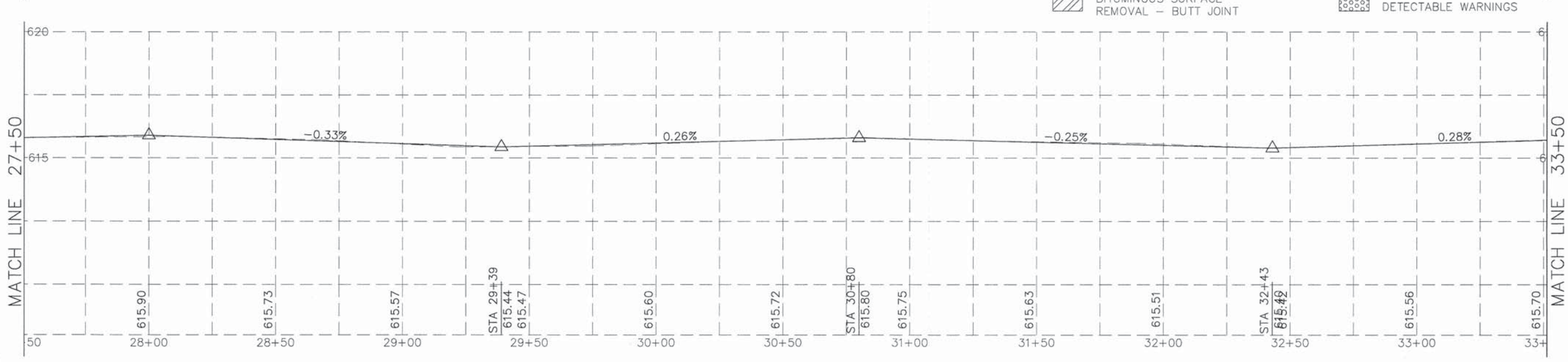
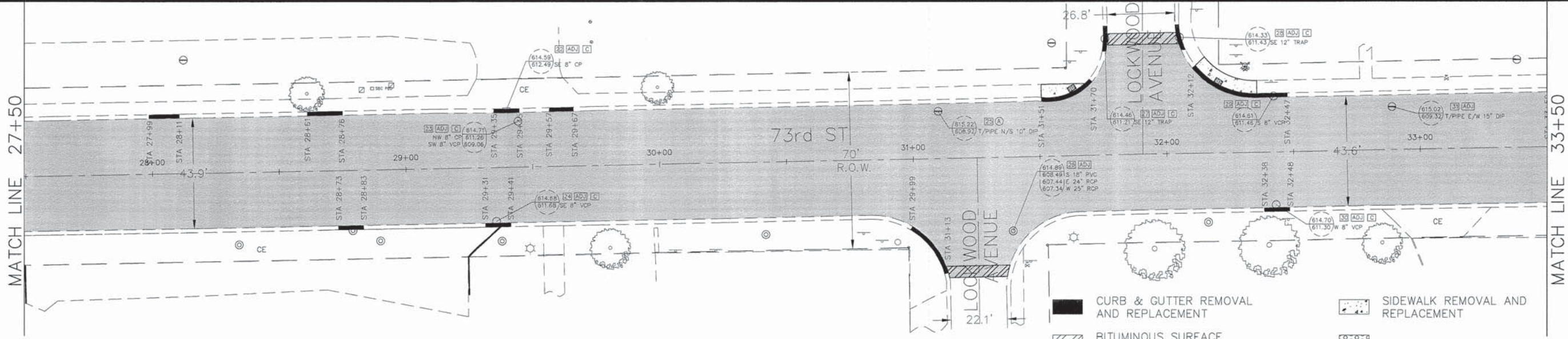
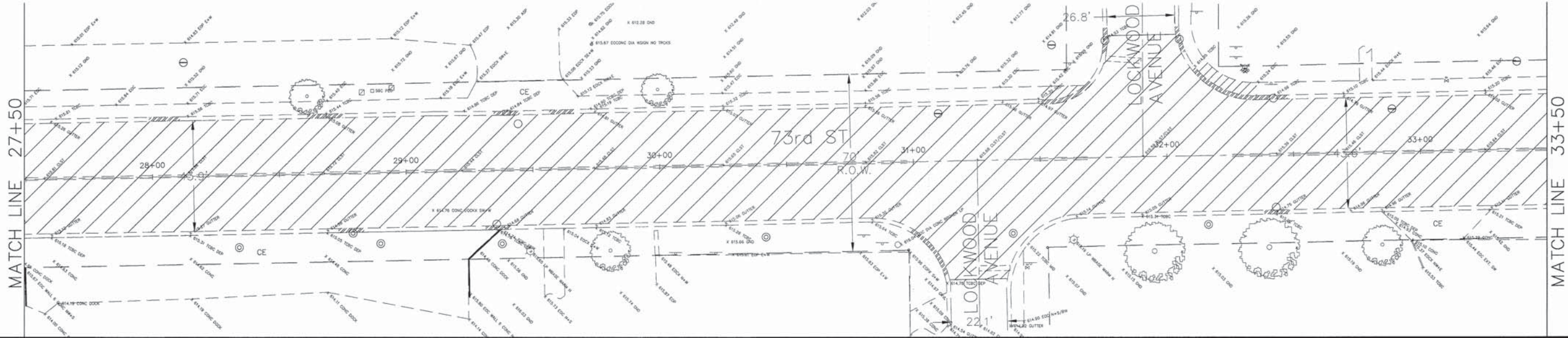

STA. 27+50 TO STA. 33+50	DRAWN BY: JMH	REVISED: _____
	CHECKED BY: SAL	REVISED: _____
	DATE: 12.01.14	REVISED: _____
	REVISED: _____	REVISED: _____

STATE OF ILLINOIS DEPARTMENT OF TRANSPORTATION	
---	--

73rd STREET PLAN & PROFILE SHEET	
SCALE: H:1"=20' V:1"=2'	SHEET No. 8 OF 20 SHEETS

FAU RTE	SECTION	COUNTY	TOTAL SHEETS	SHEET NO.
1569	14-00037-00-RS	COOK	20	8
CONTRACT No. 61B26				
FED. ROAD DIST. NO.	ILLINOIS	FED. AID PROJECT		

HBE JOB No:13-517

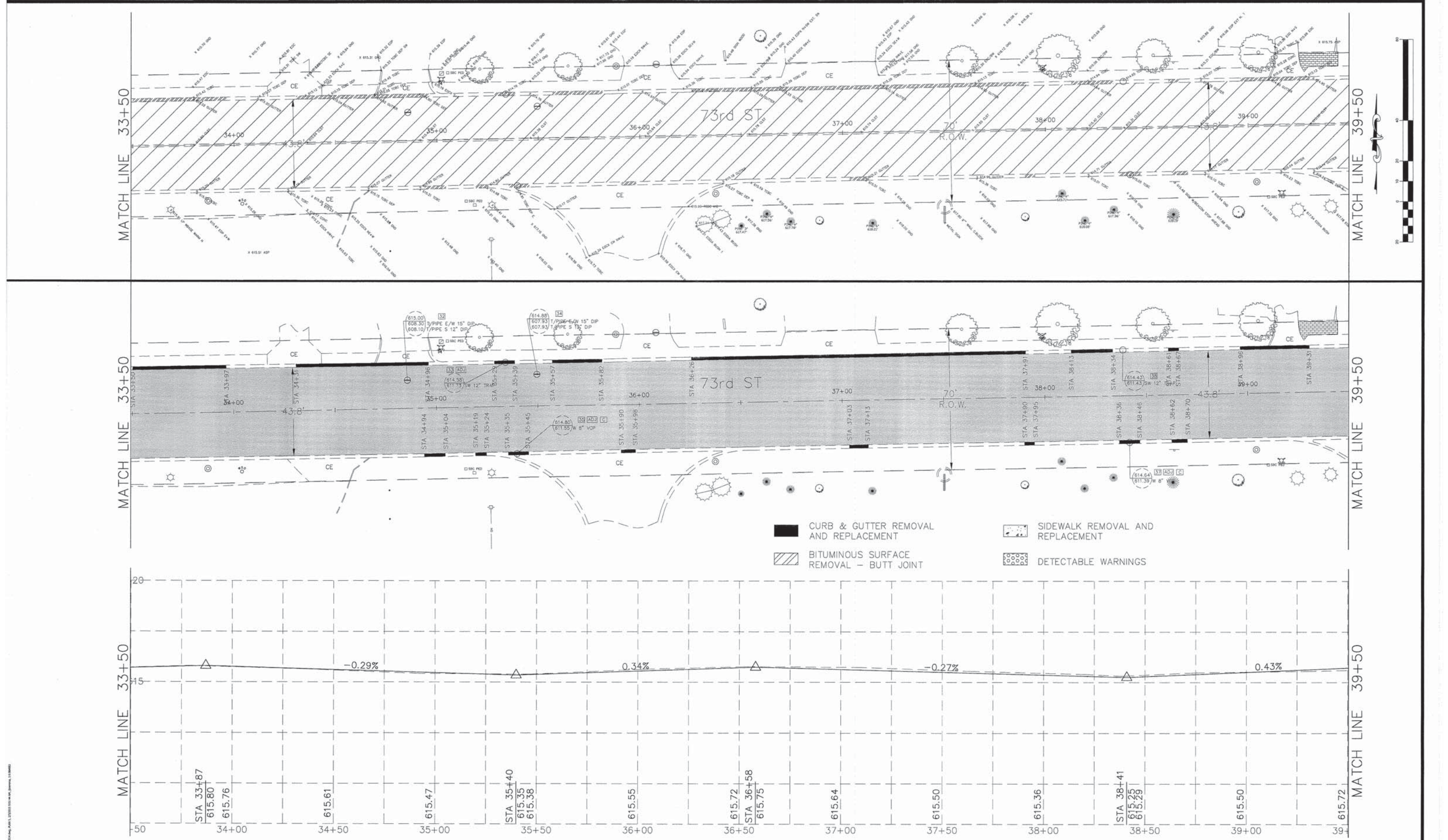

STA. 33+50 TO STA. 39+50

DRAWN BY: JMH	REVISED: _____
CHECKED BY: SAL	REVISED: _____
DATE: 12.01.14	REVISED: _____
REVISED: _____	REVISED: _____

**STATE OF ILLINOIS
DEPARTMENT OF TRANSPORTATION**

**73rd STREET
PLAN & PROFILE SHEET**

SCALE: H:1"=20' V:1"=2' SHEET No. 9 OF 20 SHEETS

FAU RTE	SECTION	COUNTY	TOTAL SHEETS	SHEET NO.
1569	14-00037-00-RS	COOK	20	9
CONTRACT No. 61B26				
FED. ROAD DIST. NO.	ILLINOIS	FED. AID PROJECT		

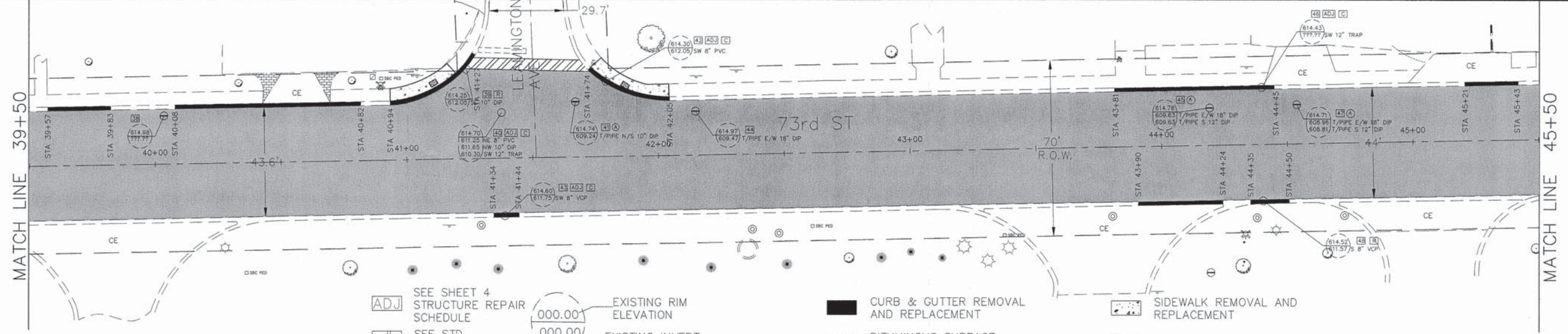
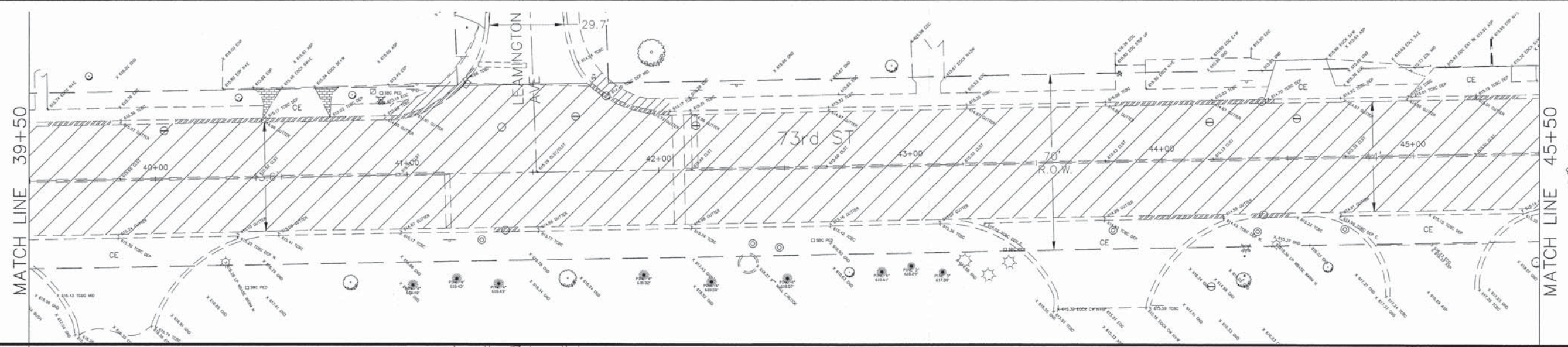

- ADJ SEE SHEET 4
STRUCTURE REPAIR
SCHEDULE
- # SEE STD.
0000001-06
- EXISTING RIM
ELEVATION
- EXISTING INVERT
ELEVATION
- CURB & GUTTER REMOVAL
AND REPLACEMENT
- BITUMINOUS SURFACE
REMOVAL - BUTT JOINT
- SIDWALK REMOVAL AND
REPLACEMENT
- DETECTABLE WARNINGS

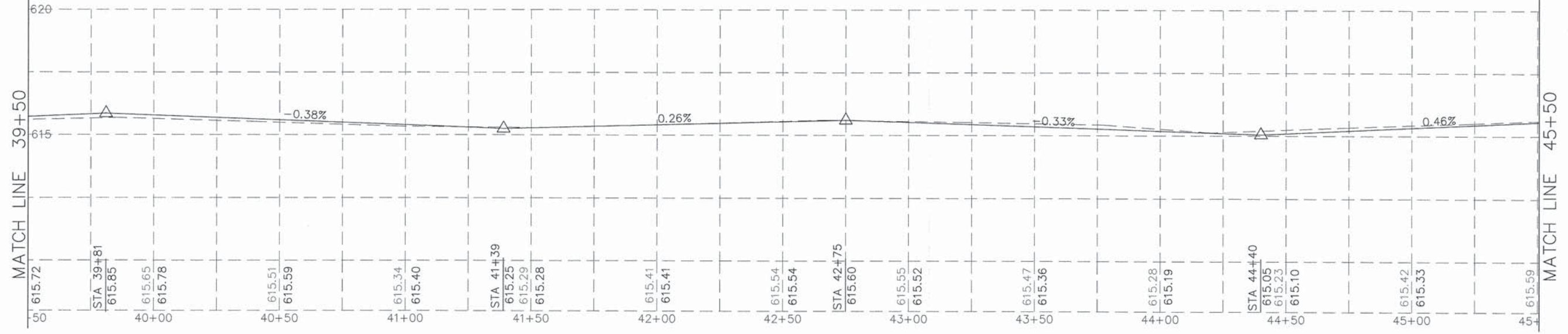

STA. 39+50 TO STA. 45+50	DRAWN BY: JMH	REVISED: _____	STATE OF ILLINOIS DEPARTMENT OF TRANSPORTATION	73rd STREET PLAN & PROFILE SHEET		FAU RTE	SECTION	COUNTY	TOTAL SHEETS	SHEET NO.
	CHECKED BY: SAL	REVISED: _____		1569	14-00037-00-RS	COOK	20	10		
	DATE: 12.01.14	REVISED: _____				CONTRACT No. 61B26				
	REVISED: _____	REVISED: _____		SCALE: H:1"=20' V:1"=2'	SHEET No. 10 OF 20 SHEETS	FED. ROAD DIST. NO.	ILLINOIS	FED. AID PROJECT		

HBE JOB No. 13-517

MATCH LINE 45+50

MATCH LINE 51+50

MATCH LINE 45+50

MATCH LINE 51+50

MATCH LINE 45+50

MATCH LINE 51+50

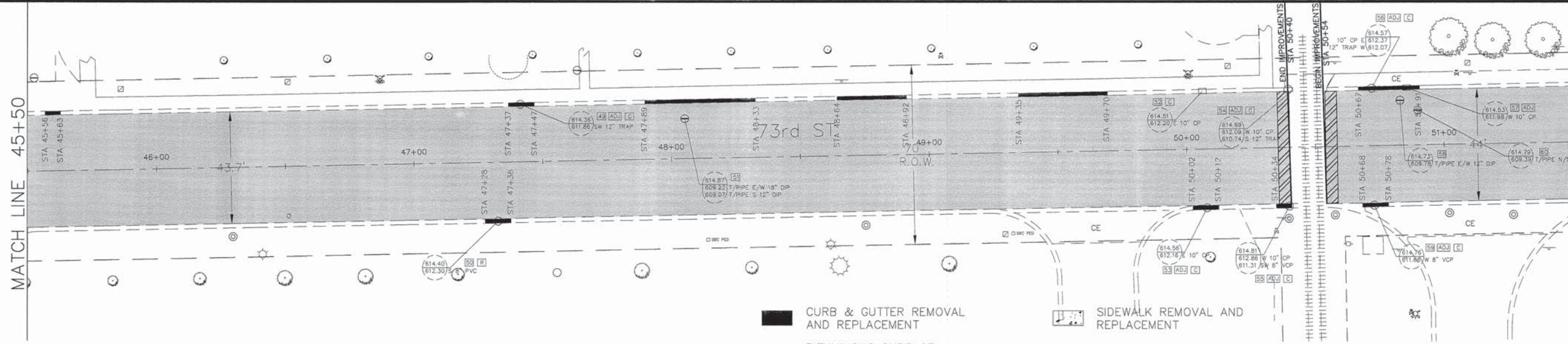
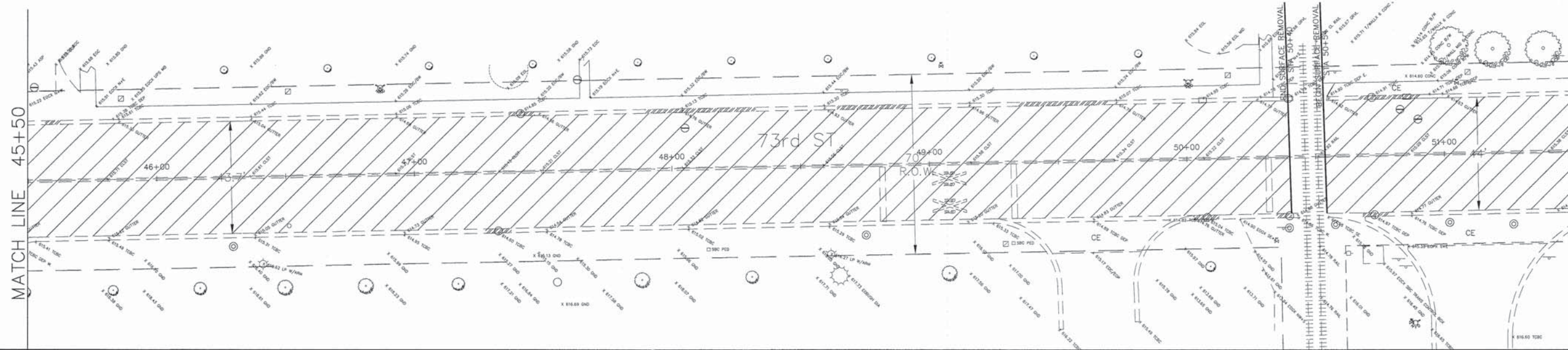

- CURB & GUTTER REMOVAL AND REPLACEMENT
- BITUMINOUS SURFACE REMOVAL - BUTT JOINT
- SIDEWALK REMOVAL AND REPLACEMENT
- DETECTABLE WARNINGS

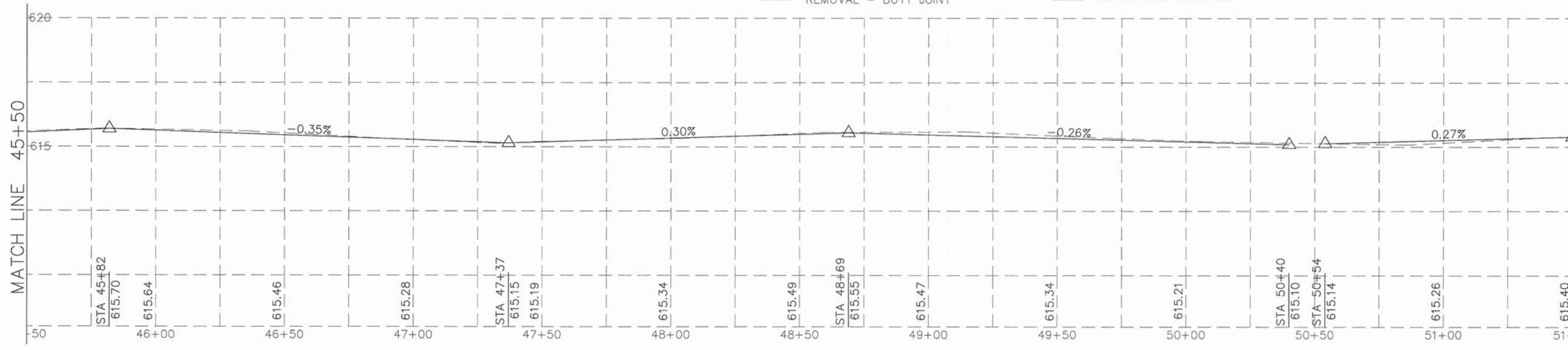

STA. 45+50 TO STA. 51+50

DRAWN BY: JMH	REVISED: _____
CHECKED BY: SAL	REVISED: _____
DATE: 12.01.14	REVISED: _____
REVISED: _____	REVISED: _____

**STATE OF ILLINOIS
DEPARTMENT OF TRANSPORTATION**

**73rd STREET
PLAN & PROFILE SHEET**

FAU RTE	SECTION	COUNTY	TOTAL SHEETS	SHEET NO.
1569	14-00037-00-RS	COOK	20	11
CONTRACT No. 61B26				
FED. ROAD DIST. NO.	ILLINOIS	FED. AID PROJECT		

SCALE: H:1"=20' V:1"=2' SHEET No. 11 OF 20 SHEETS

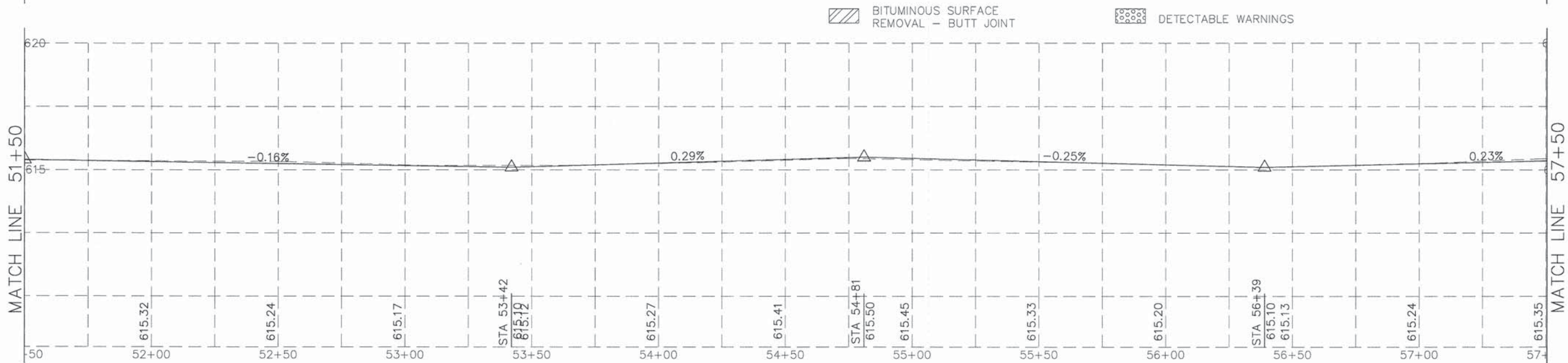
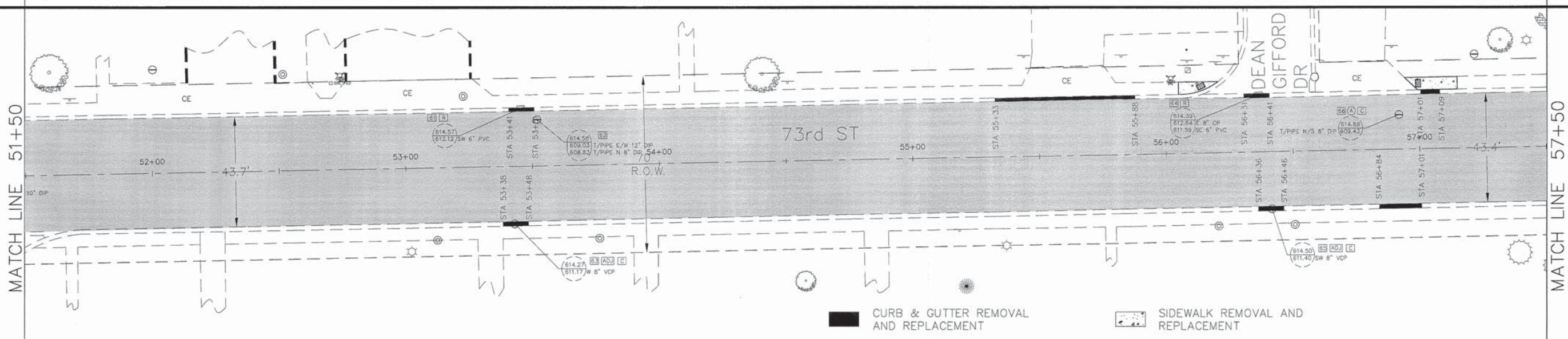
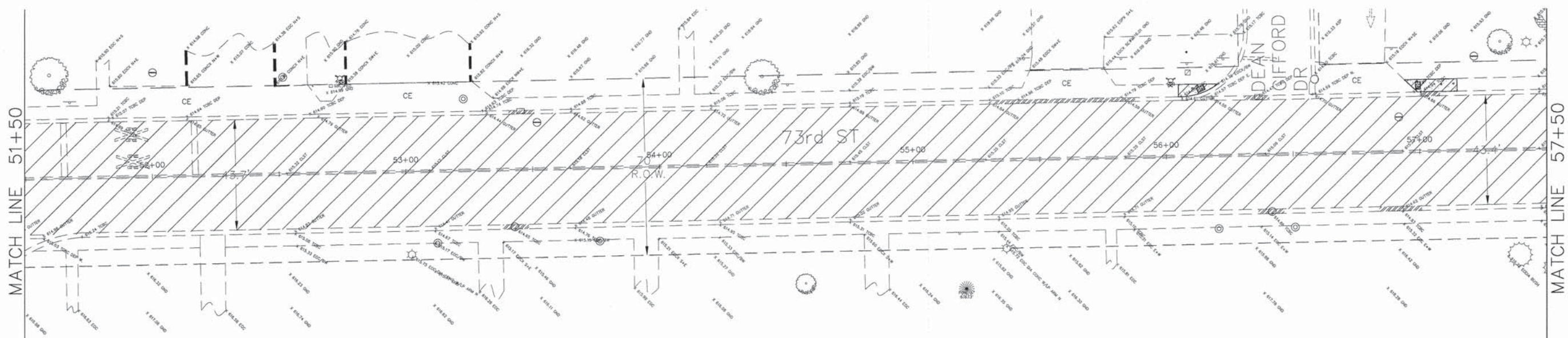

- CURB & GUTTER REMOVAL AND REPLACEMENT
- BITUMINOUS SURFACE REMOVAL - BUTT JOINT
- SIDEWALK REMOVAL AND REPLACEMENT
- DETECTABLE WARNINGS



STA. 51+50 TO STA. 57+50	DRAWN BY: JMH	REVISED: _____
	CHECKED BY: SAL	REVISED: _____
	DATE: 12.01.14	REVISED: _____
	REVISED: _____	REVISED: _____

**STATE OF ILLINOIS
DEPARTMENT OF TRANSPORTATION**

**73rd STREET
PLAN & PROFILE SHEET**

SCALE: H:1"=20' V:1"=2'

SHEET No. 12 OF 20 SHEETS

FAU RTE	SECTION	COUNTY	TOTAL SHEETS	SHEET NO.
1569	14-00037-00-RS	COOK	20	12
CONTRACT No. 61B26				
FED. ROAD DIST. NO.	ILLINOIS	FED. AID PROJECT		

© 2014 HCSS, Inc. All rights reserved. HCSS is a registered trademark of HCSS, Inc.

HBE JOB No. 13-517

MATCH LINE 57+50

MATCH LINE 57+50

MATCH LINE 57+50

CICERO AVE (IL-50)

CICERO AVE (IL-50)

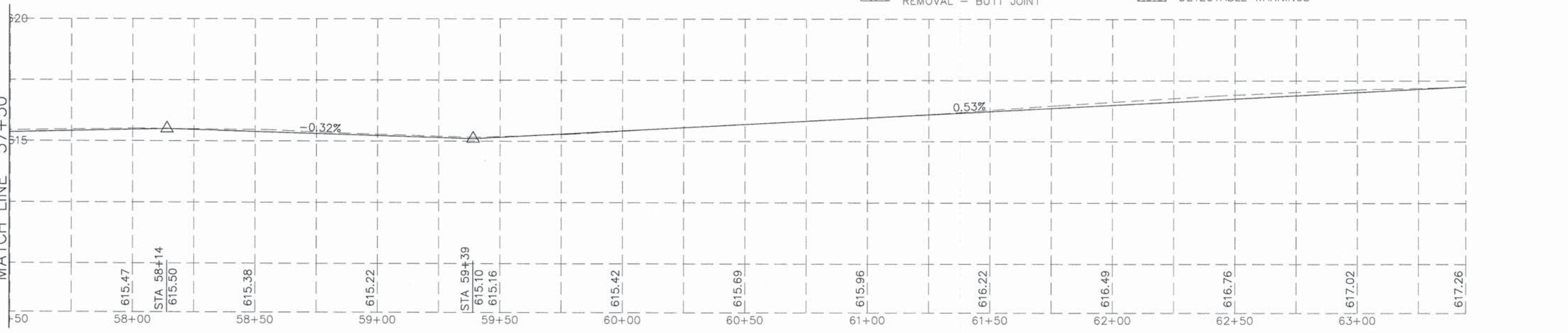
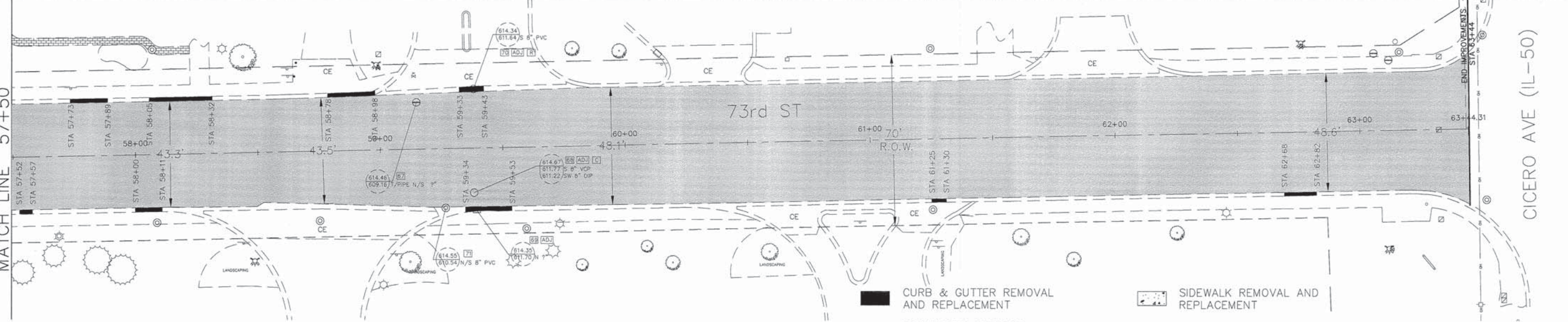
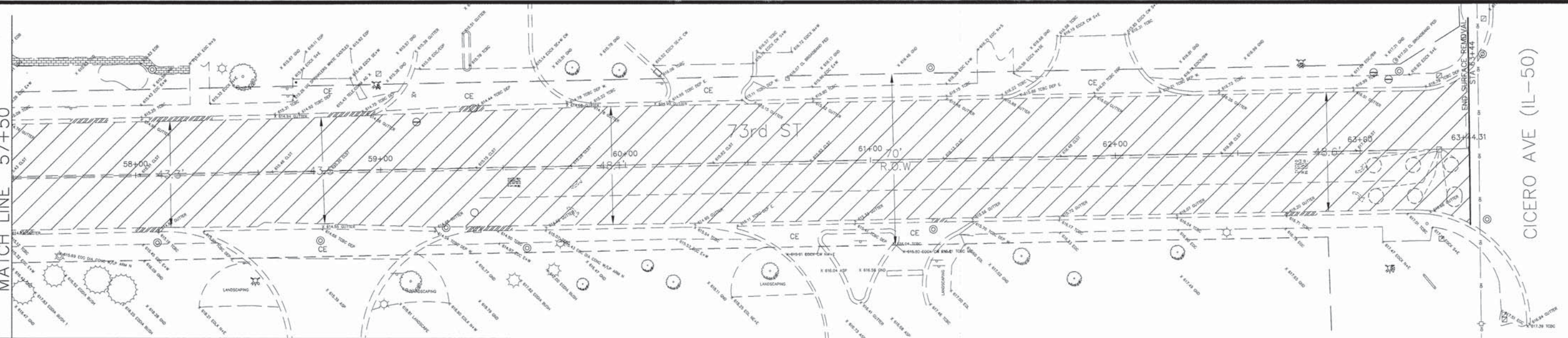
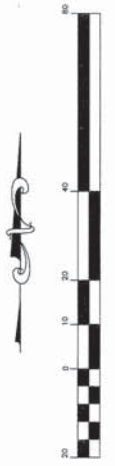

STA. 57+50 TO STA. 63+44.3

DRAWN BY: JMH	REVISED: _____
CHECKED BY: SAL	REVISED: _____
DATE: 12.01.14	REVISED: _____
REVISED: _____	REVISED: _____

**STATE OF ILLINOIS
DEPARTMENT OF TRANSPORTATION**

**73rd STREET
PLAN & PROFILE SHEET**

FAU RTE	SECTION	COUNTY	TOTAL SHEETS	SHEET NO.
1569	14-00037-00-RS	COOK	20	13
CONTRACT No. 61B26				
SCALE: H:1"=20' V:1"=2'		SHEET No. 13 OF 20 SHEETS	FED. ROAD DIST. NO.	ILLINOIS
			FED. AID PROJECT	

P:\Projects\130107000\130107000.dwg, 12/01/14, 10:00:00 AM, 130107000.dwg, 130107000.dwg

HBE JOB No: 13-517

73rd STREET RESURFACING STRUCTURE REPAIR SCHEDULE						
STRUCTURE No.	STRUCTURE TYPE	PROPOSED RIM ELEV.	ADJUST STRUCTURE	REMOVE & REPLACE STRUCTURE	CLEAN	NOTES
1	CB, 4'-DIA	615.53				
2	VALVE VAULT	615.79			X	
3	MH, 4'-DIA	615.78				OK
4	MH, 4'-DIA	615.71				OK
5	VALVE VAULT	615.63	X			
6	VALVE VAULT	615.76				OK
7	CB, 4'-DIA	614.75	X			
8	CB, 2'-DIA	614.73	X		X	
9	VALVE VAULT	615.12	X			
10	INLET, TY. A	614.93				OK
11	CB, 4'-DIA	614.70	X		X	
12	INLET, TY. A	614.88		X		
13	VALVE VAULT	615.04	X			
14	CB, 2'-DIA	614.63		X		
15	CB, 4'-DIA	614.61	X		X	
16	INLET, TY. A	614.61	X		X	RE-MORTAR AROUND OUTLET PIPE
17	CB, 4'-DIA	615.04	X		X	RE-MORTAR AROUND OUTLET PIPE
18	CB, 2'-DIA	614.75	X		X	RE-ALIGN RINGS TO MEET FLOW LINE
19	INLET, TY. A	614.71	X		X	RE-MORTAR AROUND OUTLET PIPE
20	CB, 4'-DIA	614.90	X		X	RE-MORTAR AROUND OUTLET PIPE
21	CB, 2'-DIA	614.79	X		X	
22	INLET, TY. A	614.59	X		X	RE-MORTAR AROUND OUTLET PIPE
23	CB, 4'-DIA	614.71	X		X	
24	CB, 2'-DIA	614.68	X		X	
25	VALVE VAULT	615.22	X			
26	MH, 4'-DIA	614.89	X			
27	CB, 4'-DIA	614.46	X		X	
28	INLET, TY. A	614.33	X		X	
29	CB, 4'-DIA	614.61	X		X	
30	CB, 2'-DIA	614.70	X		X	
31	CB, 4'-DIA	615.02	X			
32	VALVE VAULT	615.00				OK
33	CB, 4'-DIA	614.58	X			
34	VALVE VAULT	614.88				OK
35	CB, 2'-DIA	614.80	X		X	RE-MORTAR WALL AROUND OUTLET PIPE
36	CB, 4'-DIA	614.43				OK
37	CB, 2'-DIA	614.64	X		X	
38	VALVE VAULT	614.98				OK
39	INLET, TY. A	614.25		X		
40	MH, 4'-DIA	614.70	X		X	
41	VALVE VAULT	614.74	X			
42	CB, 2'-DIA	614.30	X		X	
43	INLET, TY. A	614.60	X		X	
44	VALVE VAULT	614.97				OK
45	VALVE VAULT	614.78	X			
46	CB, 4'-DIA	614.43	X		X	
47	VALVE VAULT	614.71	X			
48	CB, 2'-DIA	614.52		X		
49	CB, 4'-DIA	614.36	X		X	
50	CB, 2'-DIA	614.40		X		
51	VALVE VAULT	614.87				OK
52	INLET, TY. A	614.51	X		X	LID CANNOT BE OPENED
53	INLET, TY. A	614.56	X		X	
54	CB, 4'-DIA	614.89	X		X	RE-MORTAR INSIDE WALL WHERE NEEDED
55	CB, 2'-DIA	614.81	X		X	
56	CB, 4'-DIA	614.57	X		X	
57	INLET, TY. A	614.53	X			RE-MORTAR INSIDE WALL WHERE NEEDED
58	VALVE VAULT	614.73				OK
59	CB, 2'-DIA	614.76	X		X	
60	VALVE VAULT	614.79				OK
61	INLET, TY. A	614.57		X		
62	VALVE VAULT	614.58				OK
63	CB, 2'-DIA	614.27	X		X	
64	INLET, TY. A	614.39		X		
65	CB, 2'-DIA	614.50	X		X	
66	VALVE VAULT	614.88	X		X	
67	VALVE VAULT	614.46				OK
68	CB, 4'-DIA	614.67	X		X	
69	INLET, TY. A	614.35	X			RE-ALIGN RINGS & RE-MORTAR
70	INLET, TY. A	614.34	X		X	
71	SAN MH-4' DIA	614.55				OK

NOTES: STRUCTURES WITHIN PAVED AREAS WHERE IT HAS BEEN DETERMINED THAT NEW ADJUSTING RINGS ARE NEEDED SHALL BE MODIFIED TO INSTALL RUBBERIZED ADJUSTMENT RINGS. MAXIMUM ADJUSTMENT FOR RUBBER RINGS TO BE 3 INCHES. ADDITIONAL ADJUSTMENTS IN HEIGHT SHALL BE MADE WITH PCC RINGS FOR A MAXIMUM TOTAL HEIGHT ADJUSTMENT OF 8 INCHES. ALL STRUCTURES WHICH INVOLVE ADJUSTMENTS WITH RUBBER RINGS SHALL BE PAID AS "FRAMES AND LIDS TO BE ADJUSTED (SPECIAL)".

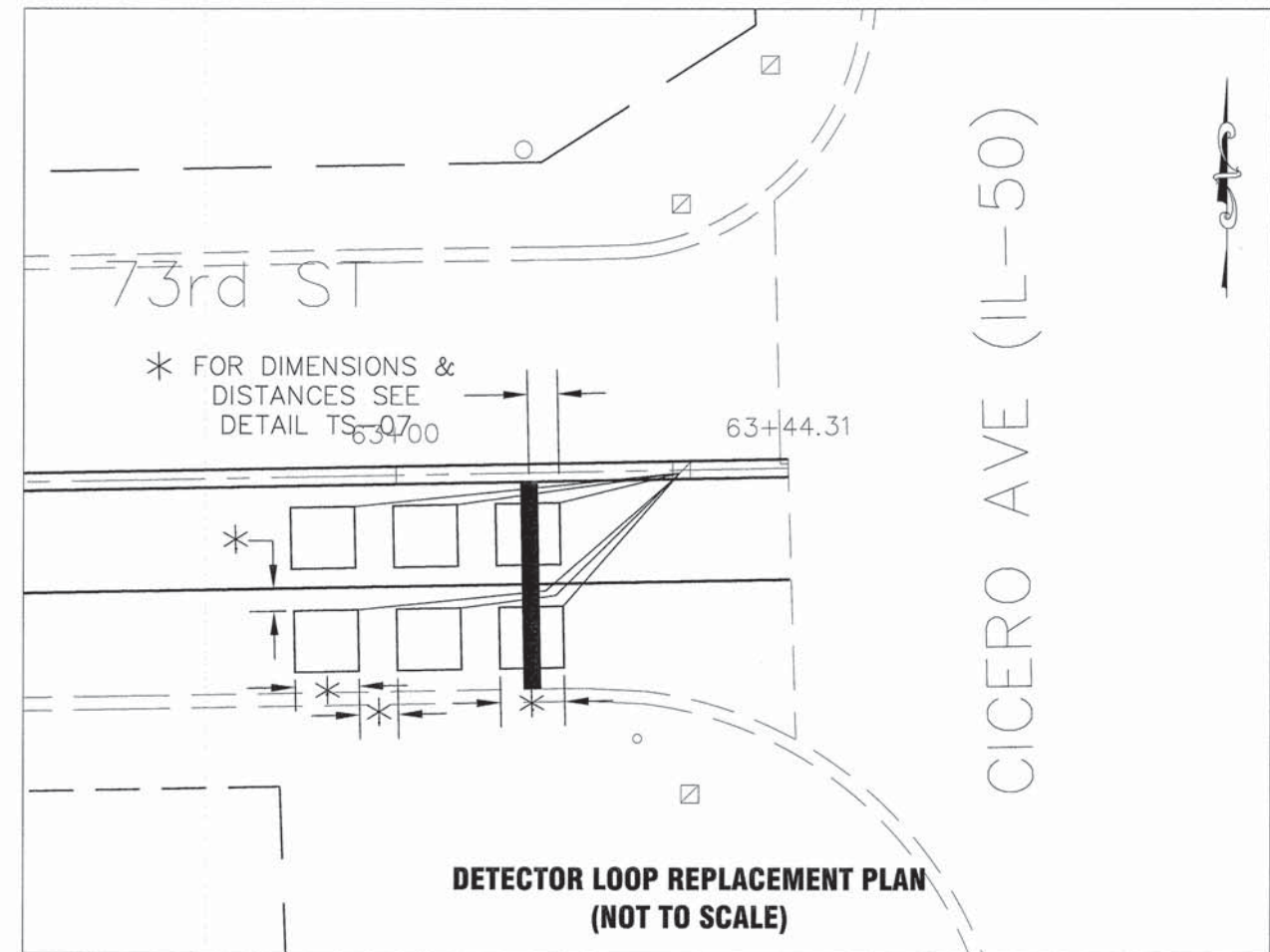

DRAWN BY: JMH CHECKED BY: SAL DATE: 12.01.14 REVISED: _____	REVISED: _____ REVISED: _____ REVISED: _____ REVISED: _____	STATE OF ILLINOIS DEPARTMENT OF TRANSPORTATION	73rd STREET STRUCTURE REPAIR SCHEDULE, DETECTOR LOOP PLAN		FAU RTE	SECTION	COUNTY	TOTAL SHEETS	SHEET NO.		
			1569	14-00037-00-RS	COOK	20	14				
			CONTRACT No. 61B26					FED. ROAD DIST. NO.	ILLINOIS	FED. AID PROJECT	
			SCALE: N.T.S.		SHEET No. 14 OF 20 SHEETS						

12/1/14 11:58 AM 12/1/14 11:58 AM 12/1/14 11:58 AM 12/1/14 11:58 AM 12/1/14 11:58 AM 12/1/14 11:58 AM 12/1/14 11:58 AM 12/1/14 11:58 AM 12/1/14 11:58 AM 12/1/14 11:58 AM

SEE JOB No. 13-917

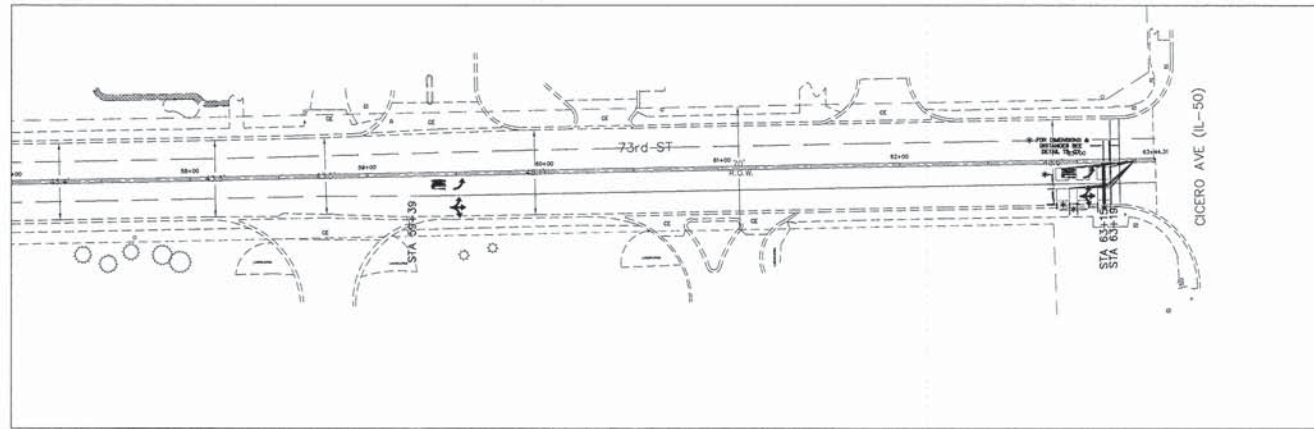
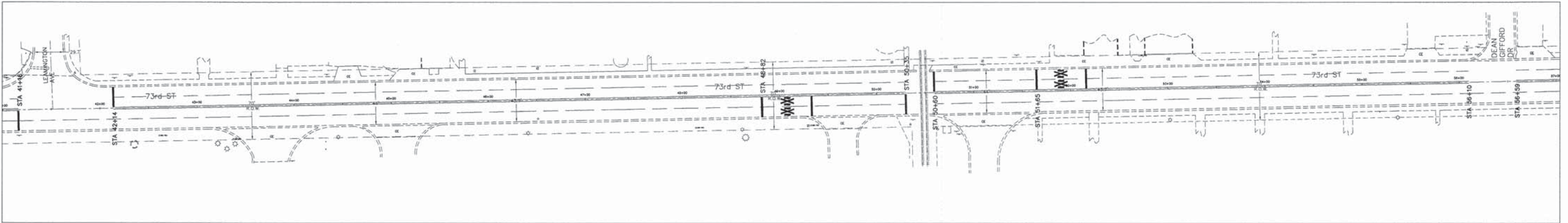
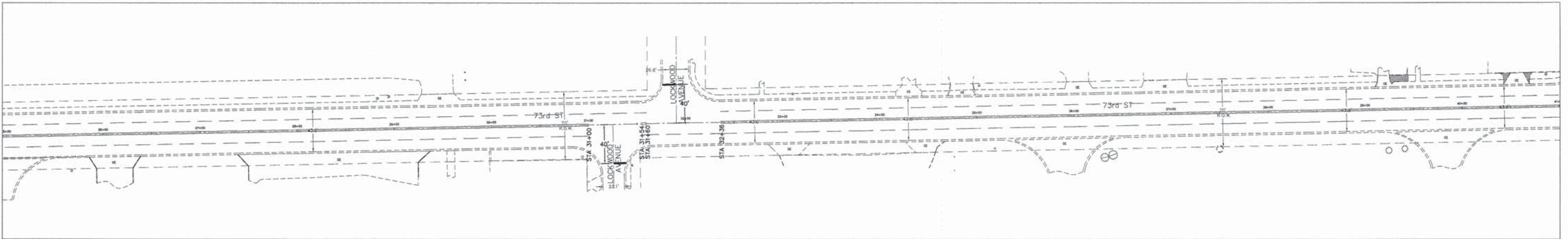
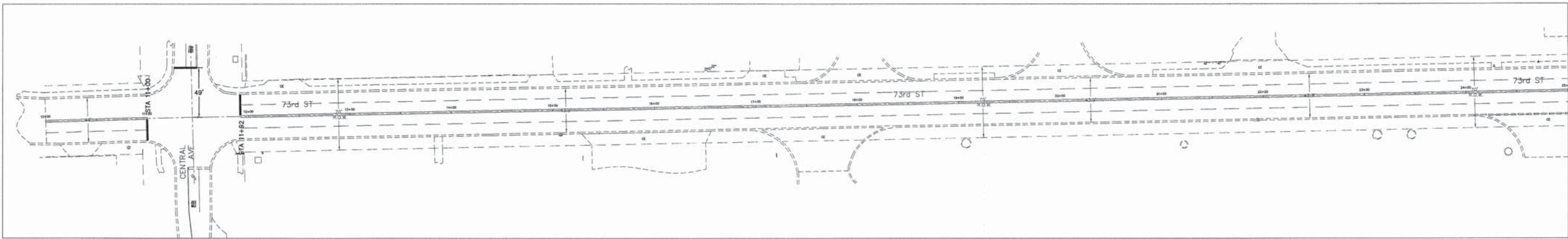

DRAWN BY: JMH	REVISED: _____	STATE OF ILLINOIS DEPARTMENT OF TRANSPORTATION	73rd STREET PAVEMENT MARKING PLAN		FAU RTE	SECTION	COUNTY	TOTAL SHEETS	SHEET NO.
	CHECKED BY: SAL		REVISED: _____	1569	14-00037-00-RS	COOK	20	15	
DATE: 12.01.14	REVISED: _____		CONTRACT No. 61B26						
REVISED: _____	REVISED: _____		SCALE: H:1"=50'	SHEET No. 15 OF 20 SHEETS	FED. ROAD DIST. NO.	ILLINOIS	FED. AID PROJECT		

PROJECT NO. 14-00037-00-RS SHEET NO. 15 OF 20
 DATE: 12/01/14
 DRAWN BY: JMH
 CHECKED BY: SAL
 DATE: 12/01/14
 REVISED: _____
 REVISED: _____

HBE JOB No. 13-517

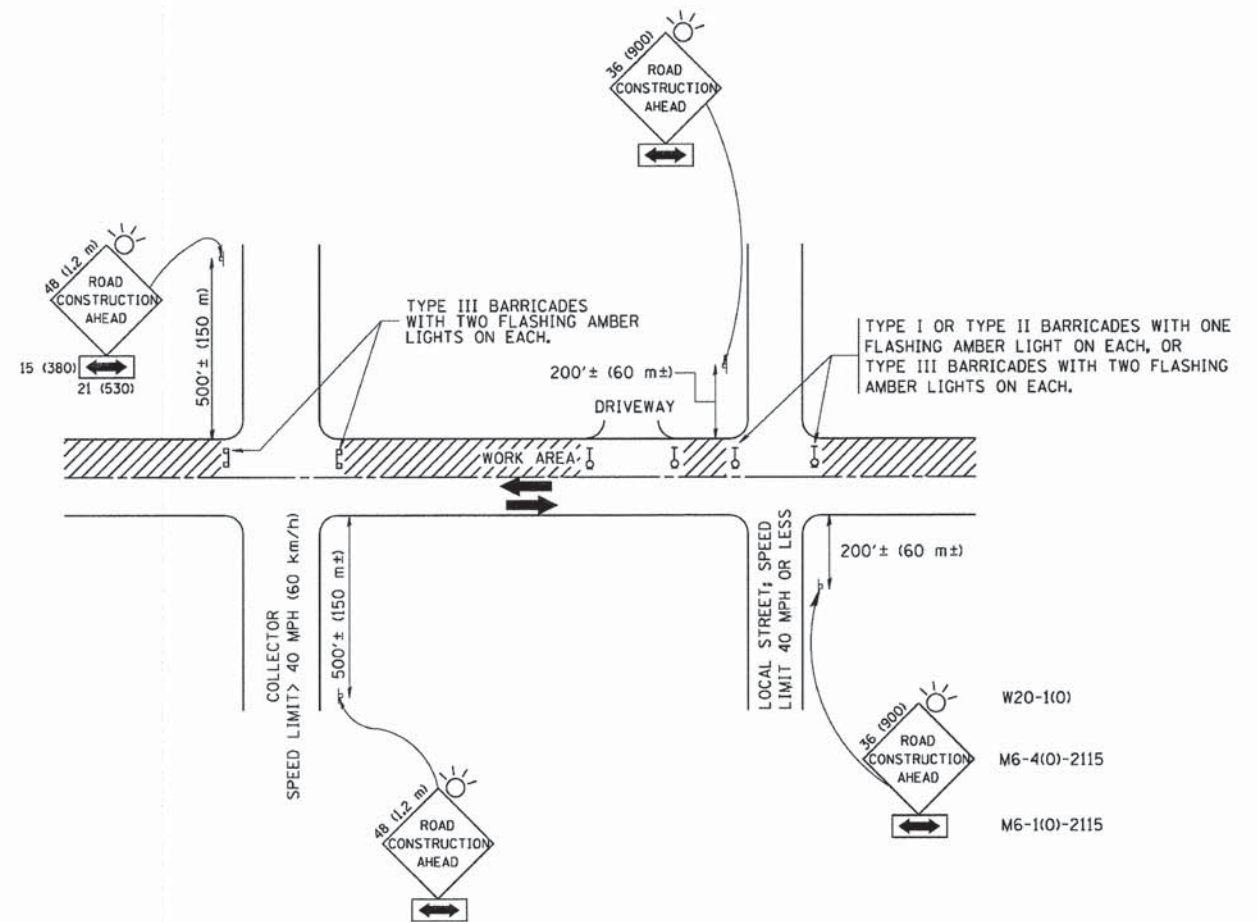

TRAFFIC CONTROL AND PROTECTION FOR SIDE ROADS, INTERSECTIONS, AND DRIVEWAYS

NOTES:

A. FOR NO LANE RESTRICTION ON THE SIDE ROAD OR DRIVEWAYS

1. SIDE ROAD WITH A SPEED LIMIT OF 40 MPH (60 km/h) OR LESS AS SHOWN ON THE DRAWING AND AS DIRECTED BY THE ENGINEER:

a) ONE ROAD CONSTRUCTION AHEAD SIGN 36 x 36 (900x900) WITH A FLASHER AND FLAG MOUNTED ON IT APPROXIMATELY 200' (60 m) IN ADVANCE OF THE MAIN ROUTE.

b) THE CLOSED PORTION OF THE MAIN ROUTE SHALL BE PROTECTED BY BLOCKING WITH TYPE I, TYPE II OR TYPE III BARRICADES, 1/3 OF THE CROSS SECTION OF THE CLOSED PORTION.

2. SIDE ROAD WITH A SPEED LIMIT GREATER THAN 40 MPH (60 km/h) AS SHOWN ON THE DRAWING AND AS DIRECTED BY THE ENGINEER:

a) ONE ROAD CONSTRUCTION AHEAD SIGN 48 x 48 (1.2 m x 1.2 m) WITH A FLASHER MOUNTED ON IT APPROXIMATELY 500' (150 m) IN ADVANCE OF THE MAIN ROUTE.

b) THE CLOSED PORTION OF THE MAIN ROUTE SHALL BE PROTECTED BY BLOCKING WITH TYPE III BARRICADES, 1/2 OF THE CROSS SECTION OF THE CLOSED PORTION.

3. WHEN THE SIDE ROAD LIES BETWEEN THE BEGINNING OF THE MAINLINE SIGNING AND THE WORK ZONE, A SINGLE HEADED ARROW (M6-1) SHALL BE USED IN LIEU OF THE DOUBLE HEADED ARROW (M6-4).

B. FOR A LANE CLOSURE ON A SIDE ROAD OR DRIVEWAY:

USE APPLICABLE PORTIONS OF THE TYPICAL APPLICATION OF TRAFFIC CONTROL DEVICES (STD. 701501, STD. 701606 OR THE APPROPRIATE STANDARD). THE SPACING OF SIGNS AND BARRICADES SHALL BE ADJUSTED FOR FIELD CONDITIONS AS DIRECTED BY THE ENGINEER. THE DIRECTIONAL ARROW SHALL BE COVERED OR REMOVED WHEN NO LONGER CONSISTENT WITH THE SIDE ROAD LANE CLOSURE.

C. ADVANCE WARNING SIGNS ARE TO BE OMITTED ON DRIVEWAY UNLESS OTHERWISE NOTED.

D. THE TRAFFIC CONTROL AND PROTECTION FOR SIDE ROADS, INTERSECTIONS, AND DRIVEWAYS SHALL BE INCIDENTAL TO THE COST OF SPECIFIED TRAFFIC CONTROL STANDARDS OR ITEMS.

All dimensions are in millimeters (inches) unless otherwise shown.

FILE NAME = W:\d\statd\22x34\td18.dgn	USER NAME = gaglienobt	DESIGNED - LHA	REVISED - J. OBERLE 10-18-95
		DRAWN -	REVISED - A. HOUSEH 03-06-96
	PLOT SCALE = 50,000' / IN.	CHECKED -	REVISED - A. HOUSEH 10-15-96
	PLOT DATE = 1/4/2008	DATE - 06-89	REVISED - T. RAMMACHER 01-06-00

STATE OF ILLINOIS
DEPARTMENT OF TRANSPORTATION

TRAFFIC CONTROL AND PROTECTION FOR SIDE ROADS, INTERSECTIONS, AND DRIVEWAYS	
SCALE: NONE	SHEET NO. 1 OF 1 SHEETS
STA.	TO STA.

F.A. RTE.	SECTION	COUNTY	TOTAL SHEETS	SHEET NO.
1569	14-00037-00-RS	COOK	20	16
TC-10			CONTRACT NO. 61B26	
FED. ROAD DIST. NO. 1 ILLINOIS FED. AID PROJECT				

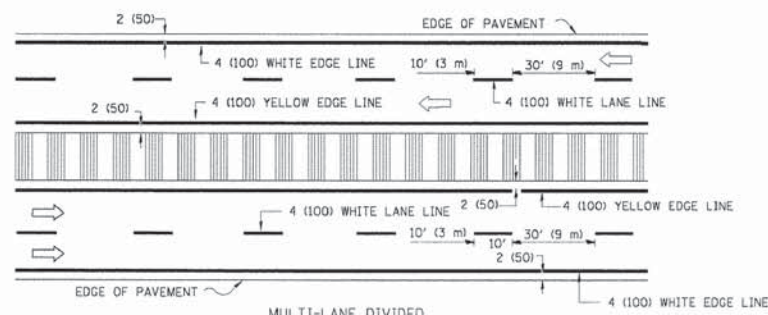
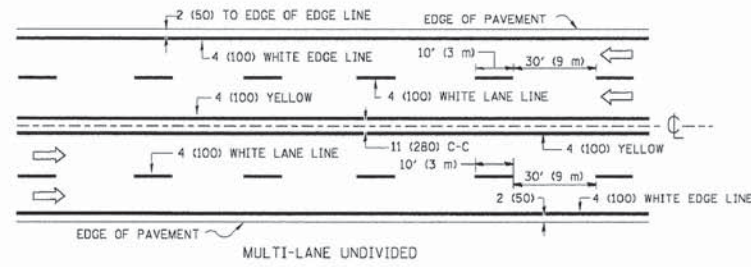
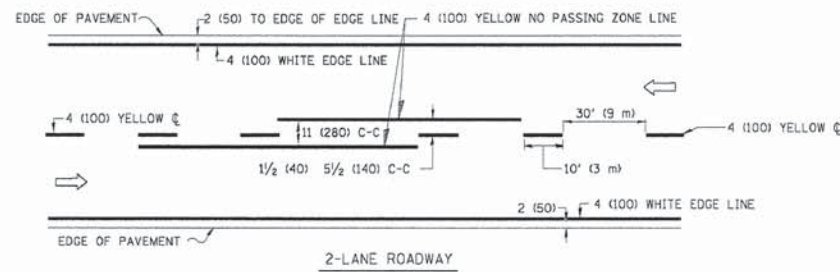

NOTE: MEDIANS WITH BARRIER CURB DO NOT REQUIRE AN EDGE LINE

TYPICAL LANE AND EDGE LINE MARKING

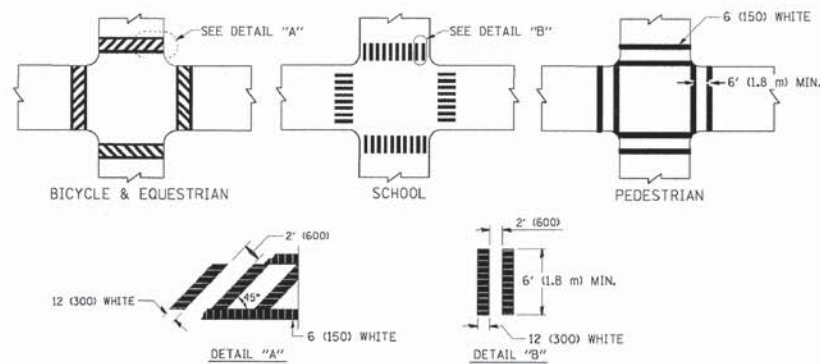

TYPICAL CROSSWALK MARKING

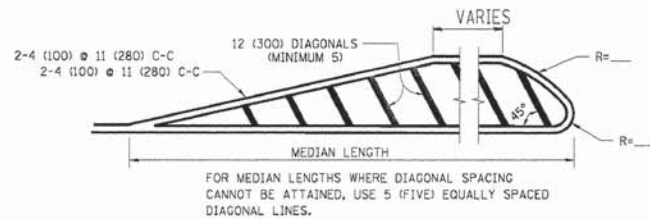
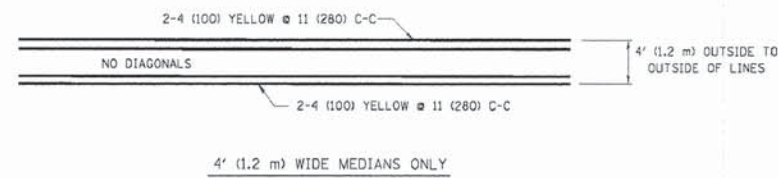

DIAGONAL LINE SPACING: 50' (15 m) C-C (LESS THAN 30MPH (50 km/h))
75' (25 m) C-C 30MPH (50 km/h) TO 45MPH (70 km/h)
150' (45 m) C-C (MORE THAN 45MPH (70 km/h))

MEDIANS OVER 4' (1.2 m) WIDE

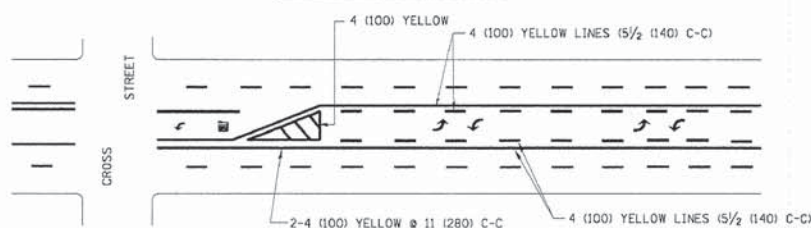

A MINIMUM OF TWO PAIRS OF TURN ARROWS SHALL BE USED, WHITE IN COLOR. ADDITIONAL PAIRS SHALL BE PLACED AT 200' (60 m) TO 300' (90 m) INTERVALS.

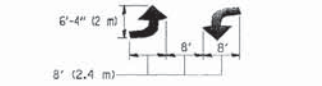

MEDIAN WITH TWO-WAY LEFT TURN LANE

TYPICAL PAINTED MEDIAN MARKING

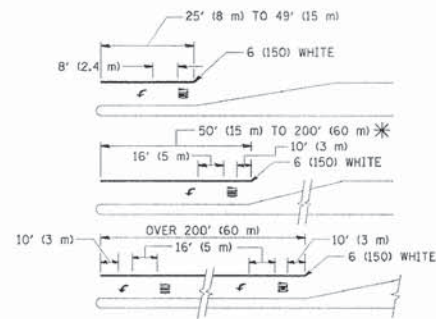

FULL SIZE LETTERS 8' (2.4 m) AND ARROWS SHALL BE USED.
AREA = 15.6 SQ. FT. (1.5 m²) ONLY AREA = 20.8 SQ. FT. (1.9 m²)

* TURN LANES IN EXCESS OF 400' (120 m) IN LENGTH MAY HAVE AN ADDITIONAL SET OF ARROW - "ONLY" INSTALLED MIDWAY BETWEEN THE OTHER TWO SETS OF ARROW - "ONLY".

TYPICAL LEFT (OR RIGHT) TURN LANE

TYPICAL TURN LANE MARKING

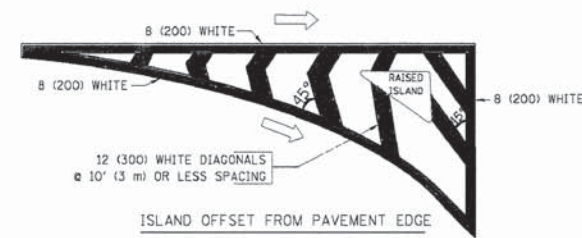

ISLAND OFFSET FROM PAVEMENT EDGE

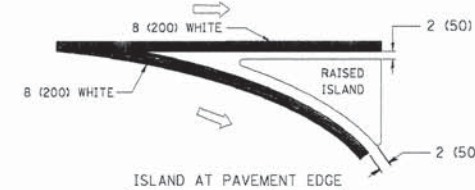

ISLAND AT PAVEMENT EDGE

TYPICAL ISLAND MARKING

TYPE OF MARKING	WIDTH OF LINE	PATTERN	COLOR	SPACING / REMARKS
CENTERLINE ON 2 LANE PAVEMENT	4 (100)	SKIP-DASH	YELLOW	10' (3 m) LINE WITH 30' (9 m) SPACE
CENTERLINE ON MULTI-LANE UNDIVIDED PAVEMENT	2 @ 4 (100)	SOLID	YELLOW	11 (280) C-C
NO PASSING ZONE LINES: FOR ONE DIRECTION FOR BOTH DIRECTIONS	4 (100) 2 @ 4 (100)	SOLID SOLID	YELLOW YELLOW	5/2 (140) C-C FROM SKIP-DASH CENTERLINE 11 (280) C-C OMIT SKIP-DASH CENTERLINE BETWEEN
LANE LINES	4 (100) 5 (125) ON FREEWAYS	SKIP-DASH SKIP-DASH	WHITE WHITE	10' (3 m) LINE WITH 30' (9 m) SPACE
DOTTED LINES (EXTENSIONS OF CENTER, LANE OR TURN LANE MARKINGS)	SAME AS LINE BEING EXTENDED	SKIP-DASH	SAME AS LINE BEING EXTENDED	2' (600) LINE WITH 6' (1.8 m) SPACE
EDGE LINES	4 (100)	SOLID	YELLOW-LEFT WHITE-RIGHT	OUTLINE MOUNTABLE MEDIANS IN YELLOW; EDGE LINES ARE NOT USED NEXT TO BARRIER CURB
TURN LANE MARKINGS	6 (150) LINE; FULL SIZE LETTERS & SYMBOLS (8' (2.4m))	SOLID	WHITE	SEE TYPICAL TURN LANE MARKING DETAIL
TWO WAY LEFT TURN MARKING	2 @ 4 (100) EACH DIRECTION 8' (2.4m) LEFT ARROW	SKIP-DASH AND SOLID IN PAIRS	YELLOW WHITE	10' (3 m) LINE WITH 30' (9 m) SPACE FOR SKIP-DASH; 5/2 (140) C-C BETWEEN SOLID LINE AND SKIP-DASH LINE SEE TYPICAL TWO-WAY LEFT TURN MARKING DETAIL
CROSSWALK LINES (PEDESTRIAN) A. DIAGONALS (BIKE & EQUESTRIAN) B. LONGITUDINAL BARS (SCHOOL)	2 @ 6 (150) 12 (300) @ 45° 12 (300) @ 90°	SOLID SOLID SOLID	WHITE WHITE WHITE	NOT LESS THAN 6' (1.8 m) APART 2' (600) APART 2' (600) APART SEE TYPICAL CROSSWALK MARKING DETAILS.
STOP LINES	24 (600)	SOLID	WHITE	PLACE 4' (1.2 m) IN ADVANCE OF AND PARALLEL TO CROSSWALK, IF PRESENT. OTHERWISE, PLACE AT DESIRED STOPPING POINT. PARALLEL TO CROSSROAD CENTERLINE, WHERE POSSIBLE
PAINTED MEDIANS	2 @ 4 (100) WITH 12 (300) DIAGONALS @ 45° NO DIAGONALS USED FOR 4' (1.2 m) WIDE MEDIANS	SOLID	YELLOW: TWO WAY TRAFFIC WHITE: ONE WAY TRAFFIC	11 (280) C-C FOR THE DOUBLE LINE SEE TYPICAL PAINTED MEDIAN MARKING.
GORE MARKING AND CHANNELIZING LINES	8 (200) WITH 12 (300) DIAGONALS @ 45°	SOLID	WHITE	DIAGONALS: 15' (4.5 m) C-C (LESS THAN 30MPH (50 km/h)) 20' (6 m) C-C 30MPH (50 km/h) TO 45MPH (70 km/h) 30' (9 m) C-C (OVER 45MPH (70 km/h))
RAILROAD CROSSING	24 (600) TRANSVERSE LINES; "RR" IS 6' (1.8 m) LETTERS; 16 (400) LINE FOR "X"	SOLID	WHITE	SEE STATE STANDARD T80001 AREA OF: "RR"=3.6 SQ. FT. (0.33 m ²) EACH "X"=54.0 SQ. FT. (5.0 m ²)
SHOULDER DIAGONALS	12 (300) @ 45°	SOLID	WHITE - RIGHT YELLOW - LEFT	50' (15 m) C-C (LESS THAN 30MPH (50 km/h)) 75' (25 m) C-C 30 MPH (50 km/h) TO 45MPH (70 km/h) 150' (45 m) C-C (OVER 45MPH (70 km/h))

FOR FURTHER DETAILS ON PAVEMENT MARKING REFER TO STANDARD SPECIFICATIONS FOR ROAD AND BRIDGE CONSTRUCTION AND STATE STANDARD T80001.

All dimensions are in inches (millimeters) unless otherwise shown.

FILE NAME =	USER NAME = drsvakosgn	DESIGNED - EVERS	REVISED - T. RAMMACHER 10-27-94
\\pwwork\pwwork\drsvakosgn\18180315\18180315.dgn		DRAWN -	REVISED - C. JUICIUS 09-09-09
		PLOT SCALE = 50,000' / IN	CHECKED -
		PLOT DATE = 9/19/2009	REVISI
		DATE - 03-19-90	REVISED -

**STATE OF ILLINOIS
DEPARTMENT OF TRANSPORTATION**

**DISTRICT ONE
TYPICAL PAVEMENT MARKINGS**

SCALE: NONE	SHEET NO. 1 OF 1 SHEETS	STA. TO STA.	F.A. -	SECTION	COUNTY	TOTAL SHEETS	SHEET NO.
			1569	14-00037-00-RS	COOK	2120	17
				TC-13			CONTRACT NO. 61B26
			FED. ROAD DIST. NO. 1 ILLINOIS FED. AID PROJECT				

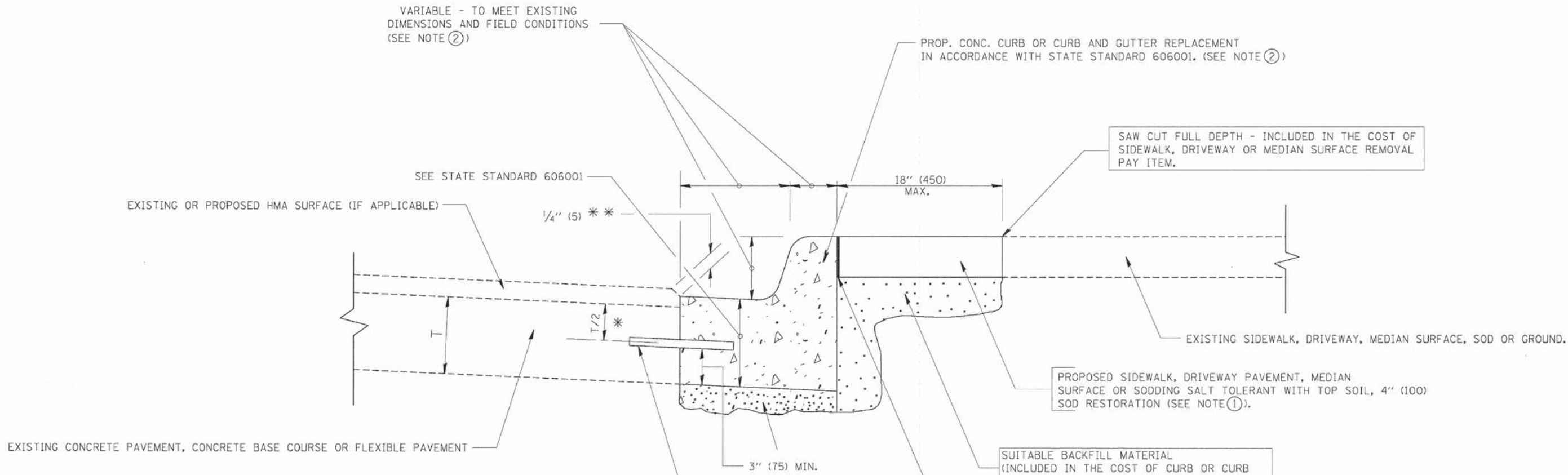

- * 3" (75) MINIMUM FROM TOP AND BOTTOM OF THE CONCRETE PAVEMENT OR BASE COURSE.
- ** IF THE FINAL SURFACE OF THE PAVEMENT IS CONCRETE, THE GUTTER IS TO BE FLUSH WITH THE PAVEMENT.

- NOTE: ① SIDEWALK, DRIVEWAY PAVEMENT OR MEDIAN SURFACE SHALL BE SIMILAR TO THE MATERIAL BEING REMOVED AND WILL BE PAID FOR SEPARATELY.
- SODDING, SALT TOLERANT AND TOP SOIL, FURNISH AND PLACE 4" WILL BE PAID FOR SEPARATELY.
- ② FERTILIZER FOR THE PLACEMENT OF THE SOD IS NOT REQUIRED
- ③ CURB OR CURB AND GUTTER REPLACEMENT SHALL MATCH THE SHAPE OF THE EXISTING CURB OR CURB AND GUTTER UNLESS OTHERWISE SPECIFIED.
- ④ FOR CURB OR CURB AND GUTTER REMOVAL AND REPLACEMENT ADJACENT TO FLEXIBLE PAVEMENT DELETE EPOXY COATED TIE BARS.
- ⑤ LONGITUDINAL BARS, IF ENCOUNTERED IN THE EXISTING CURB OR CURB AND GUTTER, ARE NOT TO BE REPLACED. CUTTING AND REMOVING LONGITUDINAL BARS SHALL BE INCLUDED IN THE COST OF CURB OR CURB AND GUTTER REMOVAL AND REPLACEMENT.
- ⑥ THE COST OF HMA SURFACE REMOVAL IN THE EXISTING GUTTER FLAG SHALL BE INCLUDED IN THE COST OF THE CURB AND GUTTER REMOVAL AND REPLACEMENT.
- ⑦ THE REMOVAL AND REPLACEMENT OF THE EXISTING CURB OR CURB AND GUTTER SHALL BE DONE IN ACCORDANCE WITH THE APPLICABLE PORTIONS OF SECTION 440 AND 606 OF THE STANDARD SPECIFICATIONS.
- ⑧ THE LOCATIONS OF REMOVAL AND REPLACEMENT OF EXISTING CURB OR CURB AND GUTTER SHALL BE DETERMINED BY THE RESIDENT ENGINEER AT THE TIME OF CONSTRUCTION.

UNSUITABLE SUB-BASE MATERIAL TO BE REMOVED, IF DIRECTED BY THE ENGINEER, SHALL BE REPLACED WITH EITHER SUB-BASE GRANULAR MATERIAL, TYPE B OR ADDITIONAL THICKNESS OF CONCRETE.

REMOVAL AND REPLACEMENT 4" (100) OR LESS IS INCLUDED IN THE COST OF CURB OR CURB AND GUTTER REMOVAL AND REPLACEMENT.

REMOVAL AND REPLACEMENT IN EXCESS OF 4" (100) WILL BE PAID FOR IN ACCORDANCE WITH ARTICLE 109.04 OF THE STANDARD SPECIFICATIONS.

PROPOSED #6 (20) EPOXY COATED TIE BARS 24" (600) LONG AT 24" (600) CENTERS WILL NOT BE PAID FOR SEPARATELY. DELETE EPOXY COATED TIE BARS IF EXISTING TIE BARS ARE USUABLE AS DETERMINED BY THE ENGINEER. (SEE NOTE 3).

BASIS OF PAYMENT:
 THIS WORK WILL BE PAID FOR AT THE CONTRACT UNIT PRICE PER FOOT (METER) FOR "CURB REMOVAL AND REPLACEMENT" OR "COMBINATION CONCRETE CURB AND GUTTER REMOVAL AND REPLACEMENT".

CURB OR CURB AND GUTTER REMOVAL AND REPLACEMENT

ALL DIMENSIONS ARE IN INCHES (MILLIMETERS) UNLESS OTHERWISE SHOWN.

FILE NAME =	USER NAME = drvakosgn	DESIGNED - A. HOUSEH	REVISED - R. SHAH 10-03-96	STATE OF ILLINOIS DEPARTMENT OF TRANSPORTATION	CURB OR CURB AND GUTTER REMOVAL AND REPLACEMENT	F.A. RTE.	SECTION	COUNTY	TOTAL SHEETS	SHEET NO.	
al\pv...work\p\dot\drvakosgn\10180315\bc24.dgn	DRAWN -	REVISED - A. ABBAS 03-21-97	REVISED - M. GOMEZ 01-22-01			1569	14-00037-00-RS	COOK	20	18	
PLOT SCALE = 50.000' / IN.	CHECKED -	REVISED - R. BORO 12-15-09				BD600-06 (BD-24)		CONTRACT NO. 61B26			
PLOT DATE = 12/15/2009	DATE - 03-11-94					FED. ROAD DIST. NO. 1 ILLINOIS FED. AID PROJECT					
					SCALE: NONE	SHEET NO. 1 OF 1 SHEETS		STA.	TO STA.		

HBE JOB No:13-517

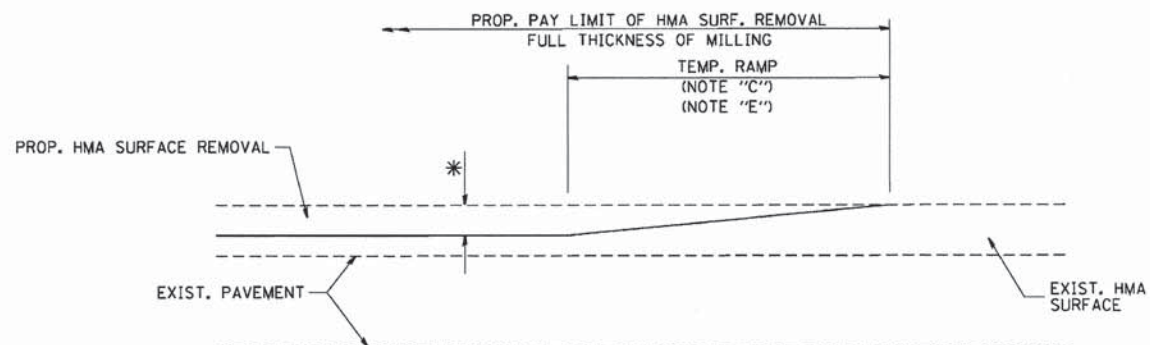

MILLED TEMPORARY RAMP
(FOR BUTT JOINT AND HMA TAPER SEE DETAIL BELOW)

OPTION 1

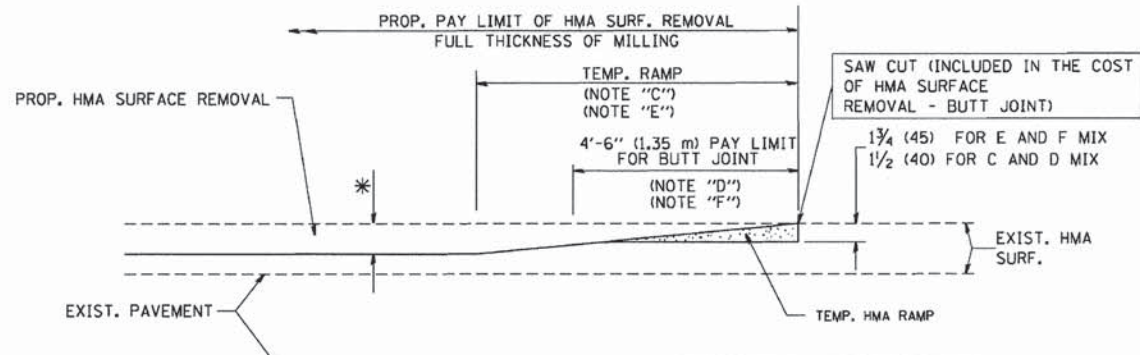

HMA CONSTRUCTED TEMPORARY RAMP
(FOR BUTT JOINT AND HMA TAPER SEE DETAIL BELOW)

OPTION 2

TYPICAL TEMPORARY RAMP

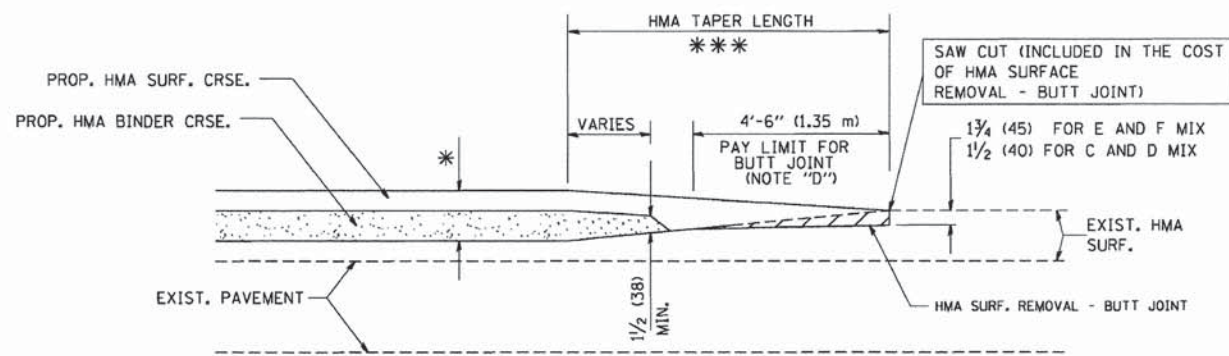

BUTT JOINT AND
HMA TAPER

TYPICAL BUTT JOINT AND HMA TAPER
FOR MILLING AND RESURFACING

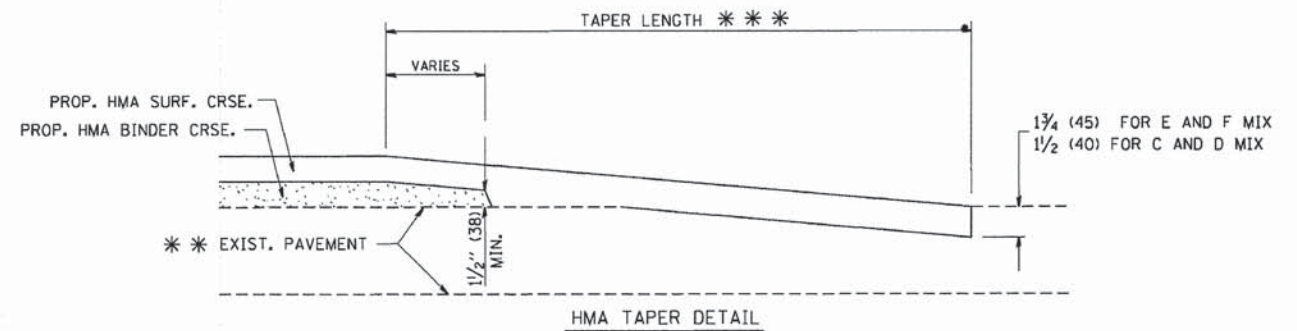
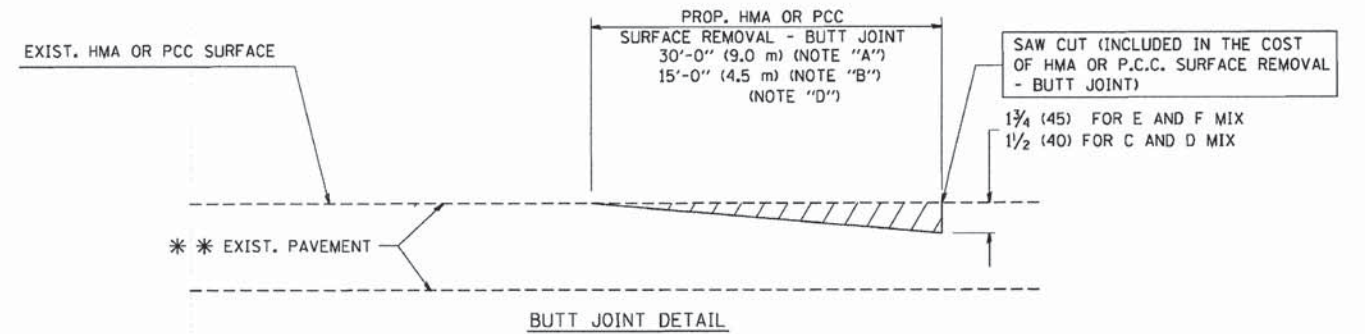

TYPICAL BUTT JOINT AND HMA TAPER
FOR RESURFACING ONLY

*** PC CONCRETE, HMA OR HMA RESURFACED PAVEMENT.

NOTES

- A: MAINLINE ROADWAYS AND MAJOR SIDE ROADS.
 - B: MINOR SIDE ROADS.
 - C: THE TEMP. RAMP SHALL BE CONSTRUCTED IMMEDIATELY UPON REMOVAL OF THE EXISTING HMA SURFACE.
 - D: THE BUTT JOINT SHALL BE CONSTRUCTED IMMEDIATELY PRIOR TO PLACING THE PROPOSED HMA COURSES.
 - E: TAPER THE TEMP. RAMP AT A RATE OF 3'-0" (900 mm) PER 1 INCH (25 mm) OF MILLING THICKNESS.
 - F: INSTALLATION AND REMOVAL OF THE 4'-6" (1.35 m) TEMP. RAMP IS INCLUDED IN COST OF HMA SURFACE REMOVAL - BUTT JOINT
 - G: SEE ARTICLE 406.08 AND 406.14 OF THE STANDARD SPECIFICATIONS FOR "HMA AND/OR PCC SURFACE REMOVAL, BUTT JOINT".
- * SEE TYPICAL SECTIONS FOR MILLING THICKNESS.
- *** 20'-0" (6.1 m) PER 1 (25) RESURFACING (NOTE "A")
10'-0" (3.0 m) PER 1 (25) RESURFACING (NOTE "B")

BASIS OF PAYMENT:

THE BUTT JOINT WILL BE PAID FOR AT THE CONTRACT UNIT PRICE PER SQUARE YARD (SQUARE METER) FOR "HOT-MIX ASPHALT SURFACE REMOVAL - BUTT JOINT" OR FOR "PORTLAND CEMENT CONCRETE SURFACE REMOVAL - BUTT JOINT".

ALL DIMENSIONS ARE IN INCHES (MILLIMETERS) UNLESS OTHERWISE SHOWN.

FILE NAME =
W:\data\22x34\bd32.dgn

USER NAME = gaglianob
PLOT SCALE = 5/8" = 1' IN.
PLOT DATE = 1/4/2008

DESIGNED - M. DE YONG
DRAWN -
CHECKED -
DATE - 06-13-90

REVISED - R. SHAH 10-25-94
REVISED - A. ABBAS 03-21-97
REVISED - M. GOMEZ 04-06-01
REVISED - R. BORO 01-01-07

STATE OF ILLINOIS
DEPARTMENT OF TRANSPORTATION

BUTT JOINT AND
HMA TAPER DETAILS

SCALE: NONE SHEET NO. 1 OF 1 SHEETS STA. TO STA.

F.A. RTE.	SECTION	COUNTY	TOTAL SHEETS	SHEET NO.
1569	14-00037-00-RS	COOK	20	19
BD400-05 BD32		CONTRACT NO. 61B26		
FED. ROAD DIST. NO. 1 ILLINOIS FED. AID PROJECT				

LOOPS NEXT TO SHOULDERS

PROVIDE A PAVEMENT REPLACEMENT NOTE WHICH SHOULD EQUAL 3' (900 mm) X WIDTH OF PAVED SHOULDER.

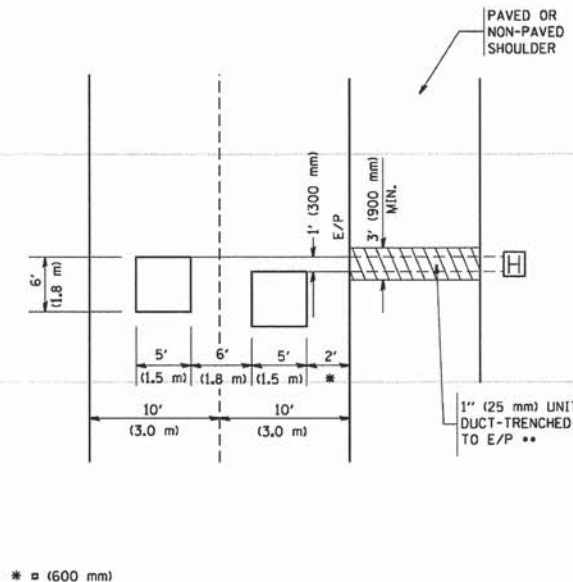

UNIT DUCT IS TO BE SHOWN ON PLAN SHEETS BUT SHALL NOT BE INCLUDED IN THE PAY ITEMS.

**LEFT TURN LANES WITH MEDIANS
VOLUME DENSITY ("FAR OUT" DETECTION)
ON SAME APPROACH
(PROTECTED / PERMITTED LEFT TURN PHASING)**

HANDHOLE LOCATION MAY VARY DEPENDING ON GEOMETRICS AND DESIGN OF TRAFFIC SIGNALS. HEAVY-DUTY HANDHOLES TO BE USED WHEN THE MEDIAN IS MOUNTABLE. REFER TO STANDARD 814001 TO ENSURE THAT HANDHOLE FITS IN MEDIAN.

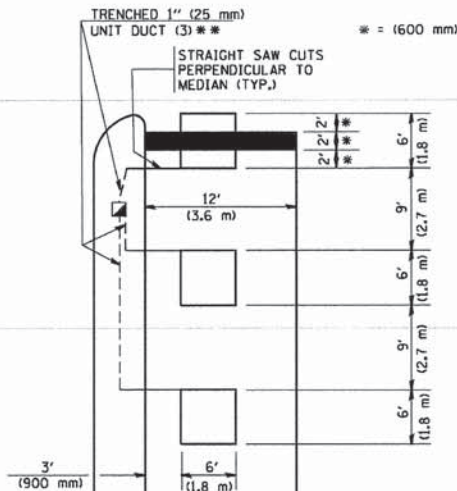

UNIT DUCT IS TO BE SHOWN ON PLAN SHEETS BUT SHALL NOT BE INCLUDED IN THE PAY ITEMS.

DUAL LEFT TURNS NOT SHOWN REFER TO PLAN SHEET FOR DETECTOR LOOP REPLACEMENT

**LEFT TURN LANES WITHOUT MEDIANS
VOLUME DENSITY ("FAR OUT" DETECTION)
ON SAME APPROACH
(PROTECTED / PERMITTED LEFT TURN PHASING)**

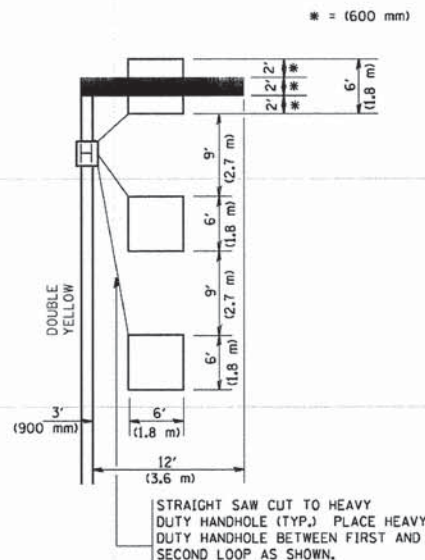

DUAL LEFT TURNS NOT SHOWN REFER TO PLAN SHEET FOR DETECTOR LOOP REPLACEMENT

**ARTERIAL-VOLUME DENSITY ("FAR OUT" DETECTION)
CROSS STREET-VOLUME DENSITY ("FAR OUT" DETECTION)**

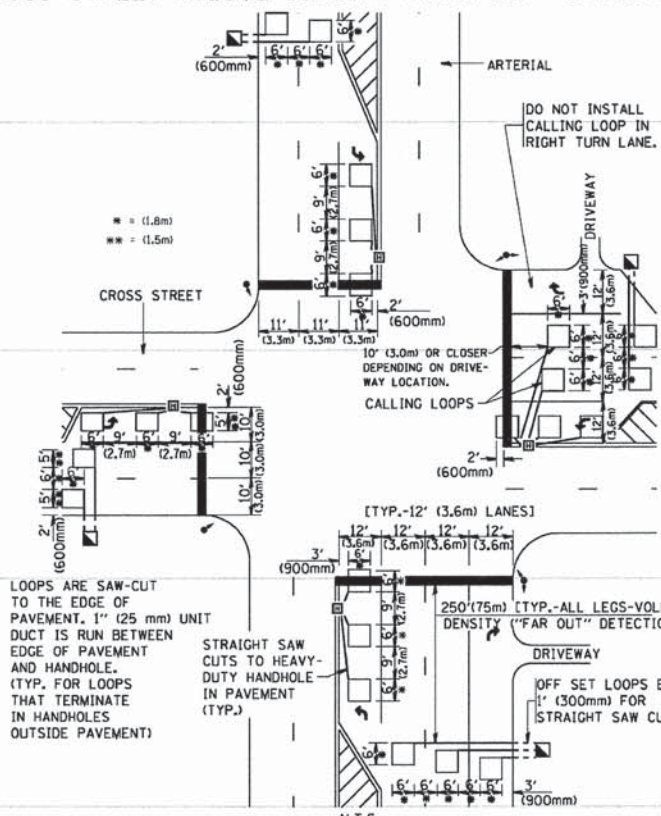

DETAIL 1
N.T.S.

**ARTERIAL-VOLUME DENSITY ("FAR OUT" DETECTION)
CROSS STREET-NON VOLUME DENSITY ("UPTIGHT" PRESENCE DETECTION)**

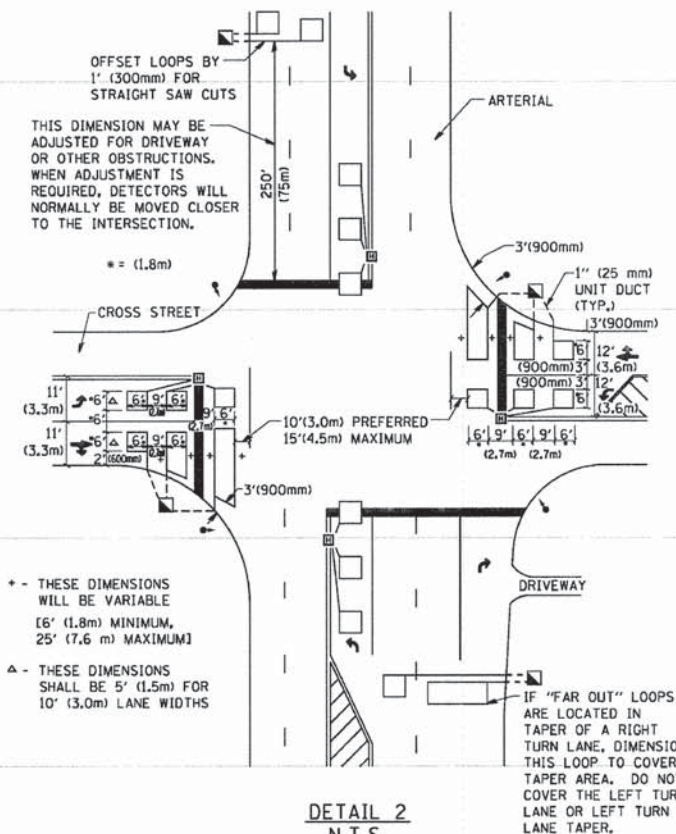

DETAIL 2
N.T.S.

NOTES:

VEHICLES LOOP DETECTORS

- * ALL LEAD IN CABLE SHALL BE TWO CONDUCTOR NO. 14 TWISTED, SHIELDED.
- * EACH DETECTOR LOOP SHALL HAVE ITS OWN SAW CUT FROM THE LOOP TO THE EDGE OF PAVEMENT OR TO A HANDHOLE IN THE PAVEMENT.
- * EACH DETECTOR LOOP SHALL HAVE ITS OWN ONE INCH (25 mm) UNIT DUCT BETWEEN THE EDGE OF PAVEMENT AND THE FIRST HANDHOLE OR JUNCTION BOX. EACH UNIT DUCT RUN SHALL BE SHOWN ON THE PLANS BY THE DESIGNER, BUT SHALL NOT BE PAID FOR SEPARATELY. THIS ITEM IS INCIDENTAL TO THE PAY ITEM FOR DETECTOR LOOPS.
- * ONE DIMENSION OF ALL DETECTOR LOOPS SHALL BE SIX FEET (1.8 m)
- * EACH LANE OF NON-LOCKING, PRESENCE DETECTION AND EACH LANE OF A DOUBLE LEFT TURN LANE REQUIRES A SEPARATE INDUCTIVE LOOP DETECTOR AND LEAD-IN CABLE.
- * WHEN NON-LOCKING, PRESENCE DETECTION IS USED, MORE THAN ONE LOOP PER LANE IS REQUIRED BEHIND THE STOP BAR (i.e. 1-1/2, 1-3/4, 2).
- * WHEN SYSTEM LOOPS ARE REQUIRED ON AN APPROACH OF AN INTERSECTION, THE LOOPS USED FOR VOLUME DENSITY AND INTERSECTION TIMING SHALL ALSO BE USED AS SYSTEM DETECTORS. EACH ONE OF THESE TYPE OF LOOPS REQUIRES A SEPARATE TWO CONDUCTOR NO. 14 TWISTED SHIELDED CABLE AND A SEPARATE INDUCTIVE LOOP DETECTOR WHEN NEW CONTROLLERS ARE UTILIZED. THE DESIGNER SHALL LABEL THESE TYPES OF LOOPS AS "INTERSECTION AND SAMPLING (SYSTEM) DETECTORS" ON THE SIGNAL LAYOUT, THE INTERCONNECT PLAN AND THE SYSTEM CABLE PLAN. WHEN AN EXISTING CONTROLLER IS UTILIZED FOR THIS TYPE OF DETECTION, THE PAY ITEM "INDUCTIVE LOOP DETECTOR WITH SYSTEM OUTPUT" SHOULD BE USED.

PLACEMENT OF DETECTORS

THE FOLLOWING FIGURES REPRESENT THE MOST COMMON DETECTOR LOOP LOCATIONS AND SIZES. ADJUSTMENTS WILL BE NECESSARY FOR SPECIFIC GEOMETRIC CONSIDERATIONS.

LOCATIONS AND DEMENSIONS OF DETECTOR LOOPS ARE REQUIRED ON ALL SIGNAL LAYOUT PLAN SHEETS.

"FAR OUT" DETECTION REFERS TO LOCKING, PRESENCE TYPE DETECTION LOCATED IN THRU LANES, RIGHT TURN LANES, AND RIGHT TURN LANE TAPER AREAS (IF APPLICABLE), USUALLY 250' (75 m) IN ADVANCE OF STOP BARS. "UPTIGHT" DETECTION REFERS TO NON-LOCKING PRESENCE TYPE DETECTION LOCATED IN ALL LANES AND 10'-15' (3.0 m-4.5 m) BEHIND THE CROSSING STREET'S EDGE OF PAVEMENT EXTENDED.

NOTE:

ALL DETAILS AND NOTES SHOWN ARE FROM THE I.D.O.T. DISTRICT 1 TRAFFIC SIGNAL DESIGN GUIDELINES DATED JANUARY 1995

THIS DRAWING HAS BEEN PREPARED TO ASSIST THE RESIDENT ENGINEER FOR ALL ROADWAY RESURFACING OR S.M.A.R.T. PROJECTS WHERE THE DIMENSIONS ARE NOT SHOWN ON THE PLANS AND THE FINAL LOCATIONS FOR CROSSWALKS OR STOP BARS ARE NOT DETERMINED.

FILE NAME = W:\diststd\22x34\ts87.dgn	USER NAME = gaglianob	DESIGNED - DRAWN -	REVISED - REVISED -	STATE OF ILLINOIS DEPARTMENT OF TRANSPORTATION	DISTRICT 1 - DETECTOR LOOP INSTALLATION DETAILS FOR ROADWAY RESURFACING		F.A. - RTE. 1569	SECTION 14-00037-00-RS	COUNTY COOK	TOTAL SHEETS 20	SHEET NO. 20
PLOT SCALE = 5/8" = 1' IN.		CHECKED - DATE -	REVISED - REVISED -		SCALE: NONE	SHEET NO. 1 OF 1 SHEETS	STA. TO STA.	TS-07		CONTRACT NO. 61B26	
PLOT DATE = 1/4/2008		DATE -	REVISED -		FED. ROAD DIST. NO. 1 (ILLINOIS) FED. AID PROJECT						