

**INDEX OF SHEETS**

1. COVER SHEET, STANDARDS, & SUMMARY OF QUANTITIES
2. TYPICAL CROSS-SECTIONS & ENTRANCE SCHEDULE
3. TRANSITIONS AT BRIDGE AND PCC PAVEMENT DETAILS
4. INTERSECTION, MAILBOX, RUMBLE STRIP & PCC PAVEMENT REPAIR DETAILS
5. SCHEDULE OF RESURFACING QUANTITIES

**HIGHWAY STANDARDS**

00001-06	STANDARD SYMBOLS, ABBREVIATIONS & PATTERNS
701301-04	LANE CLOSURE 2L, 2W SHORT TIME OPERATIONS
701306-03	LANE CLOSURE 2L, 2W SLOW MOVING OPERATIONS DAY ONLY ≥45MPH
701311-03	LANE CLOSURE 2L, 2W MOVING OPERATIONS DAY ONLY
701901-04	TRAFFIC CONTROL DEVICES
780001-05	TYPICAL PAVEMENT MARKINGS
BLR 21-9	ROAD CLOSED ON RURAL LOCAL HIGHWAYS, 2L, 2W
BLR 22-7	ROAD CLOSED TO THRU TRAFFIC, 2L, 2W RURAL TRAFFIC

STATE OF ILLINOIS  
DEPARTMENT OF TRANSPORTATION  
DIVISION OF HIGHWAYS  
**PLANS FOR PROPOSED  
FEDERAL AID HIGHWAY  
SURFACE TRANSPORTATION PROGRAM**  
F.A.S. ROUTE 1362, CH 8, (OCOYA ROAD)  
SECTION 11-00080-04-RS  
PROJECT RS-1362(116)  
LIVINGSTON COUNTY  
C-93-083-14

ROUTE NO.	SECTION	COUNTY	TOTAL SHEETS	SHEET NO.
1362	11-00080-04-RS	LIVINGSTON	5	1

PROJECT NO. RS-1362(116)



SUMMARY OF QUANTITIES		CONST. CODE 0005	
ITEM NO.	ITEM	UNIT	QUANTITIES
* 40600275	BITUMINOUS MATERIALS (PRIME COAT)	POUND	18,582.0
* 40600637	LEVELING BINDER (MACHINE METHOD), IL-9.5FG, N70	TON	2,367.0
40603315	HOT-MIX ASPHALT SURFACE COURSE, MIX "C", N70	TON	3,524.0
40800050	INCIDENTAL HOT-MIX ASPHALT SURFACING	TON	325.0
44000155	HOT-MIX ASPHALT SURFACE REMOVAL, 1 1/2"	SQ YD	36,112.0
44200944	CLASS B PATCHES, TYPE IV, 8 INCH	SQ YD	46.0
44201299	DOWEL BARS 1 1/2"	EACH	33.0
44213100	PAVEMENT FABRIC	SQ YD	46.0
44213200	SAW CUTS	FOOT	74.0
44213206	TIE BARS 5/8"	EACH	21.0
44300100	AREA REFLECTIVE CRACK CONTROL TREATMENT	SQ YD	40,761.0
* 48102100	AGGREGATE WEDGE SHOULDER, TYPE B	TON	1,407.0
67100100	MOBILIZATION	L SUM	1.0
70300100	SHORT TERM PAVEMENT MARKING	FOOT	5,001.0
70301000	WORK ZONE PAVEMENT MARKING REMOVAL	SQ FT	556.0
Δ 78000100	THERMOPLASTIC PAVEMENT MARKING - LETTERS AND SYMBOLS	SQ FT	61.2
Δ 78000650	THERMOPLASTIC PAVEMENT MARKING - LINE 24"	FOOT	44.0
Δ 78001110	PAINT PAVEMENT MARKING - LINE 4"	FOOT	4,867.0
* X0556100	PARTIAL DEPTH PATCHING (SPECIAL)	SQ YD	1.1
* X4401198	HOT-MIX ASPHALT SURFACE REMOVAL, VARIABLE DEPTH	SQ YD	4,588.0
* X7010216	TRAFFIC CONTROL AND PROTECTION, (SPECIAL)	L SUM	1.0
* Z0055300	RUMBLE STRIP	EACH	8.0

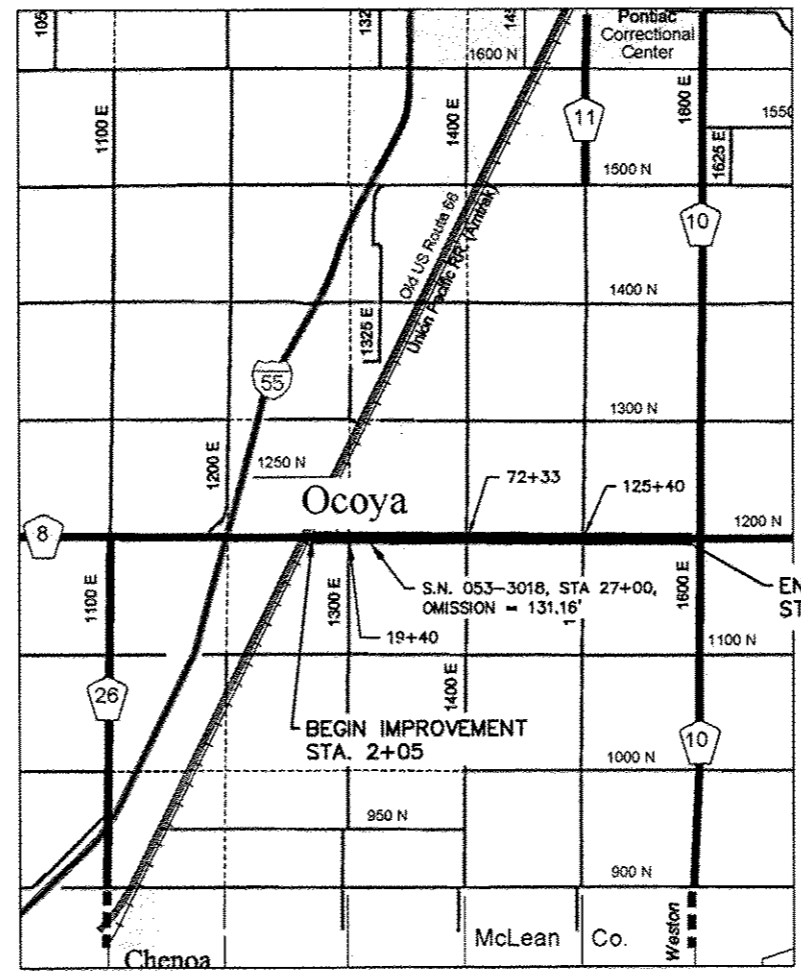

THESE PLANS WERE MADE BY ME OR BY A MEMBER OF MY STAFF WORKING UNDER MY PERSONAL SUPERVISION.  
 DATE 02-03-15 COUNTY ENGINEER, P.E. NO. 42921  
 EXPIRATION DATE 11/30/2015

\* SEE SPECIAL PROVISIONS  
 Δ SPECIALTY ITEMS

THIS PROJECT CONSISTS OF HMA SURFACE REMOVAL, HMA LEVELING BINDER, HMA SURFACE COURSE, MIX "C", N70, AND AGGREGATE SHOULDERS BEGINNING AT A POINT NEAR THE INTERSECTION OF OLD ROUTE 66 AND COUNTY HIGHWAY 8 (1200N) AND EXTENDING IN A EASTERLY DIRECTION TO THE INTERSECTION OF COUNTY HIGHWAY 8 AND COUNTY HIGHWAY 10 (1600E).

**TRAFFIC DATA**  
 C.H. 8 - COLLECTOR  
 POSTED SPEED = 55 MPH-RURAL  
 DESIGN SPEED = 50 MPH-RURAL  
 DESIGN ADT= 2800/ YR 2030  
 CLASS III ROADS, 80,000#

**UTILITIES**  
 CONTACT J.U.L.I.E. 811 or  
 800-892-0123 BEFORE DIGGING

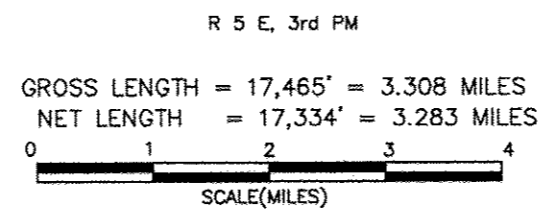

"THE ACCEPTANCE OF THIS PROJECT IS BASED ON THE MINIMUM DESIGN CRITERIA UNDER LAFO GUIDELINES."

APPROVED 02-03-15  
  
 LIVINGSTON COUNTY OFFICIAL

PASSED FEB 13 20 15  
  
 DISTRICT THREE LOCAL ROADS & STREETS ENGINEER

RELEASING FOR BID BASED ON LIMITED REVIEW FEB 13 20 15  
  
 DEPUTY DIRECTOR OF HIGHWAYS, REGION TWO ENGINEER

STATE OF ILLINOIS  
DEPARTMENT OF TRANSPORTATION

Z:\COV\ROAD Projects\00080RS+Ocoya-EofRt 66\Planning\Plans-Ocoya-Rd E of 66.dwg, 1/28/2015 10:17:10 AM

ROUTE NO.	SECTION	COUNTY	TOTAL SHEETS	SHEET NO.
1362	11-00080-04-RS	LIVINGSTON	5	2

PROJECT NO. RS-1362(116)

NOT PLOTTED TO SCALE

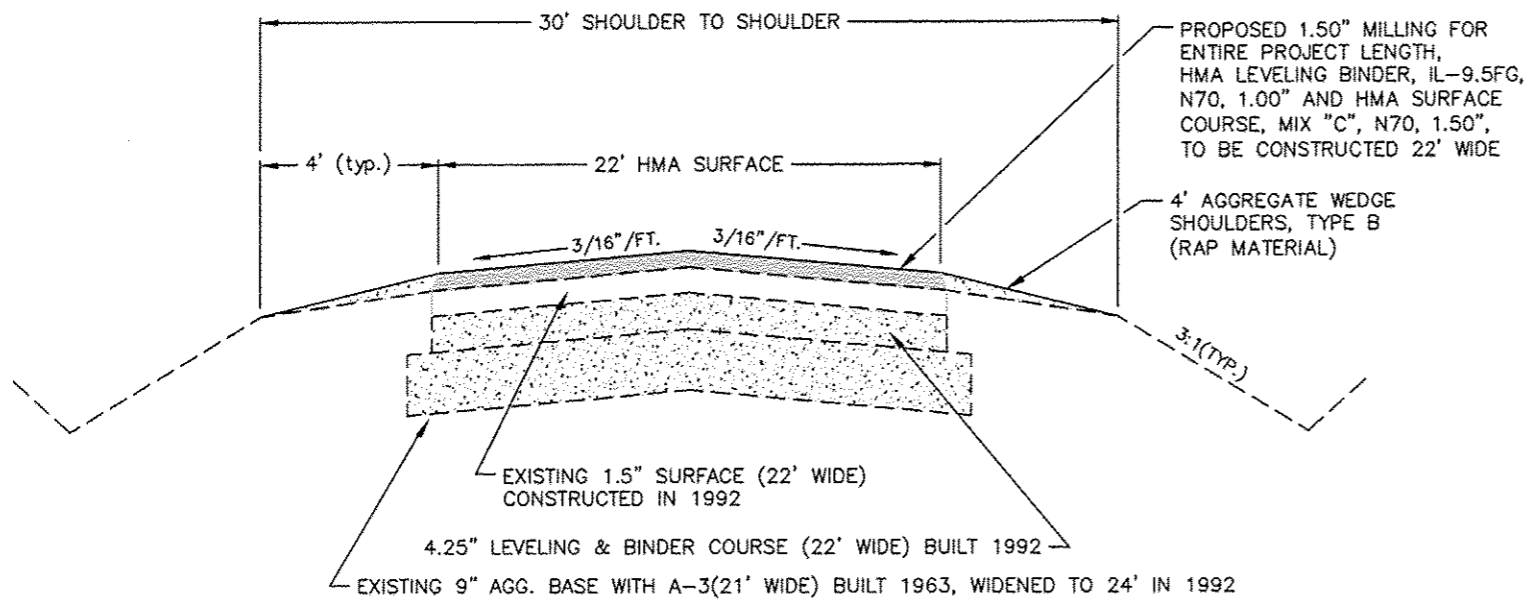

TYPICAL CROSS SECTION (NTS)

Sta. 2+05 to 176+70

	HMA Level Binder	HMA Surface	HMA Incidental
PG Grade **	PG64-22		
Design Air Voids	4.0% @ N70	4.0% @ N70	4.0% @ N50
Mixture Composition	IL 9.5FG	IL 9.5	IL 9.5
Friction Aggregate	N/A	Mixture C	Mixture C
Density Test Method	LR1030	Correlation	Satisfaction of Engineer
Mixture Weight	112 # / s.y. / inch	112 # / s.y. / inch	112 # / s.y. / inch
Quality Management Program	QC/QA	QC/QA	QC/QA
Sublot Size	N/A	N/A	N/A
Location(s)	N/A	N/A	N/A

\*\* When RAP/RAS ABR exceeds 20 percent, the high and low virgin asphalt binder grades shall each be reduced by one grade (i.e. 25% ABR would require a virgin asphalt binder grade of PG 64-22 to be reduced to PG 58-22)

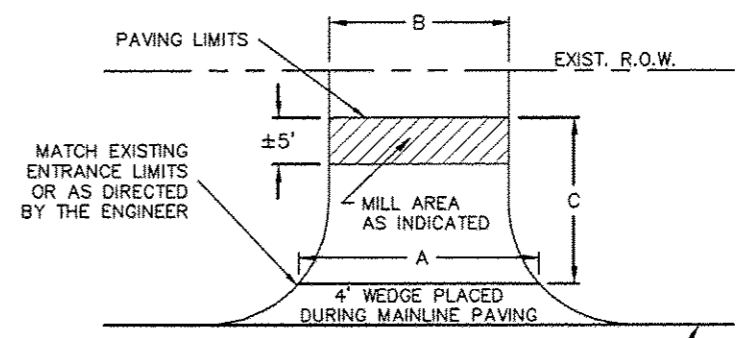

P.E. / C.E. DETAIL (NTS)

FOR QUANTITIES SEE CHART BELOW

SCHEDULE OF PAINT PAVEMENT MARKING LINE - 4"				
LOCATION	NO PASSING ZONE	SKIP DASH		
STATION TO STATION	EBL	WBL	Φ	
2+05 to 6+82		477	119	
6+82 to 177+66			4,271	
* Double NPZ, No Skip Dash				
TOTALS	0	477	4,390	
TOTAL PAY QUANTITY 4,867 FOOT				

THERMOPLASTIC PAVEMENT MARKINGS			
LOCATION	LETTERS & SYMBOLS	LINE - 24"	
STATION TO STATION	X (20')	R (6')	WBL
Railroad Crossing Symbol			
4+75	54.00	7.20	44.00
East side only			
* Double NPZ, No Skip Dash			
TOTALS	54.00	7.20	44.00
TOTAL PAY QTY. LETTERS & SYMBOLS		61.20	SQ FT
TOTAL PAY QTY. LINE - 24"		44.00	FOOT

OCOYA RD. / CH 8 - ENTRANCE QUANTITIES										
TYPE	STATION	A(Ft.)	B(Ft.)	C(Ft.)	AREA (S.Y.)	BIT. MAT. PRIME	LEVEL BINDER	SURFACE COURSE	INCID. BIT.	
CE	2+53(L)	85	42	15	106	13	3	4	18	
CE	2+53(R)	75	55	15	108	14	3	4	19	
*PE	11+42(R)	38	17	15	46	6	2	2	8	
*PE	38+60(L)	48	18	25	92	12	2	3	16	
*PE	40+47(R)	30	13	18	43	5	1	2	8	
*PE	84+11(R)	37	16	19	56	7	2	2	10	
CE	90+94(L)	42	19	24	81	10	2	2	14	
*PE	117+77(R)	34	16	19	53	7	2	2	9	
CE	124+07(L)	75	60	55	413	52	3	4	93	
*PE	138+51(R)	45	21	21	77	10	2	3	13	
*PE	147+88(L)	45	17	20	69	9	2	3	12	
CE	157+41(R)	36	14	19	53	7	2	2	9	
CE	176+30(L)	60	32	24	123	15	2	3	21	
* MBTO (7)	Total				132		8	19		
TOTALS							140	30	47	250

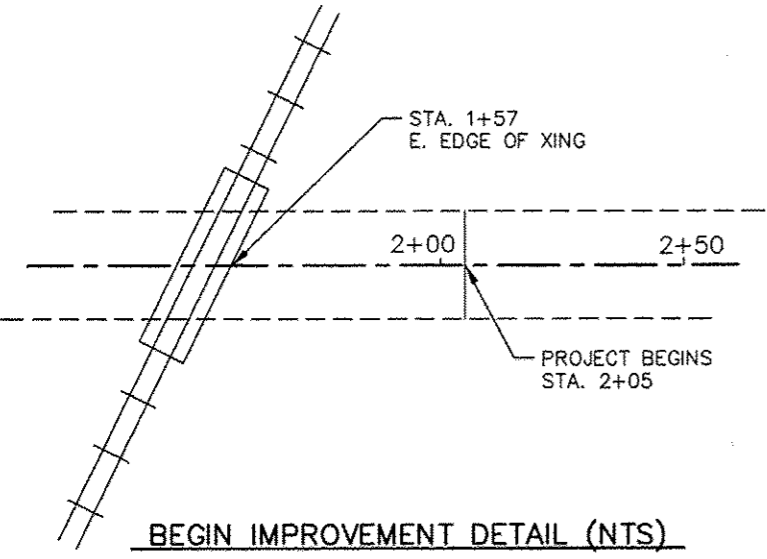

BEGIN IMPROVEMENT DETAIL (NTS)

Z:\COWork\ROAD Projects\10080\RS4-Ocoya-EofRt\66\Planning\Plans-Ocoya-Rd E of 66.dwg, 1/28/2015 7:45:54 AM

ROUTE NO.	SECTION	COUNTY	TOTAL SHEETS	SHEET NO.
1362	11-00080-04-RS	LIVINGSTON	5	3

PROJECT NO. RS-1362(116)

NOT PLOTTED TO SCALE

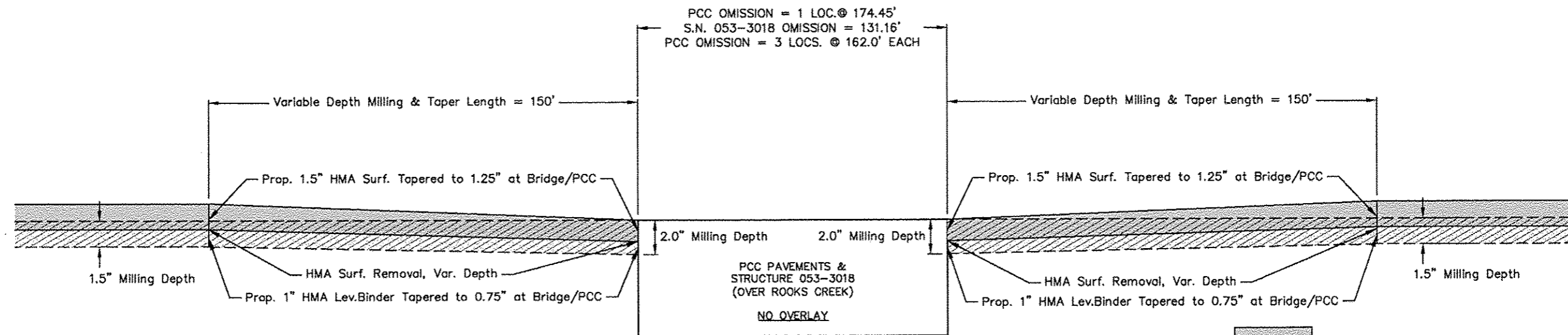

TRANSITION WITH NO OVERLAY ON BRIDGE (NTS)

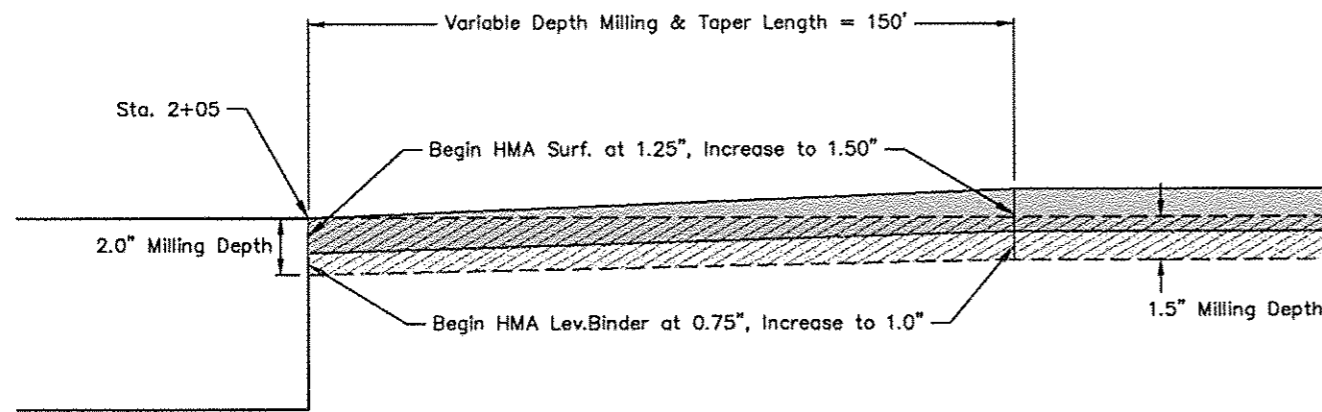
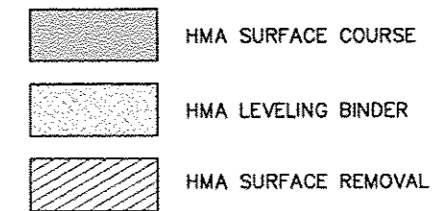

BEGINNING TAPER (NTS)

Sta. 2+05 TO 3+55 (FAS RTE. 1362)

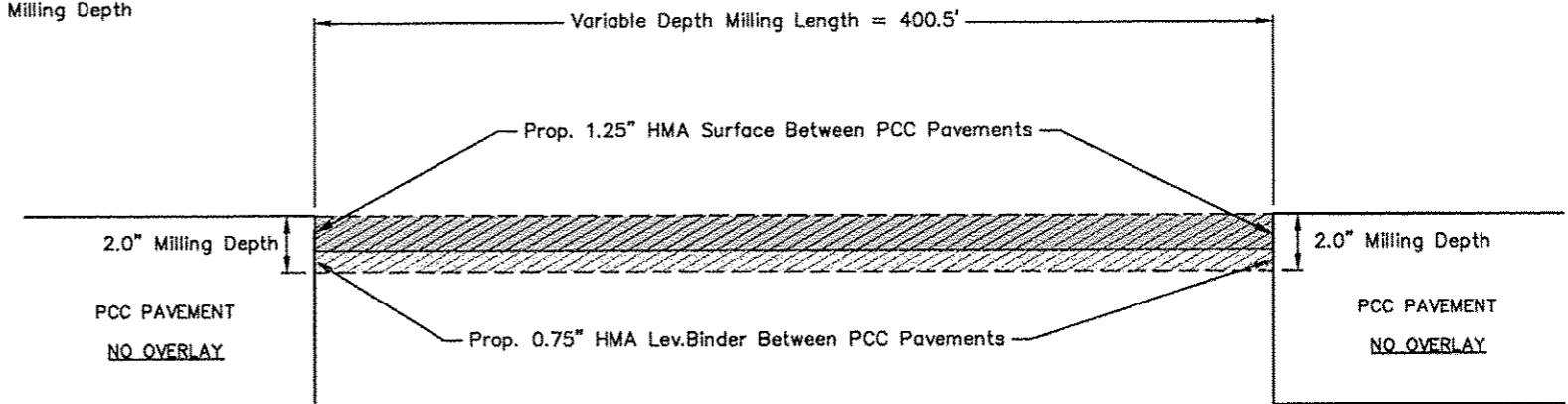

ENDING TRANSITION (NTS)

Sta. 172+69.5 TO 176+70 (FAS RTE. 1362)

ROUTE NO.	SECTION	COUNTY	TOTAL SHEETS	SHEET NO.
1362	11-00080-04-RS	LIVINGSTON	5	4

PROJECT NO. RS-1362(116)

NOT PLOTTED TO SCALE

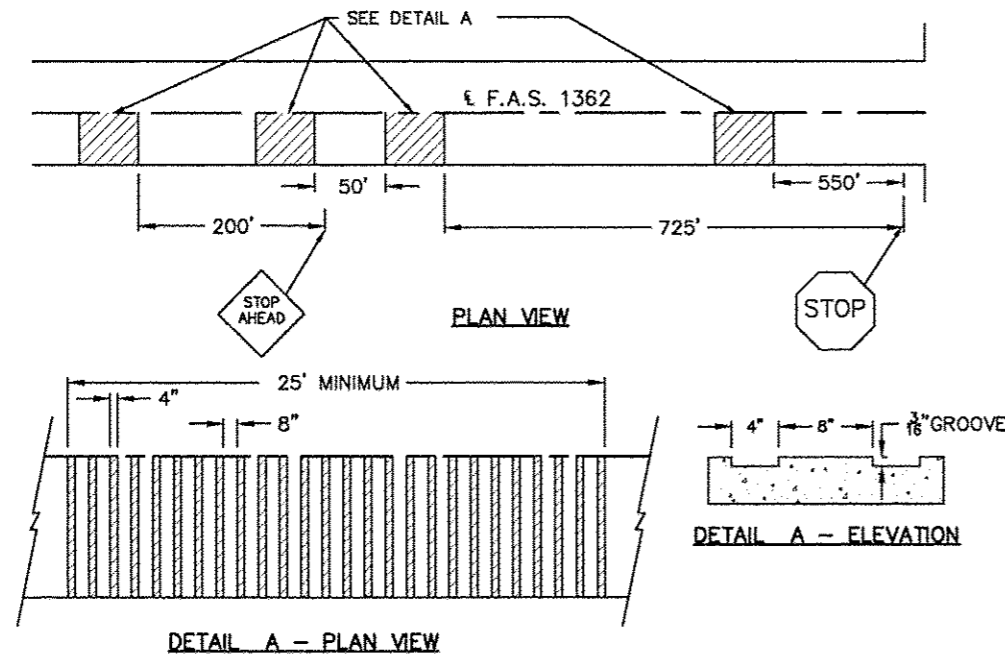

**GROOVED RUMBLE STRIP APPLICATION (NTS)**  
IN ADVANCE OF RT. 66 and CH 10 INTERSECTIONS

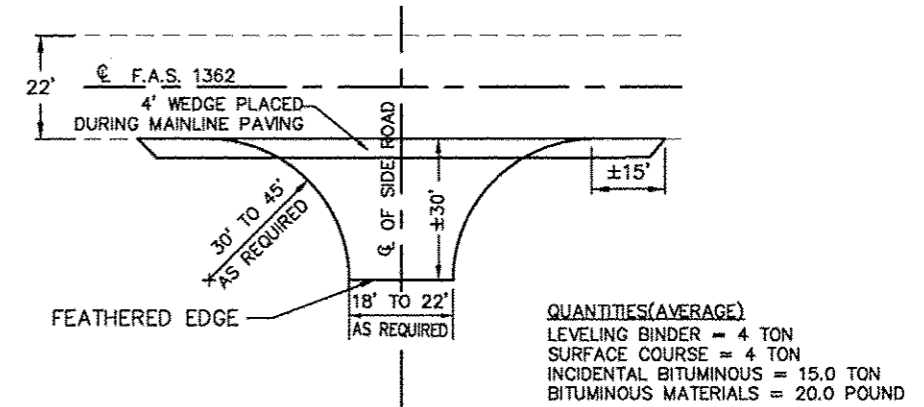

**TYPICAL SIDE ROAD INTERSECTION (NTS)**

STA. 19+40 RT. (1300E)  
STA. 72+33 LT. & RT. (1400E)  
STA. 125+00 LT. & RT. (1500E)

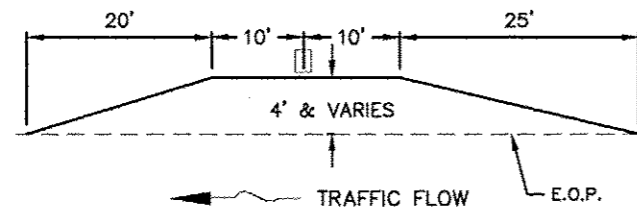

**MAILBOX TURNOUT DETAIL (NTS)**  
PLACED DURING MAINLINE PAVING

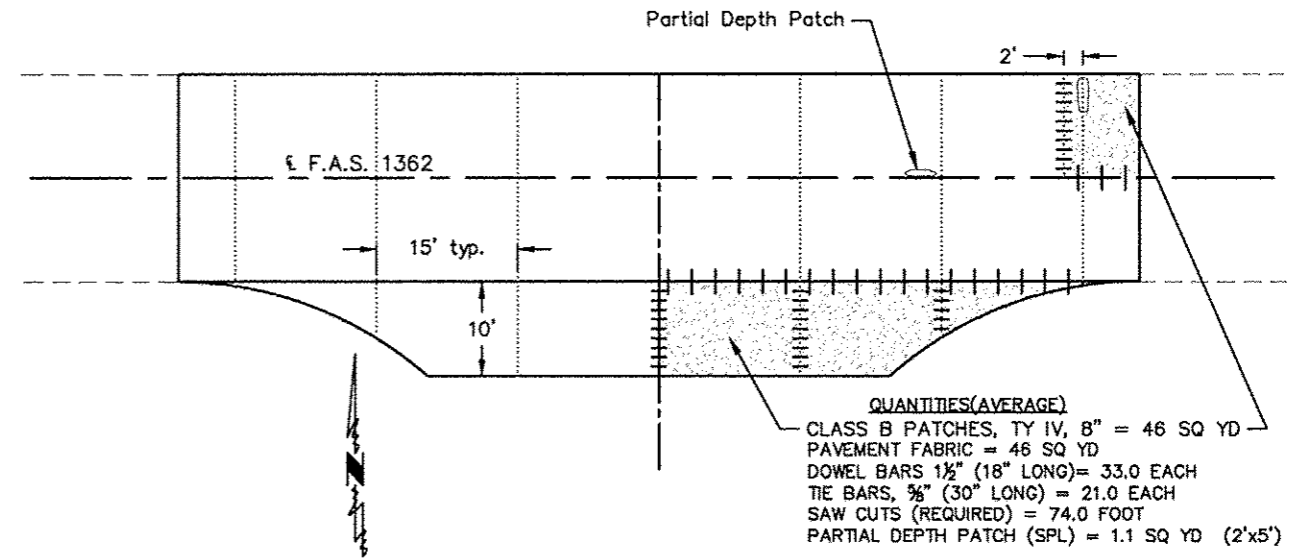

**EXISTING PCC PAVEMENT, 8" (HINGE JOINTED)**

STATION 151+12 AT CENTER

SECTION	COUNTY	TOTAL SHEETS	SHEET NO.
11-00080-04-R5	LIVINGSTON	5	5

PROJECT NO. RS-1362(116)

**SCHEDULE OF RESURFACING QUANTITIES**

Unit weight Constant = 112.0 lbs./s.y./inch

LOCATION (QUANTITY)	LENGTH	AREA (SQ YD)	HMA SURF REMOVAL VAR DEPTH (SQ YD)	HMA SURF REMOVAL 1.5" DEPTH (SQ YD)	SHORT- TERM PAVT MARKING (FOOT)	WORK ZONE PAVT MK REM (SQ FT)	PAINT PVT MARKING LINE, 4" (FOOT)	BIT MATLS PR CT * (POUND)	AREA REFL CR CONT (SQ YD)	LEVEL BINDER IL-9.5FG N70 (TON)	BIT CONC SURF CSE *C* N70 (TON)	INCIDENTAL BIT SURF N50 (TON)	AGG WEDGE SHLDRS, TY B TYPE B (TON)
<i>MAINLINE</i>													
2+05. to 3+55. (TAPER)	150.0	367	367	-	45	5	S C H E D U L E Z O N	165	367	21	31	-	9
3+55. to 10+54.55	699.6	1710	-	1710	210	23		770	1710	96	144	-	62
10+54.55 to 12+04.55 (TAPER)	150.0	367	367	-	45	5		165	367	21	31	-	9
12+04.55 to 13+79. (PCC Omission)	174.5	426	-	-	-	-		-	-	-	-	-	-
13+79. to 15+29. (TAPER)	150.0	367	306	-	45	5		165	367	21	31	-	9
15+29. to 24+90.42	961.4	2350	-	2350	288	32		1,058	2350	132	197	-	85
24+90.42 to 26+40.42 (TAPER)	150.0	367	367	-	45	5		165	367	21	31	-	9
26+40.42 to 27+71.58 (BR Omission)	131.2	321	-	-	-	-		-	-	-	-	-	-
27+71.58 to 29+21.58 (TAPER)	150.0	367	367	-	45	5		165	367	21	31	-	9
29+21.58 to 139+19.	10,997.4	26883	-	26883	3300	367		12,097	26883	1,505	2,258	-	974
139+19. to 140+69. (TAPER)	150.0	367	367	-	45	5		165	367	21	31	-	9
140+69. to 142+31. (PCC Omission)	162.0	396	-	-	-	-		-	-	-	-	-	-
142+31. to 143+81. (TAPER)	150.0	367	367	-	45	5		165	367	21	31	-	9
143+81. to 148+81.	500.0	1222	-	1222	150	17		550	1222	68	103	-	44
148+81. to 150+31. (TAPER)	150.0	367	367	-	45	5		165	367	21	31	-	9
150+31. to 151+93. (PCC Omission)	162.0	396	-	-	-	-		-	-	-	-	-	-
151+93. to 153+43. (TAPER)	150.0	367	367	-	45	5	165	367	21	31	-	9	
153+43. to 169+57.5	1,614.5	3947	-	3947	483	54	1,776	3947	221	332	-	143	
169+57.5 to 171+07.5 (TAPER)	150.0	367	367	-	45	5	165	367	21	31	-	9	
171+07.5 to 172+69.5 (PCC Omission)	162.0	396	-	-	-	-	-	-	-	-	-	-	
172+69.5 to 176+70.	400.5	979	979	-	120	13	441	979	41	69	-	9	
<b>TOTAL JOB LENGTH OR MAINLINE QUANTITY</b>	<b>17,465.0</b>	<b>42,692</b>	<b>4,588</b>	<b>36,112</b>	<b>5,001</b>	<b>556</b>	<b>4,867</b>	<b>18,342</b>	<b>40,761</b>	<b>2,273</b>	<b>3,413</b>	<b>-</b>	<b>1,407</b>
<i>MISCELLANEOUS</i>													
PRIVATE & COMMERCIAL ENTRANCES (13)	-	-	-	-	-	-	-	140.0	-	22	28	250.0	-
SIDEROAD INTERSECTIONS (5)	-	-	-	-	-	-	-	100.0	-	64	64	75.0	-
M.B.T.O.'s (7)	-	-	-	-	-	-	-	-	-	8	19	-	-
<b>TOTALS OF MAINLINE &amp; MISC.</b>	<b>17,465.0</b>	<b>42,692</b>	<b>4,588</b>	<b>36,112</b>	<b>5,001</b>	<b>556</b>	<b>4,867</b>	<b>18,582</b>	<b>40,761</b>	<b>2,367</b>	<b>3,524</b>	<b>325</b>	<b>1,407</b>

\* BITUMINOUS MATERIALS (PRIME COAT) SHALL BE IN ACCORDANCE WITH THE TABLE SHOWN IN ARTICLE 406.02 OF THE STANDARD SPECIFICATIONS.

Z:\00Work\ROAD Projects\00080R\54-Ooysa-Eor\58\Planning\Est\Cost\Resurf\Sched.at\SheetResurfDys