

FOR INDEX OF SHEETS, SEE SHEET NO. 2

FOR HIGHWAY STANDARDS, SEE SHEET NO. 2



**TRAFFIC DATA**

ADT = 3,300 (2014)  
SPEED LIMIT = 25 MPH

**DESIGN DESIGNATION**  
MAJOR COLLECTOR

PROJECT NUMBER:  
F.A.U. ROUTE 210 (LONG LAKE DRIVE)  
BEGIN RESURFACING  
STA 21+00

STATE OF ILLINOIS  
DEPARTMENT OF TRANSPORTATION  
DIVISION OF HIGHWAYS  
**PLANS FOR PROPOSED  
FEDERAL AID PROJECT**  
F.A.U. ROUTE 210 (LONG LAKE DRIVE)  
LOTUS DRIVE TO SUNSET DRIVE  
RESURFACING  
SECTION No: 12-00035-00-RS  
PROJECT No: M-9003(940)  
VILLAGE OF ROUND LAKE  
LAKE COUNTY  
JOB No: C-91-216-12

PROJECT NUMBER:  
F.A.U. ROUTE 210 (LONG LAKE DRIVE)  
END RESURFACING  
STA 37+17

LOCATION MAP  
(NOT TO SCALE)  
R10E



R10E  
SECTIONS 19 AND 20, T45N, R10E, OF THE THIRD PRINCIPAL MERIDIAN  
AVON TOWNSHIP  
GROSS LENGTH OF IMPROVEMENT = 1,617 LF OR 0.306 MILES  
NET LENGTH OF IMPROVEMENT = 1,617 LF OR 0.306 MILES



LOCATION OF SECTION INDICATED THIS: [Symbol]

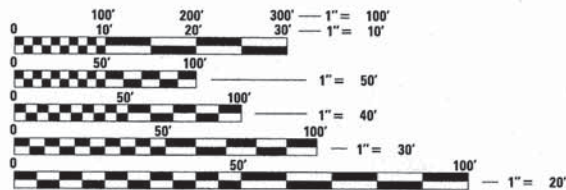

FULL SIZE PLANS HAVE BEEN PREPARED USING STANDARD  
ENGINEERING SCALES. REDUCED SIZED PLANS WILL NOT  
CONFORM TO STANDARD SCALES. IN MAKING MEASUREMENTS  
ON REDUCED PLANS, THE ABOVE SCALES MAY BE USED.

J.U.L.I.E. DESIGN STAGE REQUEST  
DIG. No. X3040314



CONTACT JULIE AT 811 OR 800-892-0123  
WITH THE FOLLOWING:

COUNTY = LAKE  
CITY-TWNSHP. = ROUND LAKE - AVON  
SEC. & 1/4 SEC. NO. = 19NE, 20NW, T45N, R10E  
48 HOURS (2 working days) BEFORE YOU DIG



"LICENSE EXPIRES 11-30-2015"

STATE OF ILLINOIS  
DEPARTMENT OF TRANSPORTATION  
DIVISION OF HIGHWAYS

APPROVED 4 AUGUST 2014  
Ron Pharo  
VILLAGE OF ROUND LAKE, DIRECTOR OF PUBLIC WORKS

PASSED SEPTEMBER 3, 2014  
CHRISTOPHER HOLT  
DISTRICT 1 ENGINEER OF LOCAL ROADS AND STREETS

RELEASING FOR BID  
BASED ON LIMITED  
REVIEW September 3, 2014  
John Fontenauer Jr.  
DEPUTY DIRECTOR OF  
HIGHWAYS, REGION 1 ENGINEER

PRINTED BY THE AUTHORITY  
OF THE STATE OF ILLINOIS

CONTRACT NO. 61A71

B&W PROJECT NO.: 100345 DATE: 06-16-14

COPYRIGHT © 2014 BY BAXTER & WOODMAN, INC.  
 ALL RIGHTS RESERVED. NO PART OF THIS DOCUMENT IS TO BE REPRODUCED OR TRANSMITTED IN ANY FORM OR BY ANY MEANS, ELECTRONIC OR MECHANICAL, INCLUDING PHOTOCOPYING, RECORDING, OR BY ANY INFORMATION STORAGE AND RETRIEVAL SYSTEM, WITHOUT PERMISSION IN WRITING FROM BAXTER & WOODMAN, INC.  
 LICENSE NO. 084-00721-130905, EXPIRES 8/7/2014  
 FEDERAL AID PROGRAM ENGINEER FAWAD AQUEEL, PE, PTOE (847-705-4021), SCHAMBERG, IL



**GENERAL NOTES**

- ALL CONSTRUCTION SHALL BE DONE IN ACCORDANCE WITH THE DETAILS IN THE PLANS, THE SPECIAL PROVISIONS INCLUDED IN THE CONTRACT DOCUMENTS, AND THE LATEST EDITION OF THE FOLLOWING STATE OF ILLINOIS SPECIFICATIONS: "THE STANDARD SPECIFICATIONS FOR ROAD AND BRIDGE CONSTRUCTION" (REFERRED TO AS THE "STANDARD SPECIFICATIONS"), THE "SUPPLEMENTAL SPECIFICATIONS AND RECURRING SPECIAL PROVISIONS", THE "MANUAL ON UNIFORM TRAFFIC CONTROL DEVICES FOR STREETS AND HIGHWAYS" AND THE "MANUAL OF TEST PROCEDURES FOR MATERIALS".
- THE LOCATIONS OF PUBLIC OR PRIVATE UTILITIES SHOWN ON THE PLANS ARE APPROXIMATE AND THE ENGINEER DOES NOT GUARANTEE THEIR ACCURACY. THE CONTRACTOR SHALL BE RESPONSIBLE FOR THE PROTECTION OF ALL UNDERGROUND OR SURFACE UTILITIES, INCLUDING SPRINKLER SYSTEMS, EVEN THOUGH THEY MAY NOT BE SHOWN ON THE PLANS. PRIOR TO CONSTRUCTION OF ANY PROPOSED UTILITIES, THE CONTRACTOR SHALL EXCAVATE AND LOCATE THE EXISTING UTILITIES TO VERIFY THEIR LOCATION, SIZE, AND DEPTH TO INSURE THAT GRADE CONFLICTS WILL NOT OCCUR. THE COST OF THIS EXPLORATION SHALL BE PAID FOR AS EXPLORATION TRENCH, SPECIAL.
- THE CONTRACTOR SHALL BE RESPONSIBLE FOR THE PROTECTION OF ALL UNDERGROUND OR SURFACE UTILITIES EVEN THOUGH THEY MAY NOT BE SHOWN ON THE PLANS. ANY UTILITY THAT IS DAMAGED DURING CONSTRUCTION SHALL BE REPAIRED OR REPLACED AT THE CONTRACTOR'S EXPENSE TO THE SATISFACTION OF THE ENGINEER.
- THE CONTRACTOR SHALL NOTIFY THE VILLAGE DIRECTOR OF PUBLIC WORKS AND THE ENGINEER AT LEAST 48 HOURS IN ADVANCE OF BEGINNING WORK TO OBTAIN VILLAGE UTILITY LOCATIONS AND SHALL COORDINATE ALL CONSTRUCTION OPERATIONS WITH THE VILLAGE SUPERINTENDENT OF PUBLIC WORKS AND THE ENGINEER.
- MATERIALS RESULTING FROM THE REMOVAL OF PAVEMENT, DRIVEWAYS, CURB AND GUTTER, HOT-MIX ASPHALT SURFACES, SIDEWALKS AND EXCAVATION FOR NEW SIDEWALKS ETC. SHALL BE REMOVED AT THE END OF EACH DAY TO AN APPROVED SITE. IN THE JUDGMENT OF THE ENGINEER, SHOULD IT BE NECESSARY TO REMOVE SUCH MATERIALS, THE ENGINEER WILL HAVE THE MATERIAL REMOVED AND THE CONTRACTOR WILL BE BILLED (CHARGED) ACCORDINGLY.
- THE CONTRACTOR MAY OBTAIN MUNICIPAL WATER IN BULK, AT NO CHARGE, AS LONG AS THERE IS NOT A "WATERING BAN" IN EFFECT. THE INDISCRIMINATE USE OF FIRE HYDRANTS IS STRICTLY PROHIBITED. WATER FOR CONSTRUCTION SHALL BE METERED OR OTHERWISE ACCOUNTED FOR AND A DAILY LOG MAINTAINED. THE CONTRACTOR SHALL PROVIDE THE WATER TRUCK AND DRIVER REQUIRED TO OBTAIN AND TRANSPORT THIS WATER. THE VILLAGE RESERVES THE RIGHT TO RESTRICT OR REFUSE THE USE OF VILLAGE WATER IF DEEMED NECESSARY.
- IT WILL BE THE CONTRACTOR'S RESPONSIBILITY TO NOTIFY RESIDENTS AND THE ENGINEER WHEN ACCESS TO THEIR DRIVEWAYS WILL BE TEMPORARILY CLOSED DUE TO DRIVEWAY REPLACEMENT. THE CONTRACTOR SHALL DISTRIBUTE NOTICES PROVIDED BY THE VILLAGE TO RESIDENTS. EVERY EFFORT SHALL BE MADE TO ACCOMMODATE ACCESS TO THESE PROPERTIES INCLUDING KNOCKING ON DOORS WHEN DRIVEWAYS ARE ABOUT TO BE CLOSED. THE COST OF THIS WORK IS INCLUDED IN COMBINATION CONCRETE CURB AND GUTTER REMOVAL AND REPLACEMENT.
- THE CONTRACTOR SHALL PROTECT AND CAREFULLY PRESERVE ALL SECTION OR SUBSECTION MONUMENTS OR PROPERTY OR REFERENCE MARKERS UNTIL THE OWNERS, HIS AGENT OR AN AUTHORIZED SURVEYOR HAS WITNESSED OR OTHERWISE REFERENCED THEIR LOCATIONS.
- ALL SIGNS AND MAILBOXES THAT ARE IN CONFLICT WITH THE PROPOSED CONSTRUCTION SHALL BE REMOVED AND REPLACED IN ACCORDANCE WITH VILLAGE STANDARDS AND IN ACCORDANCE WITH ARTICLE 107.20. MAIL SERVICE SHALL BE MAINTAINED AT ALL TIMES.
- EXISTING PAVEMENT, DRIVEWAY PAVEMENT, CURB AND GUTTER AND SIDEWALK TO REMAIN IN PLACE SHALL BE SAW CUT FULL DEPTH TO PROVIDE A NEAT VERTICAL FACE BETWEEN THE PROPOSED AND EXISTING AND SHALL BE INCLUDED IN THE COST OF THE APPROPRIATE REMOVAL PAY ITEM.
- IN AREAS WHERE THE EXISTING DRIVEWAY (HOT-MIX ASPHALT OR GRAVEL), SIDEWALK, OR CURB AND GUTTER IS TO BE REMOVED AND REPLACED, THE REMOVAL AND DISPOSAL OF ANY ADDITIONAL MATERIAL REQUIRED TO ESTABLISH THE PROPOSED DRIVEWAY, SIDEWALK, OR CURB AND GUTTER SUBGRADE ELEVATION SHALL BE INCLUDED IN THE PAY ITEMS, HMA SURFACE REMOVAL OF THE TYPE SPECIFIED, SIDEWALK REMOVAL OR COMBINATION CONCRETE CURB AND GUTTER REMOVAL AND REPLACEMENT.
- RESERVED
- ALL AGGREGATE USED ON THIS PROJECT SHALL BE CRUSHED MATERIAL.
- THE DAYS PAVING OPERATION SHALL RESULT IN A SINGLE TRANSVERSE JOINT. COLD LONGITUDINAL JOINTS WILL NOT BE ACCEPTED. PROVIDING A SINGLE TRANSVERSE JOINT SHALL BE ACCOMPLISHED BY PAVING ONE LANE OF SUFFICIENT LENGTH THAT WILL ALLOW FOR THE PAVING OF THE ADJACENT LANE IN THE SAME DAY.
- THE CONTRACTOR SHALL UTILIZE A MECHANICAL SWEEPER TO CLEAN STREETS AFFECTED BY CONTRACTORS OPERATIONS, INCLUDING HAUL ROUTES, AT LEAST TWICE PER WEEK AND ADDITIONALLY AS DIRECTED BY THE ENGINEER. THIS WORK SHALL BE INCLUDED IN THE COST OF MOBILIZATION.
- CURB AND GUTTER SHALL BE DEPRESSED AT DRIVEWAYS AND SIDEWALK RAMPS IN ACCORDANCE WITH THE IDOT HIGHWAY STANDARDS. SIDEWALK RAMPS FOR ACCESS FOR THE DISABLED SHALL BE PROVIDED AT THE PROPOSED CROSSWALKS IN ACCORDANCE WITH THE IDOT HIGHWAY STANDARDS OR AS DETERMINED BY THE ENGINEER.
- PORTLAND CEMENT CONCRETE SIDEWALK SHALL BE THICKENED TO 8-INCHES WHERE THE SIDEWALK CROSSES COMMERCIAL DRIVEWAYS. 6" x 6" WELDED WIRE FABRIC SHALL BE INSTALLED IN THE SIDEWALK WHERE THE SIDEWALK CROSSES EITHER PRIVATE OR COMMERCIAL DRIVEWAYS. TRANSVERSE EXPANSION JOINTS 3/4-INCH SHALL BE PLACED EVERY 50 FEET OR AS DETERMINED BY THE ENGINEER. TRANSVERSE CONTRACTION JOINTS SHALL BE PLACED EVERY 5-FEET. THIS WORK IS INCLUDED IN THE COST OF THE APPLICABLE PCC SIDEWALK PAY ITEM.
- THE CONTRACTOR WILL ONLY BE ALLOWED TO REMOVE AND REPLACE CURB AND GUTTER ON ONE SIDE OF THE ROAD AT A TIME TO MINIMIZE CONGESTION. REPLACEMENT MUST BE COMPLETE ON ONE SIDE OF THE ROAD BEFORE THE CONTRACTOR IS ALLOWED TO BEGIN REMOVING CURB AND GUTTER ON THE OTHER SIDE OF THE ROAD.
- THE FINISHED HOT-MIX ASPHALT SURFACE SHALL BE CONSTRUCTED 0.25 INCHES ABOVE THE GUTTER FLAG.
- A 1/2-INCH THICK EXPANSION JOINT SHALL BE PROVIDED AT THE JUNCTION OF THE DRIVEWAY APRON AND CURB, AND AT THE JUNCTION OF THE DRIVEWAY APRON AND THE SIDEWALK. THIS WORK WILL BE INCLUDED IN THE COST OF PORTLAND CEMENT CONCRETE DRIVEWAY PAVEMENT.
- THE CONTRACTOR SHALL CONTACT THE LOCAL AGENCY MATERIAL INSPECTOR (SOIL AND MATERIAL CONSULTANTS - THOMAS JOHNSON - 847-870-0544) AT LEAST 48 HOURS PRIOR TO ANY CONCRETE OR HOT-MIX ASPHALT MATERIAL DELIVERIES.
- ALL FRAME AND LID CASTINGS LOCATED WITHIN THE PAVEMENT WHICH REQUIRE RESETTING TO FINISH GRADE SHALL BE BACKFILLED WITH CLASS SI CONCRETE AND ALLOWED TO CURE FOR 72 HOURS. HMA MATERIALS WILL NOT BE ALLOWED AS BACKFILL AROUND AN ADJUSTED CASTING. THIS WORK SHALL APPLY AT ALL CASTINGS ADJUSTED OR RECONSTRUCTED AS PART OF THIS CONTRACT, WHETHER PAID FOR SEPARATELY OR INCLUDED IN OTHER CONTRACT WORK. SEE SPECIAL PROVISION.
- THE COST OF MAKING ANY SEWER CONNECTIONS TO EXISTING DRAINAGE STRUCTURES OR PIPE SHALL BE INCLUDED IN THE COST OF THE NEW SEWER OR STRUCTURE. ANY ADDITIONAL STORM SEWER PIPE REQUIRED TO MAKE THE CONNECTION SHALL BE OF THE SAME SIZE AND MATERIAL TYPE AS THE EXISTING STORM SEWER AND SHALL BE INCLUDED IN THE COST OF THE SEWER OR STRUCTURE.
- IF ANY STORM SEWER LATERALS ARE FOUND DURING CONSTRUCTION AND ARE NOT IDENTIFIED ON THE PLANS, THEY SHALL BE CONNECTED TO THE PROPOSED STORM SEWER SYSTEM AND INCLUDED IN THE COST OF THE STORM SEWER CONSTRUCTION.
- STORM STRUCTURE OFFSET LOCATIONS ARE TO THE EDGE OF PAVEMENT IF THE STRUCTURE IS IN THE CURB LINE OR TO THE CENTER OF STRUCTURE IF THE STRUCTURE IS NOT IN THE CURBLINE.
- IN ALL TRENCHES CROSSING DRIVEWAYS, SIDEWALKS, AND ALL PROPOSED AND EXISTING ROADWAYS, THE MATERIAL FOR THE TOP 12 INCHES SHALL BE CA-6 CRUSHED GRAVEL OR CRUSHED STONE AND BE INCLUDED IN THE PAY ITEM FOR TRENCH BACKFILL.
- FRAME ELEVATIONS GIVEN ON THE PLANS ARE ONLY TO ASSIST THE CONTRACTOR IN DETERMINING THE APPROXIMATE OVERALL HEIGHT OF THE STRUCTURE. FRAMES ON ALL NEW STRUCTURES SHALL BE ADJUSTED TO THE FINAL ELEVATION OF THE AREA IN WHICH THEY ARE LOCATED AS PART OF COST OF THE STRUCTURE.
- A PORTABLE BATHROOM(S) SHALL BE PLACED ON THE JOB SITE(S) AND RELOCATED WHEN NECESSARY SO IT IS ACCESSIBLE TO WORKERS. IF WORK IS OCCURRING AT SEVERAL LOCATIONS, ONE PORTABLE BATHROOM SHALL BE PLACED AT EACH LOCATION WITHIN A REASONABLE DISTANCE FROM THE WORK AS DETERMINED BY THE ENGINEER. THIS SHALL BE INCLUDED IN THE PAY ITEM FOR MOBILIZATION IN ACCORDANCE WITH ARTICLE 107.08.
- THE DETAIL FOR COMBINATION CONCRETE CURB AND GUTTER REMOVAL AND REPLACEMENT SHOWN ON THE PLANS SHALL BE MODIFIED TO INCLUDE THE FOLLOWING. THE WORK SHALL INCLUDE SAW-CUTTING AND REMOVING THE EXISTING PAVEMENT A MINIMUM OF 6-INCHES MEASURED FROM THE EXISTING EDGE OF PAVEMENT, AND FILLING THE 6" GAP WITH CLASS SI CONCRETE TO AN ELEVATION 5-1/4" BELOW THE PROPOSED CURB AND GUTTER FLAG. IF THE CONCRETE IS PLACED HIGHER THAN 5-1/4" FROM THE GUTTER FLAG FOR STREETS TO BE RESURFACED, THE CONTRACTOR WILL BE REQUIRED TO GRIND ADDITIONAL CONCRETE TO THE REQUIRED 5-1/4" DEPTH. THE AREA BEHIND THE PROPOSED CURB AND GUTTER SHALL BE RESTORED WITH NATIVE SOD IN ACCORDANCE WITH SECTION 1081.03 RATHER THAN SALT TOLERANT SOD. THIS WORK IS INCLUDED IN THE COST OF THE APPLICABLE CURB AND GUTTER PAY ITEMS.
- ON STREETS TO BE FULL WIDTH MILLED (2" OR MORE), THE EXISTING STRUCTURES IN THE PAVEMENT SHALL BE ADJUSTED IN ACCORDANCE WITH THE IDOT DETAIL "DETAILS FOR FRAMES AND LIDS ADJUSTMENT WITH MILLING". THIS WORK SHALL BE IN ADDITION TO THE REQUIREMENTS FOR ANY STRUCTURE TO BE ADJUSTED AND SHALL BE PAID FOR ONCE AT THE CONTRACT UNIT PRICE FOR THE APPLICABLE PAY ITEM.
- WHEN MILLED PAVEMENT IS OPEN TO TRAFFIC, THE MAXIMUM GRADE DIFFERENTIAL BETWEEN PASSES OF THE MILLING MACHINE SHALL NOT EXCEED 1-1/2 INCHES WHERE THE SPEED LIMIT IS 45 MPH OR LESS, AND SHALL NOT EXCEED 1 INCH WHERE THE SPEED LIMIT IS OVER 45 MPH. A MAXIMUM GRADE DIFFERENCE OF 3 INCHES MAY BE ALLOWED IF THE EDGE OF THE MILLING IS SLOPED A MINIMUM OF 1:3 (V:H), AS DETERMINED BY THE ENGINEER.

**INDEX OF SHEETS**

| SHEET NO. | TITLE  |
|-----------|--|
| 1         | COVER SHEET  |
| 2         | INDEX OF SHEETS, HIGHWAY STANDARDS, LEGEND, AND GENERAL NOTES  |
| 3 - 4     | SUMMARY OF QUANTITIES  |
| 5         | TYPICAL SECTIONS AND HOT-MIX ASPHALT MIXTURE REQUIREMENTS  |
| 6 - 9     | PLAN AND PROFILE - LONG LAKE DRIVE   |
| 10        | DISTRICT 1 DETAIL - BD-01 DRIVEWAY DETAILS - DISTANCE BETWEEN R.O.W. AND FACE OF CURB & EDGE OF SHOULDER >= 15' (4.5m) |
| 11        | DISTRICT 1 DETAIL - BD-08 FRAMES AND LIDS ADJUSTMENT WITH MILLING AND FRAMES AND LIDS ADJUSTMENT WITHOUT MILLING       |
| 12        | DISTRICT 1 DETAIL - BD-24 CURB AND CURB AND GUTTER REMOVAL AND REPLACEMENT   |
| 13        | DISTRICT 1 DETAIL - TC-10 TRAFFIC CONTROL AND PROTECTION FOR SIDE ROADS, INTERSECTIONS, AND DRIVEWAYS                  |
| 14        | DISTRICT 1 DETAIL - TC-13 DISTRICT ONE TYPICAL PAVEMENT MARKINGS   |
| 15        | DISTRICT 1 DETAIL - TC-22 ARTERIAL ROAD INFORMATION SIGN   |
| 16 - 17   | CROSS SECTIONS - LONG LAKE DRIVE   |

**HIGHWAY STANDARDS**

|           |  |
|-----------|--|
| 000001-06 | STANDARD SYMBOLS, ABBREVIATIONS AND PATTERNS                         |
| 280001-07 | TEMPORARY EROSION CONTROL SYSTEMS                                    |
| 424001-08 | PERPENDICULAR CURB RAMPS FOR SIDEWALKS                               |
| 424006-02 | DIAGONAL CURB RAMPS FOR SIDEWALKS                                    |
| 424011-02 | CORNER PARALLEL CURB RAMPS FOR SIDEWALKS                             |
| 424016-02 | MID-BLOCK CURB RAMPS FOR SIDEWALKS                                   |
| 424026-01 | ENTRANCE/ALLEY PEDESTRIAN CROSSINGS                                  |
| 602001-02 | CATCH BASIN TYPE A   |
| 602011-02 | CATCH BASIN TYPE C   |
| 602401-03 | MANHOLE TYPE A   |
| 602406-06 | MANHOLE TYPE A 6' (1.8 m) DIAMETER                                   |
| 602601-03 | PRECAST REINFORCED CONCRETE FLAT SLAB TOP                            |
| 602701-02 | MANHOLE STEPS  |
| 604001-04 | FRAME AND LIDS TYPE 1  |
| 604051-04 | FRAME AND GRATE TYPE 11  |
| 606001-06 | CONCRETE CURB TYPE B AND COMBINATION CONCRETE CURB AND GUTTER        |
| 701006-05 | OFF-RD OPERATIONS, 2L, 2W, 15' (4.5 m) TO 24' (600 mm) FROM PAVEMENT |
| 701301-04 | LANE CLOSURE, 2L, 2W, SHORT TIME OPERATIONS                          |
| 701501-06 | URBAN LANE CLOSURE, 2L, 2W, UNDIVIDED                                |
| 701801-05 | SIDEWALK, CORNER OR CROSSWALK CLOSURE                                |
| 701901-04 | TRAFFIC CONTROL DEVICES  |
| 720001-01 | SIGN PANEL MOUNTING DETAILS  |
| 720006-04 | SIGN PANEL ERECTION DETAILS  |
| 728001-01 | TELESCOPING STEEL SIGN SUPPORT                                       |
| 780001-05 | TYPICAL PAVEMENT MARKINGS  |

**LEGEND**

EXISTING ELEVATION + STATION  
PROPOSED ELEVATION

**BENCHMARKS**

|                  |   |
|------------------|---|
| BM#1             | RRS IN POWER POLE AT NORTHWEST CORNER OF LONG LAKE DRIVE AND LOTUS DRIVE<br>ELEV = 751.68 |
| BM#2             | RRS IN POWER POLE WITH LIGHT AT ROUND LAKE BEACH PUBLIC WORKS DRIVE<br>ELEV = 757.15      |
| BM#3             | RRS IN POWER POLE ON EAST SIDE OF SUNSET DRIVE AT LONG LAKE DRIVE<br>ELEV = 759.19        |
| DATUM IS NAVD 88 |   |

COPYRIGHT © 2014 BY BAXTER & WOODMAN, INC.  
 STATE OF ILLINOIS - PROFESSIONAL DESIGN FIRM  
 LICENSE NO. - JBF-00107 - EXPIRES 12/31/2015  
 2/27/2015  
 ...:\pilot\dr-v\pof-Bw\_De\Proj.dwg  
 ...:\CAD\DWG\PLT\SV\00345\_SHT.dwg  
 ...:\Gry\BTL\Long\W00345.dgn - Long Lake STA.CADD\00345SHT-GenNotes.dgn

**BAXTER & WOODMAN**  
Consulting Engineers

|                 |                               |
|-----------------|-------------------------------|
| DESIGNED - MWP  | REVISED - IDOT REVIEW 8-18-14 |
| DRAWN - KAR     | REVISED - IDOT REVIEW 8-28-14 |
| CHECKED - TMS   | REVISED - IDOT REVIEW 2-27-15 |
| DATE - 06-16-14 | FILE - 100345SHT-GenNotes.dgn |

STATE OF ILLINOIS  
DEPARTMENT OF TRANSPORTATION

INDEX OF SHEETS, HIGHWAY STANDARDS,  
LEGEND, AND GENERAL NOTES

SCALE: NONE

STA. TO STA.

| F.A.U. RTE.  | SECTION        | COUNTY | TOTAL SHEETS | SHEET NO. |
|--|----------------|--------|--------------|-----------|
| 210  | 12-00035-00-RS | LAKE   | 17           | 2         |
| CONTRACT NO. 61A71   |                |        |              |           |
| FED. ROAD DIST. NO. 1 ILLINOIS FED. AID PROJECT M-9003 (940) |                |        |              |           |



**SUMMARY OF QUANTITIES**

| CODE NUMBER | PAY ITEM                                    | UNIT  | TOTAL QUANTITY | CONSTRUCTION TYPE CODE     |   |
|-------------|---|-------|----------------|----------------------------|---|
|             |   |       |                | RESURFACING<br>0005<br>STU | NON PARTICIPATING<br>(100% VILLAGE)<br>0044 |
| 20200100    | EARTH EXCAVATION                            | CU YD | 134            | 134                        | 0   |
| 20201200    | REMOVAL AND DISPOSAL OF UNSUITABLE MATERIAL | CU YD | 193            | 187                        | 6   |
| 20800150    | TRENCH BACKFILL                             | CU YD | 75             | 75                         | 0   |
| 21101615    | TOPSOIL FURNISH AND PLACE, 4"               | SQ YD | 1,350          | 1,350                      | 0   |
| 21400100    | GRADING AND SHAPING DITCHES                 | FOOT  | 130            | 130                        | 0   |
| 25000400    | NITROGEN FERTILIZER NUTRIENT                | POUND | 17             | 17                         | 0   |
| 25000600    | POTASSIUM FERTILIZER NUTRIENT               | POUND | 17             | 17                         | 0   |
| 25200110    | SODDING, SALT TOLERANT                      | SQ YD | 1,350          | 1,350                      | 0   |
| 25200200    | SUPPLEMENTAL WATERING                       | UNIT  | 21             | 21                         | 0   |
| 28000250    | TEMPORARY EROSION CONTROL SEEDING           | POUND | 28             | 28                         | 0   |
| 28000305    | TEMPORARY DITCH CHECKS                      | FOOT  | 40             | 40                         | 0   |
| 28000400    | PERIMETER EROSION BARRIER                   | FOOT  | 200            | 200                        | 0   |
| 28000510    | INLET FILTERS                               | EACH  | 15             | 14                         | 1   |
| # 30300001  | AGGREGATE SUBGRADE IMPROVEMENT              | CU YD | 39             | 33                         | 6   |
| 35101400    | AGGREGATE BASE COURSE, TYPE B               | TON   | 341            | 315                        | 26  |
| 35101600    | AGGREGATE BASE COURSE, TYPE B 4"            | SQ YD | 971            | 971                        | 0   |
| 35102400    | AGGREGATE BASE COURSE, TYPE B 12"           | SQ YD | 632            | 607                        | 25  |

| CODE NUMBER | PAY ITEM   | UNIT  | TOTAL QUANTITY | CONSTRUCTION TYPE CODE     |   |
|-------------|--|-------|----------------|----------------------------|---|
|             |  |       |                | RESURFACING<br>0005<br>STU | NON PARTICIPATING<br>(100% VILLAGE)<br>0044 |
| # 35501316  | HOT-MIX ASPHALT BASE COURSE, 8"                            | SQ YD | 14             | 14                         | 0   |
| # 35800100  | PREPARATION OF BASE  | SQ YD | 6,315          | 5,825                      | 490   |
| # 40600275  | BITUMINOUS MATERIALS (PRIME COAT)                          | POUND | 15,630         | 14,417                     | 1,213                                       |
| # 40603080  | HOT-MIX ASPHALT BINDER COURSE, IL-19.0, N50                | TON   | 1,090          | 1,005                      | 85  |
| # 40603335  | HOT-MIX ASPHALT SURFACE COURSE, MIX "D", N50               | TON   | 727            | 670                        | 57  |
| 40800050    | INCIDENTAL HOT-MIX ASPHALT SURFACING                       | TON   | 1              | 1                          | 0   |
| 42300400    | PORTLAND CEMENT CONCRETE DRIVEWAY PAVEMENT, 8 INCH         | SQ YD | 162            | 162                        | 0   |
| 42400200    | PORTLAND CEMENT CONCRETE SIDEWALK 5 INCH                   | SQ FT | 6,300          | 6,300                      | 0   |
| 42400410    | PORTLAND CEMENT CONCRETE SIDEWALK 8 INCH                   | SQ FT | 855            | 855                        | 0   |
| 42400800    | DETECTABLE WARNINGS  | SQ FT | 40             | 40                         | 0   |
| 44000200    | DRIVEWAY PAVEMENT REMOVAL                                  | SQ YD | 277            | 277                        | 0   |
| 44000500    | COMBINATION CURB AND GUTTER REMOVAL                        | FOOT  | 582            | 582                        | 0   |
| 44000600    | SIDEWALK REMOVAL   | SQ FT | 6,838          | 6,838                      | 0   |
| 550A2320    | STORM SEWERS, RUBBER GASKET, CLASS A, TYPE 1 12"           | FOOT  | 196            | 196                        | 0   |
| 60201105    | CATCH BASINS, TYPE A, 4'-DIAMETER, TYPE 11 FRAME AND GRATE | EACH  | 2              | 2                          | 0   |
| 60207905    | CATCH BASINS, TYPE C, TYPE 11 FRAME AND GRATE              | EACH  | 2              | 2                          | 0   |
| 60219300    | MANHOLES, TYPE A, 4'-DIAMETER, TYPE 11 FRAME AND GRATE     | EACH  | 1              | 1                          | 0   |

\* SPECIALTY ITEM  
# INDICATES SPECIAL PROVISION AND/OR GENERAL NOTE AND/OR DETAIL  
\$ INDICATES CONSTRUCTION CODE 0042 TRAINEES

\* SPECIALTY ITEM  
# INDICATES SPECIAL PROVISION AND/OR GENERAL NOTE AND/OR DETAIL  
\$ INDICATES CONSTRUCTION CODE 0042 TRAINEES

COPYRIGHT © 2014 BY BAXTER & WOODMAN, INC.  
 STATE OF ILLINOIS - PROFESSIONAL DESIGN FIRM  
 LICENSE NO. - 184-072054-2014-03-15-0000  
 DATE: 2/27/2015 7:55:27 AM  
 ...\\dot\driv\acct\B&W\de\duil\pht  
 ...\\dot\driv\acct\B&W\de\duil\pht  
 ...\\dot\driv\acct\B&W\de\duil\pht



|                 |                               |
|-----------------|-------------------------------|
| DESIGNED - MWP  | REVISED - IDOT REVIEW 8-18-14 |
| DRAWN - KAR     | REVISED - IDOT REVIEW 8-28-14 |
| CHECKED - TMS   | REVISED - IDOT REVIEW 2-27-15 |
| DATE - 06-16-14 | FILE - I00345SHT-S00.dgn      |

**STATE OF ILLINOIS  
DEPARTMENT OF TRANSPORTATION**

|                              |              |
|------------------------------|--------------|
| <b>SUMMARY OF QUANTITIES</b> |              |
| SCALE: NONE                  | STA. TO STA. |

|                                |                |        |                         |           |
|--------------------------------|----------------|--------|-------------------------|-----------|
| F.A.U. RTE.                    | SECTION        | COUNTY | TOTAL SHEETS            | SHEET NO. |
| 210                            | 12-00035-00-RS | LAKE   | 17                      | 3         |
| FED. ROAD DIST. NO. 1 ILLINOIS |                |        | FED. AID PROJECT M-9003 | 19401     |
| CONTRACT NO. 61A71             |                |        |                         |           |



**SUMMARY OF QUANTITIES**

| CODE NUMBER | PAY ITEM   | UNIT  | TOTAL QUANTITY | CONSTRUCTION TYPE CODE |                                       |
|-------------|--|-------|----------------|------------------------|---------------------------------------|
|             |  |       |                | RESURFACING 0005 STU   | NON PARTICIPATING (100% VILLAGE) 0044 |
| 60224020    | MANHOLES, TYPE A, 6'-DIAMETER, TYPE 11 FRAME AND GRATE | EACH  | 1              | 1                      | 0                                     |
| # 60250200  | CATCH BASINS TO BE ADJUSTED                            | EACH  | 1              | 1                      | 0                                     |
| # 60255500  | MANHOLES TO BE ADJUSTED                                | EACH  | 1              | 1                      | 0                                     |
| # 60260100  | INLETS TO BE ADJUSTED                                  | EACH  | 3              | 3                      | 0                                     |
| # 60265700  | VALVE VAULTS TO BE ADJUSTED                            | EACH  | 1              | 1                      | 0                                     |
| # 60266600  | VALVE BOXES TO BE ADJUSTED                             | EACH  | 2              | 2                      | 0                                     |
| 60603800    | COMBINATION CONCRETE CURB AND GUTTER, TYPE B-6.12      | FOOT  | 582            | 582                    | 0                                     |
| 67100100    | MOBILIZATION   | LSUM  | 1              | 1                      | 0                                     |
| # 70102620  | TRAFFIC CONTROL AND PROTECTION, STANDARD 701501        | LSUM  | 1              | 1                      | 0                                     |
| # 70102640  | TRAFFIC CONTROL AND PROTECTION, STANDARD 701801        | LSUM  | 1              | 1                      | 0                                     |
| 70300100    | SHORT TERM PAVEMENT MARKING                            | FOOT  | 1,274          | 1,249                  | 25                                    |
| 70301000    | WORK ZONE PAVEMENT MARKING REMOVAL                     | SQ FT | 213            | 203                    | 10                                    |
| 72000100    | SIGN PANEL - TYPE 1                                    | SQ FT | 79             | 58                     | 21                                    |
| 72400200    | REMOVE SIGN PANEL ASSEMBLY - TYPE B                    | EACH  | 7              | 5                      | 2                                     |
| 72400310    | REMOVE SIGN PANEL - TYPE 1                             | SQ FT | 18             | 18                     | 0                                     |
| 72400600    | RELOCATE SIGN PANEL ASSEMBLY - TYPE B                  | EACH  | 1              | 1                      | 0                                     |
| 72800100    | TELESCOPING STEEL SIGN SUPPORT                         | FOOT  | 105            | 75                     | 30                                    |

\* SPECIALTY ITEM  
 # INDICATES SPECIAL PROVISION AND/OR GENERAL NOTE AND/OR DETAIL  
 \$ INDICATES CONSTRUCTION CODE 0042 TRAINEES

| CODE NUMBER   | PAY ITEM                                  | UNIT  | TOTAL QUANTITY | CONSTRUCTION TYPE CODE |                                       |
|---------------|---|-------|----------------|------------------------|---------------------------------------|
|               |   |       |                | RESURFACING 0005 STU   | NON PARTICIPATING (100% VILLAGE) 0044 |
| * 78000200    | THERMOPLASTIC PAVEMENT MARKING - LINE 4"  | FOOT  | 430            | 410                    | 20                                    |
| * 78000400    | THERMOPLASTIC PAVEMENT MARKING - LINE 6"  | FOOT  | 90             | 90                     | 0                                     |
| * 78000600    | THERMOPLASTIC PAVEMENT MARKING - LINE 12" | FOOT  | 84             | 84                     | 0                                     |
| * 78000650    | THERMOPLASTIC PAVEMENT MARKING - LINE 24" | FOOT  | 134            | 97                     | 37                                    |
| # Z0003300    | BASE COURSE REMOVAL (SPECIAL)             | SQ YD | 632            | 607                    | 25                                    |
| # Z0013798    | CONSTRUCTION LAYOUT                       | L SUM | 1              | 1                      | 0                                     |
| # Z0019600    | DUST CONTROL WATERING                     | UNIT  | 76             | 70                     | 6                                     |
| # Z0030850    | TEMPORARY INFORMATION SIGNING             | SQ FT | 182            | 130                    | 52                                    |
| # \$ Z0076600 | TRAINEES                                  | HOOR  | 500            | 0                      | 0                                     |
| # \$ Z0076604 | TRAINEES TRAINING PROGRAM GRADUATE        | HOOR  | 500            | 0                      | 0                                     |
| # X2130010    | EXPLORATION TRENCH, SPECIAL               | FOOT  | 70             | 70                     | 0                                     |
| # X4021000    | TEMPORARY ACCESS (PRIVATE ENTRANCE)       | EACH  | 8              | 4                      | 4                                     |
| # X4022000    | TEMPORARY ACCESS (COMMERCIAL ENTRANCE)    | EACH  | 10             | 10                     | 0                                     |
| # X4023000    | TEMPORARY ACCESS (ROAD)                   | EACH  | 5              | 4                      | 1                                     |
| # X4400196    | HOT-MIX ASPHALT SURFACE REMOVAL, SPECIAL  | SQ YD | 6,315          | 5,825                  | 490                                   |
| # X6026050    | SANITARY MANHOLES TO BE ADJUSTED          | EACH  | 3              | 3                      | 0                                     |
| # X6030310    | FRAMES AND LIDS TO BE ADJUSTED (SPECIAL)  | EACH  | 4              | 3                      | 1                                     |

\* SPECIALTY ITEM  
 # INDICATES SPECIAL PROVISION AND/OR GENERAL NOTE AND/OR DETAIL  
 \$ INDICATES CONSTRUCTION CODE 0042 TRAINEES

COPYRIGHT © 2014 BY BAXTER & WOODMAN, INC.  
 STATE OF ILLINOIS - PROFESSIONAL DESIGN FIRM  
 LICENSE NO. 184-00122 - EXPIRES 4/30/2015  
 560agr 2/27/2015 7:59:33 AM  
 ...:\p01dr-v\pdf-BW\_Def\out\p01...  
 ...:\CAD\PL\05\100345\_PEN.tbl  
 ...:\C:\yestol\l\ok\ROUL\K\100345-Long Lake ST\CADD\DRG\100345SHT-500.dgn



|                 |                               |
|-----------------|-------------------------------|
| DESIGNED - MWP  | REVISED - IDOT REVIEW 8-18-14 |
| DRAWN - KAR     | REVISED - IDOT REVIEW 8-28-14 |
| CHECKED - TMS   | REVISED - IDOT REVIEW 2-27-15 |
| DATE - 06-16-14 | FILE - 100345SHT-500.dgn      |

**STATE OF ILLINOIS  
 DEPARTMENT OF TRANSPORTATION**

**SUMMARY OF QUANTITIES**

SCALE: NONE

STA. TO STA.

| F.A.U. RTE.  | SECTION        | COUNTY | TOTAL SHEETS       | SHEET NO. |
|--|----------------|--------|--------------------|-----------|
| 210  | 12-00035-00-RS | LAKE   | 17                 | 4         |
| FED. ROAD DIST. NO. 1 ILLINOIS FED. AID PROJECT M-9003 (940) |                |        | CONTRACT NO. 61A71 |           |











| STORM STRUCTURES |         |          |                            |                 |           |                          |                          |
|------------------|---------|----------|----------------------------|-----------------|-----------|--------------------------|--------------------------|
| STRUCTURE NUMBER | STATION | OFFSET   | STRUCTURE                  | FRAME AND LID   | RIM       | INVERTS                  |                          |
| S-EX-100         | 24+78   | 40.5' LT | STORM SEWER                | -               | -         | EX 751.12 8" (NE)        |                          |
| S-EX-101         | 24+76   | 31' LT   | STORM SEWER                | -               | -         | EX 748.90 18" (S)        |                          |
| S-EX-111         | 24+67   | 13' RT   | MANHOLE 5' DIA             | TYPE 11         | EX 751.74 | EX 742.16 19" x 30" (N)  | EX 742.16 19" x 30" (S)  |
| S-EX-112         | 24+84   | 9' RT    | INLET 2' DIA               | TYPE 1 OPEN LID | EX 751.58 | EX 748.78 8" (SW)        | 748.78 12" (SE)          |
| S-EX-153         | 24+69   | 34' LT   | MANHOLE 5' DIA             | TYPE 1 OPEN LID | EX 750.28 | EX 741.69 19" x 30" (N)  | EX 741.69 19" x 30" (S)  |
| S-4              | 25+01   | 18' RT   | CATCH BASIN, TYPE C 2' DIA | TYPE 11         | 751.50±   | 749.18 12" (NW)          |                          |
| S-5              | 24+68   | 13' LT   | MANHOLE TYPE 6' DIA        | TYPE 11         | 751.50±   | EX 741.89± 19" x 30" (N) | EX 741.89± 19" x 30" (S) |
| S-6              | 24+89   | 13' LT   | CATCH BASIN, TYPE A 4' DIA | TYPE 11         | 751.58±   | 746.92 12" (W)           | 746.50 12" (E)           |
| S-7              | 27+05   | 15.5' LT | CATCH BASIN, TYPE A 4' DIA | TYPE 11         | 753.12±   | 749.62 12" (S)           |                          |
| S-EX-116         | 27+05   | 50' RT   | CATCH BASIN, TYPE A 4' DIA | TYPE 1 OPEN LID | 752.74±   | EX 749.29 12" (S)        | EX 749.29 12" (E)        |

| STORM PIPES |   |           |             |           |           |
|-------------|---|-----------|-------------|-----------|-----------|
| PIPE NO.    | CLASS/TYPE  | DIAMETER  | LENGTH (FT) | SLOPE (%) | TBF CU YD |
| P-EX-1      | EXISTING REINFORCED CONCRETE STORM SEWER ELLIPTICAL | 19" x 30" | 47          | 1.00%±    |           |
| P-EX-2      | EXISTING REINFORCED CONCRETE STORM SEWER            | 8"        | 17          | 12.00%±   |           |
| P-3         | STORM SEWERS, RUBBER GASKET, CLASS A, TYPE 1        | 12"       | 20          | 2.00%     | 8         |
| P-4         | STORM SEWERS, RUBBER GASKET, CLASS A, TYPE 1        | 12"       | 21          | 2.00%     | 9         |
| P-5         | STORM SEWERS, RUBBER GASKET, CLASS A, TYPE 2        | 12"       | 65          | 0.50%     | 26        |

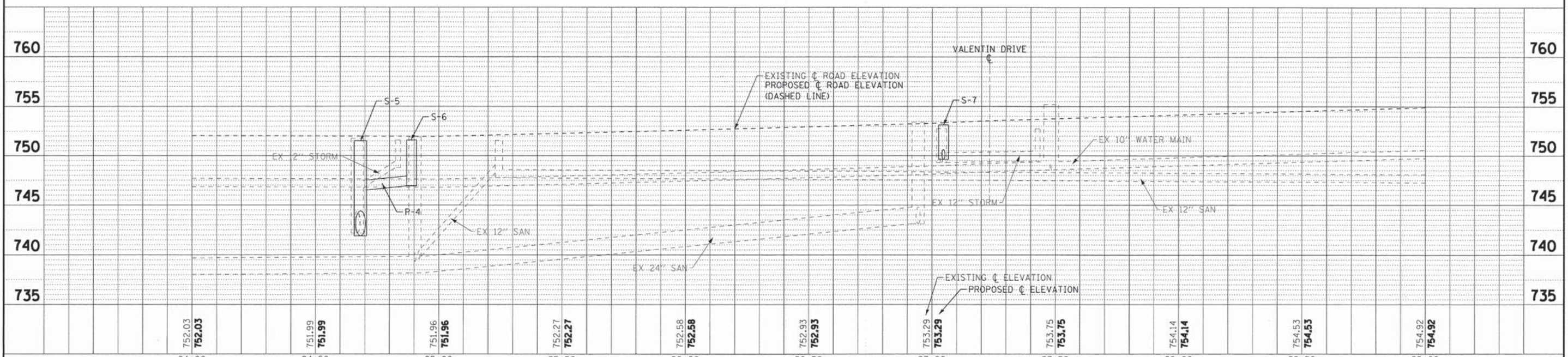
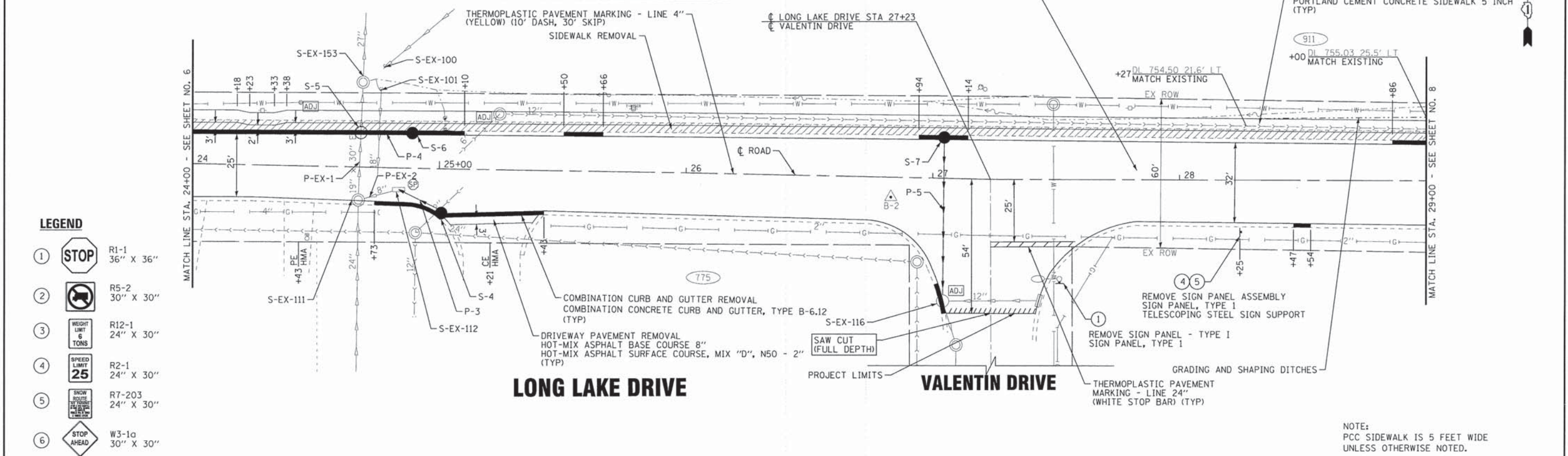

|                 |                               |   |   |   |  |                        |             |                 |             |  |
|-----------------|-------------------------------|---|---|---|--|------------------------|-------------|-----------------|-------------|--|
| DESIGNED - MWP  | REVISOR - IDOT REVIEW 8-18-14 | <b>BAXTER &amp; WOODMAN</b><br>Consulting Engineers<br>STATE OF ILLINOIS<br>LICENSE NO. 184-00201 - EXPIRES 4/30/2015<br>560KCF 8/28/2014 | <b>STATE OF ILLINOIS</b><br><b>DEPARTMENT OF TRANSPORTATION</b> | <b>PLAN AND PROFILE</b><br><b>LONG LAKE DRIVE</b> | F.A.U. RTE. 210  | SECTION 12-00035-00-RS | COUNTY LAKE | TOTAL SHEETS 17 | SHEET NO. 7 |  |
| DRAWN - KAR     | REVISOR - IDOT REVIEW 8-28-14 |   |   |   | CONTRACT NO. 61A71   |                        |             |                 |             |  |
| CHECKED - TMS   | REVISOR -                     |   |   |   | FED. ROAD DIST. NO. 1 [ILLINOIS] FED. AID PROJECT M-9003 (940) |                        |             |                 |             |  |
| DATE - 06-16-14 | FILE - 100345SHT-PP2.dgn      |   |   |   | SCALE: H: 1"=20' V: 1"=5' STA. 24+00 TO STA. 29+00             |                        |             |                 |             |  |

COPYRIGHT © 2014 BY BAXTER & WOODMAN, INC.  
 STATE OF ILLINOIS  
 LICENSE NO. 184-00201 - EXPIRES 4/30/2015  
 560KCF 8/28/2014  
 \\s01dev\proj\14-BW\_Default.dgn  
 ...CAD\DWG\DOTS\00345\_Plan.dwg  
 I:\CR\YST\14-000345-Long Lake ST\CADD\DWG\100345SHT-PP2.dgn



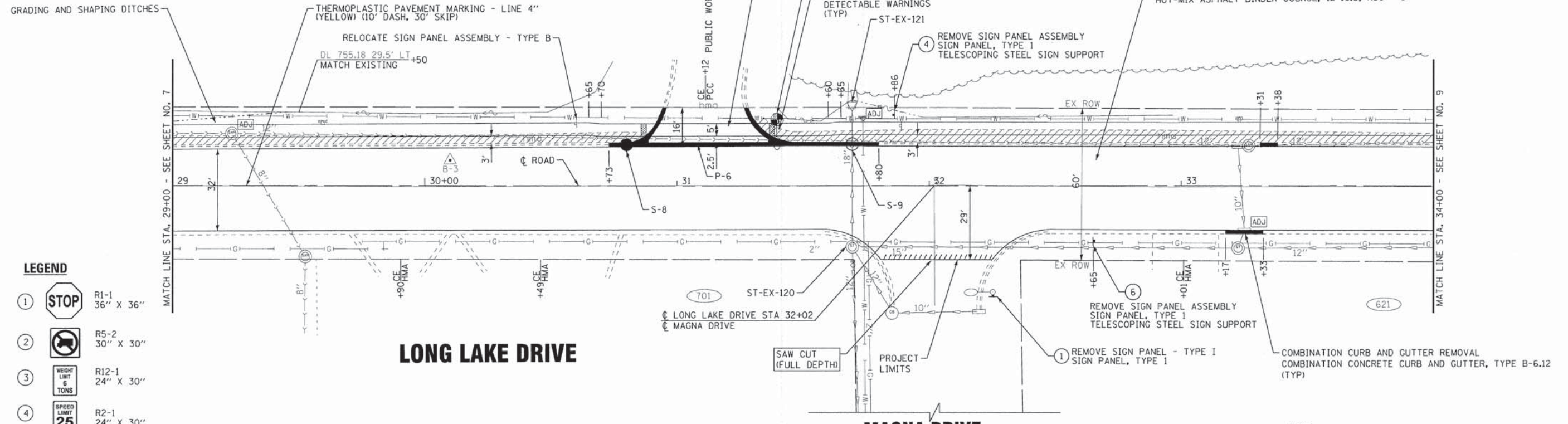

**LEGEND**

- ① R1-1 36" X 36"
- ② R5-2 30" X 30"
- ③ R12-1 24" X 30"
- ④ R2-1 24" X 30"
- ⑤ R7-203 24" X 30"
- ⑥ W3-1a 30" X 30"

**LONG LAKE DRIVE**

**MAGNA DRIVE**

**STORM STRUCTURES**

| STRUCTURE NUMBER | STATION | OFFSET   | STRUCTURE                  | FRAME AND LID | RIM       | INVERTS                              |
|------------------|---------|----------|----------------------------|---------------|-----------|--------------------------------------|
| S-EX-120         | 31+69   | 23.5' RT | STORM SEWER MANHOLE        | -             | EX 757.41 | EX 754.10 18" (N)                    |
| S-EX-121         | 31+69   | 30.5' LT | FLARED END SECTION         | -             | -         | EX 753.79 18" (S)                    |
| S-8              | 30+80   | 15.5' LT | CATCH BASIN, TYPE C 2' DIA | TYPE 11       | 756.10±   | 754.15± 12" (W)                      |
| S-9              | 31+69   | 15.5' LT | MANHOLE 4' DIA             | TYPE 11       | 756.65±   | EX 753.88± 18" (N,S) 753.88± 12" (W) |

**STORM PIPES**

| PIPE NO. | CLASS/TYPE                                   | DIAMETER | LENGTH (FT) | SLOPE (%) | TBF (CU YD) |
|----------|--|----------|-------------|-----------|-------------|
| P-6      | STORM SEWERS, RUBBER GASKET, CLASS A, TYPE 1 | 12"      | 89          | 0.30%     | 32          |

NOTE:  
PCC SIDEWALK IS 5 FEET WIDE  
UNLESS OTHERWISE NOTED.

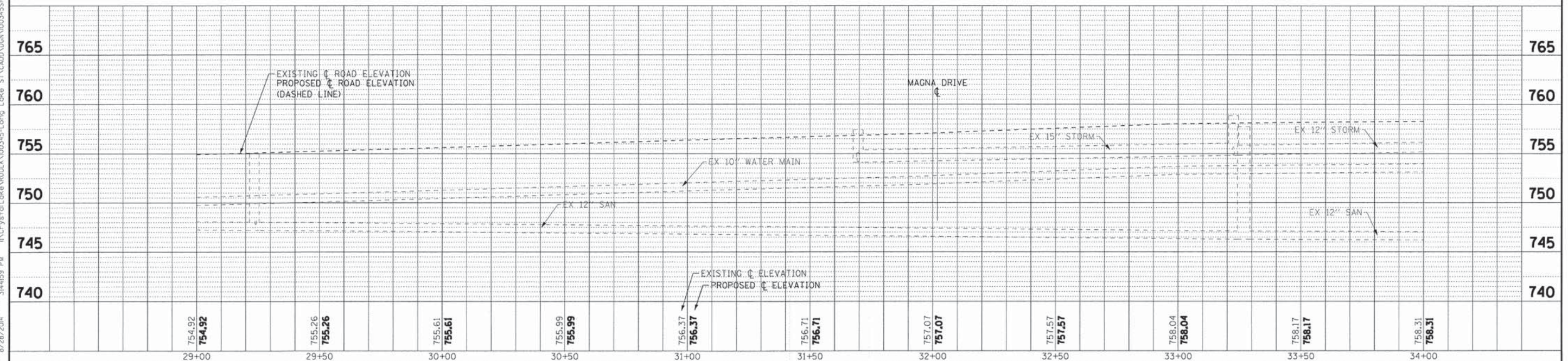

DESIGNED - MWP  
DRAWN - KAR  
CHECKED - TMS  
DATE - 06-16-14

REVISED - IDOT REVIEW 8-18-14  
REVISED - IDOT REVIEW 8-28-14  
REVISED -  
FILE - 100345SHT-PP3.dgn

**STATE OF ILLINOIS  
DEPARTMENT OF TRANSPORTATION**

**PLAN AND PROFILE  
LONG LAKE DRIVE**

SCALE: H: 1"=20' V: 1"=5'  
STA. 29+00 TO STA. 34+00

| F.A.U. RTE. | SECTION        | COUNTY | TOTAL SHEETS | SHEET NO. |
|-------------|----------------|--------|--------------|-----------|
| 210         | 12-00035-00-RS | LAKE   | 17           | 8         |

CONTRACT NO. 61A71  
FED. ROAD DIST. NO. 1 [ILLINOIS] FED. AID PROJECT M-9003 (940)

COPYRIGHT © 2014 BY BAXTER & WOODMAN, INC.  
 STATE OF ILLINOIS - PROFESSIONAL DESIGN FIRM  
 LICENSE NO. - 184-00121 - EXPIRES 4/30/2015  
 5600cr  
 \\s101dr\v\ppf-bw\_defout.dwg  
 \\CAD\VP\OTS\100345\_PEN.tbl  
 \\Crystal Lake\ROLK\100345-Long Lake STA.CADD\DR\100345SHT-PP3.dgn  
 8/28/2014 3:44:59 PM



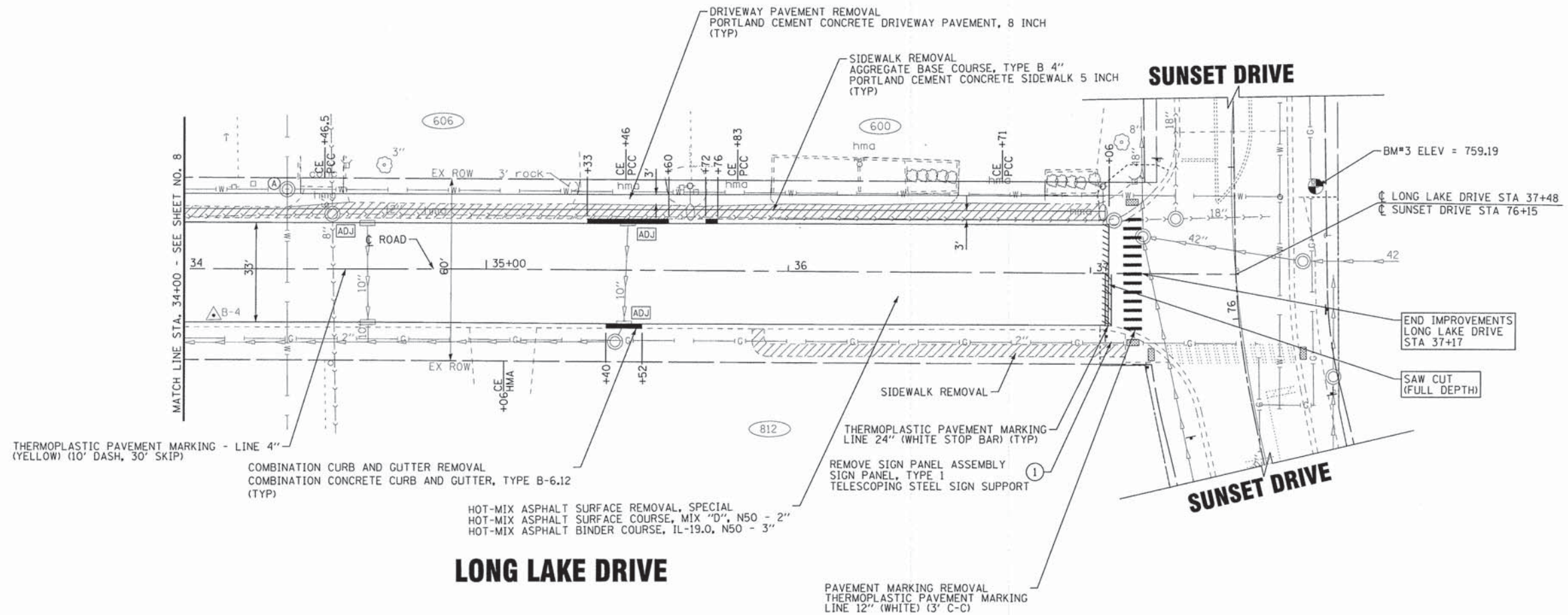

**LEGEND**

- ① R1-1 36" X 36"
- ② R5-2 30" X 30"
- ③ R12-1 24" X 30"
- ④ R2-1 24" X 30"
- ⑤ R7-203 24" X 30"
- ⑥ W3-1a 30" X 30"

NOTE:  
PCC SIDEWALK IS 5 FEET WIDE  
UNLESS OTHERWISE NOTED.

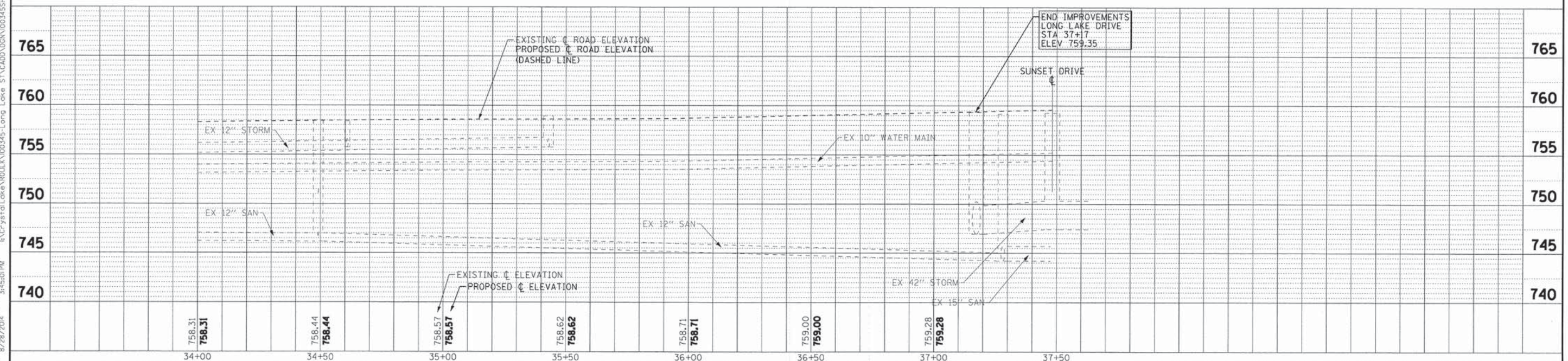

|   |                 |                               |   |   |  |                          |                |  |              |           |
|---|-----------------|-------------------------------|---|---|--|--------------------------|----------------|--|--------------|-----------|
| <b>BAXTER &amp; WOODMAN</b><br>Consulting Engineers | DESIGNED - MWP  | REVISED - IDOT REVIEW 8-18-14 | <b>STATE OF ILLINOIS</b><br><b>DEPARTMENT OF TRANSPORTATION</b> | <b>PLAN AND PROFILE</b><br><b>LONG LAKE DRIVE</b> |  | F.A.U. RTE.              | SECTION        | COUNTY   | TOTAL SHEETS | SHEET NO. |
|   | DRAWN - KAR     | REVISED - IDOT REVIEW 8-28-14 |   |   |  | 210                      | 12-00035-00-RS | LAKE   | 17           | 9         |
|   | CHECKED - TMS   | REVISED -                     |   |   |  | CONTRACT NO. 61A71       |                |  |              |           |
|   | DATE - 06-16-14 | FILE - 100345SHT-PP4.dgn      |   | SCALE: H: 1"=20' V: 1"=5'                         |  | STA. 34+00 TO STA. 37+48 |                | FED. ROAD DIST. NO. 1   ILLINOIS FED. AID PROJECT M-9003 19401 |              |           |

COPYRIGHT © 2014 BY BAXTER & WOODMAN, INC.  
 STATE OF ILLINOIS - PROFESSIONAL DESIGN FIRM  
 LICENSE NO. - 184-00121 - EXPIRES 4/30/2015  
 560k.or 8/28/2014 3:45:01 PM  
 ...\\p01dr-vapref-bw.Dwg.Dwg.dgn  
 ...\\CAD\\PL01S\\100345\_PEN.rvt  
 ...\\CAD\\PL01S\\100345-Long Lake STA\\CAD\\DGN\\100345SHT-PP4.dgn



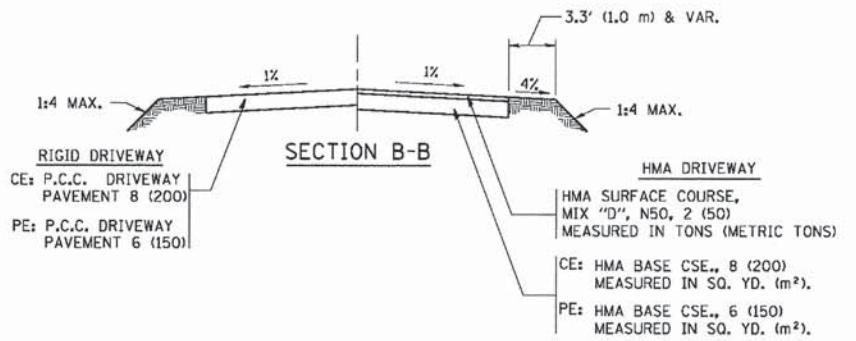
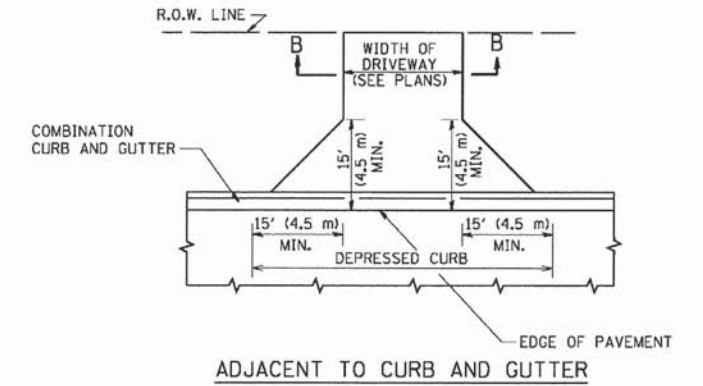
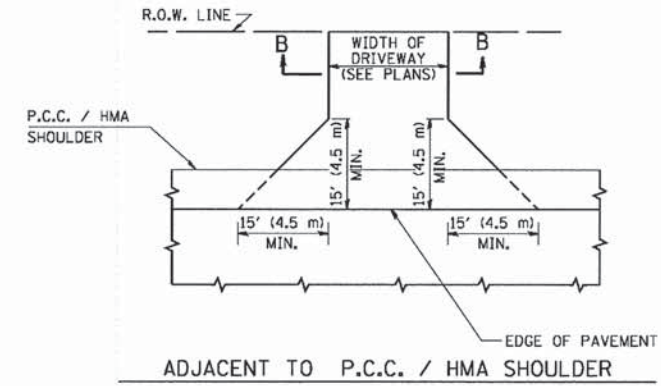
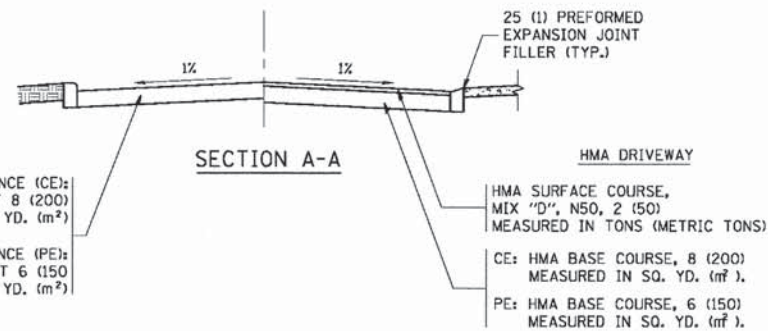
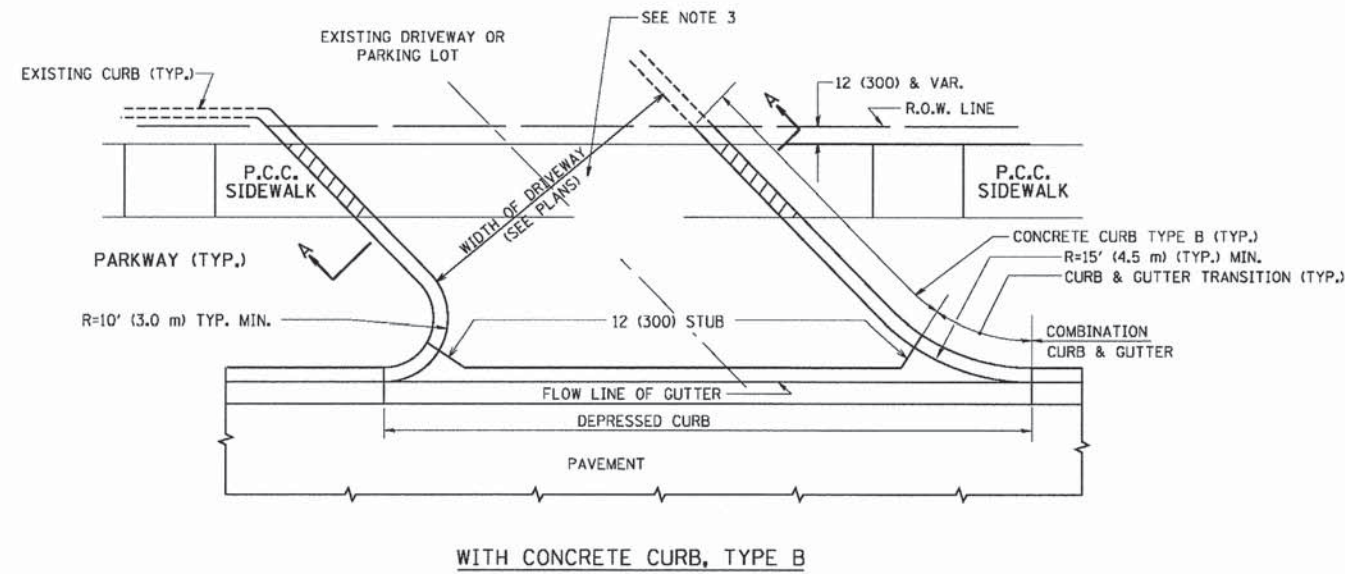
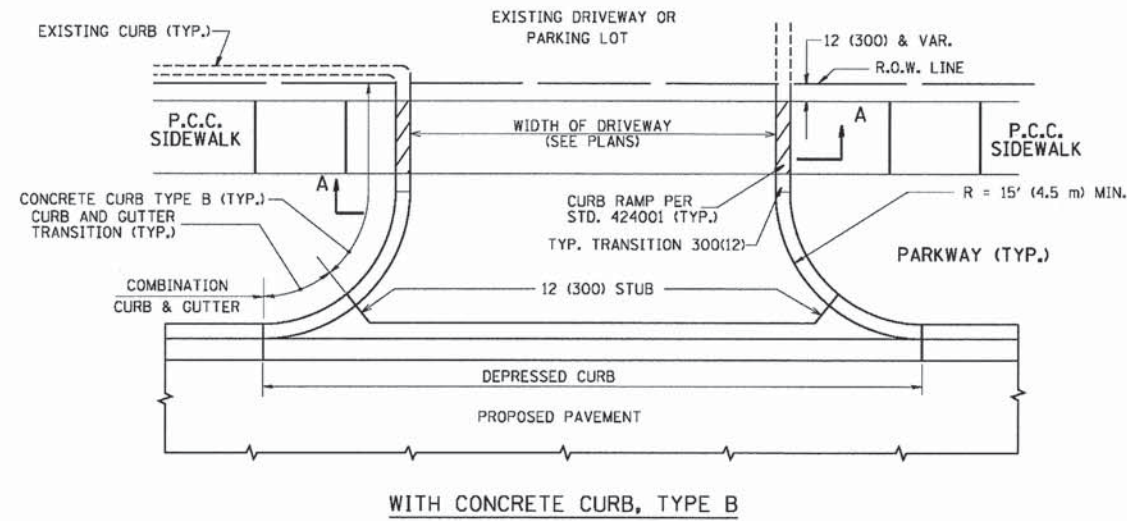

**GENERAL NOTES:**

DRIVEWAY SLOPES, LOCATIONS, & GEOMETRIC LAYOUT SHALL BE IN ACCORDANCE WITH THE LATEST EDITION OF THE "HANDBOOK FOR POLICY ON PERMITS FOR ACCESS DRIVEWAYS TO STATE HIGHWAYS". FOR FURTHER LAYOUT REQUIREMENTS, REFER TO ILLUSTRATIONS IN THE PERMIT HANDBOOK. DRIVEWAYS SHALL BE REPLACED IN KIND, UNLESS OTHERWISE NOTED ON THE PLANS.

COMMERCIAL DRIVEWAYS SHALL BE CONSTRUCTED WITH CONCRETE CURB, TYPE B RETURNS EXCEPT WHEN THE SIDEWALK EDGE IS 4 FEET (1.2 METERS) OR LESS FROM THE BACK OF CURB, CONSTRUCT A FLARE DRIVEWAY WITHOUT CURB.

THE RESIDENT ENGINEER SHALL CONTACT THE TRAFFIC PERMIT OFFICE AT 847/ 705-4131 FOR ANY QUESTIONS ON DRIVEWAYS SHOWN IN THE PLANS; SPECIFICALLY IN REFERENCE TO ADDITIONAL AND/OR RELOCATION/REMOVAL OF A DRIVEWAY.

COMBINATION CONCRETE CURB & GUTTER SHALL BE MEASURED STRAIGHT ACROSS THE DRIVEWAY. NO ADDITIONAL COMPENSATION WILL BE ALLOWED FOR THE CURB & GUTTER TRANSITION.

1 (25) PREFORMED EXPANSION JOINT FILLER WILL NOT BE PAID SEPARATELY, BUT SHALL BE CONSIDERED INCLUDED IN THE COST OF THE P.C.C. DRIVEWAY PAVEMENT OR P.C.C. SIDEWALK.

WHEN THE P.C.C. SIDEWALK EXTENDS THROUGH THE DRIVEWAY, THE THICKNESS OF THE SIDEWALK IN THE DRIVEWAY AREA SHALL BE THE SAME AS THE DRIVEWAY THICKNESS. SIDEWALK WILL BE PAID FOR AS P.C.C. SIDEWALK OF THE THICKNESS SPECIFIED. SIDEWALK CROSS SLOPE THRU DRIVEWAY AREA TO BE A MAXIMUM OF 1:50.

COPYRIGHT © 2014 BY BAXTER & WOODMAN, INC. ALL RIGHTS RESERVED. THIS DOCUMENT IS THE PROPERTY OF BAXTER & WOODMAN, INC. AND IS TO BE USED ONLY FOR THE PROJECT AND SITE SPECIFICALLY IDENTIFIED HEREIN. ANY REUSE OR DISTRIBUTION OF THIS DOCUMENT IS STRICTLY PROHIBITED.

|             |             |                    |                               |
|-------------|-------------|--------------------|-------------------------------|
| FILE NAME = | USER NAME = | DESIGNED - R. SHAH | REVISED - P. LOFLUER 04-15-03 |
| ...         | ...         | DRAWN -            | REVISED - R. BORO 01-01-07    |
| ...         | ...         | CHECKED -          | REVISED - R. BORO 06-11-08    |
| ...         | ...         | DATE - 11-04-95    | REVISED - R. BORO 09-06-11    |

**STATE OF ILLINOIS  
DEPARTMENT OF TRANSPORTATION**

| DRIVEWAY DETAILS - DISTANCE BETWEEN R.O.W. AND FACE OF CURB & EDGE OF SHOULDER >= 15' (4.5 m) |                         |      |         |
|---|-------------------------|------|---------|
| SCALE: NONE   | SHEET NO. 1 OF 1 SHEETS | STA. | TO STA. |

| F.A.U. RTE.                                     | SECTION        | COUNTY | TOTAL SHEETS | SHEET NO. |
|---|----------------|--------|--------------|-----------|
| 210   | 12-00035-00-RS | LAKE   | 17           | 10        |
| BD0156-07 (BD-01)                               |                |        | CONTRACT NO. |           |
| FED. ROAD DIST. NO. 1 ILLINOIS FED. AID PROJECT |                |        |              |           |



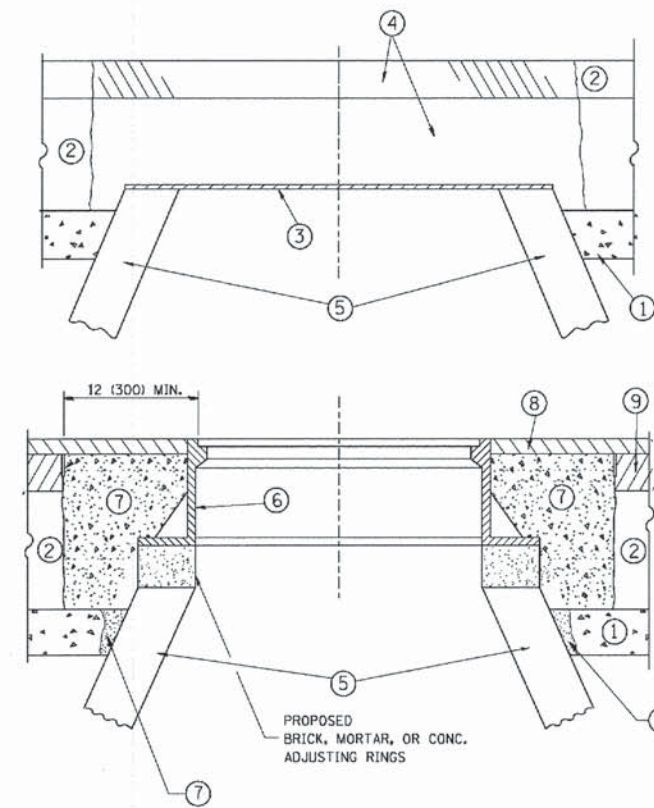

**CONSTRUCTION PROCEDURES**

**STAGE 1 (BEFORE PAVEMENT MILLING)**

- A) REMOVE A MINIMUM OF 12 (300) OF THE PAVEMENT FROM AROUND THE STRUCTURE.
- B) REMOVE THE EXISTING FRAME AND LID FROM THE STRUCTURE.
- C) COVER THE STRUCTURE OPENING WITH A 36 (900) DIAMETER METAL PLATE.
- D) BACKFILL WITH CRUSHED STONE AND A MINIMUM 1 1/2 (40) THICK HMA SURFACE MIX APPROVED BY THE ENGINEER.

**STAGE 2 (AFTER PAVEMENT MILLING)**

- A) REMOVE THE HMA SURFACE MIX AND CRUSHED STONE.
  - B) INSTALL THE FRAME AND LID; ADJUST THE FRAME TO ITS FINAL SURFACE ELEVATION.
  - C) THE SURROUNDING SPACE SHALL BE FILLED WITH CLASS PP-1# CONCRETE TO THE ELEVATION OF THE SURFACE OF THE EXISTING BASE COURSE OR THE BINDER COURSE.
- \* UNLESS OTHERWISE SPECIFIED IN THE PLANS.

THE PROCEDURE EXPLAINED ABOVE SHALL CONFORM TO THE APPLICABLE PORTIONS OF SECTIONS 353, 406, 602, AND 603 OF THE STANDARD SPECIFICATIONS EXCEPT THAT "THE CONTRACTOR SHALL ADJUST THE STRUCTURES TO THE FINISHED PAVEMENT ELEVATION NO MORE THAN 5 CALENDAR DAYS PRIOR TO PLACEMENT OF THE FINAL LIFT OF SURFACE UNLESS APPROVED BY THE ENGINEER."

**LEGEND**

- ① SUB-BASE GRANULAR MATERIAL
- ⑥ FRAME AND LID (SEE NOTES)
- ② EXISTING PAVEMENT
- ⑦ CLASS PP-1# CONCRETE
- ③ 36 (900) DIAMETER METAL PLATE
- ⑧ PROPOSED HMA SURFACE COURSE
- ④ PROPOSED CRUSHED STONE AND HMA SURFACE MIX
- ⑨ PROPOSED HMA BINDER COURSE
- ⑤ EXISTING STRUCTURE

**LOCATION OF STRUCTURES:**

THE CONTRACTOR WILL BE REQUIRED TO KEEP A RECORD OF THE LOCATIONS OF THE BURIED STRUCTURES ACCORDING TO THE STATION AND DISTANCE LEFT OR RIGHT OF THE CENTERLINE OF PAVEMENT. UPON COMPLETION OF THE WORK, THE CONTRACTOR WILL DELIVER THE RECORD TO THE ENGINEER.

**BASIS OF PAYMENT:**

REMOVING FRAMES AND LIDS ON DRAINAGE AND UTILITY STRUCTURES IN THE PAVEMENT PRIOR TO MILLING, AND ADJUSTING TO FINAL GRADE PRIOR TO PLACING THE SURFACE COURSE, WILL BE PAID FOR AT THE CONTRACT UNIT PRICE EACH FOR "FRAMES AND LIDS TO BE ADJUSTED (SPECIAL)."

THIS WORK WILL NOT BE PAID FOR WHEN DRAINAGE AND UTILITY STRUCTURES ARE SPECIFIED FOR PAYMENT AS STRUCTURE RECONSTRUCTION.

NEW FRAMES AND LIDS, WHEN SPECIFIED, WILL BE PAID FOR SEPARATELY.

**NOTES:**

EXISTING BROKEN FRAMES AND LIDS SHALL BE REMOVED AND DISPOSED OF BY THE CONTRACTOR AND SHALL BE REPLACED AS DIRECTED BY THE ENGINEER. REPLACEMENT FRAMES AND LIDS WILL BE PAID FOR IN ACCORDANCE WITH ARTICLE 109.04 OF THE STANDARD SPECIFICATIONS UNLESS A SEPARATE PAY ITEM HAS BEEN PROVIDED.

IF THE EXISTING LIDS ARE OPEN, THE FRAME WILL BE ADJUSTED TO THE ELEVATION OF THE MILLED PAVEMENT SURFACE PRIOR TO THE MILLING OPERATION. THE FRAME WILL NOT BE REMOVED AND COVERED BY THE METAL PLATE.

CITY OF CHICAGO CASTINGS ARE THE PROPERTY OF THE CITY AND THE CONTRACTOR SHALL NOTIFY THE CITY FOR REMOVAL AND DISPOSITION OF THE CASTINGS.

THE METAL PLATE USED TO COVER THE STRUCTURE SHALL REMAIN THE PROPERTY OF THE CONTRACTOR.

WHEN STRUCTURES ARE TO BE ADJUSTED OR RECONSTRUCTED, THE LOWERING AND RAISING OF THE FRAMES AND LIDS WILL NOT BE PAID FOR SEPARATELY BUT WILL BE INCLUDED IN THE COST OF THE CORRESPONDING PAY ITEM.

**DETAILS FOR FRAMES AND LIDS ADJUSTMENT WITH MILLING**

ALL DIMENSIONS ARE IN INCHES (MILLIMETERS) UNLESS OTHERWISE SHOWN

COPYRIGHT © 2004 BY BAXTER & BODDWIN, INC. ...  
 LICENSE NO. 184-00127 EXPIRES 7/30/2015  
 8/28/2014 3:45:10 PM

|                                |                     |                            |                                |
|--------------------------------|---------------------|----------------------------|--------------------------------|
| FILE NAME =                    | USER NAME = bauerdl | DESIGNED - R. SHAH         | REVISED - R. WIEDEMAN 05-14-04 |
| ...                            | ...                 | DRAWN -                    | REVISED - R. BORO 01-01-07     |
| PLOT SCALE = 1/648.50000 ' / m | CHECKED -           | REVISED - R. BORO 03-09-11 |                                |
| PLOT DATE = 12/6/2011          | DATE - 10-25-94     | REVISED - R. BORO 12-06-11 |                                |

**STATE OF ILLINOIS  
DEPARTMENT OF TRANSPORTATION**

| DETAILS FOR<br>FRAMES AND LIDS ADJUSTMENT WITH MILLING |                         |      |         |
|--|-------------------------|------|---------|
| SCALE: NONE  | SHEET NO. 1 OF 1 SHEETS | STA. | TO STA. |

| F.A.U. RTE.                                     | SECTION        | COUNTY | TOTAL SHEETS | SHEET NO. |
|---|----------------|--------|--------------|-----------|
| 210   | 12-00035-00-RS | LAKE   | 17           | 11        |
| BD600-03 (BD-8)                                 |                |        | CONTRACT NO. |           |
| FED. ROAD DIST. NO. 1 ILLINOIS FED. AID PROJECT |                |        |              |           |



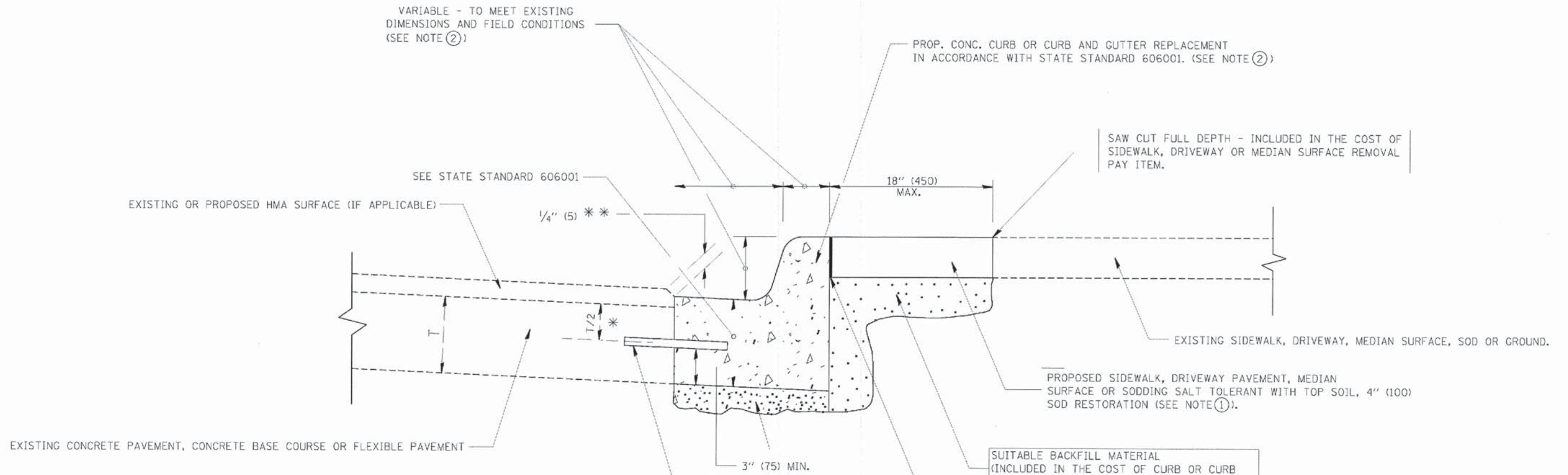

- \* 3" (75) MINIMUM FROM TOP AND BOTTOM OF THE CONCRETE PAVEMENT OR BASE COURSE.
  - \*\* IF THE FINAL SURFACE OF THE PAVEMENT IS CONCRETE, THE GUTTER IS TO BE FLUSH WITH THE PAVEMENT.
- NOTE: ① SIDEWALK, DRIVEWAY PAVEMENT OR MEDIAN SURFACE SHALL BE SIMILAR TO THE MATERIAL BEING REMOVED AND WILL BE PAID FOR SEPARATELY.  
SODDING, SALT TOLERANT AND TOP SOIL, FURNISH AND PLACE 4" WILL BE PAID FOR SEPARATELY.
- ② FERTILIZER FOR THE PLACEMENT OF THE SOD IS NOT REQUIRED
- ③ CURB OR CURB AND GUTTER REPLACEMENT SHALL MATCH THE SHAPE OF THE EXISTING CURB OR CURB AND GUTTER UNLESS OTHERWISE SPECIFIED.
- ④ FOR CURB OR CURB AND GUTTER REMOVAL AND REPLACEMENT ADJACENT TO FLEXIBLE PAVEMENT DELETE EPOXY COATED TIE BARS.
- ⑤ LONGITUDINAL BARS, IF ENCOUNTERED IN THE EXISTING CURB OR CURB AND GUTTER, ARE NOT TO BE REPLACED. CUTTING AND REMOVING LONGITUDINAL BARS SHALL BE INCLUDED IN THE COST OF CURB OR CURB AND GUTTER REMOVAL AND REPLACEMENT.
- ⑥ THE COST OF HMA SURFACE REMOVAL IN THE EXISTING GUTTER FLAG SHALL BE INCLUDED IN THE COST OF THE CURB AND GUTTER REMOVAL AND REPLACEMENT.
- ⑦ THE REMOVAL AND REPLACEMENT OF THE EXISTING CURB OR CURB AND GUTTER SHALL BE DONE IN ACCORDANCE WITH THE APPLICABLE PORTIONS OF SECTION 440 AND 606 OF THE STANDARD SPECIFICATIONS.
- ⑧ THE LOCATIONS OF REMOVAL AND REPLACEMENT OF EXISTING CURB OR CURB AND GUTTER SHALL BE DETERMINED BY THE RESIDENT ENGINEER AT THE TIME OF CONSTRUCTION.

SUITABLE BACKFILL MATERIAL (INCLUDED IN THE COST OF CURB OR CURB AND GUTTER REMOVAL AND REPLACEMENT)

PROPOSED 3/4" (20) PREFORMED EXPANSION JOINT AT CONCRETE SIDEWALKS, DRIVEWAYS, AND MEDIANS. (INCLUDED IN THE COST OF CURB OR CURB AND GUTTER REMOVAL AND REPLACEMENT.)

UNSUITABLE SUB-BASE MATERIAL TO BE REMOVED, IF DIRECTED BY THE ENGINEER, SHALL BE REPLACED WITH EITHER SUB-BASE GRANULAR MATERIAL, TYPE B OR ADDITIONAL THICKNESS OF CONCRETE.

REMOVAL AND REPLACEMENT 4" (100) OR LESS IS INCLUDED IN THE COST OF CURB OR CURB AND GUTTER REMOVAL AND REPLACEMENT.

REMOVAL AND REPLACEMENT IN EXCESS OF 4" (100) WILL BE PAID FOR IN ACCORDANCE WITH ARTICLE 109.04 OF THE STANDARD SPECIFICATIONS.

PROPOSED #6 (20) EPOXY COATED TIE BARS 24" (600) LONG AT 24" (600) CENTERS WILL NOT BE PAID FOR SEPARATELY. DELETE EPOXY COATED TIE BARS IF EXISTING TIE BARS ARE USUABLE AS DETERMINED BY THE ENGINEER. (SEE NOTE ③).

**BASIS OF PAYMENT:**  
THIS WORK WILL BE PAID FOR AT THE CONTRACT UNIT PRICE PER FOOT (METER) FOR "CURB REMOVAL AND REPLACEMENT" OR "COMBINATION CONCRETE CURB AND GUTTER REMOVAL AND REPLACEMENT".

## CURB OR CURB AND GUTTER REMOVAL AND REPLACEMENT

ALL DIMENSIONS ARE IN INCHES (MILLIMETERS) UNLESS OTHERWISE SHOWN.

COPYRIGHT © 2004 BY BAXTER & WOODMAN, INC.  
 LICENSE NO. 184-00021 - EXPIRES 7/30/2015  
 8/28/2014 3:45:25 PM I:\C\78101\06\A\RD\K\00345-Long Lake ST\CADD\000\SUBSTRUCT ONE DETAILS - BD.dgn

|   |  |   |  |   |
|---|--|---|--|---|
| DESIGNED - A. HOUSEH<br>DRAWN -<br>CHECKED -<br>DATE - 03-11-94 | REVISED - R. SHAH 10-03-96<br>REVISED - A. ABBAS 03-21-97<br>REVISED - M. GOMEZ 01-22-01<br>REVISED - R. BORO 12-15-09 | <b>STATE OF ILLINOIS</b><br><b>DEPARTMENT OF TRANSPORTATION</b> | <b>CURB OR CURB AND GUTTER</b><br><b>REMOVAL AND REPLACEMENT</b> | F.A.U. R.T.E. 210<br>SECTION 12-00035-00-RS<br>COUNTY LAKE<br>TOTAL SHEETS 17<br>SHEET NO. 12<br><b>BD600-06 (BD-24)</b><br>CONTRACT NO.<br>FED. ROAD DIST. NO. 1 ILLINOIS FED. AID PROJECT |
| PLCT DATE = 12/15/2009<br>DATE = 03-11-94                       |  |   | SCALE: NONE<br>SHEET NO. 1 OF 1 SHEETS<br>STA. TO STA.           |   |



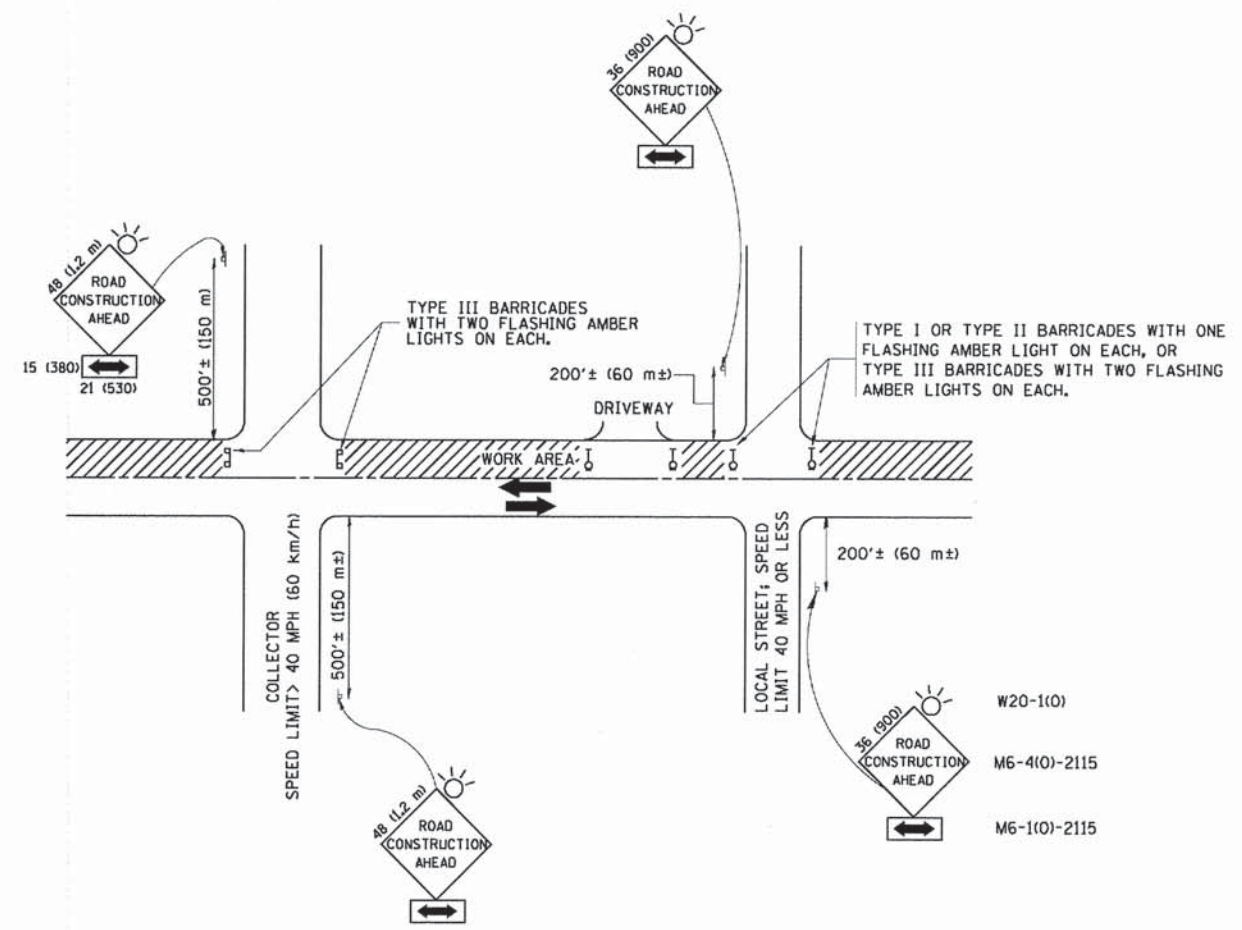

TRAFFIC CONTROL AND PROTECTION FOR SIDE ROADS, INTERSECTIONS, AND DRIVEWAYS

NOTES:

- A. FOR NO LANE RESTRICTION ON THE SIDE ROAD OR DRIVEWAYS
  1. SIDE ROAD WITH A SPEED LIMIT OF 40 MPH (60 km/h) OR LESS AS SHOWN ON THE DRAWING AND AS DIRECTED BY THE ENGINEER:
    - a) ONE ROAD CONSTRUCTION AHEAD SIGN 36 x 36 (900x900) WITH A FLASHER MOUNTED ON IT APPROXIMATELY 200' (60 m) IN ADVANCE OF THE MAIN ROUTE.
    - b) THE CLOSED PORTION OF THE MAIN ROUTE SHALL BE PROTECTED BY BLOCKING WITH TYPE I, TYPE II OR TYPE III BARRICADES, 1/3 OF THE CROSS SECTION OF THE CLOSED PORTION.
  2. SIDE ROAD WITH A SPEED LIMIT GREATER THAN 40 MPH (60 km/h) AS SHOWN ON THE DRAWING AND AS DIRECTED BY THE ENGINEER:
    - a) ONE ROAD CONSTRUCTION AHEAD SIGN 48 x 48 (1.2 m x 1.2 m) WITH A FLASHER MOUNTED ON IT APPROXIMATELY 500' (150 m) IN ADVANCE OF THE MAIN ROUTE.
    - b) THE CLOSED PORTION OF THE MAIN ROUTE SHALL BE PROTECTED BY BLOCKING WITH TYPE III BARRICADES, 1/2 OF THE CROSS SECTION OF THE CLOSED PORTION.
- 3. WHEN THE SIDE ROAD LIES BETWEEN THE BEGINNING OF THE MAINLINE SIGNING AND THE WORK ZONE, A SINGLE HEADED ARROW (M6-1) SHALL BE USED IN LIEU OF THE DOUBLE HEADED ARROW (M6-4).
- B. FOR A LANE CLOSURE ON A SIDE ROAD OR DRIVEWAY:
 

USE APPLICABLE PORTIONS OF THE TYPICAL APPLICATION OF TRAFFIC CONTROL DEVICES (STD. 701501, STD. 701606 OR THE APPROPRIATE STANDARD). THE SPACING OF SIGNS AND BARRICADES SHALL BE ADJUSTED FOR FIELD CONDITIONS AS DIRECTED BY THE ENGINEER. THE DIRECTIONAL ARROW SHALL BE COVERED OR REMOVED WHEN NO LONGER CONSISTENT WITH THE SIDE ROAD LANE CLOSURE.
- C. ADVANCE WARNING SIGNS ARE TO BE OMITTED ON DRIVEWAY UNLESS OTHERWISE NOTED.
- D. THE TRAFFIC CONTROL AND PROTECTION FOR SIDE ROADS, INTERSECTIONS, AND DRIVEWAYS SHALL BE INCIDENTAL TO THE COST OF SPECIFIED TRAFFIC CONTROL STANDARDS OR ITEMS.

All dimensions are in millimeters (inches) unless otherwise shown.

COPYRIGHT © 2016 BY BAXTER & WOODMAN, INC.  
 LICENSE NO. 184-00121 - EXPIRES 4/30/2015  
 FILE NAME: \\s01s01d\22x34\1\1010.dgn  
 USER NAME: gaglienabst  
 DESIGNED: LHA  
 DRAWN: A. HOUSEH  
 CHECKED: A. HOUSEH  
 DATE: 06-89  
 REVISED: J. OBERLE 10-18-95  
 REVISED: A. HOUSEH 03-06-96  
 REVISED: A. HOUSEH 10-15-96  
 REVISED: T. RAMMACHER 01-06-00

|                             |             |            |                       |
|-----------------------------|-------------|------------|-----------------------|
| FILE NAME =                 | USER NAME = | DESIGNED - | REVISED -             |
| W:\s01s01d\22x34\1\1010.dgn | gaglienabst | LHA        | J. OBERLE 10-18-95    |
|                             |             | DRAWN -    | REVISED -             |
|                             |             | A. HOUSEH  | A. HOUSEH 03-06-96    |
|                             |             | CHECKED -  | REVISED -             |
|                             |             | A. HOUSEH  | A. HOUSEH 10-15-96    |
|                             |             | DATE -     | REVISED -             |
|                             |             | 06-89      | T. RAMMACHER 01-06-00 |

STATE OF ILLINOIS  
DEPARTMENT OF TRANSPORTATION

TRAFFIC CONTROL AND PROTECTION FOR  
SIDE ROADS, INTERSECTIONS, AND DRIVEWAYS

SCALE: NONE SHEET NO. 1 OF 1 SHEETS STA. TO STA.

| F.A.U. RTE.                                       | SECTION        | COUNTY       | TOTAL SHEETS | SHEET NO. |
|---|----------------|--------------|--------------|-----------|
| 210   | 12-00035-00-RS | LAKE         | 17           | 13        |
| TC-10   |                | CONTRACT NO. |              |           |
| FED. ROAD DIST. NO. 1 [ILLINOIS] FED. AID PROJECT |                |              |              |           |







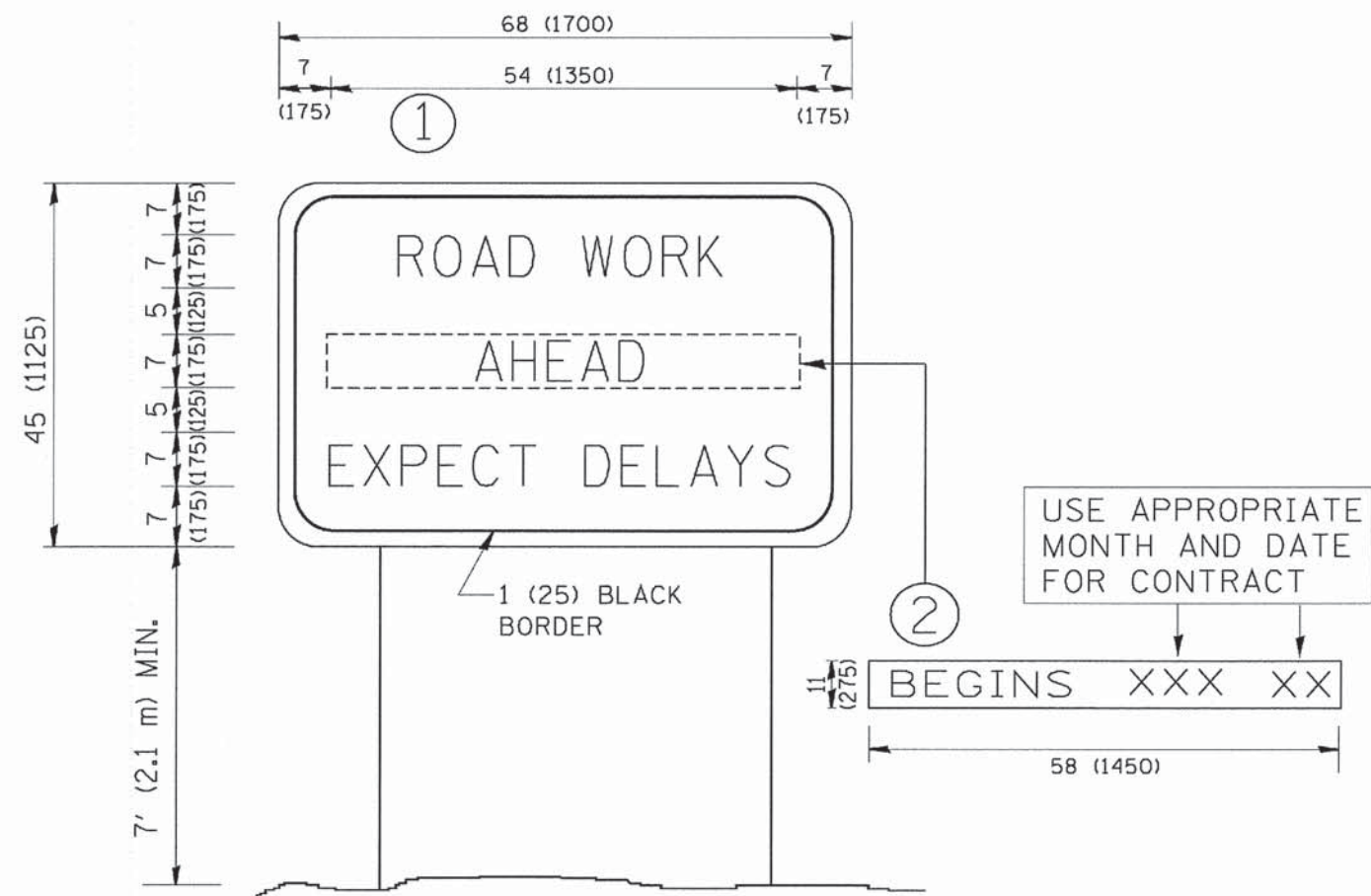

**NOTES:**

1. USE BLACK LETTERING ON ORANGE BACKGROUND.
2. ERECT SIGNS IN ADVANCE OF THE LOCATION FOR THE "ROAD CONSTRUCTION AHEAD" SIGN AT LOCATIONS AS DIRECTED BY THE ENGINEER.
3. ERECT SIGN ① WITH INSTALLED PANEL ② ONE WEEK PRIOR TO THE START OF CONSTRUCTION.
4. REMOVE PANEL ② SOON AFTER THE START OF CONSTRUCTION.
5. SEE SPECIAL PROVISION FOR "TEMPORARY INFORMATION SIGNING" FOR ADDITIONAL INFORMATION.
6. ONE SIGN ASSEMBLY EQUALS 25.70 SQ. FT. (2.3 SQ. M.)
7. SHALL BE PAID FOR AS TEMPORARY INFORMATION SIGNING.

ALL DIMENSIONS ARE IN INCHES (MILLIMETERS) UNLESS OTHERWISE SHOWN.

COPYRIGHT © 2004 BY BAXTER & WOODMAN, INC.  
 STATE OF ILLINOIS PROFESSIONAL DESIGN FIRM  
 5600 W. 111th Street, Suite 200, Oak Brook, IL 60452  
 8/28/2004 3:46:00 PM H:\C:\95101\WORK\1001\100145-Long Lake ST\CAD\DD\DISTRICT ONE DETAILS - TC.dgn

|  |                       |            |                                 |
|--|-----------------------|------------|---------------------------------|
| FILE NAME =<br>N:\disto\22x34\to22.dgn | USER NAME = gng1enobt | DESIGNED - | REVISED - R. MIRS 09-15-97      |
|  |                       | DRAWN -    | REVISED - R. MIRS 12-11-97      |
|  |                       | CHECKED -  | REVISED - T. RAMMACHER 02-02-99 |
|  |                       | DATE -     | REVISED - C. JUXTUS 01-31-07    |

**STATE OF ILLINOIS  
DEPARTMENT OF TRANSPORTATION**

|   |                                      |
|---|--------------------------------------|
| <b>ARTERIAL ROAD<br/>INFORMATION SIGN</b> |                                      |
| SCALE: NONE                               | SHEET NO. 1 OF 1 SHEETS STA. TO STA. |

|   |                           |                |                       |                    |
|---|---------------------------|----------------|-----------------------|--------------------|
| F.A.U.<br>RTE. 210                              | SECTION<br>12-00035-00-RS | COUNTY<br>LAKE | TOTAL<br>SHEETS<br>17 | SHEET<br>NO.<br>15 |
| <b>TC-22</b>                                    |                           |                | CONTRACT NO.          |                    |
| FED. ROAD DIST. NO. 1 ILLINOIS FED. AID PROJECT |                           |                |                       |                    |



COPYRIGHT © 2014 BY BAXTER & WOODMAN, INC.  
 STATE OF ILLINOIS - PROFESSIONAL DESIGN FIRM  
 LICENSE NO. 184-00027 - EXPIRES 4/30/2015  
 1800 S. WASHINGTON AVE. SUITE 200  
 DECATUR, IL 62521-3400  
 PROJECT: 12-00035-00-RS  
 SHEET: 17 OF 16

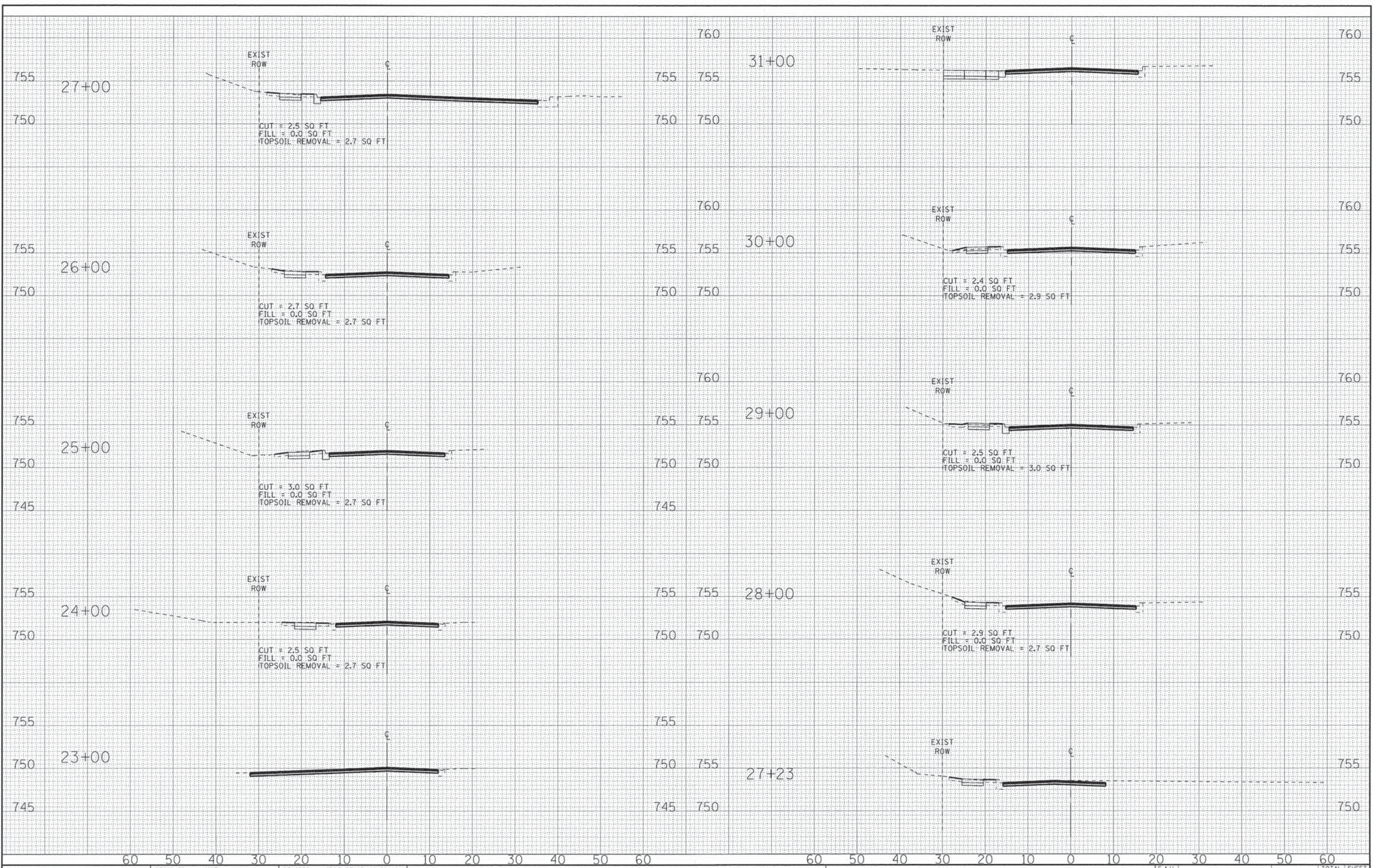

|                 |                               |
|-----------------|-------------------------------|
| DESIGNED - MWP  | REVISED - IDOT REVIEW 8-28-14 |
| DRAWN - KAR     | REVISED -                     |
| CHECKED - TMS   | REVISED -                     |
| DATE - 06-16-14 | REVISED -                     |

STATE OF ILLINOIS  
DEPARTMENT OF TRANSPORTATION

**CROSS SECTIONS  
LONG LAKE DRIVE**

SCALE: H: 1"=10' V: 1"=5'

STA. 23+00 TO STA. 31+00

|                     |                        |             |                           |              |
|---------------------|------------------------|-------------|---------------------------|--------------|
| F.A.J. RTE. 210     | SECTION 12-00035-00-RS | COUNTY LAKE | TOTAL SHEETS 17           | SHEET NO. 16 |
| FED. ROAD DIST. NO. |                        |             | ILLINOIS FED. AID PROJECT |              |



COPYRIGHT © 2013 BY BAXTER & WOODMAN, INC.  
 STATE OF ILLINOIS - PROFESSIONAL DESIGN FIRM  
 LICENSE NO. 184-0028 - EXPIRES 3/31/2015  
 I:\Crystal Lake\1001\1001045-Long Lake STA. 32+00\001\001.dwg - xsec - Long.dwg  
 8/28/2014 3:41:02 PM

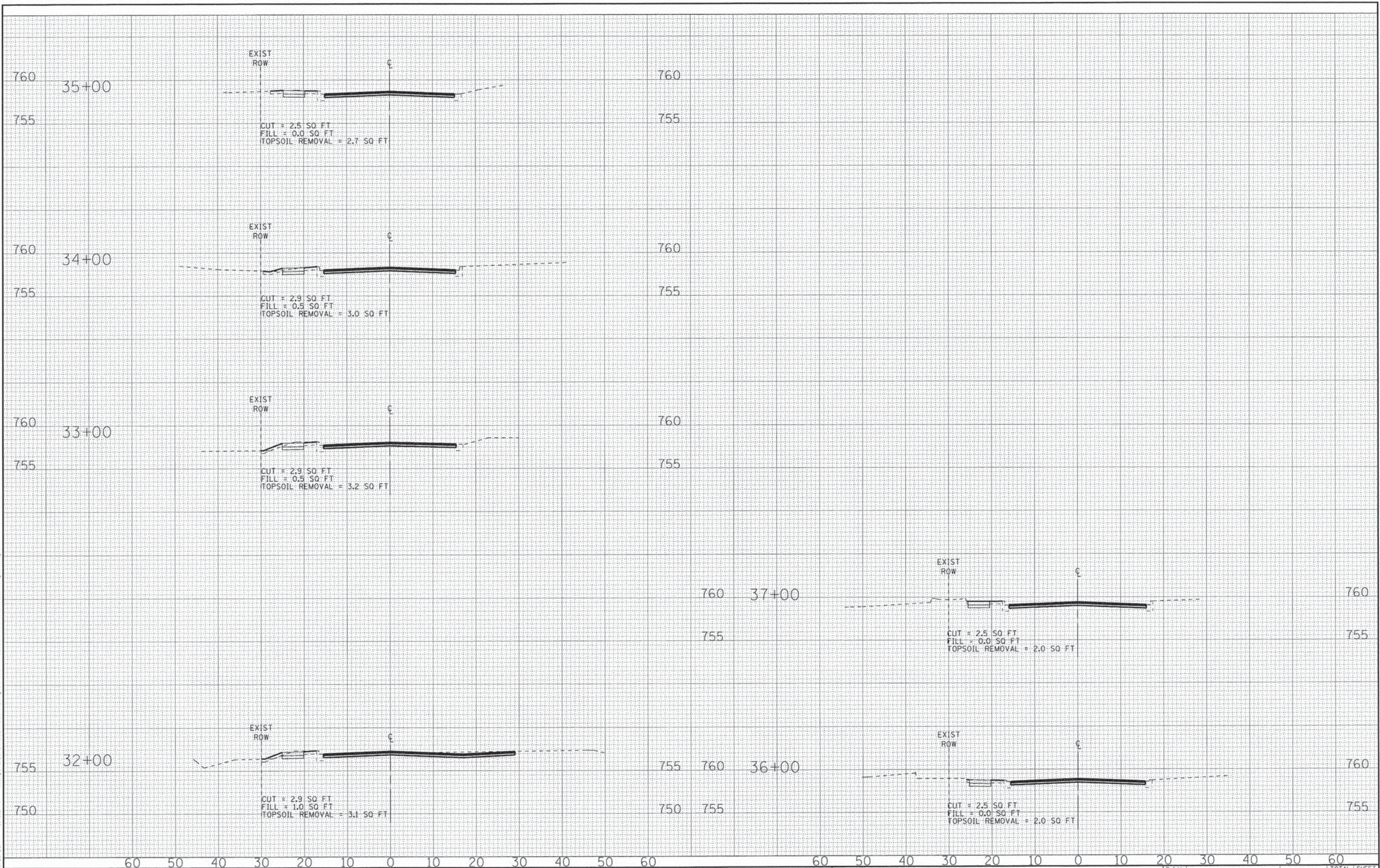

**BAXTER & WOODMAN**  
Consulting Engineers

|                 |                               |
|-----------------|-------------------------------|
| DESIGNED - MWP  | REVISED - IDOT REVIEW 8-28-14 |
| DRAWN - KAR     | REVISED -                     |
| CHECKED - TMS   | REVISED -                     |
| DATE - 06-16-14 | REVISED -                     |

STATE OF ILLINOIS  
DEPARTMENT OF TRANSPORTATION

**CROSS SECTIONS  
LONG LAKE DRIVE**  
SCALE: H: 1"=10' V: 1"=5'  
STA. 32+00 TO STA. 37+00

| F.A.U. RTE.         | SECTION        | COUNTY | TOTAL SHEETS              | SHEET NO. |
|---------------------|----------------|--------|---------------------------|-----------|
| 210                 | 12-00035-00-R5 | LAKE   | 17                        | 17        |
| CONTRACT NO.        |                |        |                           |           |
| FED. ROAD DIST. NO. |                |        | ILLINOIS FED. AID PROJECT |           |