

CONSTRUCTION PLANS

REHABILITATE AIRFIELD PAVEMENTS WITH CRACK CLEANING AND SEALING (MAINTENANCE)

LITCHFIELD AIRPORT AUTHORITY
LITCHFIELD MUNICIPAL AIRPORT (3LF)
LITCHFIELD, MONTGOMERY COUNTY, ILLINOIS

SBG PROJECT NO. 3-17-SBGP-111
IDA PROJECT NO. 3LF - 4318

LITCHFIELD MUNICIPAL AIRPORT

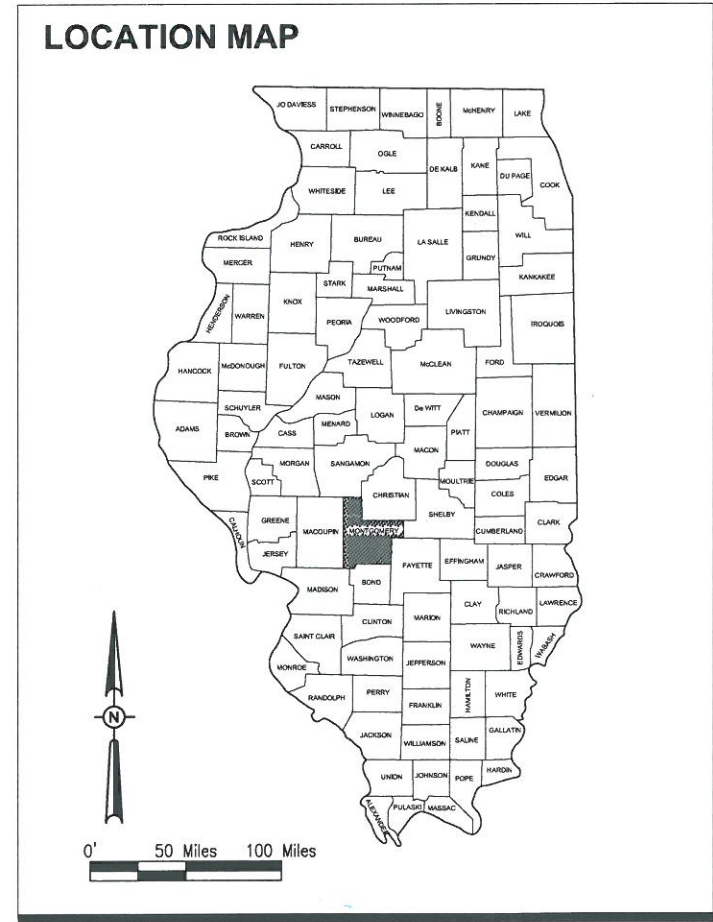
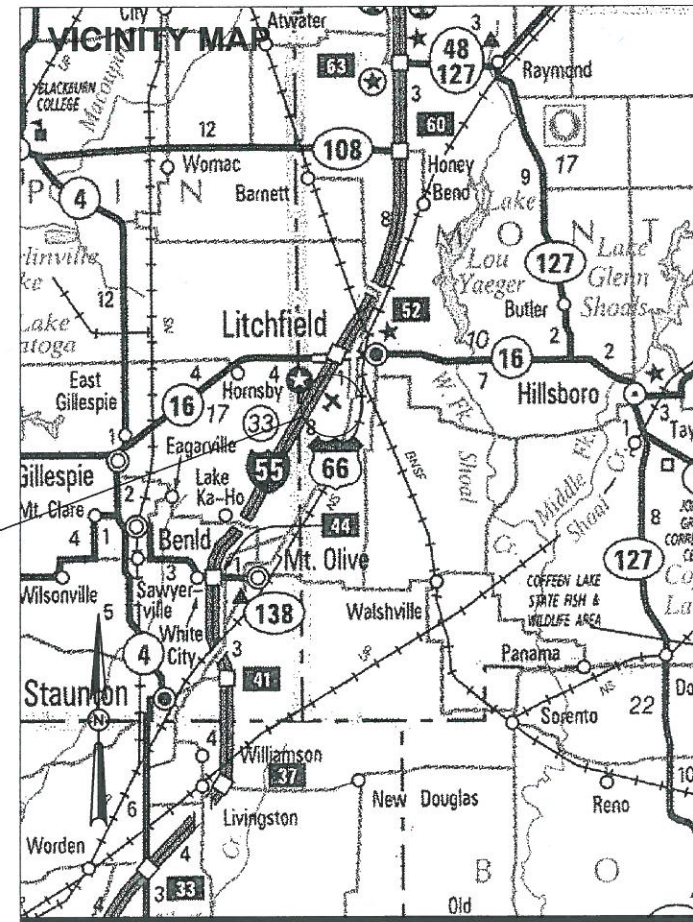

NOTICE TO CONTRACTORS AND BIDDERS

THESE CONSTRUCTION PLANS RELY UPON THE SPECIAL PROVISIONS AND THE SPECIFICATIONS TO PROVIDE FOR A COMPLETE DESCRIPTION OF THE WORK AND CONSTRUCTION REQUIREMENTS. THE PLANS SHALL ONLY BE USED IN COMBINATION WITH ALL CONTRACT DOCUMENTS.

No.	Issue/Description	Sheets Changed	Date	By



Charles A. Hagloch
Charles A. Hagloch, P.E.
Project Engineer

December 3, 2014

February 4, 2015
Date



HANSON PROFESSIONAL SERVICES INC.
1525 South Sixth Street
Springfield, Illinois 62703
Telephone: 217.788.2450
Fax: 217.788.2503

Robert A. Waller
Robert A. Waller, P.E.
Project Manager

February 4, 2015
Date

LITCHFIELD AIRPORT AUTHORITY
1201 US Route 88 South
P.O. Box 381
Litchfield, Illinois 62456

William Fleming
William Fleming,
Chairman

12-03-14
Date

SUMMARY OF QUANTITIES - BASE BID				
ITEM NO.	DESCRIPTION	UNIT	TOTAL QUANTITY	AS-BUILT QUANTITY
AR150520	MOBILIZATION	L.S.	1	
AR201661	CLEAN & SEAL BITUMINOUS CRACKS	L.F.	33,224	
SUMMARY OF QUANTITIES - ADDITIVE ALTERNATE NO. 1				
AS201661	CLEAN & SEAL BITUMINOUS CRACKS	L.F.	3,936	
SUMMARY OF QUANTITIES - ADDITIVE ALTERNATE NO. 2				
AT201661	CLEAN & SEAL BITUMINOUS CRACKS	L.F.	3,902	
SUMMARY OF QUANTITIES - ADDITIVE ALTERNATE NO. 3				
AU201661	CLEAN & SEAL BITUMINOUS CRACKS	L.F.	3,859	

INDEX TO SHEETS	
SHEET NO.	DESCRIPTION
1	COVER SHEET
2	SUMMARY OF QUANTITIES AND INDEX TO SHEETS
3	PROPOSED SAFETY PLAN
4	PROPOSED CONSTRUCTION PLAN RUNWAY 18-36 STA. 0+00 TO STA. 27+00
5	PROPOSED CONSTRUCTION PLAN RUNWAY 18-36 STA. 27+00 TO STA. 40+00
6	PROPOSED CONSTRUCTION PLAN RUNWAY 9-27 STA. 0+00 TO STA. 28+00
7	PROPOSED CONSTRUCTION PLAN RUNWAY 9-27 STA. 28+00 TO STA. 39+00
8	PROPOSED CONSTRUCTION PLAN FRONTAL AREA

CERTIFIED PAYROLLS

THE RESIDENT ENGINEER CANNOT FORWARD CONSTRUCTION REPORTS TO THE ILLINOIS DIVISION OF AERONAUTICS FOR PROCESSING UNTIL ALL CERTIFIED PAYROLLS FOR THE PERIOD HAVE BEEN RECEIVED.

MATERIAL CERTIFICATION

MATERIAL TO BE INCORPORATED INTO THE PROJECT CANNOT BE USED WITHOUT PRIOR APPROVAL. ALL MATERIAL TO BE USED IN THE PROJECT MUST BE SUBMITTED TO THE RESIDENT ENGINEER FOR APPROVAL. USE OF MATERIAL WITHOUT PRIOR APPROVAL AND ULTIMATELY DETERMINED TO BE UNACCEPTABLE BY THE ILLINOIS DIVISION OF AERONAUTICS ARE SUBJECT TO REMOVAL AND/OR NON-PAYMENT.

REHABILITATE AIRFIELD PAVEMENTS

IDA No: 3LF-4318

Contract No. LI035

NO.	DATE	DESCRIPTION		
		DES	DWN	REV
1	02/02/15	IDA REVIEW	CAH	CAH

ISSUE: DECEMBER 3, 2014
PROJECT NO: 13A0068D
CAD FILE: G-002-SOQ.DWG
DESIGNED BY: CAH 10/22/14
DRAWN BY: CAH 10/22/14
REVIEWED BY: BSS 12/02/14

SHEET TITLE

SHEET INDEX AND SUMMARY OF QUANTITIES

UTILITY NOTE

THE LOCATION, SIZE, AND TYPE OF MATERIAL OF EXISTING UNDERGROUND AND/OR ABOVEGROUND UTILITIES INDICATED ON THE PLANS ARE NOT REPRESENTED AS BEING ACCURATE, SUFFICIENT OR COMPLETE. NEITHER THE OWNER NOR THE ENGINEER ASSUMES ANY RESPONSIBILITY WHATSOEVER IN RESPECT TO THE ACCURACY, COMPLETENESS, OR SUFFICIENCY OF THE INFORMATION. THERE IS NO GUARANTEE, EITHER EXPRESSED OR IMPLIED, THAT THE LOCATIONS, SIZE AND TYPE OF MATERIAL OF EXISTING UNDERGROUND UTILITIES INDICATED ARE REPRESENTATIVE OF THOSE TO BE ENCOUNTERED IN THE CONSTRUCTION. IT SHALL BE THE CONTRACTOR'S RESPONSIBILITY TO DETERMINE THE ACTUAL LOCATION OF ALL SUCH FACILITIES, INCLUDING SERVICE CONNECTIONS TO UNDERGROUND UTILITIES. PRIOR TO CONSTRUCTION, THE CONTRACTOR SHALL NOTIFY THE UTILITY COMPANIES OF HIS OPERATIONAL PLANS AND SHALL OBTAIN FROM THE RESPECTIVE UTILITY COMPANIES DETAILED INFORMATION AND ASSISTANCE RELATIVE TO THE LOCATION OF THEIR FACILITIES AND THE WORKING SCHEDULE OF THE COMPANIES FOR REMOVAL OR ADJUSTMENT WHERE REQUIRED. IN THE EVENT AN UNEXPECTED UTILITY INTERFERENCE IS ENCOUNTERED DURING CONSTRUCTION, THE CONTRACTOR SHALL IMMEDIATELY NOTIFY THE UTILITY COMPANY OF JURISDICTION. THE OWNER'S REPRESENTATIVE AND/OR THE RESIDENT ENGINEER SHALL ALSO BE IMMEDIATELY NOTIFIED. ANY DAMAGE TO SUCH MAINS AND SERVICES SHALL BE RESTORED TO SERVICE AT ONCE AND PAID FOR BY THE CONTRACTOR AT NO ADDITIONAL COST TO THE CONTRACT. ALL UTILITY CABLES AND LINES SHALL BE LOCATED BY THE RESPECTIVE UTILITY. **CONTACT JULIE (JOINT UTILITY LOCATION INFORMATION FOR EXCAVATORS) FOR UTILITY INFORMATION, PHONE: 1-800-892-0123.** CONTACT THE FAA (FEDERAL AVIATION ADMINISTRATION) FOR ASSISTANCE IN LOCATING FAA CABLES AND UTILITIES. LOCATION OF FAA POWER, CONTROL, AND COMMUNICATION CABLES SHALL BE COORDINATED WITH AND/OR LOCATED BY THE FAA. ALSO CONTACT AIRPORT DIRECTOR/MANAGER AND AIRPORT PERSONNEL FOR ASSISTANCE IN LOCATING UNDERGROUND AIRPORT CABLES AND/OR UTILITIES. ALSO COORDINATE WORK WITH ALL ABOVEGROUND UTILITIES.







HAUL ROUTE AND VEHICLE PARKING

THE CONTRACTOR WILL USE THE DESIGNATED HAUL ROUTE AND PARKING AREA AS SHOWN ON THIS SHEET. THE PROPOSED PARKING AREA WILL BE 100' X 100'. THE CONTRACTOR WILL BE REQUIRED TO MAINTAIN THE PROPOSED HAUL ROUTE AND PARKING AREA THROUGHOUT THE COURSE OF THE PROJECT. ANY AREAS DAMAGED OUTSIDE OF THESE AREAS WILL BE REPAIRED BY THE CONTRACTOR AND AT THE CONTRACTOR'S OWN EXPENSE. AT THE CONCLUSION OF THE PROJECT THE CONTRACTOR WILL RESTORE THE HAUL ROUTE AND PARKING AREA TO THEIR ORIGINAL STATE. RESTORATION OF THE HAUL ROUTE AND PARKING AREA WILL BE CONSIDERED INCIDENTAL TO THE PROJECT AND NO ADDITIONAL COMPENSATION WILL BE ALLOWED.

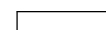
CONTRACTOR RESPONSIBILITIES

1. THE CONTRACTOR'S EQUIPMENT PARKING AND STORAGE AREA WILL BE AS SHOWN ON THIS SHEET. THE CONTRACTOR'S EMPLOYEES WILL PARK THEIR VEHICLES IN THIS AREA. ONLY CONTRACTOR VEHICLES WILL BE ALLOWED OUTSIDE THIS AREA.
2. THE CONTRACTOR AND HIS EMPLOYEES WILL BE RESTRICTED TO THE WORK AREA AND ALL OTHER AREAS OF THE AIRPORT ARE "OFF LIMITS" TO THEM.
3. THE CONTRACTOR SHALL KEEP ONE RUNWAY OPEN AT ALL TIMES AND MAINTAIN CONTINUOUS TAXIWAY ACCESS FROM THE ACTIVE RUNWAY TO THE AIRCRAFT PARKING APRON.
4. ALL WORK PERFORMED SHALL BE DONE IN A ORDERLY AND EFFECTIVE MANNER TO MINIMIZE RUNWAY CLOSURE.
5. NO TRENCHES OR HOLES WILL REMAIN OPEN OVERNIGHT.
6. NO RUNWAY SHALL BE CLOSED OVERNIGHT.

LEGEND

-  EXISTING IMPROVEMENTS
-  EXISTING BUILDINGS
-  PROPOSED HAUL ROUTE AND EQUIPMENT PARKING AREA
-  PROPOSED BARRICADES WHEN RUNWAY 9-27 IS CLOSED
-  PROPOSED BARRICADES WHEN RUNWAY 18-36 IS CLOSED
-  PROPOSED BARRICADES WHEN TAXIWAY "B" ONLY IS CLOSED

SCOPE OF WORK

THIS PROJECT CONSISTS OF THE CLEANING AND SEALING OF BITUMINOUS CRACKS ON RUNWAY 9-27, RUNWAY 18-36, TAXIWAYS "B", "C", "C1", AIRCRAFT PARKING APRON AND THE T-HANGAR AREA.

AIRPORT SECURITY NOTE

AIRPORT SECURITY WILL BE MAINTAINED AT ALL TIMES. THE CONTRACTOR WILL CLOSE AND LOCK THE EXISTING GATE IN THE HAUL ROUTE AT THE END OF EACH WORKING DAY.

HEIGHT OF CONSTRUCTION EQUIPMENT

THE MAXIMUM ANTICIPATED HEIGHT OF THE CONSTRUCTION EQUIPMENT WILL BE 20 FEET. THE TALLEST EQUIPMENT IS EXPECTED TO BE A STRAIGHT TRUCK.

NOTE

1. ALL CONSTRUCTION/OPERATIONS ARE TO BE PERFORMED IN ACCORDANCE WITH FAA ADVISORY CIRCULAR (AC) 150/5370-2F "OPERATIONAL SAFETY ON AIRPORTS DURING CONSTRUCTION" AND AC 150/5300-13A "AIRPORT DESIGN".
2. ALL CONSTRUCTION EQUIPMENT ON THE AIRPORT SHALL BE MARKED, LIGHTED AND/OR FLAGGED IN ACCORDANCE WITH AC 150/5210-5 AND 70/7460-1.

CRITICAL POINT DATA

- | | |
|---|---|
| NO. 1
LATITUDE: 39° 09' 58.36"
LONGITUDE: 89° 40' 20.56"
ELEVATION: 688.6 M.S.L. | NO. 5
LATITUDE: 39° 09' 58.69"
LONGITUDE: 89° 40' 10.85"
ELEVATION: 687.1 M.S.L. |
| NO. 2
LATITUDE: 39° 10' 02.11"
LONGITUDE: 89° 40' 20.58"
ELEVATION: 690.0 M.S.L. | NO. 6
LATITUDE: 39° 09' 50.43"
LONGITUDE: 89° 40' 12.43"
ELEVATION: 684.3 M.S.L. |
| NO. 3
LATITUDE: 39° 10' 01.25"
LONGITUDE: 89° 40' 41.72"
ELEVATION: 683.9 M.S.L. | NO. 7
LATITUDE: 39° 09' 57.70"
LONGITUDE: 89° 40' 08.26"
ELEVATION: 686.0 M.S.L. |
| NO. 4
LATITUDE: 39° 09' 58.53"
LONGITUDE: 89° 40' 15.81"
ELEVATION: 687.3 M.S.L. | NO. 8
LATITUDE: 39° 09' 54.42"
LONGITUDE: 89° 40' 14.62"
ELEVATION: 685.3 M.S.L. |

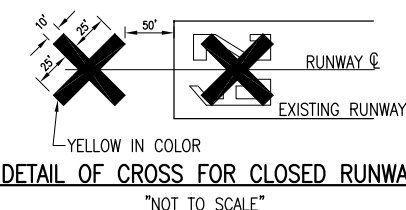

NOTE:

COST OF CONSTRUCTING, PLACING, MAINTAINING AND REMOVING CROSSES WILL BE CONSIDERED INCIDENTAL TO THE CONTRACT AND NO ADDITIONAL COMPENSATION WILL BE ALLOWED. THE CROSSES WILL BE YELLOW IN COLOR AND SHALL BE MADE OF A SUITABLE MATERIAL AS APPROVED BY THE AIRPORT MANAGER. THE CROSSES WILL BE PLACED OVER THE NUMERALS AND SECURED IN A MANNER APPROVED BY THE MANAGER. THE PROPOSED CROSSES WILL BE PLACED EACH DAY THE RUNWAY IS CLOSED AND REMOVED WHEN THE RUNWAY IS RE-OPENED. THE CONTRACTOR WILL BE RESPONSIBLE FOR THE PLACEMENT AND REMOVAL OF THE CROSSES. NO ADDITIONAL COMPENSATION WILL BE ALLOWED.

J.U.L.I.E. INFORMATION

COUNTY _____ MONTGOMERY
CITY _____ LITCHFIELD
TOWNSHIP _____ SOUTH LITCHFIELD
SECTION NO. _____ 5 & 8
ADDRESS _____ LITCHFIELD MUNICIPAL AIRPORT
P.O. BOX 381
US ROUTE 66
LITCHFIELD, IL 62056

PROPOSED SAFETY PLAN

1. GENERAL - THE LITCHFIELD MUNICIPAL AIRPORT IS COMPRISED OF A 3,900 FT. BY 75 FT. EAST-WEST (9-27) RUNWAY AND A 4,000 FT. BY 75 FT. NORTH-SOUTH (18-36) RUNWAY. THE PROPOSED CONSTRUCTION WILL NECESSITATE CLOSING BOTH RUNWAYS. ANY TIME THE CONTRACTOR IS WORKING WITHIN 125' OF THE RUNWAY CENTERLINE THE RUNWAY WILL BE CLOSED. THE RUNWAY WILL BE CLOSED ONLY DURING THE CONSTRUCTION DAY. AT THE END OF EACH CONSTRUCTION DAY THE CONTRACTOR WILL SMOOTH GRADE ALL AREAS WITHIN THE SAFETY AREA TO THE SATISFACTION OF THE RESIDENT ENGINEER AND RE-OPEN THE RUNWAY. ALL WORK INCLUDED IN OPENING AND CLOSING THE RUNWAY WILL BE CONSIDERED INCIDENTAL TO THE PROJECT AND NO ADDITIONAL COMPENSATION WILL BE ALLOWED.
2. IDENTIFICATION - WHEN THE CONTRACTORS VEHICLES AND EQUIPMENT ARE ON THE AIRPORT THEY SHALL BE PROPERLY MARKED WITH THREE (3') FOOT SQUARE CHECKERED FLAGS (INTERNATIONAL ORANGE AND WHITE). THE CONTRACTOR WILL ALSO PROVIDE WORKERS WITH SOME TYPE OF TAG OR GARMENT TO IDENTIFY THE PERSON AS BEING PART OF THE CONSTRUCTION CREW.
3. RADIO CONTROL - THE CONTRACTOR WILL BE REQUIRED TO BE IN TWO-WAY RADIO CONTACT (122.8 MHz.) WITH THE AIRPORT UNICOM. THIS WILL KEEP THE CONTRACTOR IN CONSTANT CONTACT WITH THE LITCHFIELD MUNICIPAL AIRPORT AND ENABLE THE AIRPORT TO IMMEDIATELY CONTACT THE CONTRACTOR IN CASE OF AN AERONAUTIC EMERGENCY THAT WOULD REQUIRE ACTION BY THE CONTRACTOR AND/OR HIS PERSONNEL.

EROSION CONTROL

THIS PROJECT WILL DISTURB LESS THAN 1 ACRE OF LAND, THEREFORE NO N.P.D.E.S. PERMIT WILL BE REQUIRED.

BARRICADES AND TRAFFIC CONES

IT WILL BE THE CONTRACTOR'S RESPONSIBILITY TO PLACE AND MAINTAIN BARRICADES AND TRAFFIC CONES AS SHOWN OR AS DIRECTED BY THE AIRPORT MANAGER. THE BARRICADES WILL BE EQUIPPED WITH RED FLASHING OR RED STEADY-BURN LIGHTS AND 20" SQUARE ORANGE FLAGS. THE BARRICADES, THEIR MAINTENANCE, PLACEMENT AND REMOVAL WILL BE CONSIDERED AS AN INCIDENTAL ITEM TO THE CONTRACT AND NO ADDITIONAL COMPENSATION WILL BE ALLOWED.

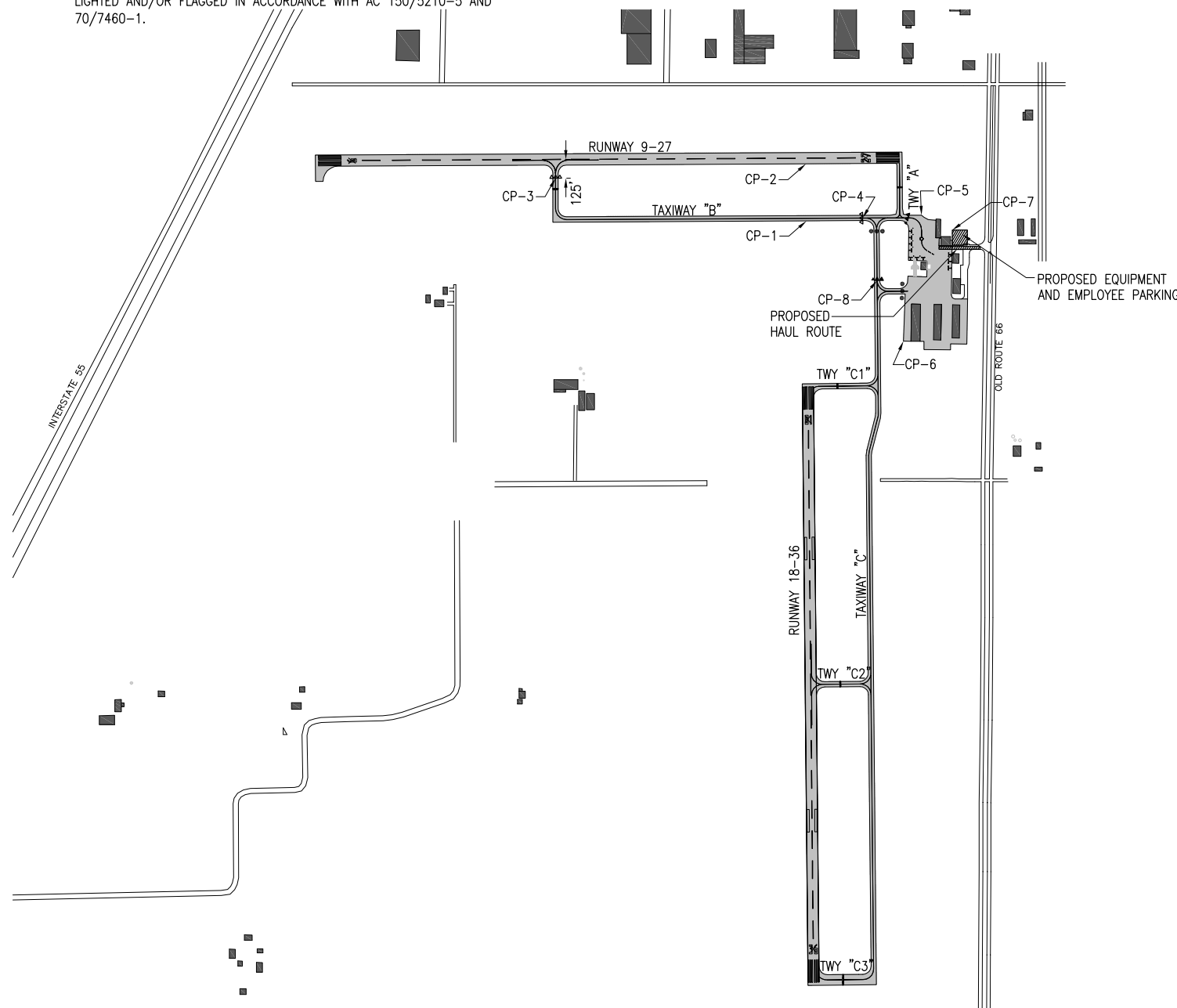

REHABILITATE AIRFIELD PAVEMENTS

IDA No: 3LF-4318

Contract No. LI035

NO.	DATE	DESCRIPTION		
		DES	DWN	REV
1	02/02/15	CAH	CAH	CAH

ISSUE: DECEMBER 3, 2014
PROJECT NO: 13A0068D
CAD FILE: G-003-SFY.DWG
DESIGNED BY: CAH 10/09/2014
DRAWN BY: CAH 10/09/2014
REVIEWED BY: BSS 12/02/2014

SHEET TITLE

PROPOSED SAFETY PLAN

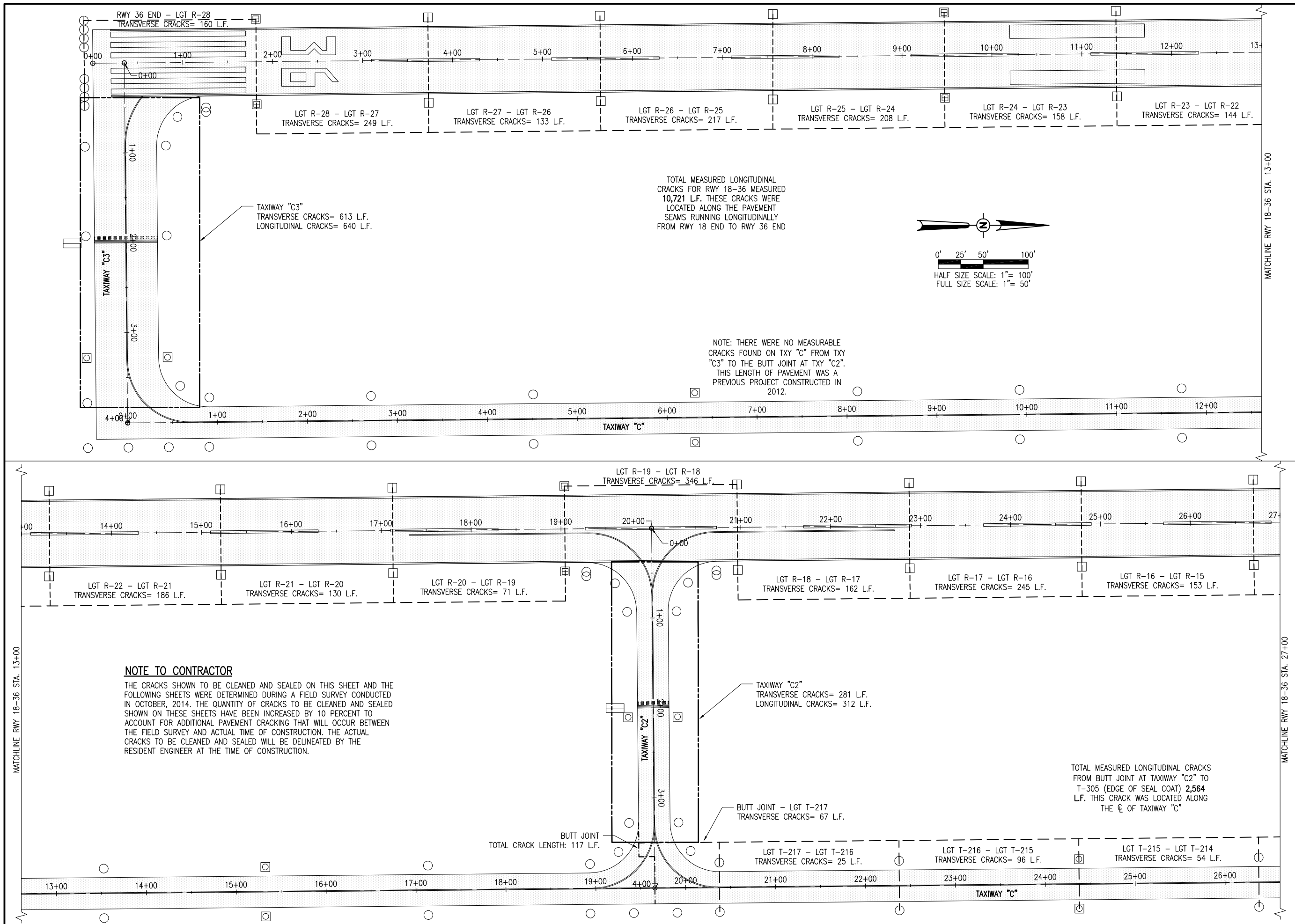

TOTAL MEASURED LONGITUDINAL CRACKS FOR RWY 18-36 MEASURED 10,721 L.F. THESE CRACKS WERE LOCATED ALONG THE PAVEMENT SEAMS RUNNING LONGITUDINALLY FROM RWY 18 END TO RWY 36 END

NOTE: THERE WERE NO MEASURABLE CRACKS FOUND ON TXY "C" FROM TXY "C3" TO THE BUTT JOINT AT TXY "C2". THIS LENGTH OF PAVEMENT WAS A PREVIOUS PROJECT CONSTRUCTED IN 2012.

TOTAL MEASURED LONGITUDINAL CRACKS FROM BUTT JOINT AT TAXIWAY "C2" TO T-305 (EDGE OF SEAL COAT) 2,564 L.F. THIS CRACK WAS LOCATED ALONG THE CL OF TAXIWAY "C"

REHABILITATE AIRFIELD PAVEMENTS

IDA No: 3LF-4318

Contract No. LI035

NO.	DATE	DESCRIPTION		
		DES	DWN	REV
1	02/03/15	IDA REVIEW	CAH	CAH

ISSUE: DECEMBER 3, 2014
PROJECT NO: 13A0068D
CAD FILE: C-100-PLAN.DWG
DESIGNED BY: BCT 11/07/2014
DRAWN BY: BCT 11/07/2014
REVIEWED BY: BSS 12/02/2014

SHEET TITLE

PROPOSED CONSTRUCTION PLAN
RUNWAY 18-36
STA. 0+00 TO STA. 27+00

REHABILITATE
AIRFIELD PAVEMENTS

IDA No: 3LF-4318

Contract No. LI035

NO.	DATE	DESCRIPTION		
		DES	DWN	REV

ISSUE: DECEMBER 3, 2014
PROJECT NO: 13A0068D
CAD FILE: C-100-PLAN.DWG
DESIGNED BY: BCT 11/07/2014
DRAWN BY: BCT 11/07/2014
REVIEWED BY: BSS 12/02/2014

SHEET TITLE

PROPOSED
CONSTRUCTION PLAN
RUNWAY 18-36 STA.
27+00 TO STA. 40+00

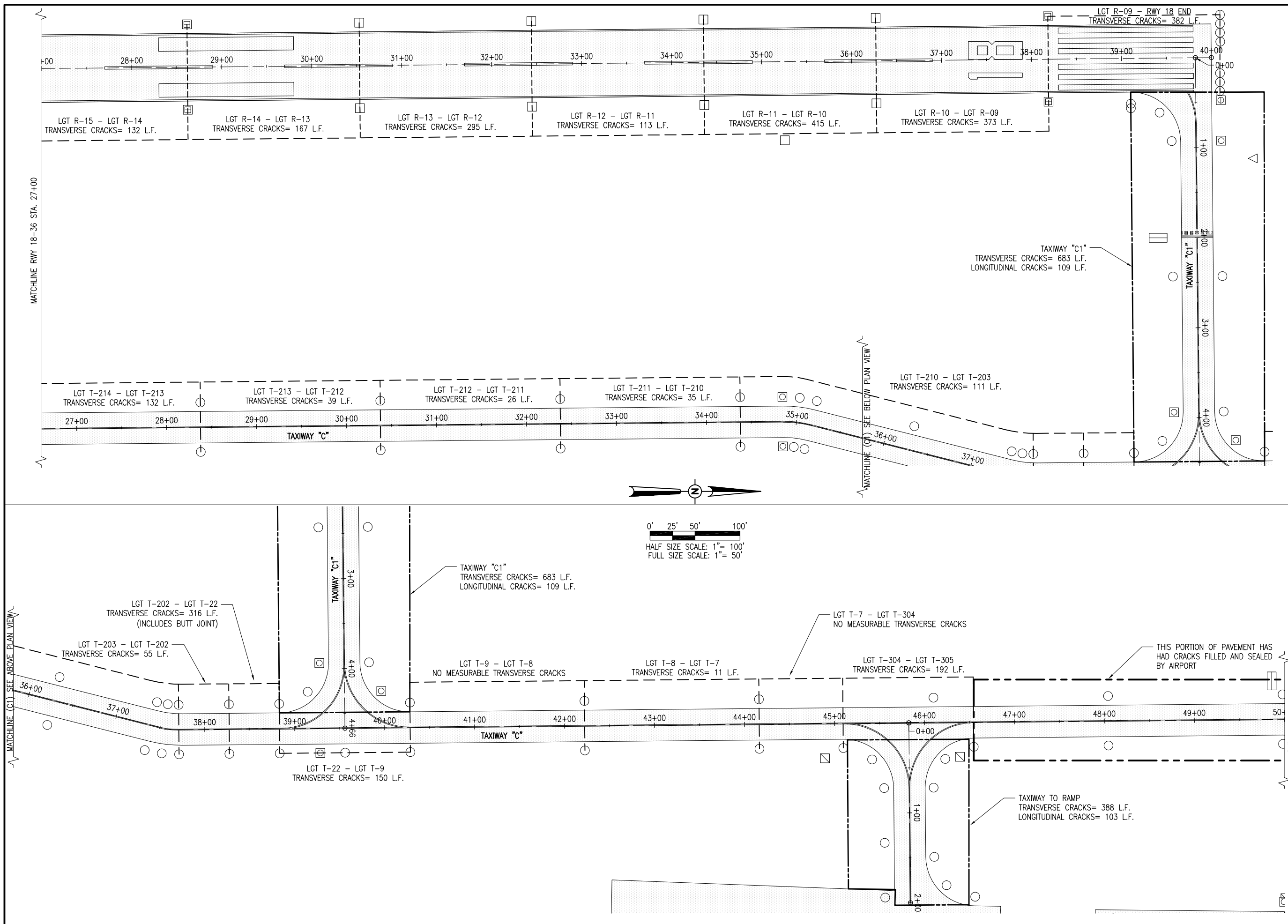

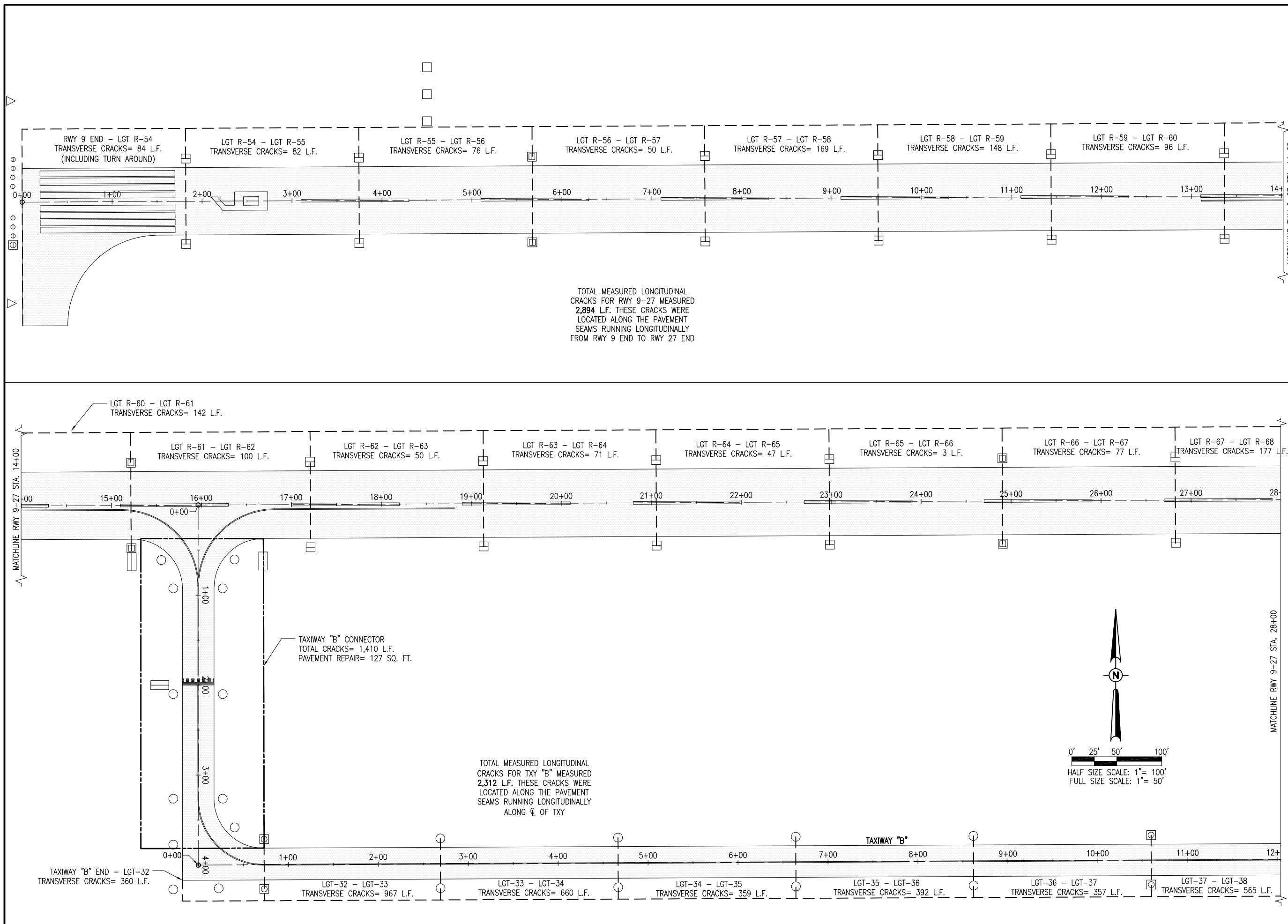

REHABILITATE AIRFIELD PAVEMENTS

IDA No: 3LF-4318

Contract No. LI035

NO.	DATE	DESCRIPTION		
		DES	DWN	REV
1	02/03/15	IDA REVIEW	CAH	CAH

ISSUE: DECEMBER 3, 2014
PROJECT NO: 13A0068D
CAD FILE: C-100-PLAN.DWG
DESIGNED BY: BCT 11/07/2014
DRAWN BY: BCT 11/07/2014
REVIEWED BY: BSS 12/02/2014

SHEET TITLE

PROPOSED CONSTRUCTION PLAN
RUNWAY 9-27 STA. 0+00 TO STA. 28+00

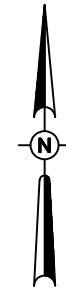

0' 25' 50' 100'
HALF SIZE SCALE: 1" = 100'
FULL SIZE SCALE: 1" = 50'

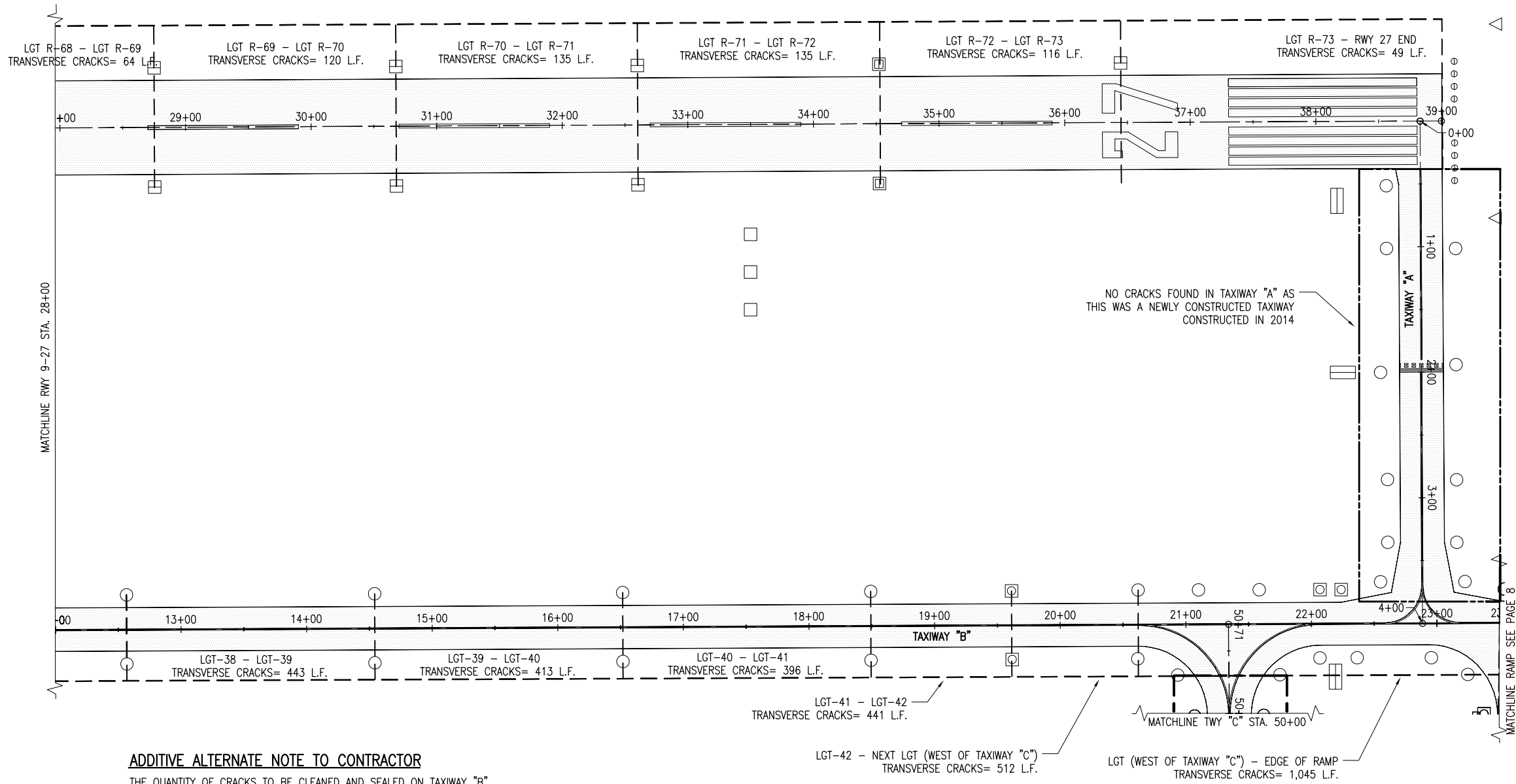

ADDITIVE ALTERNATE NOTE TO CONTRACTOR
THE QUANTITY OF CRACKS TO BE CLEANED AND SEALED ON TAXIWAY "B" HAS BEEN DIVIDED INTO THREE ADDITIVE ALTERNATES. THE ADDITIVE ALTERNATE ARE AS FOLLOWS:

ADDITIVE ALTERNATE NO. 1 - EAST END OF TAXIWAY "B" TO LIGHT 39

ADDITIVE ALTERNATE NO. 2 - LIGHT 39 TO LIGHT 33

ADDITIVE ALTERNATE NO. 3 - LIGHT 33 TO WEST END OF TAXIWAY "B" (INCLUDES TAXIWAY "B" CONNECTOR)

REHABILITATE AIRFIELD PAVEMENTS

IDA No: 3LF-4318

Contract No. LI035

NO.	DATE	DESCRIPTION		
		DES	DWN	REV
1	02/03/15	IDA REVIEW	CAH	CAH

ISSUE: DECEMBER 3, 2014
PROJECT NO: 13A0068D
CAD FILE: C-100-PLAN.DWG
DESIGNED BY: BCT 11/07/2014
DRAWN BY: BCT 11/07/2014
REVIEWED BY: BSS 12/02/2014

SHEET TITLE

PROPOSED CONSTRUCTION PLAN
RUNWAY 9-27 STA. 28+00 TO STA. 39+00

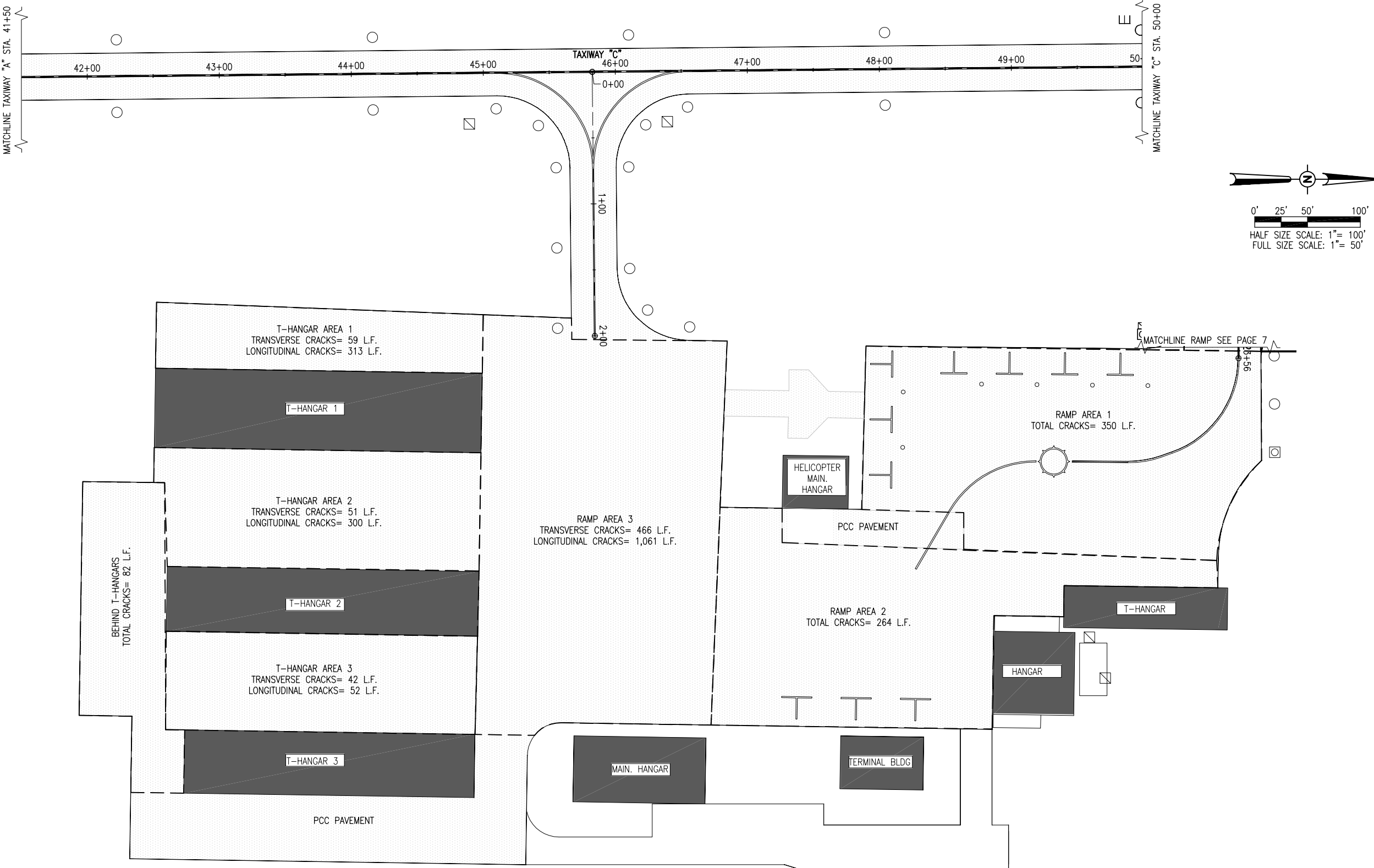

REHABILITATE
AIRFIELD PAVEMENTS

IDA No: 3LF-4318

Contract No. LI035

NO.	DATE	DESCRIPTION		
		DES	DWN	REV

ISSUE: DECEMBER 3, 2014
PROJECT NO: 13A0068D
CAD FILE: C-100-PLAN.DWG
DESIGNED BY: BCT 11/07/2014
DRAWN BY: BCT 11/07/2014
REVIEWED BY: BSS 12/02/2014

SHEET TITLE

PROPOSED
CONSTRUCTION PLAN
FRONTAL AREA