

DATE	
BY	
SURVEYED	
PLOTTED	
TEMPLATE	
AREAS CHECKED	
FINAL SURVEY NOTE BOOK NO.	

DATE	
BY	
SURVEYED	
PLOTTED	
TEMPLATE	
AREAS CHECKED	
ORIGINAL SURVEY NOTE BOOK NO.	

FILE NAME = L:\VANCE\13296-02_Longmeadow\Key\Drawings\CADD\Sheets\Section\csh-18-02-2020.dwg

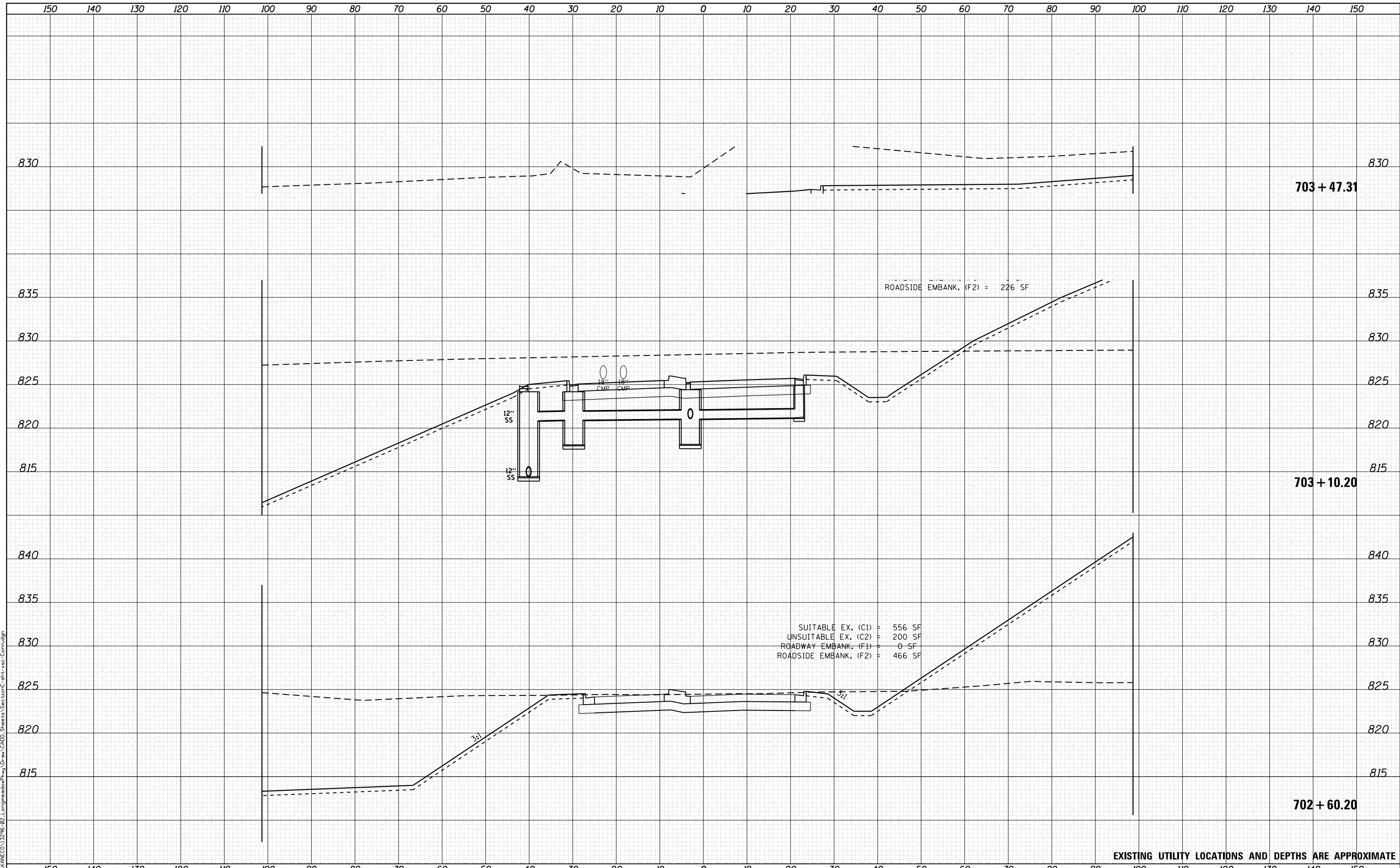

EXISTING UTILITY LOCATIONS AND DEPTHS ARE APPROXIMATE



USER NAME = Ed Davis	DESIGNED - PFR	REVISED -
	DRAWN - PFR	REVISED -
PLOT SCALE = 20.0000' / in.	CHECKED - JMS	REVISED -
PLOT DATE = 2/27/2020	DATE - 01/13/2020	REVISED -

STATE OF ILLINOIS
DEPARTMENT OF TRANSPORTATION

CROSS SECTIONS
BOLZ ROAD CONNECTOR

SCALE: 1"=10'/5' SHEET 3 OF 3 SHEETS STA. TO STA.

F.A.U. RTE.	SECTION	COUNTY	TOTAL SHEETS	SHEET NO.
2298	18-00215-21-BR	KANE	415	401
CONTRACT NO.			61G02	
ILLINOIS FED. AID PROJECT XGDF(875)				

DATE	
BY	
SURVEYED	
PLOTTED	
TEMPLATE	
AREAS CHECKED	
FINAL SURVEY NOTE BOOK NO.	

DATE	
BY	
SURVEYED	
PLOTTED	
TEMPLATE	
AREAS CHECKED	
ORIGINAL SURVEY NOTE BOOK NO.	

FILE NAME = L:\VANCE\13296-02_LongmeadowPkwy_Don\ACADD\Sheets\SectionC-shr-hill.dgn

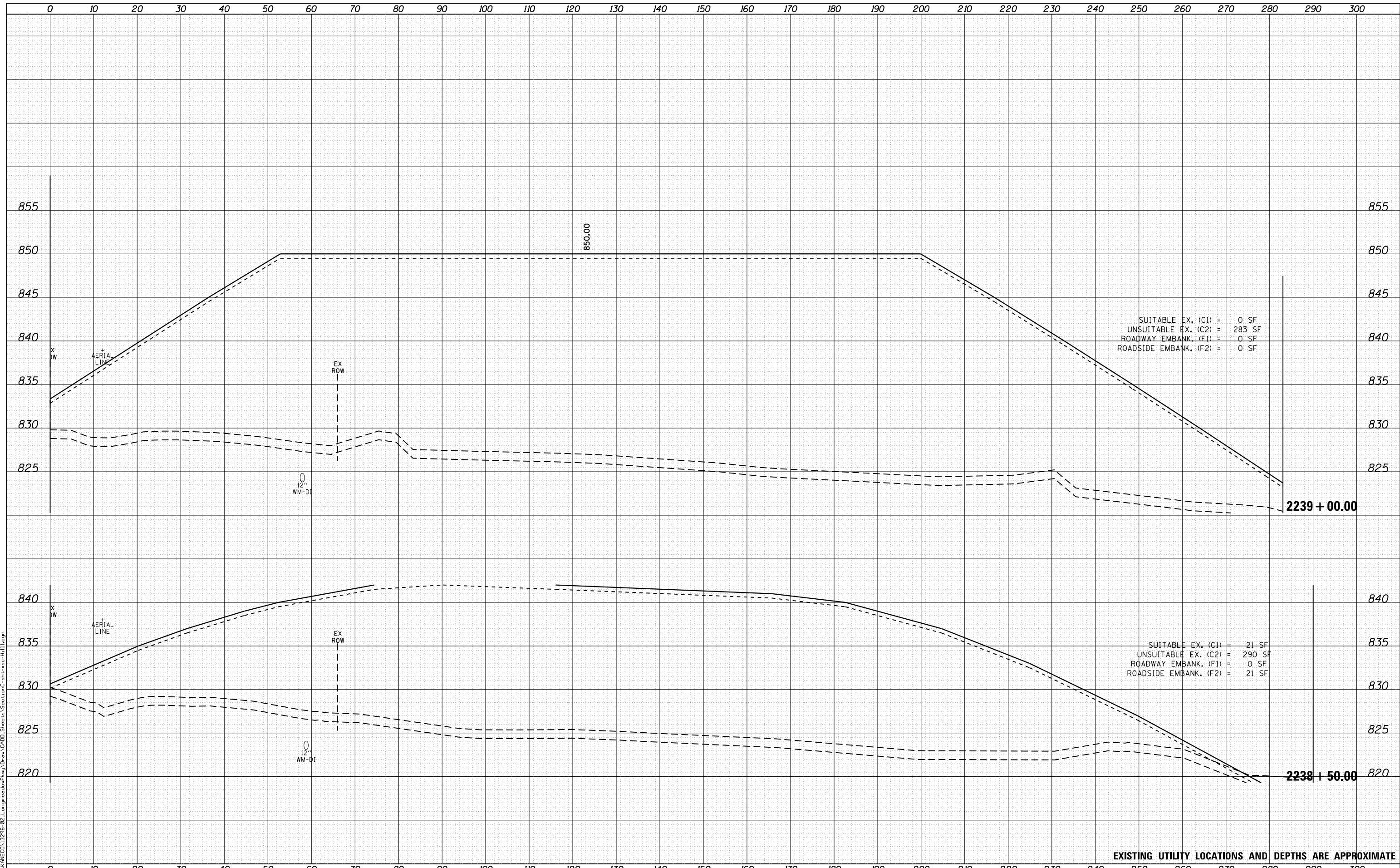

EXISTING UTILITY LOCATIONS AND DEPTHS ARE APPROXIMATE



USER NAME = Ed Davis	DESIGNED - PFR	REVISED -
	DRAWN - PFR	REVISED -
PLOT SCALE = 20.0000' / in.	CHECKED - KDF	REVISED -
PLOT DATE = 2/27/2020	DATE - 01/13/2020	REVISED -

**STATE OF ILLINOIS
DEPARTMENT OF TRANSPORTATION**

**CROSS SECTIONS
HILL IMMEDIATELY EAST OF BOLZ ROAD CONNECTOR**

SCALE: 1"=10'/5' SHEET 1 OF 4 SHEETS STA. TO STA.

F.A.U. RTE.	SECTION	COUNTY	TOTAL SHEETS	SHEET NO.
2298	18-00215-21-BR	KANE	415	402
				CONTRACT NO. 61G02
ILLINOIS FED. AID PROJECT XGDF(875)				

DATE	
BY	
FINAL SURVEY	SURVEYED
NOTE BOOK	PLOTTED
NO.	AREAS CHECKED

DATE	
BY	
ORIGINAL SURVEY	SURVEYED
NOTE BOOK	PLOTTED
NO.	AREAS CHECKED

FILE NAME: L:\VANCE\13296-02.Longsprings\Proj\Drawings\CADD\Sheets\SectionC-shr-vac-Hill.dgn

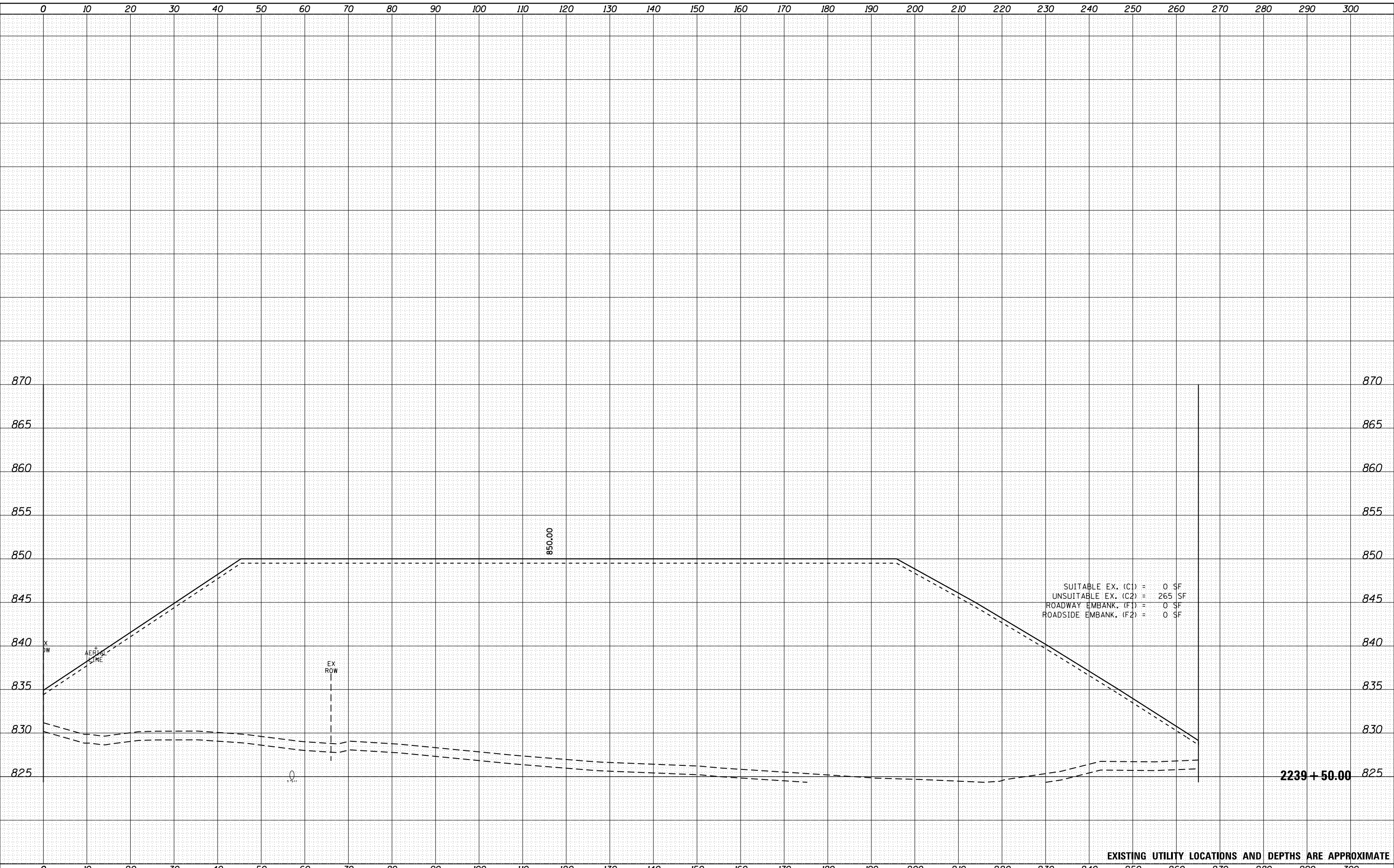

EXISTING UTILITY LOCATIONS AND DEPTHS ARE APPROXIMATE



USER NAME	= Ed Davis	DESIGNED	- PFR	REVISED	-
		DRAWN	- PFR	REVISED	-
PLOT SCALE	= 20.0000' / in.	CHECKED	- KDF	REVISED	-
PLOT DATE	= 2/27/2020	DATE	- 01/13/2020	REVISED	-

**STATE OF ILLINOIS
DEPARTMENT OF TRANSPORTATION**

CROSS SECTIONS
HILL IMMEDIATELY EAST OF BOLZ ROAD CONNECTOR
SCALE: 1"=10'/5' SHEET 2 OF 4 SHEETS STA. TO STA.

F.A.U. RTE.	SECTION	COUNTY	TOTAL SHEETS	SHEET NO.
2298	18-00215-21-BR	KANE	415	403
				CONTRACT NO. 61G02

DATE	
BY	
SURVEYED	
PLOTTED	
TEMPLATE	
AREAS CHECKED	
FINAL SURVEY NO.	
NOTE BOOK NO.	
AREAS CHECKED	

DATE	
BY	
SURVEYED	
PLOTTED	
TEMPLATE	
AREAS CHECKED	
ORIGINAL SURVEY NO.	
NOTE BOOK NO.	
AREAS CHECKED	

FILE NAME = L:\A\NEC\13296-02_Longmeadow_Pkwy_Don\ACADD\Sheets\SectionC-shr-hill111.dgn

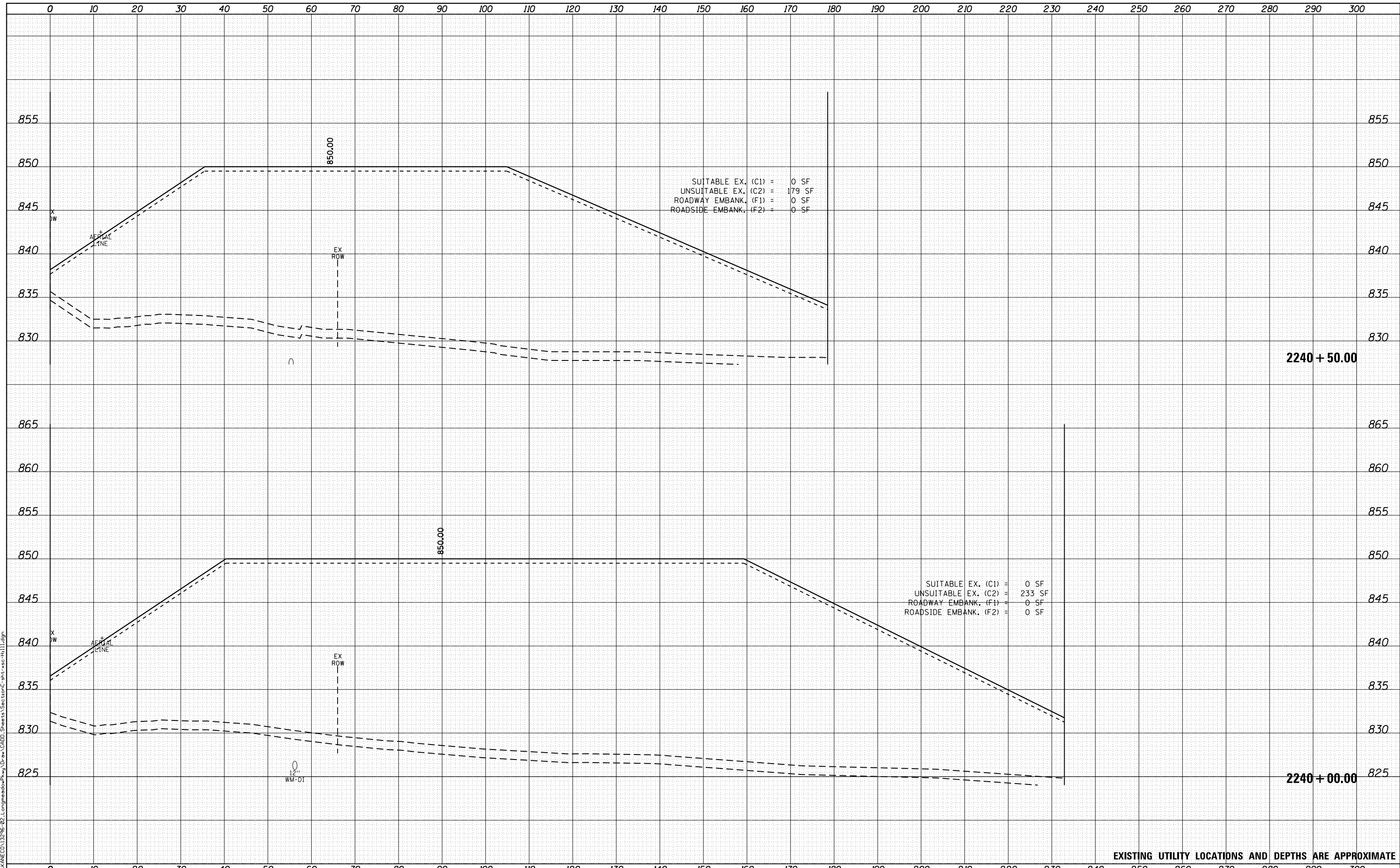

EXISTING UTILITY LOCATIONS AND DEPTHS ARE APPROXIMATE



USER NAME = Ed Davis	DESIGNED - PFR	REVISED -
	DRAWN - PFR	REVISED -
PLOT SCALE = 20.0000' / in.	CHECKED - KDF	REVISED -
PLOT DATE = 2/27/2020	DATE - 01/13/2020	REVISED -

**STATE OF ILLINOIS
DEPARTMENT OF TRANSPORTATION**

**CROSS SECTIONS
HILL IMMEDIATELY EAST OF BOLZ ROAD CONNECTOR**

SCALE: 1"=10'/5' SHEET 3 OF 4 SHEETS STA. TO STA.

F.A.U. RTE.	SECTION	COUNTY	TOTAL SHEETS	SHEET NO.
2298	18-00215-21-BR	KANE	415	404
CONTRACT NO. 61G02				

ILLINOIS FED. AID PROJECT XGDF(875)

DATE	
BY	
SURVEYED	
PLOTTED	
TEMPLATE	
AREAS CHECKED	
FINAL SURVEY NOTE BOOK NO.	

DATE	
BY	
SURVEYED	
PLOTTED	
TEMPLATE	
AREAS CHECKED	
ORIGINAL SURVEY NOTE BOOK NO.	

FILE NAME = L:\VANCE\13296-02-Longmeadow-Pkwy_Don\ACADD\Sheets\SectionC-shr-vac-Hill.dgn

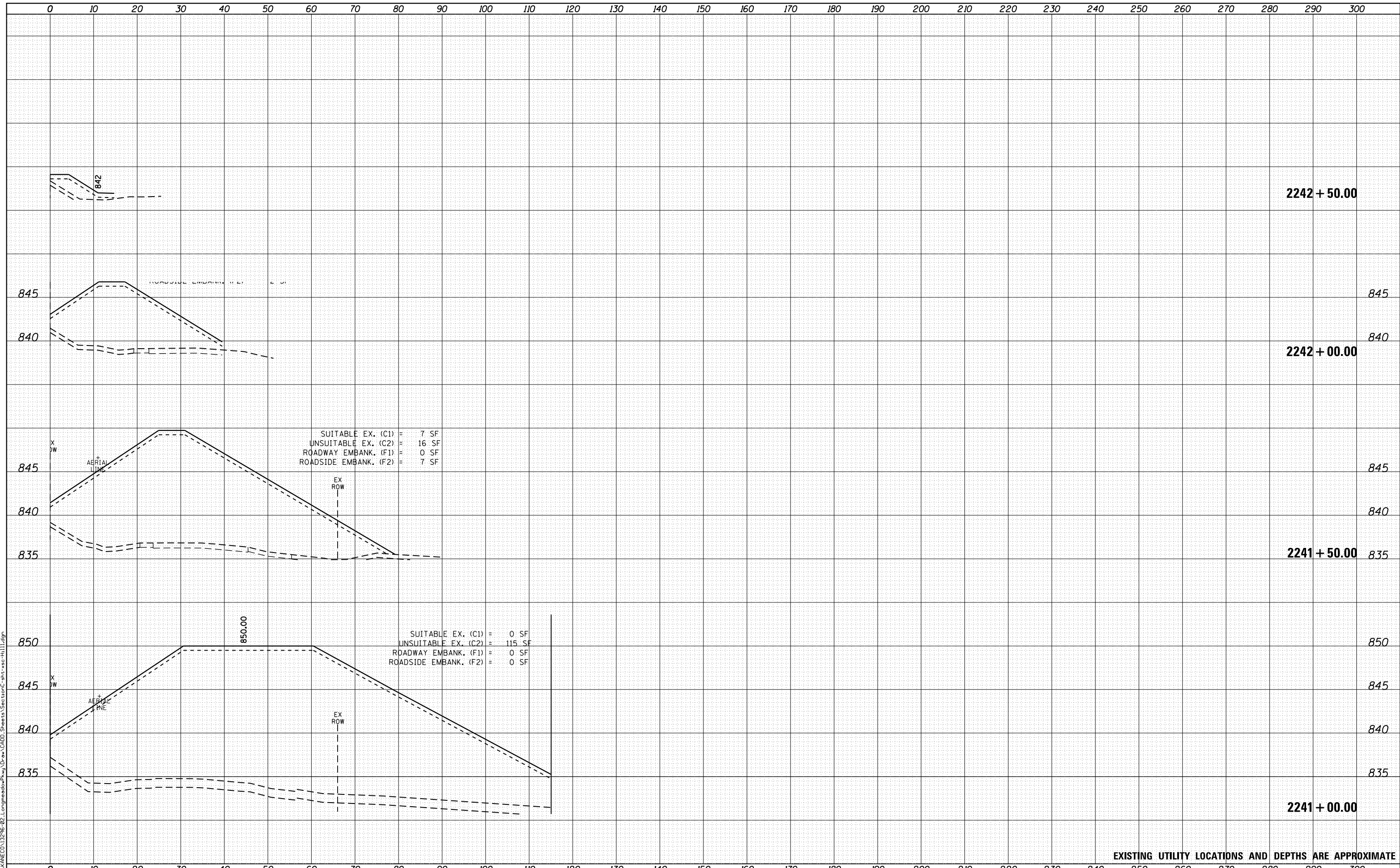

SUITABLE EX. (C1) = 7 SF
 UNSUITABLE EX. (C2) = 16 SF
 ROADWAY EMBANK. (F1) = 0 SF
 ROADSIDE EMBANK. (F2) = 7 SF

SUITABLE EX. (C1) = 0 SF
 UNSUITABLE EX. (C2) = 115 SF
 ROADWAY EMBANK. (F1) = 0 SF
 ROADSIDE EMBANK. (F2) = 0 SF

EXISTING UTILITY LOCATIONS AND DEPTHS ARE APPROXIMATE



USER NAME = Ed Davis	DESIGNED - PFR	REVISED -
	DRAWN - PFR	REVISED -
PLOT SCALE = 20.0000' / in.	CHECKED - KDF	REVISED -
PLOT DATE = 2/27/2020	DATE - 01/13/2020	REVISED -

STATE OF ILLINOIS
 DEPARTMENT OF TRANSPORTATION

CROSS SECTIONS
 HILL IMMEDIATELY EAST OF BOLZ ROAD CONNECTOR

SCALE: 1"=10'/5' SHEET 4 OF 4 SHEETS STA. TO STA.

F.A.U. RTE.	SECTION	COUNTY	TOTAL SHEETS	SHEET NO.
2298	18-00215-21-BR	KANE	415	405
CONTRACT NO.			61G02	
ILLINOIS FED. AID PROJECT XGDF(875)				

DATE	
BY	
SURVEYED	
PLOTTED	
TEMPLATE	
AREAS CHECKED	
FINAL SURVEY NOTE BOOK NO.	

DATE	
BY	
SURVEYED	
PLOTTED	
TEMPLATE	
AREAS CHECKED	
ORIGINAL SURVEY NOTE BOOK NO.	

FILE NAME = L:\A\NEC\13296-02_Longmeadow_Pond\Drawings\CADD\Sheets\CrossSectionC-sh1-18-21.dgn

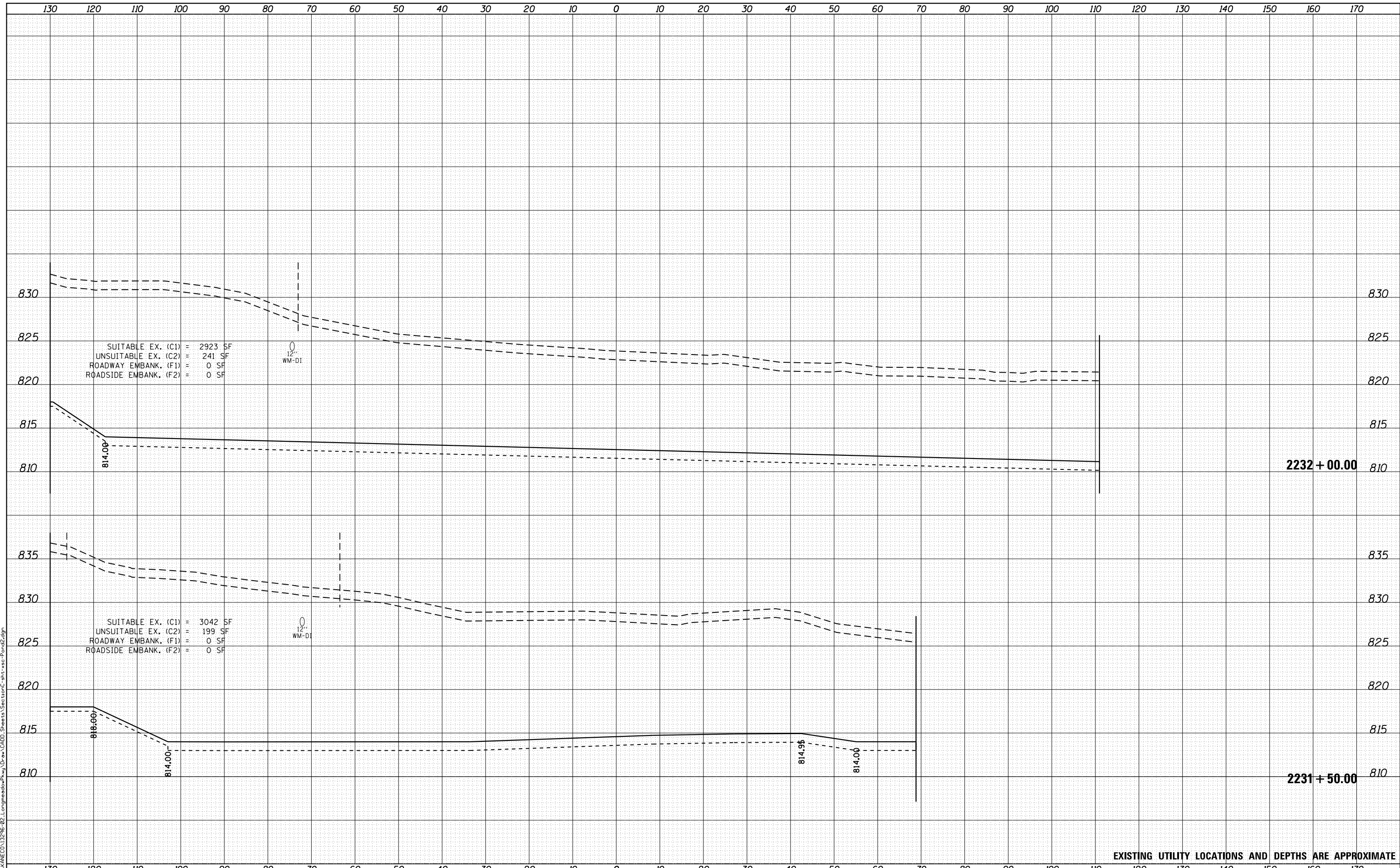

SUITABLE EX. (C1) = 2923 SF
 UNSUITABLE EX. (C2) = 241 SF
 ROADWAY EMBANK. (F1) = 0 SF
 ROADSIDE EMBANK. (F2) = 0 SF

SUITABLE EX. (C1) = 3042 SF
 UNSUITABLE EX. (C2) = 199 SF
 ROADWAY EMBANK. (F1) = 0 SF
 ROADSIDE EMBANK. (F2) = 0 SF

EXISTING UTILITY LOCATIONS AND DEPTHS ARE APPROXIMATE



USER NAME = Ed Davis	DESIGNED - PFR	REVISED -
	DRAWN - PFR	REVISED -
PLOT SCALE = 20.0000' / in.	CHECKED - KDF	REVISED -
PLOT DATE = 2/27/2020	DATE - 01/13/2020	REVISED -

STATE OF ILLINOIS
 DEPARTMENT OF TRANSPORTATION

CROSS SECTIONS
 POND IMMEDIATELY WEST OF BOLZ ROAD CONNECTOR

SCALE: 1"=10'/5' SHEET 1 OF 4 SHEETS STA. TO STA.

F.A.U. RTE.	SECTION	COUNTY	TOTAL SHEETS	SHEET NO.
2298	18-00215-21-BR	KANE	415	406
CONTRACT NO. 61G02				

ILLINOIS FED. AID PROJECT XGDF(875)

DATE	
BY	
FINAL SURVEY	
SURVEYED	
PLOTTED	
NOTE BOOK	
AREAS CHECKED	
NO.	

DATE	
BY	
ORIGINAL SURVEY	
SURVEYED	
PLOTTED	
NOTE BOOK	
AREAS CHECKED	
NO.	

FILE NAME = L:\A\NEO\13296-02_Longmeadow_Pond\Drawings\CADD\Sheets\SectionC-shr-Pond2.dgn

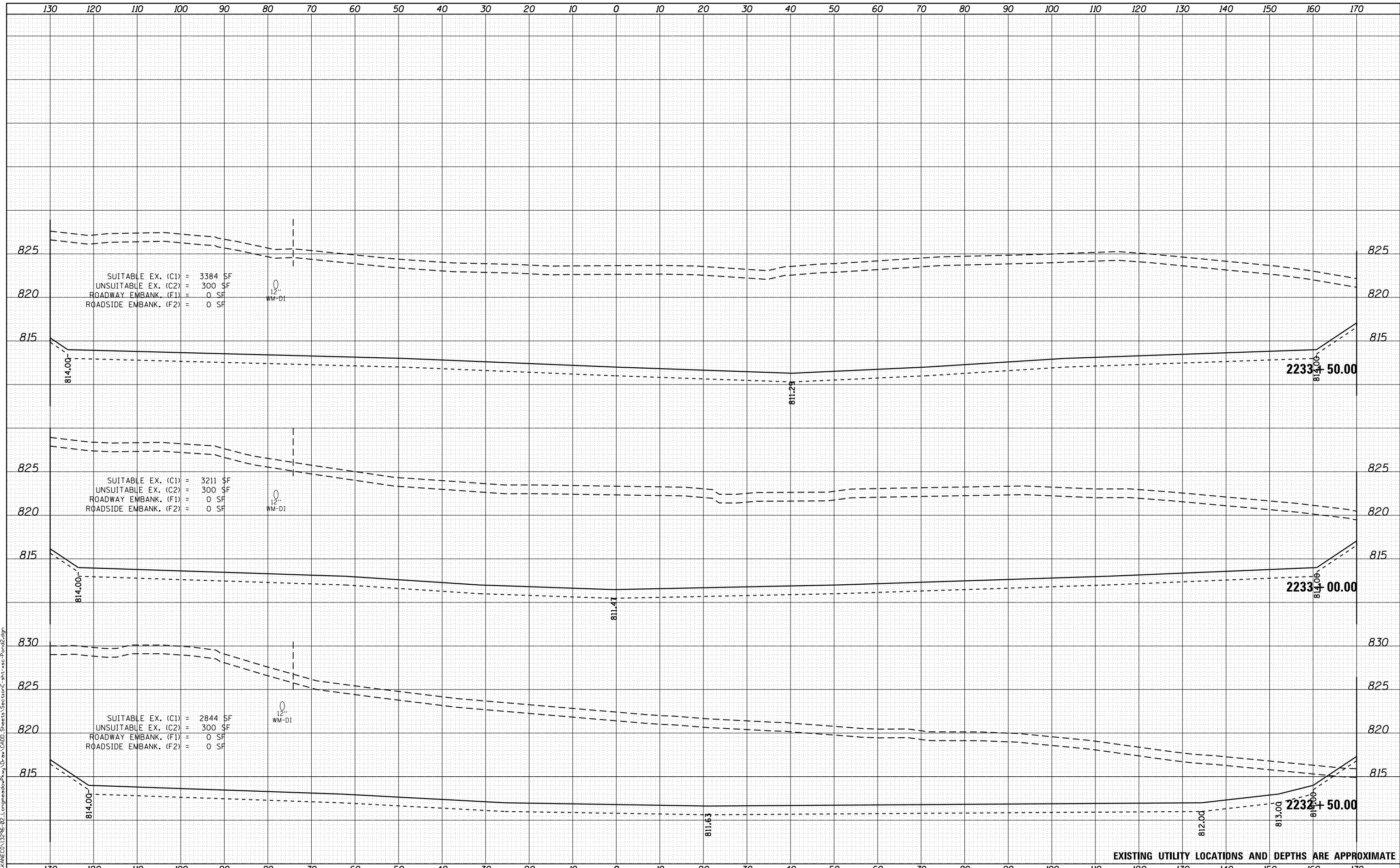

EXISTING UTILITY LOCATIONS AND DEPTHS ARE APPROXIMATE



USER NAME = Ed Davis	DESIGNED - PFR	REVISED -
	DRAWN - PFR	REVISED -
PLOT SCALE = 20.0000' / in.	CHECKED - KDF	REVISED -
PLOT DATE = 2/27/2020	DATE - 01/13/2020	REVISED -

**STATE OF ILLINOIS
DEPARTMENT OF TRANSPORTATION**

**CROSS SECTIONS
POND IMMEDIATELY WEST OF BOLZ ROAD CONNECTOR**

SCALE: 1"=10'/5' SHEET 2 OF 4 SHEETS STA. TO STA.

F.A.U. RTE.	SECTION	COUNTY	TOTAL SHEETS	SHEET NO.
2298	18-00215-21-BR	KANE	415	407
CONTRACT NO. 61G02				

ILLINOIS FED. AID PROJECT XGDF(875)

DATE	
BY	
ORIGINAL SURVEY NO.	
SURVEYED	
PLOTTED	
TEMPLATE	
AREAS CHECKED	
FINAL SURVEY NO.	
NOTE BOOK	
AREAS CHECKED	

DATE	
BY	
ORIGINAL SURVEY NO.	
SURVEYED	
PLOTTED	
TEMPLATE	
AREAS CHECKED	

FILE NAME = L:\A\NEC\13296-02-Longmeadow\Proj\Drawn\CAD\Draw\Sheet\SectionC-sh1-vac-Pond2.dgn

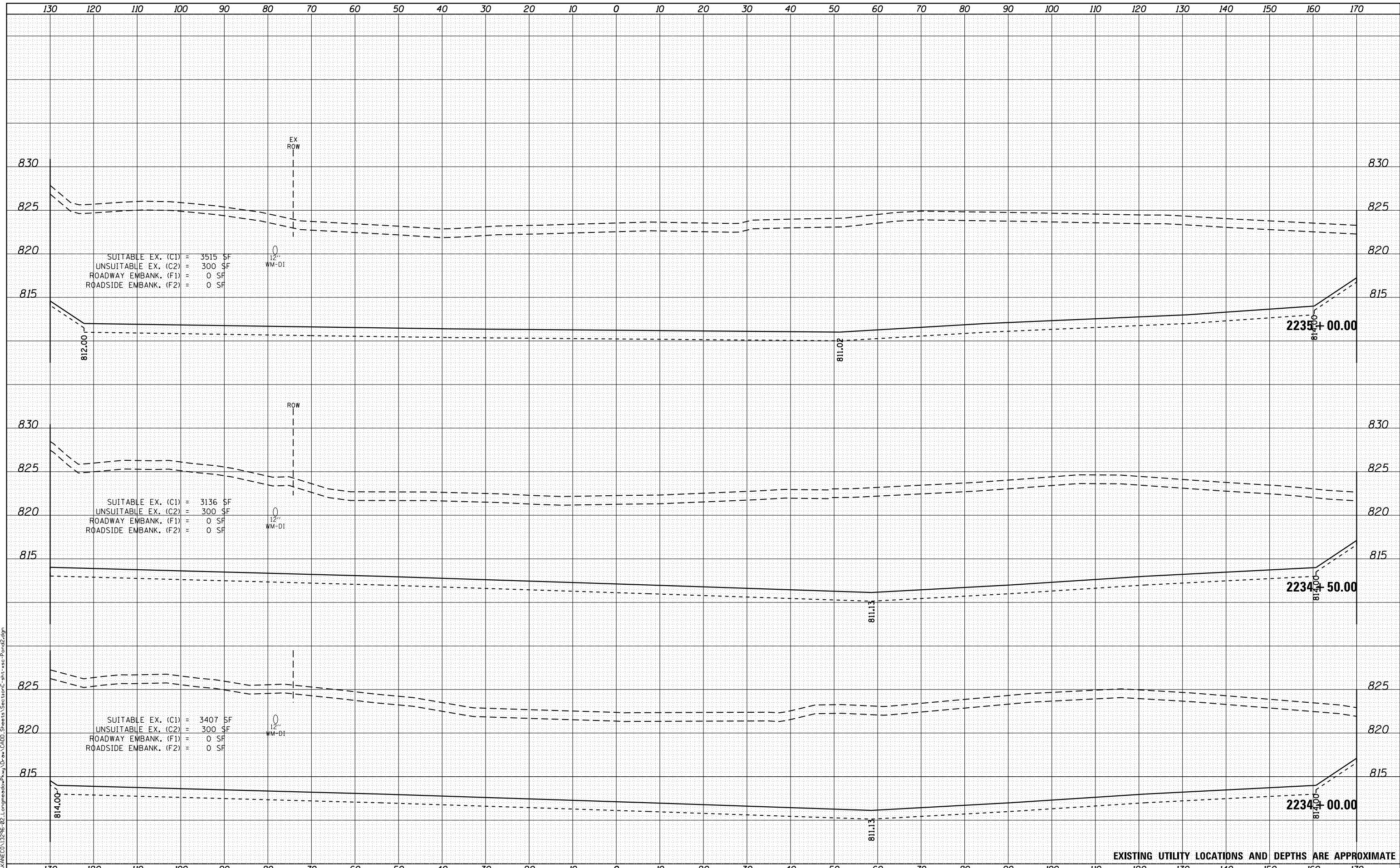

SUITABLE EX. (C1) = 3515 SF
 UNSUITABLE EX. (C2) = 300 SF
 ROADWAY EMBANK. (F1) = 0 SF
 ROADSIDE EMBANK. (F2) = 0 SF

SUITABLE EX. (C1) = 3136 SF
 UNSUITABLE EX. (C2) = 300 SF
 ROADWAY EMBANK. (F1) = 0 SF
 ROADSIDE EMBANK. (F2) = 0 SF

SUITABLE EX. (C1) = 3407 SF
 UNSUITABLE EX. (C2) = 300 SF
 ROADWAY EMBANK. (F1) = 0 SF
 ROADSIDE EMBANK. (F2) = 0 SF

2235+00.00

2234+50.00

2234+00.00

EXISTING UTILITY LOCATIONS AND DEPTHS ARE APPROXIMATE



USER NAME = Ed Davis
 DESIGNED - PFR
 DRAWN - PFR
 CHECKED - KDF
 DATE - 01/13/2020

REVISIED -
 REVISIED -
 REVISIED -
 REVISIED -

STATE OF ILLINOIS
 DEPARTMENT OF TRANSPORTATION

CROSS SECTIONS
 POND IMMEDIATELY WEST OF BOLZ ROAD CONNECTOR

SCALE: 1"=10'/5' SHEET 3 OF 4 SHEETS STA. TO STA.

F.A.U. RTE.	SECTION	COUNTY	TOTAL SHEETS	SHEET NO.
2298	18-00215-21-BR	KANE	415	408
CONTRACT NO.			61G02	

DATE	
BY	
SURVEYED	
PLOTTED	
TEMPLATE	
AREAS CHECKED	
NO.	

DATE	
BY	
SURVEYED	
PLOTTED	
TEMPLATE	
AREAS CHECKED	
NO.	

FILE NAME: L:\VANCE\13296-02-Longmeadow-Pond\Drawings\CADD\Sheets\CrossSectionC-sh1-sec-Pond2.dgn

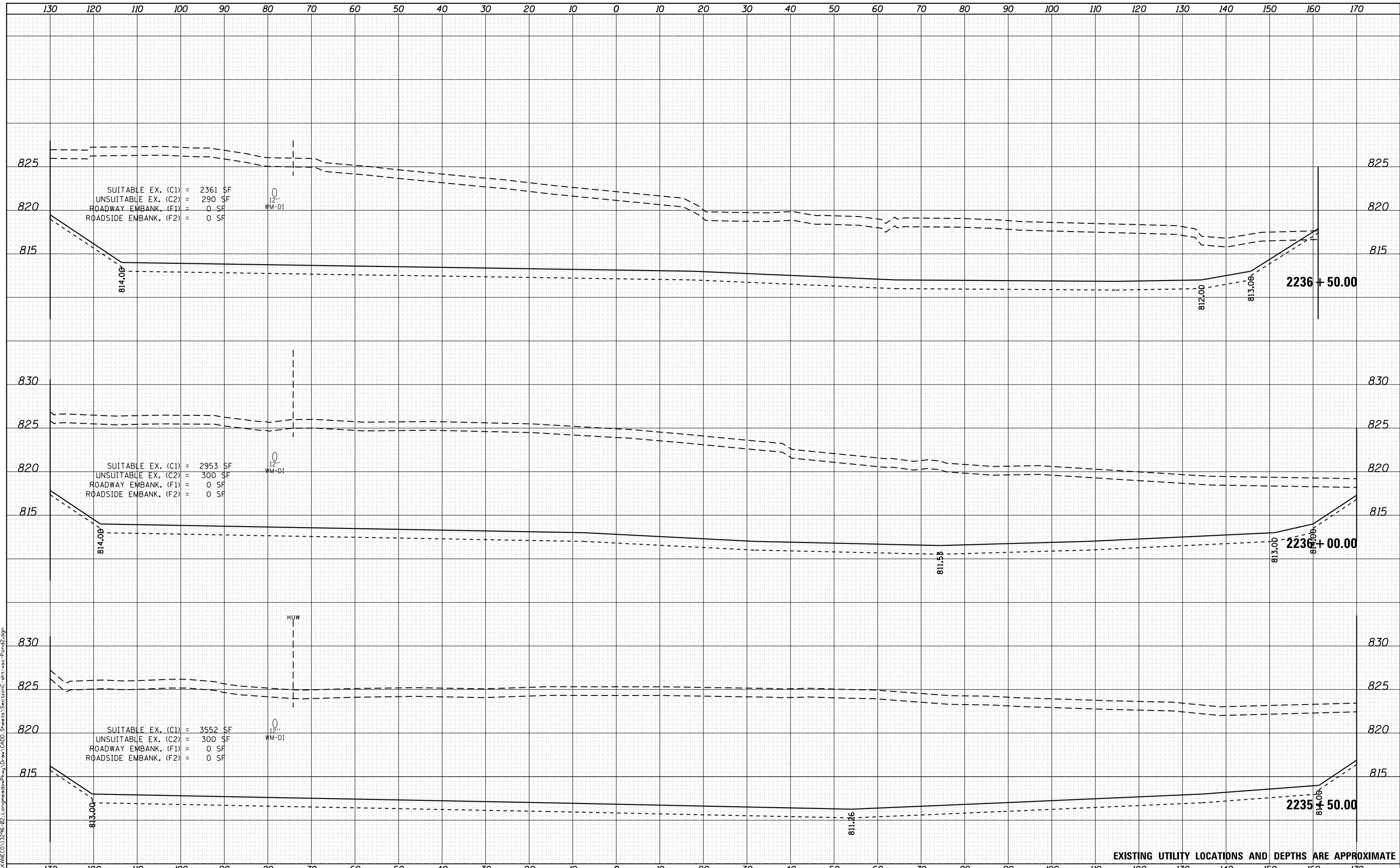

EXISTING UTILITY LOCATIONS AND DEPTHS ARE APPROXIMATE



USER NAME = Ed Davis	DESIGNED - PFR	REVISED -
	DRAWN - PFR	REVISED -
PLOT SCALE = 20.0000' / in.	CHECKED - KDF	REVISED -
PLOT DATE = 2/27/2020	DATE - 01/13/2020	REVISED -

STATE OF ILLINOIS
DEPARTMENT OF TRANSPORTATION

CROSS SECTIONS
POND IMMEDIATELY WEST OF BOLZ ROAD CONNECTOR
SCALE: 1"=10'/5' SHEET 4 OF 4 SHEETS STA. TO STA.

F.A.U. RTE.	SECTION	COUNTY	TOTAL SHEETS	SHEET NO.
2298	18-00215-21-BR	KANE	415	409
CONTRACT NO.				61G02

DATE	
BY	
FINAL SURVEY	SURVEYED
NOTE BOOK	PLOTTED
NO.	AREAS CHECKED

DATE	
BY	
ORIGINAL SURVEY	SURVEYED
NOTE BOOK	PLOTTED
NO.	AREAS CHECKED

FILE NAME = L:\VANCE\13296-02_Longmeadow_Pkwy_Don_V\CAD\Drawings\Section\Sheet\Tower.dgn

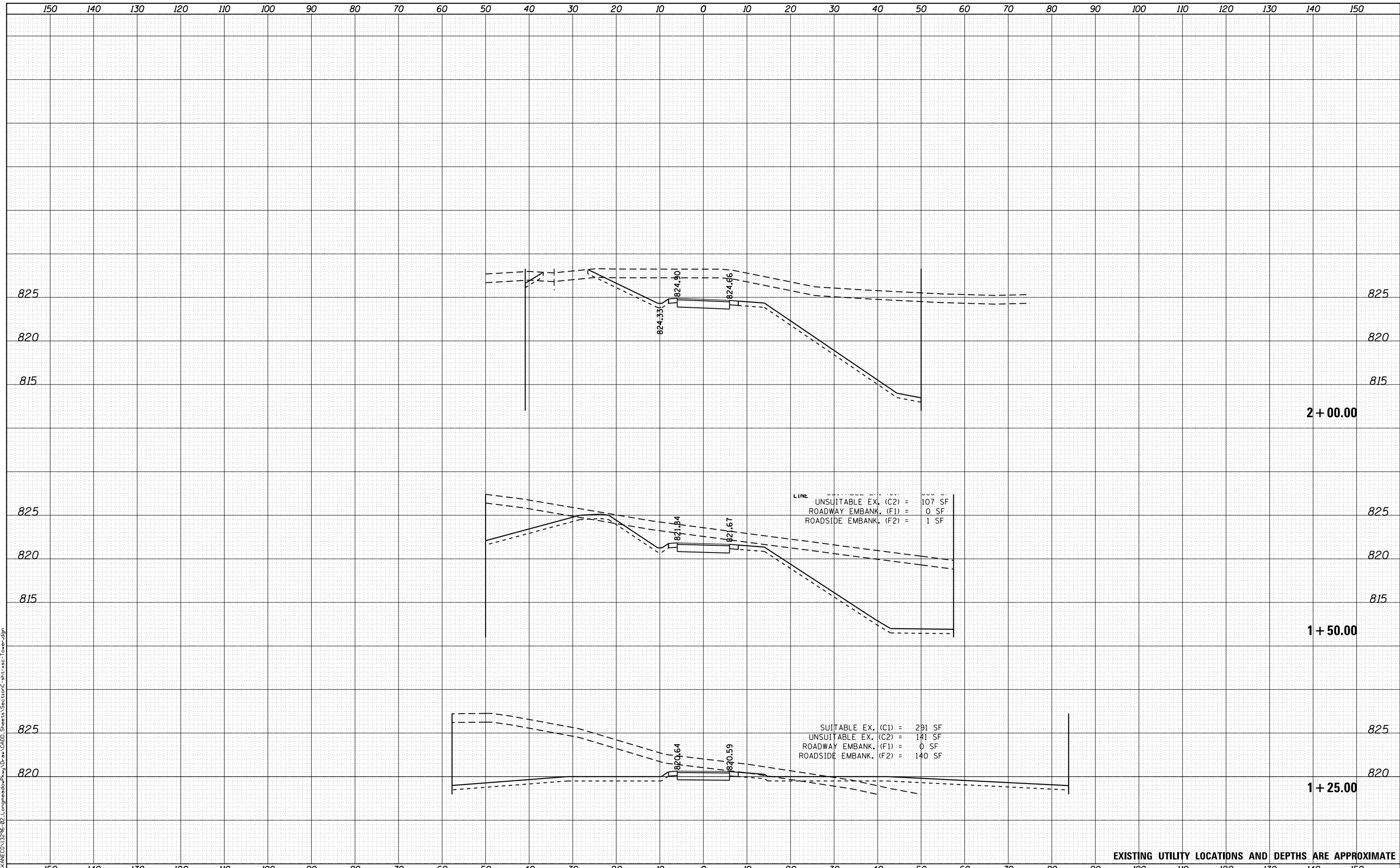

EXISTING UTILITY LOCATIONS AND DEPTHS ARE APPROXIMATE



USER NAME = Ed Davis	DESIGNED - PFR	REVISIED -
	DRAWN - PFR	REVISIED -
PLOT SCALE = 20.0000' / in.	CHECKED - KDF	REVISIED -
PLOT DATE = 2/27/2020	DATE - 01/13/2020	REVISIED -

**STATE OF ILLINOIS
DEPARTMENT OF TRANSPORTATION**

**CROSS SECTIONS
TOWER ACCESS DRIVE**

SCALE: 1"=10'/5' SHEET 1 OF 3 SHEETS STA. TO STA.

F.A.U. RTE.	SECTION	COUNTY	TOTAL SHEETS	SHEET NO.
2298	18-00215-21-BR	KANE	415	410
CONTRACT NO.			61G02	

ILLINOIS FED. AID PROJECT XGDF(875)

DATE	
BY	
FINAL SURVEY NO.	
SURVEYED PLOTTED AREAS CHECKED	
NOTE BOOK	
TEMPLATE	
AREAS CHECKED	

DATE	
BY	
ORIGINAL SURVEY NO.	
SURVEYED PLOTTED AREAS CHECKED	
NOTE BOOK	
TEMPLATE	
AREAS CHECKED	

FILE NAME = L:\VANCE\13296-02-Longmeadow-Pkwy-D-01\ACADD\Sheets\SectionC-sh1-18-2020.dgn



EXISTING UTILITY LOCATIONS AND DEPTHS ARE APPROXIMATE



USER NAME = Ed Davis
 PLOT SCALE = 20.0000' / in.
 PLOT DATE = 2/27/2020

DESIGNED - PFR
 DRAWN - PFR
 CHECKED - KDF
 DATE - 01/13/2020

REVISED -
 REVISED -
 REVISED -
 REVISED -

STATE OF ILLINOIS
 DEPARTMENT OF TRANSPORTATION

CROSS SECTIONS
 TOWER ACCESS DRIVE

SCALE: 1"=10'/5' SHEET 3 OF 3 SHEETS STA. TO STA.

F.A.U. RTE.	SECTION	COUNTY	TOTAL SHEETS	SHEET NO.
2298	18-00215-21-BR	KANE	415	412
CONTRACT NO.			61G02	
ILLINOIS FED. AID PROJECT XGDF(875)				

DATE	
BY	
SURVEYED	
PLOTTED	
TEMPLATE	
AREAS CHECKED	
FINAL SURVEY NOTE BOOK NO.	

DATE	
BY	
ORIGINAL SURVEY NOTE BOOK NO.	
SURVEYED	
PLOTTED	
TEMPLATE	
AREAS CHECKED	

FILE NAME: L:\VANCE\13296-02-Longmeadow\Proj\Draw\CADD\Sheets\SectionC-shr-11-25.dwg

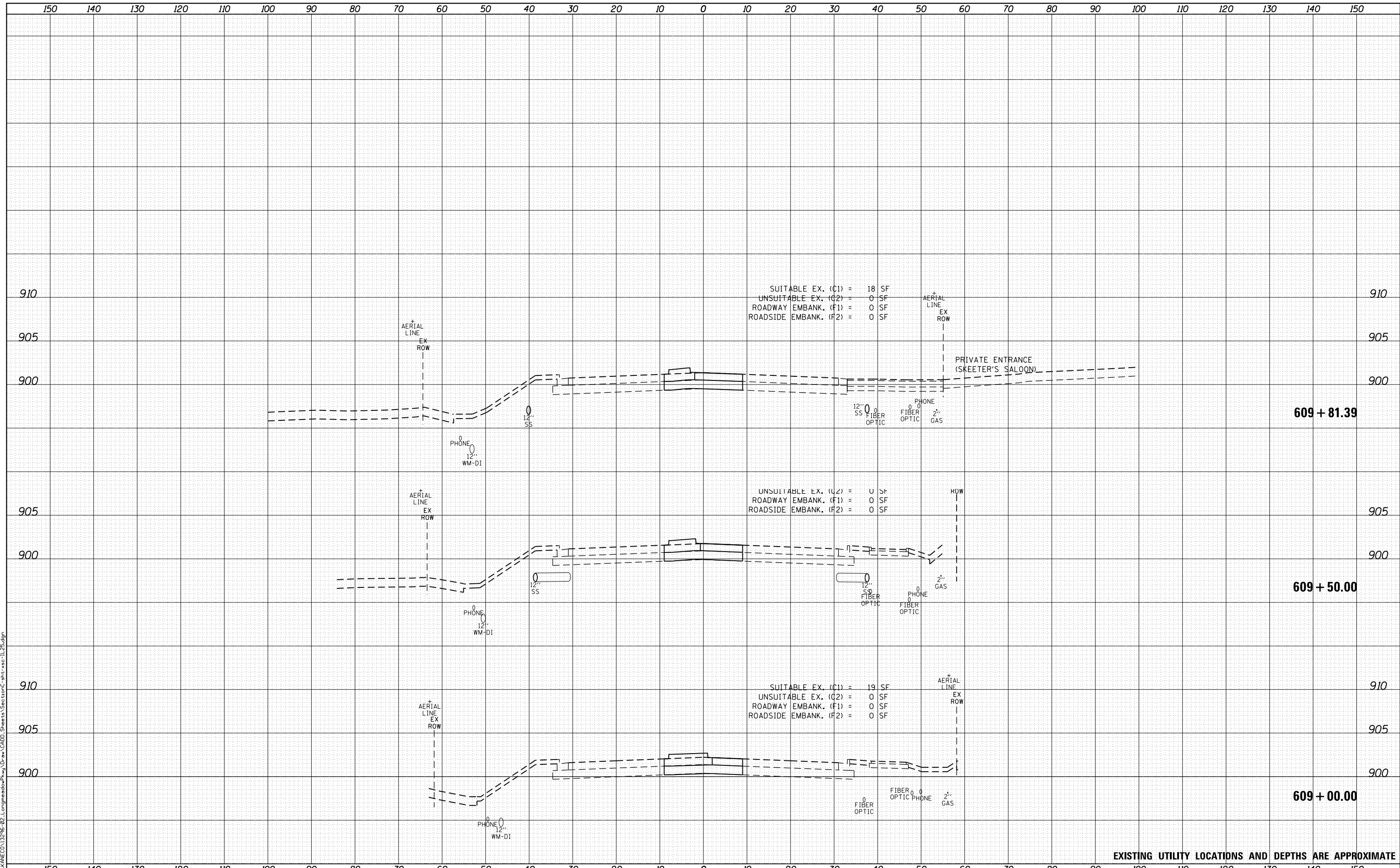

EXISTING UTILITY LOCATIONS AND DEPTHS ARE APPROXIMATE



USER NAME	= Ed Davis
DESIGNED	- PFR
DRAWN	- PFR
CHECKED	- JMS
DATE	- 01/13/2020
REVISIONS	
REVISED	-
REVISED	-
REVISED	-
REVISED	-

STATE OF ILLINOIS
DEPARTMENT OF TRANSPORTATION

CROSS SECTIONS
ILLINOIS ROUTE 25

SCALE: 1"=10'/5' SHEET 1 OF 3 SHEETS STA. TO STA.

F.A.U. RTE.	SECTION	COUNTY	TOTAL SHEETS	SHEET NO.
2298	18-00215-21-BR	KANE	415	413
CONTRACT NO.			61G02	
ILLINOIS FED. AID PROJECT XGDF(875)				

BY	DATE

ORIGINAL SURVEY	SURVEYED	DATE
NOTE BOOK	PLOTTED	
	TEMPLATE	
	AREAS	
	CHECKED	

FILE NAME : L:\VANCE\13296-02_Longmeadow_Pkwy_Don\ACADD_Sheets\SectionC-sh1-vss-1L25.dgn

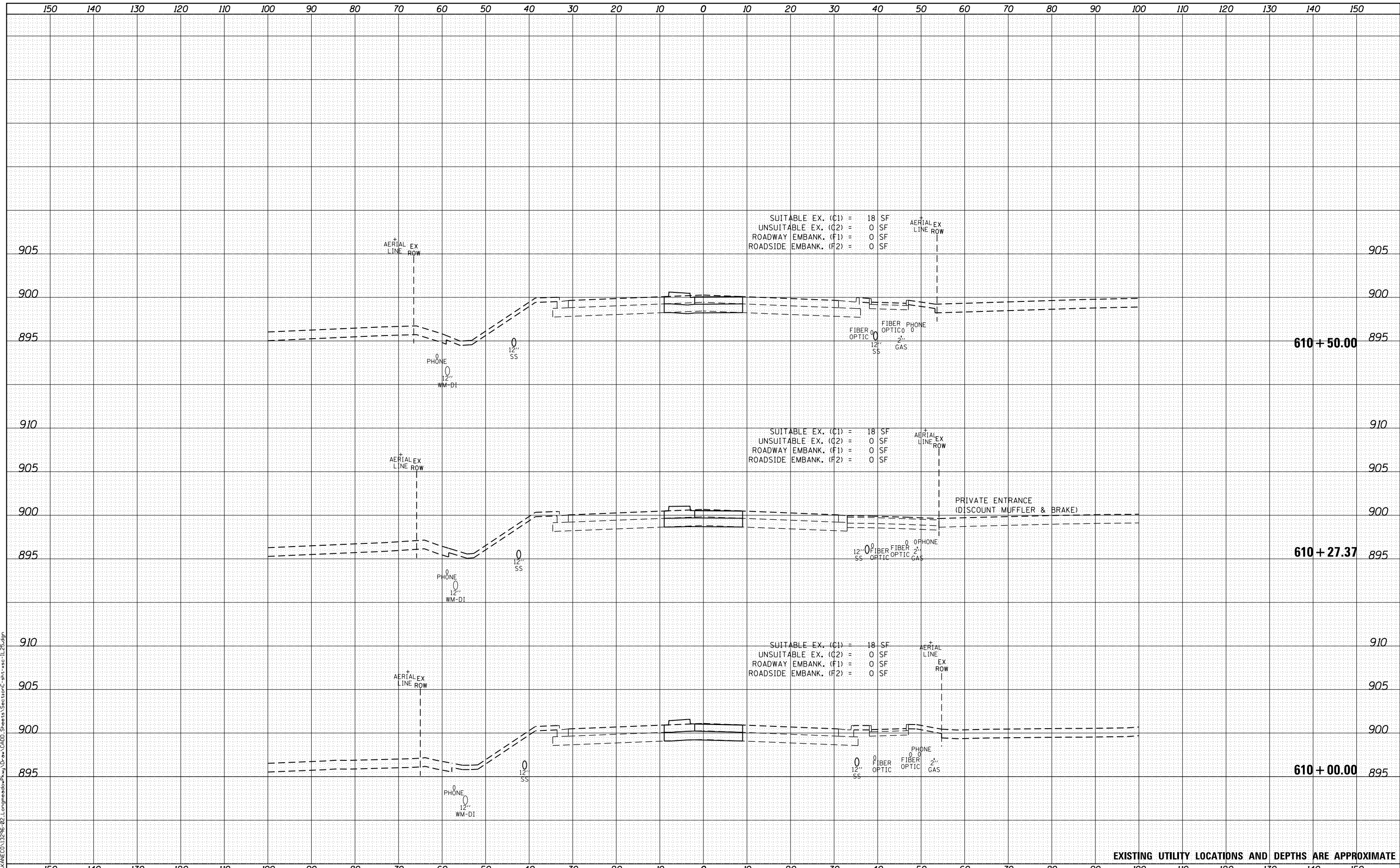

EXISTING UTILITY LOCATIONS AND DEPTHS ARE APPROXIMATE



USER NAME = Ed Davis	DESIGNED - PFR	REVISED -
	DRAWN - PFR	REVISED -
	CHECKED - JMS	REVISED -
	DATE - 01/13/2020	REVISED -

STATE OF ILLINOIS
DEPARTMENT OF TRANSPORTATION

CROSS SECTIONS
ILLINOIS ROUTE 25

SCALE: 1"=10'/5' SHEET 2 OF 3 SHEETS STA. TO STA.

F.A.U. RTE.	SECTION	COUNTY	TOTAL SHEETS	SHEET NO.
2298	18-00215-21-BR	KANE	415	414
CONTRACT NO. 61G02				
ILLINOIS FED. AID PROJECT XGDF(875)				

DATE	
BY	
FINAL SURVEY	SURVEYED
NOTE BOOK	PLOTTED
NO.	TEMPLATE
	AREAS CHECKED

DATE	
BY	
ORIGINAL SURVEY	SURVEYED
NOTE BOOK	PLOTTED
NO.	TEMPLATE
	AREAS CHECKED

FILE NAME = L:\VANCE\13296-02.Longsprings\Proj\Drawings\SectionC-shr-vac-IL25.dgn

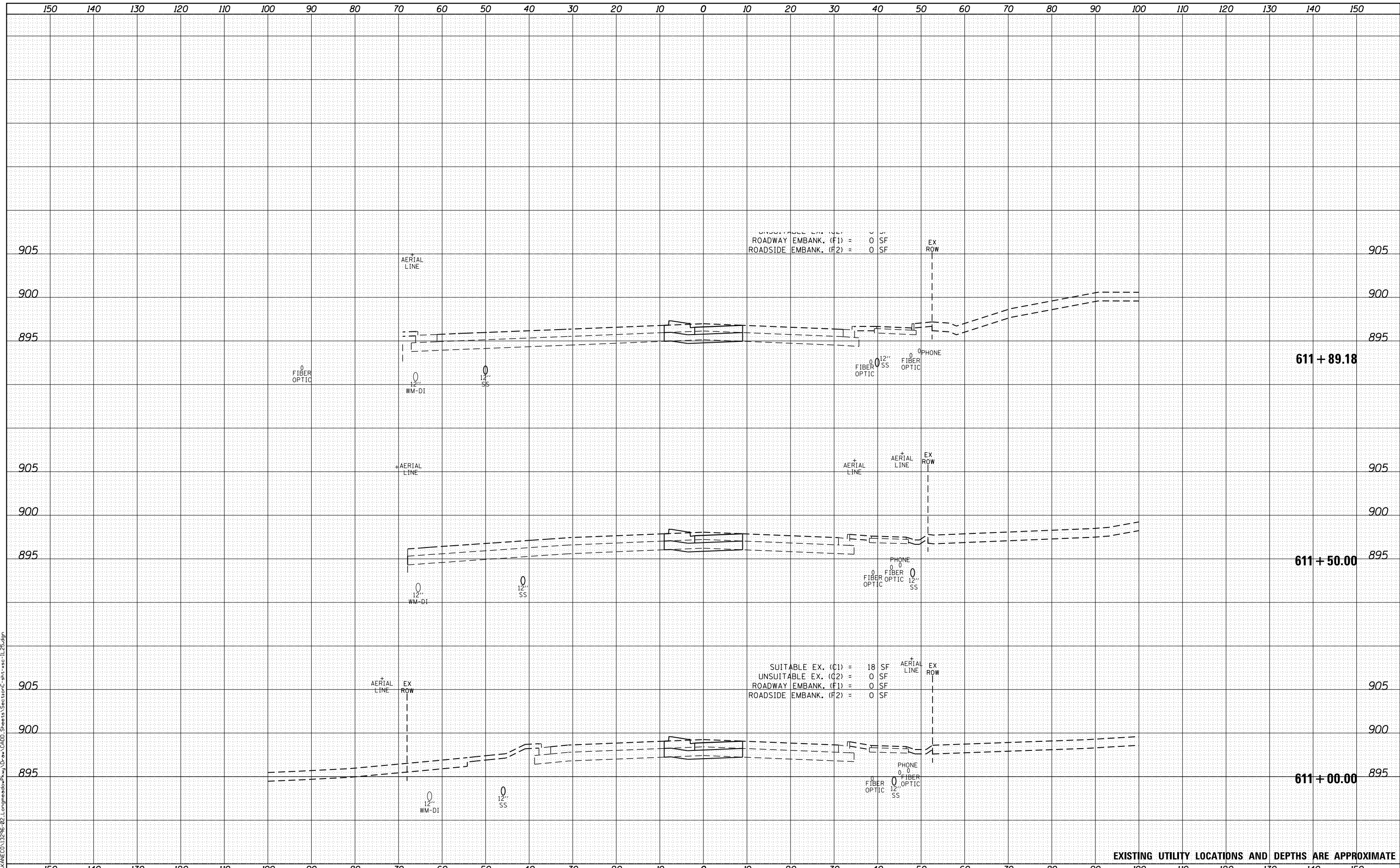

EXISTING UTILITY LOCATIONS AND DEPTHS ARE APPROXIMATE



USER NAME = Ed Davis	DESIGNED - PFR	REVISED -
	DRAWN - PFR	REVISED -
PLOT SCALE = 20.0000' / in.	CHECKED - JMS	REVISED -
PLOT DATE = 2/27/2020	DATE - 01/13/2020	REVISED -

STATE OF ILLINOIS
DEPARTMENT OF TRANSPORTATION

CROSS SECTIONS
ILLINOIS ROUTE 25

SCALE: 1"=10'/5' SHEET 3 OF 3 SHEETS STA. TO STA.

F.A.U. RTE.	SECTION	COUNTY	TOTAL SHEETS	SHEET NO.
2298	18-00215-21-BR	KANE	415	415
CONTRACT NO. 61G02				

ILLINOIS FED. AID PROJECT XGDF(875)