

ROUTE	SECTION	COUNTY	TOTAL SHEETS	SHEET NUMBER
VARIOUS	2008-010 PP	MCHENRY	27+1=28	1

**STATE OF ILLINOIS**  
**DEPARTMENT OF TRANSPORTATION**  
**DIVISION OF HIGHWAYS**  
**DISTRICT ONE**  
**PROPOSED HIGHWAY PLANS**

**CONTRACT NO. 60E36**

D-91-361-08

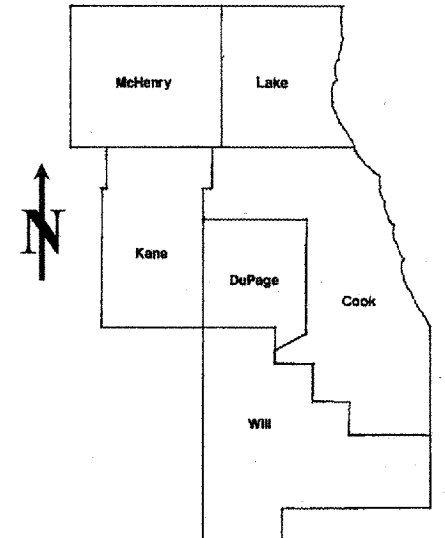

LOCATION OF IMPROVEMENT INDICATED THUS:

FOR INDEX OF SHEETS SEE SHEET 2

VARIOUS ROUTES  
 SECTION: 2008-010 PP  
 VARIOUS LOCATIONS IN MCHENRY COUNTY  
 PAVEMENT PATCHING  
 MCHENRY COUNTY  
 C-91-361-08

DISTRICT ONE - DESIGN - PLAN PREPARATION ENGINEER:  
 KEN ENG / (847) 705-4247

**CONTRACT NO. 60E36**

**STATE OF ILLINOIS**  
**DEPARTMENT OF TRANSPORTATION**  
**DIVISION OF HIGHWAYS**  
 SUBMITTED: MARCH 14, 2008  
*Diane M. O'Keefe* DE  
 DEPUTY DIRECTOR OF HIGHWAYS, REGION ENGINEER  
March 20, 2008  
*Eric E. Harm*  
 INTERIM ENGINEER OF DESIGN AND ENVIRONMENT  
March 20, 2008  
*Christine M. Reed*  
 DIRECTOR, DIVISION OF HIGHWAYS

**PRINTED BY THE AUTHORITY**  
**OF THE STATE OF ILLINOIS**

**J.U.L.I.E.: JOINT UTILITY LOCATION**  
**INFORMATION FOR EXCAVATION**  
**(312) 744-7000**

INDEX OF SHEETS

<u>SHEET NO.</u>	<u>DESCRIPTION</u>
1	TITLE SHEET
2	INDEX OF SHEETS, STATE STANDARDS AND GENERAL NOTES
3	SUMMARY OF QUANTITIES
4	GENERAL LOCATION MAP
5	SUMMARY OF PATCHING SCHEDULE
6-21	PATCHING SCHEDULE
22	SPECIAL DETAIL FOR PAVEMENT PATCHING FOR HMA SURFACED PAVEMENT
23	BUTT JOINT AND HMA TAPER DETAILS
24	TYPICAL APPLICATIONS: RAISED REFLECTIVE PAVEMENT MARKERS (SNOW-PLOW RESISTANT)
25	DISTRICT ONE TYPICAL PAVEMENT MARKINGS
26	TRAFFIC CONTROL AND PROTECTION OF TURN BAYS (TO REMAIN OPEN TO TRAFFIC)
27	ARTERIAL ROAD INFORMATION SIGN
27A	TRAFFIC CONTROL AND PROTECTION FOR SIDE ROADS, INTERSECTIONS AND DRIVEWAYS

STATE STANDARDS

<u>STANDARD NO.</u>	<u>DESCRIPTION</u>
000001-05	TYPICAL SYMBOLS, ABBREVIATIONS AND PATTERNS
420001-07	PAVEMENT JOINTS
442201-03	CLASS C AND D PATCHES
701201-02	LANE CLOSURE, 2L, 2W, DAY ONLY
701306-01	LANE CLOSURE, 2L, 2W, SLOW MOVING OPERATIONS - DAY ONLY
701336-04	LANE CLOSURE, 2L, 2W, WORK AREAS IN SERIES
701501-04	URBAN LANE CLOSURE, 2L, 2W, UNDIVIDED
701601-05	URBAN LANE CLOSURE, MULTILANE, 1W OR 2W WITH NONTRAVERSABLE MEDIAN
701606-05	URBAN LANE CLOSURE, MULTILANE, 2W WITH MOUNTABLE MEDIAN
701701-05	URBAN LANE CLOSURE, MULTILANE INTERSECTION
701901	TRAFFIC CONTROL DEVICES

THE PAY ITEM "MIXTURE FOR CRACKS, JOINTS AND FLANGEWAYS" SHALL BE USED IN AREAS WHERE THE EXISTING CRACK IS 2 INCHES OR LESS. THE CONTRACTOR SHALL CLEAN OUT ALL DEBRIS FROM THE CRACK. THE CLEAN OUT WORK SHALL BE INCLUDED IN THE COST OF "MIXTURE FOR CRACKS, JOINTS AND FLANGEWAYS". THE ENGINEER SHALL DETERMINE THE LOCATIONS FOR THE PLACEMENT OF THE "MIXTURE FOR CRACKS, JOINTS AND FLANGEWAYS".

GENERAL NOTES

BEFORE STARTING ANY EXCAVATION, THE CONTRACTOR SHALL CALL "JULIE" AT (800) 892-0123 OR 811 FOR FIELD LOCATIONS OF BURIED ELECTRIC, TELEPHONE AND GAS FACILITIES. (48 HOUR NOTIFICATION REQUIRED)

THE CONTRACTOR WILL NOT BE ALLOWED TO SET UP A YARD OR FIELD OFFICE ON STATE (OR TOLLWAY) PROPERTY WITHOUT WRITTEN PERMISSION FROM THE DEPARTMENT (OR ISTHA)

WHEN ARTIFICIAL LIGHTING IS UTILIZED IN NIGHT OPERATIONS, THE CONTRACTOR SHALL EXERCISE THE UTMOST PRECAUTIONS IN PREVENTING ADVERSE VISABILITY TO THE MOTORING PUBLIC AND ADJOINING RESIDENTIAL AREAS.

ANY PAVEMENT MARKINGS AND RAISED REFLECTIVE PAVEMENT MARKERS OBLITERATED BY MILLING AND RESURFACING OPERATIONS ON SIDE STREETS AND ENTRANCES SHALL BE REPLACED AND PAID FOR IN KIND.

BEFORE BEGINNING ANY WORK, THE CONTRACTOR SHALL RETAIN AND RECORD FOR FUTURE REFERENCE, ALL EXISTING PAVEMENT MARKING LINES (AND RAISED REFLECTIVE PAVEMENT MARKERS) IN ORDER THAT THESE LOCATIONS CAN BE RE-ESTABLISHED FOR STRIPING. EXACT LOCATIONS OF ALL PAVEMENT MARKINGS SHALL BE AS DIRECTED BY THE ENGINEER.

ALL PAVEMENT PATCHING LOCATIONS WILL BE DETERMINED IN THE FIELD BY THE ENGINEER.

THE CONTRACTOR SHALL CONTACT THE DISTRICT ONE TRAFFIC CONTROL SUPERVISOR AT (847) 705-4470 A MINIMUM OF 72 HOURS IN ADVANCE OF BEGINNING WORK.

THE ENGINEER SHALL CONTACT MS. DEBBIE HANLON, AREA TRAFFIC FIELD ENGINEER AT (815) 438-2300 A MINIMUM OF TWO (2) WEEKS PRIOR TO PLACEMENT OF PERMANENT PAVEMENT MARKINGS.

DOUBLE LANE MARKERS ARE TO BE USED AS SHOWN ON THE DISTRICT ONE DETAIL "TYPICAL APPLICATIONS - RAISED REFLECTIVE PAVEMENT MARKERS (SNOW-PLOW RESISTANT)" SHOWN IN THE PLANS.

THE EXISTING ROADWAY TYPICAL SECTION IS ASSUMED TO HAVE A 3 INCH HOT-MIX ASPHALT OVERLAY ON TOP OF A TEN INCH CONCRETE BASE.

ALL MILLING AREAS AS NOTED ON THE INDIVIDUAL PATCHING SCHEDULES WITH A PATCH WIDTH OF 3 FEET OR LESS AND PATCH LENGTH OF 25 FEET OR MORE SHALL BE PAID FOR AS HOT-MIX ASPHALT SURFACE REMOVAL (SPECIAL).

THE COST OF TRAFFIC CONTROL AND PROTECTION FOR THE PROJECT SHALL BE INCLUDED IN THE COST OF THE ASSOCIATED ROAD WORK.

HOT-MIX ASPHALT MIXTURE REQUIREMENTS

MIXTURE TYPE	AC TYPE	AIR VOIDS (%)
HOT-MIX ASPHALT SURFACE COURSE, MIX "D", N70 (IL 9.5 MM)	PG 64-22	4% @ 70 GYR
LEVELING BINDER (MM), N70	PG 64-22/58-22	4% @ 70 GYR
CLASS D PATCHES, (HMA BINDER IL-19.0 MM)	PG 64-22 *	4% @ 70 GYR
HOT-MIX ASPHALT REPLACEMENT OVER PATCHES, (HMA BINDER IL-19.0 MM)	PG 64-22 *	4% @ 70 GYR
TOP 1 1/2 INCH OF REPLACEMENT OVER PATCHES: [HMA SURFACE COURSE, MIX "D", N70 (IL 9.5 MM)]	PG 64-22	4% @ 70 GYR

THE UNIT WEIGHT USED TO CALCULATE ALL HOT-MIX ASPHALT SURFACE MIXTURE QUANTITIES IS 112 LBS/SY/IN.

\* WHEN RAP EXCEEDS 20%, THE NEW ASPHALT BINDER IN THE MIX SHALL BE PG 58-22

(4-9-08)

FILE NAME = c:\projects\13103\design\as.dgn	USER NAME = wjgroundp	DESIGNED -	REVISED -	<b>STATE OF ILLINOIS DEPARTMENT OF TRANSPORTATION</b>	<b>INDEX OF SHEETS, STATE STANDARDS AND GENERAL NOTES</b>	F.A.P. RTE.	SECTION	COUNTY	TOTAL SHEETS	SHEET NO.
PLOT SCALE = 1/8" = 1' IN.	CHECKED -	REVISED -	VAR.			2008-010 PP	MCHENRY	27	2	
PLOT DATE = 4/9/2008	DATE -	REVISED -	CONTRACT NO. 60E36							
						FED. ROAD DIST. NO. 1 [ILLINOIS] FED. AID PROJECT				
					SCALE:	SHEET NO. OF SHEETS		STA. TO STA.		

F.A.P. RTE.	SECTION	COUNTY	TOTAL SHEETS	SHEET NO.
VAR.	2008-010 PP	MCHENRY	27	3
FED. ROAD DIST. NO. 1		ILLINOIS	HIGHWAY PROJECT	
CONTRACT NO. G0E36				

SUMMARY OF QUANTITIES			URBAN 100% STATE TOTAL QUANTITIES	CONSTRUCTION TYPE CODE				
CODE NO	ITEM	UNIT		1000-2A				
40600200	BITUMINOUS MATERIALS (PRIME COAT)	TON	14	14				
40600300	AGGREGATE (PRIME COAT)	TON	70	70				
40600400	MIXTURE FOR CRACKS, JOINTS, AND FLANGEWAYS	TON	35	35				
40600635	LEVELING BINDER (MACHINE METHOD), N70	TON	965	965				
40600982	HOT-MIX ASPHALT SURFACE REMOVAL - BUTT JOINT	SO YD	3000	3000				
40601005	HOT-MIX ASPHALT REPLACEMENT OVER PATCHES	TON	880	880				
40603340	HOT-MIX ASPHALT SURFACE COURSE, MIX "D", N70	TON	2885	2885				
44000158	HOT-MIX ASPHALT SURFACE REMOVAL, 2 1/4"	SO YD	22935	22935				
44000196	HOT-MIX ASPHALT SURFACE REMOVAL, SPECIAL	SO YD	11417	11417				
44002212	HOT-MIX ASPHALT REMOVAL OVER PATCHES, 3"	SO YD	5220	5220				
44201349	CLASS C PATCHES, TYPE I, 10 INCH	SO YD	40	40				
44201353	CLASS C PATCHES, TYPE II, 10 INCH	SO YD	29	29				
44201357	CLASS C PATCHES, TYPE III, 10 INCH	SO YD	184	184				
44201359	CLASS C PATCHES, TYPE IV, 10 INCH	SO YD	33	33				
44201761	CLASS D PATCHES, TYPE I, 10 INCH	SO YD	87	87				
44201765	CLASS D PATCHES, TYPE II, 10 INCH	SO YD	4071	4071				
44201769	CLASS D PATCHES, TYPE III, 10 INCH	SO YD	289	289				
44201771	CLASS D PATCHES, TYPE IV, 10 INCH	SO YD	296	296				
67000400	ENGINEER'S FIELD OFFICE, TYPE A	CAL MO	3	3				
67100100	MOBILIZATION	L SUM	1	1				
* 78000200	THERMOPLASTIC PAVEMENT MARKING - LINE 4"	FOOT	22850	22850				
* 78100100	RAISED REFLECTIVE PAVEMENT MARKER	EACH	2004	2004				
78300200	RAISED REFLECTIVE PAVEMENT MARKER REMOVAL	EACH	2004	2004				
X0322256	TEMPORARY INFORMATION SIGNING	SO FT	617	617				
* XX006058	POLYUREA PAVEMENT MARKING - LINE 4"	FOOT	100	100				

\* SPECIALTY ITEM

SUMMARY OF QUANTITIES				CONSTRUCTION TYPE CODE				
CODE NO	ITEM	UNIT	TOTAL QUANTITIES	1000-2A				

(4-9-08)

REVISIONS	
NAME	DATE

ILLINOIS DEPARTMENT OF TRANSPORTATION  
SUMMARY OF QUANTITIES

PLOT DATE: 4/9/2008

4/9/2008 10:00:00 AM

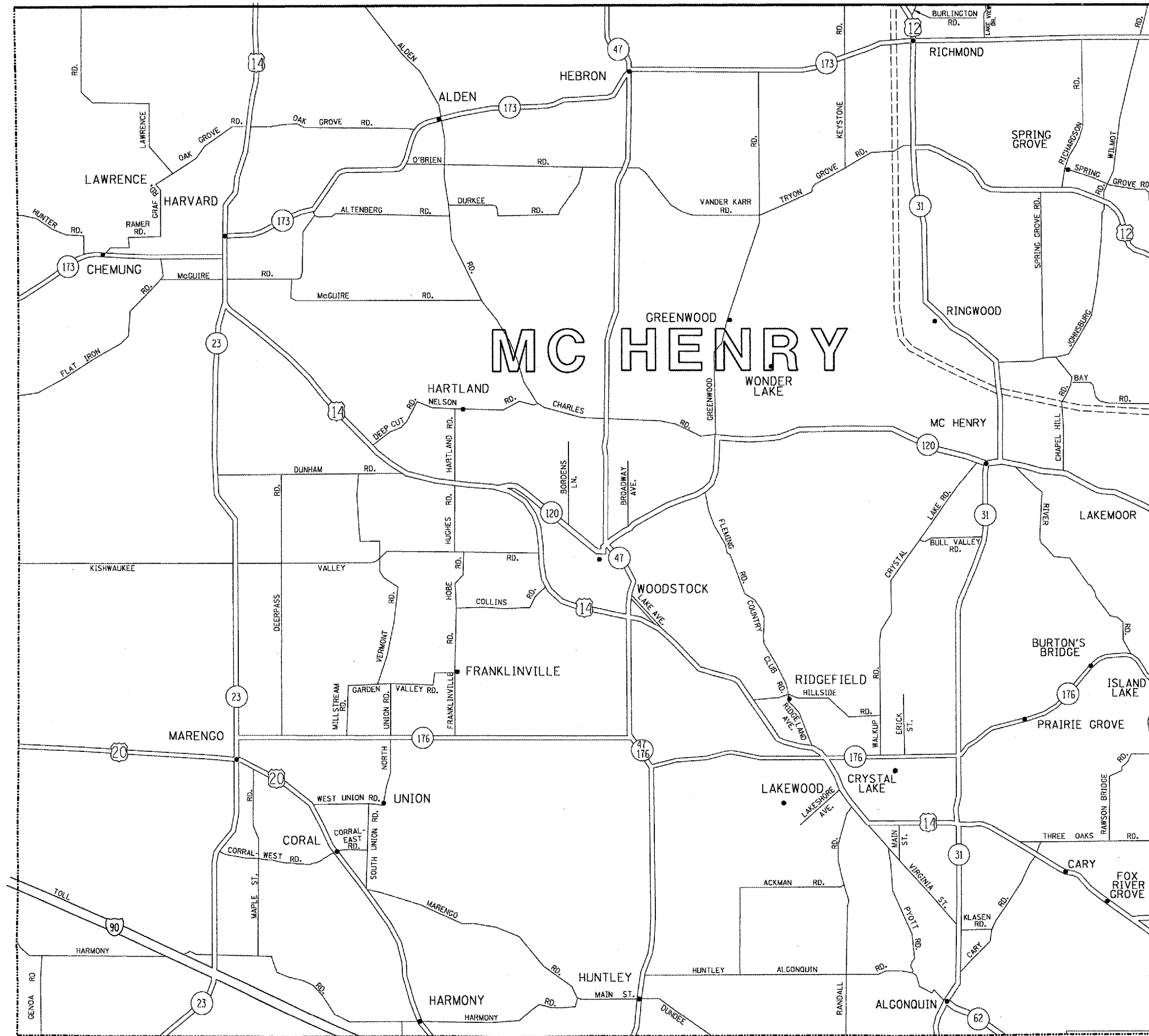

FILE NAME = c:\projects\113408\sh_rdw.dgn	USER NAME = am:thkl	DESIGNED -	REVISED -	<b>STATE OF ILLINOIS</b> <b>DEPARTMENT OF TRANSPORTATION</b>	<b>GENERAL LOCATION MAP - MCHENRY COUNTY</b>		F.A. RTE.	SECTION	COUNTY	TOTAL SHEETS	SHEET NO.
	PLOT SCALE = 100,0000' / IN.	DRAWN -	REVISED -				VAR.	2008-010 PP	MCHENRY	27	4
	PLOT DATE = 3/14/2008	DATE -	REVISED -				CONTRACT NO. 60E36				
					SCALE:	SHEET NO. OF SHEETS	STA. TO STA.	FED. ROAD DIST. NO. 1 (ILLINOIS) FED. AID PROJECT			

McHENRY COUNTY ROUTE SEGMENT	HMA SURF REM 2-1/4" & RESURF (SY)	HMA SURF REM (SP) & RESURF (SY)	CLASS D PATCH TYPE I (SY)	CLASS D PATCH TYPE II (SY)	CLASS D PATCH TYPE III (SY)	CLASS D PATCH TYPE IV (SY)	PAVT MARKING 4" (FT)	RAISED REFL PAVT MKS (EACH)
IL 23 (I-90 TO HARMONY ROAD)			33	5			50	10
US 12 (IL 31 TO STATE PARK ROAD)	983	775		256	38	66	1400	30
US 12 (STATELINE TO IL 173)	726	99		618	118	163	700	20
IL 31 (JOHNSBERG ROAD TO US 12)	841	466		214	40		1000	20
IL 47 (NEAR WOODSTOCK)	3544	280	16	134	20		1200	60
IL 173	7724	1415	19	18			2300	120
IL 173 (IL 47 TO LAKE COUNTYLINE)	2194	3700		1318		27	5600	300
IL 176 (ROBERTS ROAD TO IL 47)	715	489		1447	73	40	1300	64
US 14 (IL 120 TO BLUE JAY LANE)	6209	1260	19	61			4000	200
US 14 (IL 173 TO STATE LINE ROAD)		2933					5300	270
<b>SUMMARY TOTALS:</b>	<b>22936</b>	<b>11417</b>	<b>87</b>	<b>4071</b>	<b>289</b>	<b>296</b>	<b>22850</b>	<b>1094</b>

McHENRY COUNTY ROUTE SEGMENT (PCC SECTIONS)	HMA SURF REM 2-1/4" & RESURF (SY)	HMA SURF REM (SP) & RESURF (SY)	CLASS C PATCH TYPE I (SY)	CLASS C PATCH TYPE II (SY)	CLASS C PATCH TYPE III (SY)	CLASS C PATCH TYPE IV (SY)	PAVT MARKING 4" (FT)	RAISED REFL PAVT MKS (EACH)
IL 31 (IN CRYSTAL LAKE)				29	80		40	8
US 14 (IN CARY AND RIVER GROVE)			40		104	33	60	12
<b>SUMMARY TOTALS:</b>			<b>40</b>	<b>29</b>	<b>184</b>	<b>33</b>	<b>100</b>	<b>10</b>

**NOTE:**

ALL MILLING AREAS AS NOTED ON THE INDIVIDUAL PATCHING SCHEDULES WITH A PATCH WIDTH OF 3 FEET OR LESS AND PATCH LENGTH OF 25 FEET OR MORE SHALL BE PAID FOR AS HOT-MIX ASPHALT SURFACE REMOVAL (SPECIAL).

(4-9-08)

FILE NAME = c:\projects\13108\design\design.dgn	USER NAME = wjgreendp	DESIGNED -	REVISED -	<b>STATE OF ILLINOIS DEPARTMENT OF TRANSPORTATION</b>	<b>SUMMARY OF PATCHING SCHEDULE MCHENRY COUNTY</b>				F.A.P. RTE.	SECTION	COUNTY	TOTAL SHEETS	SHEET NO.
PLOT SCALE = 1/8" = 100.0000' / IN.	CHECKED -	REVISOR -	REVISOR -		SCALE:	SHEET NO.	OF	SHEETS	STA.	TO STA.	MCHENRY	27	5
PLOT DATE = 4/7/2008	DATE -	REVISOR -	REVISOR -		CONTRACT NO. 60E36								

FED. ROAD DIST. NO. 1 ILLINOIS FED. AID PROJECT











ROUTE: **US 14 (IL 120 to Blue Jay Lane)**

CROSS STREETS		DIRECTION (EB/WB) (NB/SB)	LANE NO. (1, 2, 3)	PAVEMENT PATCH WIDTH	PAVEMENT PATCH LENGTH	REPAIR AREA (SQ FT)	REPAIR AREA (SQ YD)	MILL & RESURF	CLASS D PATCH TYPE I	CLASS D PATCH TYPE II	CLASS D PATCH TYPE III	CLASS D PATCH TYPE IV	PAVT MARKING 4"	RAISED REFL PVT MKS
FROM	TO													
ROUTE 120	BLUE JAY LANE	WB/NB	1	2.0	2.0	4.0	0		1					
ROUTE 120	BLUE JAY LANE	WB/NB	1	2.0	2.0	4.0	0		1					
ROUTE 120	1.1 HUGHES ROAD	WB/NB	1	2.0	2.0	4.0	0		1					
CENTERLINE JOINT 1.4 MILES		WB/NB	1	2.0	800.0	1600.0	178	178						
ROUTE 120	1.4 MILES	WB/NB	1	3.0	3.0	9.0	1			9				
ROUTE 120	1.4 MILES	WB/NB	1	2.0	2.0	4.0	0		1					
ROUTE 120	1.8 MILES	WB/NB	1	10.0	13.0	130.0	14			14				
CENTERLINE JOINT 1.8 MILES		WB/NB	1	2.0	600.0	1200.0	133	133						
ROUTE 120	1.8 MILES	WB/NB	1	6.0	6.0	36.0	4		4					
ROUTE 120	1.8 MILES	WB/NB	1	2.0	2.0	4.0	0		1					
ROUTE 120	1.8 MILES	WB/NB	1	2.0	2.0	4.0	0		1					
ROUTE 120	1.9 MILES	WB/NB	1	3.0	13.0	39.0	4		4					
CENTERLINE JOINT 1.9 MILES		WB/NB	1	2.0	1500.0	3000.0	333	333						
ROUTE 120	2.6 MILES	WB/NB	1	13.0	100.0	1300.0	144	144						
ROUTE 120	2.6 MILES	WB/NB	1	6.0	15.0	90.0	10			10				
CENTERLINE JOINT 2.6 MILES		WB/NB	1	2.0	1000.0	2000.0	222	222						
ROUTE 120	2.9 MILES	WB/NB	1	13.0	1000.0	13000.0	1444	1444						
CENTERLINE JOINT 3.0 MILES		WB/NB	1	2.0	1000.0	2000.0	222	222						
ROUTE 120	3.0 MILES	WB/NB	1	2.0	2.0	4.0	0		1					
ROUTE 120	3.3 DEEP CUT RD	WB/NB	1	3.0	6.0	18.0	2		2					
ROUTE 120	3.9 BUNKER HILL	WB/NB	1	3.0	6.0	18.0	2		2					
CENTERLINE JOINT 4.7 MILES		WB/NB	1	2.0	30.0	60.0	7	7						
ROUTE 120	7.0 MILES	WB/NB	1	6.0	13.0	78.0	9			9				
ROUTE 120	7.8 BLUE JAY ROAD	WB/NB	1											
BLUE JAY ROAD	RTE 120	EB/SB												
CENTERLINE JOINT .1 MILES		EB/SB	1	2.0	100.0	200.0	22	22						
CENTERLINE JOINT .3 MILES		EB/SB	1	2.0	200.0	400.0	44	44						
CENTERLINE JOINT .3 MILES		EB/SB	1	2.0	100.0	200.0	22	22						
CENTERLINE JOINT .3 MILES		EB/SB	1	2.0	50.0	100.0	11	11						
CENTERLINE JOINT .4 MILES		EB/SB	1	2.0	100.0	200.0	22	22						
BLUE JAY ROAD	1.3 MILES	EB/SB	1	6.0	15.0	90.0	10			10				
BLUE JAY ROAD	3.2 MILES	EB/SB	1	2.0	200.0	400.0	44	44						
BLUE JAY ROAD	4.1 MILES	EB/SB	1	6.0	13.0	78.0	9			9				
BLUE JAY ROAD	4.1 MILES	EB/SB	1	13.0	200.0	2600.0	289	289						
BLUE JAY ROAD	4.2 MILES	EB/SB	1	13.0	1000.0	13000.0	1444	1444						
BLUE JAY ROAD	4.9 MILES	EB/SB	1	13.0	1000.0	13000.0	1444	1444						
BLUE JAY ROAD	5.3 MILES	EB/SB	1	13.0	500.0	6500.0	722	722						
BLUE JAY ROAD	5.4 MILES	EB/SB	1	13.0	500.0	6500.0	722	722						

TOTALS:

7541 SY    7469 SY    19 SY    61 SY

FT EACH

FILE NAME = c:\projects\dl36108\design_ea.dgn	USER NAME = wilgreendp	DESIGNED -	REVISED -	<b>STATE OF ILLINOIS DEPARTMENT OF TRANSPORTATION</b>	<b>PATCHING SCHEDULE US 14</b>				F.A.P. RTE.	SECTION	COUNTY	TOTAL SHEETS	SHEET NO.
		DRAWN -	REVISED -		SCALE:	SHEET NO.	OF	SHEETS	STA.	TO STA.	MCHENRY	27	9
		CHECKED -	REVISED -		FED. ROAD DIST. NO. 1 (ILLINOIS) FED. AID PROJECT								
		DATE -	REVISED -		CONTRACT NO. 60E36								



ROUTE: IL 23

CROSS STREETS		DIRECTION (EB/WB) (NB/SB)	LANE NO. (1, 2, 3)	PAVEMENT PATCH WIDTH	PAVEMENT PATCH LENGTH	REPAIR AREA (SQ FT)	REPAIR AREA (SQ YD)	MILL & RESURF	CLASS D PATCH TYPE I	CLASS D PATCH TYPE II	CLASS D PATCH TYPE III	CLASS D PATCH TYPE IV	PAVT MARKING 4"	RAISED REFL PVT MKS
FROM	TO													
I-90	HARMONY ROAD	NB	1	3.0	3.0	9	1		1					
I-90	HARMONY ROAD	NB	1	6.0	3.0	18	2		2					
I-90	HARMONY ROAD	NB	1	6.0	6.0	36	4		4					
I-90	HARMONY ROAD	NB	1	3.0	15.0	45	5			5				
I-90	HARMONY ROAD	NB	1	2.0	12.0	24	3		3					
I-90	HARMONY ROAD	NB	1	2.0	12.0	24	3		3					
I-90	HARMONY ROAD	NB	1	2.0	12.0	24	3		3					
I-90	HARMONY ROAD	NB	1	2.0	12.0	24	3		3					
I-90	HARMONY ROAD	NB	1	6.0	6.0	36	4		4					
I-90	HARMONY ROAD	NB	1	2.0	2.0	4	1		1					
HARMONY ROAD	I-90	EB	1	2.0	12.0	24	3		3					
HARMONY ROAD	I-90	EB	1	2.0	12.0	24	3		3					
HARMONY ROAD	I-90	EB	1	3.0	3.0	9	1		1					
HARMONY ROAD	I-90	EB	1	6.0	6.0	36	4		4					

TOTALS:

38  
SY

33  
SY

5  
SY

FT EACH

ROUTE: IL 31 (Johnsberg Rd. to US 12)

CROSS STREETS		DIRECTION (EB/WB) (NB/SB)	LANE NO. (1, 2, 3)	PAVEMENT PATCH WIDTH	PAVEMENT PATCH LENGTH	REPAIR AREA (SQ FT)	REPAIR AREA (SQ YD)	MILL & RESURF	CLASS D PATCH TYPE I	CLASS D PATCH TYPE II	CLASS D PATCH TYPE III	CLASS D PATCH TYPE IV	PAVT MARKING 4"	RAISED REFL PVT MKS
FROM	TO													
Johnsburg Rd.	Ringwood Rd.	NB	1	12	6	72	8			8				
Johnsburg Rd.	Ringwood Rd.	NB	1	12	6	72	8			8				
Johnsburg Rd.	Ringwood Rd.	NB	1	12	6	72	8			8				
Johnsburg Rd.	Ringwood Rd.	NB	1	12	6	72	8			8				
Johnsburg Rd.	Ringwood Rd.	SB	1	12	6	72	8			8				
Johnsburg Rd.	Ringwood Rd.	SB	1	12	6	72	8			8				
Johnsburg Rd.	Ringwood Rd.	SB	1	12	6	72	8			8				
Johnsburg Rd.	Ringwood Rd.	SB	1	12	50	600	67	67						
Johnsburg Rd.	Ringwood Rd.	SB	1	3	100	300	33	33						
Johnsburg Rd.	Ringwood Rd.	SB	1	12	8	96	11			11				
Ringwood Rd.	Harts Rd.	NB	1	12	6	72	8			8				
Ringwood Rd.	Harts Rd.	NB	1	12	6	72	8			8				
Ringwood Rd.	Harts Rd.	NB	1	12	6	72	8			8				
Ringwood Rd.	Harts Rd.	NB	1	12	6	72	8			8				
Ringwood Rd.	Harts Rd.	NB	1	12	6	72	8			8				
Ringwood Rd.	Harts Rd.	NB	1	12	6	72	8			8				
Ringwood Rd.	Harts Rd.	NB	1	12	6	72	8			8				
Ringwood Rd.	Harts Rd.	SB	1	12	8	96	11			11				
Ringwood Rd.	Harts Rd.	SB	1	6	25	125	14	14						
Ringwood Rd.	Harts Rd.	Centerline		3	100	300	33	33						
Ringwood Rd.	Harts Rd.	Centerline		3	250	750	83	83						
Ringwood Rd.	Harts Rd.	SB	1	12	100	1200	133	133						
Ringwood Rd.	Harts Rd.	Centerline		3	50	150	17	17						
Ringwood Rd.	Harts Rd.	SB	1	12	75	900	100	100						
Ringwood Rd.	Harts Rd.	Centerline		3	50	150	17	17						
Ringwood Rd.	Harts Rd.	Centerline		3	100	300	33	33						
Ringwood Rd.	Harts Rd.	SB	1	12	100	1200	133	133						
Ringwood Rd.	Harts Rd.	SB	1	3	100	300	33	33						
Ringwood Rd.	Harts Rd.	SB	1	12	50	600	67	67						
Harts Rd.	IL Rt. 12	NB	1	12	6	72	8			8				
Harts Rd.	IL Rt. 12	NB	1	12	6	72	8			8				
Harts Rd.	IL Rt. 12	NB	1	12	6	72	8			8				
Harts Rd.	IL Rt. 12	SB	1	12	6	72	8			8				
Harts Rd.	IL Rt. 12	SB	1	12	6	72	8			8				
Harts Rd.	IL Rt. 12	SB	1	12	6	72	8			8				
Harts Rd.	IL Rt. 12	SB	1	12	6	72	8			8				
Harts Rd.	IL Rt. 12	SB	1	12	125	1500	167	167						
Harts Rd.	IL Rt. 12	Centerline		3	75	225	25	25						
Harts Rd.	IL Rt. 12	Centerline		3	500	1500	167	167						
Harts Rd.	IL Rt. 12	NB	1	12	75	900	100	100						
Harts Rd.	IL Rt. 12	Centerline		3	75	225	25	25						
Harts Rd.	IL Rt. 12	NB	1	12	20	240	27	27						
Harts Rd.	IL Rt. 12	NB	1	12	15	180	20				20			
Harts Rd.	IL Rt. 12	NB	1	12	15	180	20				20			
Harts Rd.	IL Rt. 12	Centerline		3	100	300	33	33						

TOTALS: 1561 SY 1307 SY 214 SY 40 SY FT EACH

CROSS STREETS		DIRECTION (EB/WB) (NB/SB)	LANE NO. (1, 2, 3)	PAVEMENT PATCH WIDTH	PAVEMENT PATCH LENGTH	REPAIR AREA (SQ FT)	REPAIR AREA (SQ YD)	MILL & RESURF	CLASS C PATCH TYPE I	CLASS C PATCH TYPE II	CLASS C PATCH TYPE III	CLASS C PATCH TYPE IV	PAVT MARKING 4"	RAISED REFL PVT MKS
FROM	TO													
<b>Crystal Lake</b>														
Rakow Rd.	Three Oaks Rd.													
PCC PAVT SECTION		SB	2	6	15	90	10			10				
		NB	1	12	6	72	8			8				
		SB	2	12	8	96	11			11				
		NB	1	12	15	180	20				20			
		NB	2	12	15	180	20				20			
		SB	1	12	15	180	20				20			
		SB	2	12	15	180	20				20			

TOTALS: 109 SY 29 SY 80 SY FT EACH



ROUTE: IL 173

CROSS STREETS		DIRECTION (EB/WB) (NB/SB)	LANE NO. (1, 2, 3)	PAVEMENT PATCH WIDTH	PAVEMENT PATCH LENGTH	REPAIR AREA (SQ FT)	REPAIR AREA (SQ YD)	MILL & RESURF	CLASS D PATCH TYPE I	CLASS D PATCH TYPE II	CLASS D PATCH TYPE III	CLASS D PATCH TYPE IV	PAVT MARKING 4"	RAISED REFL PVT MKS
FROM	TO													
ROUTE 47	PRICE ROAD	EB	1	6.0	12.0	72	8	8						
ROUTE 47	PRICE ROAD	EB	1	6.0	6.0	36	4	4						
ALLIGATOR CRACKING AND SMALL POTHOLES WIDTH 26' TOTAL LENGTH = 0.5 MILES						68840	7627	7627						
PRICE ROAD	JOHNSON ROAD	WB	1	4.0	4.0	16	2	2						
PRICE ROAD	JOHNSON ROAD	WB	1	6.0	6.0	36	4	4						
PRICE ROAD	JOHNSON ROAD	WB	1	6.0	12.0	72	8	8						
PRICE ROAD	JOHNSON ROAD	WB	1	6.0	12.0	72	8	8						
PRICE ROAD	JOHNSON ROAD	WB	1	6.0	12.0	72	8	8						
PRICE ROAD	JOHNSON ROAD	WB	1	6.0	12.0	72	8	8						
PRICE ROAD	JOHNSON ROAD	WB	1	6.0	6.0	36	4		4					
PRICE ROAD	JOHNSON ROAD	WB	1	5.0	5.0	25	3		3					
PRICE ROAD	JOHNSON ROAD	WB	1	6.0	12.0	72	8			8				
RIGHT WHEEL LANE JOINT		WB	1	1.5	0.4 Miles	3168	352	352						
PRICE ROAD	JOHNSON ROAD	EB	1	3.0	3.0	9	1	1						
PRICE ROAD	JOHNSON ROAD	EB		3.0	3.0	9	1	1						
PRICE ROAD	JOHNSON ROAD	EB		3.0	6.0	18	2	2						
JOHNSON ROAD	PRICE ROAD	EB	1	6.0	12.0	72.0	8	8						
JOHNSON ROAD	PRICE ROAD	EB	1	6.0	6.0	36.0	4	4						
JOHNSON ROAD	PRICE ROAD	EB	1	6.0	6.0	36.0	4	4						
JOHNSON ROAD	PRICE ROAD	EB	1	6.0	6.0	36.0	4	4						
JOHNSON ROAD	PRICE ROAD	EB	1	6.0	6.0	36.0	4	4	4					
JOHNSON ROAD	PRICE ROAD	EB	1	6.0	6.0	36.0	4	4	4					
JOHNSON ROAD	PRICE ROAD	EB	1	6.0	6.0	36.0	4	4	4					
WHEEL LANE JOINT - RIGHT		EB	1	1.5	0.4 miles	3168.0	352	352						
CENTERLINE JOINT		EB	1	1.5	300.0	4500.0	500	500						
JOHNSON ROAD	ALDEN ROAD	WB	1	3.0	3.0	9.0	1	1						
JOHNSON ROAD	ALDEN ROAD	WB	1	3.0	3.0	9.0	1	1						
1 MILE WEST OF JOHNSON ROAD		WB	1	3.0	5.0	15.0	2	2						
1 MILE WEST OF JOHNSON ROAD		WB	1	3.0	3.0	9.0	1	1						
FRENCH DRIVE		WB	1	2.0	12.0	24.0	3	3						
FRENCH DRIVE		WB	1	3.0	3.0	9.0	1	1						
FRENCH DRIVE		WB	1	2.0	12.0	24.0	3	3						
FINK ROAD		WB	1	6.0	15.0	90.0	10			10				
FINK ROAD		WB	1	2.0	12.0	24.0	3	3						
JOHNSON ROAD	ALDEN ROAD	WB	1	2.0	12.0	24.0	3	3						
JOHNSON ROAD	ALDEN ROAD	WB	1	2.0	12.0	24.0	3	3						
JOHNSON ROAD	ALDEN ROAD	WB	1	2.0	12.0	24.0	3	3						
JOHNSON ROAD	ALDEN ROAD	WB	1	2.0	12.0	24.0	3	3						
ALDEN ROAD	JOHNSON ROAD	EB	1	2.0	3.0	6.0	1	1						
ALDEN ROAD	JOHNSON ROAD	EB	1	2.0	3.0	6.0	1	1						
ALDEN ROAD	JOHNSON ROAD	EB	1	2.0	2.0	4.0	1	1						
RIGHT WHEEL LANE JOINT		EB	1	1.5	30.0	45.0	5	5						
RIGHT WHEEL LANE JOINT		EB	1	1.5	50.0	75.0	8	8						
RIGHT WHEEL LANE JOINT		EB	1	2.0	3.0	6.0	1	1						
1/2 MILE EASE OF ALDEN		EB	1	2.0	15.0	30.0	3	3						
1/2 MILE EASE OF ALDEN		EB	1	3.0	3.0	9.0	1	1						
1/2 MILE EASE OF ALDEN		EB	1	2.0	10.0	20.0	2	2						
1/2 MILE EASE OF ALDEN		EB	1	2.0	10.0	20.0	2	2						
1 MILE EASE OF ALDEN		EB	1	2.0	10.0	20.0	2	2						
1 MILE EASE OF ALDEN		EB	1	2.0	13.0	26.0	3	3						
1 MILE EASE OF ALDEN		EB	1	3.0	6.0	18.0	2	2						
RIGHT WHEEL LANE JOINT		EB	1	3.0	100.0	300.0	33	33						
ALDEN ROAD	JOHNSON	EB	1	3.0	3.0	9.0	1	1						
ALDEN ROAD	JOHNSON	EB	1	3.0	3.0	9.0	1	1						
FINK ROAD RIGHT WHEEL LANE JOINT		EB	1	3.0	20.0	60.0	7	7						
FINK ROAD RIGHT WHEEL LANE JOINT		EB	1	3.0	3.0	9.0	1	1						
1.6 MILE E OF ALDEN ROAD		EB	1	2.0	50.0	100.0	11	11						
1.7 MILE E OF ALDEN ROAD		EB	1	2.0	100.0	200.0	22	22						
1.7 MILE E OF ALDEN ROAD		EB	1	2.0	50.0	100.0	11	11						
1.7 MILE E OF ALDEN ROAD		EB	1	3.0	13.0	39.0	4	4						
1.7 MILE E OF ALDEN ROAD		EB	1	2.0	20.0	40.0	4	4						
1.8 MILE E OF ALDEN ROAD		EB	1	2.0	30.0	60.0	7	7						
FRENCH DRIVE		EB	1	2.0	200.0	400.0	44	44						
1.9 MILE E OF ALDEN ROAD		EB	1	2.0	100.0	200.0	22	22						

TOTALS:

9176 SY      9139 SY      19 SY      18 SY

FT EACH

FILE NAME = c:\projects\dl36188\design_aa.dgn	USER NAME = wilgreenp	DESIGNED -	REVISED -	<b>STATE OF ILLINOIS DEPARTMENT OF TRANSPORTATION</b>	<b>PATCHING SCHEDULE IL 173</b>				F.A.P. RTE. VAR.	SECTION 2008-010 PP	COUNTY MCHENRY	TOTAL SHEETS 27	SHEET NO. 14
PLOT SCALE = 1/8" = 1' / IN.	CHECKED -	REVISED -	REVISED -		SCALE:	SHEET NO.	OF	SHEETS	STA.	TO STA.	FED. ROAD DIST. NO. 1 (ILLINOIS) FED. AID PROJECT		
PLOT DATE = 3/14/2008	DATE -	REVISED -	REVISED -		CONTRACT NO. 60E36								











ROUTE: IL 173 (IL 47 to Lake County Line)

CROSS STREETS		DIRECTION (EB/WB) (NB/SB)	LANE NO. (1, 2, 3)	PAVEMENT PATCH WIDTH	PAVEMENT PATCH LENGTH	REPAIR AREA (SQ FT)	REPAIR AREA (SQ YD)	MILL & RERSURF	CLASS D PATCH TYPE I	CLASS D PATCH TYPE II	CLASS D PATCH TYPE III	CLASS D PATCH TYPE IV	PAVT MARKING 4"	RAISED REFL PVT MKS
FROM	TO													
Zarnstorff	Richardson	EB		12	6	72	8			8				
Zarnstorff	Richardson	EB		12	6	72	8			8				
Zarnstorff	Richardson	EB		12	6	72	8			8				
Zarnstorff	Richardson	EB		12	6	72	8			8				
Zarnstorff	Richardson	WB		12	6	72	8			8				
Zarnstorff	Richardson	WB		12	6	72	8			8				
Zarnstorff	Richardson	WB		12	6	72	8			8				
Zarnstorff	Richardson	WB		12	6	72	8			8				
Zarnstorff	Richardson	WB		12	6	72	8			8				
Zarnstorff	Richardson	WB		12	6	72	8			8				
Zarnstorff	Richardson	EB		12	50	600	67	67						
Zarnstorff	Richardson	WB		3	400	1200	133	133						
Zarnstorff	Richardson	EB		3	400	1200	133	133						
Zarnstorff	Richardson	WB		12	6	72	8			8				
Zarnstorff	Richardson	WB		12	6	72	8			8				
Zarnstorff	Richardson	WB		12	6	72	8			8				
Zarnstorff	Richardson	WB		12	6	72	8			8				
Zarnstorff	Richardson	WB		12	6	72	8			8				
Zarnstorff	Richardson	WB		12	6	72	8			8				
Zarnstorff	Richardson	WB		12	6	72	8			8				
Zarnstorff	Richardson	EB		12	6	72	8			8				
Zarnstorff	Richardson	EB		12	6	72	8			8				
Zarnstorff	Richardson	EB		12	6	72	8			8				
Zarnstorff	Richardson	EB		12	6	72	8			8				
Zarnstorff	Richardson	EB		12	6	72	8			8				
Zarnstorff	Richardson	EB		12	6	72	8			8				
Zarnstorff	Richardson	EB		12	6	72	8			8				
Richardson	Siedschlag Rd.	EB		3	100	300	33	33						
Richardson	Siedschlag Rd.	WB		3	100	300	33	33						
Richardson	Siedschlag Rd.	WB		3	250	750	83	83						
Richardson	Siedschlag Rd.	EB		12	50	600	67	67						
Richardson	Siedschlag Rd.	WB		3	400	1200	133	133						
Richardson	Siedschlag Rd.	EB		12	6	72	8			8				
Richardson	Siedschlag Rd.	EB		12	6	72	8			8				
Richardson	Siedschlag Rd.	EB		12	6	72	8			8				
Richardson	Siedschlag Rd.	EB		12	6	72	8			8				
Richardson	Siedschlag Rd.	EB		12	6	72	8			8				
Richardson	Siedschlag Rd.	WB		12	6	72	8			8				
Richardson	Siedschlag Rd.	WB		12	6	72	8			8				
Richardson	Siedschlag Rd.	WB		12	6	72	8			8				
Richardson	Siedschlag Rd.	WB		12	6	72	8			8				
Richardson	Siedschlag Rd.	WB		12	6	72	8			8				
Siedschlag Rd.	Lake Co. Line	WB		3	100	300	33	33						
Siedschlag Rd.	Lake Co. Line	WB		3	80	240	27	27						
Siedschlag Rd.	Lake Co. Line	WB		12	6	72	8			8				
Siedschlag Rd.	Lake Co. Line	WB		12	6	72	8			8				
Siedschlag Rd.	Lake Co. Line	WB		12	6	72	8			8				
Siedschlag Rd.	Lake Co. Line	WB		12	6	72	8			8				
Siedschlag Rd.	Lake Co. Line	WB		12	6	72	8			8				
Siedschlag Rd.	Lake Co. Line	EB		12	6	72	8			8				
Siedschlag Rd.	Lake Co. Line	EB		12	6	72	8			8				
Siedschlag Rd.	Lake Co. Line	EB		12	6	72	8			8				
Siedschlag Rd.	Lake Co. Line	EB		12	6	72	8			8				
Siedschlag Rd.	Lake Co. Line	EB		12	6	72	8			8				

TOTALS: 7250 SY 5895 SY 1318 SY 27 SY FT EACH









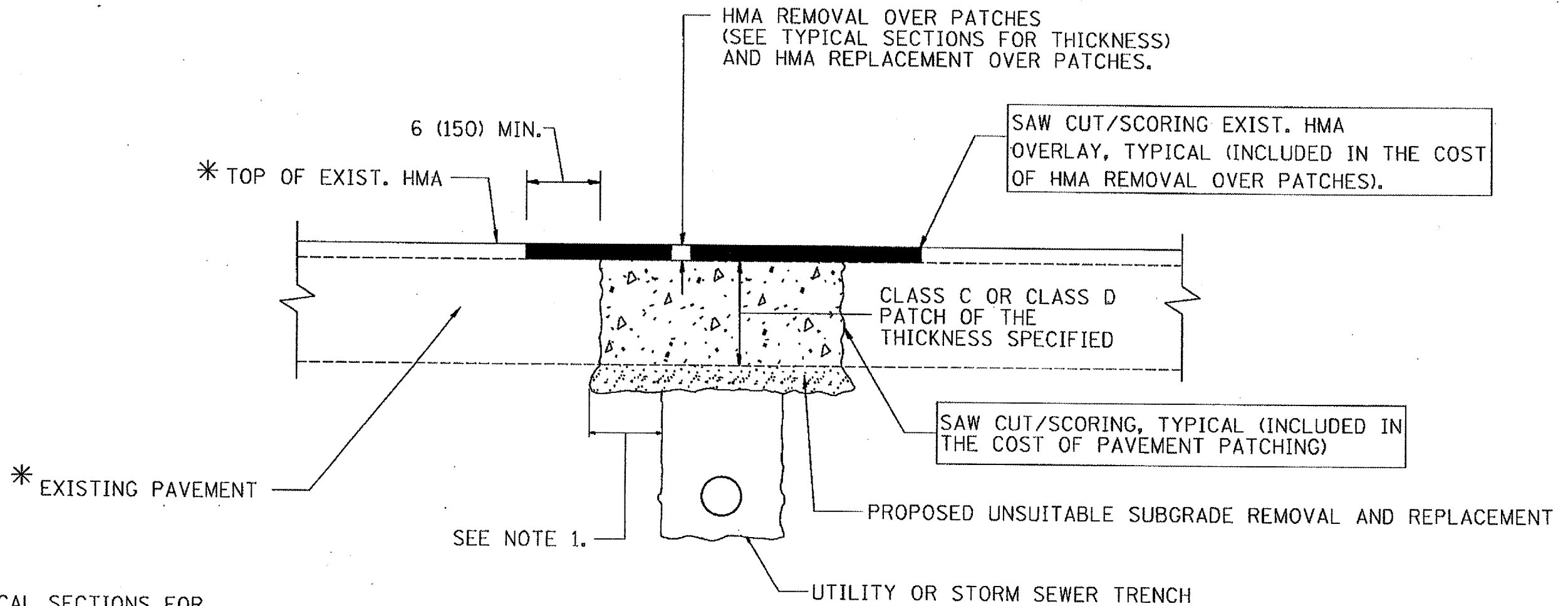

\* SEE TYPICAL SECTIONS FOR THICKNESS AND MATERIALS

**NOTES:**

1. THE WIDTH OF THE FULL DEPTH PATCH OVER A TRENCH SHALL BE 12 (300) WIDER ON EACH SIDE OF THE TRENCH.
2. FOR METHOD OF MEASUREMENT AND BASIS OF PAYMENT, SEE RECURRING SPECIAL PROVISION "PATCHING WITH HOT-MIX ASPHALT OVERLAY REMOVAL".
3. THE TOP 1/2 INCHES OF PROPOSED HOT-MIX ASPHALT REPLACEMENT OVER PATCHES SHALL BE HOT-MIX ASPHALT SURFACE COURSE, MIX "D", N70. THE COST SHALL BE INCLUDED IN THE COST OF THE PAY ITEM FOR HOT-MIX ASPHALT REPLACEMENT OVER PATCHES.

**SEQUENCE OF CONSTRUCTION**

1. REMOVE THE EXISTING HMA MATERIAL OVER THE AREA TO BE PATCHED.
2. REMOVE AND REPLACE FULL DEPTH PATCHES
3. REPLACE HMA MATERIAL OVER THE AREA TO BE PATCHED.

(4-9-08)

ALL DIMENSIONS ARE IN INCHES (MILLIMETERS) UNLESS OTHERWISE SHOWN.

FILE NAME *	USER NAME * wlgreendp	DESIGNED - R. SHAH	REVISED - A. ABBAS 01-20-98	<b>STATE OF ILLINOIS DEPARTMENT OF TRANSPORTATION</b>	<b>SPECIAL DETAIL PAVEMENT PATCHING FOR HMA SURFACED PAVEMENT</b>	F.A. RTE.	SECTION	COUNTY	TOTAL SHEETS	SHEET NO.
\\distin\fs2\users\wlgreendp\Desk\top\bd22.dgn	DRAWN -	REVISED - A. ABBAS 04-27-98	VAR.			2008-010 PP	MCHENRY	27	22	
PLOT SCALE = 100.000' / IN.	CHECKED -	REVISED - R. BORO 01-01-07	BD400-04 (BD-22)			CONTRACT NO. 60E36				
PLOT DATE = 4/9/2008	DATE - 10-25-94	REVISED - R. BORO 09-04-07	FED. ROAD DIST. NO. 1 ILLINOIS FED. AID PROJECT							
				SCALE: NONE	SHEET NO. 1 OF 1 SHEETS	STA.	TO STA.			



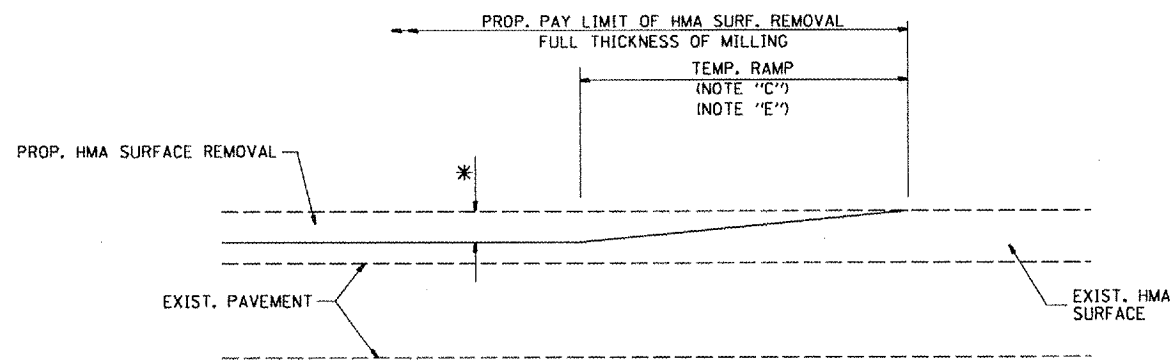

MILLED TEMPORARY RAMP  
(FOR BUTT JOINT AND HMA TAPER SEE DETAIL BELOW)

**OPTION 1**

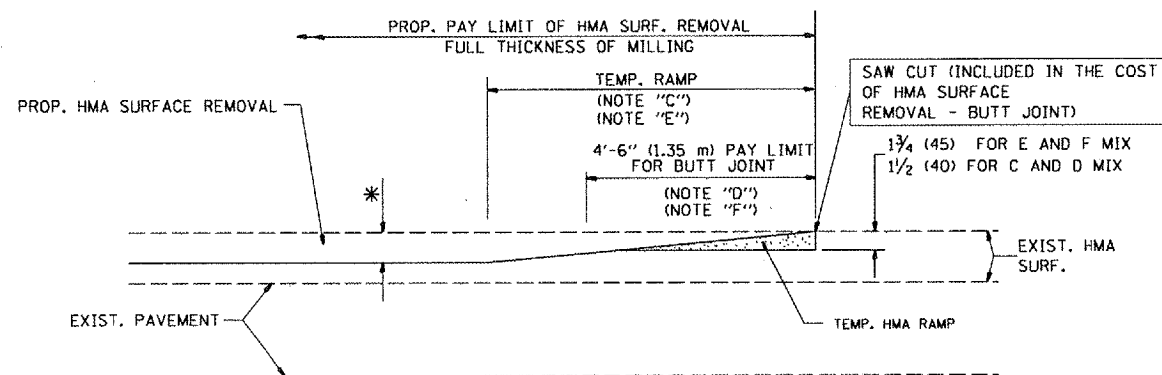

HMA CONSTRUCTED TEMPORARY RAMP  
(FOR BUTT JOINT AND HMA TAPER SEE DETAIL BELOW)

**OPTION 2**  
**TYPICAL TEMPORARY RAMP**

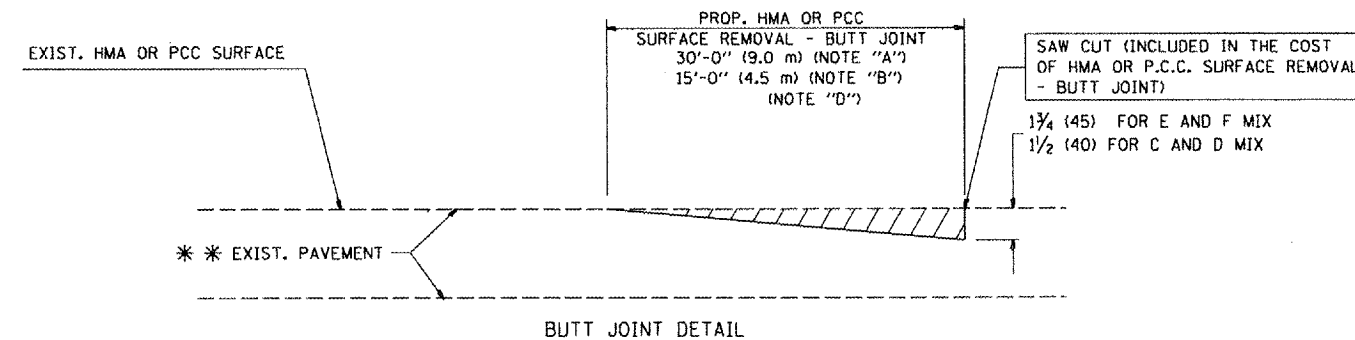

BUTT JOINT DETAIL

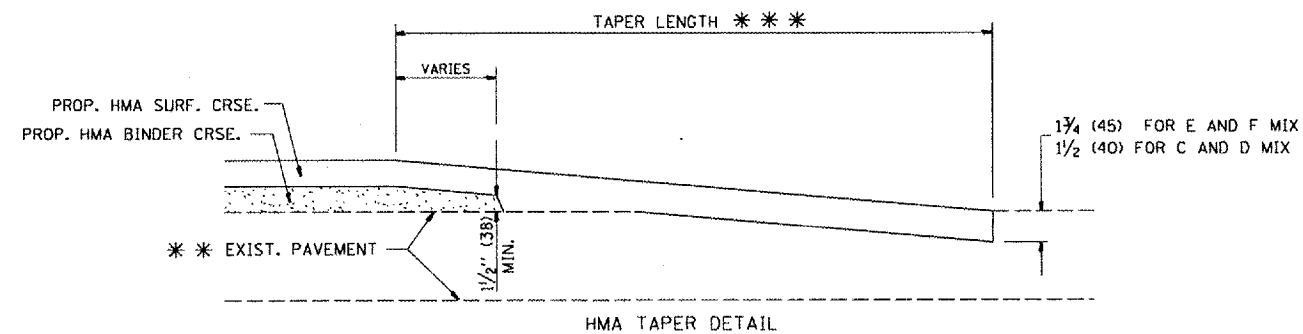

HMA TAPER DETAIL

**TYPICAL BUTT JOINT AND HMA TAPER FOR RESURFACING ONLY**

\*\*\* PC CONCRETE, HMA OR HMA RESURFACED PAVEMENT.

**NOTES**

- A: MAINLINE ROADWAYS AND MAJOR SIDE ROADS.
  - B: MINOR SIDE ROADS.
  - C: THE TEMP. RAMP SHALL BE CONSTRUCTED IMMEDIATELY UPON REMOVAL OF THE EXISTING HMA SURFACE.
  - D: THE BUTT JOINT SHALL BE CONSTRUCTED IMMEDIATELY PRIOR TO PLACING THE PROPOSED HMA COURSES.
  - E: TAPER THE TEMP. RAMP AT A RATE OF 3'-0" (900 mm) PER 1 INCH (25 mm) OF MILLING THICKNESS.
  - F: INSTALLATION AND REMOVAL OF THE 4'-6" (1.35 m) TEMP. RAMP IS INCLUDED IN COST OF HMA SURFACE REMOVAL - BUTT JOINT
  - G: SEE ARTICLE 406.08 AND 406.14 OF THE STANDARD SPECIFICATIONS FOR "HMA AND/OR PCC SURFACE REMOVAL, BUTT JOINT".
- \* SEE TYPICAL SECTIONS FOR MILLING THICKNESS.
- \*\*\* 20'-0" (6.1 m) PER 1 (25) RESURFACING (NOTE "A")  
10'-0" (3.0 m) PER 1 (25) RESURFACING (NOTE "B")

**BASIS OF PAYMENT:**

THE BUTT JOINT WILL BE PAID FOR AT THE CONTRACT UNIT PRICE PER SQUARE YARD (SQUARE METER) FOR "HOT-MIX ASPHALT SURFACE REMOVAL - BUTT JOINT" OR FOR "PORTLAND CEMENT CONCRETE SURFACE REMOVAL - BUTT JOINT".

ALL DIMENSIONS ARE IN INCHES (MILLIMETERS) UNLESS OTHERWISE SHOWN.

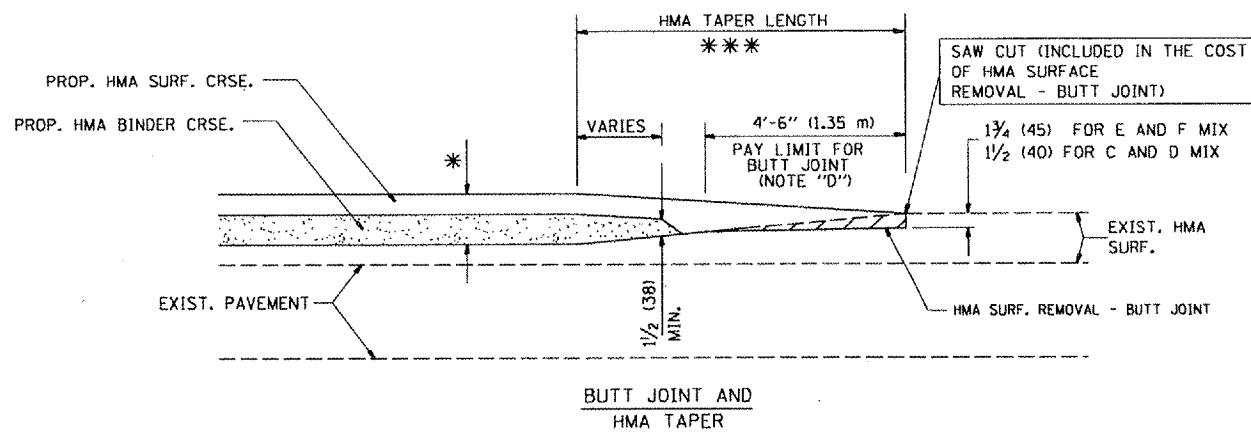

**TYPICAL BUTT JOINT AND HMA TAPER FOR MILLING AND RESURFACING**

FILE NAME = W:\statato\22x34\bd32.dgn	USER NAME = amzchk1	DESIGNED - M. DE YONG	REVISED - R. SHAH 10-25-94
		DRAWN -	REVISED - A. ABBAS 03-21-97
	PLOT SCALE = 1/8" = 1'-0"	CHECKED -	REVISED - M. GOMEZ 04-06-01
	PLOT DATE = 3/14/2008	DATE - 06-13-90	REVISED - R. BORO 01-01-07

**STATE OF ILLINOIS  
DEPARTMENT OF TRANSPORTATION**

<b>BUTT JOINT AND HMA TAPER DETAILS</b>		F.A. RTE.	SECTION	COUNTY	TOTAL SHEETS	SHEET NO.
SCALE: NONE	SHEET NO. 1 OF 1 SHEETS	VAR	2008-010 PP	McHENRY	27	23
	STA. TO STA.	BD400-05 BD32		CONTRACT NO. 60E36		
FED. ROAD DIST. NO. 1 ILLINOIS FED. AID PROJECT						

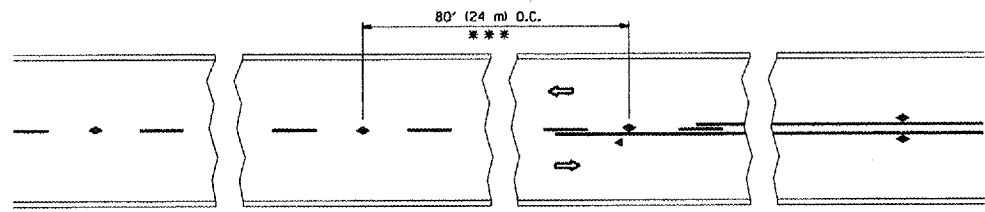

\*\*\* REDUCE TO 40' (12 m) O.C. ON CURVES WITH POSTED OR ADVISORY SPEED 45 M.P.H. (70 km/h) OR LESS.

TWO-LANE/TWO-WAY

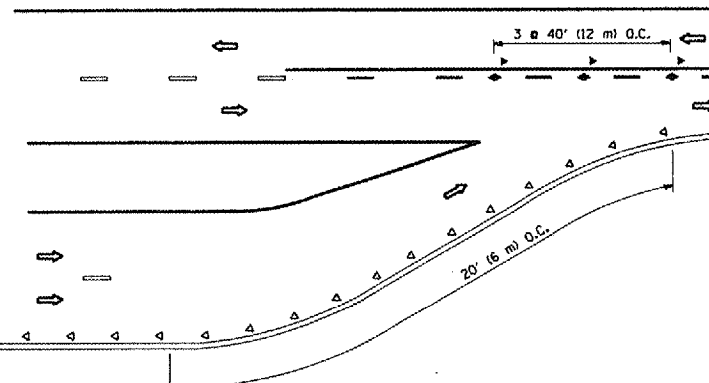

LANE REDUCTION TRANSITION

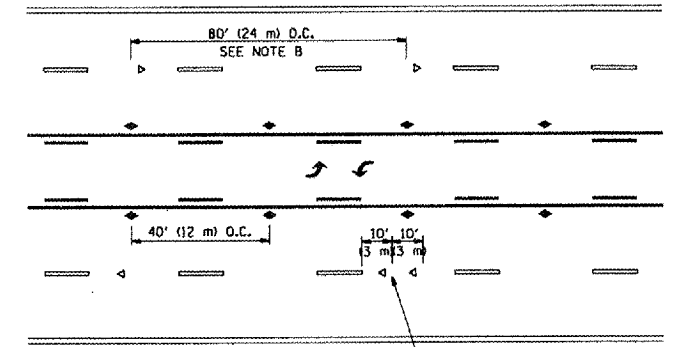

TWO-WAY LEFT TURN

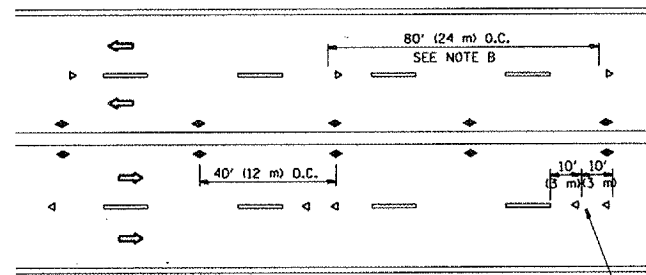

MULTI-LANE/UNDIVIDED

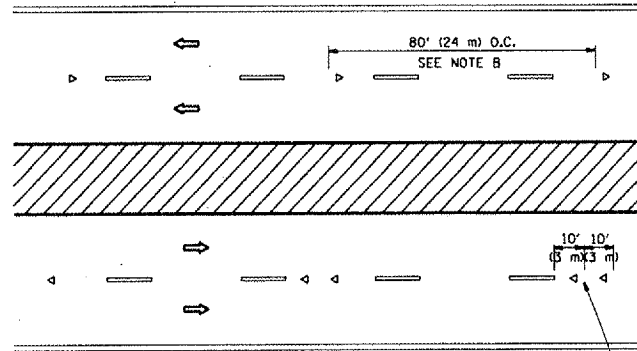

MULTI-LANE/DIVIDED

GENERAL NOTES

1. MARKERS USED WITH DASHED LINES SHALL BE CENTERED IN THE GAP BETWEEN SEGMENTS.
2. MARKERS USED ADJACENT TO SOLID LINES SHALL BE OFFSET 2 TO 3 (50 TO 75) TOWARD TRAFFIC AS SHOWN.
3. MARKERS THROUGH TANGENTS LESS THAN 500' (150 m) IN LENGTH BETWEEN CURVES SHALL BE INSTALLED AT THE LESSER OF THE TWO CURVE SPACINGS.

SYMBOLS

- YELLOW STRIPE
- WHITE STRIPE
- ◀ ONE-WAY AMBER MARKER
- ◁ ONE-WAY CRYSTAL MARKER (W/O)
- ◆ TWO-WAY AMBER MARKER

LANE MARKER NOTES

- B. REDUCE TO 40' (12 m) O.C. ON CURVES WHERE ADVISORY SPEEDS ARE 10 M.P.H. (20 km/h) LOWER THAN POSTED SPEEDS.
- A. USE DOUBLE LANE LINE MARKERS SPACED AS SHOWN.

DESIGN NOTES

1. DOUBLE LANE LINE MARKERS SHALL BE USED UNLESS SPECIFIED OTHERWISE.
2. EXCEPT AS SHOWN ON THE LANE REDUCTION TRANSITION AND FREEWAY EXIT RAMP DETAIL, MARKERS ARE NOT TO BE SPECIFIED ON RIGHT EDGE LINES.
3. THE EXACT MARKER LIMITS, SPACING, AND COLOR SHOULD BE INCLUDED IN THE PLANS.
4. MARKERS SHOULD NOT BE USED ALONGSIDE CURBS EXCEPT FOR EXTREMELY SHORT SECTIONS OF CURBS WHERE NOT MORE THAN TWO MARKERS WOULD BE INVOLVED.

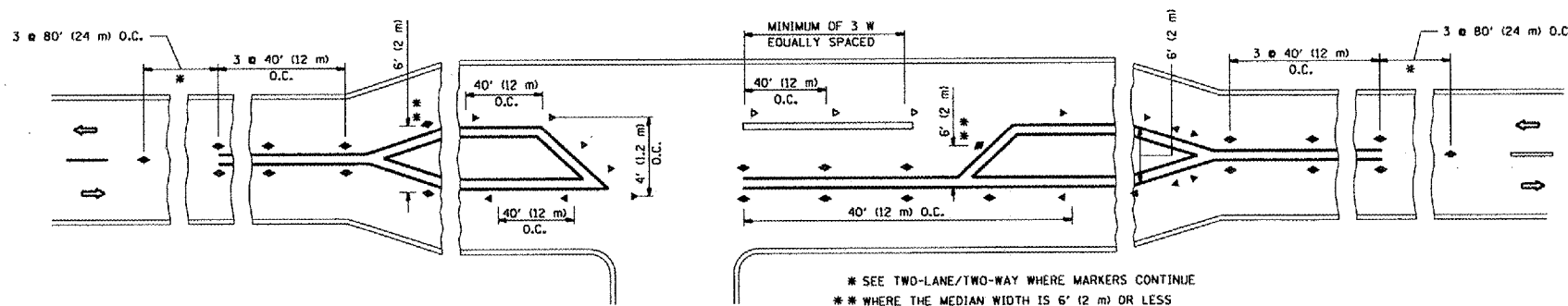

LEFT TURN

\* SEE TWO-LANE/TWO-WAY WHERE MARKERS CONTINUE  
 \*\* WHERE THE MEDIAN WIDTH IS 6' (2 m) OR LESS USE TWO-WAY MARKERS.

All dimensions are in inches (millimeters) unless otherwise shown.

FILE NAME = W:\distatd\22x34\toll.dgn	USER NAME = amthkl	DESIGNED -	REVISED - T. RAMMACHER 09-19-94
		DRAWN -	REVISED - T. RAMMACHER 03-12-99
	PLLOT SCALE = 1/83.705' / IN.	CHECKED -	REVISED - T. RAMMACHER 01-06-00
	PLLOT DATE = 3/14/2008	DATE -	REVISED -

STATE OF ILLINOIS  
 DEPARTMENT OF TRANSPORTATION

TYPICAL APPLICATIONS		F.A. -	SECTION	COUNTY	TOTAL SHEETS	SHEET NO.
RAISED REFLECTIVE PAVEMENT MARKERS (SNOW-PLOW RESISTANT)		RTE.	2008-010PP	McHENRY	27	24
SCALE: NONE	SHEET NO. 1 OF 1 SHEETS	STA.	TC-11	CONTRACT NO. 60E36		
		TO STA.	FED. ROAD DIST. NO. 1 ILLINOIS FED. AID PROJECT			

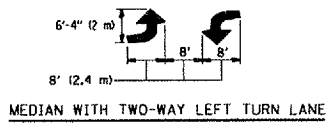
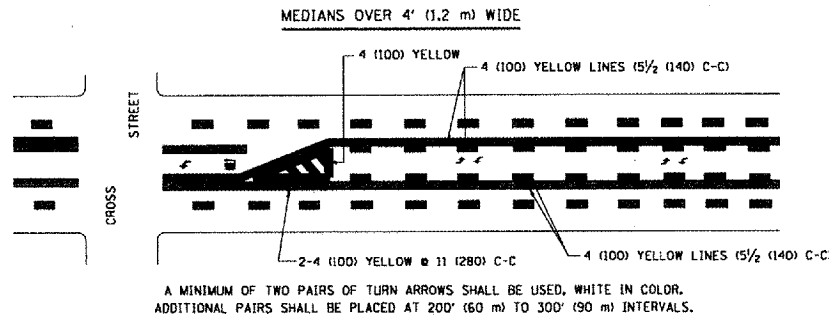
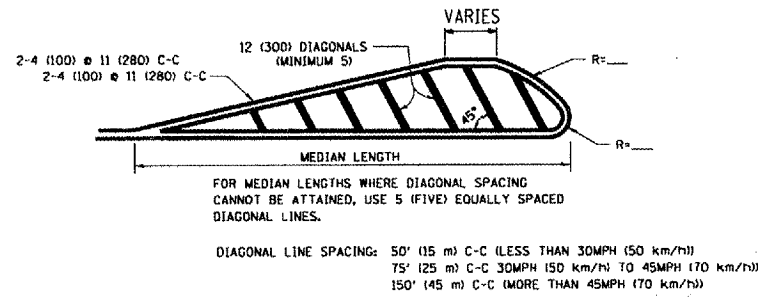
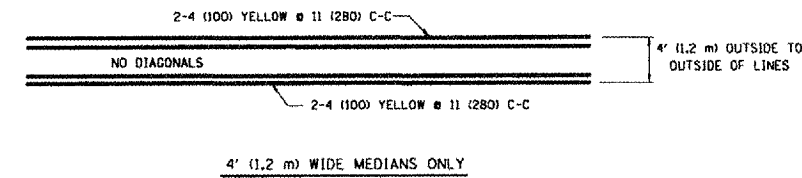
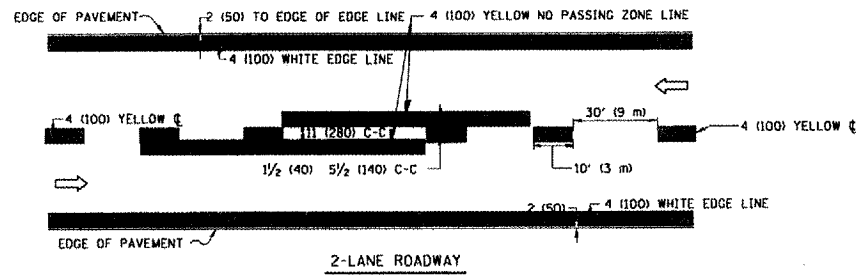

TYPICAL PAINTED MEDIAN MARKING

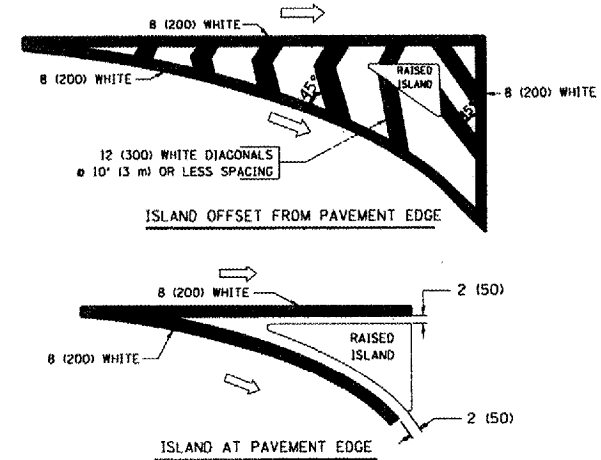

TYPICAL ISLAND MARKING

TYPE OF MARKING	WIDTH OF LINE	PATTERN	COLOR	SPACING / REMARKS
CENTERLINE ON 2 LANE PAVEMENT	4 (100)	SKIP-DASH	YELLOW	10' (3 m) LINE WITH 30' (9 m) SPACE
CENTERLINE ON MULTI-LANE UNDIVIDED PAVEMENT	2 @ 4 (100)	SOLID	YELLOW	11 (280) C-C
NO PASSING ZONE LINES: FOR ONE DIRECTION FOR BOTH DIRECTIONS	4 (100) 2 @ 4 (100)	SOLID SOLID	YELLOW YELLOW	5 1/2 (140) C-C FROM SKIP-DASH CENTERLINE 11 (280) C-C OMIT SKIP-DASH CENTERLINE BETWEEN
LANE LINES	4 (100) 5 (125) ON FREEWAYS	SKIP-DASH SKIP-DASH	WHITE WHITE	10' (3 m) LINE WITH 30' (9 m) SPACE
DOTTED LINES (EXTENSIONS OF CENTER, LANE OR TURN LANE MARKINGS)	SAME AS LINE BEING EXTENDED	SKIP-DASH	SAME AS LINE BEING EXTENDED	2' (600) LINE WITH 6' (1.8 m) SPACE
EDGE LINES	4 (100)	SOLID	YELLOW-LEFT WHITE-RIGHT	OUTLINE MOUNTABLE MEDIANS IN YELLOW; EDGE LINES ARE NOT USED NEXT TO BARRIER CURB
TURN LANE MARKINGS	6 (150) LINES: FULL SIZE LETTERS & SYMBOLS 18" (2.4m)	SOLID	WHITE	SEE TYPICAL TURN LANE MARKING DETAIL
TWO WAY LEFT TURN MARKING	2 @ 4 (100) EACH DIRECTION 8' (2.4m) LEFT ARROW	SKIP-DASH AND SOLID IN PAIRS	YELLOW WHITE	10' (3 m) LINE WITH 30' (9 m) SPACE FOR SKIP-DASH; 5 1/2 (140) C-C BETWEEN SOLID LINE AND SKIP-DASH LINE SEE TYPICAL TWO-WAY LEFT TURN MARKING DETAIL
CROSSWALK LINES (PEDESTRIAN) A. DIAGONALS (BIKE & EQUESTRIAN) B. LONGITUDINAL BARS (SCHOOL)	2 @ 6 (150) 12 (300) @ 45° 12 (300) @ 90°	SOLID SOLID SOLID	WHITE WHITE WHITE	NOT LESS THAN 6' (1.8 m) APART 2' (600) APART SEE TYPICAL CROSSWALK MARKING DETAILS.
STOP LINES	24 (600)	SOLID	WHITE	PLACE 4' (1.2 m) IN ADVANCE OF AND PARALLEL TO CROSSWALK, IF PRESENT. OTHERWISE, PLACE AT DESIRED STOPPING POINT, PARALLEL TO CROSSROAD CENTERLINE, WHERE POSSIBLE
PAINTED MEDIANS	2 @ 4 (100) WITH 12 (300) DIAGONALS @ 45° NO DIAGONALS USED FOR 4' (1.2 m) WIDE MEDIANS	SOLID	YELLOW; TWO WAY TRAFFIC WHITE; ONE WAY TRAFFIC	11 (280) C-C FOR THE DOUBLE LINE SEE TYPICAL PAINTED MEDIAN MARKING.
CORE MARKING AND CHANNELIZING LINES	8 (200) WITH 12 (300) DIAGONALS @ 45°	SOLID	WHITE	DIAGONALS: 15' (4.5 m) C-C (LESS THAN 30MPH (50 km/h)) 20' (6 m) C-C 30MPH (50 km/h) TO 45MPH (70 km/h) 30' (9 m) C-C (OVER 45MPH (70 km/h))
RAILROAD CROSSING	24 (600) TRANSVERSE LINES; "RR" IS 6' (1.8 m) LETTERS; 16 (400) LINE FOR "X"	SOLID	WHITE	SEE STATE STANDARD 780001 AREA OF: "R"=3.6 SQ. FT. (0.33 m²) EACH "X"=54.0 SQ. FT. (5.0 m²)
SHOULDER DIAGONALS	12 (300) @ 45°	SOLID	WHITE - RIGHT YELLOW - LEFT	50' (15 m) C-C (LESS THAN 30MPH (50 km/h)) 75' (25 m) C-C (30 MPH (50 km/h) TO 45MPH (70 km/h)) 150' (45 m) C-C (OVER 45MPH (70 km/h))

FOR FURTHER DETAILS ON PAVEMENT MARKING REFER TO STANDARD SPECIFICATIONS FOR ROAD AND BRIDGE CONSTRUCTION AND STATE STANDARD 780001.

All dimensions are in inches (millimeter) unless otherwise shown.

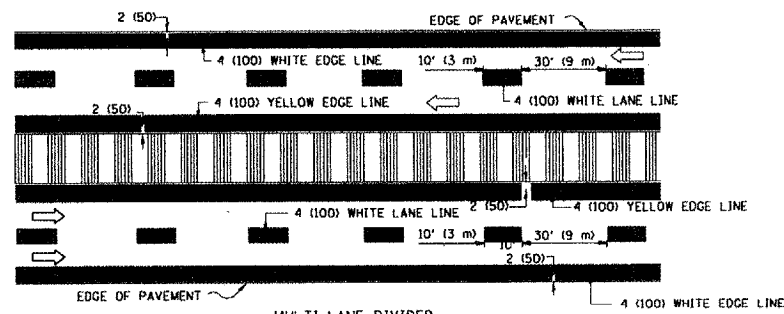
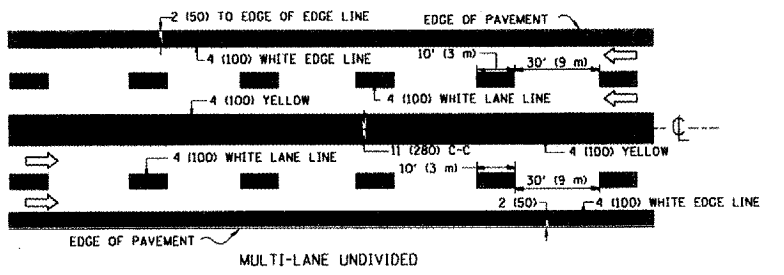

NOTE: MEDIANS WITH BARRIER CURB DO NOT REQUIRE AN EDGE LINE

TYPICAL LANE AND EDGE LINE MARKING

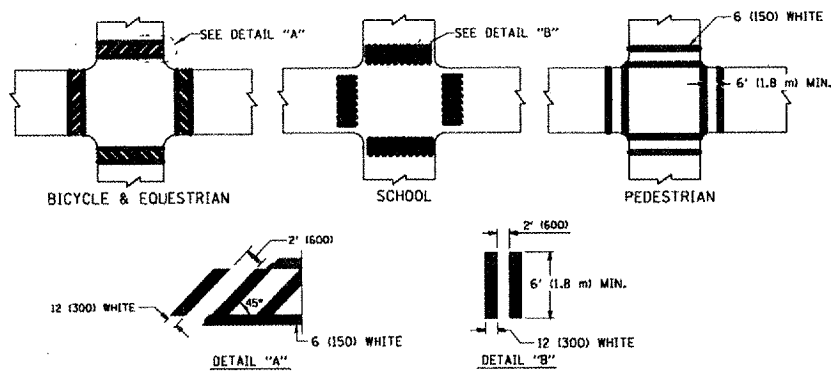

TYPICAL CROSSWALK MARKING

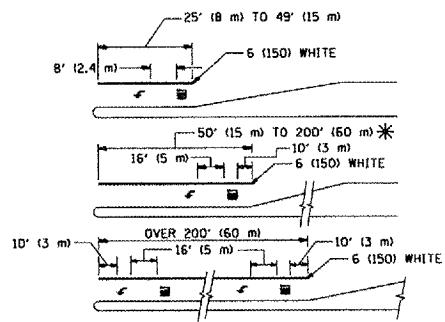

FULL SIZE LETTERS 18" (2.4 m) AND ARROWS SHALL BE USED.  
\* AREA = 15.6 SQ. FT. (1.5 m²) ONLY AREA = 20.8 SQ. FT. (1.9 m²)  
\* TURN LANES IN EXCESS OF 400' (120 m) IN LENGTH MAY HAVE AN ADDITIONAL SET OF ARROW - "ONLY" INSTALLED MIDWAY BETWEEN THE OTHER TWO SETS OF ARROW - "ONLY".

TYPICAL LEFT (OR RIGHT) TURN LANE



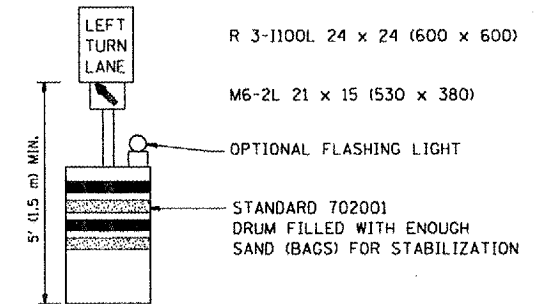
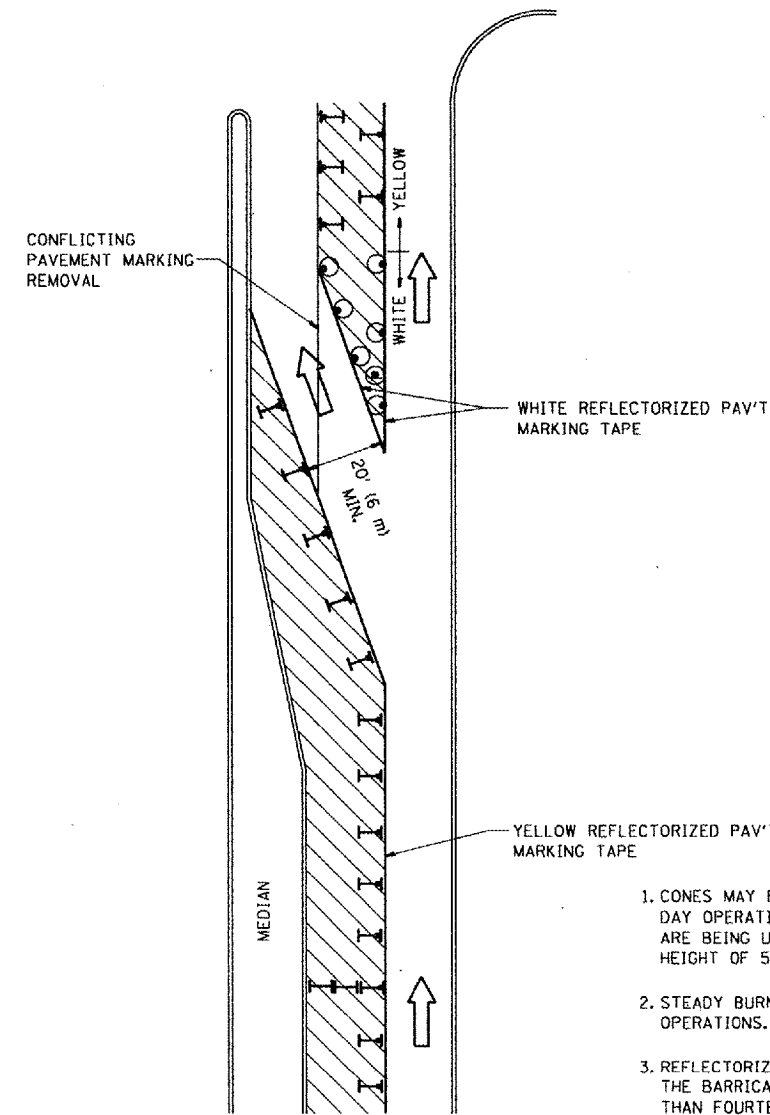

TYPICAL TURN LANE MARKING

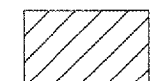
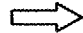
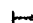

**GENERAL NOTES**

1. CONES MAY BE SUBSTITUTED FOR BARRICADES OR DRUMS AT HALF THE SPACING DURING DAY OPERATIONS. CONES SHALL BE A MINIMUM OF 28 (710) IN HEIGHT. WHEN CONES ARE BEING USED, THE "LEFT TURN LANE" SIGN MAY BE SKID MOUNTED AT A MINIMUM HEIGHT OF 5' (1.5 m).
2. STEADY BURNING LIGHTS WILL NOT BE REQUIRED ON BARRICADES OR DRUMS FOR DAY OPERATIONS. ALL LIGHTS SHALL BE MONODIRECTIONAL.
3. REFLECTORIZED TEMPORARY PAVEMENT MARKING TAPE SHALL BE PLACED THROUGHOUT THE BARRICADED AREA OF EACH TURN BAY WHERE THE CLOSURE TIME IS GREATER THAN FOURTEEN DAYS.
4. THIS APPLICATION ALSO APPLIES WHEN WORK IS BEING PERFORMED IN THE RIGHT LANE(S) AND THE RIGHT TURN BAY IS TO REMAIN OPEN. UNDER THIS CONDITION, "RIGHT TURN LANE" R3-100 24 x 24 (600 x 600) AND M6-2R 21 x 15 (530 x 380) SHALL BE USED.
5. THESE CONTROLS SHALL SUPPLEMENT MAINLINE TRAFFIC CONTROL FOR LANE CLOSURES.
6. LONGITUDINAL DIMENSIONS MAY BE ADJUSTED TO FIT FIELD CONDITIONS.
7. FORM BT 725 IS REQUIRED.
8. TRAFFIC CONTROL AND PROTECTION AT TURN BAYS (TO REMAIN OPEN TO TRAFFIC) SHALL BE INCLUDED IN THE COST SPECIFIED TRAFFIC CONTROL STANDARDS OR ITEMS.

**LEGEND**

-  WORK AREA
-  LANE OPEN TO TRAFFIC
-  TYPE I OR II BARRICADE WITH STEADY BURN LIGHT
-  DRUM WITH STEADY BURN LIGHT
-  DRUM WITH SIGN (WITH OPTIONAL FLASHING LIGHT) SEE DETAIL
-  TYPE I OR II CHECK BARRICADE WITH FLASHING LIGHT

All dimensions are in inches (millimeters) unless otherwise shown.

FILE NAME =	USER NAME = amthkl	DESIGNED -	REVISED -T. RAMMACHER 09-08-94
W:\diststd\22x34\td14.dgn		DRAWN -	REVISED - A. HOUSEH 11-07-95
		PLOT SCALE = 1/8" = 1'-0"	REVISED - A. HOUSEH 10-12-96
		PLOT DATE = 3/14/2000	REVISED -T. RAMMACHER 01-06-00
		DATE -	

**STATE OF ILLINOIS  
DEPARTMENT OF TRANSPORTATION**

**TRAFFIC CONTROL AND PROTECTION AT TURN BAYS  
(TO REMAIN OPEN TO TRAFFIC)**

SCALE: NONE SHEET NO. 1 OF 1 SHEETS STA. TO STA.

F.A. RTE.	SECTION	COUNTY	TOTAL SHEETS	SHEET NO.
VAR.	2008-010PP	McHENRY	27	26
	TC-14	CONTRACT NO. 60E36		
FED. ROAD DIST. NO. 1 ILLINOIS FED. AID PROJECT				

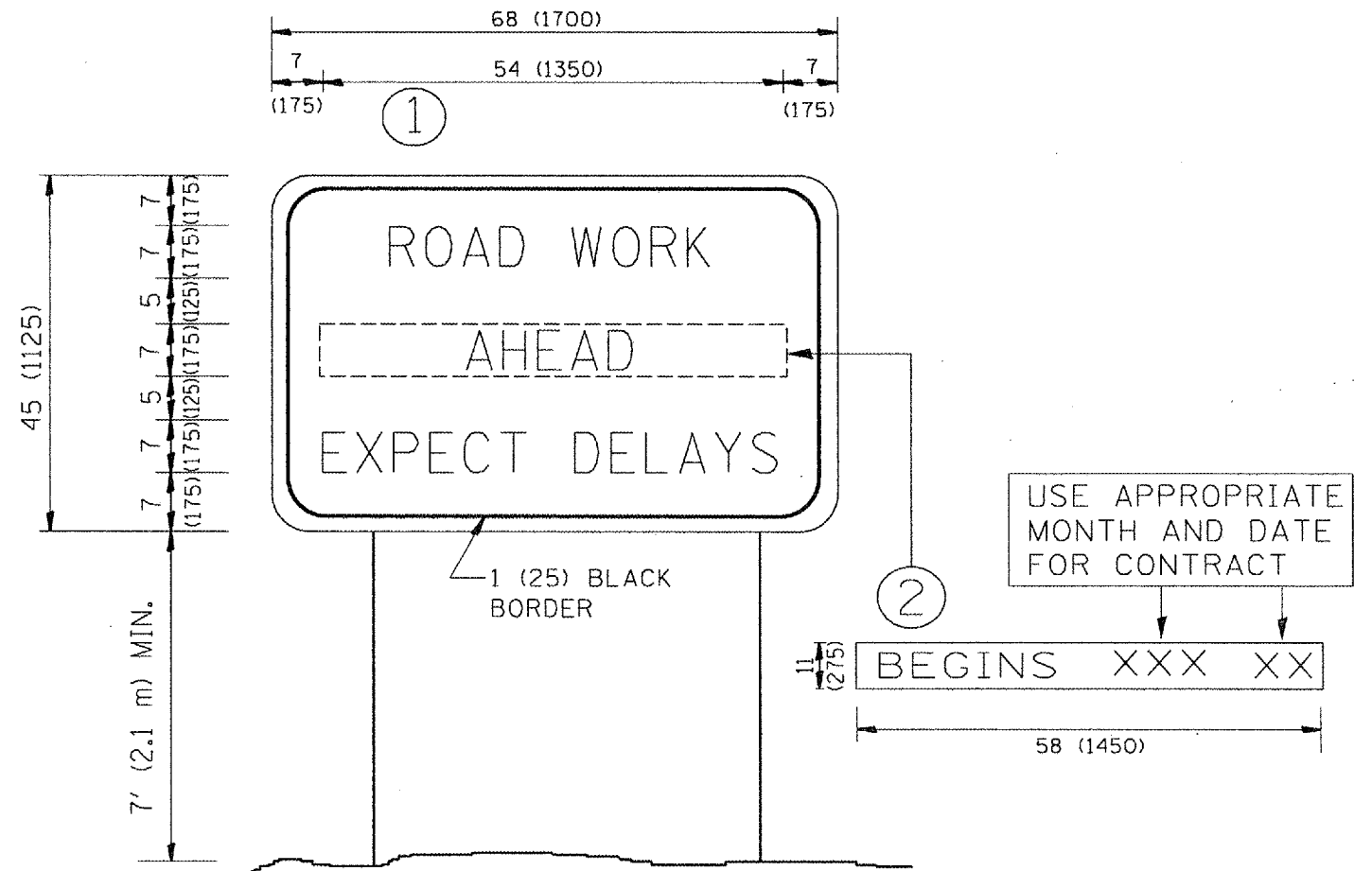

NOTES:

1. USE BLACK LETTERING ON ORANGE BACKGROUND.
2. ERECT SIGNS IN ADVANCE OF THE LOCATION FOR THE "ROAD CONSTRUCTION AHEAD" SIGN AT LOCATIONS AS DIRECTED BY THE ENGINEER.
3. ERECT SIGN ① WITH INSTALLED PANEL ② ONE WEEK PRIOR TO THE START OF CONSTRUCTION.
4. REMOVE PANEL ② SOON AFTER THE START OF CONSTRUCTION.
5. SEE SPECIAL PROVISION FOR "TEMPORARY INFORMATION SIGNING" FOR ADDITIONAL INFORMATION.
6. ONE SIGN ASSEMBLY EQUALS 25.70 SQ. FT. (2.3 SQ. M.)
7. SHALL BE PAID FOR AS TEMPORARY INFORMATION SIGNING.

ALL DIMENSIONS ARE IN INCHES (MILLIMETERS)  
UNLESS OTHERWISE SHOWN.

FILE NAME = W:\diststd\22x34\to22.dgn	USER NAME = amshkl	DESIGNED -	REVISED - R. MIRS 09-15-97	<b>STATE OF ILLINOIS DEPARTMENT OF TRANSPORTATION</b>	<b>ARTERIAL ROAD INFORMATION SIGN</b>	F.A. RTE.	SECTION	COUNTY	TOTAL SHEETS	SHEET NO.
	DRAWN -	REVISED - R. MIRS 12-11-97	VAR			2008-010PP	McHENRY	27	27	
	PLOT SCALE = 1/83.705" / IN.	CHECKED -	REVISED - T. RAMMACHER 02-02-99			TC-22	CONTRACT NO. 60E36			
	PLOT DATE = 3/14/2008	DATE -	REVISED - C. JUCIUS 01-31-07			SCALE: NONE	SHEET NO. 1 OF 1 SHEETS	STA.	TO STA.	FED. ROAD DIST. NO. 1 ILLINOIS FED. AID PROJECT

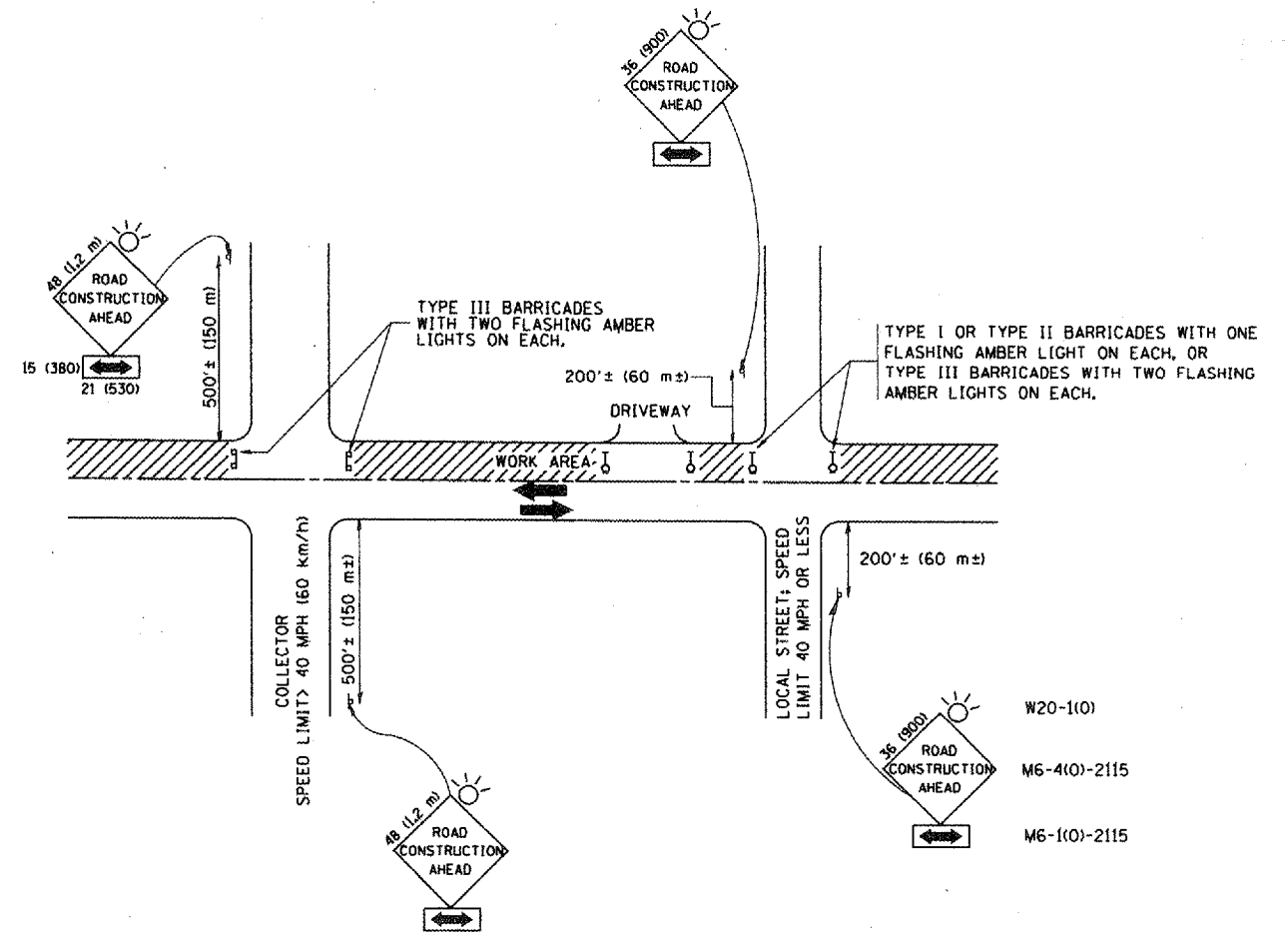

TRAFFIC CONTROL AND PROTECTION FOR SIDE ROADS, INTERSECTIONS, AND DRIVEWAYS

NOTES:

- A. FOR NO LANE RESTRICTION ON THE SIDE ROAD OR DRIVEWAYS
  - 1. SIDE ROAD WITH A SPEED LIMIT OF 40 MPH (60 km/h) OR LESS AS SHOWN ON THE DRAWING AND AS DIRECTED BY THE ENGINEER:
    - a) ONE ROAD CONSTRUCTION AHEAD SIGN 36 x 36 (900x900) WITH A FLASHER AND FLAG MOUNTED ON IT APPROXIMATELY 200' (60 m) IN ADVANCE OF THE MAIN ROUTE.
    - b) THE CLOSED PORTION OF THE MAIN ROUTE SHALL BE PROTECTED BY BLOCKING WITH TYPE I, TYPE II OR TYPE III BARRICADES, 1/3 OF THE CROSS SECTION OF THE CLOSED PORTION.
  - 2. SIDE ROAD WITH A SPEED LIMIT GREATER THAN 40 MPH (60 km/h) AS SHOWN ON THE DRAWING AND AS DIRECTED BY THE ENGINEER:
    - a) ONE ROAD CONSTRUCTION AHEAD SIGN 48 x 48 (1.2 m x 1.2 m) WITH A FLASHER MOUNTED ON IT APPROXIMATELY 500' (150 m) IN ADVANCE OF THE MAIN ROUTE.
    - b) THE CLOSED PORTION OF THE MAIN ROUTE SHALL BE PROTECTED BY BLOCKING WITH TYPE III BARRICADES, 1/2 OF THE CROSS SECTION OF THE CLOSED PORTION.
  - 3. WHEN THE SIDE ROAD LIES BETWEEN THE BEGINNING OF THE MAINLINE SIGNING AND THE WORK ZONE, A SINGLE HEADED ARROW (M6-1) SHALL BE USED IN LIEU OF THE DOUBLE HEADED ARROW (M6-4).
- B. FOR A LANE CLOSURE ON A SIDE ROAD OR DRIVEWAY:
  - USE APPLICABLE PORTIONS OF THE TYPICAL APPLICATION OF TRAFFIC CONTROL DEVICES (STD. 70150L, STD. 701606 OR THE APPROPRIATE STANDARD). THE SPACING OF SIGNS AND BARRICADES SHALL BE ADJUSTED FOR FIELD CONDITIONS AS DIRECTED BY THE ENGINEER. THE DIRECTIONAL ARROW SHALL BE COVERED OR REMOVED WHEN NO LONGER CONSISTENT WITH THE SIDE ROAD LANE CLOSURE.
- C. ADVANCE WARNING SIGNS ARE TO BE OMITTED ON DRIVEWAY UNLESS OTHERWISE NOTED.
- D. THE TRAFFIC CONTROL AND PROTECTION FOR SIDE ROADS, INTERSECTIONS, AND DRIVEWAYS SHALL BE INCIDENTAL TO THE COST OF SPECIFIED TRAFFIC CONTROL STANDARDS OR ITEMS.

All dimensions are in millimeters (inches) unless otherwise shown.

FILE NAME = W:\data\test\22x34\1018.dgn	USER NAME = geg1:enobt	DESIGNED - LHA	REVISED - J. OBERLE 10-18-95	<b>STATE OF ILLINOIS DEPARTMENT OF TRANSPORTATION</b>	<b>TRAFFIC CONTROL AND PROTECTION FOR SIDE ROADS, INTERSECTIONS, AND DRIVEWAYS</b>			F.A. RTE.	SECTION	COUNTY	TOTAL SHEET
		DRAWN -	REVISED - A. HOUSEH 03-06-96					VAR. 2008-010 PP	MCHENRY	27	27A
		CHECKED -	REVISED - A. HOUSEH 10-15-96					TC-10			CONTRACT NO. 60E36
		DATE - 06-89 3/17/08	REVISED - T. RAMMACHER 01-06-00					SCALE: NONE	SHEET NO. 1	OF 1 SHEETS	STA. TO STA.