

ROUTE	SECTION	COUNTY	TOTAL SHEETS	SHEET NUMBER
VARIOUS	2008-012 PP	WILL	33	1

33  
- 1  
+ 2  
---  
34

**CONTRACT NO. 60E38**

D-91-363-08

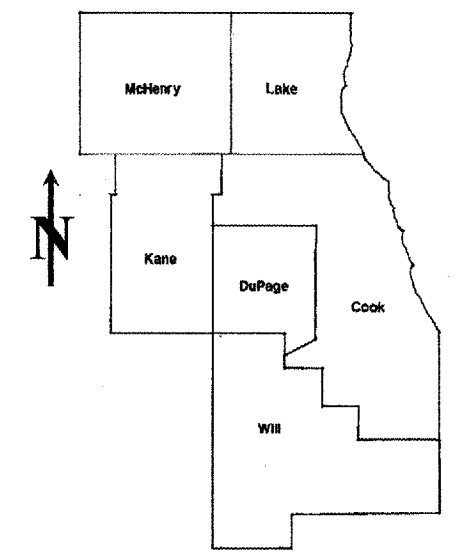

LOCATION OF IMPROVEMENT INDICATED THUS: 

**STATE OF ILLINOIS  
DEPARTMENT OF TRANSPORTATION  
DIVISION OF HIGHWAYS  
DISTRICT ONE  
PROPOSED HIGHWAY PLANS**

VARIOUS ROUTES  
SECTION: 2008-012 PP  
VARIOUS LOCATIONS IN WILL COUNTY  
PAVEMENT PATCHING  
WILL COUNTY  
C-91-363-08

FOR INDEX OF SHEETS SEE SHEET 2

**STATE OF ILLINOIS  
DEPARTMENT OF TRANSPORTATION  
DIVISION OF HIGHWAYS**

SUBMITTED: MARCH 14, 2008  
Diane M. O'Keefe or  
DEPUTY DIRECTOR OF HIGHWAYS, REGION ENGINEER

March 20, 2008  
Eric E. Harm  
Interim ENGINEER OF DESIGN AND ENVIRONMENT

March 20, 2008  
Christina M. Reed  
DIRECTOR, DIVISION OF HIGHWAYS

**PRINTED BY THE AUTHORITY  
OF THE STATE OF ILLINOIS**

**J.U.L.I.E.: JOINT UTILITY LOCATION  
INFORMATION FOR EXCAVATION  
(312) 744-7000**

**CONTRACT NO. 60E38**

DISTRICT ONE - DESIGN - PLAN PREPARATION ENGINEER:  
KEN ENG / (847) 705-4247

INDEX OF SHEETS

<u>SHEET NO.</u>	<u>DESCRIPTION</u>
1	TITLE SHEET
2	INDEX OF SHEETS, STATE STANDARDS AND GENERAL NOTES
3	SUMMARY OF QUANTITIES
4	GENERAL LOCATION MAP
5	SUMMARY OF PATCHING SCHEDULE
* 6-27A	PATCHING SCHEDULE
28	SPECIAL DETAIL FOR PAVEMENT PATCHING FOR HMA SURFACED PAVEMENT
29	BUTT JOINT AND HMA TAPER DETAILS
30	TYPICAL APPLICATIONS: RAISED REFLECTIVE PAVEMENT MARKERS (SNOW-PLOW RESISTANT)
31	DISTRICT ONE TYPICAL PAVEMENT MARKINGS
32	TRAFFIC CONTROL AND PROTECTION OF TURN BAYS (TO REMAIN OPEN TO TRAFFIC)
33	ARTERIAL ROAD INFORMATION SIGN
33A	TRAFFIC CONTROL AND PROTECTION FOR SIDE ROADS, INTERSECTIONS AND DRIVEWAYS
* 25	DELETED

STATE STANDARDS

<u>STANDARD NO.</u>	<u>DESCRIPTION</u>
000001-05	TYPICAL SYMBOLS, ABBREVIATIONS AND PATTERNS
420001-07	PAVEMENT JOINTS
442201-03	CLASS C AND D PATCHES
701201-02	LANE CLOSURE, 2L, 2W, DAY ONLY
701306-01	LANE CLOSURE, 2L, 2W, SLOW MOVING OPERATIONS - DAY ONLY
701336-04	LANE CLOSURE, 2L, 2W, WORK AREAS IN SERIES
701501-04	URBAN LANE CLOSURE, 2L, 2W, UNDIVIDED
701601-05	URBAN LANE CLOSURE, MULTILANE, 1W OR 2W WITH NONTRAVERSABLE MEDIAN
701606-05	URBAN LANE CLOSURE, MULTILANE, 2W WITH MOUNTABLE MEDIAN
701701-05	URBAN LANE CLOSURE, MULTILANE INTERSECTION
701901	TRAFFIC CONTROL DEVICES

THE PAY ITEM "MIXTURE FOR CRACKS, JOINTS AND FLANGEWAYS" SHALL BE USED IN AREAS WHERE THE EXISTING CRACK IS 2 INCHES OR LESS. THE CONTRACTOR SHALL CLEAN OUT ALL DEBRIS FROM THE CRACK. THE CLEAN OUT WORK SHALL BE INCLUDED IN THE COST OF "MIXTURE FOR CRACKS, JOINTS AND FLANGEWAYS". THE ENGINEER SHALL DETERMINE THE LOCATIONS FOR THE PLACEMENT OF THE "MIXTURE FOR CRACKS, JOINTS AND FLANGEWAYS".

GENERAL NOTES

BEFORE STARTING ANY EXCAVATION, THE CONTRACTOR SHALL CALL "JULIE" AT (800) 892-0123 OR 811 FOR FIELD LOCATIONS OF BURIED ELECTRIC, TELEPHONE AND GAS FACILITIES. (48 HOUR NOTIFICATION REQUIRED)

THE CONTRACTOR WILL NOT BE ALLOWED TO SET UP A YARD OR FIELD OFFICE ON STATE (OR TOLLWAY) PROPERTY WITHOUT WRITTEN PERMISSION FROM THE DEPARTMENT (OR ISTHA)

WHEN ARTIFICIAL LIGHTING IS UTILIZED IN NIGHT OPERATIONS, THE CONTRACTOR SHALL EXERCISE THE UTMOST PRECAUTIONS IN PREVENTING ADVERSE VISABILITY TO THE MOTORING PUBLIC AND ADJOINING RESIDENTIAL AREAS.

ANY PAVEMENT MARKINGS AND RAISED REFLECTIVE PAVEMENT MARKERS OBLITERATED BY MILLING AND RESURFACING OPERATIONS ON SIDE STREETS AND ENTRANCES SHALL BE REPLACED AND PAID FOR IN KIND.

BEFORE BEGINNING ANY WORK, THE CONTRACTOR SHALL RETAIN AND RECORD FOR FUTURE REFERENCE, ALL EXISTING PAVEMENT MARKING LINES (AND RAISED REFLECTIVE PAVEMENT MARKERS) IN ORDER THAT THESE LOCATIONS CAN BE RE-ESTABLISHED FOR STRIPING. EXACT LOCATIONS OF ALL PAVEMENT MARKINGS SHALL BE AS DIRECTED BY THE ENGINEER.

ALL PAVEMENT PATCHING LOCATIONS WILL BE DETERMINED IN THE FIELD BY THE ENGINEER.

THE CONTRACTOR SHALL CONTACT THE DISTRICT ONE TRAFFIC CONTROL SUPERVISOR AT (847) 705-4470 A MINIMUM OF 72 HOURS IN ADVANCE OF BEGINNING WORK.

THE ENGINEER SHALL CONTACT MS. CORA MATHIS, AREA TRAFFIC FIELD ENGINEER AT (815) 485-6475 MINIMUM OF TWO (2) WEEKS PRIOR TO PLACEMENT OF PERMANENT PAVEMENT MARKINGS.

DOUBLE LANE MARKERS ARE TO BE USED AS SHOWN ON THE DISTRICT ONE DETAIL "TYPICAL APPLICATIONS - RAISED REFLECTIVE PAVEMENT MARKERS (SNOW-PLOW RESISTANT)" SHOWN IN THE PLANS.

THE EXISTING ROADWAY TYPICAL SECTION IS ASSUMED TO HAVE A 3 INCH HOT-MIX ASPHALT OVERLAY ON TOP OF A TEN INCH CONCRETE BASE.

ALL MILLING AREAS AS NOTED ON THE INDIVIDUAL PATCHING SCHEDULES WITH A PATCH WIDTH OF 3 FEET OR LESS AND PATCH LENGTH OF 25 FEET OR MORE SHALL BE PAID FOR AS HOT-MIX ASPHALT SURFACE REMOVAL (SPECIAL).

THE COST OF TRAFFIC CONTROL AND PROTECTION FOR THE PROJECT SHALL BE INCLUDED IN THE COST OF THE ASSOCIATED ROAD WORK.

HOT-MIX ASPHALT MIXTURE REQUIREMENTS

MIXTURE TYPE	AC TYPE	AIR VOIDS (%)
HOT-MIX ASPHALT SURFACE COURSE, MIX "D", N70 (IL 9.5 MM)	PG 64-22	4% @ 70 GYR
LEVELING BINDER (MM), N70	PG 64-22/58-22	4% @ 70 GYR
CLASS D PATCHES, (HMA BINDER IL-19.0 MM)	PG 64-22 *	4% @ 70 GYR
HOT-MIX ASPHALT REPLACEMENT OVER PATCHES, (HMA BINDER IL-19.0 MM)	PG 64-22 *	4% @ 70 GYR
TOP 1 1/2 INCH OF REPLACEMENT OVER PATCHES; (HMA SURFACE COURSE, MIX "D", N70 (IL 9.5 MM))	PG 64-22	4% @ 70 GYR

THE UNIT WEIGHT USED TO CALCULATE ALL HOT-MIX ASPHALT SURFACE MIXTURE QUANTITIES IS 112 LBS/SY/IN.

\* WHEN RAP EXCEEDS 20%, THE NEW ASPHALT BINDER IN THE MIX SHALL BE PG 58-22

FILE NAME = c:\projects\04135388\design.as.dgn	USER NAME = wjgreendp	DESIGNED - DRAWN -	REVISED - REVISED -	STATE OF ILLINOIS DEPARTMENT OF TRANSPORTATION	INDEX OF SHEETS, STATE STANDARDS AND GENERAL NOTES	F.A.P. RTE.	SECTION	COUNTY	TOTAL SHEETS	SHEET NO.
PLOT SCALE = 100.0000 * / IN.	CHECKED -	REVISED -	VAR.			2008-012 PP	WILL	33	2	
PLOT DATE = 4/9/2008	DATE -	REVISED -	CONTRACT NO. 60E38							
SCALE: SHEET NO. OF SHEETS STA. TO STA.						FED. ROAD DIST. NO. 1 ILLINOIS FED. AID PROJECT				

(4-9-08)

Rev.

SUMMARY OF QUANTITIES			URBAN 100% STATE	CONSTRUCTION TYPE CODE					
CODE NO	ITEM	UNIT	TOTAL QUANTITIES	I000-2A					
40600200	BITUMINOUS MATERIALS (PRIME COAT)	TON	15	15					
40600300	AGGREGATE (PRIME COAT)	TON	72	72					
40600400	MIXTURE FOR CRACKS, JOINTS, AND FLANGEWAYS	TON	35	35					
40600635	LEVELING BINDER (MACHINE METHOD), N70	TON	1210	1210					
40600982	HOT-MIX ASPHALT SURFACE REMOVAL - BUTT JOINT	SO YD	1752	1752					
40601005	HOT-MIX ASPHALT REPLACEMENT OVER PATCHES	TON	1180	1180					
40603340	HOT-MIX ASPHALT SURFACE COURSE, MIX "O", N70	TON	2985	2985					
44000158	HOT-MIX ASPHALT SURFACE REMOVAL, 2 1/4"	SO YD	28704	28704					
44000196	HOT-MIX ASPHALT SURFACE REMOVAL, SPECIAL	SO YD	6804	6804					
44002212	HOT-MIX ASPHALT REMOVAL OVER PATCHES, 3"	SO YD	7025	7025					
44201349	CLASS C PATCHES, TYPE I, 10 INCH	SO YD	42	42					
44201353	CLASS C PATCHES, TYPE II, 10 INCH	SO YD	15	15					
44201357	CLASS C PATCHES, TYPE III, 10 INCH	SO YD	80	80					
44201761	CLASS D PATCHES, TYPE I, 10 INCH	SO YD	1262	1262					
44201765	CLASS D PATCHES, TYPE II, 10 INCH	SO YD	3642	3642					
44201769	CLASS D PATCHES, TYPE III, 10 INCH	SO YD	847	847					
44201771	CLASS D PATCHES, TYPE IV, 10 INCH	SO YD	634	634					
67000400	ENGINEER'S FIELD OFFICE, TYPE A	CAL MO	3	3					
67100100	MOBILIZATION	L SUM	1	1					
* 78000200	THERMOPLASTIC PAVEMENT MARKING - LINE 4"	FOOT	21076	21076					
* 78000400	THERMOPLASTIC PAVEMENT MARKING - LINE 6"	FOOT	500	500					
* 78100100	RAISED REFLECTIVE PAVEMENT MARKER	EACH	740	740					
78300200	RAISED REFLECTIVE PAVEMENT MARKER REMOVAL	EACH	740	740					
X0322256	TEMPORARY INFORMATION SIGNING	SO FT	1748	1748					

\* SPECIALTY ITEM

SUMMARY OF QUANTITIES			URBAN 100% STATE	CONSTRUCTION TYPE CODE					
CODE NO	ITEM	UNIT	TOTAL QUANTITIES	I000-2A					
X0324626	PORTLAND CEMENT CONCRETE SURFACE REMOVAL 2 1/4"	SO YD	176	176					
* XX006058	POLYUREA PAVEMENT MARKING - LINE 4"	FOOT	700	700					

(4-9-08)

REVISIONS	
NAME	DATE

ILLINOIS DEPARTMENT OF TRANSPORTATION  
SUMMARY OF QUANTITIES

PLOT DATE: 4/9/2008

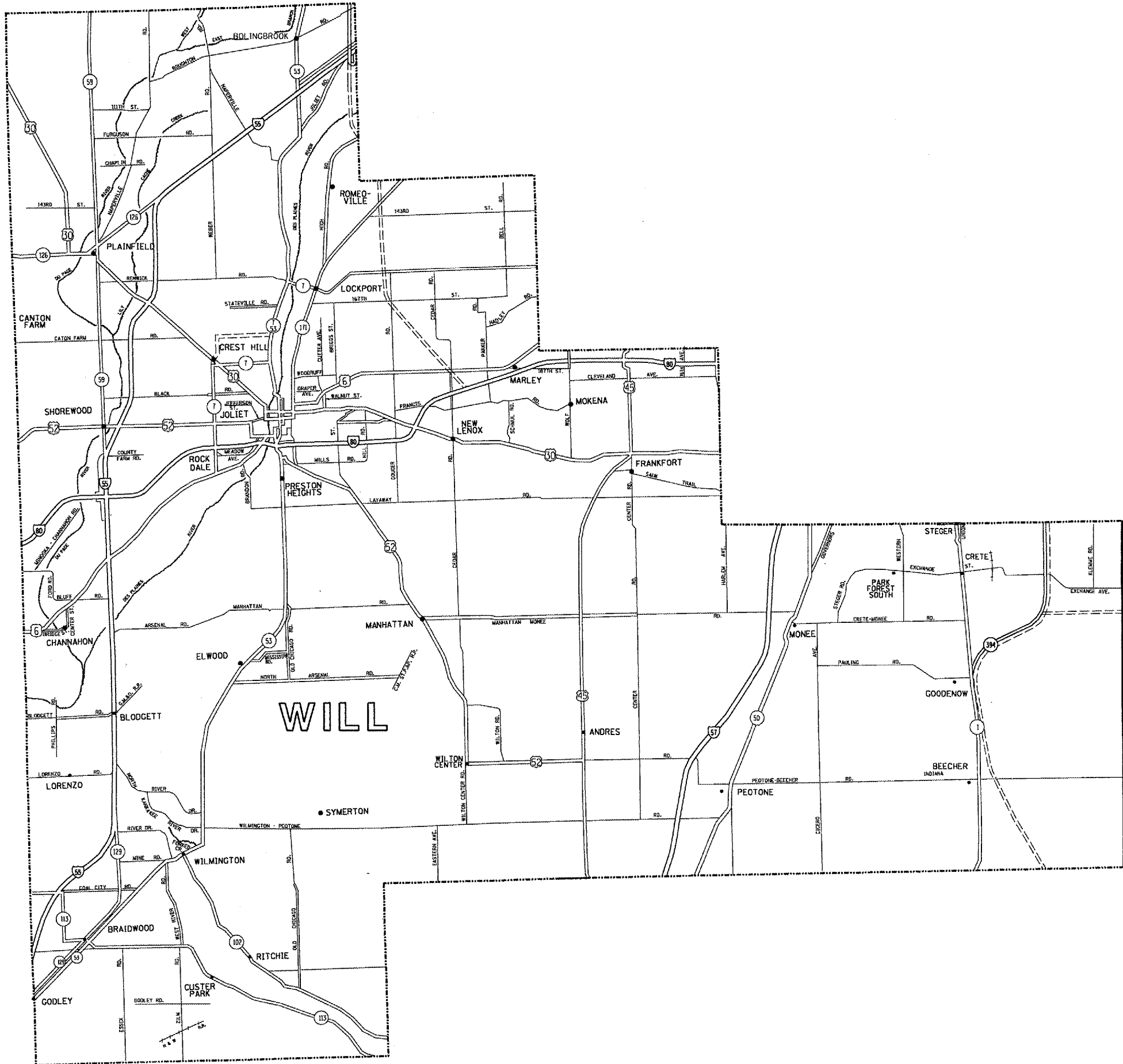

FILE NAME =  
 c:\projects\113408\sh\_dwg.dgn

USER NAME = smthkl  
 PLOT SCALE = 100.0000' / IN.  
 PLOT DATE = 3/14/2008

DESIGNED -  
 DRAWN -  
 CHECKED -  
 DATE -

REVISED -  
 REVISED -  
 REVISED -  
 REVISED -

**STATE OF ILLINOIS  
 DEPARTMENT OF TRANSPORTATION**

**GENERAL LOCATION MAP - WILL COUNTY**

SCALE:      SHEET NO.    OF    SHEETS    STA.            TO STA.

F.A. RTE.	SECTION	COUNTY	TOTAL SHEETS	SHEET NO.
VAR.	2008-012 PP	WILL	33	4
			<b>CONTRACT NO. 60E38</b>	
FED. ROAD DIST. NO. 1   ILLINOIS FED. AID PROJECT				

WILL COUNTY ROUTE SEGMENT	HMA SURF REM 2-1/4" & RESURF (SY)	HMA SURF REM (SP) & RESURF (SY)	CLASS D PATCH TYPE I (SY)	CLASS D PATCH TYPE II (SY)	CLASS D PATCH TYPE III (SY)	CLASS D PATCH TYPE IV (SY)	PAVT MARKING 4" (FT)	PAVT MARKING 6" (FT)	RAISED REFL PAVT MKS (EACH)
CENTER STREET (MCDONOUGH ST TO BRANDON RD)	656	0	10				220		12
CHICAGO ROAD (MISSISSIPPI TO HOFF ROAD)	0	0	15				10		4
CHICAGO ROAD (NORTH OF IL 102)	0	2000	361	333			100		10
COAL CITY ROAD (IL 113 TO IL 53)	395	0	10	29			400		20
GOVERNORS HIGHWAY (UNIVERSITY PARKWAY TO IL 50)	961	0	11	15			1582		16
HOFF ROAD (WEST OF CHICAGO ROAD TO 7.37 MILE EAST)	0	0	80	40			20		10
IL 50 / CICERO AVENUE (GOVERNORS HWY TO COUNTY LINE ROAD)	607	1247	58	72	128	53	3834		38
IL 53 (RIVER ROAD TO DIVISION STREET)	0	512		62			550		30
IL 102 (COUNTY LINE TO IL 53)	933	0		123	41		350		20
IL 102 (COUNTY LINE TO IL 53)	5774	0	99	243		67	1210		60
IL 113 (0.5 MILE EAST OF HORSE CREEK TO COUNTY LINE)	0	0	49	49			40		10
IL 113 (DIVISION STREET TO GRUNDY COUNTY LINE)	7658	0					1550		80
IL 113 (IL 129 TO CUSTER PARK FIREHOUSE)	133	0	120	377			100		20
IL 113 (MAIN STREET TO COAL CITY ROAD)	107	0	10	8		33	60		6
IL 129 (I-55 TO COAL CITY ROAD)	0	0	17				20		6
IL 129 (IL 113 TO COUNTY LINE)	0	0	4	900	352	67	60		4
MANHATTAN MONEE (SCHEER ROAD TO CEDAR ROAD)	1062	0	23	13	61	113	1950		43
RICAHRDS STREET (4TH ST TO US 52)	0	0	13	253			20		12
US 45 (STUENKEL ROAD TO 179TH STREET)	0	18	61	18	20		100		10
US 52 (DELANEY ROAD TO BAKER ROAD)	4271	0		27			2530		59
US 52 (300 FT E/O MCDONALD ROAD TO AIRPORT ROAD)	448	33		32	32		140		12
US 52 (WILTON CENTER TO US 45)	134	0	3	113	68	173	160		10
US 6 (200 FT E/O HOUBOLT RD TO EMPRESS DR)	1920	0		27			2880	500	28
US 6 (WALNUT ST TO BRIGGS ST)	159	0		31	17		400		8
US 30 (80TH AVENUE TO SCHOOLHOUSE ROAD)	978	0	42	193			660		40
US 30 (CEDAR ROAD TO GOUGER ROAD)	0	2650	74	204			150		10
US 30 (SCHOOLHOUSE ROAD TO SPENCER ROAD)	0	0	104	236		66	50		10
US 30 (WASHINGTON ST TO US 6)	0	0	20	64	66		20		6
WASHINGTON STREET (US 30 TO BRIGGS ROAD)	0	0	24	15			10		6
IL 1 (STEGER ROAD TO COUNTY LINE ROAD)	2508	350	54	165	62	62	1900		100
<b>SUMMARY TOTALS:</b>	<b>28704</b>	<b>6804</b>	<b>1262</b>	<b>3642</b>	<b>847</b>	<b>634</b>	<b>21076</b>	<b>500</b>	<b>700</b>

NOTE:

ALL MILLING AREAS AS NOTED ON THE INDIVIDUAL PATCHING SCHEDULES WITH A PATCH WIDTH OF 3 FEET OR LESS AND PATCH LENGTH OF 25 FEET OR MORE SHALL BE PAID FOR AS HOT-MIX ASPHALT SURFACE REMOVAL (SPECIAL).

WILL COUNTY ROUTE SEGMENT (PCC SECTIONS)	PCC SURF REM 2-1/4" RESURF (SY)	HMA SURF REM (SP) & RESURF (SY)	CLASS C PATCH TYPE I (SY)	CLASS C PATCH TYPE II (SY)	CLASS C PATCH TYPE III (SY)	CLASS C PATCH TYPE IV (SY)	PAVT MARKING 4" (FT)	RAISED REFL PAVT MKS (EACH)
IL 50 (STEGER ROAD TO GOVERNORS HIGHWAY)	176	0	42	15	80	0	700	40
<b>SUMMARY TOTALS:</b>	<b>176</b>	<b>0</b>	<b>42</b>	<b>15</b>	<b>80</b>	<b>0</b>	<b>700</b>	<b>40</b>

(4-9-08)

FILE NAME = or\projects\136308\design\_00.dgn  
PLOT SCALE = 100.0000 \* / IN.  
PLOT DATE = 4/9/2008

USER NAME = wilgreenjp	DESIGNED -	REVISED -
	DRAWN -	REVISED -
	CHECKED -	REVISED -
	DATE -	REVISED -

STATE OF ILLINOIS  
DEPARTMENT OF TRANSPORTATION

SUMMARY OF PATCHING SCHEDULE  
WILL COUNTY

SCALE: SHEET NO. OF SHEETS STA. TO STA.

F.A.P. RTE.	SECTION	COUNTY	TOTAL SHEETS	SHEET NO.
VAR.	2008-012 PP	WILL	33	5
CONTRACT NO. 60E38				
FED. ROAD DIST. NO. 1 ILLINOIS FED. AID PROJECT				



ROUTE: **US 30 (80th Ave to Schoolhouse Rd)**

CROSS STREETS		DIRECTION (EB/WB) (NB/SB)	LANE NO. (1, 2, 3)	PAVEMENT PATCH WIDTH	PAVEMENT PATCH LENGTH	REPAIR AREA (SQ FT)	REPAIR AREA (SQ YD)	MILL & RESURF	CLASS D PATCH TYPE I	CLASS D PATCH TYPE II	CLASS D PATCH TYPE III	CLASS D PATCH TYPE IV	PAVT MARKING 4"	RAISED REFL PAVT MKS
FROM	TO													
80th Ave	US 45	eb	12ea	2	2	48	5		12					
"	"	"	9ea	6	12	648	72			72				
"	"	WB	9ea	6	12	648	72			72				
"	"	WB	5ea	2	2	20	2		12					
Eisner	Wolf Rd	eb	6a	4	4	96	11		6					
"	"	wb	4ea	2	2	16	2		4					
"	"	EB	2ea	2	2	2	8		2					
Wolf Rd	Bluestone	eb	2ea	2	2	8	1		2					
"	"	wb	4ea	2	2	16	1		4					
"	"	wb	4ea	10	11	440	49			49				
Bluestone	Schoolhouse Rd	eb	1ea	6	1200	7200	800	800						
"	"	eb	1ea	4	400	1600	178	178						

TOTAL:

978  
SY      42  
SY      193  
SY

ROUTE: **US 30 (Cedar Rd to Gougar Rd)**

CROSS STREETS		DIRECTION (EB/WB) (NB/SB)	LANE NO. (1, 2, 3)	PAVEMENT PATCH WIDTH	PAVEMENT PATCH LENGTH	REPAIR AREA (SQ FT)	REPAIR AREA (SQ YD)	MILL & RESURF	CLASS D PATCH TYPE I	CLASS D PATCH TYPE II	CLASS D PATCH TYPE III	CLASS D PATCH TYPE IV	PAVT MARKING 4"	RAISED REFL PAVT MKS
FROM	TO													
E of Cedar	W of Cedar	eb	4ea	2	2	16	2		8					
"	"	eb	2ea	2	30	120	13			26				
"	"	wb	4ea	2	2	16	2		8					
Nelson	Washington	eb in line	10ea	1	100	1000	111	1110						
"	"	"	5	1	50	250	28	140						
"	"	eb	6	2	2	24	3		18					
"	"	"	8ea	4	4	128	14			112				
"	"	wb in line	12ea	1	100	1200	133	1356						
"	"	"	8	1	50	400	44	44						
"	"	wb	6ea	4	4	96	11			66				
"	"	"	10ea	2	2	40	4		40					

TOTALS:

2650  
SY      74  
SY      204  
SY

FILE NAME =  
es:\projects\dl38308\design\_00.dgn

USER NAME = am:thkl

DESIGNED -

DRAWN -

CHECKED -

DATE -

REVISED -

REVISED -

REVISED -

REVISED -

**STATE OF ILLINOIS  
DEPARTMENT OF TRANSPORTATION**

**PATCHING SCHEDULE  
US 30**

SCALE: SHEET NO. OF SHEETS STA. TO STA.

F.A.P.  
RTE.  
VAR.

SECTION  
2008-012 PP

COUNTY  
WILL

TOTAL  
SHEETS  
33

SHEET  
NO.  
7

CONTRACT NO. 60E38

FED. ROAD DIST. NO. 1 ILLINOIS FED. AID PROJECT

ROUTE: US 30 (Schoolhouse Rd to Spencer Rd)

CROSS STREETS		DIRECTION (EB/WB) (NB/SB)	LANE NO. (1, 2, 3)	PAVEMENT PATCH WIDTH	PAVEMENT PATCH LENGTH	REPAIR AREA (SQ FT)	REPAIR AREA (SQ YD)	MILL & RESURF	CLASS D PATCH TYPE I	CLASS D PATCH TYPE II	CLASS D PATCH TYPE III	CLASS D PATCH TYPE IV	PAVT MARKING 4"	RAISED REFL PAVT MKS
FROM	TO													
Schoolhouse Rd	.4 mi. W of Spencer	eb	4ea	4	6	96	11			44				
"	"	"	8ea	2	2	32	4		32					
"	"	wb	10ea	2	2	40	4		40					
"	"	"	6ea	4	4	96	11			66				
"	"	eb	8ea	2	2	32	4		32					
"	"	"	6ea	4	4	96	11			66				
"	"	"	1ea	6	50	300	33					33		
"	"	wb	1ea	6	50	300	33					33		
"	"	wb	12ea	2	2	48	5			60				

TOTALS:

104 236 66  
SY SY SY

ROUTE: US 30 (Washington St to US 6)

CROSS STREETS		DIRECTION (EB/WB) (NB/SB)	LANE NO. (1, 2, 3)	PAVEMENT PATCH WIDTH	PAVEMENT PATCH LENGTH	REPAIR AREA (SQ FT)	REPAIR AREA (SQ YD)	MILL & RESURF	CLASS D PATCH TYPE I	CLASS D PATCH TYPE II	CLASS D PATCH TYPE III	CLASS D PATCH TYPE IV	PAVT MARKING 4"	RAISED REFL PAVT MKS
FROM	TO													
E of cherry hill rd	Hillcrest rd	eb	3ea	2	10	60	7			21				
"	"	eb	2ea	2	2	8	1		2					
"	"	eb	4	4	4	64	7			28				
"	"	wb	3ea	11	6	198	22				66			
"	"	wb	3ea	4	4	48	5			15				
"	"	wb	6ea	2	2	24	3		18					

TOTAL:

20 64 66  
SY SY SY

FILE NAME =  
c:\projects\dl35388\design\_ea.dgn

USER NAME = smthkl	DESIGNED -	REVISED -
	DRAWN -	REVISED -
PLOT SCALE = 100.0000' / IN.	CHECKED -	REVISED -
PLOT DATE = 3/14/2008	DATE -	REVISED -

STATE OF ILLINOIS  
DEPARTMENT OF TRANSPORTATION

PATCHING SCHEDULE  
US 30

SCALE: SHEET NO. OF SHEETS STA. TO STA.

F.A.P. RTE.	SECTION	COUNTY	TOTAL SHEETS	SHEET NO.
VAR.	2008-012 PP	WILL	33	8
CONTRACT NO. 60E38			FFD. ROAD DIST. NO. 1 ILLINOIS FED. AID PROJECT	



ROUTE: **US 45 (STUENKEL RD TO 179TH STREET)**

CROSS STREETS		DIRECTION (EB/WB) (NB/SB)	LANE NO. (1, 2, 3)	PAVEMENT PATCH WIDTH	PAVEMENT PATCH LENGTH	REPAIR AREA (SQ FT)	REPAIR AREA (SQ YD)	MILL & RESURF	CLASS D PATCH TYPE I	CLASS D PATCH TYPE II	CLASS D PATCH TYPE III	CLASS D PATCH TYPE IV	PAVT MARKING 4"	RAISED REFL PAVT MKS
FROM	TO													
Bankview Dr	Colorado Av	NB	1&2	24	3	72	8			8				
At Colorado Av		NB	2	3	6	18	2		2					
100' North of Colorado Av		NB	1	2	2	4	1		1					
200' North of Colorado Av		NB	1&2	24	1	24	3		3					
Colorado Av	Abbey Woods	NB	J	2	2	4	1		1					
At Abbey Woods		NB	J	2	4	8	1		1					
Abbey Woods	Lincoln Way Ln	NB	J	2	2	4	1		1					
Abbey Woods	Lincoln Way Ln	NB	J	2	8	16	2		2					
.1 Miles North of Lincoln Way Ln		NB	1	3	3	9	1		1					
.1 Miles North of Lincoln Way Ln		NB	1	3	2	6	1		1					
.1 Miles North of Lincoln Way Ln		NB	2	3	16	48	5			5				
.2 Miles North of Lincoln Way Ln		NB	J	2	4	8	1		1					
.2 Miles North of Lincoln Way Ln		NB	J	2	12	24	3		3					
.3 Miles North of Lincoln Way Ln		NB	J	2	12	24	3		3					
.3 Miles North of Lincoln Way Ln		NB	J	2	14	28	3		3					
.35 Miles North of Lincoln Way Ln		NB	1&2	24	1	24	3		3					
.4 Miles North of Lincoln Way Ln		NB	1&2	24	1	24	3		3					
.4 Miles North of Lincoln Way Ln		NB	J	2	4	8	1		1					
560' South of St. Francis Rd		NB	1	12	15	180	20				20			
490' South of St. Francis Rd		NB	2	2	2	4	1		1					
200' South of St. Francis Rd		NB	2	2	10	20	2		2					
At St. Francis Rd		NB	2	3	55	165	18	18						
At LaPorte Rd		NB	3	3	3	9	1		1					
Just North of LaPorte Rd		NB	1&2	24	1	24	3		3					
At Birch St		NB	2	2	10	20	2		2					
Just North of Birch St		NB	1	2	2	4	1		1					
200' North of 194th St		SB	J	2	2	4	1		1					
194th St	195th St	SB	J	2	2	4	1		1					
196th St	197th St	SB	2	4	4	16	2		2					
196th St	197th St	SB	2	4	8	32	4		4					
100' North of LaPorte Rd		SB	J	2	2	4	1		1					
North of St Francis Rd		SB	J	2	2	4	1		1					
South of St Francis Rd		SB	1&2	24	1	24	3		3					
At Manheim Sq		SB	3	2	8	16	2		2					
At Bankview Dr		SB	1&2	24	2	48	5			5				
.5 Miles South of Laraway		NB	1	12	2	24	3		3					
.3 Miles North of Laraway		NB	1	2	2	4	1		1					
.1 Miles South of Sager		NB	1	2	10	20	2		2					
.1 Miles South of Sager		NB	1	2	10	20	2		2					
At Nebraska St		NB	1	2	2	4	1		1					

TOTALS: 118 SY 18 SY 61 SY 18 SY 20 SY FT EACH

ROUTE: RT 52 (DELANY RD TO BAKER RD)

CROSS STREETS		DIRECTION (EB/WB) (NB/SB)	LANE NO. (1, 2, 3)	PAVEMENT PATCH WIDTH	PAVEMENT PATCH LENGTH	REPAIR AREA (SQ FT)	REPAIR AREA (SQ YD)	MILL & RESURF	CLASS D PATCH TYPE I	CLASS D PATCH TYPE II	CLASS D PATCH TYPE III	CLASS D PATCH TYPE IV	PAVT MARKING 4"	RAISED REFL PAVT MKS
FROM	TO													
DELANY RD	RANCH OAKS RD	NB	1	6	25	150	17			17				
DELANY RD	RANCH OAKS RD	SB	1	12	280	3360	373	373						
DELANY RD	RANCH OAKS RD	SB	1	12	129	1548	172	172						
DELANY RD	RANCH OAKS RD	NB	1	12	455	5480	607	607						
DELANY RD	RANCH OAKS RD	SB	1	12	137	1644	183	183						
RANCH OAKS RD	BAKER RD	NB	1	12	40	480	53	53						
RANCH OAKS RD	BAKER RD	NB	1	12	66	792	88	88						
RANCH OAKS RD	BAKER RD	SB	1	12	35	420	47	47						
RANCH OAKS RD	BAKER RD	NB	1	12	57	684	76	76						
RANCH OAKS RD	BAKER RD	NB	1	12	100	1200	133	133						
RANCH OAKS RD	BAKER RD	NB	1	12	950	11400	1287	1287						
RANCH OAKS RD	BAKER RD	NB	1	12	4	48	5			5				
RANCH OAKS RD	BAKER RD	SB	1	12	4	48	5			5				
JUST SOUTH OF BAKER		SB	1	4	43	172	19	19						
JUST SOUTH OF BAKER		NB	1	12	60	720	80	80						
JUST SOUTH OF BAKER		NB	1	12	270	3240	360	360						
JUST SOUTH OF BAKER		SB	1	12	610	7320	813	813						

TOTALS: 4298 SY 4271 SY 27 SY 2530 FT 59 EACH

(4-9-08)

FILE NAME * n:\projects\136388\design_00.dgn	USER NAME * wlgreendp	DESIGNED - DRAWN -	REVISED - REVISED -	<b>STATE OF ILLINOIS DEPARTMENT OF TRANSPORTATION</b>	<b>PATCHING SCHEDULE US 52</b>				F.A.P. RTE. VAR.	SECTION 2008-012 PP	COUNTY WILL	TOTAL SHEETS 33	SHEET NO. 10
PLOT SCALE = 100.0000' / IN.	CHECKED -	REVISED -	REVISED -		SCALE:	SHEET NO.	OF	SHEETS	STA.	TO STA.	FED. ROAD DIST. NO. 1 ILLINOIS FED. AID PROJECT CONTRACT NO. 60E38		
PLOT DATE = 4/9/2008	DATE -	REVISED -	REVISED -										

ROUTE: **US52 (300' E. of McDONALD RD. TO AIRPORT DR.)**  
 \*\*\*PCC PAVT ENDS 300' +/- E. OF McDONALD RD.\*\*\*

CROSS STREETS	DIRECTION	LANE	PAVEMENT	PAVEMENT	REPAIR	REPAIR	MILL & RESURF	CLASS D	CLASS D	CLASS D	CLASS D	PAVT MARKING	RAISED REFL
FROM TO	(EB/WB) (NB/SB)	NO. (1, 2, 3)	PATCH WIDTH	PATCH LENGTH	AREA (SQ FT)	AREA (SQ YD)		PATCH TYPE I	PATCH TYPE II	PATCH TYPE III	PATCH TYPE IV	4"	PAVT MKS
203' E OF PCC PAVT	498' E OF PCC PAVT	EB	2	1	295	295	33						
507' E OF PCC PAVT	1011' E OF PCC PAVT	EB	1/2	4	504	2016	224						
513' E OF PCC PAVT	513' E OF PCC PAVT	EB	2	12	6	72	8		8				
827' E OF PCC PAVT	827' E OF PCC PAVT	EB	2	12	6	72	8		8				
204' E OF PCC PAVT	204' E OF PCC PAVT	WB	2	12	6	72	8		8				
851' E OF PCC PAVT	851' E OF PCC PAVT	WB	2	12	6	72	8		8				
507' E OF PCC PAVT	1011' E OF PCC PAVT	WB	1	4	504	2016	224	224					
713' E OF PCC PAVT	713' E OF PCC PAVT	WB	1/2	24	6	144	16			16			
502' E OF PCC PAVT	502' E OF PCC PAVT	WB	1/2	24	6	144	16			16			

TOTALS: 545 SY 481 SY 32 SY 32 SY 140 FT 12 EACH

ROUTE: **US 52 (WILTON CENTER TO US 45)**

CROSS STREETS	DIRECTION	LANE	PAVEMENT	PAVEMENT	REPAIR	REPAIR	MILL & RESURF	CLASS D	CLASS D	CLASS D	CLASS D	PAVT MARKING	RAISED REFL
FROM TO	(EB/WB) (NB/SB)	NO. (1, 2, 3)	PATCH WIDTH	PATCH LENGTH	AREA (SQ FT)	AREA (SQ YD)		PATCH TYPE I	PATCH TYPE II	PATCH TYPE III	PATCH TYPE IV	4"	PAVT MKS
4 Miles East of Wilton	WB	1	12	50	600	67	67						
5 Miles East of Wilton	WB	1	3	3	9	1		1					
1 Mile East of Wilton	WB	1	4	4	16	2		2					
2 Miles East of Wilton	WB	1	12	50	600	67	67						
2.5 Miles East of Wilton	EB	1	6	15	90	10			10				
2.5 Miles East of Wilton	WB	1	12	25	300	33					33		
2.5 Miles East of Wilton	WB	1	12	35	420	47					47		
2.6 Miles East of Wilton	WB	1	12	25	300	33					33		
2.6 Miles East of Wilton	WB	1	12	10	120	13					33		
2.6 Miles East of Wilton	WB	1	12	25	300	33			13				
2.7 Miles East of Wilton	WB	1	12	7	84	9			9				
2.8 Miles East of Wilton	WB	1	12	6	72	8			9				
3 Miles East of Wilton	WB	1	12	20	240	27					27		
3 Miles East of Wilton	EB	1	12	10	120	13			13				
3.1 Miles East of Wilton	EB	1	12	10	120	13			13				
3.1 Miles East of Wilton	WB	1	12	10	120	13			13				
3.1 Miles East of Wilton	EB	1	12	12	144	16				16			
3.4 Miles East of Wilton	EB	1	12	15	180	20				20			
3.7 Miles East of Wilton	EB	1	12	12	144	16				16			
3.9 Miles East of Wilton	WB	1	12	12	144	16				16			
3.9 Miles East of Wilton	WB	1	12	10	120	13			13				
3.9 Miles East of Wilton	WB	1	12	15	180	20			20				

TOTALS: 492 SY 134 SY 3 SY 113 SY 68 SY 173 SY

ROUTE: IL 50 / CICERO (STEGER RD TO GOVERNORS HWY)

CROSS STREETS		DIRECTION (EB/WB) (NB/SB)	LANE NO. (1, 2, 3)	PAVEMENT PATCH WIDTH	PAVEMENT PATCH LENGTH	REPAIR AREA (SQ FT)	REPAIR AREA (SQ YD)	MILL & RESURF	CLASS C PATCH TYPE I	CLASS C PATCH TYPE II	CLASS C PATCH TYPE III	CLASS C PATCH TYPE IV	PAVT MARKING 4"	RAISED REFL PAVT MKS
FROM	TO													
430' South of Steger Rd		SB	J	2	5	10	1		1					
445' South of Steger Rd		SB	J	2	8	16	2		2					
488' South of Steger Rd		SB	1	12	2	24	3		3					
530' South of Steger Rd		SB	1	12	2	24	3		3					
590' South of Steger Rd		SB	1&2	24	2	48	5			5				
.1 Miles South of Steger Rd		SB	J	2	2	4	1		1					
.2 Miles South of Steger Rd		SB	J	2	4	8	1		1					
.2 Miles South of Steger Rd		SB	J	2	10	20	2		2					
.2 Miles South of Steger Rd		SB	J	2	2	4	1		1					
.2 Miles South of Steger Rd		SB	J	3	3	9	1		1					
.3 Miles South of Steger Rd		SB	J	2	2	4	1		1					
.3 Miles South of Steger Rd		SB	J	2	2	4	1		1					
.5 Miles South of Steger Rd		SB	J	2	2	4	1		1					
.5 Miles South of Steger Rd		SB	1&2	24	2	48	5			5				
.5 Miles South of Steger Rd		SB	J	2	5	10	1		1					
.7 Miles South of Steger Rd		SB	J	2	6	12	1		1					
.7 Miles South of Steger Rd		SB	1	12	2	24	3		3					
.7 Miles South of Steger Rd		SB	1	2	2	4	1		1					
.7 Miles South of Steger Rd		SB	1	12	2	24	3		3					
.7 Miles South of Steger Rd		SB	J	2	6	12	1		1					
.7 Miles South of Steger Rd		SB	1&2	24	2	48	5			5				
.7 Miles South of Steger Rd		SB	J	2	6	12	1		1					
.8 Miles South of Steger Rd		SB	1	2	2	4	1		1					
.8 Miles South of Steger Rd		SB	2	2	2	4	1		1					
.8 Miles South of Steger Rd		SB	J	1	20	20	2		2					
.8 Miles South of Steger Rd		SB	J	2	3	6	1		1					
.1 Miles South of University Pkwy		SB	J	2	3	6	1		1					
.4 Miles South of University Pkwy		SB	1&2	24	1	24	3		3					
.3 Miles North of Governors Hwy		NB	J	1	1580	1580	176	176						
.3 Miles North of Governors Hwy		NB	1	2	3	6	1		1					
.6 Miles North of Governors Hwy		NB	2	12	1	12	1		1					
440' South of Steger Rd		NB	2	12	2	24	3		3					

176 SY      42 SY      15 SY      700 FT      40 EACH

FILE NAME =	USER NAME = smltkhl	DESIGNED -	REVISED -
ar\projects\dl3538B\design_ee.dgn		DRAWN -	REVISED -
		CHECKED -	REVISED -
		DATE -	REVISED -

**STATE OF ILLINOIS  
DEPARTMENT OF TRANSPORTATION**

<b>PATCHING SCHEDULE IL 50 (CICERO AVE.)</b>			
SCALE:	SHEET NO.	OF SHEETS	STA. TO STA.

F.A.P. RTE.	SECTION	COUNTY	TOTAL SHEETS	SHEET NO.
VAR.	2008-012 PP	WILL	33	12
FED. ROAD DIST. NO. 1   ILLINOIS FED. AID PROJECT			CONTRACT NO. 60E38	

ROUTE: IL 50 / CICERO (GOVERNORS HWY TO COUNTY LINE RD)

CROSS STREETS		DIRECTION	LANE	PAVEMENT	PAVEMENT	REPAIR	REPAIR	MILL	CLASS D	CLASS D	CLASS D	CLASS D	PAVT	RAISED
FROM	TO	(EB/WB)	NO.	PATCH	PATCH	AREA	AREA	&	PATCH	PATCH	PATCH	PATCH	MARKING	REFL
		(NB/SB)	(1, 2, 3)	WIDTH	LENGTH	(SQ FT)	(SQ YD)	RESURF	TYPE I	TYPE II	TYPE III	TYPE IV	4"	PAVT MKS
3 Miles South of Dralle		SB	2	12	20	240	27				27			
6 Miles South of Dralle		SB	2	2	3	6	1		1					
10' South of Horner Ave		SB	2	2	2	4	1		1					
1 Miles South of Horner		SB	2	12	40	480	53	53						
1 Miles South of Horner		SB	2	2	2	4	1		1					
At Monee Manhattan Rd		SB	2	3	8	24	3		3					
2 Miles South of Monee Manhattan Rd		SB	2	4	10	40	4		4					
2 Miles South of Monee Manhattan Rd		SB	2	2	2	4	1		1					
3 Miles South of Monee Manhattan Rd		SB	2	2	2	4	1		1					
4 Miles South of Monee Manhattan Rd		SB	2	4	2	8	1		1					
1 Miles South of Egyptian		SB	2	3	500	1500	167	167						
2 Miles South of Egyptian		SB	1	12	10	120	13			12				
At Watson Dr		SB	2	3	150	450	50	50						
1 Miles South of Watson Dr		SB	1	12	2	24	3		2					
5 Miles South of Watson Dr		SB	1&2	14	500	7000	778	778						
2 Miles South of Pauly Rd		SB	2	5	10	50	6			6				
At Offner Rd		SB	1&2	24	10	240	27				27			
At North Peotone Rd		SB	2	2	2	4	1		1					
3 Miles South of North Peotone Rd		SB	2	2	2	4	1		1					
8 Miles South of North Peotone Rd		SB	2	2	2	4	1		1					
9 Miles South of North Peotone Rd		SB	2	3	65	195	22	22						
1 Miles South of South St		SB	2	4	100	400	44	44						
At 5th St		SB	2	4	25	100	11			11				
3 Miles South of Wilmington Rd		SB	2	3	12	36	4		4					
5 Miles South of Wilmington Rd		SB	2	2	100	200	22	22						
7 Miles South of Wilmington Rd		SB	2	2	4	8	1		1					
1 Mile South of Wilmington Rd		SB	2	2	2	4	1		1					
1 Miles South of Kennedy		SB	2	2	8	16	2		2					
1 Miles South of Kennedy		SB	2	12	10	120	13			13				
2 Miles South of Kennedy		SB	1	2	6	12	1		1					
At Rathje Rd		SB	2	2	3	6	1		1					
1 Miles South of Rathje		SB	1	3	70	210	23	23						
1 Miles North of County Line Rd		NB	2	2	2	4	1		1					
1 Miles North of County Line Rd		NB	J	2	8	16	2		2					
1 Miles North of County Line Rd		NB	2	3	20	60	7			7				
1 Miles North of County Line Rd		NB	1	2	50	100	11	11						
2 Miles North of County Line Rd		NB	1	2	2	4	1		1					
2 Miles North of County Line Rd		NB	1	2	300	600	67	67						
2 Miles North of County Line Rd		NB	2	3	50	150	17	17						
4 Miles North of County Line Rd		NB	1	4	8	32	4			4				
5 Miles North of County Line Rd		NB	2	6	85	510	57	57						
5 Miles North of County Line Rd		NB	2	3	2	6	1		1					
5 Miles North of County Line Rd		NB	2	2	8	16	2		2					
2 Miles North of Rathje		NB	2	2	2	4	1		1					
3 Miles North of Rathje		NB	2	2	2	4	1		1					
At Beecher Rd		NB	2	2	2	4	1		1					
1 Miles North of Peotone Rd		NB	1	2	2	4	1		1					
1 Miles North of Peotone Rd		NB	J	2	8	16	2		2					
1 Miles North of Peotone Rd		NB	J	2	2	4	1		1					
3 Miles North of Peotone Rd		NB	J	2	2	4	1		1					
At Eagle Lake Rd		NB	2	3	3	9	1		1					
3 Miles North of Eagle Lake Rd		NB	2	5	10	50	6			6				
1 Miles North of Offner Rd		NB	2	4	4	16	2		2					
1 Miles North of Offner Rd		NB	J	3	50	150	17	17						
1 Miles North of Offner Rd		NB	2	12	20	240	27				27			
2 Miles North of Offner Rd		NB	2	3	10	30	3		3					
7 Miles North of Offner Rd		NB	2	6	3	18	2		2					
8 Miles North of Offner Rd		NB	1&2	24	118	2832	315	315						
100' South of Pauly Rd		NB	1&2	24	20	480	53					53		
1 Miles North of Pauly Rd		NB	2	3	250	750	83	83						
2 Miles North of Pauly Rd		NB	1	2	8	16	2		2					
6 Miles North of Pauly Rd		NB	2	2	150	300	33	33						
At Watson Rd		NB	2	2	2	4	1		1					
At Wayne Stassen Way		NB	2	2	2	4	1		1					
At Wayne Stassen Way		NB	1&2	18	10	180	20				20			
5 Miles North of Monee Manhattan Rd		NB	1	10	12	120	13			13				
2 Miles North of Bond St		NB	2	2	300	600	67	67						
2 Miles North of Bond St		NB	1	12	20	240	27				27			
2 Miles North of Bond St		NB	J	2	50	100	11	11						
3 Miles North of Bond St		NB	2	3	50	150	17	17						
4 Miles North of Bond St		NB	J	3	8	24	3		3					

TOTALS: 2163 SY 1854 SY 58 SY 72 SY 128 SY 53 SY 3834 FT 38 EACH

FILE NAME = c:\projects\136398\design_aa.dgn	USER NAME = smthkl	DESIGNED -	REVISED -	<b>STATE OF ILLINOIS DEPARTMENT OF TRANSPORTATION</b>	<b>PATCHING SCHEDULE IL 50 (CICERO AVE.)</b>	F.A.P. RTE.	SECTION	COUNTY	TOTAL SHEETS	SHEET NO.
PLOT SCALE = 1/8" = 100'-0"	DRAWN -	REVISED -	VAR.			2008-012 PP	WILL	33	13	
PLOT DATE = 3/14/2008	CHECKED -	REVISED -	CONTRACT NO. 60E38							
DATE -	REVISED -	FED. ROAD DIST. NO. 1 [ILLINOIS] FED. AID PROJECT								
SCALE: SHEET NO. OF SHEETS STA. TO STA.										

ROUTE: IL 53 (River Rd to Division St)

CROSS STREETS		DIRECTION (EB/WB) (NB/SB)	LANE NO. (1, 2, 3)	PAVEMENT PATCH WIDTH	PAVEMENT PATCH LENGTH	REPAIR AREA (SQ FT)	REPAIR AREA (SQ YD)	MILL & RESURF	CLASS D PATCH TYPE I	CLASS D PATCH TYPE II	CLASS D PATCH TYPE III	CLASS D PATCH TYPE IV	PAVT MARKING 4"	RAISED REFL PAVT MKS
FROM	TO													
River Rd	Coal City Rd	NB	1	2	300	600	67	67						
River Rd	Coal City Rd	"	1	2	300	600	67	67						
River Rd	Coal City Rd	"	4ea	4	4	64	7			7				
River Rd	Coal City Rd	SB	6ea	4	4	96	11			11				
Coal City Rd	Rt 113	NB	5ea	2	100	1000	111	111						
Coal City Rd	Rt 113	"	20ea	3	3	180	20			20				
Coal City Rd	Rt 113	SB	20ea	2	2	80	9			9				
Rt 113	Division	NB	2ea	2	600	2400	267	267						
Rt 113	Division	NB	22ea	2	2	88	10			10				
Rt 113	Division	SB	12 ea	2	2	48	5			5				

TOTALS: 573 SY 512 SY 62 SY FT EACH

ROUTE: IL 102 (County Line to IL 53)

CROSS STREETS		DIRECTION (EB/WB) (NB/SB)	LANE NO. (1, 2, 3)	PAVEMENT PATCH WIDTH	PAVEMENT PATCH LENGTH	REPAIR AREA (SQ FT)	REPAIR AREA (SQ YD)	MILL & RESURF	CLASS D PATCH TYPE I	CLASS D PATCH TYPE II	CLASS D PATCH TYPE III	CLASS D PATCH TYPE IV	PAVT MARKING 4"	RAISED REFL PAVT MKS
FROM	TO													
Chicago Ave	Fulton St	sb	1	8	24	192	21				21			
Chicago Ave	Fulton St	"	1	6	30	180	20				20			
Chicago Ave	Fulton St	"	1	12	160	1920	213	213						
Chicago Ave	Fulton St	"	1	12	180	2160	240	240						
Chicago Ave	Fulton St	"	1	6	20	120	13			13				
Chicago Ave	Fulton St	"	"	12	90	1080	120	120						
Chicago Ave	Fulton St	"	"	12	160	1920	213	160						
Chicago Ave	Fulton St	"	"	12	150	1800	200	200						
Chicago Ave	Fulton St	sb/nb	10EA	4	24	96	11			110				

TOTALS: 933 123 41

ROUTE: IL102 (County Line to IL 53)

CROSS STREETS		DIRECTION (EB/WB) (NB/SB)	LANE NO. (1, 2, 3)	PAVEMENT PATCH WIDTH	PAVEMENT PATCH LENGTH	REPAIR AREA (SQ FT)	REPAIR AREA (SQ YD)	MILL & RESURF	CLASS D PATCH TYPE I	CLASS D PATCH TYPE II	CLASS D PATCH TYPE III	CLASS D PATCH TYPE IV	PAVT MARKING 4"	RAISED REFL PAVT MKS
FROM	TO													
Kanakee County Line	Chicago Ave	nb/sb	6ea	3	3	9	1		6					
Chicago Ave	Fulton	nb	3ea	2	2	4	1		3					
Chicago Ave	Fulton	"	10ea	3	3	9	1		10					
Chicago Ave	Fulton	nb	14ea	4	10	40	4		52					
Chicago Ave	Fulton	"	16ea	4	20	80	9			144				
Chicago Ave	Fulton	"	1	12	160	1920	2133	2133						
Chicago Ave	Fulton	"	1	12	20	240	27				27			
Chicago Ave	Fulton	"	"	12	30	360	40				40			
Chicago Ave	Fulton	"	1	12	180	2160	240	240						
Chicago Ave	Fulton	"	1	12	60	720	80	80						
Chicago Ave	Fulton	"	"	12	470	5640	627	627						
Chicago Ave	Fulton	nb	1	12	180	2160	240	240						
Chicago Ave	Fulton	"	"	12	160	1920	213	213						
Chicago Ave	Fulton	"	"	12	180	2160	240	240						
Chicago Ave	Fulton	"	"	12	140	1680	187	187						
Chicago Ave	Fulton	"	"	12	150	1800	200	200						
Chicago Ave	Fulton	"	"	"	160	1920	213	213						
Chicago Ave	Fulton	"	"	"	180	2160	240	240						
Chicago Ave	Fulton	"	"	"	170	2040	227	227						
Chicago Ave	Fulton	sb	2ea	2	2	4	1		2					
Chicago Ave	Fulton	"	6ea	3	3	9	1		6					
Chicago Ave	Fulton	"	5ea	4	10	40	4		20					
Chicago Ave	Fulton	"	11ea	4	20	80	9			99				
Chicago Ave	Fulton	"	1	12	180	2160	240	240						
Chicago Ave	Fulton	sb	1	12	75	900	100	100						
Chicago Ave	Fulton	"	1	12	65	780	87	87						
Chicago Ave	Fulton	"	1	12	130	1560	173	173						
Chicago Ave	Fulton	"	"	12"	170	2040	227	227						
Chicago Ave	Fulton	"	"	12	80	960	107	107						

TOTALS: 5871 SY 5774 SY 99 SY 243 SY 67 SY FT EACH

FILE NAME = c:\projects\dl36388\design.aa.dgn  
PLOT SCALE = 1/8"=1'-0"  
PLOT DATE = 3/14/2008

USER NAME = smthkl  
DESIGNED -  
DRAWN -  
CHECKED -  
DATE -

REVISED -  
REVISED -  
REVISED -  
REVISED -

STATE OF ILLINOIS  
DEPARTMENT OF TRANSPORTATION

PATCHING SCHEDULE  
IL 102

SCALE: SHEET NO. OF SHEETS STA. TO STA.

F.A.P. RTE. SECTION COUNTY TOTAL SHEETS SHEET NO.  
VAR. 2008-012 PP WILL 33 15  
CONTRACT NO. 60E38  
FED. ROAD DIST. NO. 1 ILLINOIS FED. AID PROJECT

ROUTE: IL 113 (0.5 miles east of Horse Creek to County Line)

CROSS STREETS		DIRECTION (EB/WB) (NB/SB)	LANE NO. (1, 2, 3)	PAVEMENT PATCH WIDTH	PAVEMENT PATCH LENGTH	REPAIR AREA (SQ FT)	REPAIR AREA (SQ YD)	MILL & RESURF	CLASS D PATCH TYPE I	CLASS D PATCH TYPE II	CLASS D PATCH TYPE III	CLASS D PATCH TYPE IV	PAVT MARKING 4"	RAISED REFL PAVT MKS
FROM	TO													
.5 miles east of hrse crk	County Line	sb	5ea	2	2	4	1		5					
"	"	sb	7ea	3	3	9	1		7					
"	"	"	2ea	4	10	40	4		8					
"	"	"	1	4	20	80	9			9				
"	"	nb/sb	2ea	4	24	96	11			22				
"	"	nb	6ea	2	2	4	1		6					
"	"	nb	19ea	3	3	9	1		19					
"	"	"	1	4	10	40	4		4					
"	"	nb	2ea	4	20	80	9			18				

TOTALS:

49  
SY      49  
SY

ROUTE: IL 113 (Divisions St to Grundy Co Line)

CROSS STREETS		DIRECTION (EB/WB) (NB/SB)	LANE NO. (1, 2, 3)	PAVEMENT PATCH WIDTH	PAVEMENT PATCH LENGTH	REPAIR AREA (SQ FT)	REPAIR AREA (SQ YD)	MILL & RESURF	CLASS D PATCH TYPE I	CLASS D PATCH TYPE II	CLASS D PATCH TYPE III	CLASS D PATCH TYPE IV	PAVT MARKING 4"	RAISED REFL PAVT MKS
FROM	TO													
IL 113	west approach	wb		17.25	380	6555	728	728						
"	"	"		16.25	380	6175	686	686						
"	"	"		16.75	670	11223	1247	1247						
"	"	"		16.75	670	11223	1247	1247						
"	east approach	eb		16.5	383	6320	702	702						
"	"	"		16.5	383	6320	702	702						
"	"	"		20	437	8740	971	971						
"	"	"		20	437	8740	971	971						
"	"	"		25	145	3625	403	403						

TOTALS:

7858  
SY

FILE NAME = c:\projects\dl36308\design.aa.dgn	USER NAME = smthk1	DESIGNED -	REVISED -
		DRAWN -	REVISED -
		CHECKED -	REVISED -
		DATE -	REVISED -

**STATE OF ILLINOIS  
DEPARTMENT OF TRANSPORTATION**

**PATCHING SCHEDULE  
IL 113**

SCALE: SHEET NO. OF SHEETS STA. TO STA.

F.A.P. RTE.	SECTION	COUNTY	TOTAL SHEETS	SHEET NO.
VAR.	2008-012 PP	WILL	33	16
FED. ROAD DIST. NO. 1 ILLINOIS FED. AID PROJECT			CONTRACT NO. 60E38	



ROUTE: IL 113 (IL 129 to Custer Park Firehouse)

CROSS STREETS		DIRECTION (EB/WB) (NB/SB)	LANE NO. (1, 2, 3)	PAVEMENT PATCH WIDTH	PAVEMENT PATCH LENGTH	REPAIR AREA (SQ FT)	REPAIR AREA (SQ YD)	MILL & RESURF	CLASS D PATCH TYPE I	CLASS D PATCH TYPE II	CLASS D PATCH TYPE III	CLASS D PATCH TYPE IV	PAVT MARKING 4"	RAISED REFL PAVT MKS
FROM	TO													
IL 129	Custer Park Firehouse	sb	10ea	2	2	4	1		10					
"	"	"	17ea	3	3	9	1		17					
"	"	"	10ea	4	10	40	4		40					
"	"	"	16ea	4	20	80	9			144				
"	"	"	1	6	20	120	13			13				
"	"	"	"	12	100	1200	133	133						
Custer Park Firehouse	IL 129	nb	8ea	2	2	4	1		8					
"	"	"	9ea	3	3	9	1		9					
"	"	"	9ea	4	10	40	4		36					
"	"	"	11ea	4	20	89	9			99				
IL 129	Custer Park Firehouse	1	11ea	4	24	96	11			121				

TOTALS: 133 120 377

ROUTE: IL 113 (Division St.) from Main St to Coal City Rd

CROSS STREETS		DIRECTION (EB/WB) (NB/SB)	LANE NO. (1, 2, 3)	PAVEMENT PATCH WIDTH	PAVEMENT PATCH LENGTH	REPAIR AREA (SQ FT)	REPAIR AREA (SQ YD)	MILL & RESURF	CLASS D PATCH TYPE I	CLASS D PATCH TYPE II	CLASS D PATCH TYPE III	CLASS D PATCH TYPE IV	PAVT MARKING 4"	RAISED REFL PAVT MKS
FROM	TO													
Main St	Coal City Road	sb	1	2	4	8	1		1					
Main St	Coal City Road	sb	1	2	7	14	2		2					
Main St	Coal City Road	"	"	2	4	8	1		1					
Main St	Coal City Road	"	"	12	25	300	33				33			
Main St	Coal City Road	"	"	12	80	960	107	107						
Main St	Coal City Road	NB	1	2	6	12	8			8				
Main St	Coal City Road	"	"	2	10	20	2		2					
Main St	Coal City Road	"	"	4	8	32	4		4					

TOTALS: 157 107 10 8 33 FT EACH  
SY SY SY SY SY

ROUTE: IL 129 (I-55 to Coal City Rd)

CROSS STREETS		DIRECTION (EB/WB) (NB/SB)	LANE NO. (1, 2, 3)	PAVEMENT PATCH WIDTH	PAVEMENT PATCH LENGTH	REPAIR AREA (SQ FT)	REPAIR AREA (SQ YD)	MILL & RESURF	CLASS D PATCH TYPE I	CLASS D PATCH TYPE II	CLASS D PATCH TYPE III	CLASS D PATCH TYPE IV	PAVT MARKING 4"	RAISED REFL PAVT MKS
FROM	TO													
I-55	Strip Mine Road	sb	1	4	4	16	2		2					
"	"	"	"	4	4	16	2		2					
"	"	"	"	4	6	24	3		3					
"	"	"	"	2	3	6	1		1					
"	"	"	"	2	2	4	1		1					
"	"	nb	1	4	4	16	2		2					
"	"	"	1	2	3	6	1		1					
Strip Mine Road	Coal City Road	sb	1	2	2	4	1		1					
"	"	"	1	2	3	6	1		1					
"	"	nb	1	2	3	6	1		1					
"	"	nb	1	2	2	4	1		1					
"	"	"	1	3	3	9	1		1					
"	"	"	1	2	2	4	1		1					
"	"	"	"	2	2	4	1		1					

TOTALS:

17  
SY

ROUTE: IL 129 (IL 113 to County Line)

CROSS STREETS		DIRECTION (EB/WB) (NB/SB)	LANE NO. (1, 2, 3)	PAVEMENT PATCH WIDTH	PAVEMENT PATCH LENGTH	REPAIR AREA (SQ FT)	REPAIR AREA (SQ YD)	MILL & RESURF	CLASS D PATCH TYPE I	CLASS D PATCH TYPE II	CLASS D PATCH TYPE III	CLASS D PATCH TYPE IV	PAVT MARKING 4"	RAISED REFL PAVT MKS
FROM	TO													
IL 129	County Line	sb	1	4	10	40	4		4					
"	"	"	1	4	20	80	9			9				
"	"	nb/sb	81ea	4	24	96	11			891				
"	"	nb/sb	22ea	6	24	144	16				352			
"	"	nb	1	12	50	600	67					67		

TOTALS:

4      900      352      67  
SY      SY      SY      SY

ROUTE: Center Street (McDonough St to Brandon Rd)

CROSS STREETS		DIRECTION (EB/WB) (NB/SB)	LANE NO. (1, 2, 3)	PAVEMENT PATCH WIDTH	PAVEMENT PATCH LENGTH	REPAIR AREA (SQ FT)	REPAIR AREA (SQ YD)	MILL & RESURF	CLASS D PATCH TYPE I	CLASS D PATCH TYPE II	CLASS D PATCH TYPE III	CLASS D PATCH TYPE IV	PAVT MARKING 4"	RAISED REFL PAVT MKS
FROM	TO													
McDonough St	Brandon Rd	sb	2	4	8	32	4		4					
McDonough St	Brandon Rd	sb	2	4	6	24	3		3					
McDonough St	Brandon Rd	SB	2	4	6	24	3		3					
McDonough St	Brandon Rd	SB	2	12	180	2160	240	240						
McDonough St	Brandon Rd	NB	2	12	280	3360	373	373						
McDonough St	Brandon Rd	SB	2	6	65	390	43	43						

TOTALS:

666 SY      656 SY      10 SY

FT      EACH

ROUTE: Chicago Road (Mississippi to Hoff Rd)

CROSS STREETS		DIRECTION (EB/WB) (NB/SB)	LANE NO. (1, 2, 3)	PAVEMENT PATCH WIDTH	PAVEMENT PATCH LENGTH	REPAIR AREA (SQ FT)	REPAIR AREA (SQ YD)	MILL & RESURF	CLASS D PATCH TYPE I	CLASS D PATCH TYPE II	CLASS D PATCH TYPE III	CLASS D PATCH TYPE IV	PAVT MARKING 4"	RAISED REFL PAVT MKS
FROM	TO													
mississippi	1 mile north	nb	4ea	4	4	64	7		7					
"	"	sb	10ea	2	2	40	4		4					
"	hoff rd	nb	4ea	2	2	16	2		2					
"	"	SB	4ea	2	2	16	2		2					

TOTALS: 15 SY 15 SY FT EACH

ROUTE: Chicago Road: (North of IL 102)

CROSS STREETS		DIRECTION (EB/WB) (NB/SB)	LANE NO. (1, 2, 3)	PAVEMENT PATCH WIDTH	PAVEMENT PATCH LENGTH	REPAIR AREA (SQ FT)	REPAIR AREA (SQ YD)	MILL & RESURF	CLASS D PATCH TYPE I	CLASS D PATCH TYPE II	CLASS D PATCH TYPE III	CLASS D PATCH TYPE IV	PAVT MARKING 4"	RAISED REFL PAVT MKS
FROM	TO													
IL 102	3.7 miles N	nb	50 Ea	6	10	3000	333			333				
IL 102	3.7 miles N	"	30 EA	3	100	9000	1000	1000						
IL 102	3.7 miles N	"	100EA	2	2	400	44		44					
IL 102	3.7 miles N	"	50 EA	3	3	450	50		50					
IL 102	3.7 miles N	"	20EA	4	4	320	16		16					
IL 102	3.7 miles N	SB	60EA	2	100	12000	1333	1000						
IL 102	3.7 miles N	"	100EA	2	2	400	44		44					
IL 102	3.7 miles N	"	100EA	3	3	900	100		100					
IL 102	3.7 miles N	"	60	4	4	960	107		107					

TOTALS: 3028 SY 2000 SY 361 SY 333 SY FT EACH

ROUTE: Coal City Road (IL 113 to IL 53)

CROSS STREETS		DIRECTION (EB/WB) (NB/SB)	LANE NO. (1, 2, 3)	PAVEMENT PATCH WIDTH	PAVEMENT PATCH LENGTH	REPAIR AREA (SQ FT)	REPAIR AREA (SQ YD)	MILL & RESURF	CLASS D PATCH TYPE I	CLASS D PATCH TYPE II	CLASS D PATCH TYPE III	CLASS D PATCH TYPE IV	PAVT MARKING 4"	RAISED REFL PAVT MKS
FROM	TO													
Rt.113	Rt.53	eb	1	3	3	9	1		1					
Rt.113	Rt.53	"	1	4	10	40	4		4					
Rt.113	Rt.53	"	13ea	4	20	80	9			9				
Rt.113	Rt.53	eb/wb	5ea	4	24	96	11			11				
Rt.113	Rt.53	wb	1	3	3	9	1		1					
Rt.113	Rt.53	"	9EA	4	10	40	4		4					
Rt.113	Rt.53	"	11EA	4	20	80	9			9				
Rt.113	Rt.53	"	1	4	140	560	62	62						
Rt.113	Rt.53	"	1	4	100	400	44	44						
Rt.113	Rt.53	"	1	4	80	320	36	36						
Rt.113	Rt.53	"	1	4	100	400	44	44						
Rt.113	Rt.53	"	1	4	470	1880	209	209						

TOTALS: 435 SY 395 SY 10 SY 29 SY FT EACH

ROUTE: Governors Highway (University Pkwy to IL 50)

CROSS STREETS		DIRECTION (EB/WB) (NB/SB)	LANE NO. (1, 2, 3)	PAVEMENT PATCH WIDTH	PAVEMENT PATCH LENGTH	REPAIR AREA (SQ FT)	REPAIR AREA (SQ YD)	MILL & RESURF	CLASS D PATCH TYPE I	CLASS D PATCH TYPE II	CLASS D PATCH TYPE III	CLASS D PATCH TYPE IV	PAVT MARKING 4"	RAISED REFL PAVT MKS
FROM	TO													
.2 Miles North of University Pkwy		NB	2	2	2	4	1		1					
.3 Miles North of University Pkwy		NB	2	3	80	240	27	27						
.3 Miles North of University Pkwy		NB	2	12	200	2400	267	267						
.5 Miles North of University Pkwy		NB	2	6	10	60	7			7				
.6 Miles North of University Pkwy		NB	2	6	12	72	8			8				
.8 Miles North of University Pkwy		NB	2	2	2	4	1		1					
50' South of Cook County Line		SB	2	2	8	16	2		2					
.1 Miles South of Cook County Line		SB	2	2	2	4	1		1					
.2 Miles South of Cook County Line		SB	2	2	2	4	1		1					
.3 Miles South of Cook County Line		SB	2	2	2	4	1		1					
.3 Miles South of Cook County Line		SB	1	2	2	4	1		1					
.8 Miles South of Cook County Line		SB	2	2	4	8	1		1					
.1 Miles North of IL 50		SB	2	4	4	16	2		2					
Just North of IL 50		NB	1	12	500	6000	667	667						

TOTALS:

985      961      11      15  
 SY      SY      SY      SY  
 1528      16  
 FT      EACH

FILE NAME =  
 c:\projects\dl36300\design\_ee.dgn

USER NAME = smthkl  
 DESIGNED -  
 DRAWN -  
 PLOT SCALE = 100.0000' / IN.  
 PLOT DATE = 3/14/2008

DESIGNED -  
 DRAWN -  
 CHECKED -  
 DATE -

REVISED -  
 REVISED -  
 REVISED -  
 REVISED -

**STATE OF ILLINOIS  
 DEPARTMENT OF TRANSPORTATION**

**PATCHING SCHEDULE  
 GOVERNORS HIGHWAY.**

SCALE:      SHEET NO.      OF      SHEETS      STA.      TO      STA.

F.A.P. RTE.	SECTION	COUNTY	TOTAL SHEETS	SHEET NO.
VAR.	2008-012 PP	WILL	33	22
FED. ROAD DIST. NO. 1   ILLINOIS   FED. AID PROJECT			CONTRACT NO. 60E38	

ROUTE: Hoff Road (West of Chicago Rd to 3.7 mile east)

CROSS STREETS		DIRECTION (EB/WB) (NB/SB)	LANE NO. (1, 2, 3)	PAVEMENT PATCH WIDTH	PAVEMENT PATCH LENGTH	REPAIR AREA (SQ FT)	REPAIR AREA (SQ YD)	MILL & RESURF	CLASS D PATCH TYPE I	CLASS D PATCH TYPE II	CLASS D PATCH TYPE III	CLASS D PATCH TYPE IV	PAVT MARKING 4"	RAISED REFL PAVT MKS
FROM	TO													
W of Chicago	IL53	wb	4ea	2	2	16	2		2					
coldwater	il53	wb	8ea	2	6	528	59		59					
coldwater	"	eb	6ea	2	30	360	40			40				
E of chgo	3.7 miles east	eb	6	2	2	24	3		3					
E of chgo	3.7 miles east	eb	4	4	4	64	7		7					
E of chgo	3.7 miles east	wb	4	2	2	16	2		2					
E of chgo	3.7 miles east	wb	4	4	4	64	7		7					

TOTALS: 119 SY 80 SY 40 SY FT EACH

ROUTE: MANHATTAN MONEE ROAD (SCHEER RD TO CEDER RD)

CROSS STREETS		DIRECTION (EB/WB) (NB/SB)	LANE NO. (1, 2, 3)	PAVEMENT PATCH WIDTH	PAVEMENT PATCH LENGTH	REPAIR AREA (SQ FT)	REPAIR AREA (SQ YD)	MILL & RESURF	CLASS D PATCH TYPE I	CLASS D PATCH TYPE II	CLASS D PATCH TYPE III	CLASS D PATCH TYPE IV	PAVT MARKING 4"	RAISED REFL PAVT MKS
FROM	TO													
.1 Miles West of Scheer		WB	1	3	3	9	1		1					
.1 Miles West of Scheer		EB	1	6	25	150	17				17			
.15 Miles West of Scheer		WB	1	6	6	36	4		4					
.2 Miles West of Scheer		WB	1	12	25	300	33					33		
.2 Miles West of Scheer		WB	1	12	50	600	67	67						
.3 Miles West of Scheer		EB	1	6	25	150	17				17			
.7 Miles West of Scheer		EB	1	6	500	3000	333	333						
1.4 Miles West of Scheer		EB	1	6	6	36	4		4					
1.4 Miles West of Scheer		EB	1	6	20	120	13			13				
1.5 Miles West of Scheer		WB	1	12	25	300	33					33		
1.5 Miles West of Scheer		EB	1	12	100	1200	133	113						
1.6 Miles West of Scheer		EB	1	12	65	780	87	87						
1.65 Miles West of Scheer		WB	1	12	70	840	93	93						
1.65 Miles West of Scheer		EB	1	12	55	660	73	37						
1.7 Miles West of Scheer		WB	1	6	50	300	33	33						
1.8 Miles West of Scheer		WB	1	5	5	25	3		3					
1.9 Miles West of Scheer		EB	1	12	100	1200	133	133						
1.9 Miles West of Scheer		WB	1	12	100	1200	133	133						
2.2 Miles West of Scheer		EB	1	3	3	9	1		1					
2.5 Miles West of Scheer		EB	1	12	20	240	27				27			
2.6 Miles West of Scheer		WB	1	12	35	420	47					47		
2.65 Miles West of Scheer		WB	1	4	5	20	2		2					
2.8 Miles West of Scheer		EB	1	3	3	9	1		1					
2.8 Miles West of Scheer		EB	1	6	50	300	33	33						
2.9 Miles West of Scheer		WB	1	5	5	25	3		3					
2.9 Miles West of Scheer		EB	1	6	6	36	4		4					

TOTALS: 1329 SY 1062 SY 23 SY 13 SY 61 SY 113 SY 1950 FT 43 EACH

FILE NAME =  
c:\projects\dl36308\design\_ee.dgn

USER NAME = am14kl	DESIGNED -	REVISED -
	DRAWN -	REVISED -
PLOT SCALE = 1/8" = 100.0000' / IN.	CHECKED -	REVISED -
PLOT DATE = 3/14/2008	DATE -	REVISED -

STATE OF ILLINOIS  
DEPARTMENT OF TRANSPORTATION

PATCHING SCHEDULE  
MANHATTAN-MONEE RD.

SCALE: SHEET NO. OF SHEETS STA. TO STA.

F.A.P. RTE.	SECTION	COUNTY	TOTAL SHEETS	SHEET NO.
VAR.	2008-012 PP	WILL	33	24
FED. ROAD DIST. NO. 1 [ILLINOIS] FED. AID PROJECT			CONTRACT NO. 60E38	



ROUTE: Richards St. (4th to US 52)

CROSS STREETS		DIRECTION (EB/WB) (NB/SB)	LANE NO. (1, 2, 3)	PAVEMENT PATCH WIDTH	PAVEMENT PATCH LENGTH	REPAIR AREA (SQ FT)	REPAIR AREA (SQ YD)	MILL & RESURF	CLASS D PATCH TYPE I	CLASS D PATCH TYPE II	CLASS D PATCH TYPE III	CLASS D PATCH TYPE IV	PAVT MARKING 4"	RAISED REFL PAVT MKS
FROM	TO													
4th Ave	US 52	sb lane line	1 & 2	2	4	8	1		1					
4th Ave	US 52	"	"	2	3	6	1		1					
4th Ave	US 52	"	"	2	3	6	1		1					
4th Ave	US 52	"	"	2	4	8	1		1					
4th Ave	US 52	sb	23 ea	4	24	96	11			253				
4th Ave	US 52	nb lane line	10 ea	2	4	80	9		9					

TOTAL:

13  
SY

253  
SY

FT EACH

FILE NAME *	USER NAME = amthkl	DESIGNED -	REVISED -	<b>STATE OF ILLINOIS DEPARTMENT OF TRANSPORTATION</b>	<b>PATCHING SCHEDULE RICHARDS ST.</b>	F.A.P. RTE.	SECTION	COUNTY	TOTAL SHEETS	SHEET NO.	
ca\projects\rd136308\design_aa.dgn	DRAWN -	REVISED -	VAR.			2008-012 PP	WILL	33	26		
PLOT SCALE = 100.0000' / IN.	CHECKED -	REVISED -	SCALE:			SHEET NO.	OF	SHEETS	STA.	TO STA.	FED. ROAD DIST. NO. 1 (ILLINOIS) FED. AID PROJECT
PLOT DATE = 3/14/2008	DATE -	REVISED -	<i>Handwritten signature/initials</i>								

ROUTE: Washington St (US 30 to Briggs Rd)

CROSS STREETS		DIRECTION (EB/WB) (NB/SB)	LANE NO. (1, 2, 3)	PAVEMENT PATCH WIDTH	PAVEMENT PATCH LENGTH	REPAIR AREA (SQ FT)	REPAIR AREA (SQ YD)	MILL & RESURF	CLASS D PATCH TYPE I	CLASS D PATCH TYPE II	CLASS D PATCH TYPE III	CLASS D PATCH TYPE IV	PAVT MARKING 4"	RAISED REFL PAVT MKS
FROM	TO													
US 30	Cherry Hill Rd	sb	4ea	2	2	16	3		3					
"	"	sb	4ea	4	4	64	7		7					
"	"	sb	3ea	10	2	60	7		7					
"	"	nb	2ea	2	2	8	1		7					
"	"	nb	2ea	6	11	132	15			15				

TOTALS:

24  
SY      15  
SY

ROUTE: IL 1 (Steger Rd to County Line Rd)

CROSS STREETS		DIRECTION (EB/WB) (NB/SB)	LANE NO. (1, 2, 3)	PAVEMENT PATCH WIDTH	PAVEMENT PATCH LENGTH	REPAIR AREA (SQ FT)	REPAIR AREA (SQ YD)	MILL & RESURF	CLASS D PATCH TYPE I	CLASS D PATCH TYPE II	CLASS D PATCH TYPE III	CLASS D PATCH TYPE IV	PAVT MARKING 4"	RAISED REFL PAVT MKS
FROM	TO													
.1 Miles South of Goodenow		SB	1	3	30	90	10							
At Chestnut Ln		SB	1	2	2	4	0							
At Chestnut Ln		SB	1	2	6	12	1		1					
1.5 Miles South of Chesnut		SB	1	10	12	120	13			13				
.1 Miles North of Corning Rd		SB	1	2	2	4	0							
At Corning Rd		SB	1	2	2	4	0							
50' South of Corning Rd		SB	1	3	12	36	4		4					
.2 Miles South of Corning Rd		SB	1	2	2	4	0							
.7 Miles South of Corning Rd		SB	1	12	150	1800	200	200						
Just North of County Line Rd		JT	JT	0.5	400	200	22				22			
.1 Miles North of County Line Rd		SB	1	6	12	72	8			8				
.2 Miles North of County Line Rd		SB	1	6	12	72	8			8				
.25 Miles North of County Line Rd		SB	1	6	12	72	8			8				
.3 Miles North of County Line Rd		SB	1	3	12	36	4		4					
.3 Miles North of County Line Rd		SB	1	3	12	36	4		4					
.3 Miles North of County Line Rd		SB	1	4	4	12	1		1					
.1 Miles North of Kentucky Rd		NB	1	4	100	400	44	44						
.5 Miles North of Kentucky Rd		NB	1	4	350	1400	156	156						
At Corning Rd		NB	1	12	40	480	53	53						
.3 Miles North of Corning Rd		NB	1	6	420	2520	280	280						
.2 Miles North of Church Rd		NB	1	4	4	16	2		2					
.8 Miles North of Church Rd		NB	1	4	12	48	5		5					
At Eagle Lake Rd		NB	1	2	8	16	2		2					
.5 Miles North of Eagle Lake Rd		NB	1	3	450	1350	150	150						
.7 Miles North of Eagle Lake Rd		NB	1	4	4	16	2		2					
.7 Miles North of Eagle Lake Rd		NB	1	3	40	120	13			13				
.8 Miles North of Eagle Lake Rd		NB	1	6	12	72	8			8				
1 Mile North of Eagle Lake Rd		NB	1	3	600	1800	200	200						
.1 Miles South of Old Monee Rd		SB	1	4	67	268	30					30		
.3 Miles South of Old Monee Rd		SB	2	2	2	4	0							
Windsor St	Kent St	SB	1	2	2	4	0							
Windsor St	Kent St	SB	1	2	2	4	0							
Windsor St	Kent St	SB	1	4	8	32	4		4					
South of Kent St		SB	2	3	4	12	1		1					
South of Kent St		SB	1	6	10	60	7			7				
.2 Miles South of Kent St		SB	2	6	8	48	5		5					
.2 Miles South of Kent St		SB	1	4	27	108	12			12				
.2 Miles South of Kent St		SB	J	0.25	5	1.25	0							
.4 Miles South of Kent St		SB	1	4	25	100	11			11				
.1 Miles North of Elms Court Ln		SB	1	12	80	960	107	107						
.3 Miles South of Arlington Ln		SB	1	3	3	9	1		1					
Just North of Goodenow Rd		SB	1	12	60	720	80	80						
.6 Miles North of Goodenow Rd		NB	1	6	12	72	8			8				
.1 Miles North of Elms Ct		NB	1	4	14	56	6			6				
.1 Miles North of Elms Ct		NB	1	3	40	120	13			13				
.1 Miles North of Elms Ct		NB	1	2	12	24	3		3					
.2 Miles North of Old Monee Rd		NB	1	4	8	32	4		4					
.2 Miles North of Old Monee Rd		NB	2	4	4	16	2		2					
.3 Miles North of Crete Monee Rd		NB	2	4	30	120	13			13				
Just South of Burville Rd		NB	1	12	120	1440	160	160						
100' South of Burville Rd		NB	1	4	4	16	2		2					
At 1st St		NB	1	16	233	3728	414	414						
.1 Miles North of 5th St		NB	1	6	10	60	7			7				
At 136th Street - South of Steger Rd		SB	1 & 2	0.17	45	7.5	1		1					
.2 Miles South of Union Ave		SB	1	2	2	4	0							
At Union Ave		NB	1	12	364	4368	485	485						
At Union Ave		NB	2	12	364	4368	485	485						
.4 Miles South of Union Ave		SB	1	2	2	4	0							
.5 Miles South of Union Ave		SB	1	2	2	4	0							
At 5th Street		SB	1	2	2	4	0							
North of 1st Street		SB	1	4	4	16	2		2					
10' South of Burville Rd		SB	1	2	2	4	0							
75' South of Burville Rd		SB	1	6	30	180	20				20			
.1 Miles South of Burville Rd		SB	1	6	20	120	13			13				
.2 Miles South of Burville Rd		SB	2	4	72	288	32				32			
.3 Miles South of Burville Rd		SB	2	4	4	16	2		2					
.4 Miles South of Burville Rd		SB	2	4	4	16	2		2					
.5 Miles South of Burville Rd		SB	2	12	15	180	20				20			
50' North of Old Monee Rd		SB	2	6	10	60	7			7				
At Old Monee Rd		SB	2	2	2	4	0							
At Old Monee Rd		SB	1	8	50	400	44	44						

Total 3208 SY 2858 SY 54 SY 165 SY 62 SY 62 SY 1900 FT 100 EACH

FILE NAME =  
c:\projects\136308\design\_aa.dgn  
PLOT SCALE = 100.0000' / IN.  
PLOT DATE = 3/17/2008

USER NAME = wlgroendp  
DESIGNED -  
DRAWN -  
CHECKED -  
DATE - 3/17/08  
REVISED -  
REVISED -  
REVISED -  
REVISED -

STATE OF ILLINOIS  
DEPARTMENT OF TRANSPORTATION

PATCHING SCHEDULE  
IL 1  
SCALE: SHEET NO. OF SHEETS STA. TO STA.

F.A.P. RTE. SECTION COUNTY TOTAL SHEETS SHEET NO.  
VAR. 2008-012 PP WILL 33 27A  
CONTRACT NO. 60E38  
FED. ROAD DIST. NO. 1 ILLINOIS FED. AID PROJECT

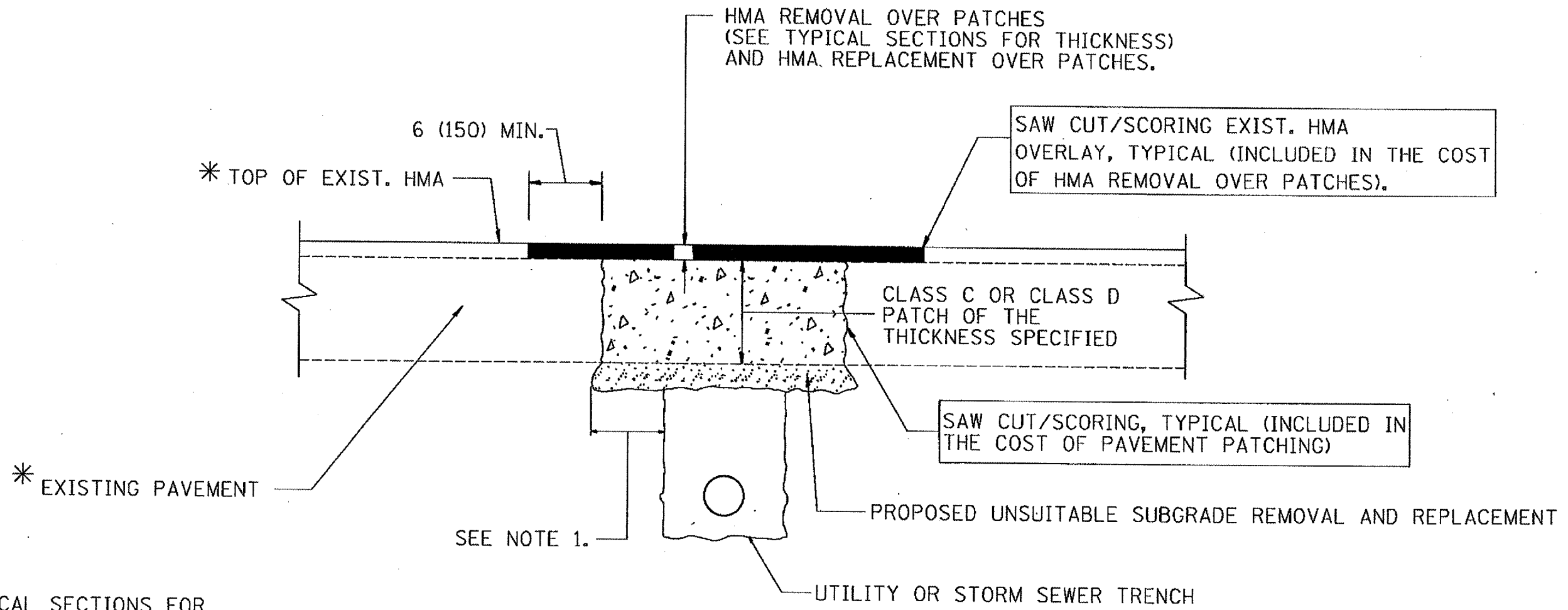

\* SEE TYPICAL SECTIONS FOR THICKNESS AND MATERIALS

**NOTES:**

1. THE WIDTH OF THE FULL DEPTH PATCH OVER A TRENCH SHALL BE 12 (300) WIDER ON EACH SIDE OF THE TRENCH.
2. FOR METHOD OF MEASUREMENT AND BASIS OF PAYMENT, SEE RECURRING SPECIAL PROVISION "PATCHING WITH HOT-MIX ASPHALT OVERLAY REMOVAL".
3. THE TOP 1 1/2 INCHES OF PROPOSED HOT-MIX ASPHALT REPLACEMENT OVER PATCHES SHALL BE HOT-MIX ASPHALT SURFACE COURSE, MIX "D", N70. THE COST SHALL BE INCLUDED IN THE COST OF THE PAY ITEM FOR HOT-MIX ASPHALT REPLACEMENT OVER PATCHES.

**SEQUENCE OF CONSTRUCTION**

1. REMOVE THE EXISTING HMA MATERIAL OVER THE AREA TO BE PATCHED.
2. REMOVE AND REPLACE FULL DEPTH PATCHES
3. REPLACE HMA MATERIAL OVER THE AREA TO BE PATCHED.

(4-9-08)

ALL DIMENSIONS ARE IN INCHES (MILLIMETERS) UNLESS OTHERWISE SHOWN.

FILE NAME *	USER NAME * wlgreandp	DESIGNED - R. SHAH	REVISED - A. ABBAS 01-20-98	<b>STATE OF ILLINOIS DEPARTMENT OF TRANSPORTATION</b>	<b>SPECIAL DETAIL PAVEMENT PATCHING FOR HMA SURFACED PAVEMENT</b>		F.A. R.T.E.	SECTION	COUNTY	TOTAL SHEETS	SHEET NO.	
\\nas1n1fa2\users\wlgreandp\desk\top\Copy of bd22.dgn		DRAWN -	REVISED - A. ABBAS 04-27-98		SCALE: NONE	SHEET NO. 1 OF 1 SHEETS	STA.	TO STA.	2008-012 PP	WILL	33	28
PLOT SCALE * 1/8" = 1'-0"		CHECKED -	REVISED - R. BORO 01-01-07						BD400-04 (BD-22)			
PLOT DATE * 4/9/2008		DATE - 10-25-94	REVISED - R. BORO 09-04-07									
								CONTRACT NO. 60E38				
								FED. ROAD DIST. NO. 1 ILLINOIS FED. AID PROJECT				

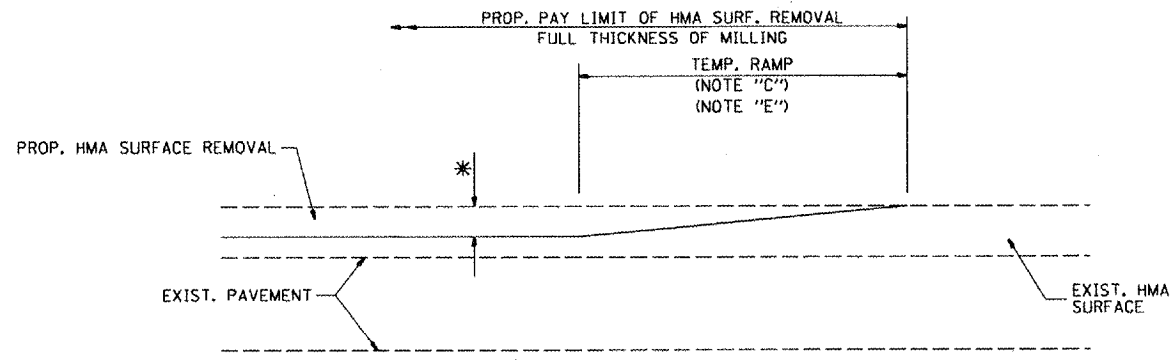

MILLED TEMPORARY RAMP  
(FOR BUTT JOINT AND HMA TAPER SEE DETAIL BELOW)

**OPTION 1**

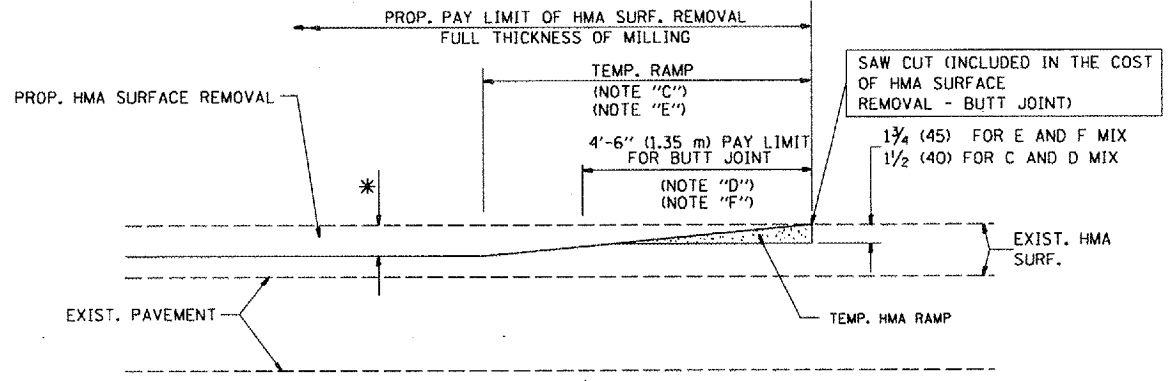

HMA CONSTRUCTED TEMPORARY RAMP  
(FOR BUTT JOINT AND HMA TAPER SEE DETAIL BELOW)

**OPTION 2**  
**TYPICAL TEMPORARY RAMP**

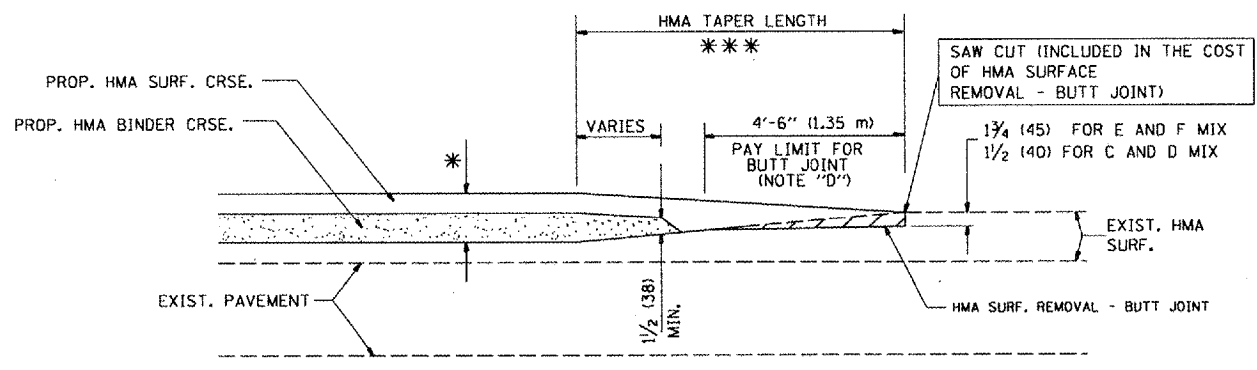

BUTT JOINT AND HMA TAPER  
**TYPICAL BUTT JOINT AND HMA TAPER FOR MILLING AND RESURFACING**

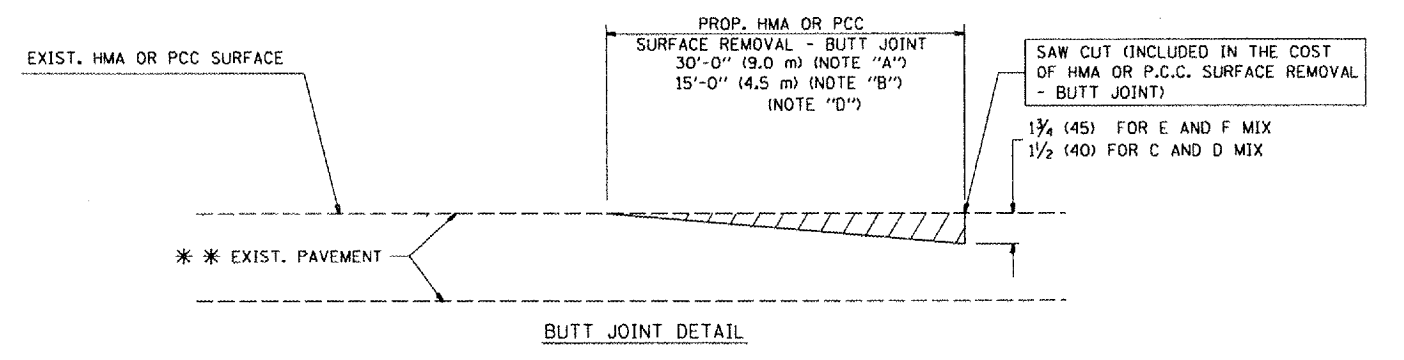

BUTT JOINT DETAIL

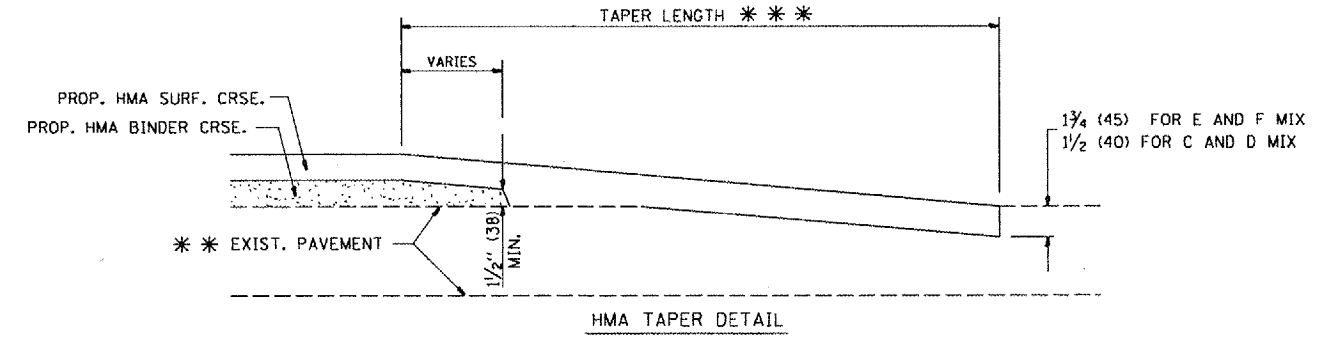

HMA TAPER DETAIL

**TYPICAL BUTT JOINT AND HMA TAPER FOR RESURFACING ONLY**

\*\*\* PC CONCRETE, HMA OR HMA RESURFACED PAVEMENT.

**NOTES**

- A: MAINLINE ROADWAYS AND MAJOR SIDE ROADS.
  - B: MINOR SIDE ROADS.
  - C: THE TEMP. RAMP SHALL BE CONSTRUCTED IMMEDIATELY UPON REMOVAL OF THE EXISTING HMA SURFACE.
  - D: THE BUTT JOINT SHALL BE CONSTRUCTED IMMEDIATELY PRIOR TO PLACING THE PROPOSED HMA COURSES.
  - E: TAPER THE TEMP. RAMP AT A RATE OF 3'-0" (900 mm) PER 1 INCH (25 mm) OF MILLING THICKNESS.
  - F: INSTALLATION AND REMOVAL OF THE 4'-6" (1.35 m) TEMP. RAMP IS INCLUDED IN COST OF HMA SURFACE REMOVAL - BUTT JOINT
  - G: SEE ARTICLE 406.08 AND 406.14 OF THE STANDARD SPECIFICATIONS FOR "HMA AND/OR PCC SURFACE REMOVAL, BUTT JOINT".
- \* SEE TYPICAL SECTIONS FOR MILLING THICKNESS.
- \*\*\* 20'-0" (6.1 m) PER 1 (25) RESURFACING (NOTE "A")  
10'-0" (3.0 m) PER 1 (25) RESURFACING (NOTE "B")

**BASIS OF PAYMENT:**

THE BUTT JOINT WILL BE PAID FOR AT THE CONTRACT UNIT PRICE PER SQUARE YARD (SQUARE METER) FOR "HOT-MIX ASPHALT SURFACE REMOVAL - BUTT JOINT" OR FOR "PORTLAND CEMENT CONCRETE SURFACE REMOVAL - BUTT JOINT".

ALL DIMENSIONS ARE IN INCHES (MILLIMETERS) UNLESS OTHERWISE SHOWN.

FILE NAME =	USER NAME = amsthkl	DESIGNED - M. DE YONG	REVISED - R. SHAH 10-25-94
W:\data\td\22x34\bd32.dgn		DRAWN -	REVISED - A. ABBAS 03-21-97
	PLOT SCALE = 1/32" = 1/8" / IN.	CHECKED -	REVISED - M. GOMEZ 04-06-01
	PLOT DATE = 3/14/2008	DATE - 06-13-90	REVISED - R. BORO 01-01-07

**STATE OF ILLINOIS  
DEPARTMENT OF TRANSPORTATION**

<b>BUTT JOINT AND HMA TAPER DETAILS</b>		SCALE: NONE	SHEET NO. 1 OF 1 SHEETS	STA. TO STA.
---	--	-------------	-------------------------	--------------

F.A. RTE.	SECTION	COUNTY	TOTAL SHEETS	SHEET NO.
VAR	2008-012 PP	WILL	33	29
BD400-05 BD32		CONTRACT NO. 60E38		
FED. ROAD DIST. NO. 1 ILLINOIS FED. AID PROJECT				

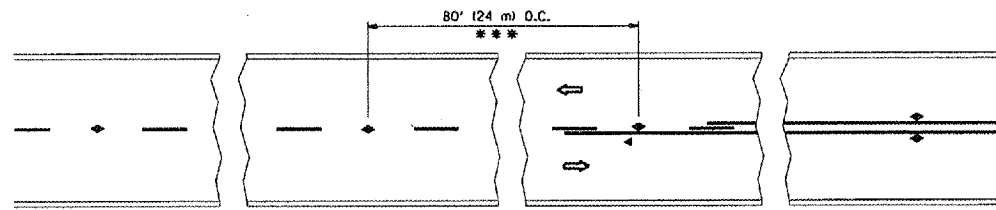

\*\*\* REDUCE TO 40' (12 m) O.C. ON CURVES WITH POSTED OR ADVISORY SPEED 45 M.P.H. (70 km/h) OR LESS.

TWO-LANE/TWO-WAY

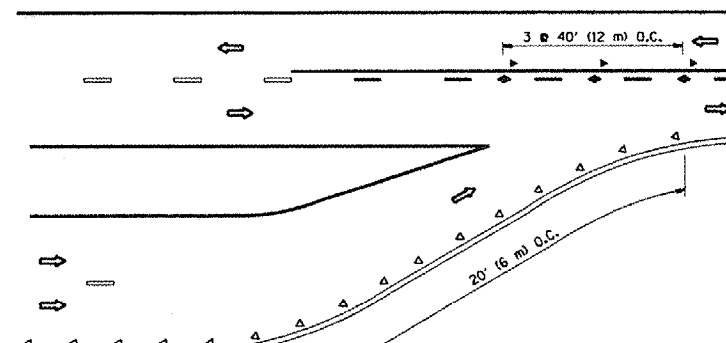

LANE REDUCTION TRANSITION

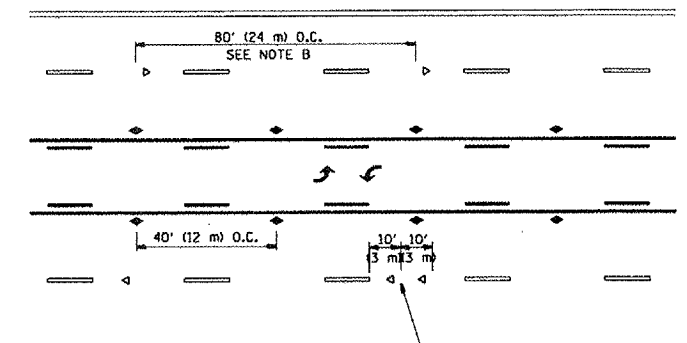

TWO-WAY LEFT TURN

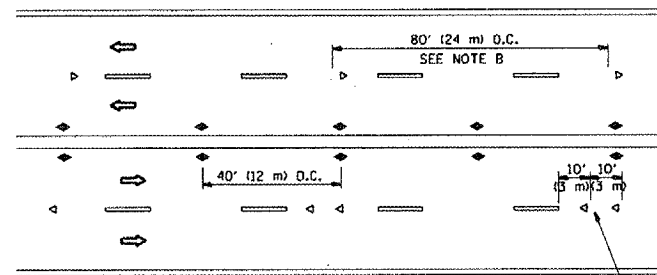

MULTI-LANE/UNDIVIDED

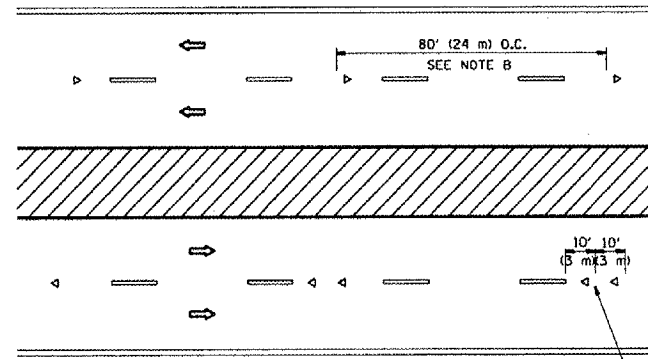

MULTI-LANE/DIVIDED

GENERAL NOTES

1. MARKERS USED WITH DASHED LINES SHALL BE CENTERED IN THE GAP BETWEEN SEGMENTS.
2. MARKERS USED ADJACENT TO SOLID LINES SHALL BE OFFSET 2 TO 3 (50 TO 75) TOWARD TRAFFIC AS SHOWN.
3. MARKERS THROUGH TANGENTS LESS THAN 500' (150 m) IN LENGTH BETWEEN CURVES SHALL BE INSTALLED AT THE LESSER OF THE TWO CURVE SPACINGS.

SYMBOLS

- YELLOW STRIPE
- WHITE STRIPE
- ◀ ONE-WAY AMBER MARKER
- ◀ ONE-WAY CRYSTAL MARKER (W/O)
- ◀ TWO-WAY AMBER MARKER

LANE MARKER NOTES

- A. USE DOUBLE LANE LINE MARKERS SPACED AS SHOWN.
- B. REDUCE TO 40' (12 m) O.C. ON CURVES WHERE ADVISORY SPEEDS ARE 10 M.P.H. (20 km/h) LOWER THAN POSTED SPEEDS.

DESIGN NOTES

1. DOUBLE LANE LINE MARKERS SHALL BE USED UNLESS SPECIFIED OTHERWISE.
2. EXCEPT AS SHOWN ON THE LANE REDUCTION TRANSITION AND FREEWAY EXIT RAMP DETAIL, MARKERS ARE NOT TO BE SPECIFIED ON RIGHT EDGE LINES.
3. THE EXACT MARKER LIMITS, SPACING, AND COLOR SHOULD BE INCLUDED IN THE PLANS.
4. MARKERS SHOULD NOT BE USED ALONGSIDE CURBS EXCEPT FOR EXTREMELY SHORT SECTIONS OF CURBS WHERE NOT MORE THAN TWO MARKERS WOULD BE INVOLVED.

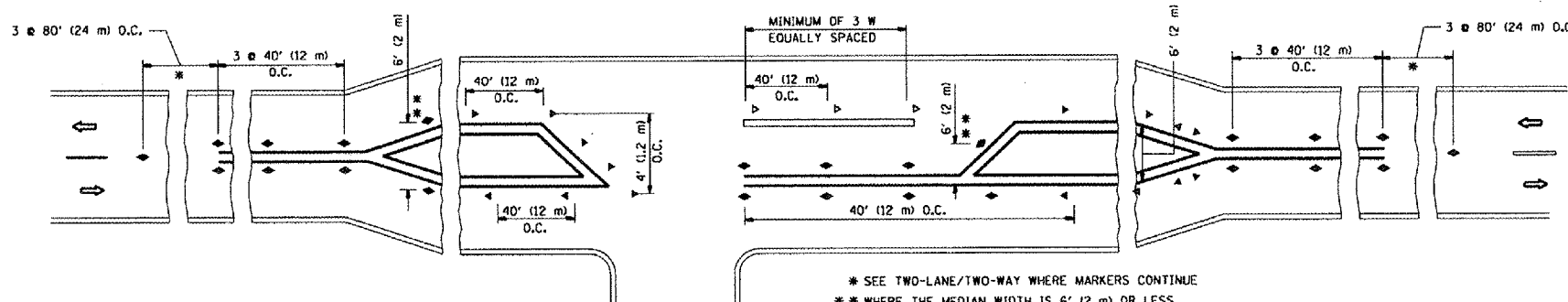

LEFT TURN

\* SEE TWO-LANE/TWO-WAY WHERE MARKERS CONTINUE  
 \*\* WHERE THE MEDIAN WIDTH IS 6' (2 m) OR LESS USE TWO-WAY MARKERS.

All dimensions are in inches (millimeters) unless otherwise shown.

FILE NAME = W:\distsd\22x34\tell.dgn	USER NAME = smthk1	DESIGNED -	REVISED - T. RAMMACHER 09-19-94	STATE OF ILLINOIS DEPARTMENT OF TRANSPORTATION	TYPICAL APPLICATIONS		F.A. RTE.	SECTION	COUNTY	TOTAL SHEETS	SHEET NO.
	PLOT SCALE = 183.785' / IN.	DRAWN -	REVISED - T. RAMMACHER 03-12-99		RAISED REFLECTIVE PAVEMENT MARKERS (SNOW-FLOW RESISTANT)	SCALE: NONE	SHEET NO. 1 OF 1 SHEETS	STA.	TO STA.	VAR 2008-012 PP	WILL
PLOT DATE = 3/14/2008	CHECKED -	REVISED - T. RAMMACHER 01-06-00	REVISED -				TC-11		CONTRACT NO. 60E38		
	DATE -						FED. ROAD DIST. NO. 1 ILLINOIS FED. AID PROJECT				

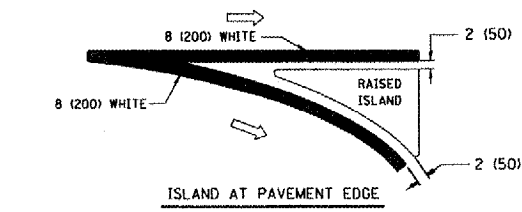
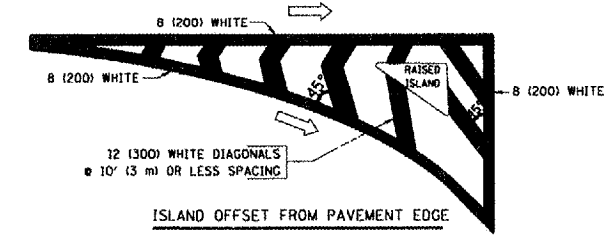
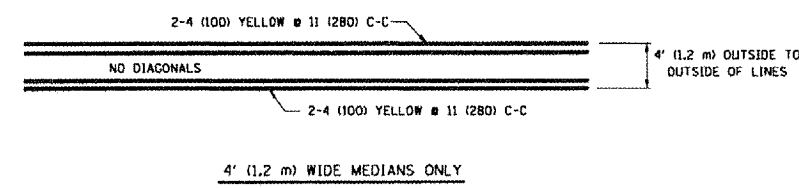
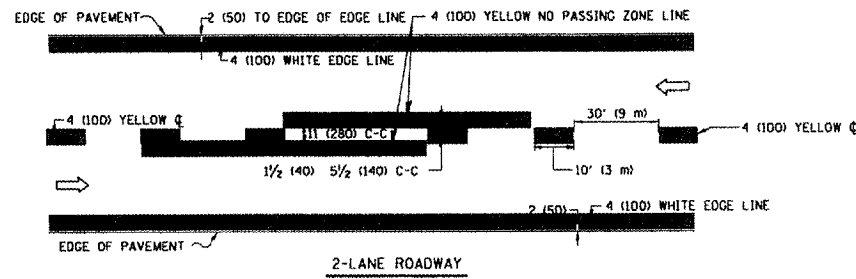

TYPICAL ISLAND MARKING

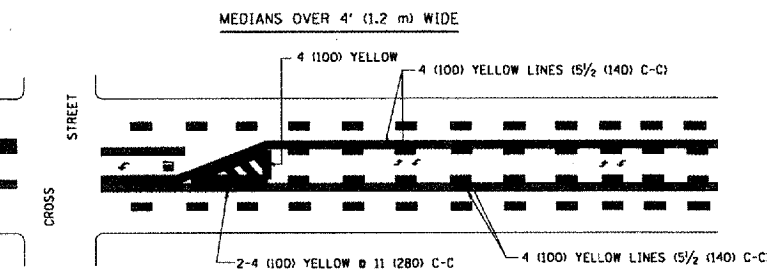
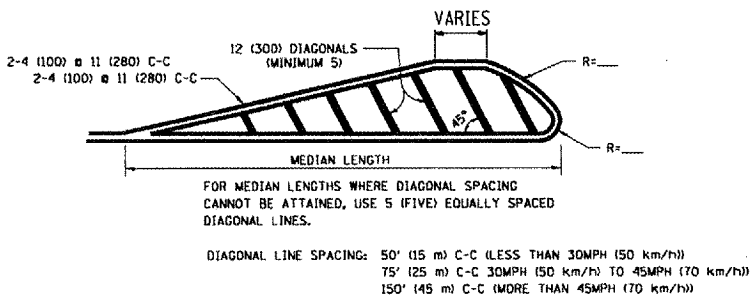
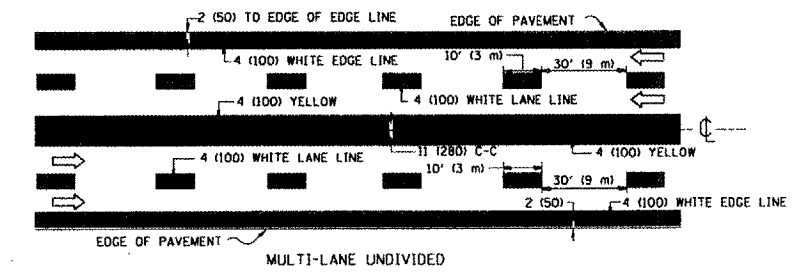

TYPICAL PAINTED MEDIAN MARKING

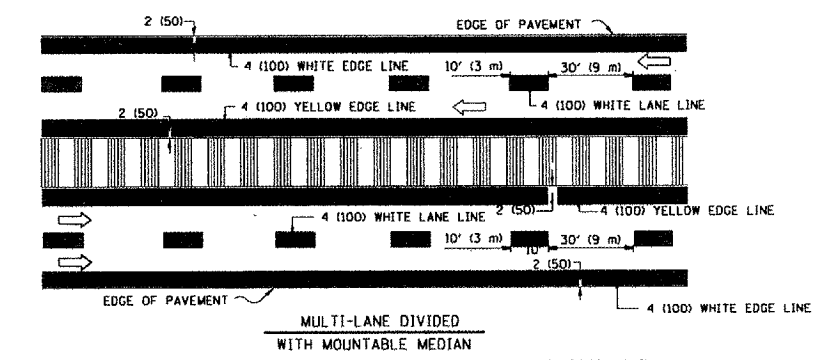

NOTE: MEDIANS WITH BARRIER CURB DO NOT REQUIRE AN EDGE LINE

TYPICAL LANE AND EDGE LINE MARKING

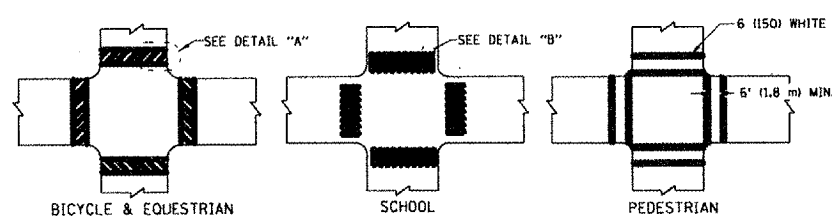

TYPICAL CROSSWALK MARKING

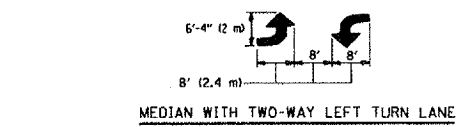

TYPICAL TURN LANE MARKING

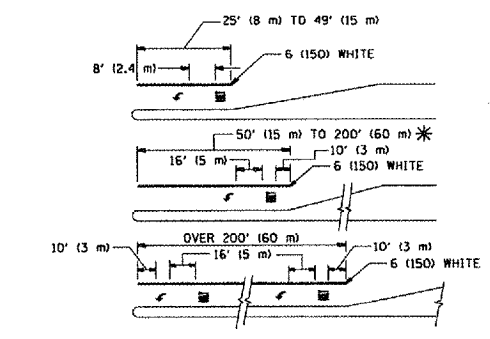

FULL SIZE LETTERS 8' (2.4 m) AND ARROWS SHALL BE USED.  
 \* AREA = 15.6 SQ. FT. (1.5 m<sup>2</sup>) ONLY AREA = 20.8 SQ. FT. (1.9 m<sup>2</sup>)  
 \* TURN LANES IN EXCESS OF 400' (120 m) IN LENGTH MAY HAVE AN ADDITIONAL SET OF ARROW - "ONLY" INSTALLED MIDWAY BETWEEN THE OTHER TWO SETS OF ARROW - "ONLY".

TYPICAL TURN LANE MARKING

TYPE OF MARKING	WIDTH OF LINE	PATTERN	COLOR	SPACING / REMARKS
CENTERLINE ON 2 LANE PAVEMENT	4 (100)	SKIP-DASH	YELLOW	10' (3 m) LINE WITH 30' (9 m) SPACE
CENTERLINE ON MULTI-LANE UNDIVIDED PAVEMENT	2 @ 4 (100)	SOLID	YELLOW	11 (280) C-C
NO PASSING ZONE LINES: FOR ONE DIRECTION FOR BOTH DIRECTIONS	4 (100) 2 @ 4 (100)	SOLID SOLID	YELLOW YELLOW	5/2 (140) C-C FROM SKIP-DASH CENTERLINE 11 (280) C-C OMIT SKIP-DASH CENTERLINE BETWEEN
LANE LINES	4 (100) 5 (125) ON FREEWAYS	SKIP-DASH SKIP-DASH	WHITE WHITE	10' (3 m) LINE WITH 30' (9 m) SPACE
DOTTED LINES (EXTENSIONS OF CENTER, LANE OR TURN LANE MARKINGS)	SAME AS LINE BEING EXTENDED	SKIP-DASH	SAME AS LINE BEING EXTENDED	2' (600) LINE WITH 6' (1.8 m) SPACE
EDGE LINES	4 (100)	SOLID	YELLOW-LEFT WHITE-RIGHT	OUTLINE MOUNTABLE MEDIANS IN YELLOW; EDGE LINES ARE NOT USED NEXT TO BARRIER CURB
TURN LANE MARKINGS	6 (150) LINE; FULL SIZE LETTERS & SYMBOLS (8' (2.4m))	SOLID	WHITE	SEE TYPICAL TURN LANE MARKING DETAIL
TWO WAY LEFT TURN MARKING	2 @ 4 (100) EACH DIRECTION 8' (2.4m) LEFT ARROW	SKIP-DASH AND SOLID IN PAIRS	YELLOW WHITE	10' (3 m) LINE WITH 30' (9 m) SPACE FOR SKIP-DASH; 5/2 (140) C-C BETWEEN SOLID LINE AND SKIP-DASH LINE SEE TYPICAL TWO-WAY LEFT TURN MARKING DETAIL
CROSSWALK LINES (PEDESTRIAN) A. DIAGONALS (BIKE & EQUESTRIAN) B. LONGITUDINAL BARS (SCHOOL)	2 @ 6 (150) 12 (300) @ 45° 12 (300) @ 90°	SOLID SOLID SOLID	WHITE WHITE WHITE	NOT LESS THAN 6' (1.8 m) APART 2' (600) APART SEE TYPICAL CROSSWALK MARKING DETAILS.
STOP LINES	24 (600)	SOLID	WHITE	PLACE 4' (1.2 m) IN ADVANCE OF AND PARALLEL TO CROSSWALK, IF PRESENT. OTHERWISE, PLACE AT DESIRED STOPPING POINT, PARALLEL TO CROSSROAD CENTERLINE, WHERE POSSIBLE
PAINTED MEDIANS	2 @ 4 (100) WITH 12 (300) DIAGONALS @ 45° NO DIAGONALS USED FOR 4' (1.2 m) WIDE MEDIANS	SOLID	YELLOW; TWO WAY TRAFFIC WHITE; ONE WAY TRAFFIC	11 (280) C-C FOR THE DOUBLE LINE SEE TYPICAL PAINTED MEDIAN MARKING.
GORE MARKING AND CHANNELIZING LINES	8 (200) WITH 12 (300) DIAGONALS @ 45°	SOLID	WHITE	DIAGONALS: 15' (4.5 m) C-C (LESS THAN 30MPH (50 km/h)) 20' (6 m) C-C (30MPH (50 km/h) TO 45MPH (70 km/h)) 30' (9 m) C-C (OVER 45MPH (70 km/h))
RAILROAD CROSSING	24 (600) TRANSVERSE LINES; "RR" IS 6' (1.8 m) LETTERS; 16 (400) LINE FOR "X"	SOLID	WHITE	SEE STATE STANDARD 780001 AREA OF: "R"=3.6 SQ. FT. (0.33 m <sup>2</sup> ) EACH "X"=54.0 SQ. FT. (5.0 m <sup>2</sup> )
SHOULDER DIAGONALS	12 (300) @ 45°	SOLID	WHITE - RIGHT YELLOW - LEFT	50' (15 m) C-C (LESS THAN 30MPH (50 km/h)) 75' (25 m) C-C (30 MPH (50 km/h) TO 45MPH (70 km/h)) 150' (45 m) C-C (OVER 45MPH (70 km/h))

FOR FURTHER DETAILS ON PAVEMENT MARKING REFER TO STANDARD SPECIFICATIONS FOR ROAD AND BRIDGE CONSTRUCTION AND STATE STANDARD 780001.



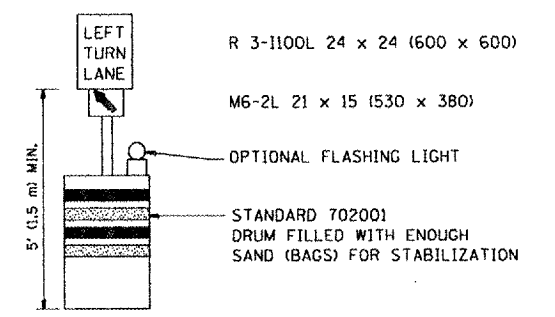
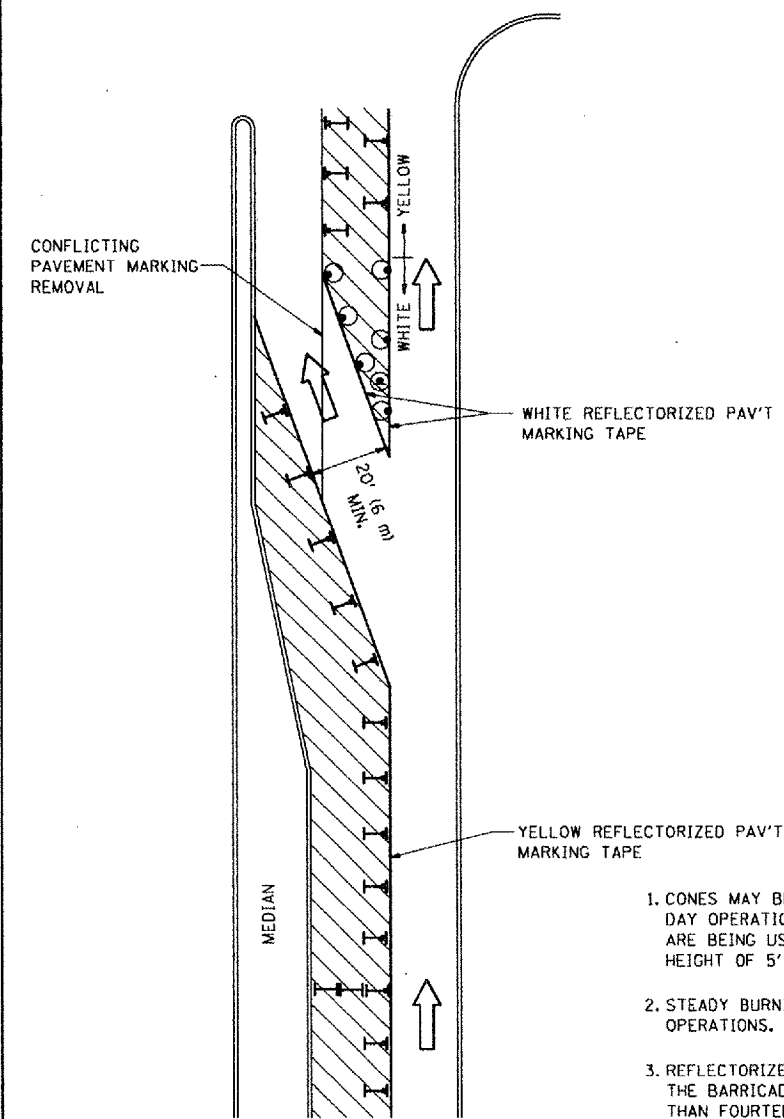

All dimensions are in inches (millimeter) unless otherwise shown.

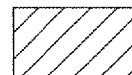
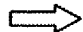

**GENERAL NOTES**

1. CONES MAY BE SUBSTITUTED FOR BARRICADES OR DRUMS AT HALF THE SPACING DURING DAY OPERATIONS. CONES SHALL BE A MINIMUM OF 28 (710) IN HEIGHT. WHEN CONES ARE BEING USED, THE "LEFT TURN LANE" SIGN MAY BE SKID MOUNTED AT A MINIMUM HEIGHT OF 5' (1.5 m).
2. STEADY BURNING LIGHTS WILL NOT BE REQUIRED ON BARRICADES OR DRUMS FOR DAY OPERATIONS. ALL LIGHTS SHALL BE MONODIRECTIONAL.
3. REFLECTORIZED TEMPORARY PAVEMENT MARKING TAPE SHALL BE PLACED THROUGHOUT THE BARRICADED AREA OF EACH TURN BAY WHERE THE CLOSURE TIME IS GREATER THAN FOURTEEN DAYS.
4. THIS APPLICATION ALSO APPLIES WHEN WORK IS BEING PERFORMED IN THE RIGHT LANE(S) AND THE RIGHT TURN BAY IS TO REMAIN OPEN. UNDER THIS CONDITION, "RIGHT TURN LANE" R3-100 24 x 24 (600 x 600) AND M6-2R 21 x 15 (530 x 380) SHALL BE USED.
5. THESE CONTROLS SHALL SUPPLEMENT MAINLINE TRAFFIC CONTROL FOR LANE CLOSURES.
6. LONGITUDINAL DIMENSIONS MAY BE ADJUSTED TO FIT FIELD CONDITIONS.
7. FORM BT 725 IS REQUIRED.
8. TRAFFIC CONTROL AND PROTECTION AT TURN BAYS (TO REMAIN OPEN TO TRAFFIC) SHALL BE INCLUDED IN THE COST SPECIFIED TRAFFIC CONTROL STANDARDS OR ITEMS.

**LEGEND**

-  WORK AREA
-  LANE OPEN TO TRAFFIC
-  TYPE I OR II BARRICADE WITH STEADY BURN LIGHT
-  DRUM WITH STEADY BURN LIGHT
-  DRUM WITH SIGN (WITH OPTIONAL FLASHING LIGHT) SEE DETAIL
-  TYPE I OR II CHECK BARRICADE WITH FLASHING LIGHT

All dimensions are in inches (millimeters) unless otherwise shown.

FILE NAME =	USER NAME = smathk	DESIGNED -	REVISED -T. RAMMACHER 09-08-94
W:\distatd\22x34\td14.dgn		DRAWN -	REVISED - A. HOUSEH 11-07-95
		PLOT SCALE = 103.7849 / IN.	REVISED - A. HOUSEH 10-12-96
		PLOT DATE = 3/14/2008	REVISED -T. RAMMACHER 01-06-00

**STATE OF ILLINOIS  
DEPARTMENT OF TRANSPORTATION**

**TRAFFIC CONTROL AND PROTECTION AT TURN BAYS  
(TO REMAIN OPEN TO TRAFFIC)**

SCALE: NONE SHEET NO. 1 OF 1 SHEETS STA. TO STA.

F.A. RTE.	SECTION	COUNTY	TOTAL SHEETS	SHEET NO.
VAR	2008-01Z PP	WILL	33	32
TC-14			CONTRACT NO. 60E38	
FED. ROAD DIST. NO. 1 ILLINOIS FED. AID PROJECT				



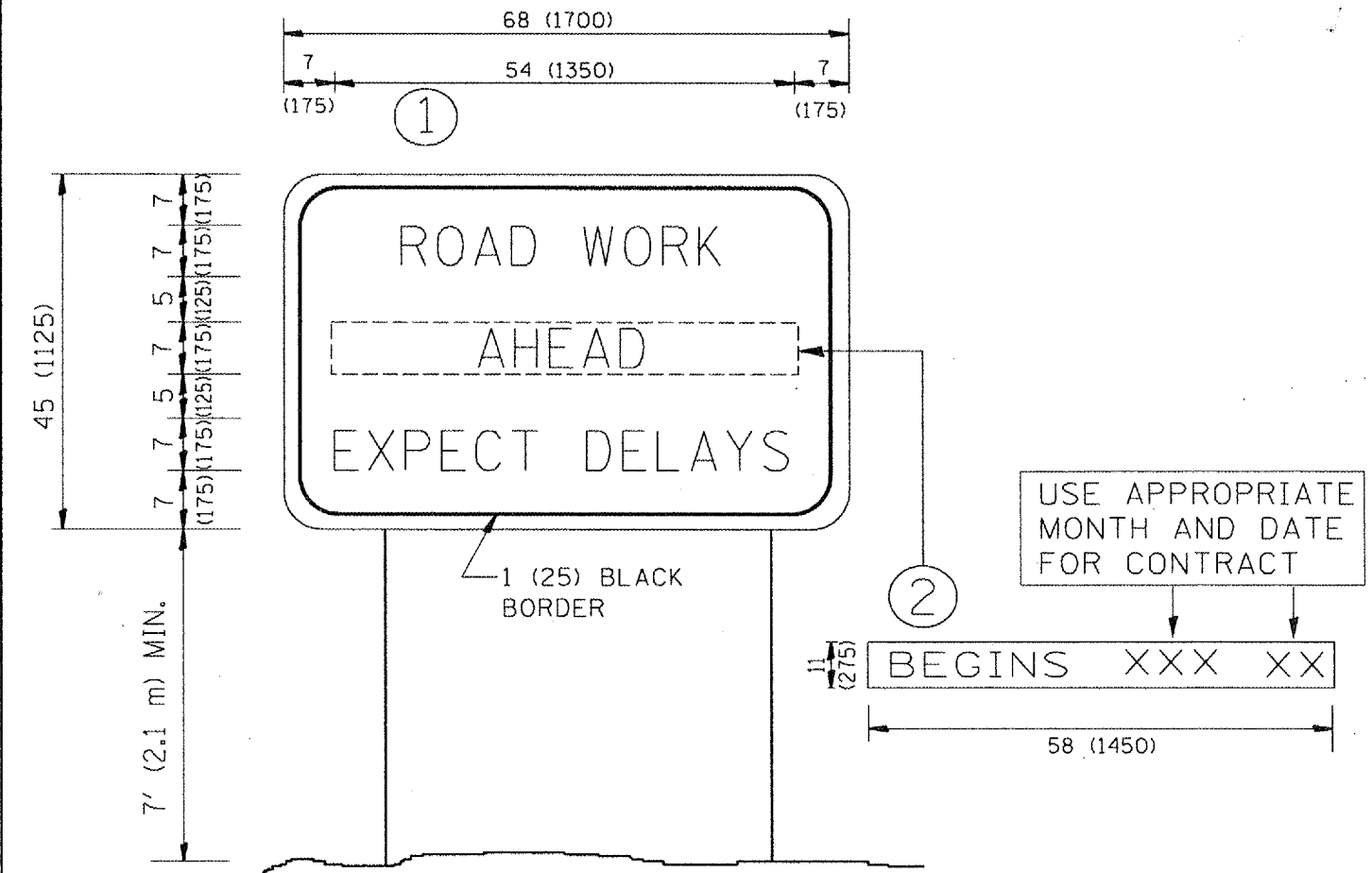

**NOTES:**

1. USE BLACK LETTERING ON ORANGE BACKGROUND.
2. ERECT SIGNS IN ADVANCE OF THE LOCATION FOR THE "ROAD CONSTRUCTION AHEAD" SIGN AT LOCATIONS AS DIRECTED BY THE ENGINEER.
3. ERECT SIGN ① WITH INSTALLED PANEL ② ONE WEEK PRIOR TO THE START OF CONSTRUCTION.
4. REMOVE PANEL ② SOON AFTER THE START OF CONSTRUCTION.
5. SEE SPECIAL PROVISION FOR "TEMPORARY INFORMATION SIGNING" FOR ADDITIONAL INFORMATION.
6. ONE SIGN ASSEMBLY EQUALS 25.70 SQ. FT. (2.3 SQ. M.)
7. SHALL BE PAID FOR AS TEMPORARY INFORMATION SIGNING.

ALL DIMENSIONS ARE IN INCHES (MILLIMETERS) UNLESS OTHERWISE SHOWN.

FILE NAME = W:\data\22x34\to22.dgn	USER NAME = smthk1	DESIGNED -	REVISED - R. MIRS 09-15-97
		DRAWN -	REVISED - R. MIRS 12-11-97
	PLOT SCALE = 103.705' / IN.	CHECKED -	REVISED - T. RAMMACHER 02-02-99
	PLOT DATE = 3/14/2008	DATE -	REVISED - C. JUCIUS 01-31-07

**STATE OF ILLINOIS  
DEPARTMENT OF TRANSPORTATION**

<b>ARTERIAL ROAD INFORMATION SIGN</b>		F.A. -	SECTION	COUNTY	TOTAL SHEETS	SHEET NO.
SCALE: NONE	SHEET NO. 1 OF 1 SHEETS	RTE.	TC-22	WILL	33	33
STA.	TO STA.	FED. ROAD DIST. NO. 1 ILLINOIS FED. AID PROJECT				

F.A. -	SECTION	COUNTY	TOTAL SHEETS	SHEET NO.
VAR	2008-012 PP	WILL	33	33
CONTRACT NO. 60E38				

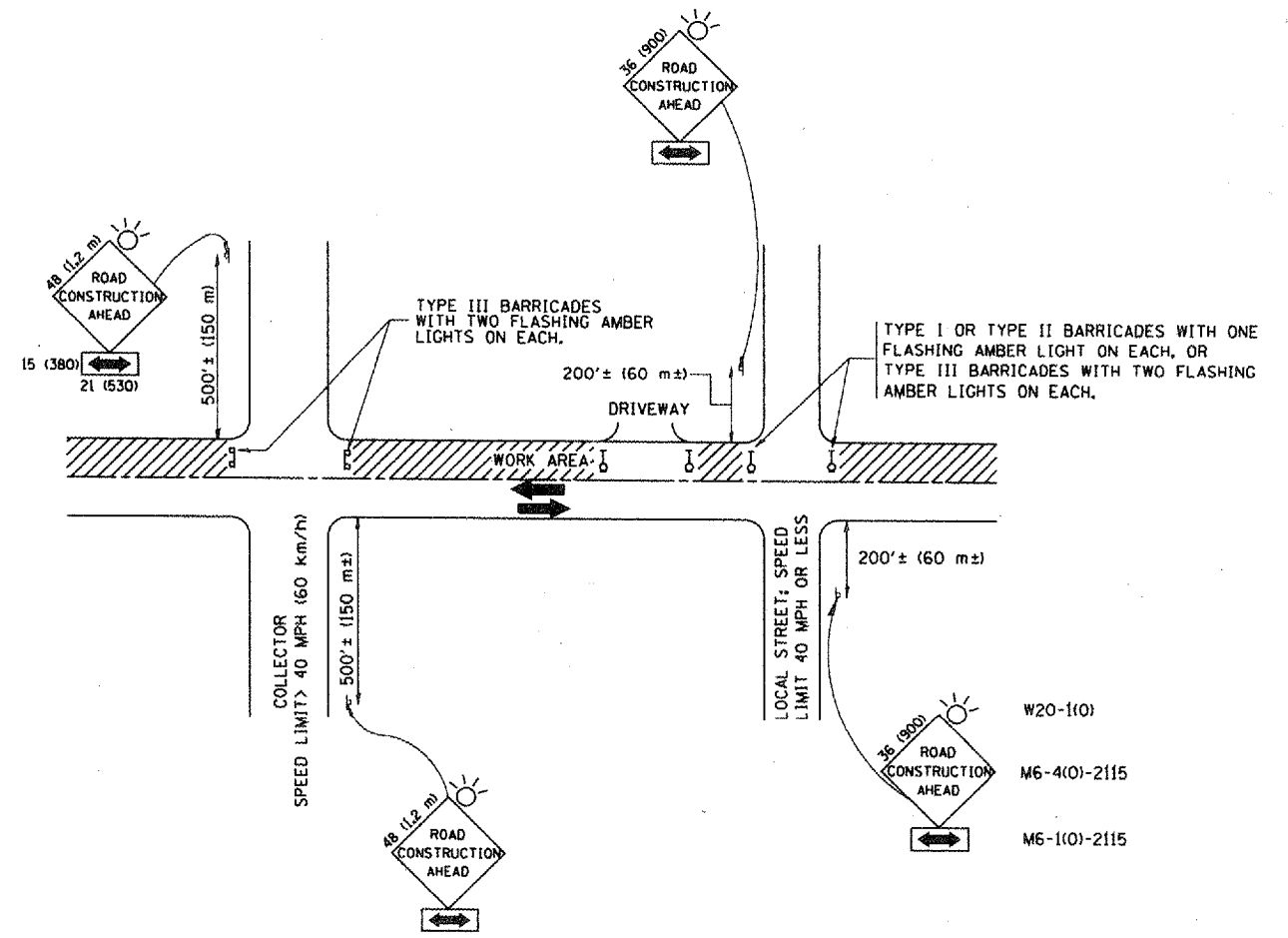

TRAFFIC CONTROL AND PROTECTION FOR SIDE ROADS, INTERSECTIONS, AND DRIVEWAYS

NOTES:

- A. FOR NO LANE RESTRICTION ON THE SIDE ROAD OR DRIVEWAYS
  - 1. SIDE ROAD WITH A SPEED LIMIT OF 40 MPH (60 km/h) OR LESS AS SHOWN ON THE DRAWING AND AS DIRECTED BY THE ENGINEER:
    - a) ONE ROAD CONSTRUCTION AHEAD SIGN 36 x 36 (900x900) WITH A FLASHER AND FLAG MOUNTED ON IT APPROXIMATELY 200' (60 m) IN ADVANCE OF THE MAIN ROUTE.
    - b) THE CLOSED PORTION OF THE MAIN ROUTE SHALL BE PROTECTED BY BLOCKING WITH TYPE I, TYPE II OR TYPE III BARRICADES, 1/3 OF THE CROSS SECTION OF THE CLOSED PORTION.
  - 2. SIDE ROAD WITH A SPEED LIMIT GREATER THAN 40 MPH (60 km/h) AS SHOWN ON THE DRAWING AND AS DIRECTED BY THE ENGINEER:
    - a) ONE ROAD CONSTRUCTION AHEAD SIGN 48 x 48 (1.2 m x 1.2 m) WITH A FLASHER MOUNTED ON IT APPROXIMATELY 500' (150 m) IN ADVANCE OF THE MAIN ROUTE.
    - b) THE CLOSED PORTION OF THE MAIN ROUTE SHALL BE PROTECTED BY BLOCKING WITH TYPE III BARRICADES, 1/2 OF THE CROSS SECTION OF THE CLOSED PORTION.
- 3. WHEN THE SIDE ROAD LIES BETWEEN THE BEGINNING OF THE MAINLINE SIGNING AND THE WORK ZONE, A SINGLE HEADED ARROW (M6-1) SHALL BE USED IN LIEU OF THE DOUBLE HEADED ARROW (M6-4).
- B. FOR A LANE CLOSURE ON A SIDE ROAD OR DRIVEWAY:
  - USE APPLICABLE PORTIONS OF THE TYPICAL APPLICATION OF TRAFFIC CONTROL DEVICES (STD. 701501, STD. 701606 OR THE APPROPRIATE STANDARD). THE SPACING OF SIGNS AND BARRICADES SHALL BE ADJUSTED FOR FIELD CONDITIONS AS DIRECTED BY THE ENGINEER. THE DIRECTIONAL ARROW SHALL BE COVERED OR REMOVED WHEN NO LONGER CONSISTENT WITH THE SIDE ROAD LANE CLOSURE.
- C. ADVANCE WARNING SIGNS ARE TO BE OMITTED ON DRIVEWAY UNLESS OTHERWISE NOTED.
- D. THE TRAFFIC CONTROL AND PROTECTION FOR SIDE ROADS, INTERSECTIONS, AND DRIVEWAYS SHALL BE INCIDENTAL TO THE COST OF SPECIFIED TRAFFIC CONTROL STANDARDS OR ITEMS.

All dimensions are in millimeters (inches) unless otherwise shown.

FILE NAME =	USER NAME = gegl.enabt	DESIGNED - LHA	REVISED - J. OBERLE 10-18-95
W:\diststd\22x34\col18.dgn		DRAWN -	REVISED - A. HOUSEH 03-06-96
		CHECKED -	REVISED - A. HOUSEH 10-15-96
		DATE - 06-89	REVISED - T. RAMMACHER 01-06-00

STATE OF ILLINOIS  
DEPARTMENT OF TRANSPORTATION

TRAFFIC CONTROL AND PROTECTION FOR  
SIDE ROADS, INTERSECTIONS, AND DRIVEWAYS

F.A. RTE.	SECTION	COUNTY	TOTAL SHEETS	SHEET NO.
VAR 2008-012 PP	TC-10	WILL	33	33A
FED. ROAD DIST. NO. 1 ILLINOIS FED. AID PROJECT			CONTRACT NO. 60E38	