

F.A.P. RTE.	SECTION	COUNTY	TOTAL SHEETS	SHEET NO.
374	3268F-R-1	COOK	279	36
STA. 122+00.00		TO STA. 148+00.00		
FED. ROAD DIST. NO.		ILLINOIS FED. AID PROJECT		
CONTRACT NO. 62387				

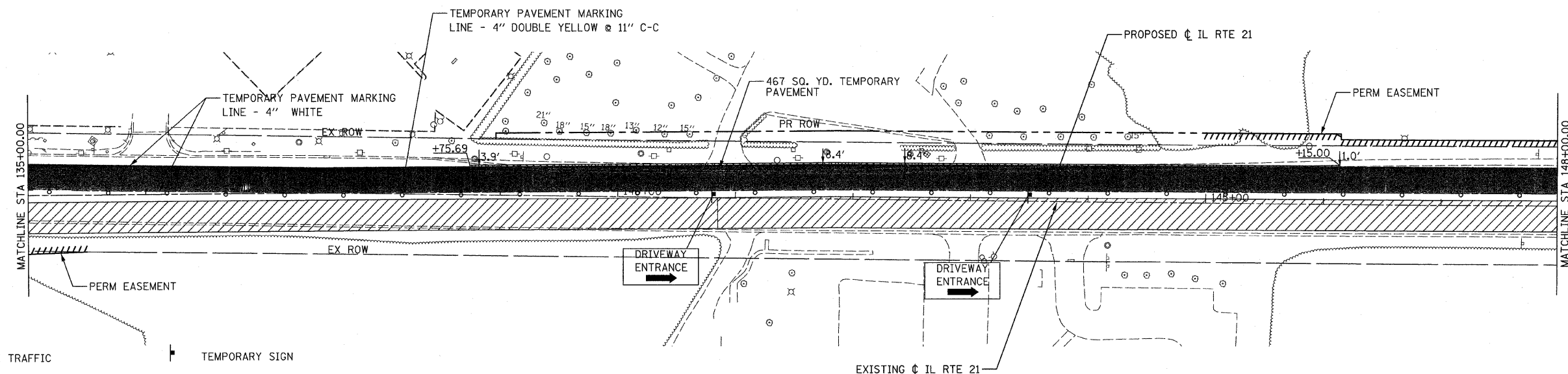
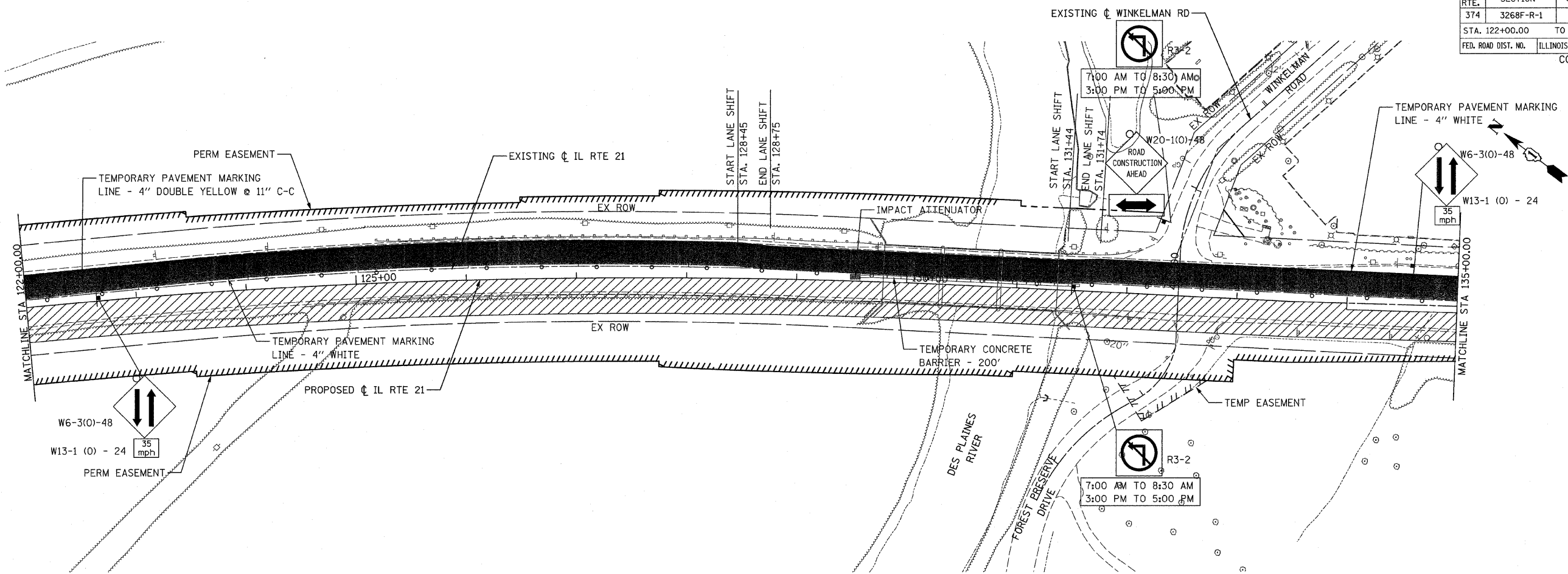

- LEGEND:**
- STAGE I TRAFFIC
  - STAGE I CONSTRUCTION
  - TEMPORARY PAVEMENT
  - DIRECTION OF TRAFFIC
  - DRUM WITH STEADY BURN LIGHT
  - TEMPORARY SIGN
  - ARROW BOARD
  - CONSTRUCTION SPEED LIMIT
  - BARRICADE TYPE III WITH STEADY BURN LIGHTS
  - FLASHING LIGHT

NOTE:  
1. FOR BRIDGE CONSTRUCTION  
DETAILS SEE STRUCTURAL PLANS.

**STV Incorporated**  
engineers/architects/scientists/construction managers  
200 W Monroe - Suite 1650  
Chicago, Illinois 60606

REVISIONS	
NAME	DATE

ILLINOIS DEPARTMENT OF TRANSPORTATION  
**SUGGESTED STAGES OF CONSTRUCTION AND TRAFFIC CONTROL**  
STAGE I - 3  
ILLINOIS ROUTE 21  
STA 122+00.00 TO STA 148+00.00

DATE: 02/05/08  
DRAWN BY: RDT  
CHECKED BY: GC

0 50' 100'  
1" = 50'