

F.A.P. RTE.	SECTION	COUNTY	TOTAL SHEETS	SHEET NO.
374	3268F-R-1	COOK	279	135
STA.		TO STA.		
FED. ROAD DIST. NO.		ILLINOIS FED. AID PROJECT		

CONTRACT NO. 62387

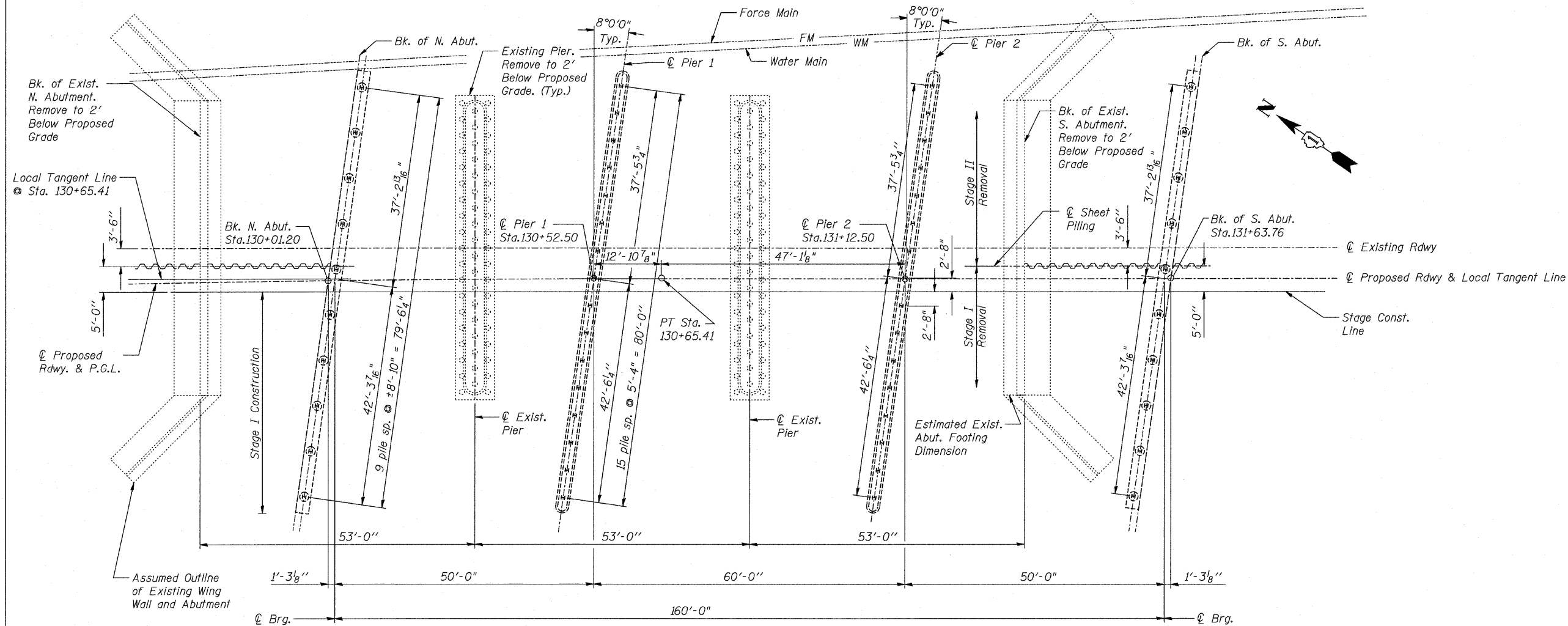

FOUNDATION PLAN

NOTE:
ALL DIMENSIONS SHOWN TO LOCAL TANGENT LINE

Notes:
See Sheets S-18 and S-20 of S-29 for Abutment sheets
See Sheets S-21 and S-22 of S-29 for Pier sheets

REVISIONS	
NAME	DATE

ILLINOIS DEPARTMENT OF TRANSPORTATION
ILLINOIS ROUTE 21
MILWAUKEE AVE. OVER DES PLAINES RIVER
F.A.P. ROUTE 374 SECTION 3268F-R-1
COOK COUNTY, SN 016-6566

FOUNDATION PLAN

DESIGN BY: BTO DRAWN BY: BTO
DATE: 02/05/08 CHECKED BY: JAN CHECKED BY: JAW



135/1000 1000/1000 1000/1000 1000/1000 1000/1000 1000/1000 1000/1000 1000/1000 1000/1000 1000/1000