

F.A.P. RITE.	SECTION	COUNTY	TOTAL SHEETS	SHEET NO.
374	3268F-R-1	COOK	279	138
STA.		TO STA.		
FED. ROAD DIST. NO.		ILLINOIS FED. AID PROJECT		

CONTRACT NO. 62387

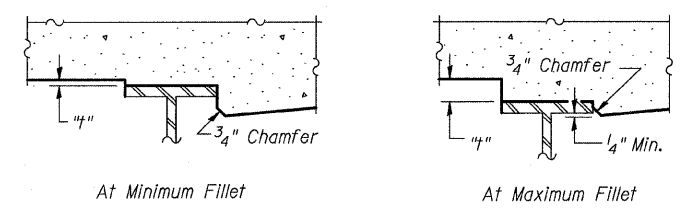

To determine fillet height "f", measure elevations at span quarter points as shown below after all steel has been erected. Add this number to the slab thickness and subtract the sum from the "Theoretical Grade Elev. Adjusted for Dead Load Deflection." This equals the fillet height above the beams.

FILLET HEIGHTS

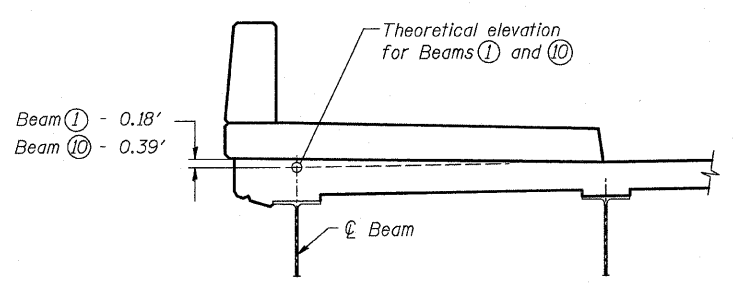

SIDEWALK SECTION

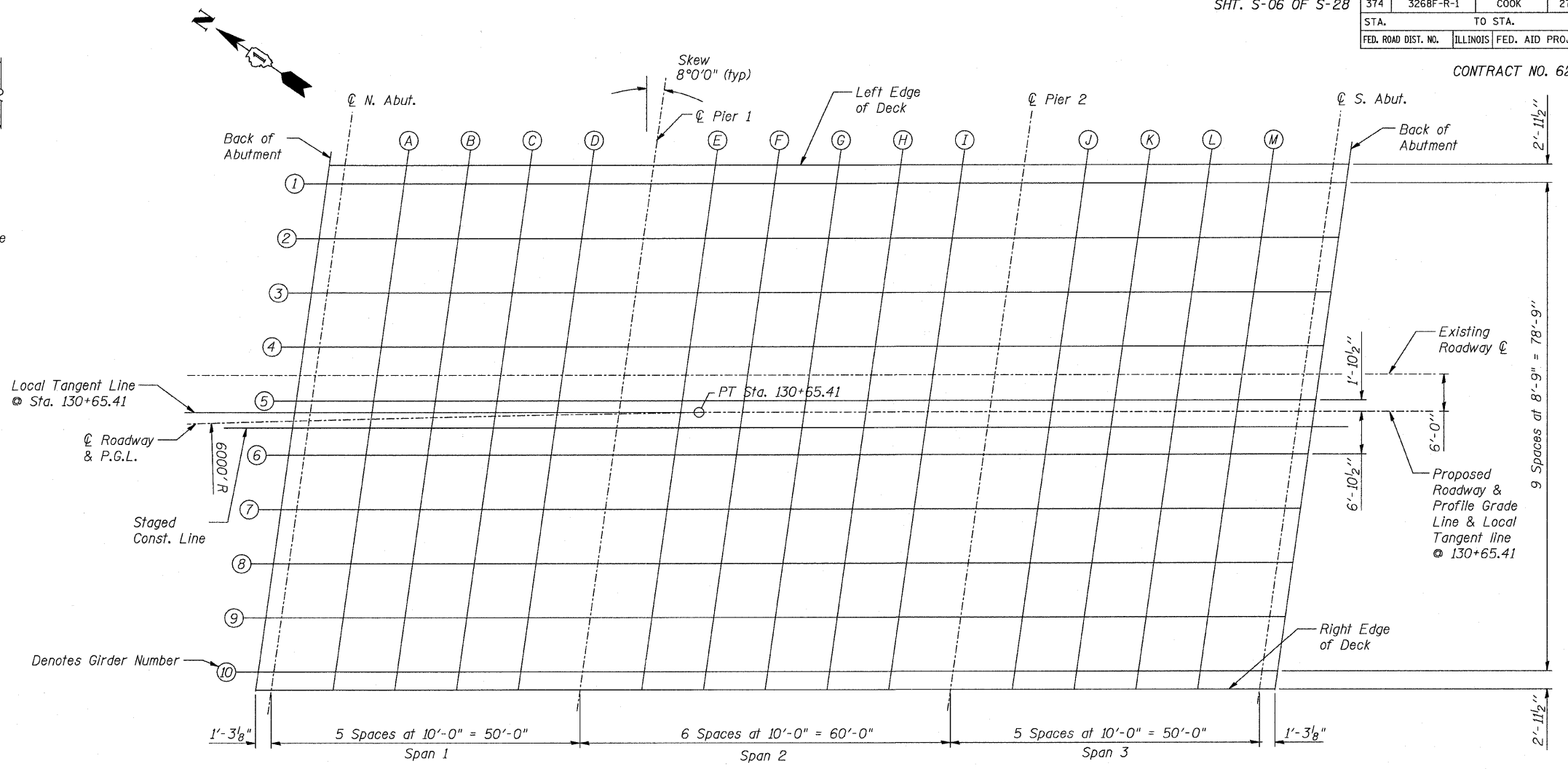

PLAN

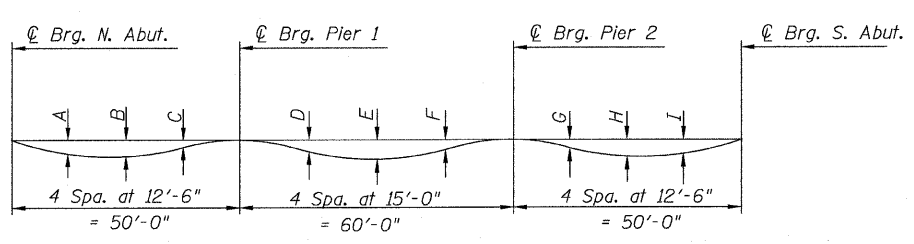

DEAD LOAD DEFLECTION DIAGRAM

(Includes weight of concrete only)

Note: The above deflections are not to be used in the field if the engineer is working from the grade elevations adjusted for dead load deflections as shown below. All dimensions are in inches except as noted. All offsets are in feet.

BEAM	A	B	C	D	E	F	G	H	I
Beams 1 through 10	0.34	0.42	0.20	0.22	0.39	0.22	0.20	0.42	0.34

Notes: See Sheets S-07 thru S-10 for Deck Elevations

REVISIONS	
NAME	DATE

ILLINOIS DEPARTMENT OF TRANSPORTATION
 ILLINOIS ROUTE 21
 MILWAUKEE AVE. OVER DES PLAINES RIVER
 F.A.P. ROUTE 374 SECTION 3268F-R-1
 COOK COUNTY, SN 016-6566

SCREED PLAN

DESIGN BY: AWH DRAWN BY: BTO
 DATE: 02/05/08 CHECKED BY: JAN CHECKED BY: JAW

STV Incorporated
 Engineers/Architects/Planners/Construction Managers
 200 W. Monroe Street, Suite 1650
 Chicago, IL 60606-5013
 312/853-0655, FAX 312/853-0661