

**TEMPORARY INTERCONNECT NOTES**

- ALL LABOR, MATERIALS, AND EQUIPMENT REQUIRED TO INSTALL AND MAINTAIN THE TEMPORARY INTERCONNECT ARE INCLUDED IN THE COST OF THE ITEM "TEMPORARY TRAFFIC SIGNAL INSTALLATION."
- THE EXISTING INTERCONNECT CABLE MAY BE USED AS THE TEMPORARY INTERCONNECT CABLE. IF ADDITIONAL CABLE IS REQUIRED, IT SHALL BE SPLICED TO THE EXISTING CABLE INSIDE BOXES MOUNTED 10' HIGH ON THE WOOD POLES. THE COST OF ANY ADDITIONAL CABLE REQUIRED TO IMPLEMENT THE TEMPORARY INTERCONNECT IS INCLUDED IN THE COST OF THE ASSOCIATED TEMPORARY TRAFFIC SIGNAL INSTALLATIONS.
- DRILL EXISTING HANDHOLE AND PROVIDE 2" GALVANIZED STEEL CONDUIT BETWEEN HANDHOLE AND BASE OF WOOD POLE. PROVIDE 2" UNIT DUCT ON WOOD POLE TO A HEIGHT OF 10' TO PROTECT FIBER OPTIC CABLE. SEE DETAIL THIS SHEET.
- THE CONTRACTOR MAY REQUEST TO SUBSTITUTE THE FIBER OPTIC TEMPORARY INTERCONNECT WITH A WIRELESS INTERCONNECT. SEE SPECIAL PROVISIONS. NO ADDITIONAL COMPENSATION WILL BE MADE IN THE EVENT THAT SUCH A REQUEST IS APPROVED.
- THIS WOOD POLE IS ALSO USED AS A TEMPORARY LIGHTING POLE, AND SHALL MEET THE REQUIREMENTS FOR TEMPORARY LIGHT POLES. SEE LIGHTING PLANS.

**TEMPORARY WOOD POLE LOCATIONS**  
(FOR POLES NOT INSTALLED AS PART OF INTERSECTION TEMPORARY TRAFFIC SIGNAL INSTALLATIONS)

STATION	OFFSET
100+83.5 (EX ILL RTE 21)	29' RT
102+26 (EX ILL RTE 21)	29' RT
104+28	49' RT
109+11	53' RT
111+11	54.5' RT
111+89	54' RT
304+72.5 (US RTE 45)	169.5' LT
303+08 (US RTE 45)	90.5' LT
301+14.5 (US RTE 45)	48' LT
26+18 (EX US RTE 45)	38.5' RT

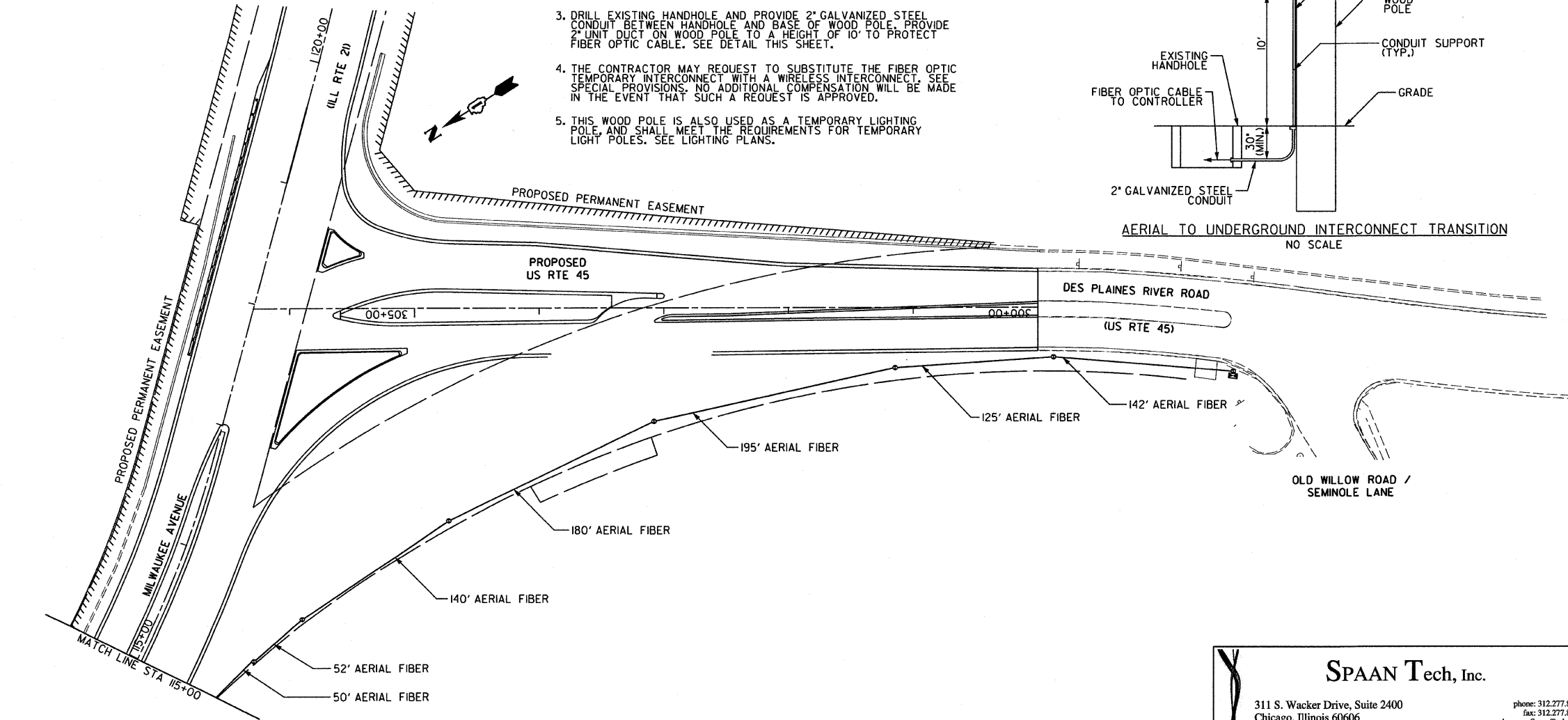
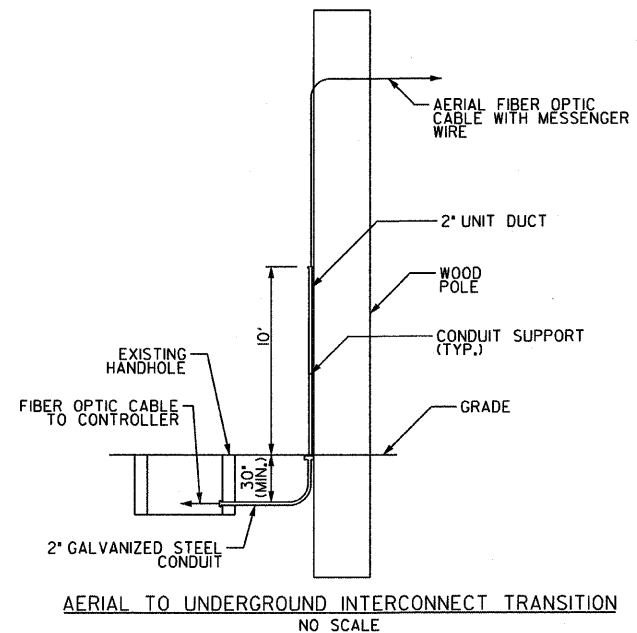

**TEMPORARY INTERCONNECT PLAN LEGEND**

- TEMPORARY CONTROLLER
- EXISTING PERMANENT CONTROLLER
- EXISTING HANDHOLE
- EXISTING HEAVY-DUTY HANDHOLE
- EXISTING DOUBLE HANDHOLE
- TEMPORARY WOOD POLE
- AERIAL FIBER OPTIC CABLE WITH MESSENGER WIRE
- G.S. CONDUIT IN TRENCH (T) OR PUSHED (P)
- EXISTING G.S. CONDUIT

REVISIONS	
NAME	DATE

ILLINOIS DEPARTMENT OF TRANSPORTATION

**TEMPORARY INTERCONNECT PLAN**  
MILWAUKEE AVENUE (US RTE 45/ILL RTE 21)  
PRE-STAGE I AND STAGE I

SCALE: 1" = 50'  
DATE: 02/05/08

DRAWN BY: RAS  
DESIGN BY: RAS  
CHECKED BY: ADO

**SPAAN Tech, Inc.**

311 S. Wacker Drive, Suite 2400  
Chicago, Illinois 60606

phone: 312.277.8800  
fax: 312.277.8808  
web: www.SpaanTech.com

Robert Swanson  
 01/17/08  
 01/17/08  
 2/5/2008 7:00:04 AM  
 I:\Working Files\Drawing Files\Sh\Final\TS\15-33.dgn  
 50,0000 ft / in