

F. A. L. A. SECTION	COUNTY	TOTAL SHEETS	SHEET NO.
05-00113-00-PK	COOK	012	001
STA.	TO STA.	12+1: (13)	
FED. ROAD DIST. NO.	ILLINOIS	FED. AID PROJECT	

CONTRACT NO. 63006

INDEX OF SHEETS

1. TITLE SHEET
2. SUMMARY OF QUANTITIES & GENERAL NOTES
3. TYPICAL CROSS SECTIONS
4. REMOVAL PLAN
5. PROPOSED PLAN
6. PAVEMENT MARKING AND SIGNAGE PLAN
7. LIGHTING PLAN
8. LIGHTING DETAILS
- 9.-10. CROSS SECTIONS
- 11.-12. DISTRICT STANDARDS

STATE STANDARDS

- | | |
|-----------|--|
| 000001-05 | STANDARD SYMBOLS, ABBREVIATIONS AND PATTERNS |
| 280001-04 | TEMPORARY EROSION CONTROL SYSTEMS |
| 424001-05 | CURB RAMPS FOR SIDEWALKS |
| 606001-03 | CONCRETE CURB TYPE B & COMBINATION CONCRETE CURB & GUTTER |
| 701006-02 | OFF-ROAD OPERATIONS, 2L, 2W |
| 701301-02 | LANE CLOSURE, 2L, 2W, SHORT TIME OPERATIONS |
| 701311-02 | LANE CLOSURE, 2L, 2W, MOVING OPERATIONS-DAY ONLY |
| 701501-04 | URBAN LANE CLOSURE, 2L, 2W, UNDIVIDED |
| 701801-03 | URBAN LANE CLOSURE, ML, 2W, CROSSWALK AND SIDEWALK CLOSURE |
| 701901 | TRAFFIC CONTROL DEVICES |
| 720001 | SIGN PANEL MOUNTING DETAILS |
| 720006-01 | SIGN PANEL ERECTION DETAILS |
| 720011 | METAL POSTS FOR SIGNS, MARKERS, AND DELINEATORS |
| 729001 | APPLICATIONS OF TYPE A AND B METAL POSTS (FOR SIGNS & MARKERS) |
| 780001-01 | TYPICAL PAVEMENT MARKINGS |
| 805001 | ELECTRIC SERVICE INSTALLATION DETAILS |

STATE OF ILLINOIS
DEPARTMENT OF TRANSPORTATION
DIVISION OF HIGHWAYS

PLANS FOR PROPOSED FEDERAL AID HIGHWAY

**IVANHOE METRA COMMUTER KISS 'N RIDE
TRACY AVENUE BETWEEN 143RD ST. AND 144TH ST.
CMAQ PROJECT NO.: CMM-8003(584)
L.A. SECTION NO:05-00113-00-PK
VILLAGE of RIVERDALE
COOK COUNTY
C-91-133-06**

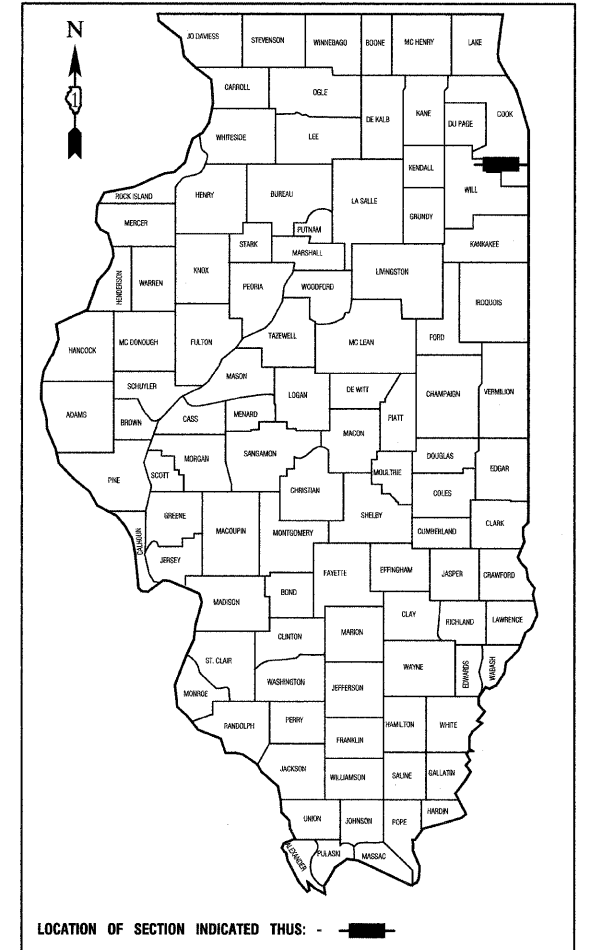

DESIGN DESIGNATION - TRACY AVENUE ADT 5,600 (2030) - LOCAL ROAD
PV=4,928 SU=392 MU=280

TRACY AVENUE

2006 ADT - 5,500
2030 ADT - 5,600

POSTED SPEED LIMIT - 25 MPH

DESIGN PERIOD - 20 YEARS
DESIGN SPEED LIMIT - 30 MPH
STREET CLASSIFICATION - CLASS III

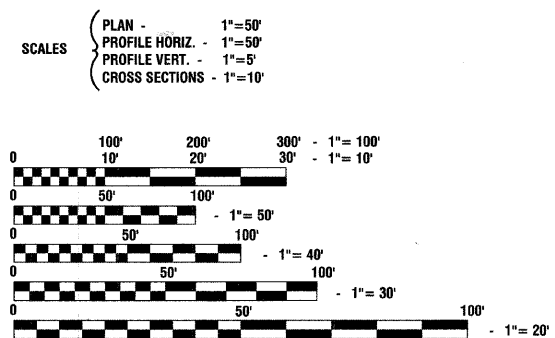
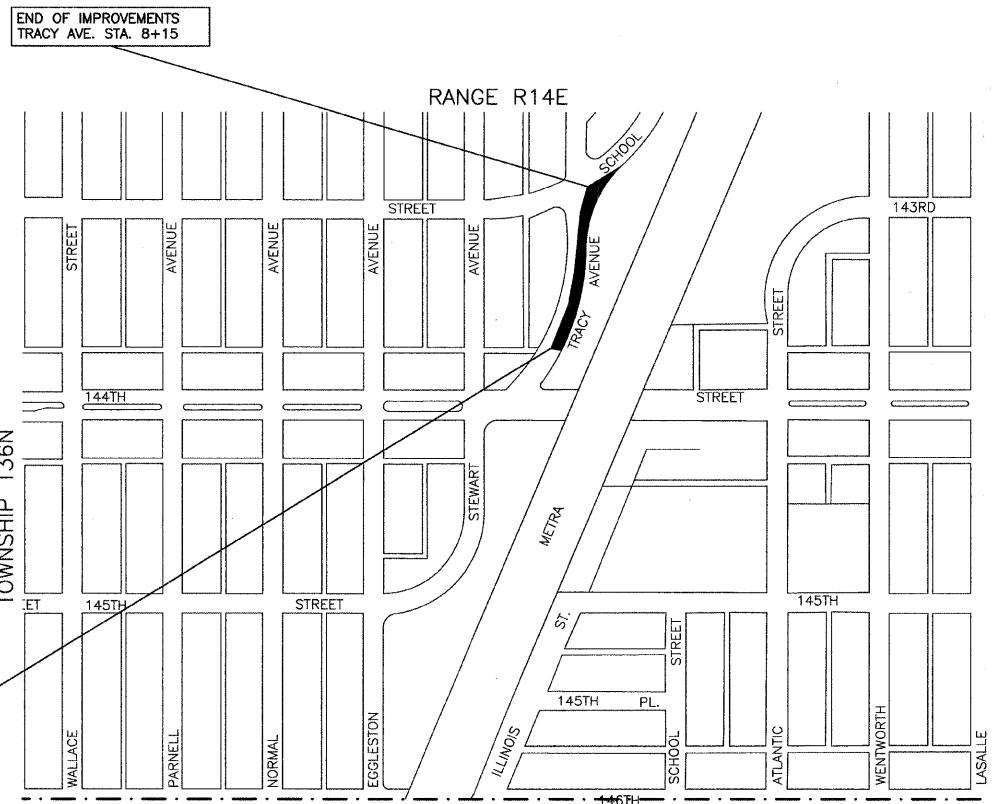

FULL SIZE PLANS HAVE BEEN PREPARED USING STANDARD ENGINEERING SCALES, REDUCED SIZED PLANS WILL NOT CONFORM TO STANDARD SCALES, IN MAKING MEASUREMENTS ON REDUCED PLANS, THE ABOVE SCALES MAY BE USED.

J. U. L. I. E.
JOINT UTILITY LOCATION INFORMATION FOR EXCAVATION
1 - 800 - 892 - 0123

BEGINNING OF IMPROVEMENTS
TRACY AVE. STA 3+15

END OF IMPROVEMENTS
TRACY AVE. STA. 8+15

LOCATION MAP

GROSS LENGTH=528 FEET=0.10 MILES
NET LENGTH=528 FEET=0.10 MILES

STATE OF ILLINOIS
DEPARTMENT OF TRANSPORTATION
DIVISION OF HIGHWAYS

APPROVED: December 21 2007
Benjamin B. Evans
PRESIDENT, VILLAGE OF RIVERDALE

PASSED: FEBRUARY 14 2008
Christopher Holt
DISTRICT ENGINEER OF LOCAL ROADS & STREETS

RELEASED FOR BID BASED ON LIMITED REVIEW: FEBRUARY 14, 2008
Dan M. O'Keefe
DEPUTY DIRECTOR OF HIGHWAYS, REGION ONE ENGINEER

**PRINTED BY THE AUTHORITY OF
THE STATE OF ILLINOIS**

PREPARED BY OR UNDER THE
DIRECT SUPERVISION OF:
Shrik Bah
12/21/07

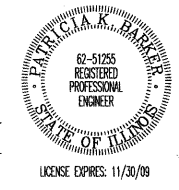

FIELD ENGINEER: MELCHOR MANGOBA 847-705-4408
CONSULTANTS: ROBINSON ENGINEERING, LTD. 708-331-6700

CONTRACT NO. 63006