

STATE OF ILLINOIS
DEPARTMENT OF TRANSPORTATION

Sheet S7 of S25

F.A.I. RTE.	SECTION	COUNTY	TOTAL SHEETS	SHEET NO.
80	81-IHBY-D	ROCK ISLAND	120	36
FED. ROAD DIST. NO. 2 ILLINOIS			FED. AID PROJECT	

Contract # 64C74

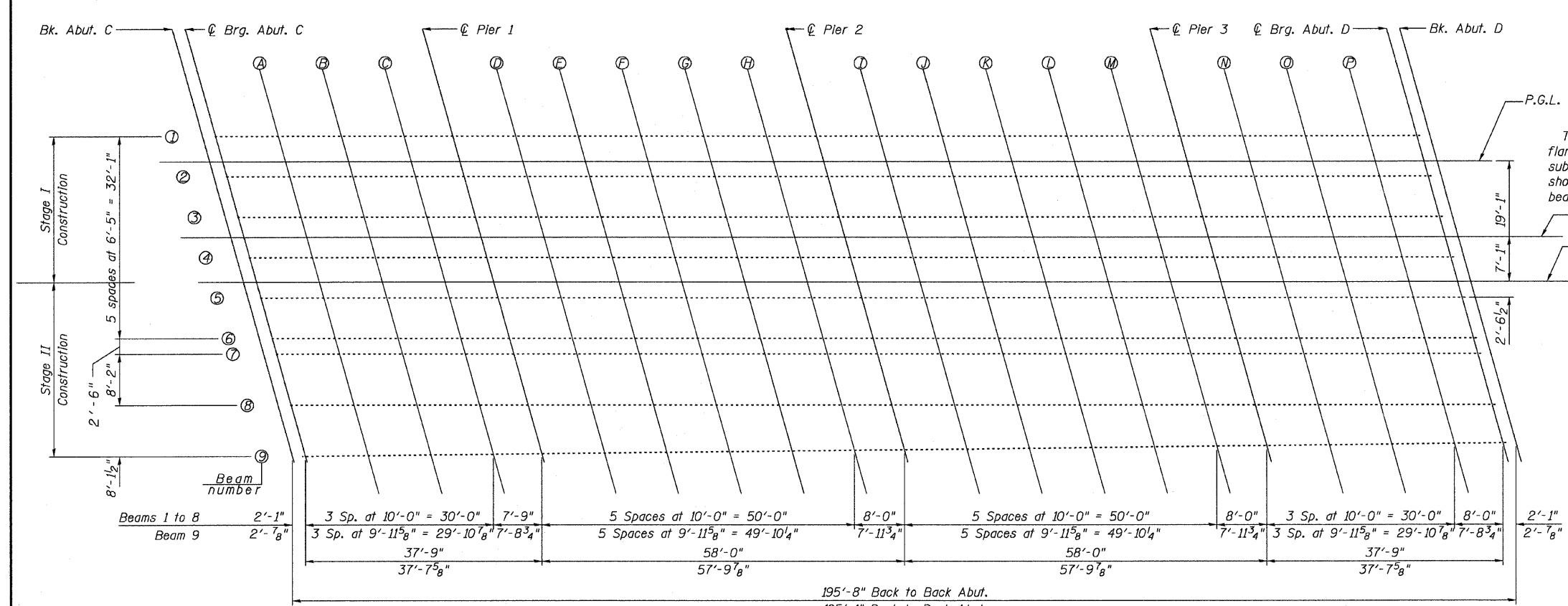

PLAN

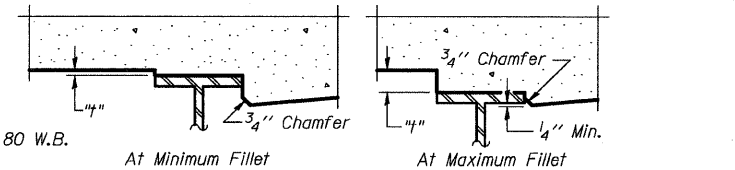

To determine "f": After all structural steel has been erected, elevations of the top flanges of the beams shall be taken at intervals shown below. These elevations subtracted from the "Theoretical Grade Elevations Adjusted for Dead Load Deflection" shown below, minus slab thickness, equals the fillet heights "f" above top flange of beams.

FILLET HEIGHTS

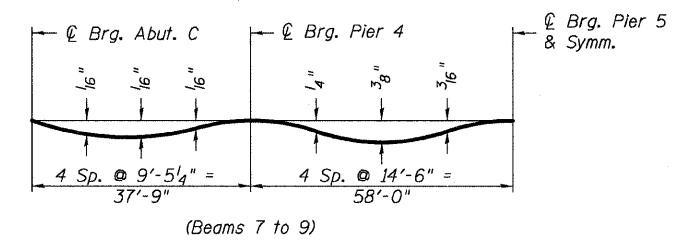
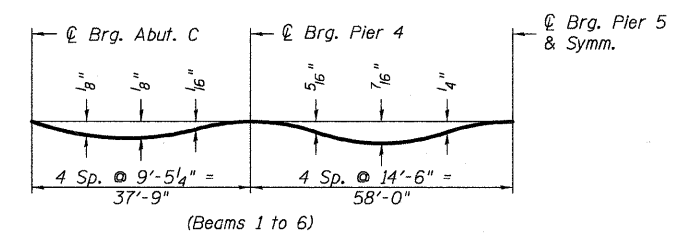

DEAD LOAD DEFLECTION DIAGRAM

(Includes weight of concrete only.)

Note:
The above deflections are not to be used in the field if the engineer is working from the grade elevations adjusted for dead load deflections as shown below.

BEAM 1

Location	Station	Offset	Theoretical Grade Elevations	Theor. Grade Elevations Adj. For Dead Load Deflection
Bk. Abut. C	216+91.88	-4.04	613.38	613.38
Q Brg. Abut. C	216+93.97	-4.04	613.32	613.32
A	217+03.97	-4.04	613.02	613.02
B	217+13.97	-4.04	612.72	612.72
C	217+23.97	-4.04	612.42	612.42
Q Brg. Pier 4	217+31.72	-4.04	612.18	612.18
D	217+41.72	-4.04	611.88	611.90
E	217+51.72	-4.04	611.58	611.61
F	217+61.72	-4.04	611.28	611.32
G	217+71.72	-4.04	610.98	611.01
H	217+81.72	-4.04	610.68	610.69
Q Brg. Pier 5	217+89.72	-4.04	610.44	610.44
I	217+99.72	-4.04	610.14	610.15
J	218+09.72	-4.04	609.84	609.87
K	218+19.72	-4.04	609.54	609.58
L	218+29.72	-4.04	609.24	609.27
M	218+39.72	-4.04	608.94	608.95
Q Brg. Pier 6	218+47.72	-4.04	608.70	608.70
N	218+57.72	-4.04	608.40	608.41
O	218+67.72	-4.04	608.10	608.11
P	218+77.72	-4.04	607.80	607.81
Q Brg. Abut. D	218+85.47	-4.04	607.57	607.57
Bk. Abut. D	218+87.55	-4.04	607.51	607.51

PGL

Location	Station	Offset	Theoretical Grade Elevations	Theor. Grade Elevations Adj. For Dead Load Deflection
Bk. Abut. C	216+93.02	0.00	613.43	613.43
Q Brg. Abut. C	216+95.10	0.00	613.37	613.37
A	217+05.10	0.00	613.07	613.07
B	217+15.10	0.00	612.77	612.77
C	217+25.10	0.00	612.47	612.47
Q Brg. Pier 4	217+32.85	0.00	612.23	612.23
D	217+42.85	0.00	611.93	611.95
E	217+52.85	0.00	611.63	611.66
F	217+62.85	0.00	611.33	611.37
G	217+72.85	0.00	611.03	611.06
H	217+82.85	0.00	610.73	610.74
Q Brg. Pier 5	217+90.85	0.00	610.49	610.49
I	218+00.85	0.00	610.19	610.20
J	218+10.85	0.00	609.89	609.92
K	218+20.85	0.00	609.59	609.63
L	218+30.85	0.00	609.29	609.32
M	218+40.85	0.00	608.99	609.01
Q Brg. Pier 6	218+48.85	0.00	608.75	608.75
N	218+58.85	0.00	608.45	608.46
O	218+68.85	0.00	608.15	608.16
P	218+78.85	0.00	607.85	607.86
Q Brg. Abut. D	218+86.60	0.00	607.62	607.62
Bk. Abut. D	218+88.68	0.00	607.56	607.56

BEAM 2

Location	Station	Offset	Theoretical Grade Elevations	Theor. Grade Elevations Adj. For Dead Load Deflection
Bk. Abut. C	216+93.68	2.38	613.45	613.45
Q Brg. Abut. C	216+95.77	2.38	613.38	613.38
A	217+05.77	2.38	613.08	613.09
B	217+15.77	2.38	612.78	612.79
C	217+25.77	2.38	612.48	612.48
Q Brg. Pier 4	217+33.52	2.38	612.25	612.25
D	217+43.52	2.38	611.95	611.97
E	217+53.52	2.38	611.65	611.68
F	217+63.52	2.38	611.35	611.38
G	217+73.52	2.38	611.05	611.07
H	217+83.52	2.38	610.75	610.76
Q Brg. Pier 5	217+91.52	2.38	610.51	610.51
I	218+01.52	2.38	610.21	610.22
J	218+11.52	2.38	609.91	609.94
K	218+21.52	2.38	609.61	609.64
L	218+31.52	2.38	609.31	609.34
M	218+41.52	2.38	609.01	609.02
Q Brg. Pier 6	218+49.52	2.38	608.77	608.77
N	218+59.52	2.38	608.47	608.47
O	218+69.52	2.38	608.17	608.18
P	218+79.52	2.38	607.87	607.88
Q Brg. Abut. D	218+87.27	2.38	607.64	607.64
Bk. Abut. D	218+89.35	2.38	607.58	607.57

FILES
TIMES
DATES

PATRICK
ENGINEERING INC.
LISLE, ILLINOIS

ILLINOIS DEPARTMENT OF TRANSPORTATION
TOP OF SLAB ELEVATIONS III (EB BRIDGE)
INTERSTATE 80 OVER INTERSTATE 88
F.A.I. ROUTE 80 - SECTION 81-IHBY-D
ROCK ISLAND COUNTY
STATION 217+81.50
EB S.N. 081-0012 & WB 081-0013
DATE: FEBRUARY 27, 2008
DRAWN BY: M. Woldezion
CHECKED BY: A. Yorglcoolu