

F.A.P. RTE.	SECTION	COUNTY	TOTAL SHEETS	SHEET NO.
316	102T	LEE	41	15
STA.		TO STA.		
FED. ROAD DIST. NO.		ILLINOIS FED. AID PROJECT		

STA. 457+83

BILL DEMPSEY TWO CELL 6' x 3' BOX CULVERT

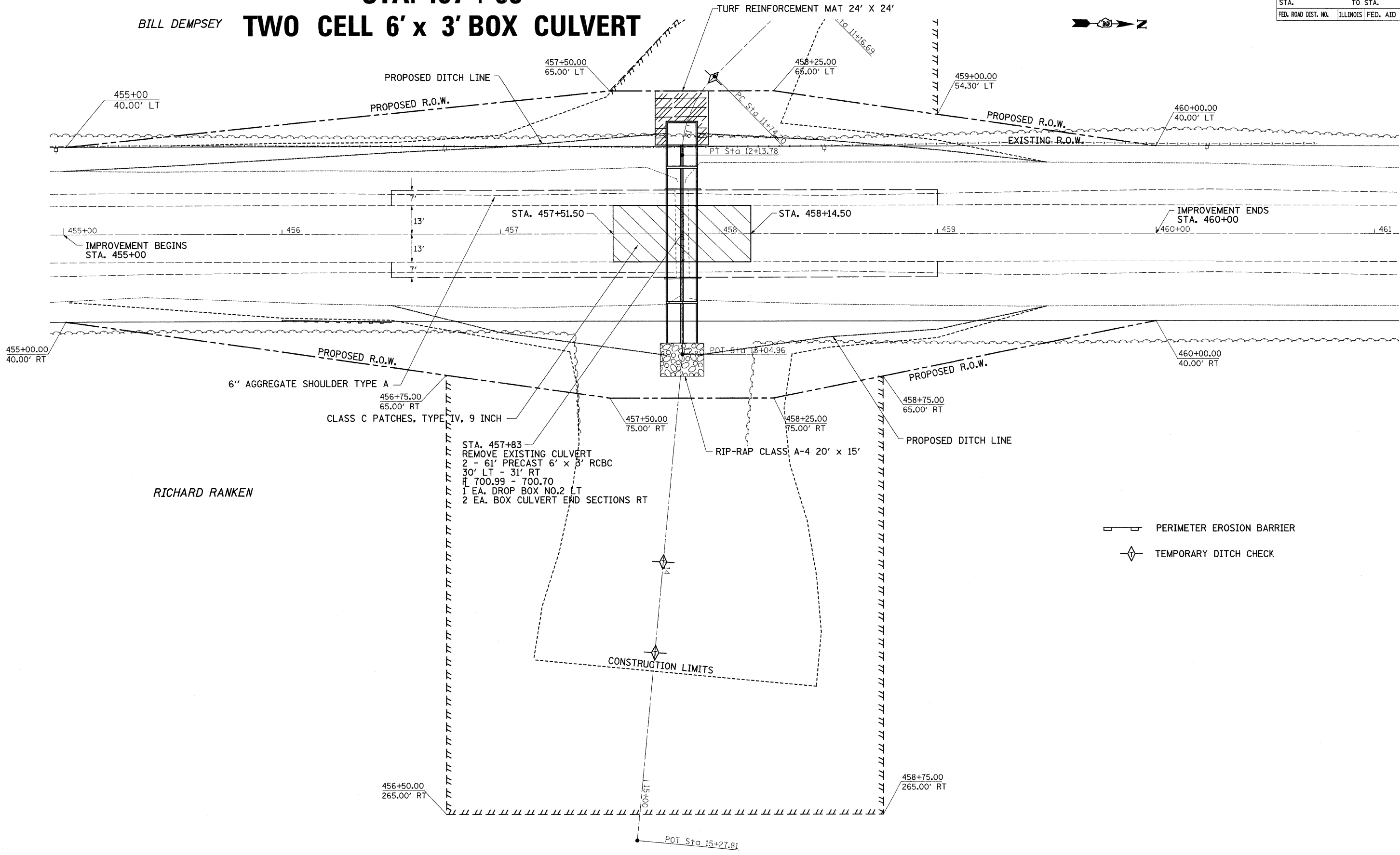

RICHARD RANKEN

STA. 457+83
 REMOVE EXISTING CULVERT
 2 - 61' PRECAST 6' x 3' RCBC
 30' LT - 31' RT
 R 700.99 - 700.70
 1 EA. DROP BOX NO.2 LT
 2 EA. BOX CULVERT END SECTIONS RT

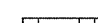
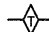
-  PERIMETER EROSION BARRIER
-  TEMPORARY DITCH CHECK

DATE	
BY	
PLAN	
NO.	
NOTE BOOK	
NO.	
DATE	
BY	
PROFILE	
NO.	
NOTE BOOK	
NO.	
DATE	
BY	

DATE	
BY	
PROFILE	
NO.	
NOTE BOOK	
NO.	
DATE	
BY	

PLOT DATE = Wed Jan 30 08:49:30 2008
 FILE NAME = C:\Projects\12200507.dwg
 USER NAME = rranken