

DATE	BY	CHKD	APP'D

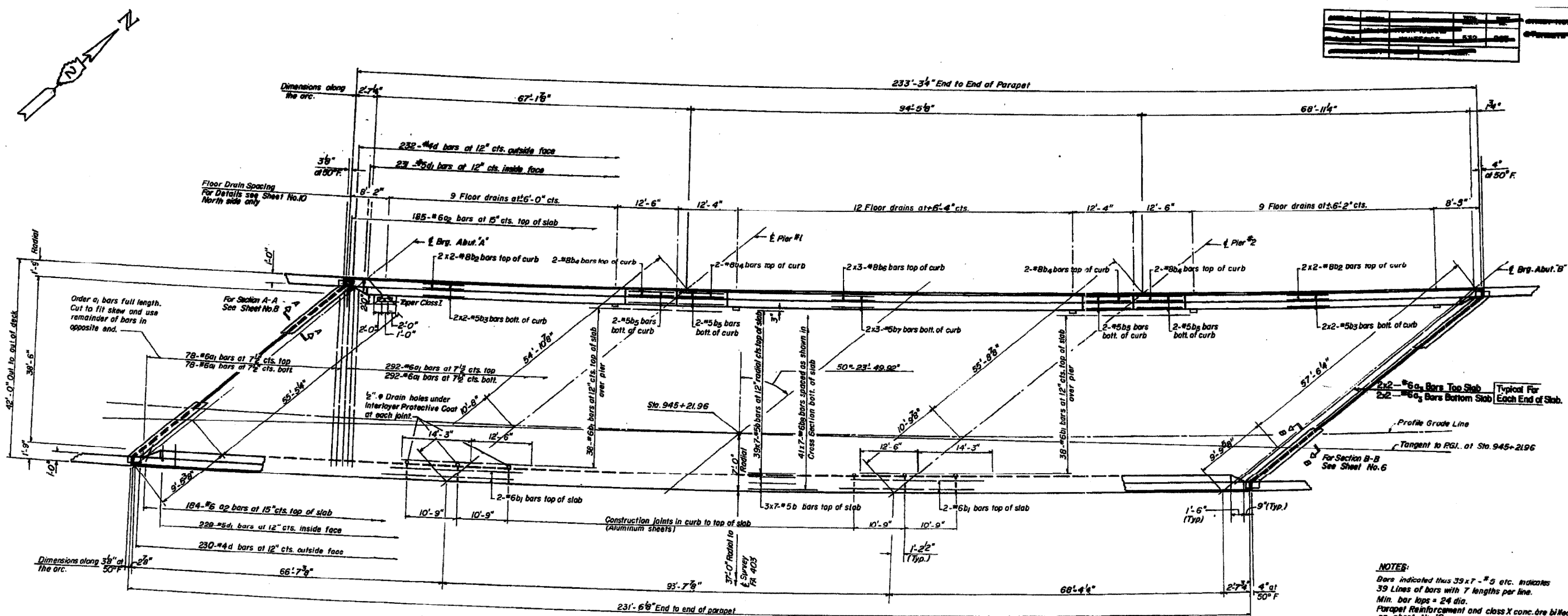

**DECK PLAN
WEST BOUND ROADWAY**

NOTES:
 Bars indicated thus 39x7-#5 etc. indicates 39 Lines of bars with 7 lengths per line. Min. bar lgs = 24 dia.
 Parapet Reinforcement and class X conc. are billed on sheet No. 10
 Work this sheet with sheets No. 688
 Dimensions shown are outside fascia of deck.

FOR INFORMATION ONLY

LOCATION 4 Structure Numbers 081-0134 & 0135

DESIGNED	HRS
CHECKED	AA
DRAWN	GG
CHECKED	A.A.

**DECK SLAB
WEST BOUND ROADWAY**
 FA 403 SECTION 161-1B-4
 FA 403 OVER MEREDOSIA DITCH
ROCK ISLAND & WHITE SIDE COUNTY
 STATION 944+69.00
 REV 9-26-72 L.S.

* FAI ROUTES 74 & 88
 ** D2 BRIDGE PAINTING 2008-1

FILE NAME = P:\PAINTING\64089\paint2008-1.dgn	USER NAME = lmkdj	DESIGNED -	REVISED -	STATE OF ILLINOIS DEPARTMENT OF TRANSPORTATION	EXISTING BRIDGE PLANS				F.A. RTE.	SECTION	COUNTY	TOTAL SHEETS	SHEET NO.
		DRAWN -	REVISED -		SCALE:	SHEET NO.	OF	SHEETS	STA.	TO STA.	ROCK ISLAND	40	34
		CHECKED -	REVISED -								CONTRACT NO. 64D89		
		DATE -	REVISED -								FED. ROAD DIST. NO.	ILLINOIS	FED. AID PROJECT