

STATE OF ILLINOIS
DEPARTMENT OF TRANSPORTATION

ROUTE NO.	SECTION	COUNTY	TOTAL SHEETS	SHEET NO.
FAU 2503	(35) BR-2	KENDALL	129	34
FED. ROAD DIST. NO. 7		ILLINOIS	FED. AID PROJECT	
Contract No. 66399				

SHEET NO. 10
25 SHEETS

EAST CURB LINE

Location	Station	Offset	Theoretical Grade Elevations
End of S. Approach Pvmt.	13+44.00	-21.00	626.586
A	13+54.00	-21.00	626.636
B	13+64.00	-21.00	626.702
Bk. S. Abutment	13+74.00	-21.00	626.786

EAST EDGE OF PAVEMENT

Location	Station	Offset	Theoretical Grade Elevations
End of S. Approach Pvmt.	13+44.00	-13.00	626.746
A	13+54.00	-13.00	626.796
B	13+64.00	-13.00	626.862
Bk. S. Abutment	13+74.00	-13.00	626.946

STAGE CONSTRUCTION LINE

Location	Station	Offset	Theoretical Grade Elevations
End of S. Approach Pvmt.	13+44.00	-0.50	626.996
A	13+54.00	-0.50	627.046
B	13+64.00	-0.50	627.112
Bk. S. Abutment	13+74.00	-0.50	627.196

☉ ROADWAY & P.G.

Location	Station	Offset	Theoretical Grade Elevations
End of S. Approach Pvmt.	13+44.00	0	627.006
A	13+54.00	0	627.056
B	13+64.00	0	627.122
Bk. S. Abutment	13+74.00	0	627.206

WEST EDGE OF PAVEMENT

Location	Station	Offset	Theoretical Grade Elevations
End of S. Approach Pvmt.	13+44.00	13.00	626.746
A	13+54.00	13.00	626.796
B	13+64.00	13.00	626.862
Bk. S. Abutment	13+74.00	13.00	626.946

WEST CURB LINE

Location	Station	Offset	Theoretical Grade Elevations
End of S. Approach Pvmt.	13+44.00	23.00	626.546
A	13+54.00	23.00	626.596
B	13+64.00	23.00	626.662
Bk. S. Abutment	13+74.00	23.00	626.746

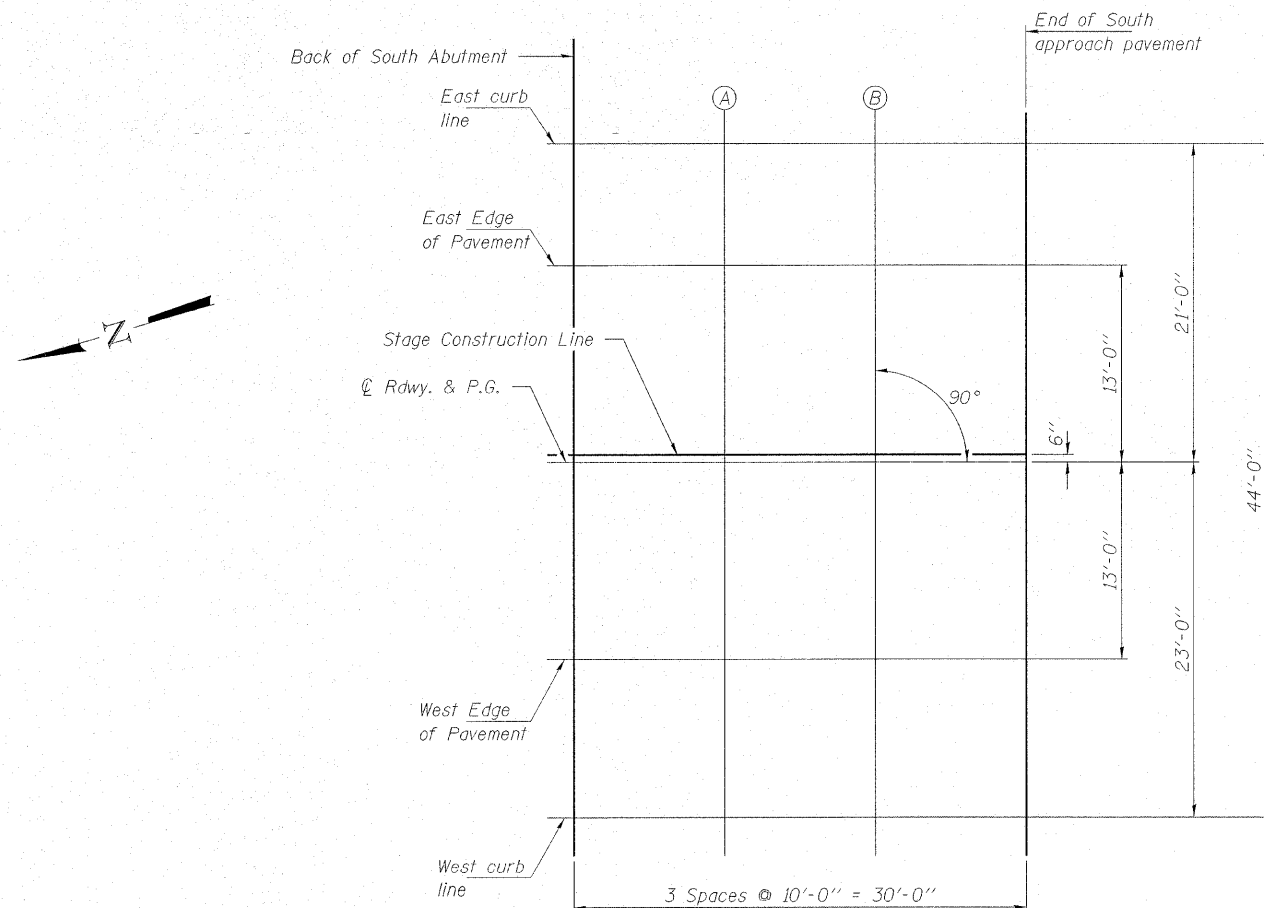

PLAN

HAMPTON, LENZINI & RENWICK, INC.
CIVIL & STRUCTURAL ENGINEERS
LAND SURVEYORS

3085 STEVENSON DRIVE, SUITE 201
SPRINGFIELD, ILLINOIS 62703
(217) 546-3400

ELGIN • SPRINGFIELD

PROJECT NUMBER: 12-06-0029-1 DATE: 01/14/08
DESIGNED: P.S.L. CHECKED: M.D.C. DRAWN: D.A.B.

SOUTH APPROACH SLAB ELEVATIONS

IL 25 OVER WAUBONSEE CREEK
F.A.U. ROUTE 2503 / SECTION (35) BR-2
KENDALL COUNTY
STATION 12+91.00
STRUCTURE NO. 047-0062